

KOBALT™

KOBALT and logo design are trademarks or registered trademarks of LF, LLC. All rights reserved.

ITEM #5472271
MODEL #CS3558LW

14-IN. CHOP SAW 35.56 CM SIERRA DE CORTE

Español p. 29

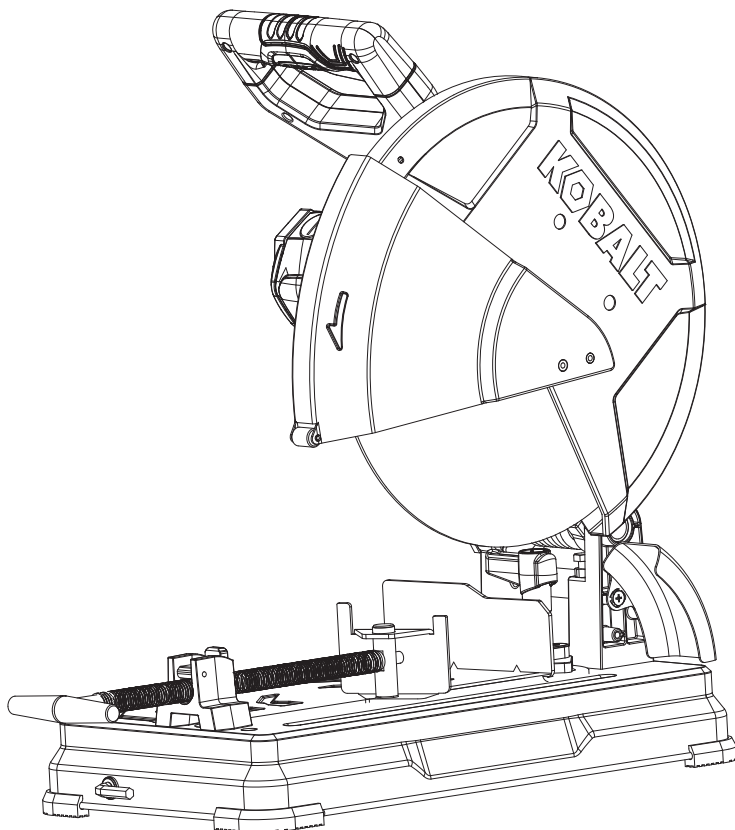

Serial Number _____

Purchase Date _____

Thank you for purchasing this KOBALT product.

Questions, problems or missing parts?

Before returning, contact us on:

888-356-2258, 8 a.m. - 8 p.m., EST, Monday - Sunday or ascs@lowes.com.

TABLE OF CONTENTS

Product Specifications.....	2
Package Contents.....	3
Know Your Chop Saw.....	4
General Power Tool Safety Warnings.....	5
Safety Instructions For Chop Saws.....	7
Electrical Safety Information.....	12
Preparation.....	14
Assembly Instructions.....	15
Adjustment Instructions.....	17
Operating Instructions.....	20
Care And Maintenance.....	22
Troubleshooting.....	24
Replacement Parts List.....	25
Warranty.....	28

PRODUCT SPECIFICATIONS

DESCRIPTION	SPECIFICATIONS
Power Source	15A, 120 V, 60 Hz
No Load Speed	3,900 RPM
Double Insulated	Yes
Diameter	14 in.
Arbor	1 in.
Cross cut 0°	
Round	5 in.
Square	4-3/4 in. x 4-3/4 in.
Rectangular	4-1/2 in. x 6-1/2 in. / 3 in. x 9 in.
Miter cut 45°	
Round	4 in.
Square	4 in. x 4 in.
Rectangular	3-11/32 in. x 5 in.
Vise clamp angle	0° - 45°

PACKAGE CONTENTS

UNPACKING YOUR CHOP SAW

⚠ WARNING: To avoid injury from unexpected starting or electrical shock, do not plug the power cord into a source of power during unpacking and assembly. The cord must remain unplugged whenever you are adjusting/assembling the saw.

- 1. Remove the chop saw from the carton.
- 2. Place the saw on a secure and stationary work surface.
- 3. Separate all parts from the packing material. Check each one with the illustration below to make certain all items are accounted for before discarding any packing material.

⚠ WARNING: If any part is missing or damaged, do not attempt to assemble the chop saw or plug in the power cord until the missing or damaged part is correctly replaced. To avoid electric shock, use only identical replacement parts when servicing double-insulated tools.

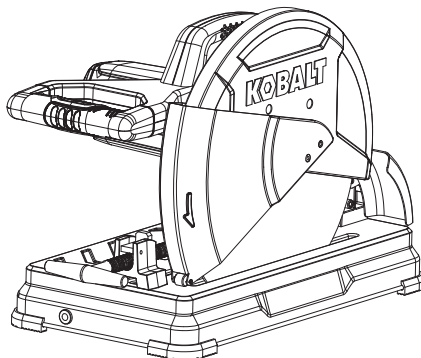

A

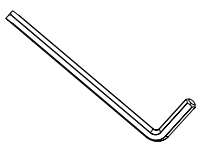

B

PART	DESCRIPTION	QUANTITY
A	Chop saw assembly	1
B	Cutting wheel wrench (8 mm)	1

KNOW YOUR CHOP SAW

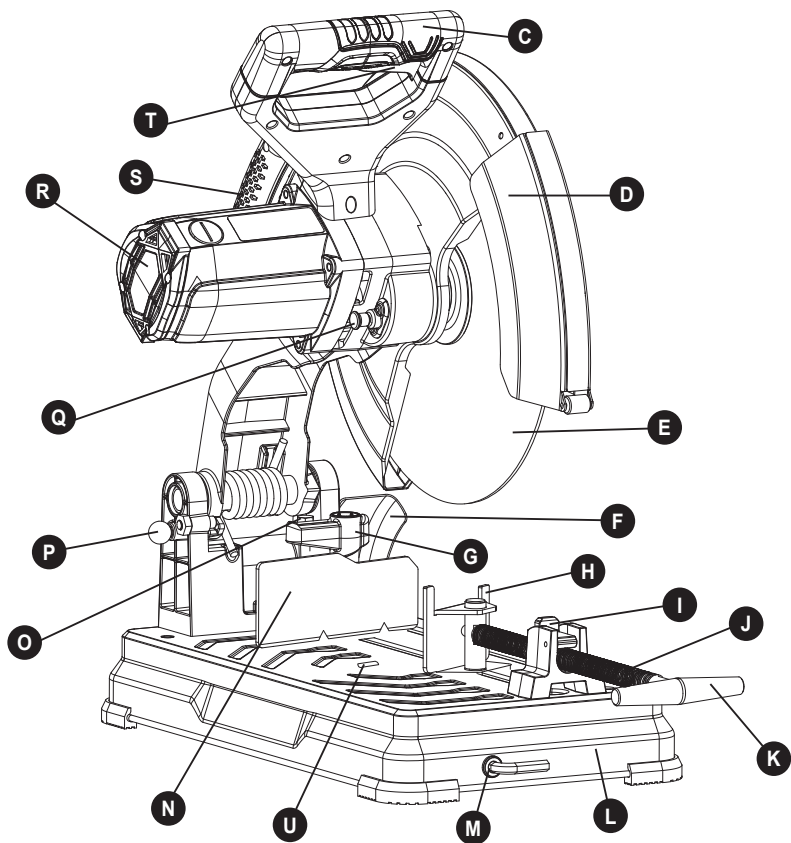

PART	DESCRIPTION
C	Switch handle
D	Lower wheel guard
E	Abrasive cutting wheel
F	Spark Deflector
G	Fence lock knob
H	Vise clamp
I	Quick-release locking lever
J	Vise
K	Vise handle

PART	DESCRIPTION
L	Base
M	Cutting wheel wrench & storage
N	Fence
O	Depth stop adjustment bolt
P	Head lock down pin
Q	Arbor lock button
R	Motor
S	Carrying handle
T	Trigger switch
U	Slot

GENERAL POWER TOOL SAFETY WARNINGS



WARNING

Read all safety warnings, instructions, illustrations and specifications provided with this power tool. Failure to follow all instructions listed below may result in electric shock, fire and/or serious injury.

Save all warnings and instructions for future reference.

The term "power tool" in the warnings refers to your mains-operated (corded) power tool or battery-operated (cordless) power tool.

Work area safety

- **Keep work area clean and well lit.** Cluttered or dark areas invite accidents.
- **Do not operate power tools in explosive atmospheres, such as in the presence of flammable liquids, gases or dust.** Power tools create sparks which may ignite the dust or fumes.
- **Keep children and bystanders away while operating a power tool.** Distractions can cause you to lose control.

Electrical safety

- **Power tool plugs must match the outlet. Never modify the plug in any way. Do not use any adapter plugs with earthed (grounded) power tools.** Unmodified plugs and matching outlets will reduce risk of electric shock.
- **Avoid body contact with earthed or grounded surfaces, such as pipes, radiators, ranges and refrigerators.** There is an increased risk of electric shock if your body is earthed or grounded.
- **Do not expose power tools to rain or wet conditions.** Water entering a power tool will increase the risk of electric shock.
- **Do not abuse the cord. Never use the cord for carrying, pulling or unplugging the power tool. Keep cord away from heat, oil, sharp edges or moving parts.** Damaged or entangled cords increase the risk of electric shock.
- **When operating a power tool outdoors, use an extension cord suitable for outdoor use.** Use of a cord suitable for outdoor use reduces the risk of electric shock.
- **If operating a power tool in a damp location is unavoidable, use a residual current device (RCD) protected supply.** Use of an RCD reduces the risk of electric shock.

Personal safety

- **Stay alert, watch what you are doing and use common sense when operating a power tool. Do not use a power tool while you are tired or under the influence of drugs, alcohol or medication.** A moment of inattention while operating power tools may result in serious personal injury.
- **Use personal protective equipment. Always wear eye protection.** Protective equipment such as dust mask, non-skid safety shoes, hard hat, or hearing protection used for appropriate conditions will reduce personal injuries.

- **Prevent unintentional starting. Ensure the switch is in the off-position before connecting to power source and/or battery pack, picking up or carrying the tool.** Carrying power tools with your finger on the switch or energizing power tools that have the switch on invites accidents.
- **Remove any adjusting key or wrench before turning the power tool on.** A wrench or a key left attached to a rotating part of the power tool may result in personal injury.
- **Do not overreach. Keep proper footing and balance at all times.** This enables better control of the power tool in unexpected situations.
- **Dress properly. Do not wear loose clothing or jewelry. Keep your hair, clothing and gloves away from moving parts.** Loose clothes, jewelry or long hair can be caught in moving parts.
- **If devices are provided for the connection of dust extraction and collection facilities, ensure these are connected and properly used.** Use of dust collection can reduce dust-related hazards.
- **Do not let familiarity gained from frequent use of tools allow you to become complacent and ignore tool safety principles.** A careless action can cause severe injury within a fraction of a second.

Power tool use and care

- **Do not force the power tool. Use the correct power tool for your application.** The correct power tool will do the job better and safer at the rate for which it was designed.
- **Do not use the power tool if the switch does not turn it on and off.** Any power tool that cannot be controlled with the switch is dangerous and must be repaired.
- **Disconnect the plug from the power source and/or remove the battery pack, if detachable, from the power tool before making any adjustments, changing accessories, or storing power tools.** Such preventive safety measures reduce the risk of starting the power tool accidentally.
- **Store idle power tools out of the reach of children and do not allow persons unfamiliar with the power tool or these instructions to operate the power tool.** Power tools are dangerous in the hands of untrained users.
- **Maintain power tools and accessories. Check for misalignment or binding of moving parts, breakage of parts and any other condition that may affect the power tool's operation. If damaged, have the power tool repaired before use.** Many accidents are caused by poorly maintained power tools.
- **Keep cutting tools sharp and clean.** Properly maintained cutting tools with sharp cutting edges are less likely to bind and are easier to control.
- **Use the power tool, accessories and tool bits etc. in accordance with these instructions, taking into account the working conditions and the work to be performed.** Use of the power tool for operations different from those intended could result in a hazardous situation.
- **Keep handles and grasping surfaces dry, clean and free from oil and grease.** Slippery handles and grasping surfaces do not allow for safe handling and control of the tool in unexpected situations.

Service

- **Have your power tool serviced by a qualified repair person using only identical replacement parts.** This will ensure that the safety of the power tool is maintained.

SAFETY INSTRUCTIONS FOR CHOP SAWS

BEFORE USING THE CHOP SAW, IT IS CRITICAL THAT YOU READ AND UNDERSTAND THESE SAFETY RULES.

- ⚠ WARNING:** To avoid mistakes that could cause serious or permanent injury, do not plug the chop saw until the following instructions have been read and understood.
- Learn the function of the ON/OFF switch, cutting handle and wheel guard.
 - Review and understand all safety instructions and operating procedures in this Operator's manual.
 - Review the maintenance methods for this chop saw.
 - Find and read all the warning labels on the chop saw:
 - Read manual before using the chop saw.
 - Wear safety goggles.
 - Never perform cutting operations with wheel guard removed.
 - Turn power OFF, wait for abrasive wheel to stop and remove power cord from power source before adjusting or servicing.
 - The arbor bolt and all clamps have to be tightened before cutting.
 - Make sure the workpiece and the abrasive wheel are not in contact prior to operating the saw.

WHEN INSTALLING OR MOVING YOUR CHOP SAW:

- **Avoid a dangerous environment:**
 - Use the chop saw in a dry, indoor location protected from rain and moisture.
 - Keep work area well lit.
- **To avoid injury from unexpected chop saw movement:**
 - Bolt or clamp the chop saw to a firm level surface where there is plenty of room to move the workpiece through the entire cut.
 - Position the chop saw so the feet are level and the chop saw does not rock.
 - Position the chop saw where operators and bystanders stand a safe distance away from the saw and are not in direct line with the cutting wheel.
 - To avoid injury from electrical shock, make sure your fingers do not touch the plug's metal prongs when plugging in or unplugging the chop saw.
 - Turn OFF and unplug the chop saw before moving it to a new area. To avoid back injury, get help when transporting.
 - Bolt the chop saw to the floor if it tends to move when cutting long, heavy workpieces.
 - **DO NOT STAND ON** the chop saw. Do not store materials above or near it. Standing on the tool could result in serious injury.

BEFORE EACH USE

- **Inspect your chop saw:**
 - If any part is missing, bent or broken in any way, or any electrical part does not work properly, turn the chop saw OFF and unplug the tool.
 - Replace damaged or missing parts before using the chop saw.
- **Avoid injury from jams, slips or thrown pieces (kickbacks):**
 - Use this chop saw to cut ferrous material only.
 - Avoid injury from thrown pieces. Make sure the abrasive wheel is properly installed and the arbor bolt is tight.
 - Use the right tool. Do not force the tool to do a job it is not intended to do.

- **Inspect your work area:**
 - Keep the work area clean.
 - Cluttered areas and benches invite accidents. The floor must not be slippery from wax, sawdust or shavings, etc.
 - Avoid burns or other fire damage. Do not use the chop saw near flammable liquids, vapors or gases.
 - Before using the chop saw, clear the table of all objects not needed to feed the workpiece.
 - Avoid injury. Do not perform layout, assembly or setup on the chop saw.
 - Never hold a workpiece. Workpiece will become very hot while being cut.
- **Plan your work:**
 - Before trying a new or not often used operation, carefully plan your hand placement. Make sure you have proper fixtures, stops and other items ready to use. Avoid injury from unsafe accessories. Use only recommended accessories.
- **Dress for safety:**
 - Plan ahead to protect your eyes, hands, face and ears.
 - Do not wear loose clothing, gloves, neckties or jewelry (rings, wrist watches). They can get caught and draw you into moving parts.
 - Wear non-slip footwear.
 - Tie back long hair.
 - Roll long sleeves above the elbow.
 - Noise levels vary widely. To avoid possible hearing damage, wear ear plugs or muffs when using the chop saw.
 - The chop saw can throw debris into your eyes which can result in permanent eye damage. Wear safety goggles (not glasses) that comply with ANSI Standards. Regular eyeglasses have only impact-resistant lenses. They are not safety glasses.
 - Wear a dust mask along with safety goggles during each operation.
- **Inspect your workpiece:**
 - Make sure there are no bolts or foreign objects in the part of the workpiece to be cut.
- **Plan your cut:**
 - Do not cut freehand. Guide your workpiece solidly against the fence and table top. Make sure there is no debris between the workpiece and its supports.
 - Use extra caution with large, small or awkward workpieces.
 - Use extra support (tables, sawhorses, blocks) if your workpiece is hard to hold down to the table. Do not use another person as additional support or to help feed, support or pull the workpiece.
 - Do not cut more than one workpiece at a time.
 - Do not turn your chop saw ON before clearing everything except the workpiece and related support devices off the table.
- **Avoid accidental starting:**
 - Make sure the switch is off before plugging the abrasive chop saw into a power source.

WHEN THE CHOP SAW IS RUNNING

 **WARNING:** Do not allow familiarity gained from frequent use of your chop saw to cause a careless mistake. Remember that a careless fraction of a second is enough to cause a severe injury.

- **Keep children away:**
 - Make sure all bystanders are clear of the power tool before and during use.

- Before using the power tool, test the saw by turning it on and letting it run for a few seconds. If it makes an unfamiliar noise or vibrates, stop immediately. Turn the chop saw off and unplug. Do not restart the tool until the problem has been corrected.
- **Do not force the tool:**
 - Only cut one piece per cutting operation.
- **Before freeing jammed material:**
 - Release the trigger switch.
 - Wait for all moving parts to stop.
 - Unplug the chop saw.
- **Before leaving the chop saw:**
 - Release the trigger switch.
 - Unplug the chop saw.
 - Make the workshop childproof. Lock the shop. Disconnect master switches.

WARNING

- A 14 in. wheel is the maximum wheel capacity of your chop saw. Never use a wheel that is too thick to allow outer flange to engage with the flats on the spindle. Larger wheels will come in contact with the wheel guards, while thicker wheels will prevent the bolt from securing the wheel on the spindle. Either of these situations could result in a serious accident causing personal injury.
- Do not attempt to cut wood or masonry with this chop saw. Never cut magnesium or magnesium alloy with this machine. Failure to comply could result in serious personal injury.
- To prevent chop saw movement or tipping during cutting procedure, secure the chop saw to a workbench or work surface that is also secure.
- Always use the vise on the chop saw to prevent accidents that could result in serious personal injury.
- Never stand or have any part of your body in line with the path of the wheel. Doing so may cause an accident resulting in serious personal injury.

WARNING



Large, circular or irregularly shaped workpieces may require additional clamping in order to be properly secured for cutting. Use “C” clamps that can be mounted along the left and front side of the machine base. Also use blocks to hold material securely. Failure to comply could result in serious personal injury.

- **Use only correct wheels.** Do not use wheels with incorrect size holes. Never use wheel washers or wheel screws that are defective or incorrect. The maximum wheel capacity of your chop saw is 14 inches.
- **Do not remove the chop saw’s wheel guards.** Never operate the chop saw with any guard or cover removed. Make sure all guards are operating properly before each use.
- **Keep hands away from cutting area.** Keep hands away from wheel. Do not reach underneath work or around or under the wheel while the wheel is rotating. Do not attempt to remove cut material while wheel is moving.
- **Never use in an explosive atmosphere.** Normal sparking of the motor or sparking from cutting metal could ignite fumes.
- **Do not use tool if switch does not turn it on and off.** Have defective switch replaced by an authorized service center.

- **Keep tool dry, clean and free from oil and grease.** Always use a clean cloth when cleaning. Never use brake fluids, gasoline, petroleum-based products or any solvents to clean tool.
- **Always support long workpieces.** To minimize risk of tipping the saw, always support long workpieces.
- **Before making a cut, be sure all adjustments are secure. Always use the vise clamp** to secure the workpiece.
- **Never touch wheel** or other moving parts during use.
- **Never start the chop saw when the wheel is in contact with the workpiece.**
- **Never** cut more than one workpiece at a time.
- **Do not stack** more than one workpiece on the machine base at a time.
- **Never perform any operation free-hand.** Always secure the workpiece to be cut in the vise.
- **Never** hand hold a workpiece. Workpiece will become very hot while being cut.
- **Never** reach behind, under or within 3 in. of the wheel and its cutting path with your hands and fingers for any reason.
- **Never** reach to pick up a workpiece, a piece of scrap or anything else that is in or near the cutting path of the wheel.
- **Make sure the wheel is securely mounted** as described in the operating instructions before connecting the tool to a power supply. Do not tighten wheel excessively, since this can cause cracks.
- **Check the wheel for fissures and cracks,** and test for normal operation prior to use.
- **Always ease the abrasive wheel against the workpiece** when starting to cut. A harsh impact can break the wheel.
- **Only use a chop saw wheel rated for 3900 rpm or greater** and manufactured in compliance with ANSI B 7.1. Always store wheels in a dry place with little temperature variation.
- **Before cutting,** press the trigger switch and allow the wheel to reach full speed.
- **This chop saw has been designed for cutting metals using reinforced abrasive chop saw wheels only. Do not remove the wheel, install a steel blade and attempt to cut other types of materials such as wood, masonry, etc. Attempting to cut these other types of materials could cause an accident resulting in serious personal injury.**
- **Do not attempt to modify this tool or create accessories not recommended for use with this tool. Any such alteration or modification is misuse and could result in a hazardous condition leading to serious personal injury.**

PROPOSITION 65 WARNING



WARNING

Some dust created by power sanding, sawing, grinding, drilling, and other construction activities contains chemicals known to the State of California to cause cancer, birth defects or other reproductive harm. Some examples of these chemicals are:

- Lead from lead-based paints,
- Crystalline silica from bricks and cement and other masonry products, and
- Arsenic and chromium from chemically treated lumber.

Your risk from these exposures varies depending on how often you do this type of work. To reduce your exposure to these chemicals: work in a well-ventilated area and work with approved safety equipment, such as dust masks that are specially designed to filter out microscopic particles.

Handling the power cord on this product may expose you to chemicals known to the state of California to cause cancer and birth defects or other reproductive harm. Wash hands after handling.

For more information go to: www.P65Warnings.ca.gov



READ INSTRUCTION MANUAL: To reduce the risk of injury, user and all bystanders must read instruction manual before using this product.

ELECTRICAL SAFETY INFORMATION

ELECTRICAL SPECIFICATIONS AND SAFETY

POWER SUPPLY AND MOTOR

CAUTION

The A/C motor used in this saw is a universal, nonreversible type. See "MOTOR" in the "PRODUCT SPECIFICATIONS" section on page 2.

To avoid electrical hazards, fire hazards or damage to the tool, use proper circuit protection. Your saw is wired at the factory for 120 V operation. Connect to a 120 V, 15 A circuit and use a 20 A time-delay fuse or circuit breaker. If power cord is worn or cut or damaged in any way, have it replaced immediately to avoid shock or fire.

DOUBLE INSULATED (Symbol:)

This power tool is double insulated to provide a double thickness of insulation between you and the tool's electrical system. All exposed metal parts are isolated from the internal metal motor components with protective insulation.

REPLACEMENT PARTS – When servicing, use only identical replacement parts. Refer to the Replacement Parts List on the page 25.

POLARIZED PLUGS – To reduce the risk of electrical shock, this saw has a polarized plug (one blade is wider than the other). This plug (illustrated at right) will fit in a polarized outlet only one way. If the plug does not fit fully in the outlet, reverse the plug. If it still does not fit, contact a qualified electrician to install the proper outlet. Do not change the plug in any way.

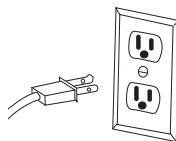

CAUTION

Double insulation does not take the place of normal safety precautions when operating this tool. To avoid electrocution:

- Use only identical replacement parts when servicing a tool with double insulation. Servicing should be performed by a qualified technician.
- Do not use power tools in wet or damp locations or expose them to rain or snow.

MOTOR SAFETY PROTECTION

CAUTION

To avoid motor damage, the motor should be blown out or vacuumed frequently to keep sawdust from interfering with motor ventilation.

- **CONNECT** this saw to a 120 V, 15 A circuit with a 20 A time-delay fuse or circuit breaker. Using the wrong size fuse can damage the motor.
- If the motor will not start, release the trigger switch immediately. **UNPLUG THE SAW.** Check the saw blade to make sure it turns freely. If the blade is free, try to start the saw again. If the motor still does not start, refer to **TROUBLESHOOTING**.
- If the tool suddenly stalls while cutting wood, release the trigger switch, unplug the tool and free the blade from the wood. The saw may now be started and the cut finished.

- **FUSES** may “blow” or circuit breakers may trip frequently if:
 - **MOTOR** is overloaded – overloading can occur if you feed too rapidly or make too many starts/stops in a short time.
 - **LINE VOLTAGE** is more than 10% above or below the nameplate voltage rating. For heavy loads, the voltage at motor terminals must equal the voltage specified on the nameplate.
 - **IMPROPER** or dull saw blades are used.

GUIDELINES FOR EXTENSION CORDS

When using an extension cord, be sure to use one heavy enough to carry the current your product will draw. An undersized cord will cause a drop in line voltage, resulting in loss of power and overheating. The table below shows the correct size to use depending on cord length and nameplate ampere rating. If in doubt, use the next heavier gauge. The smaller the gauge number, the heavier the cord.

MINIMUM GAUGE FOR EXTENSION CORDS (AWG)					
(When using 120 volts only)					
Ampere Rating		Total length of Cord			
More Than	Not More Than	25 ft.	50 ft.	100 ft.	150 ft.
0	6	18	16	16	14
6	10	18	16	14	12
10	12	16	16	14	12
12	16	14	12	Not Recommended	

Be sure your extension cord is properly wired and in good condition. Always replace a damaged extension cord or have it repaired by a qualified person before using it. Protect your extension cords from sharp objects, excessive heat and damp or wet areas.

Use a separate electrical circuit for your tools. This circuit must not be less than #12 wire and should be protected with a 20 A time-delay fuse or circuit breaker. Before connecting the tool to the extension cord, make sure the saw switch is in the OFF position. The electric circuit should be rated at the same voltage as is stamped on the motor nameplate. Running at a lower voltage will damage the motor.

CAUTION

In all cases make certain the receptacle in question is properly grounded. If you are not sure, have a certified electrician check the receptacle.

PREPARATION

Before beginning assembly or operation of the product, make sure all parts are present. Compare parts with package contents list and diagram on page 3. If any part is missing or damaged, do not attempt to assemble, install or operate the product.

Estimated Assembly Time: 5 minutes.

Tools needed to remove or install blade (included): 8 mm Hex Wrench.

Tools Required for Adjustment (not included): 10 mm Hex Wrench, 5 mm Hex Wrench, Square, Phillips Screwdriver, Slotted Screwdriver.

ASSEMBLY INSTRUCTIONS

⚠ WARNING: To avoid injury, do not connect this chop saw to a power source until it is completely assembled and you have read and understood the instruction manual.

RAISING AND LOCKING THE CUTTING HEAD (FIG. 1)

NOTE: The cutting head must be locked in the down position for transporting and storing the chop saw.

- To raise, press the cutting head down slightly and pull out the head lock down pin (P).
- To lock, press the cutting head down slightly and push in the head lock down pin (P).

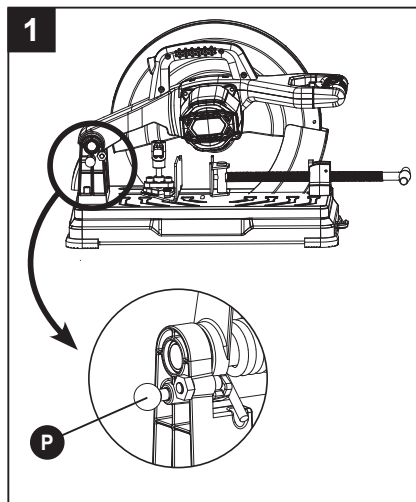

STORING THE CUTTING WHEEL WRENCH (FIG. 2)

When you are not using the cutting wheel wrench (B), the cutting wheel wrench storage (M) is located in the front of the saw base (L).

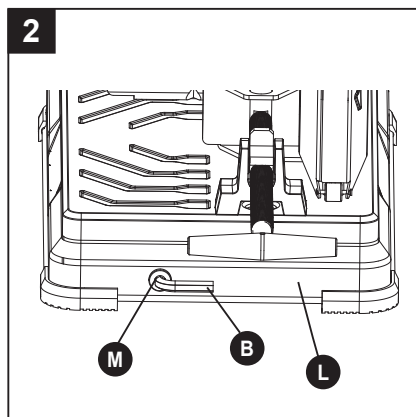

REMOVING THE ABRASIVE CUTTING WHEEL (FIG. 3, 4, 5)

NOTE: Use only recommended reinforced abrasive wheels (rated 3900 RPM or greater).

- Unplug the tool.
- Raise the cutting head to the upward position.
- Raise the lower wheel guard (D) to the uppermost position to expose the arbor bolt (1). (Fig. 3, 4)
- Place the cutting wheel wrench (B) over the arbor bolt (1). (Fig. 4)
- Push in the arbor lock button (P-Fig.5) and then loosen the arbor bolt (1) counterclockwise with the cutting wheel wrench (B) provided.
- Remove the arbor bolt (1), the washer (2), the outer wheel collar (3) and the abrasive cutting wheel (E). (Fig. 5)

NOTE: Do not remove the inner washer (4) and the inner wheel collar (5).

INSTALLING THE ABRASIVE CUTTING WHEEL (FIG. 3, 4, 5)

NOTE: Inspect wheel before mounting that it is in good shape, no chipping or cracking.

- Unplug the tool.
- Install the new abrasive cutting wheel (E) followed by the outer wheel collar (3), the washer (2) and the arbor bolt (1). (Fig. 5)
- NOTE:** Make sure the directional arrow on the replacement wheel matches the direction of the saw.
- Push in the arbor lock button (Q).
- Turn the arbor bolt (1) clockwise until snug and tighten with the cutting wheel wrench (B) provided. (Fig. 4)
- Be sure the arbor lock button (Q) is released so the abrasive cutting wheel (E) turns freely by spinning the cutting wheel while the arbor lock button (Q) disengages.
- Release the lower wheel guard (D) back to its original position. (Fig. 3)

NOTE: If the cutting depth stop bolt has been adjusted during operation of the old abrasive wheel, reset for the depth for a new 14 in. abrasive wheel. (See instructions on page 17)

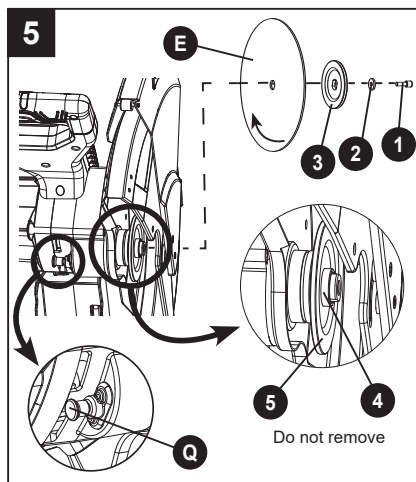
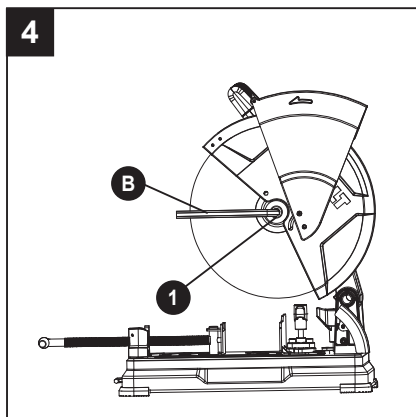
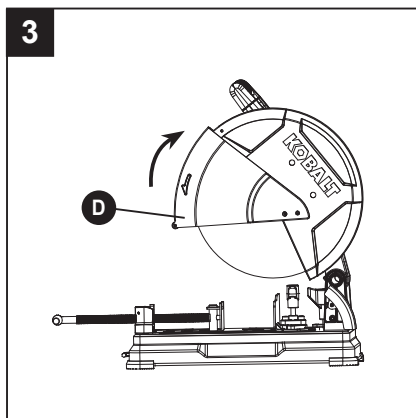

ADJUSTMENT INSTRUCTIONS

⚠ WARNING: To avoid injury, do not connect this chop saw to a power source when making any adjustments.

ADJUSTING THE CUTTING DEPTH STOP BOLT (FIG. 6)

NOTE: The cutting depth was adjusted properly at the factory. If adjustments are needed, be careful not to adjust the depth stop bolt too deep, as the cutting wheel may contact the base.

- Loosen the lock nut (1) with a 10 mm hex wrench.
- Turn the depth stop adjustment bolt (O) with a 5 mm hex wrench counterclockwise to decrease the cutting depth or clockwise to increase the cutting depth.
- Lower the cutting head to check that the wheel does not contact the base.
- Repeat until adjusted properly and tighten the lock nut (1).

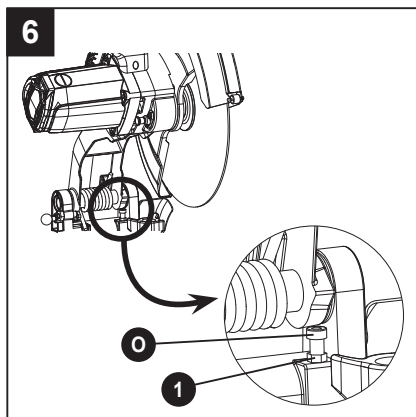

NOTE:

- To maintain this adjustment, the lock nut (1) on the depth stop adjustment bolt (O) must be tightened securely.
- The depth stop is factory set providing maximum cutting capacity for the 14 in. abrasive cutting wheel provided with your chop saw. When the diameter of the wheel has reduced in size due to normal wear, the depth stop adjustment bolt may require adjustment to provide maximum cutting capacity.
- When a replacement wheel is installed onto the unit, it is necessary to check the clearance of the cutting wheel to the machine base before operating.

ADJUSTING THE VISE (FIG. 7)

NOTE: The vise of your saw is used to secure the workpiece during cutting operations.

- Rotate the vise handle (K) counterclockwise to allow enough room for the workpiece to fit between the vise clamp (H) and the fence (N).
- Position the workpiece between the vise clamp (H) and the fence (N). Rotate the vise handle (K) clockwise to clamp the workpiece securely.
- The vise incorporates a quick-release locking lever (I). To use the quick-release feature, lift up on the quick-release locking lever (I) and hold the vise handle to move backward or forward to the desired position.
- When the vise clamp (H) is in desired location, flip the quick-release locking lever (I) down to engage the threads with the threads of the vise. Rotate the vise handle (K) clockwise to clamp the workpiece securely.

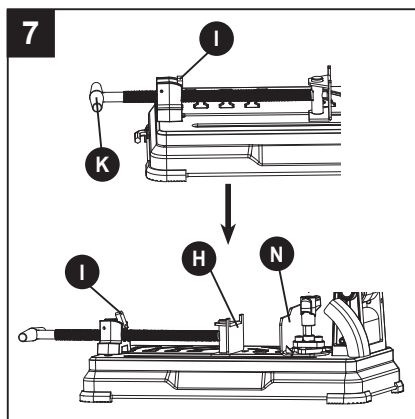

ADJUSTING THE FENCE (FIG. 8)

The fence can be moved backward or forward and adjusted to any angle between 0°~45°. No tools are required.

- Loosen the fence lock knob (G) by turning it 180 degrees counterclockwise.
- Move the fence (N) to the desired position.
- Tighten the fence lock knob (G) by turning it 180 degrees clockwise.

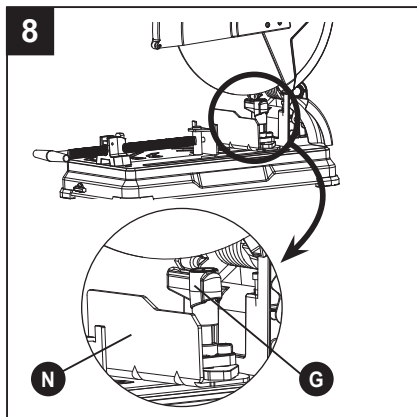

ADJUSTING FENCE SQUARENESS (FIG. 9)

- Loosen the vise handle (K) and pull back the vise clamp (H) from the fence (N).
- Loosen the fence lock knob (G) by turning it 180 degrees counterclockwise.
- Lower the cutting head down until the abrasive cutting wheel (E) is below the base.
- Place a square (1) against the abrasive cutting wheel (E) and adjust the fence against the square.
- Adjust the fence 90° to the abrasive cutting wheel (E) and tighten the fence lock knob (G) by turning it 180 degrees clockwise.

NOTE: If the saw has not been used recently, recheck abrasive cutting wheel squareness to the fence and readjust if needed.

- Raise the cutting head up to its position when alignment is achieved.

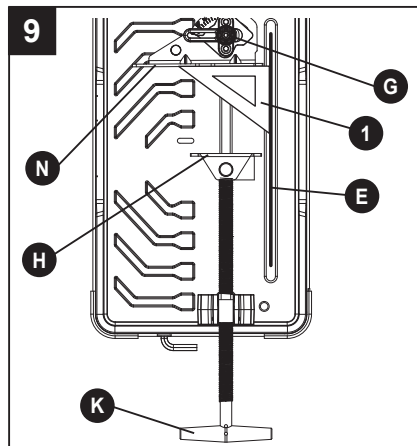

ADJUSTING THE CUTTING ANGLE (FIG. 9, 10)

- Loosen the vise handle (K-Fig. 9) and pull back the vise clamp (H) from the fence (N).
- Loosen the fence lock knob (G) by turning it 180 degrees counterclockwise.
- Move the fence (N) to the desired angle between 0 and 45 degrees.
- Tighten the fence lock knob (G) by turning it 180 degrees clockwise.
- For the 45 degrees, unlock the fence lock knob (G) turn the fence to 45 degrees, then move the fence (N) forward until the pin (1) clicks into the slot (U) located on the base.
- Tighten the fence lock knob (G) by turning it 180 degrees clockwise.

NOTE: To re-locate the fence (N) pull the pin (1) up and move the fence to the desired position and angle.

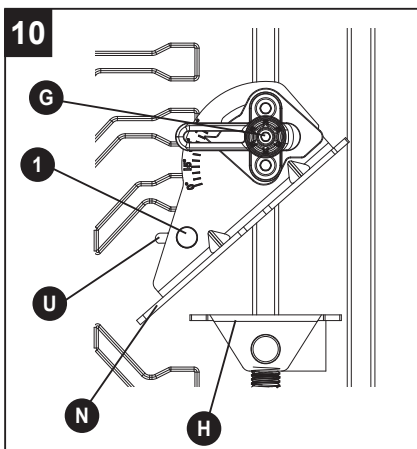

ADJUSTING THE SPARK DEFLECTOR (FIG. 11)

The spark deflector allows for the sparks caused during operation to be directed away from the workpiece and surrounding people.

- To adjust the spark deflector for the maximum effect, loosen the screw (1) by using a phillips screwdriver, adjust the spark deflector to the required angle and then retighten the screw.

CAUTION: Risk of property damage, DO NOT allow power cord to come into contact with spark deflector or sparks as damage to power cord may occur.

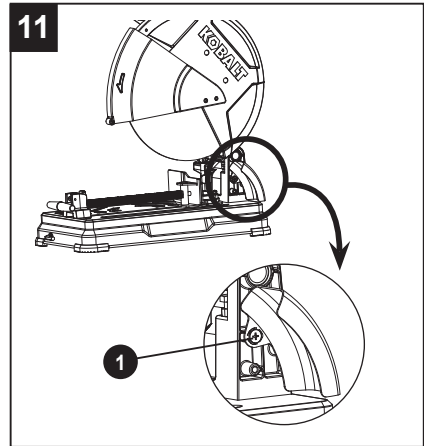

CARRYING THE CHOP SAW (FIG. 12)

The chop saw can be transported to any workplace conveniently by:

- Lowering the cutting head to its lowest position and push in the head lock down pin (P).
- Transport the chop saw using the carrying handle (S) located above the motor.

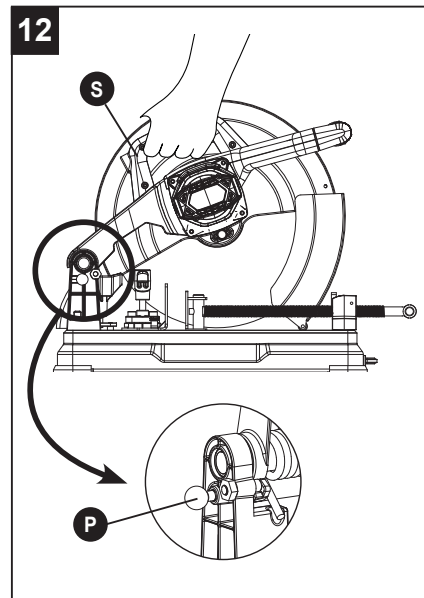

OPERATING INSTRUCTIONS

⚠ WARNING: Never connect the plug to the power source outlet until all adjustments are completed and you have read and understood the safety and operational instructions.

TURNING THE SAW ON (FIG. 13)

Squeeze the trigger switch (T) to turn the chop saw ON.

NOTE: Insert a padlock (not included) through the hole (1) in the trigger switch, locking the tool's switch and preventing children and other unauthorized users from turning the machine on.

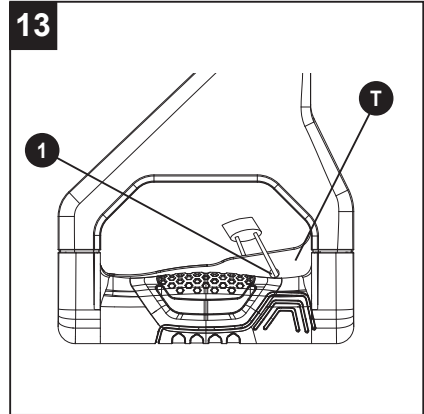

CUTTING THE WORKPIECE (FIG. 14)

⚠ WARNING

Failure to heed the safety rules could result in serious personal injury:

- To avoid serious personal injury, always make sure the fence is secured in position.
- Never perform any cutting operation freehand (without placing workpiece in the vise).
- Material will get hot during cutting operations. Keep hands off of metal being cut to avoid serious personal injury.
- Do not touch the cut material until it cools or you can be burned.
- Never stand or have any part of your body in line with the path of the wheel.
- Inspect the abrasive cutting wheel before every operation. Check for cracks, chipping and correct speed ratings on the cutting wheel.

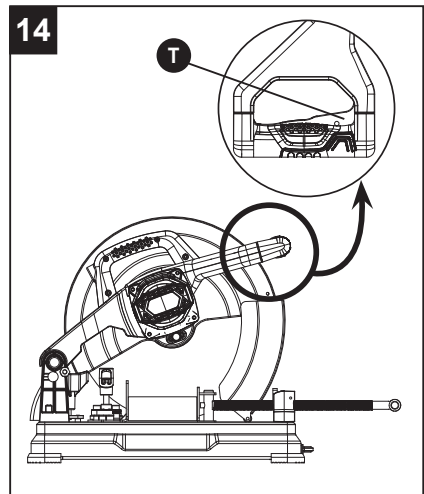

- Place the workpiece flat on the base.
- Firmly secure the workpiece to be cut using the vise.
- When cutting long workpiece, support the opposite end of the workpiece with a roller stand or with a work surface level with the saw.
- Before turning the saw on, perform a dry run of the cutting operation to verify no problems will occur when the cut is made.
- Turn on the saw by depressing the trigger switch (T). Allow a few seconds for the wheel to build up to full speed before letting it come into contact with the workpiece.
- Once the motor has reached full speed, slowly lower the cutting head until the cutting wheel contacts the workpiece. Continue to use steady, even pressure to obtain a uniform cut through the workpiece. Do not force the cutting wheel into the workpiece.

- When the cut is complete, release the trigger switch (T) and allow the wheel to stop rotating before raising the cutting head out of the workpiece.



WARNING

Do not attempt to cut wood or masonry with this chop saw. Never cut magnesium or magnesium alloy with this chop saw. Failure to comply could result in serious personal injury.

CARE AND MAINTENANCE

⚠ WARNING: Never put lubricants on the abrasive cutting wheel while it is spinning. To avoid fire or toxic reaction, never use gasoline, naphtha acetone, lacquer thinner or similar highly volatile solvents to clean the chop saw. To avoid injury from unexpected starting or electrical shock, unplug the power cord before working on the tool. To avoid electrical shock, fire or injury, use only parts identical to those identified in the parts list. Reassemble exactly as the original assembly to avoid electrical shock.

REPLACING CARBON BRUSHES (FIG. 15)

NOTE: Before replacing carbon brushes, make sure the chop saw has been disconnected from the power source.

Replace both carbon brushes when either has less than 1/4 in. length of carbon remaining, or if the spring or wire is damaged or burned.

- To insert or replace brushes, first unplug the tool. Remove the black plastic cap (1) on the side of the motor (R) using a slotted screwdriver.

NOTE: The brush assembly (U) has a spring, so the cap (1) may pop out when loosened.

- Pull out the brush assembly (U) and replace with the new one, if needed. The ears on the metal end of the assembly go in the same slots the carbon part fits into. Tighten the cap snugly, but do not overtighten. Repeat for the other side.

NOTE: To reinstall the same brushes, first make sure the brushes go back in the way they came out. This will avoid a break-in period that reduces motor performance and increases wear.

LUBRICATION

Motor and cutterhead bearings are sealed and need NO lubrication.

CLEANING

Keep your chop saw clean. Continually remove metal chips, dust, dirt and debris.

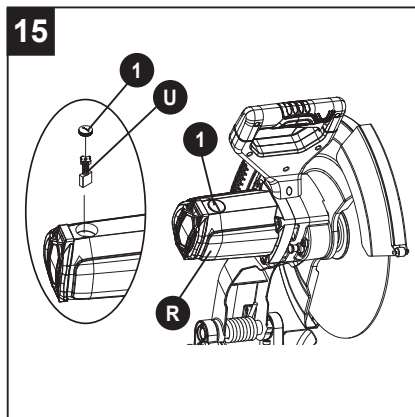

FREE WARNING LABEL REPLACEMENT:

If your warning labels become illegible or are missing, call for a free replacement.

WARNING

DO NOT replace the power cord. If you have any problem or questions concerning the power cord, call the Customer Service Department at 888-356-2258.

**#5472271**

14-IN. CHOP SAW
35.56 CM SIERRA DE CORTE
BLADE/HOJA
15A, 3,900min⁻¹ (RPM) [NO LOAD] 120V a.c. 60Hz
15 AMPERIOS, 3900 RPM (SIN CARGA) 120 V AC.- 60 HZ

**DOUBLE INSULATED- WHEN SERVICING,
USE ONLY IDENTICAL REPLACEMENT PARTS
AISLAMIENTO DOBLE: AL REPARAR, UTILICE
SÓLO PIEZAS DE REPUESTO IDENTICAS**

SERIAL NO.: MFG. DATE:
SERIE NO.: FECHA DE FABRICACIÓN:

888-356-2258 (888-3KOBALT)
DISTRIBUTED BY/DISTRIBUIDO POR:
LOWE'S HOME CENTERS LLC
1000 LOWE'S BLVD.
MOORESVILLE, NC 28177



C US
216045

JIFA GROUP CO., LTD.
JIANGNAN DEVELOPMENT AREA,
DONGYANG ZHEJIANG CHINA.
MADE IN CHINA/HECHO EN CHINA

**WARNING**

FOR YOUR OWN SAFETY READ INSTRUCTION MANUAL BEFORE OPERATING TOOL

1. Wear eye protection.
2. Wear face mask or dust mask and respirator during all operations.
3. Do not operate saw without guards in place.
4. Do not perform any operation freehand.
5. Never reach around wheel.
6. Turn off tool and wait for saw wheel to stop before moving workpiece or changing settings.
7. Disconnect power before changing wheel or servicing.
8. Use abrasive wheel suitable for speed of chop saw.
9. Do not use damaged abrasive wheels.
10. Do not expose to rain or use in damp locations.
11. Failure to comply with these warnings, and all warning listed in manual may result in serious personal injury.

**ADVERTENCIA**

POR SU PROPIA SEGURIDAD, LEA EL MANUAL DE INSTRUCCIONES ANTES DE OPERAR LA HERRAMIENTA

1. Use lentes de protección.
2. Use máscara facial o mascarilla antipolvo y filtro respiratorio durante todas las operaciones.
3. No utilice la sierra sin la cubierta protectora en su sitio.
4. No realice ninguna operación sin utilizar las manos.
5. No meta nunca la mano alrededor del disco.
6. Apague la herramienta y espere que el disco de sierra se detenga antes de mover las piezas de trabajo o de cambiar el ajuste.
7. Desconecte la fuente de alimentación antes de cambiar el disco o realizar mantenimiento.
8. Utilice un disco abrasivo adecuado para la velocidad de la sierra de corte.
9. No use discos abrasivos dañados.
10. No exponga esta herramienta a la lluvia ni la utilice en áreas húmedas.
11. El incumplimiento de estas advertencias y de todas las advertencias enumeradas en el manual puede provocar lesiones personales graves.

TROUBLESHOOTING

WARNING

To avoid injury from accidental starting, always ensure switch is in the OFF position and unplug the tool before moving, replacing the blade or making adjustments.

PROBLEM	POSSIBLE CAUSE	CORRECTIVE ACTION
Chop saw wheel hits base or work surface.	1. The cutting depth adjustment bolt is set too deep.	1. See "Adjusting the Cutting Depth Stop Bolt" section.
Cutting wheel does not cut through workpiece.	1. Depth stop bolt setting is incorrect.	1. See "Adjusting the Cutting Depth Stop Bolt" section.
Cut is not square.	1. Defective wheel. 2. Work not positioned properly. 3. Excessive wheel pressure.	1. Replace immediately. 2. See "Adjusting the Angle Cutting" section. 3. Lessen wheel pressure during cutting operation.
Chop saw wheel binds, jams, burns workpiece. Rough cuts.	1. Improper operation. 2. Dull chop saw wheel. 3. Improper chop saw wheel.	1. See "Operation" section. 2. Replace wheel. 3. Replace with 14 in. abrasive cutting wheel.
Tool vibrates or shakes.	1. Wheel not round. 2. Wheel damaged. 3. Wheel loose. 4. Machine is not secure. 5. Other.	1. Replace wheel. 2. Replace wheel. 3. Tighten arbor bolt. 4. Mount tool to worksurface. 5. Contact customer service.
Power head won't fully rise.	1. Pivot spring not replaced properly after service. 2. Part failure.	1. Contact customer service. 2. Contact customer service.

REPLACEMENT PARTS LIST

For replacement parts, call our customer service department at 888-3KOBALT (888-356-2258), 8 a.m. - 8 p.m., EST, Monday - Sunday. You could also contact us at ascs@lowes.com.

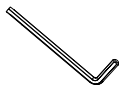

B

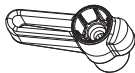

G

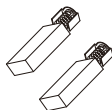

U



V

PART	DESCRIPTION	PART#
B	Cutting wheel wrench	X8GK
G	Fence lock knob	X8GJ
U	Carbon brushes (set of 2)	X8GH
V	Manual	X8GG

DISTRIBUTED BY:
Lowe's Home Centers LLC
1000 Lowe's Blvd., Mooresville, NC 28117

PAGE INTENTIONALLY LEFT BLANK

PAGE INTENTIONALLY LEFT BLANK

WARRANTY

The manufacturer will offer replacement parts for this product which under normal usage have proven to be defective in their manufacture or workmanship for a period of THREE (3) years from the date of initial retail purchase. This warranty is valid only to the original purchaser. This warranty is not transferable and does not cover any parts that have been subjected to misuse, abuse, alteration, overload, accident or normal wear of moving parts. Tools that have been sold "as is," sold reconditioned or used as rental equipment are not covered.

Warranty replacement parts can be obtained by contacting the manufacturer at 888-3KOBALT. Only the manufacturer is authorized to perform warranty service on this product. This warranty does not apply to accessories or damage caused where repairs have been made or attempted by others.

The manufacturer is not responsible for direct, indirect, incidental or consequential damages. Some states do not allow limitations on how long an implied warranty lasts and/or do not allow the exclusion or limitation of incidental damages, so the above limitations may not apply to you. This warranty gives you specific legal rights, and you may also have other rights, which vary from state to state.

The manufacturer makes no warranties, representations or promises as to the quality of its power tools other than those specially stated in this warranty.

WARRANTY VOID IF PRODUCT USED FOR COMMERCIAL PURPOSES.

For replacement parts, call our customer service department at 888-3KOBALT (888-356-2258).