



# Caxton® Oval

Undermount bathroom sink  
**K-R2210**

## Features

- Oval basin.
- No faucet holes; requires wall- or counter-mount faucet.

## Material

- Vitreous china.

## Installation

- Undermount.

## Recommended Products/Accessories

K-8998 P-Trap  
K-23726 Drain treatment  
K-23725 Cast iron cleaner

## Included Components

Additional Components:  
1193643



ADA

CSA B651

## Codes/Standards

ASME A112.19.2/CSA B45.1  
ADA  
ICC/ANSI A117.1  
CSA B651

## KOHLER® One-Year Limited Warranty

See website for detailed warranty information.

## Available Colors/Finishes

*Color tiles intended for reference only.*

Color	Code	Description
-------	------	-------------



0

White



96

Biscuit

# KOHLER®

## Caxton® Oval

Undermount bathroom sink

### K-R2210

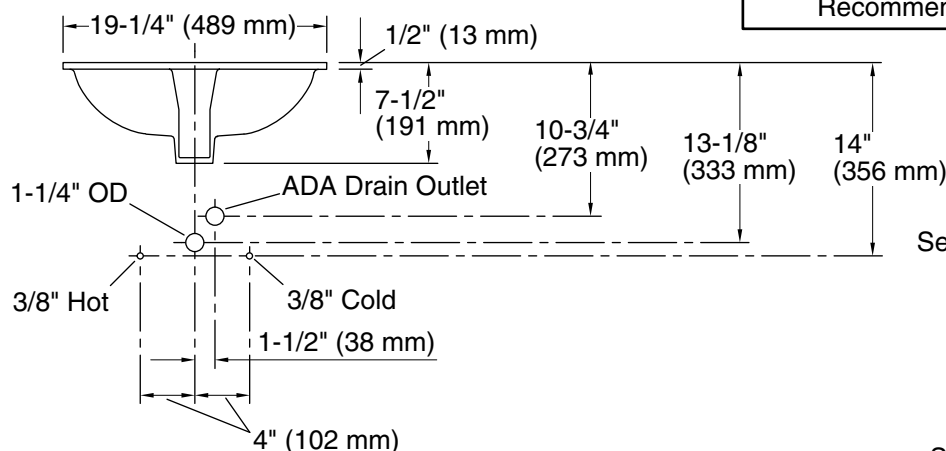
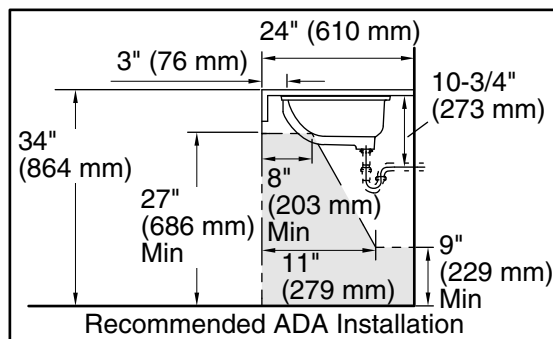
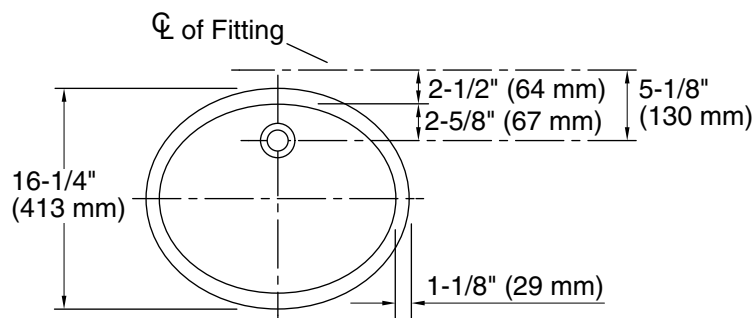

Standard Installation

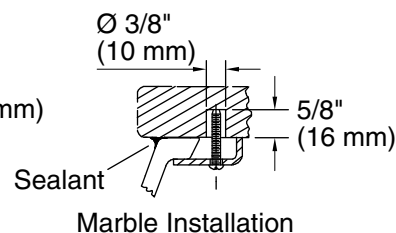

Marble Installation

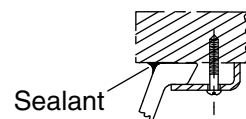

Wood Installation

### Technical Information

All product dimensions are nominal.

Bowl configuration: Single

Installation: Undermount

Bowl area (Only): Length: 17" (432 mm)  
Width: 14" (356 mm)  
Water depth: 4" (102 mm)

Drain hole: 1-3/4" (44 mm)

Template: 1151011-7, required, not included

### Notes

Install this product according to the installation instructions.

NOTICE: Countertop manufacturer or cutter must use the cut-out template provided with the product, or a current one provided by Kohler Co. (call 1-800-4KOHLER). Kohler Co. is not responsible for cutout errors when the incorrect cut-out template is used.

ADA, CSA B651 compliant when installed to the specific requirements of these regulations.