

# MODEL HB

HSHT-7

## Submittal Data

Baseboard Radiation

**ENCLOSURE:**

STYLE : "Model HB"

COLOR: White

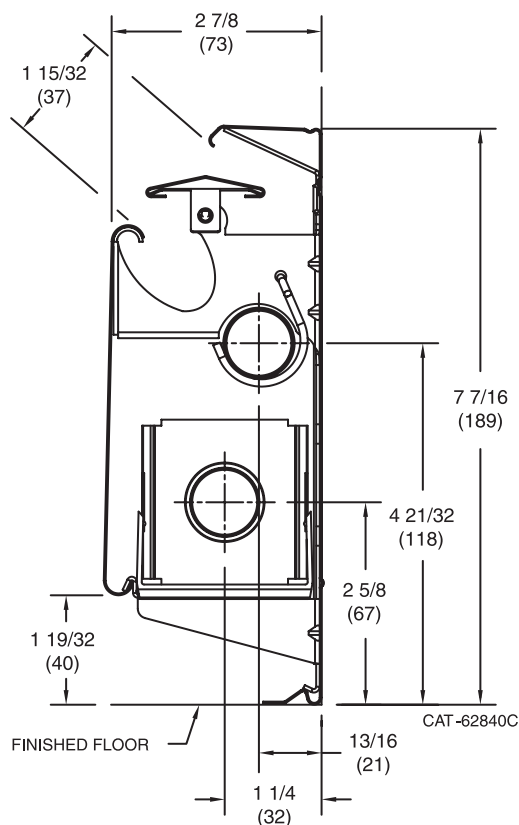
FRONT: 24-Ga. Roll Formed  
Prepainted Steel**ELEMENT:**TYPE: Cu/Al Mechanically  
Expanded  
Flared One End**FINS:** 2-1/8" x 2-1/8"**FINS/FT:** 52**BRACKETS:**Die Formed 18-Ga.  
Prepainted Steel**SLIDE SHOES:**High Temperature  
Nylon Snap On**ACCESSORIES:**All Overlapping with  
Snap On Fit and  
Powder Coat Finish**BACKPLATE:**24-Ga. Roll Formed  
Prepainted Steel**DAMPER VANE:**Roll Formed  
Prepainted Steel

NOTE: Dimensions in "[ ]" are shown in millimeters.

## RATINGS

MODEL	GPM	AVERAGE HOT WATER TEMPEAURE - BTU/HR./LIN. FT.						
		120°F	130°F	140°F	150°F	160°F	170°F	180°F
HB-750 3/4"	4	215	270	330	390	450	530	590
	1	205	255	310	370	430	500	560
HB-500 1/2"	4	226	283	340	410	480	550	610
	1	215	270	330	390	450	520	580

**HydroTherm®**260 North Elm St., Westfield, MA 01085  
(413) 564-5545 Fax: (413) 572-3764  
www.hydrotherm.com

A MESTEK COMPANY

PROJECT: \_\_\_\_\_ DATE: \_\_\_\_\_

LOCATION: \_\_\_\_\_

ARCHITECT: \_\_\_\_\_

ENGINEER: \_\_\_\_\_

CONTRACTOR: \_\_\_\_\_

PO NUMBER: \_\_\_\_\_

# MODEL HB

## Submittal Data

Baseboard Radiation

## CORRECTION FACTORS

If the calculated water flow rate through a baseboard is greater than the standard flow rate (1 GPM), the rating of that unit may be increased by multiplying the standard water rating at 1 GPM by the factor shown for the actual flow rate. All ratings based on 65°F entering air temperature.

### WATER FLOW CORRECTION FACTORS

G.P.M.	Heat Output Factor	Pressure Drop – Millinches Per Ft.	
		Copper Element Tube Size	
		3/4"	1/2"
1.0	1.000	47	260
1.5	1.016	96	520
2.0	1.028	157	850
2.5	1.038	230	1270
3.0	1.045	320	1730
3.5	1.051	420	2290
4.0	1.057	525	2880
4.5	1.062	650	3600
5.0	1.067	775	4300
6.0	1.074	1060	5900

## SPECIFICATION

Furnish and install where shown on all plans/drawings, Hydrotherm Model HB Finned Tube Enclosure and Element as described or approved equal of both quality and BTU capacity.

The baseboard panel radiator enclosure, as called out Model HB, will be manufactured from 24-gauge pre-painted galvanized. All lateral bends are to be roll formed to ensure continuity of all adjoining enclosures and accessories. The enclosure lengths are to be provided in 12 inch increments from 2 feet through 8 feet long and in 10 foot lengths. The front panel is to be fully engaged onto mounting brackets engaged with the back panel. Splice plate and damper joiner are to be used where two pieces of enclosure are adjoining each other in a run. These are to be included with all 5, 6 and 8 feet assembly packages.

All accessories will be die formed cold rolled steel and finished with a powder coat finish. The accessories will overlap the installed enclosure and are to provide adjustment for make-up in the installed runs of enclosure. End accessories will extend to the floor. The accessories are to be enclosure height and have finger tabs that form around the assembled baseboard providing a secure fit.

The brackets are to be of a one piece, die formed construction. The material is to be 18-gauge pre-painted bonderized C.R.S. The bracket is to be self locating for vertical positioning at installation. The bottom horizontal leg is to snap into bottom bend of the enclosure and is to support the element where slide shoes are located.

All elements are to be of the mechanically expanded type to ensure that proper fin to tube bonding is maximized. Copper/Aluminum elements are to be provided with one end mechanically swaged (flared) for proper assembly.

In the interest of product improvement, we reserve the right to make changes without notice.