

**Questions, problems, missing parts?**

Before returning to your retailer, call our customer service at 1-800-887-6326

Monday – Friday 9:00 a.m. – 5:00 p.m. CST

**PACKAGE CONTENTS**

Includes (3) AA 1800 mAh(1.2V) Ni-Mh rechargeable batteries.

**LED**

The lifetime for LEDs is estimated to be 100,000 hours. It should never need to be replaced.

**REF. PARTS NAME**

- A Solar panel unit
- B Solar Light Body
- C Ground Stake

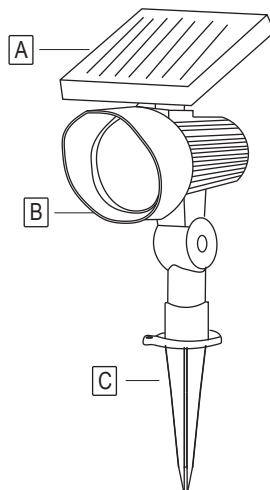

**⚠ Read all instructions before assembly. Failure to do so may result in faulty assembly and potential injury.**

**FUNCTION:** The built-in solar panels convert sunlight into electricity. The rechargeable battery stores the energy and converts the power into light for use during the night. The lighting hours of the solar light depends on the geographical location, weather condition and temperature condition. Stronger or longer exposure to sunlight enables the battery to store more energy and provide longer lighting hours.

**LOCATION:** It is important to select an outdoor location with full, direct sunlight where the solar panel can receive at least 8 hours of sunlight each day. Shady areas will not enable batteries to be fully charged. This will reduce the lighting hours at night. It is also important to avoid placing the solar light by light sources, such as street lights or porch lights, which may cause the solar light to turn off automatically. The solar light is designated for outdoor usage and ideal for night lighting of garden, paths, etc.

**CLEANING AND MAINTENANCE:** Please use a damp cloth to clean the solar panel. Do not use any chemical or abrasive cleaner. It is important to ensure that no moisture enters into the solar light.

**RECHARGEABLE BATTERY:** This product contains (3) AA 1800 mAh(1.2V) Ni-Mh rechargeable batteries. When the battery expires, it must be recycled or disposed of properly. Please contact your local waste disposal authority for correct procedure. Do not put battery into fire.

## ASSEMBLY AND BATTERY REPLACEMENT INSTRUCTIONS

### ASSEMBLY (Figure 1)

- Carefully remove your solar light from the box.
- Do not press on the surface of the solar panel because this can cause damage to solar module.

**Note: Please remove the clear mylar before using.**

- Place the ground stake (Part C) into the solar light body (Part B).
- Gently insert the ground stake (Part C) into the ground. **Never push the fixture into the ground by the fixture head.**

**CAUTION: In compacted, clay, or hard soils, moisten the ground with water before inserting the stake into the ground to avoid breakage.**

### OPERATIONAL INSTRUCTIONS

- After assembling, take the light to direct sunshine that allows the rechargeable battery to reach its maximum capacity. Ensure the light is in full sunlight for 8 hours. The unit will then automatically light up at dusk.
- Turn the switch which is on the back of solar panel unit (Part A) in "ON" position before use the unit (Fig.2).
- You can adjust the solar light body of light to expose solar panel unit better to the sun (Fig.3).
- You can adjust the focus of light by moving the solar light body (Part B) up and down (Fig.3).
- Unscrew screw until you can move solar light body (Part B) easily to the desired position. Screws back screw to tighten the solar light body (Part B).

### CHANGING BATTERIES (Figure 3)

- Remove the ground stake (Part C) from the solar light (Part B).
- Open the battery cover on the back of Solar Panel Unit (Part A) by using a screwdriver (not included).
- Replace the old battery with a new battery making sure the polarity is correct.
- Restore the battery cover and the screw by using the screwdriver (not included).

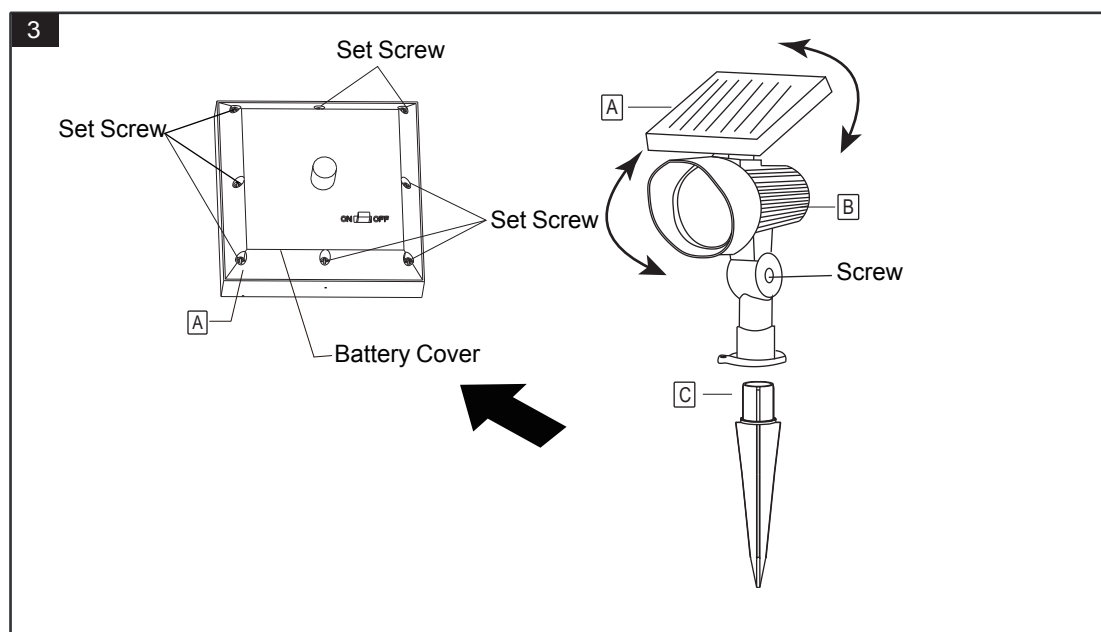
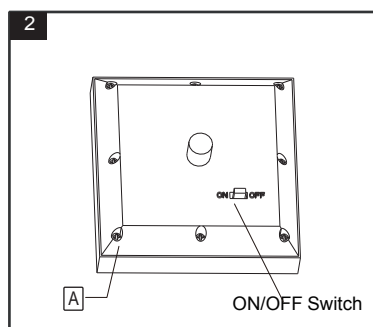
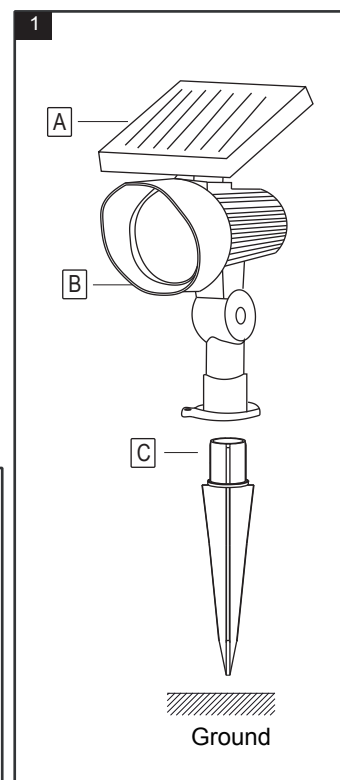

## TROUBLESHOOTING

### The light does not come on at night:

- ✓ Check the rechargeable battery and make sure that it is in contact to the metal plate and the polarity is correct. If the battery is worn out, replace the battery with (3) AA 1800 mAh(1.2V) Ni-Mh rechargeable batteries.
- ✓ Always keep the solar light distant from other night light sources, such as exterior lights. Reposition the light to avoid close contact with other night light sources.
- ✓ Make sure solar panel is clean and free of dirt and debris. If needed use a damp cloth to clean the solar panel. Do not use any chemical or abrasive cleaner. It is important to ensure that no moisture enters into the solar light.

**ONE-YEAR LIMITED WARRANTY:** If, during normal use, this PATRIOT LIGHTING® lighting fixture breaks or fails due to a defect in material workmanship within one (1) years from the date of original purchase, simply bring this lighting fixture with the original sales receipt back to your nearest MENARDS® retail store. At its discretion, PARTIOT LIGHTING® agrees to have the product or any defective part(s) repaired or replaced with the same or similar PATRIOT LIGHTING® product or part free of charge, within the stated warranty period, when returned by the original purchaser with original sales receipt. This warranty; (1) excludes expendable parts including but not limited to light bulbs and batteries; (2) does not cover damage that has resulted from abuse or misuse; and (3) does not cover any losses, labor, injuries to persons/property or costs. This warranty does give you specific legal rights and you may have other rights, which vary from state to state.



### Questions, problems, missing parts?

Before returning to your retailer, call our customer service at 1-800-887-6326  
Monday – Friday 9:00 a.m. – 5:00 p.m. CST