

**Have product questions or need technical support?**

**Contact Us:**



Website: [www.poulanpro.com](http://www.poulanpro.com)



Toll free: 1-888-676-7909 Mon-Fri 8-4 CST



Email: [support@poulanpro-power.us](mailto:support@poulanpro-power.us)



**READ AND UNDERSTAND THE OPERATOR'S MANUAL AND ALL SAFETY WARNINGS BEFORE USE**

*Failure to operate the product correctly can result in damage to the product, personal property and cause serious injury or death.*

Manufactured under license from Husqvarna AB  
Poulan Pro® is a registered Trademark of Husqvarna AB  
Imported by Novus Performance Products  
W225N16708 Cedar Park Ct. Jackson, WI 53037



Vol. 2025-02

## UNPACKING

- ▶ Carefully remove the snow thrower and all loose components from the carton.
- ▶ Verify all parts listed below are included. If any parts are missing, please contact our customer support team at 1-888-676-7909 for assistance.

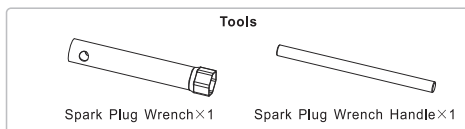
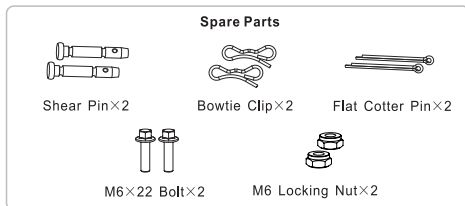
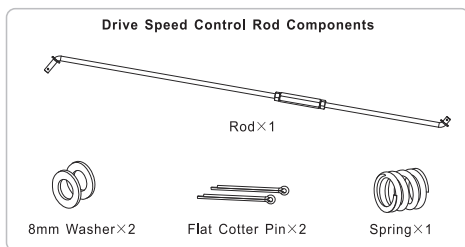
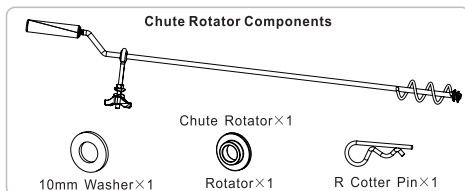
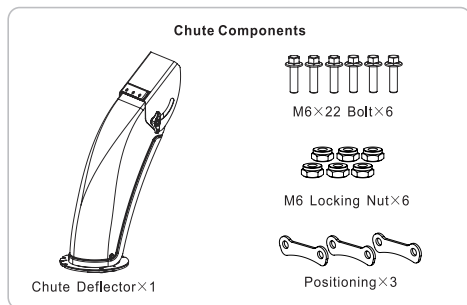
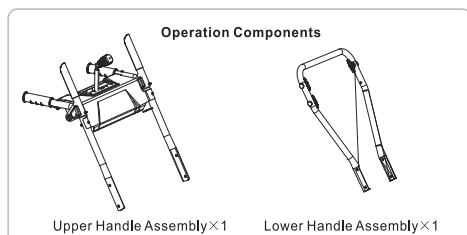
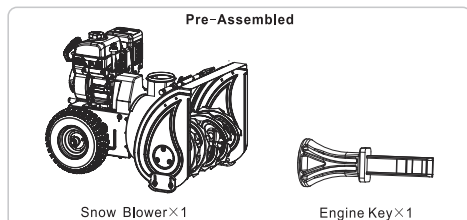

## ASSEMBLY

### Install Lower Handle

1. Remove the 4 pre-installed flange bolts (A), lock washer (B), flat washer (C) from the frame case.
2. Using the hardware removed above install the lower handle (D) onto the frame case and tighten the bolts.

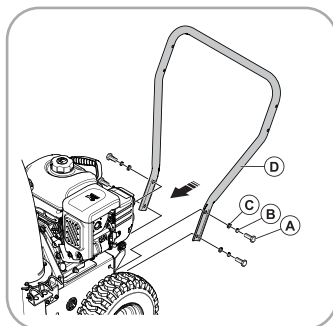

## Install Upper Handle

1. Insert the z-bend ends of the auger and drive cables (B) into the holes on the left and the right engagement levers (A) of the upper handle assembly.

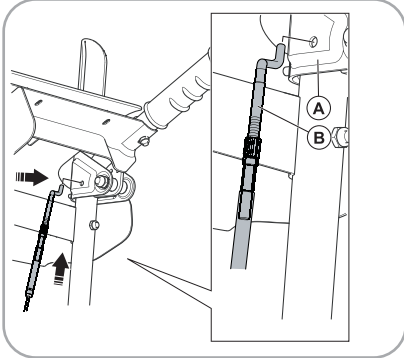

2. Remove the 3 pre-installed handle bolts (A), wave washers (B) and handle knobs (C) from the lower handle.
3. With assistance, install upper handle (D) onto the lower handle, securing in place using 3 x handle bolts (A) 3 x curved washers (B) and handle knobs (C).

**Important note:** Do not install a handle bolt into the upper hole of the left handle at this time.

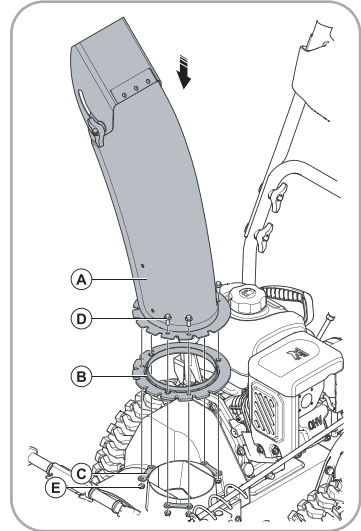
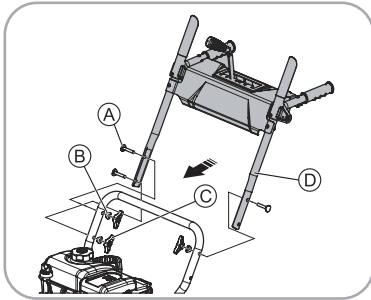

2. Insert the plastic bushing (B) into the inside of the front chute rotation bracket.
3. Slide the lower chute rotation rod through the bushing and bracket.
4. Secure with a 10mm flat washer (A) and cotter pin (C).

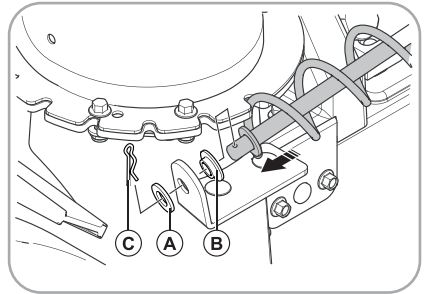

## Assemble the Chute Deflector and Chute Rotator

1. Attach rotator disk (B) and the chute deflector (A) onto the chute base using 6 x M6x22 flange bolts (D) 6 x M6 lock nut (E) to install the 3 x retainer clips (C). Do Not over tighten.

- To install the chute rotation handle (E) first remove the handle knob (A) and 2 x wave washers (B) from the chute rotation eyelet bolt.
- Place a wave washer (B) onto the threaded portion, insert the bolt into the upper left side handle bolt hole, install wave washer (B) and secure in place by tightening the handle knob (A). Note adjustment may be made by repositioning the M8 nut (D).

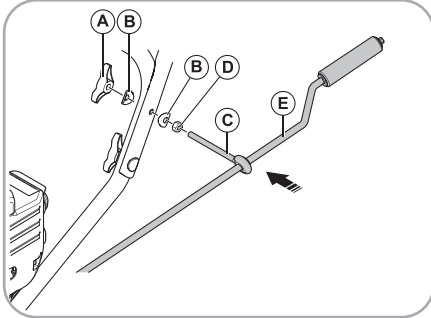

## Assemble the Drive Speed Control Rod

- Install the long-bent end of the drive speed control rod (A) to the shift lever and secure it with 1x connecting rod spring (B), 1 x M8 flat washer (C) and 1 x cotter pin (D).

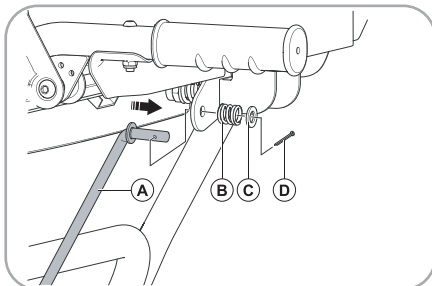

- Pull upwards on the shift connecting plate (B) and install the short-bent end of the drive speed control rod (A). Attach with 1 x M8 flat washer (C) and 1 x cotter pin (D).

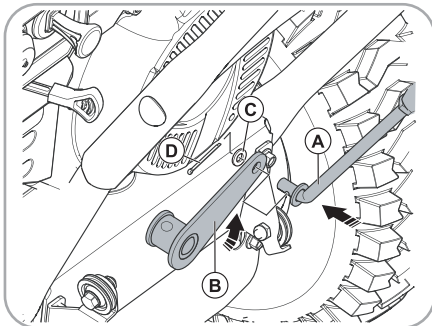

## Add Engine Oil

- Place the snow blower on a flat level surface
- Remove oil fill cap/dipstick to add engine oil.
- Using a funnel, add up to 20 fl. oz (600 ml) of oil and replace oil fill cap/dipstick.. **DO NOT OVERFILL**
- Check the engine oil level and add as needed. Securely screw in the oil filler cap/dipstick

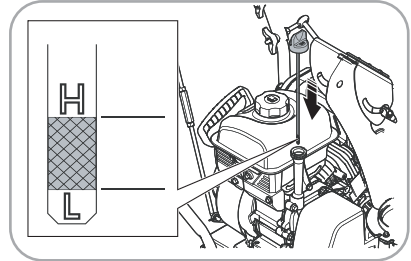

## Add Fuel

**⚠ DANGER:**

*Gasoline vapors are highly flammable and extremely explosive.*

- Remove the fuel tank cap.
- Add fresh, clean unleaded fuel with a minimum of 87 octane and a maximum of 10% ethanol to the fuel tank leaving 1/4" of space from the top of the tank. **DO NOT OVERFILL**. Immediately wipe up any spilled fuel.
- Reinstall the fuel tank cap turning clockwise until it stops.

## Starting and Operating Procedures

This section of the quick start guide provides basic instructions on how to start and operate your new Snow Blower. This quick start guide is not a comprehensive guide, we recommend the operator's manual is read and understood before using your new equipment.

## Starting The Engine (Recoil / Pull Start)

- Insert the ON/OFF key.

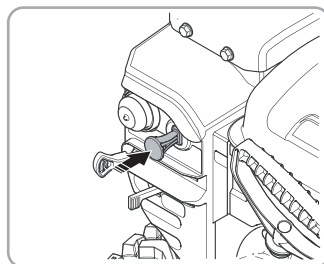

2. Slide the fuel switch lever fully to the right. "ON" position.

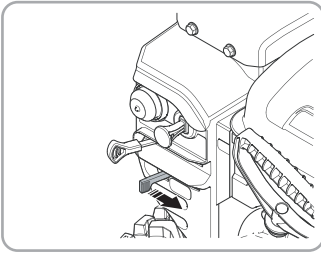

3. Slide the choke / throttle control lever to the left. "Choke" position.

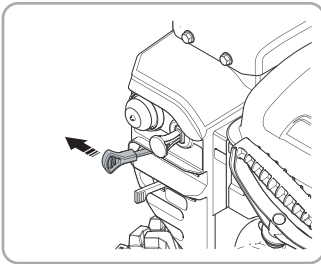

4. Firmly push in the primer 3 times with your thumb, holding the primer in for a second before releasing it each time.

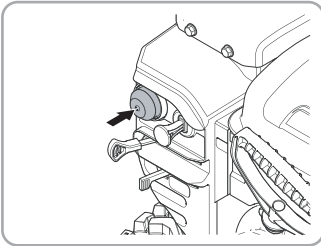

5. Pull the starter handle slowly until resistance felt, then pull rapidly.

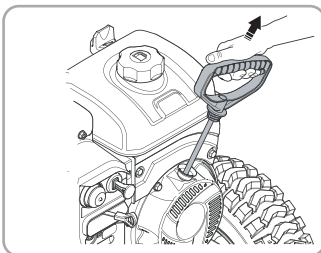

6. Once the engine starts, slowly slide the choke/ throttle control lever to the right into the "Run" position.  
7. Allow the engine to run for 30 - 40 seconds before starting to blow snow.

## Starting the Engine (Electric Start)

Follow Steps 1, 2, 3 and 4 listed under Recoil / Pull Start.

5. Plug a 3-wire extension cord into the electric start adapter on the snow thrower. Plug the other end of the power cord into a convenient 120V outlet.

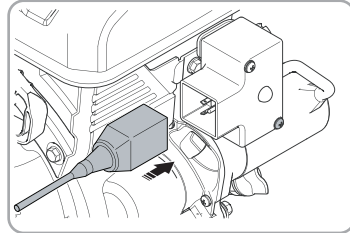

6. Press and hold the start button on the control box for 5 seconds.

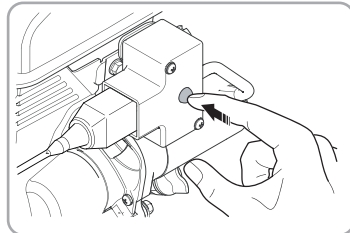

- Note:** If the engine does not start, wait 5 seconds, then push the start button again.  
7. Once the engine starts, rotate the choke lever to the OPEN position.  
8. Remove the extension cord from the unit and unplugging it from the outlet.  
9. Allow the engine to run for 30-40 seconds before starting to throw snow.

## Operating the Snow Blower

### Auger Engagement

1. Squeeze the left-side auger engagement lever to the handle to engage the auger and begin to blow snow.

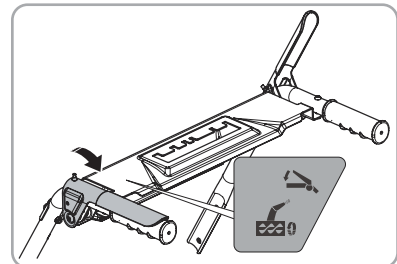

**Wheel Drive Engagement**

2. Move the shift lever to the desired forward or reverse gear. Squeeze the right-side drive engagement lever to the handle to engage the drive wheels.

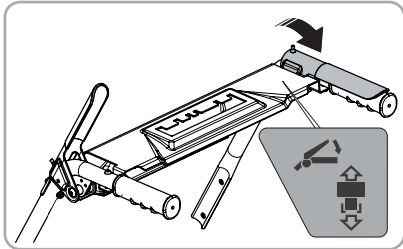
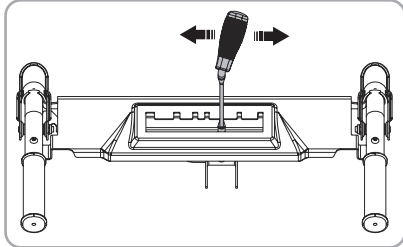

**Stopping the Snow Blower**

1. Release the right-side drive engagement lever to stop the drive wheels.
2. Release the left-side auger engagement lever to disengage the auger and stop throwing snow.
3. Slide the Choke / Throttle control lever fully to the right.
4. Pull outward on the engine key to stop the engine.
5. Slide the fuel switch lever fully to the left. "Closed" position.

