

Ceiling Fan

Instruction Manual

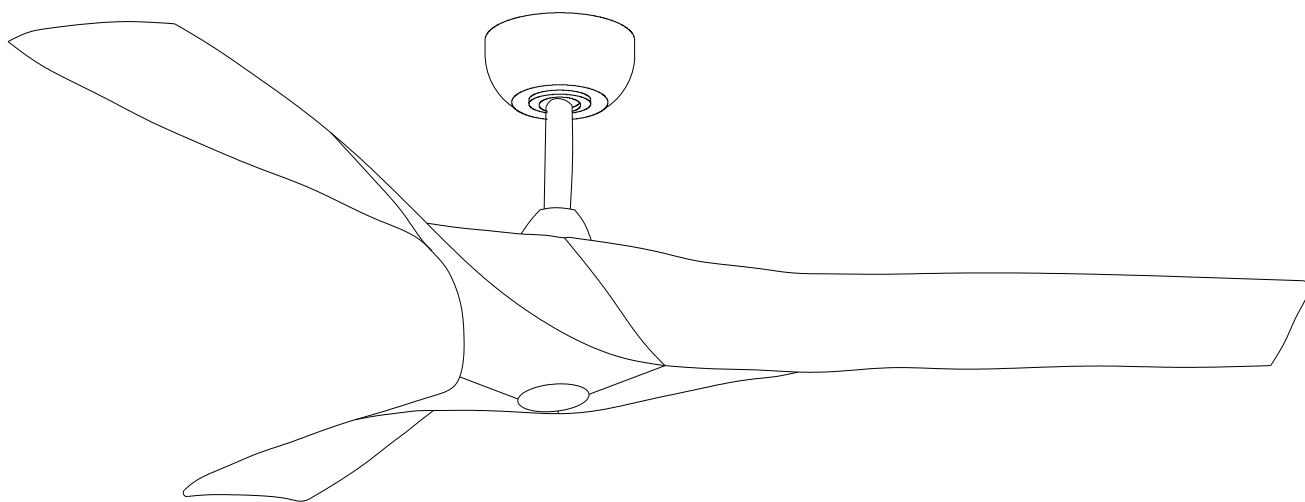

Read these instructions completely prior to installation and use. Keep for future reference. Consult a qualified electrician or customer service if unsure about any point.

TABLE OF CONTENTS

Package Contents.....	3
Safety Information.....	4
Preparation.....	5
Initial Installation.....	6
Downrod Mounting.....	7
Circuit Connection.....	8
Install the Host.....	9
Install Fan Blades.....	9
Remote Control Operation.....	10
Troubleshooting.....	11

Before beginning installation of this product, read the package list on page 2 and ensure all parts are present and display no defects. If any part is missing or damaged, do not attempt to install the product. Read all of the safety information on page 3 before installation or use.

Estimated assembly time: 120 minutes

Additional tools required for assembly:

Electrical tape, flathead & Phillips screwdriver, pliers, safety glasses, step ladder, and wire strippers

Additional helpful tools:

AC tester light, tape measure, wiring handbook, and wire cutters

- Electrical tape
- Flathead & Phillips screwdriver
- Pliers
- Safety glasses
- Step ladder
- Wire strippers
- Protective eyewear

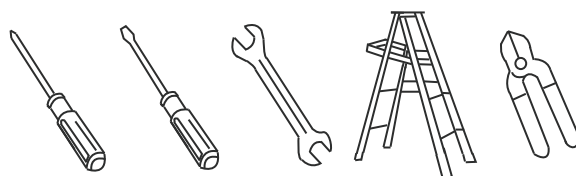

PACKAGE CONTENTS

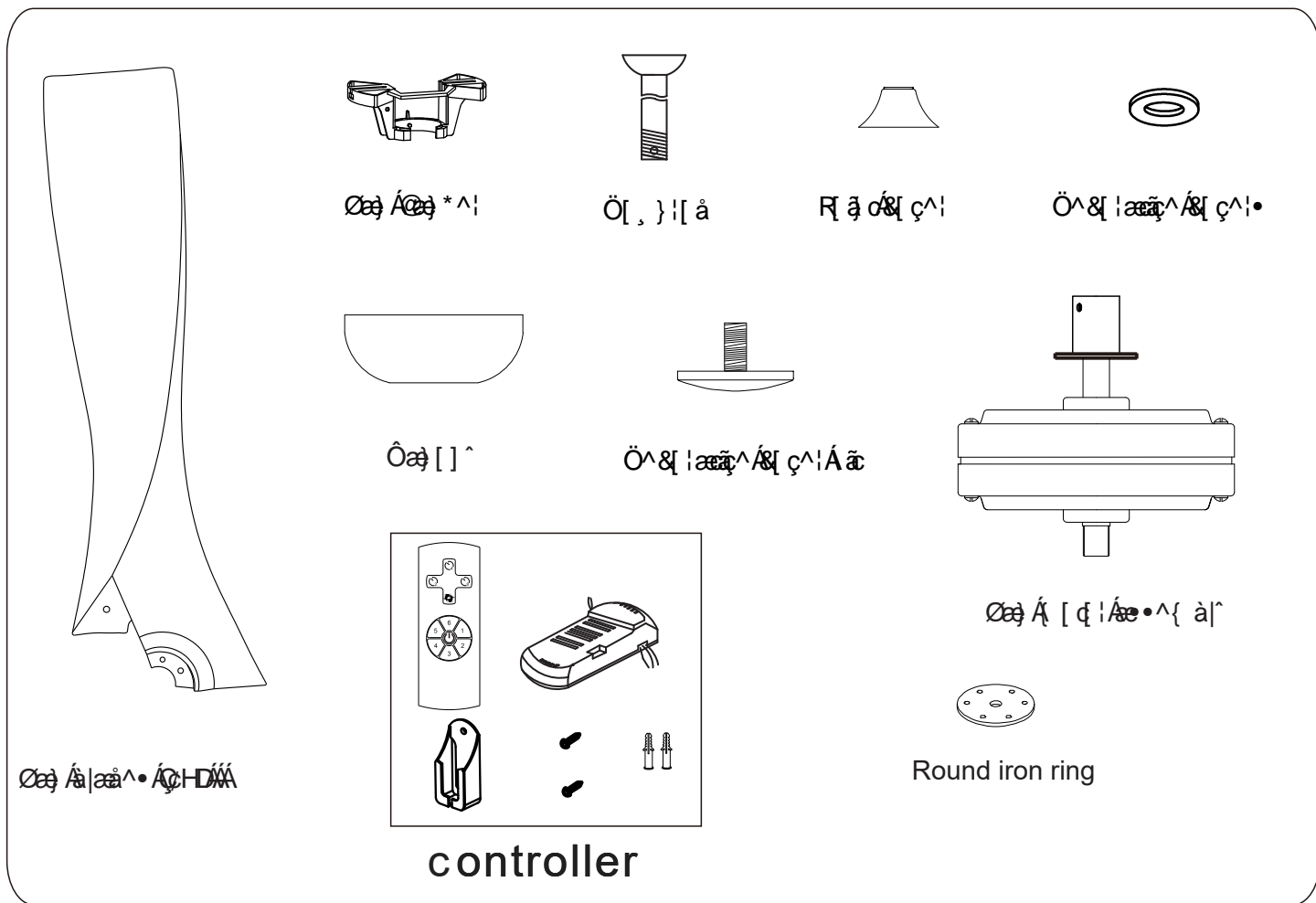

ACCESSORIES PACKAGE

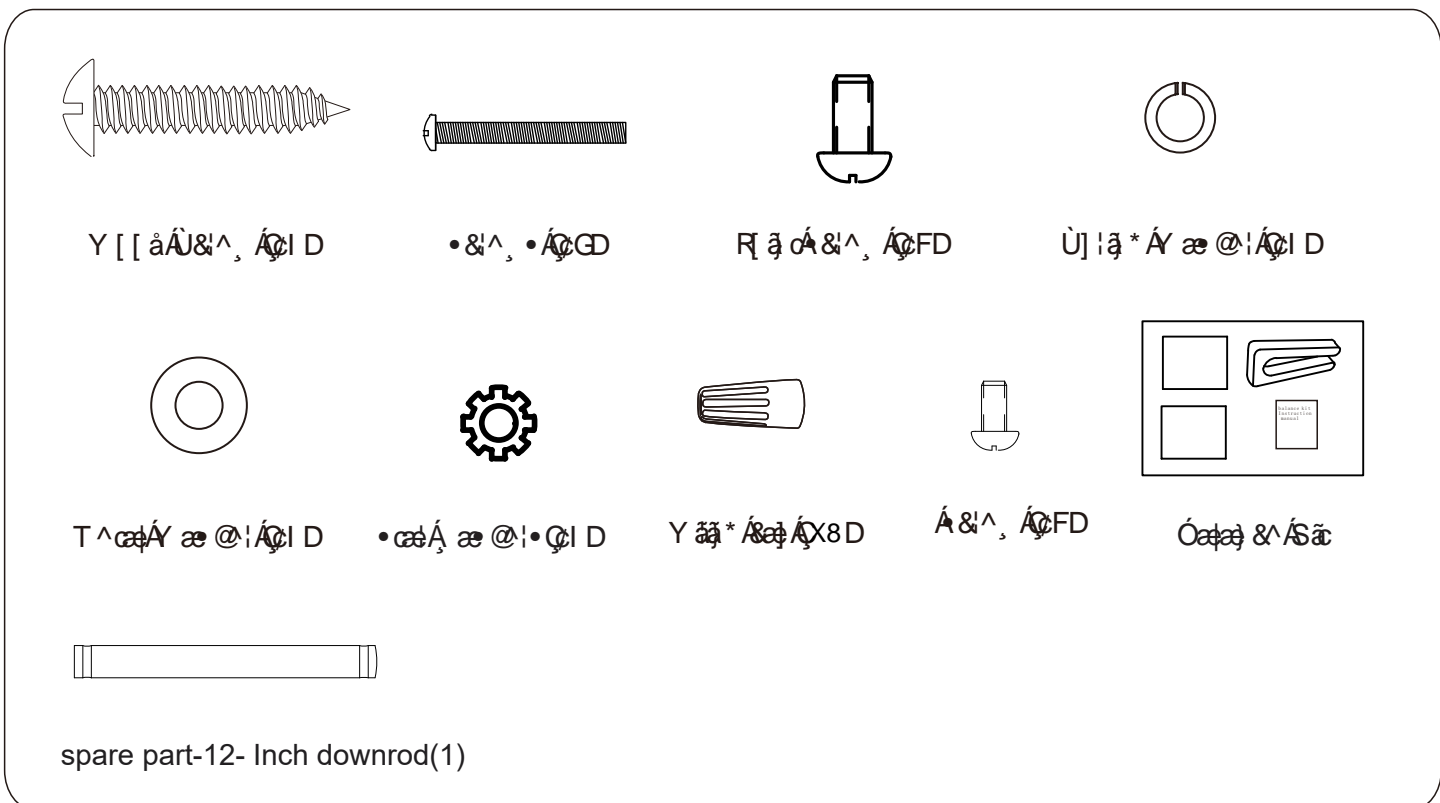

SAFETY INFORMATION

WARNING

To reduce the risk of electric shock, ensure electricity has been turned off at the circuit breaker or fuse box before beginning.

All wiring must be in accordance with national and local electrical codes. Electrical installation should be performed by a qualified licensed electrician.

Suitable for use with solid-state speed controls.

To reduce the risk of personal injury, use only the two steel screws (and lock washers) provided with the outlet box for mounting to the outlet box. Most outlet boxes commonly used for the support of lighting fixtures are not acceptable for fan support and may need to be replaced, consult a qualified electrician if in doubt.

TO REDUCE THE RISK OF FIRE, ELECTRIC SHOCK OR PERSONAL INJURY, MOUNT FAN TO OUTLET BOX MARKED "ACCEPTABLE FOR FAN SUPPORT".

5. The outlet box and support structure must be securely mounted and capable of reliably supporting a minimum of 50 pounds. Use only UL listed outlet boxes marked "FOR FAN SUPPORT".

6. After marking electrical connections, spliced conductors should be turned upward and pushed carefully up into outlet box. The wires should be spread apart with the grounded conductor and the equipment-grounding conductor on one side of the outlet box.

7. The fan must be mounted with a minimum of 7 feet clearance from the trailing edge of the blades to the floor.

8. Do not use the reverse switch while the fan blades are in motion. To prevent damage and ensure long use, the fan must be turned off and the blades stopped before reversing direction.

9. Do not place objects in the path of the blades.

10. Exercise caution when working around or cleaning the fan.

11. Use a soft dry cloth to clean the fan body and blades. Do not use water or detergent.

12. The electrical diagrams provided herein are for reference only. Light kits that are not packaged with the fan must be UL listed and suitable for use with this fan. Switches must be UL general use switches. Refer to their separate instructions for proper assembly.

TO REDUCE THE RISK OF FIRE, ELECTRIC SHOCK OR PERSONAL INJURY, MOUNT FAN TO OUTLET BOX MARKED "ACCEPTABLE FOR FAN SUPPORT".

PREPARATION

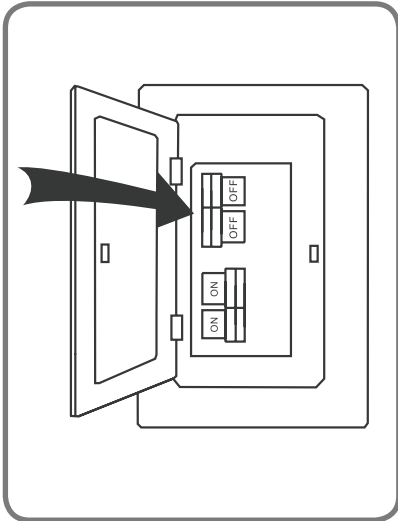

1. Turn power off

Begin installation by removing fuses or turning off circuit breakers to the wiring you will be using. Use your compatible UL listed mounting box if you already have one installed.

Failure to disconnect the power supply prior to installation may result in serious injury or death.

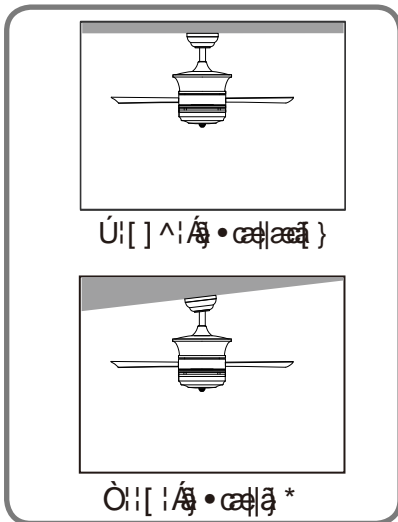

2. Choose mounting position

If you need to install a new UL listed mounting box, secure it directly to your building's structure using appropriate fasteners and materials. Do not use plastic boxes. The outlet box and its supports must be able to support the MOVING weight of the fan (at least 50 lb.) and be rated for fan support.

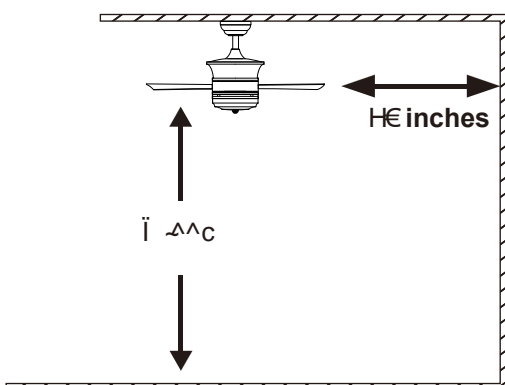

3. Choose suitable location

Ensure the blades will be at least 30 inches from any obstruction and at least 7 feet above the floor.

INITIAL INSTALLATION

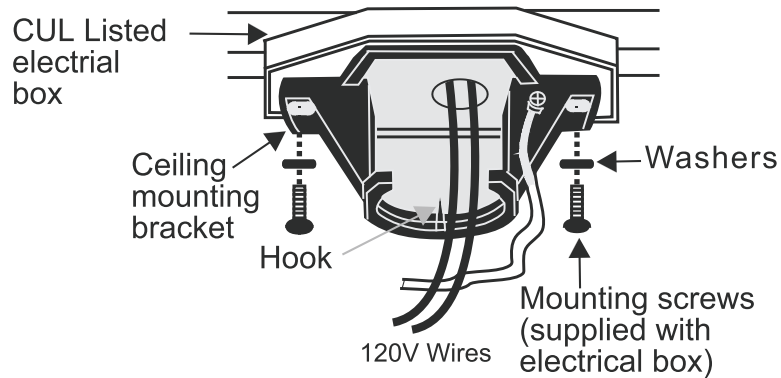

Loosen the screws on the fan hanger and fix the fan hanger to the ceiling outlet box with the wood screws and spring washers. Pass the 120V supply wires through the center hole in the ceiling mounting bracket.

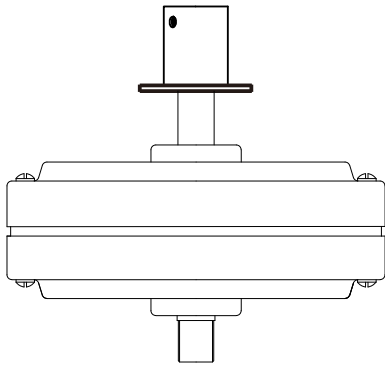

Take out the ceiling fan and check if the motor body is complete. If any part is missing or damaged, it is recommended to stop the installation.

7Y]`]b[`ZLb`achcf`UggYâV m

DOWNROD MOUNTING

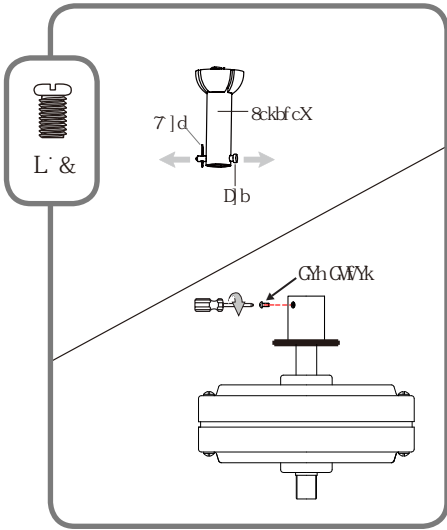

Step 1. Remove the pin and clip from the downrod. Then partially loosen the two steel screws in the yoke at the top of the motor assembly.

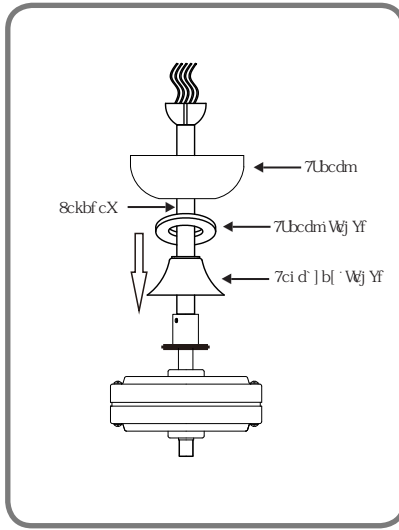

Step 2. Carefully place the canopy, canopy cover, and coupling cover onto the downrod; feed the lead wires from the fan motor through the downrod.

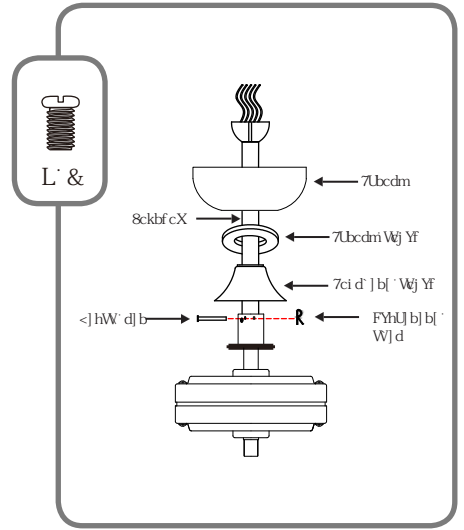

Step 3. Install the downrod onto the yoke, aligning the holes, inserting the pin through the downrod, and reinstalling the clip; then tighten the steel screws.

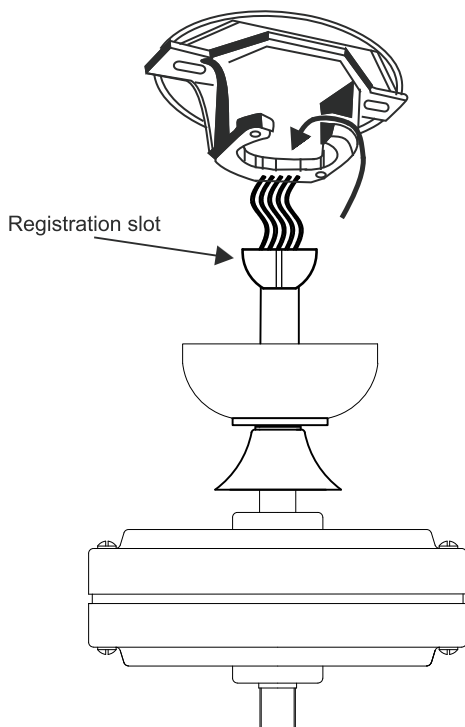

Step 4. Place the downrod's mount into the bracket on the outlet box. Rotate the entire assembly until the tab has dropped into the mount's slot and locked firmly into place. The motor assembly should no longer rotate if seated properly.

WARNING! 100% 1^Á Á ææ&@&@Á&@Á ă Áă ăđ 1Á
] [] ^ | Á • ^ æ Á @ Á â [,] | ă Á &ă Á &ă • ^ Á @ Á ă Áđ Á
 ăđ Á - [{ Á @ Á & Á ăă * Áă 1ă * Á [] ^ 1ăă } Æ Ö Ú Á Þ Ú V Á
 ~ • ^ Á @ Á ăă Á à - [1 Á Á ^) • 1ă * Á ă Á ă Á] [] ^ | Á
 • & 1^ á Áăă á Á @ Á [ċ 1 Á can n Á } * ^ 1 Á ăă É

CIRCUIT CONNECTION

⚠ WARNING: Again, ensure that the power has been cut before working with the wiring. Use the wire nuts provided with your fan. Ensure there are no loose wires or connections, and secure connectors with electrical tape.

Step 1. Insert the receiver into the tray with the receiver facing the ceiling. For best performance, make sure the White antenna, on the end of the receiver, remains extended and not tangled with any of the electrical wires.

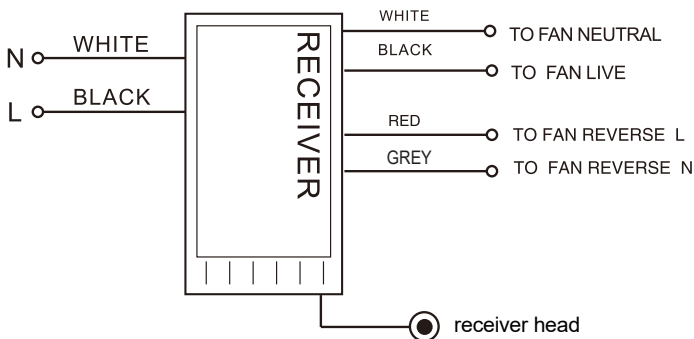
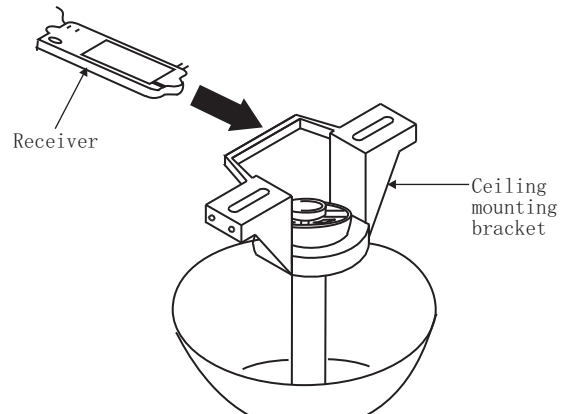

Step 2. Connect the 4 colored wires from the remote receiver to the 4 identically colored lead wires from the fan motor. Secure each set with the provided wire nuts.

Step 3. Connect the 2 colored wires from the remote receiver to the 2 identically colored lead wires from the outlet box. Secure each set with the provided wire nuts.

Step 4. Connect the green or bare copper ground wire from the outlet box to the ground wires from the ceiling mounting bracket and the ceiling fan. Separate the white and green connections from the black wire connections, which should be kept on opposite sides of the outlet box.

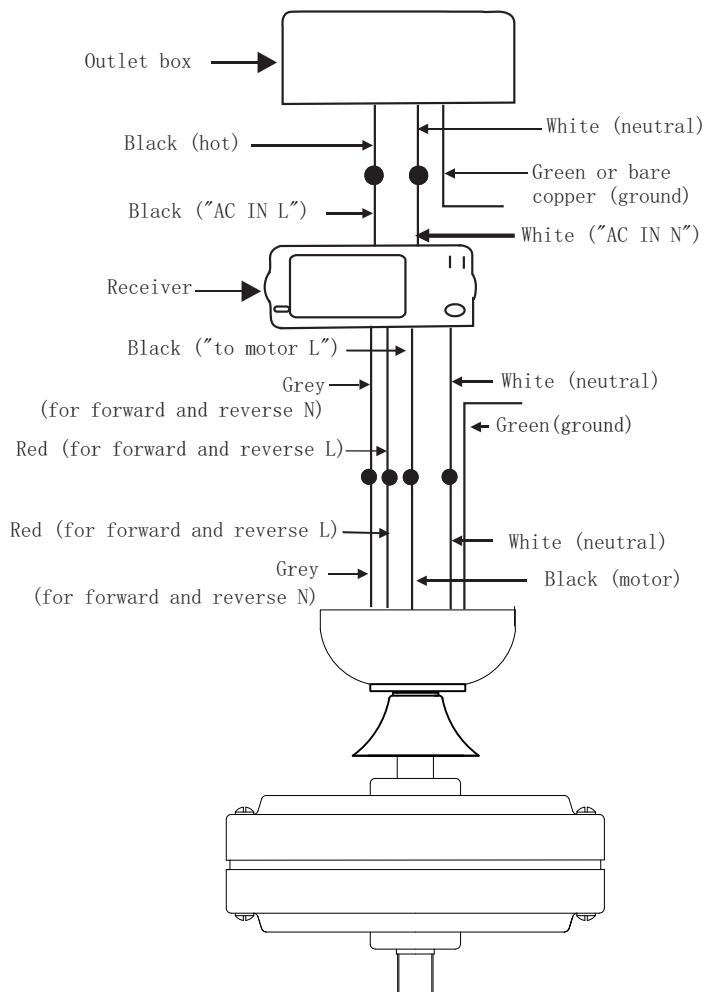

INSTALL THE HOST

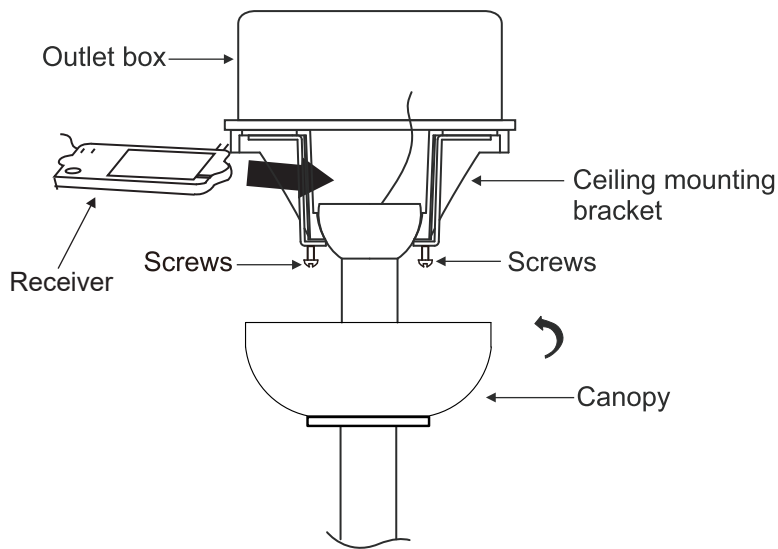

Tuck all the connections neatly into the ceiling outlet box. Slide the canopy up to the mounting bracket and place one of the key hole slots over the mounting screw on the mounting bracket. Tighten the screws.

INSTALL FAN BLADES

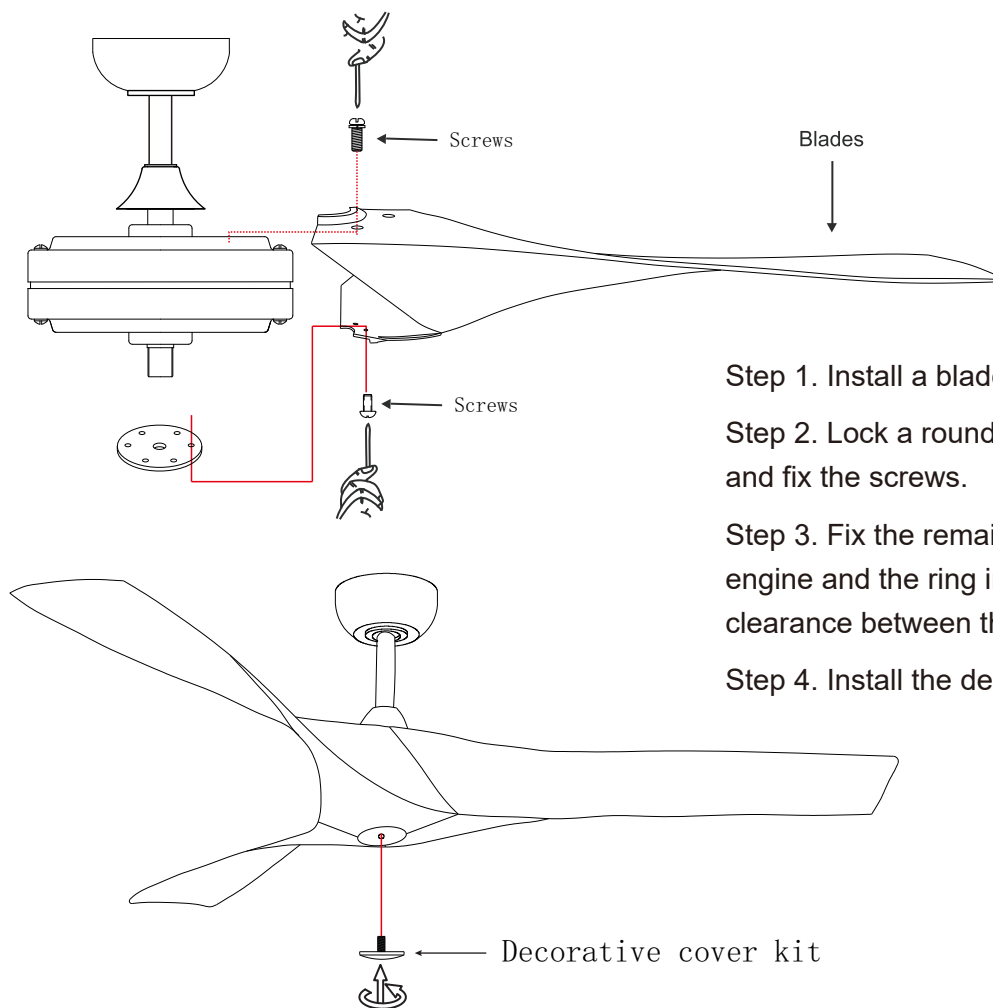

Step 1. Install a blade on the main machine.

Step 2. Lock a round iron ring inside the blade and fix the screws.

Step 3. Fix the remaining two blades on the main engine and the ring in turn, and adjust the clearance between the blades.

Step 4. Install the decorative cover.

REMOTE CONTROL OPERATION

Install the remote control holder onto any wall or suitable flat surface using the two steel screws. Upon first use, connect the remote control to its receiver in the fan by pressing the emitter's "⏻" button for 3-10 seconds. There should be a beep to announce that the remote has successfully connected to its receiver.

1, 2, 3, 4, 5, 6: Starts the fan at one speed

⏻: Turns off the fan

⌚ 2 ⌚ 4 ⌚ 8: Runs the fan for 2/4/8 hours and then turns it off

↺↻: Reverses the fan's direction "Forward and Reverse"

DO NOT press the F/R button while the fan is in operation. Wait for the blades to fully stop their movement before reversing their direction.

This remote operates with a range of 30 feet (10 m). It uses 2 1.5V AAA batteries (not included). If the remote will not be used for a prolonged period, it is recommended to remove the batteries for better service life.

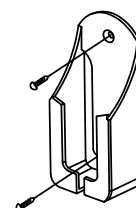
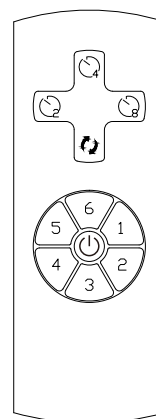

TROUBLESHOOTING

Problem

Common Solutions

Fan blades don't rotate

1. Check fuses and/or circuit breakers and reset if needed.
2. Cut off power to the fan and check its internal electrical connections.
3. Replace one of the remote control batteries.
4. Check that the fan cover is correctly placed and no screws interfere with the movement of the blades.
5. Contact customer service to replace a faulty remote control.

Fan is too noisy

1. Check that all screws and fasteners are well tightened.
2. Ensure the canopy housing has a short distance between itself and the ceiling.
3. Upon initial installation, allow 24 hours of use for the machine to break itself in.
4. Cut off power to the fan and check that the wire nut connections are not rubbing against one another or the inner housing.
5. If you have installed a solid-state variable-speed control, cut off power to the fan and disconnect this control from the device. See if using the remote resolves the problem, which can be caused by erratic signals from such controls.

Fan wobbles during use

1. Check that all screws and fasteners are well tightened.
2. Use the provided blade balancing kit to adjust the blades if their tips are found to be an unequal distance from the ceiling while well fastened.
3. Exchange the position of the various blades.

Again, do not bend the blades during any of these procedures.