



HARBOR BREEZE and logo design are trademarks or registered trademarks of LF, LLC. All rights reserved.

ITEM #5745377
MODEL #43084

OUTDOOR MOTION WALL LIGHT

Español p. 12

ATTACH YOUR RECEIPT HERE

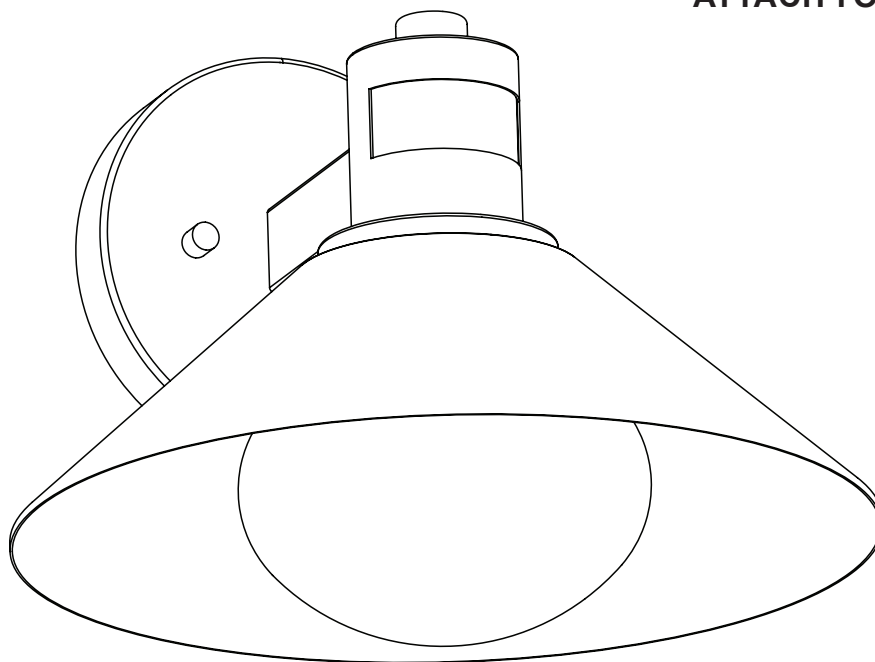

**RATED
FOR WET
LOCATION**

Purchase Date _____

Thank you for purchasing this HARBOR BREEZE product.
Questions, problems, missing parts?
Before returning, to your retailer, contact us at:
866-439-9800, 8 a.m. - 8 p.m., EST, Monday - Sunday or **ascs@lowes.com**.

TABLE OF CONTENTS

Package Contents. 3

Hardware Contents. 3

Safety Information. 4

Assembly Instructions. 5

Operating Instructions 9

Troubleshooting. 10

Warranty. 11

PACKAGE CONTENTS

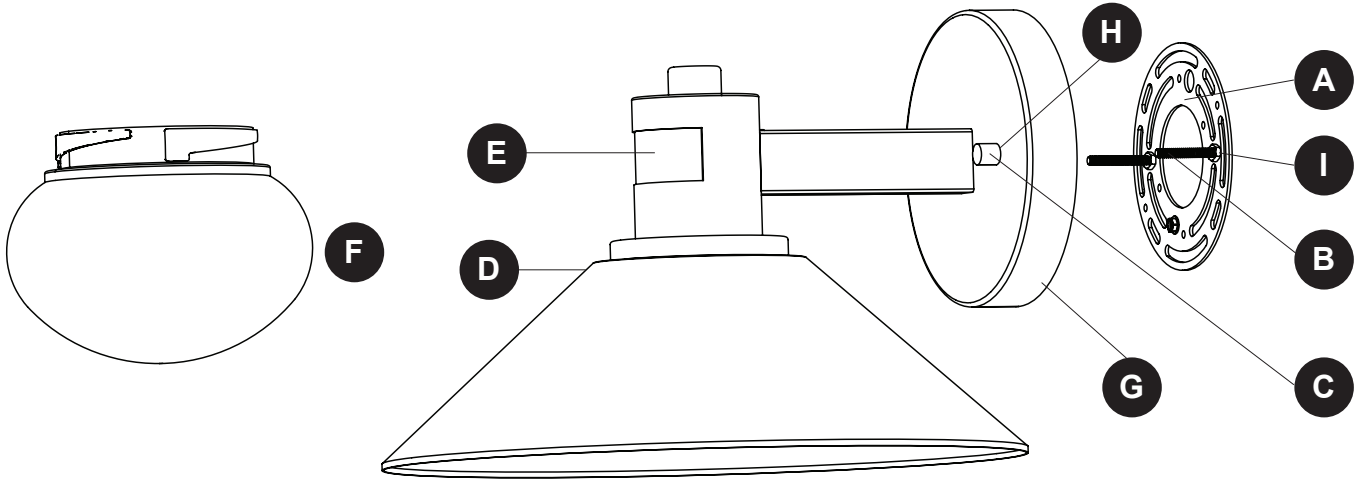

PART	DESCRIPTION	QUANTITY
A	Mounting Bracket (preassembled to Fixture [D])	1
B	Mounting Screw (preassembled to Mounting Bracket [A])	2
C	Screw Cap (preassembled to Mounting Screw [B])	2
D	Fixture	1
E	Motion Sensor (preassembled to Fixture [D])	1
F	Glass Bowl	1
G	Wall Plate (preassembled to Fixture [D])	1
H	Rubber Washer (preassembled to Mounting Bracket Screw [B])	2
I	Hex Nut (preassembled to Mounting Bracket Screw [B])	2

HARDWARE CONTENTS

AA



Wire Connector
Qty. 3

RR



Bracket Screw
Qty. 2

PREPARATION

Estimated Assembly Time: 60 minutes

Tools Required for Assembly (not included):

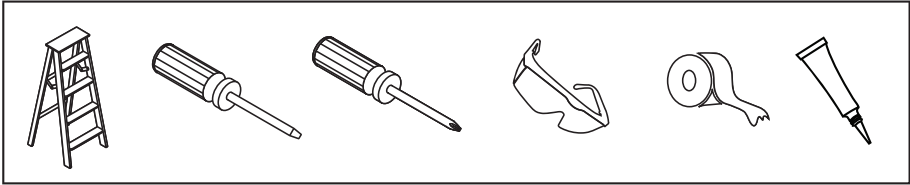

Helpful Tools (not included)

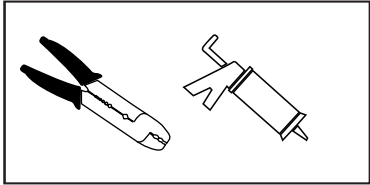

SAFETY INFORMATION

Please read and understand this entire manual before attempting to assemble, operate or install the product. Failure to do so could lead to electrical shock, fire or other injuries that could be hazardous or even fatal.

- Before you begin installing the light, disconnect the power by removing fuses or turning off the circuit breakers.
- Make sure that all electrical connections comply with local codes, ordinances, the National Electrical Code, and ANSI/NFPA 70-199. Hire a qualified electrician or consult a do-it-yourself wiring handbook if you are unfamiliar with installing electrical wiring.
- The net weight of the light is 3.32 lbs.

LISTED FOR WET LOCATION



DANGER:

- DO NOT connect this fixture to an electrical system that does not provide a means for equipment grounding. Never use a fixture in a two-wire system that is not grounded. Installing a fixture into an electrical system not having a proper grounding means could cause metal parts of the fixture to carry electrical currents if any of the fixture wires, wire connections or splices were to become broken, cut or loose during the mounting or normal operation of the fixture. Under this condition, anyone coming in contact with the fixture would be subject to electrical shock, which could cause serious injury or death.
- DO NOT connect the bare or green insulation fixture ground wire to the black (hot) current-carrying wire or the white neutral house wire. Connection of the bare or green fixture ground wire to the black or white house wires may cause metal parts of the fixture to carry electrical currents. Under this condition anyone coming in contact with the fixture will receive electrical shock, which could cause serious injury or death.
- DO NOT damage or cut the wire insulation (covering) during installation of the fixture. DO NOT permit wires to contact any surface having a sharp edge. To do so may damage or cut the wire insulation, which could cause serious injury or death from electrical shock.



WARNING:

- All electrical connections must be in agreement with local codes and ordinances, the National Electric Code (NEC) and ANSI/NFPA 70-1999. Contact your municipal building department to learn about your local codes, permits and/or inspections. Risk of fire - most dwellings built before 1985 have supply wire rated for 140°F. Consult a qualified electrician before installation.
- To avoid personal injury, the use of gloves may be necessary while handling fixture parts with sharp edges.
- DO NOT suspend any fixture by the house wires. A fixture must always be mounted directly to a an outlet box. Wire connectors will not support the weight of a fixture. Suspending a fixture by the house wires and wire connectors will result in the fixture falling, with the possibility of personal injury and the danger of electrical shock or fire.
- To reduce the risk of fire, electrical shock, or personal injury, each wire connector used with this fixture should accept only one 18-gauge wire from the light fixture and one 18-gauge wire from the outlet box. If there are three or more wires to connect or any of the wires is larger than 18 gauges, consult an electrician for the proper size wire connectors to use.

INSTRUCCIONES DE ENSAMBLAJE

1. Turn off the circuit breakers and the wall switch to the supply line leads.

⚠ DANGER: Failure to disconnect the power supply prior to installation may result in serious injury or death.

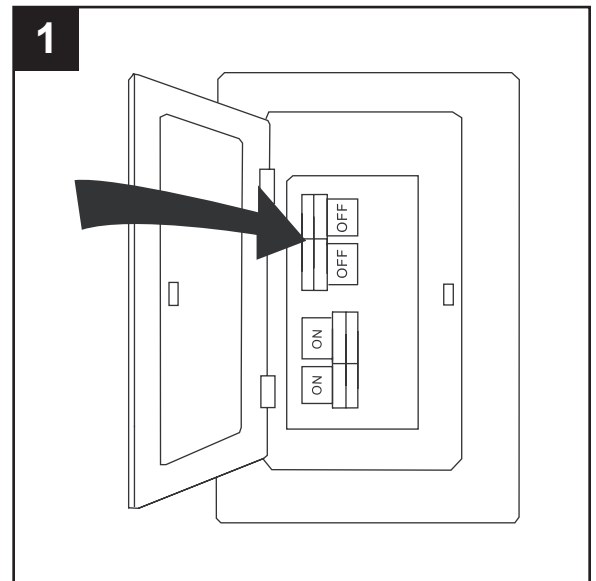

2. Remove the screw caps (C) and rubber washers (H) from the mounting screws (B) preassembled to the mounting bracket (A). Remove the mounting bracket (A) from the wall plate (G).

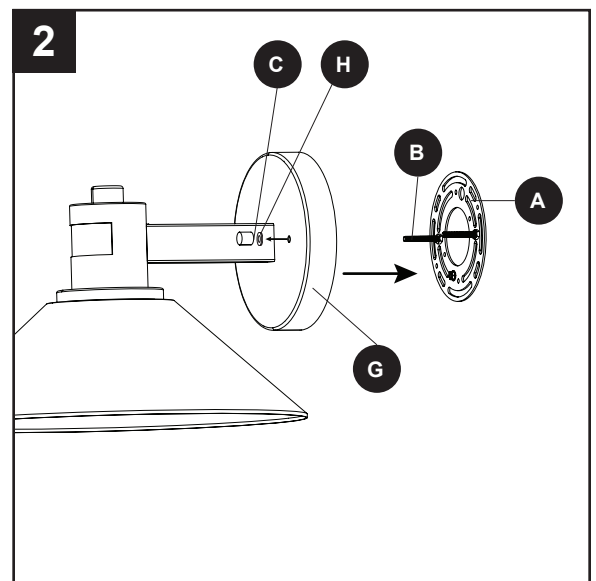

3. Use the bracket screws (RR) to attach the mounting bracket (A) securely to the outlet box (sold separately). **Note:** In order for fixture (D) to be level, the mounting screws (B) must be aligned exactly perpendicular to the horizon since they will determine the orientation of the fixture.

Hardware Used

RR Bracket Screw  x 2

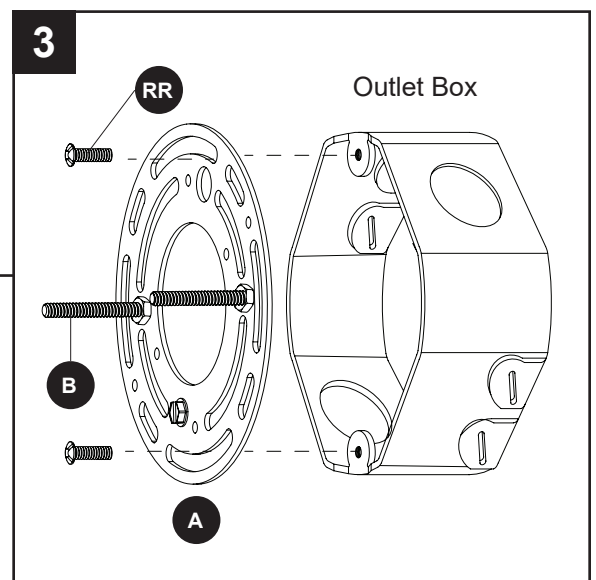

ASSEMBLY INSTRUCTIONS

⚠ WARNING: To reduce the risk of fire, electrical shock or personal injury, wire connectors provided with this fixture are designed to accept only one 12-gauge house wire and two lead wires from the fan. If your house wire is larger than 12-gauge and/or there is more than one house wire to connect to the two fixture lead wires, consult an electrician for the proper size wire connectors to use.

CAUTION: Be sure the outlet box is properly grounded or that a Ground (Green or Bare) wire is present.

4. Use wire connectors to secure the household supply wires to the fixture wires according to the image and the following instructions:

- Loosen the ground screw on the mounting bracket and wrap the bare wire from the fixture around the ground screw. Tighten the ground screw to hold the bare wire in place.
- Connect the bare wire from the fixture to the Bare/ Green (ground) supply wire.
- Connect the White wire from the fixture to the White (neutral) supply wire.
- Connect the Black wires from the fixture to the Black (hot) supply wire.
- Secure all wiring connections together with wire connectors (AA).

Note: If supply wire colors differ from these, contact a professional electrician to determine proper wiring.

Hardware Used



Wire Connector



x 3

5. Wrap electrical tape (not included) around each individual wire connector (AA) down to the wire.
6. Turn the spliced/taped wires upward and gently push the wires and wire connectors (AA) into the outlet box.

⚠ WARNING: Ensure no bare wire strands are visible after making connections. Place Green and White wire connections on opposite sides of outlet box from the Black.

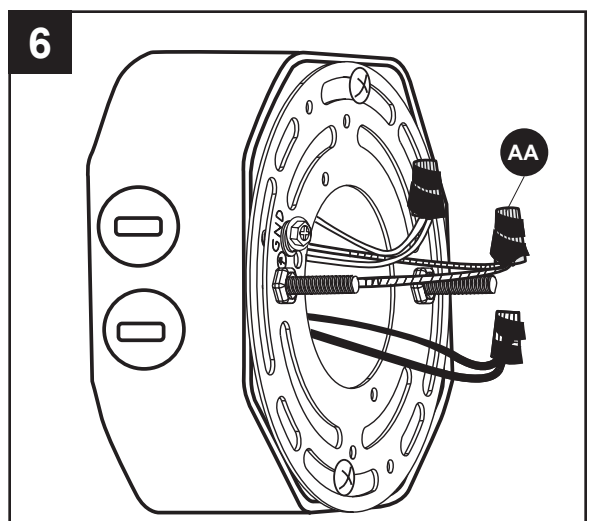
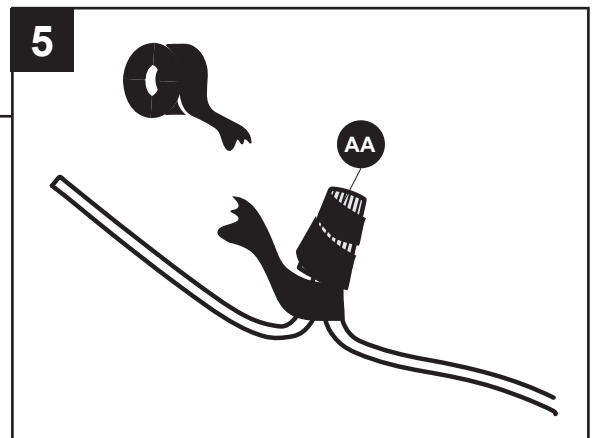
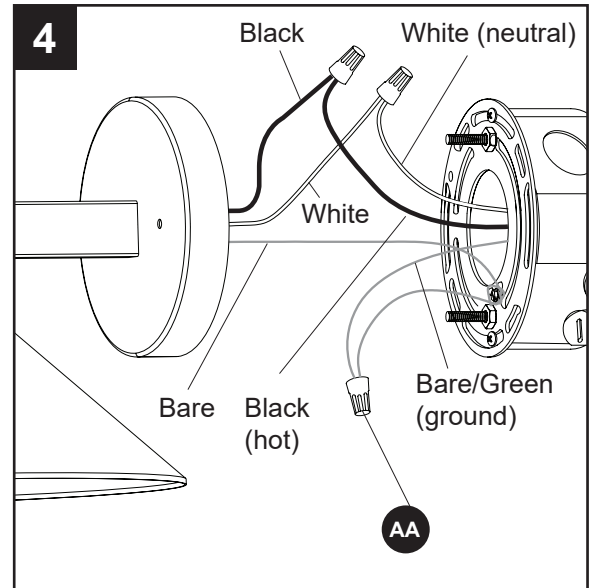

ASSEMBLY INSTRUCTIONS

7. Hang the wall plate (G) on the mounting screws (B) preassembled to the mounting bracket (A). Then use the rubber washers (H) and screw caps (C) to secure the fixture (D) to the mounting bracket (A).

Note: If the wall plate (G) is not flush against the wall, remove the wall plate (G) and loosen the hex nuts (H) to allow the mounting screw (B) length to be adjusted. Once adjusted retighten the hex nuts (H) and reinstall the wall plate (G).

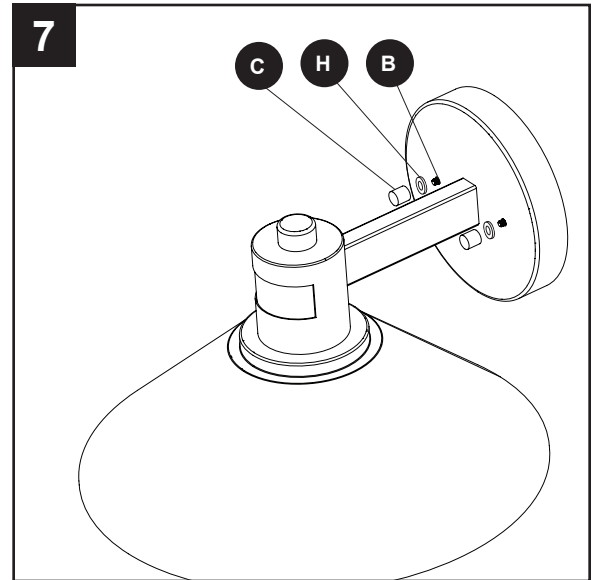

8. Install the E26-base bulb (sold separately) into the socket of the fixture (D).

Note: Fixture (D) is compatible with any E26-base LED, CFL (60 watt max.).

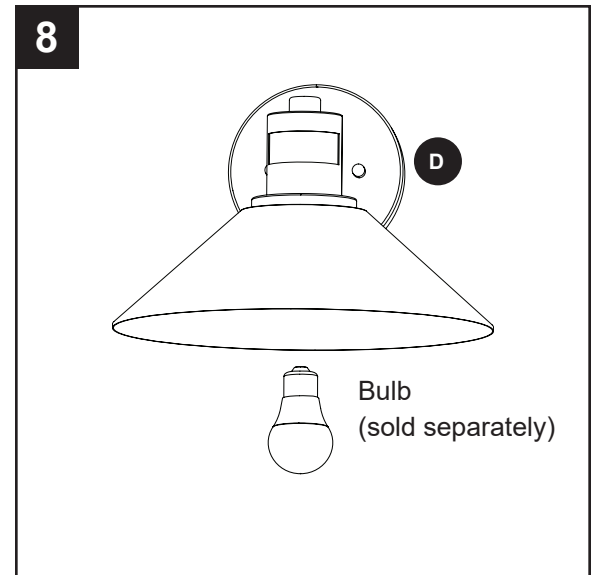

9. Attach the glass bowl (F) to the socket by twisting the glass bowl (F) firmly in a clockwise direction until it is secure.

CAUTION: Avoid cross-threading the glass during installation. Improper installation could cause the glass bowl to be difficult to remove or fall, which could cause serious injury.

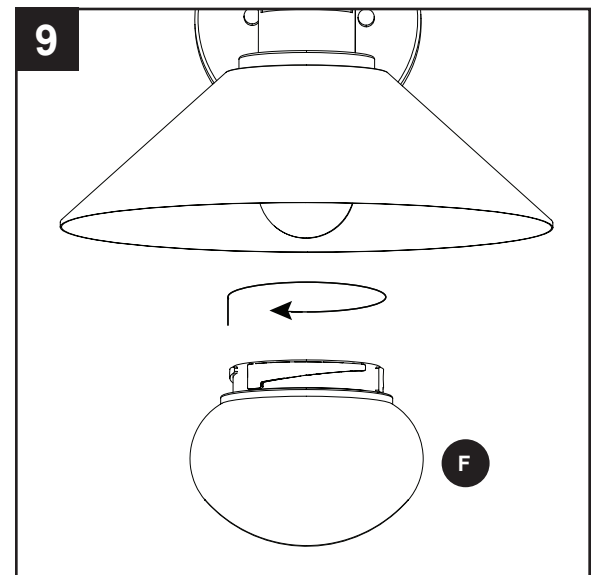

ASSEMBLY INSTRUCTIONS

10. To prevent water, rain, or moisture from entering wall plate (G), use waterproof caulk (sold separately) to seal the perimeter.

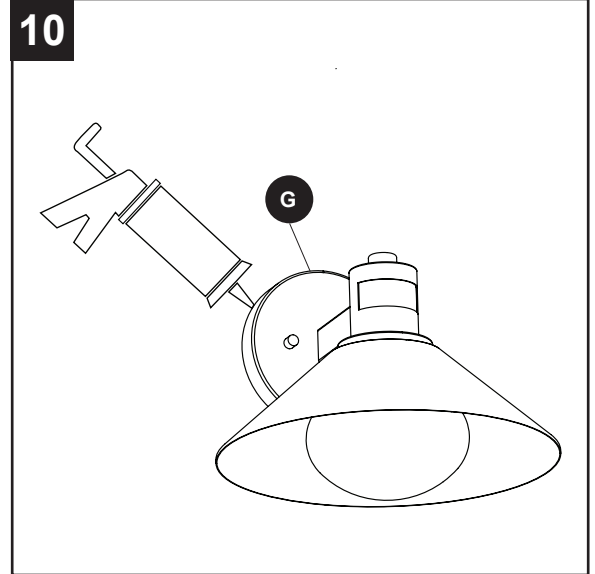

11. Restore the power to the circuit breakers and the wall switch to the supply line leads.

Assembly is complete.

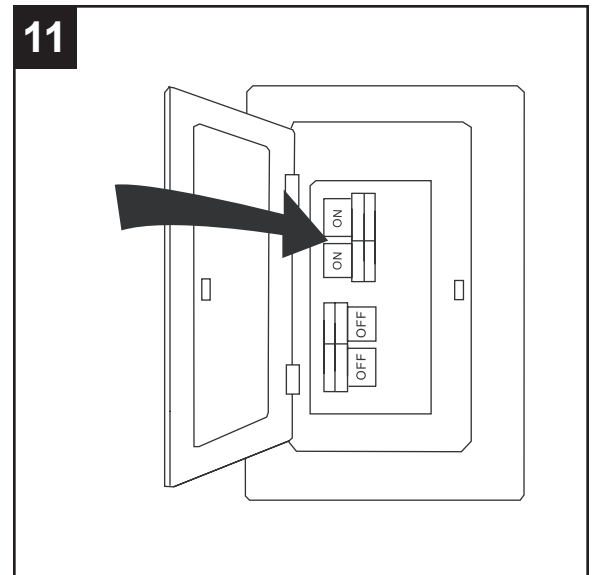

OPERATING INSTRUCTIONS

MODE	WORKS	ON TIME	SHUT OFF DELAY	EXPLANATION
STAND-BY MODE	Day & Night	20 Sec.	--	Turn on the power at the main fuse or circuit breaker box, the light will turn on immediately. Wait for about 20 seconds to allow the sensor to warm up, then the light will automatically enter into the TEST mode.
TEST MODE	Day & Night	While motion is detected.	5 Sec.	The light will turn on when motion is detected, and stay on as long as the motion is continuing. The light will turn off in about 5 seconds after motion is no longer detected. There is one red LED on motion sensor flashing 1 time when motion is detected. Note: The time of TEST mode is approximately 120 seconds, then light will automatically enter into the AUTO mode.
AUTO MODE	Night Only	While motion is detected.	2 Min.	At dusk, the light will turn on when motion is detected, and stay on as long as the motion is continuing. The light will turn off in about 120 seconds after motion is no longer detected. There is one red LED on motion sensor flashing 1 time when motion is detected.
MANUAL OVERRIDE	Night Only	While in manual override.	8 hours or Turn off at dawn.	In "AUTO" mode, to shift to the manual override mode, turn the wall switch "OFF", and turn it "ON" within 2 seconds. The light will turn on and stay on for approximately 8 hours, or until the Dusk-to-Dawn sensor detects light in the morning. Once the Dusk-to-Dawn sensor detects light for more than 30 seconds, the manual override mode will automatically go back to the AUTO mode.

- Note:** 1. To make sure the above functions operate properly, always keep the wall switch in the "ON" position (including the daytime).
2. Turn the wall switch "OFF", wait over 10 seconds and then switch it "ON" again, the light will revert to warm-up period again.

OPERATING INSTRUCTIONS

- The sensitivity of the motion sensor will increase as the enviromental temperature gets cooler. For best performance, gently clean the lens with a soft cloth every 1 to 2 months to assure maximum sensitivity.
- For best performance, install fixture 6 feet above the ground which will provide motion detection up to 40 feet at 77 degrees farenheit (Fig. 1).
- The sensor detects motion at a range of 220 degrees (Fig. 2).
- The sensor will be more sensitive to motion across its detection path than motion directly towards it (Fig. 3).
- To reduce possible nuisances, do not mount the fixture near a heat source like an air conditioner, vent or furnace exhaust, or in a direction facing any reflecting object or other light source.

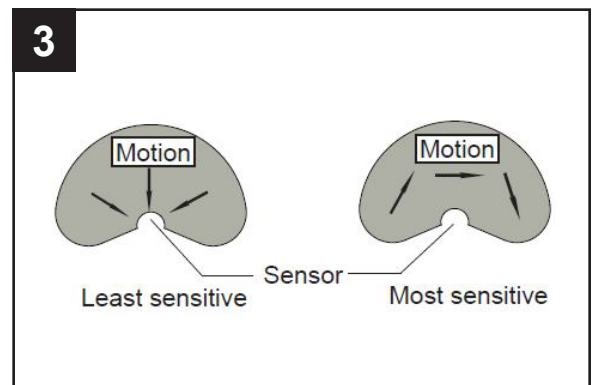
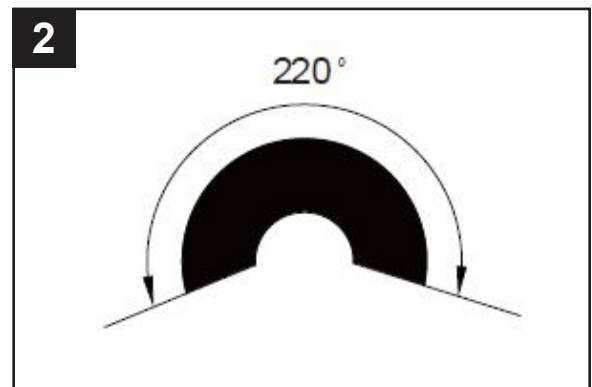
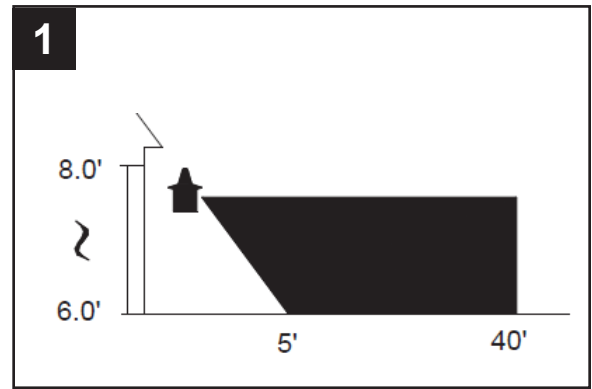

TROUBLESHOOTING

PROBLEM	POSSIBLE CAUSE	CORRECTIVE ACTION
Light does not operate in Test Mode.	1. Wall switch or circuit breaker is off. 2. Wire connections are incorrect.	1. Turn on wall switch or circuit breaker. 2. Check wire connections.
In Auto Mode, the light stays on 100% brightness continuously.	False triggering caused by heat source, such as street or sidewalk traffic, a heater or dryer vent, air conditioning vent, or heated swimming pool.	Eliminate the heat source or relocate the fixture.
In manual override mode, the light stays on after dawn.	Ambient light level is too low.	Relocate the fixture.

TROUBLESHOOTING

PROBLEM	POSSIBLE CAUSE	CORRECTIVE ACTION
In Auto Mode, the fixture does not turn on when there is motion.	<ol style="list-style-type: none">1. Wall switch or circuit breaker is off.2. Bulb is defective.3. Bulb is loose.4. Incorrect or loose wire connections.5. Too much sunlight on the Dusk-to-Dawn sensor in early evening.6. Too much light is shining onto the sensor, such as street light or other light fixture.	<ol style="list-style-type: none">1. Turn on wall switch or circuit breaker.2. Test bulb in another fixture.3. Tighten bulb in socket.4. Check wire connections.5. Relocate fixture away from western facing wall.6. Eliminate or turn off other light source, block the light source from sensor, or relocate the fixture.
The light fixture comes on during the daytime or too early in the evening.	The fixture may be installed in a shaded area, like a porch or eave, preventing daylight from shining on the sensor.	Relocate the fixture.
The light fixture comes on at 100% brightness for no apparent reason.	False triggering caused by heat source, such as street or sidewalk traffic, a heater or dryer vent, air conditioning vent, or heated swimming pool.	Eliminate the heat source or relocate the fixture.

THREE-YEAR LIMITED WARRANTY

The manufacturer warrants all of its lighting fixtures against defects in materials and workmanship for three (3) years from the date of purchase. If within this period the product is found to be defective, take a copy of the bill of sale as a proof of purchase and the product in its original carton to the place of purchase. The manufacturer will, at its option, repair, replace or refund the purchase price to the consumer. All costs of installation and removal of the fixture is the responsibility of the consumer. This warranty does not cover fixtures becoming defective due to misuse, accidental damage or improper handling and/or installation and specifically excludes liability for direct, incidental or consequential damages. As some states do not allow exclusions or limitations on an implied warranty, the above exclusion and limitation may not apply. This warranty gives you specific rights and you may also have other rights which may vary from state to state.