

## LED Single Ended Type B T8 Tubes (120V to 277V)

LED15BT8/G4/830	LED12BT8/G4/830	LED10BT8/G3/830	LED13BT8/G3/830	LED8BT8/G2/830
LED15BT8/G4/835	LED12BT8/G4/835	LED10BT8/G3/835	LED13BT8/G3/835	LED8BT8/G2/835
LED15BT8/G4/840	LED12BT8/G4/840	LED10BT8/G3/840	LED13BT8/G3/840	LED8BT8/G2/840
LED15BT8/G4/850	LED12BT8/G4/850	LED10BT8/G3/850	LED13BT8/G3/850	LED8BT8/G2/850

Above listed Type B LED T8 Tubes are suitable to replace T8 fluorescent lamps in luminaires containing standard non-shunted G13 (medium bi-pin) lamp holders.



### BEFORE YOU BEGIN

to install the Type B LED T8, please read the entire installation guide carefully.

Ensure that package includes installation guide, warning label to be attached to luminaire, LED T8 tube.

Minimum fixture volume for 4 lamps is 48 inches long x 12 inches wide x 4 inches deep (4'), 36 inches long x 12 inches wide x 4 inches deep (3'), or 24 inches long x 12 inches wide x 4 inches deep (2'). Minimum socket spacing is 2.5 inches apart.

Product is not intended to be used with dimmers and emergency light luminaires. This LED T8 tube is not suitable for direct replacement of linear fluorescent lamp in luminaires where the lamps are connect to a ballast. The technical and safety requirements of the converted luminaire are the sole responsibility of the party doing the conversion and shall comply with the local applicable safety and regulatory laws and standards. The provided Warning label should be placed onto the converted luminaire to indicate the the luminaire has been modified and can no longer be used with fluorescent lamps.



**WARNING: RISK OF FIRE OR ELECTRIC SHOCK** LED Retrofit Kit installation requires knowledge of luminaire electrical systems. If not qualified, do not attempt installation. Contact a qualified electrician. Install this kit only on luminaires that have the construction features and dimensions shown in the drawings and where the input rating of the retrofit kit does not exceed the input rating of the luminaire. To prevent wiring damage or abrasion, do not expose wiring to edges or sheet metal or other sharp objects. Installers should not disconnect existing wires from lampholder terminals to make new connections at lamp holder terminals. Instead installers should cut existing lampholder leads away from the lampholder and make new electrical connections to the lampholder lead wires by employing applicable connectors (or replace with new non-shunted lamp holders). THIS RETROFIT KIT IS ACCEPTED AS A COMPONENT OF A LUMINAIRE WHERE THE SUITABILITY OF THE COMBINATION SHALL BE DETERMINED BY AUTHORITIES HAVING JURISDICTION. Do not make or alter any open holes in an enclosure of wiring or electrical components during kit installation. This lamp operates direct from 120V-277V mains. Do not use Ballast or any starting aid. Do not connect to voltage higher than 277 volts. Ensure misapplication fuse and fuseholder are connect between Phase or Hot Lead and the lampholder per the wiring diagram (part of GE lampholder Kit). To avoid risk of fire or electrical shock, Do NOT use with SHUNTED Instant Start style lampholders. Use only with NON SHUNTED Rapid Start style on the powered end of the tube. Use of the GE pre-wired lampholder socket and fuse kit is recommended.

### CAUTION: RISK OF FIRE OR ELECTRICAL SHOCK

- Apply provided re-lamp warning sticker onto the fixture in a location where readily visible by the user during and after installation.

### RISK OF INJURY OR DAMAGE

- This Luminaire has been modified and can no longer operate a fluorescent lamp. Only use the replacement LED T8 type or contact manufacturer for more information.

### Direct wire / New luminaire

- 1) Ensure power is off to luminaire by disconnecting the supply voltage.
- 2) Remove all fluorescent lamps, ballast and lampholders (if applicable as this Single Ended Type B LED T8 requires non-shunted lampholders).
- 3) Wire luminaire to configuration shown on drawing number 3
  - a) For ease of installation use the GE LED Type B pre-wired socket/fuse kit to replace the sockets and add main voltage quick connect.
  - b) Type B LED T8 tube will only operate on non-shunted sockets.
  - c) The fuse shall be a Type 2AG, rated at 1 amp, 350 volts, Littelfuse part number 0209001.MXP or equivalent.

Note: Final compliance/inspection to local standards/regulations of the luminaire is the responsibility of the luminaire manufacturer or installer.

- 4) Place warning label found in LED retrofit lamp package to ensure that the user understands that the system now uses LED tubes and replacement with fluorescent can cause damage.
- 5) Insert Type B T8 LED lamps.
- 6) Turn power on and check for proper operation.

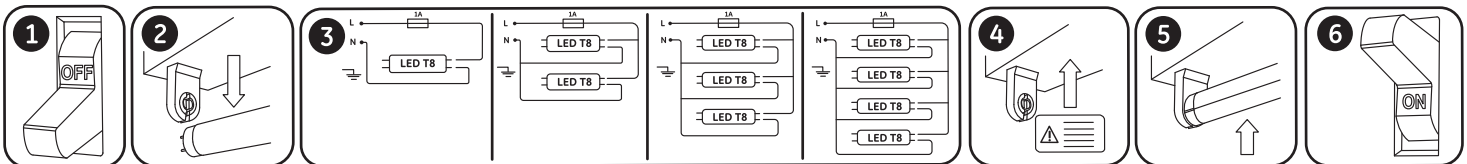

This lamp is designed for general lighting service. This lamp may not be suitable for use in all applications where a traditional fluorescent lamp has been used.

This device complies with Part 15 of the FCC Rules. Operation is subject to the following two conditions: (1) This device may not cause harmful interference, and (2) this device must accept any interference received, including interference that may cause undesired operation. This Class [A] RFLD complies with the CAN ICES-005A.

**Note:** This equipment has been tested and found to comply with the limits for a Class A digital device, pursuant to part 15 of the FCC Rules. These limits are designed to provide reasonable protection against harmful interference when the equipment is operated in a commercial environment. This equipment generates, uses, and can radiate radio frequency energy and, if not installed and used in accordance with the instruction manual, may cause harmful interference to radio communications. Operation of this equipment in a residential area is likely to cause harmful interference in which case the user will be required to correct the interference at his own expense.

