

SHELFTRACK® with **SUPERSLIDE®**

Choose Your Hardware

- | | |
|---------------------|-----------------------------|
| A Hang Track | D Closet Rod |
| B Standard | E Closet Rod Support |
| C Bracket | F Closet Rod Cap |
| | G Shelf End Cap |

SHELFTRACK® INSTALLATION TIPS

1. USE THE CORRECT HARDWARE

Select the hardware that is right for your wall type:

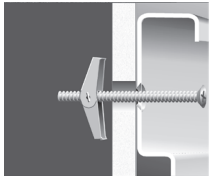

Drywall
Drill 1/2 in. holes and secure to the wall with toggle bolts.

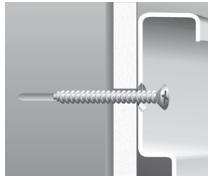

Studs
Secure to the wall with #12 x 2 in. pan head screws at stud locations.

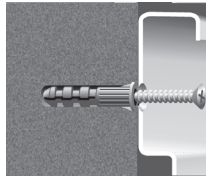

Concrete
Drill 1/4 in. holes. insert #12 wall anchors and secure to the wall with #12 x 2 in. pan head screws.

2. HANG TRACK LOCATION

Track can be installed at any height. However, for maximum adjustability and strongest installation, install track flush to ceiling and screw into wood header behind wallboard. Stud installation is recommended whenever possible for the strongest installation.

3. DETERMINE LENGTH AND SPACING OF STANDARDS

Standards are available in several lengths, depending on the number of shelves you want and the spacing between the shelves. The closer the standards are placed together, the stronger the installation. Standards should be spaced no more than 24 in. apart, and no more than 4 in. from the end of the shelf.

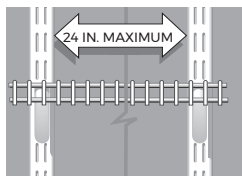

4. SECURING STANDARDS

Each standard must be secured to the wall with one screw at the closest hole to the center of the standards. When using toggle bolts, remove toggle, put bolt through standard and re-attach toggle to bolt before placing standard on track.



5. ATTACHING BRACKETS

Attach brackets at desired shelf height.

NOTE: Always match bracket size to shelving depth except when using Shelf & Rod shelving. Always use 12 in. brackets for this type of shelving. When installing 16 in. SuperSlide® with Closet Rod & Support always use 12 in. brackets.

6. CUTTING SHELVING, CLOSET RODS, AND HANG TRACKS

Wire shelving can be cut using a bolt cutter or hacksaw. Closet rods can be cut using a pipe cutter (recommended) or a hacksaw. Hang tracks can be cut with a hacksaw.

7. CORNERS

When two shelves come together in a corner, use a corner shelf support to connect them. Use a corner closet rod to allow clothes to slide uninterrupted around corners.

Note: SuperSlide® Closet rod supports should be placed where closet rods join.



8. END CAPS

Add caps to every exposed wire on both ends of each shelf and to the ends of closet rods. End caps protect you, your clothing and the shelving materials.

ClosetMaid SuperSlide® shelf system is manufactured by ClosetMaid LLC., Orlando, Florida. Manufacturer reserves the right to change specifications without notice.