

EUC50R UNDERCOUNTER REFRIGERATOR

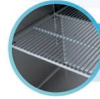

Shelves

Wire shelves to maximize storage needs.



Temperature

33-41°F with digital controller. Auto-defrost prevents ice build-up.



Casters

For easy moving around. Front locking to stay put.

TECHNICAL SPECIFICATIONS

Voltage/Frequency
110V/60Hz
Compressor Power (HP)
1/5

Interior Material
Stainless Steel
Exterior Material
Stainless Steel

Temperature Range °F
33 ~ 41°F
Refrigerant
R290
NEMA Config.
NEMA5-1SP



Back mount compressor for easy servicing and cleaning.



R290 Propane Refrigerant recommended for restaurants and businesses by the EPA.



Self-closing doors with click-to-stay open.



* Limited 1-year parts and labor warranty for commercial use only. Warranty null and void if used and installed in residential homes or garages.

CONTACT US

310-400-6395

INFO@ELITEKITCHEN.US
WWW.ELITEKITCHEN.US

MODEL EUC50R

DETAILS & SPECIFICATIONS



Rated Voltage	110V
Rated Frequency	60Hz
Total Input Power	225W
Total Current	2.4A
Total Capacity	12.21 cu ft
Climatic Category	4-5
Protection Type	I
Design Pressure High Side	300 PSIG
Design Pressure Low Side	150 PSIG
Insulation Blowing Gas	C-Pentane
Refrigerant	R290/3.17 oz

Front

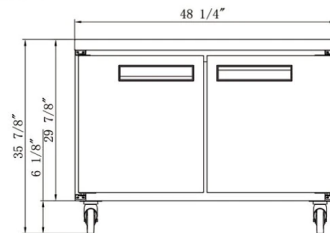

Side

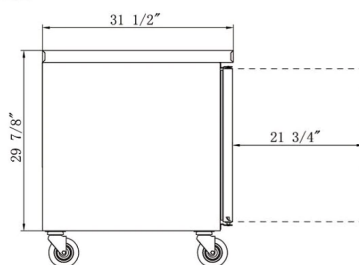

EUC50R

External Dimension
48 1/8 x 31 1/2 x 36

Packaging Dimension
49 5/8 x 33 1/8 x 39 3/8

Product Weight
237 lbs

of Shelves
2

40HQ Container Cert.
46

* Measurements presented in pounds and inches



NOTICE

For business and commercial use only. Not for use in residential homes, basements, or garages.



310-400-6395
INFO@ELITEKITCHEN.US
WWW.ELITEKITCHEN.US