

1660.610 Shown

MODEL NUMBER:

- ☐ **1660.660** 6" Traditional Rain Showerhead Only
- ☐ **1660.680** 8" Traditional Rain Showerhead Only
- ☐ **1660.610** 10" Traditional Rain Showerhead Only

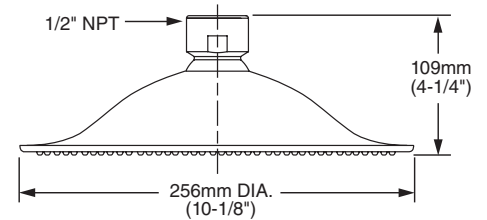
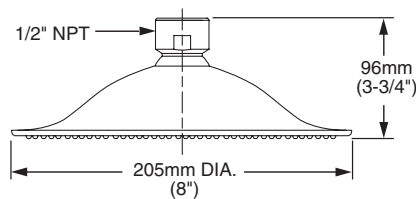
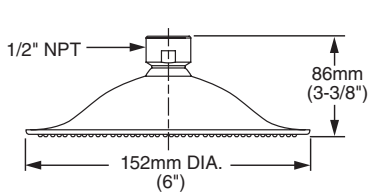

GENERAL DESCRIPTION:

Rain showerhead. Brass construction. Drenching rain spray pattern. Brass ball joint. Easy clean spray nozzles. 1/2" NPT connection. 2.5gpm/9.5L/min. maximum flow rate.

PRODUCT FEATURES:

Drenching Rain Spray Pattern: Gives the user a drenching shower similar to a rain downpour.

Brass Construction: Durable. Easy to clean. Ideal for prolonged contact with water.

Easy Clean Spray Nozzles: Easily clean lime and calcium buildup. Nozzles will not clog.

SUGGESTED SPECIFICATION

Showerhead shall have rain spray pattern and brass ball joint. Fitting shall be American Standard Model # 1660.6__.

CODES AND STANDARDS

These products meet or exceed the following codes and standards:

ASME A112.18.1
CSA 125.1

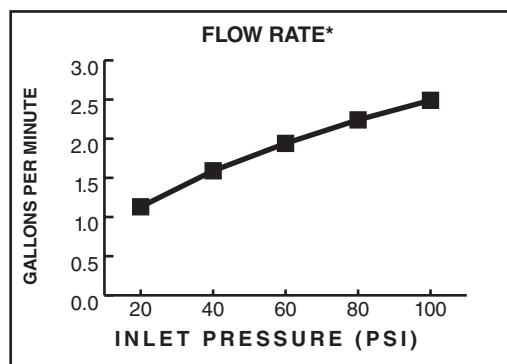

Product Number	Description	Finish Options		
		Polished Chrome	Oil Rubbed Bronze	PVD Satin Nickel
		002	224	295
1660.660	6" Rain Showerhead Only			
1660.680	8" Rain Showerhead Only			
1660.610	10" Rain Showerhead Only			

Showerhead Accessories	
Product Number	Description
1660.190	12" Ceiling Mount Shower Arm 
1660.194	12" Wall Mount Right Angle Shower Arm 
1660.198	12" Shepherd's Crook Shower Arm 
1660.191	Square Shower Arm Escutcheon 