



W-J1105-ROB8 Dual Outlet Water Purifier

User Manual

Contents

Precautions - - - - -	01	Installation Steps - - - - -	04
Product Introduction - - - - -	02	Filter Replacement - - - - -	05
Main Water-contacting Parts and Materials- -	02	Declaration of Hazardous Substances - - - -	05
Water Purification Process Flowchart - - - -	02	After-sales Service Record - - - - -	05
Electric Control Schematic Diagram - - - - -	03	Repair Guide - - - - -	06
Specifications - - - - -	03	Warranty Card - - - - -	07
Packing List - - - - -	03		

Precautions

Due to the hydrophilic nature of the RO membrane and the moisturizing ingredients (mainly food grade glycerin), it is suggested that the water faucet be opened every 2 hours after installation to drain the water for 5 minutes and repeat this operation for more than 10 times to fully ensure the taste and activate the performance of the membrane. Run the purifier on the first day of installation if possible. The water produced initially may not taste pleasant, but can be used for kitchen cleaning.

Please be sure to follow the precautions below, which are important to avoid danger and injury.

Note

- ◆ Please read this manual carefully before using your purifier, and keep the manual properly for future reference.
- ◆ For normal operation of this purifier, please use it at an ambient temperature of 4–40°C in an indoor location out of direct sunlight.
- ◆ Please disconnect the power plug if you will not use the purifier for a long time.
- ◆ The purifier should be placed vertically, but not upside down.
- ◆ In areas where the water supply pressure is higher than 0.4 MPa, please install a pressure reducing valve at the water inlet.
- ◆ When the water supply pressure is lower than 0.15MPa, the machine noise may be slightly louder.
- ◆ It takes a few seconds for water to come out after the pure water faucet is opened. Pure water may contain some bubbles.
- ◆ After expiration, the filters need to be replaced by Angel's professional after-sales personnel before the purifier can be used normally.
- ◆ This device must be installed and debugged by Angel after-sales service personnel. Before installation, please verify that the accompanying accessories in the packing box are sufficient and complete.
- ◆ If it has not been used for 72 hours, please force flush the whole device and prepare fresh water again. If the water prepared 1 day ago tastes unpleasant, it is suggested that 500ml of water be drained.

Warning

- ◆ The water inlet temperature must not be higher than 38°C or lower than 5°C; otherwise, the RO membrane will be damaged.
- ◆ Do not block the flushing port when the purifier is in operation to avoid damage to your purifier.
- ◆ Waste water is not drinkable but can be used for cleaning.
- ◆ This device uses an external power adapter. If the power adapter is damaged, to ensure safety, you must buy a new one from the manufacturer or its maintenance department for replacement.
- ◆ To ensure safety, please do not disassemble, repair or debug this device by yourself. In case of any abnormality, please contact after-sales service for maintenance.
- ◆ Damaged power cords must be replaced by professionals from the manufacturer, its maintenance department or similar departments to ensure safety.

Product Introduction

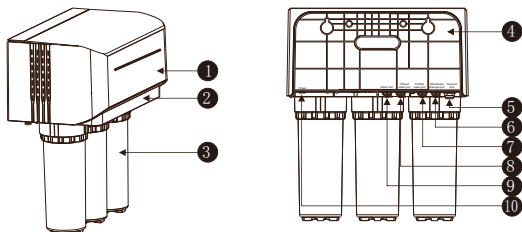

S/N	Name	S/N	Name	S/N	Name
1	Protective housing	5	Pressure tank port	9	Water inlet
2	Hanger	6	Wastewater drainage port	10	Power
3	Filter housing	7	Purified water port		
4	Hanger	8	Filtered water port		

Main Water-contacting Parts and Materials

Part name	Material	Specifications or model	Quantity	Recommended service life
Ultrafiltration membrane filter	PP	LX-101UF180	1	2 years
PP cotton filter	PP melt blown cloth	ϕ 2.5*10.0inch	1	3 months
Activated carbon filter	Nut shell activated carbon	ϕ 3.0*10.0inch	1	6 months
Spiral-wound RO membrane component	Polyamide	ϕ 2.5*10.0inch 0.0001 μ m	1	2 years
Activated carbon filter (rear)	Activated carbon	LX-201GAC180	1	6 months
PP filter housing	PP	ϕ 4.6x10.7inch	3	5 years
		ϕ 2.4x13.5inch	1	

(1) The service life of the filter element is estimated based on the average daily pure water consumption of 20L in ordinary households and the following raw water conditions:

water temperature: 41–100.4°F; water pressure: 14.5–58.2psi; pH: 7.5±0.5; turbidity: <1.0NTU; total dissolved solids (TDS): ≤500mg/L; TOC: ≤1.0mg/L. Other indicators meet the GB 5749 standard.

(2) To ensure the performance of the water purifier, the filter should be replaced regularly to ensure the quality of purified water. The service life of the filter varies depending on the raw water temperature, water pressure, water quality, pure water consumption, and operating environment. The filter should be replaced according to the actual condition.

Water Purification Process Flowchart

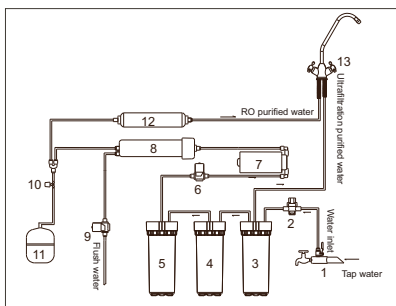

S/N	Name
1	Water inlet three-way ball valve
2	Relief valve
3	Ultrafiltration membrane filter
4	PP cotton filter
5	Activated carbon filter
6	Water inlet valve
7	Booster pump
8	Spiral-wound RO membrane component
9	Combination flush valve
10	High-pressure switch
11	Pressure tank
12	Activated carbon filter (rear)
13	Water purifier faucet

Note: The above figure is a schematic diagram of the purification system for reference only. The actual device is subject to change.

Electric Control Schematic Diagram

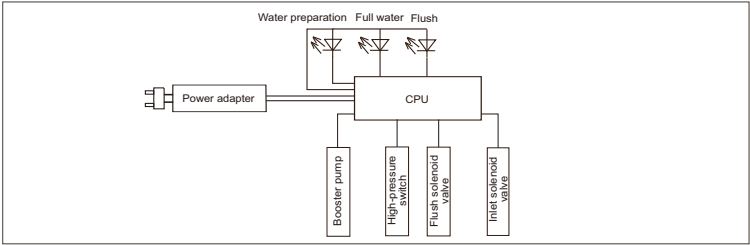

Note: The control button is subject to that on the actual product.

Specifications

Model	J1105-ROB8
Suitable water source	Tap water
Suitable water temperature	41°F ~ 100.4°F
Working temperature	39.2°F ~ 104°F
Water inlet pressure	14.5psi~58. 0psi
Working pressure (purified water)	58.0psi~87. 0psi
Working pressure (filtered water)	14.5psi~58. 0psi
Rated voltage	220V~
Rated frequency	50Hz
Rated power	30W
Type of protection against electric shock	Class II
Filtered water flow	13.2gal/h
Purified water flow	1.72gal/h
Rated total water purification volume (filtered water)	439.9gal
Rated total water purification volume (purified water)	439.9gal
Water production rate	45%
Precautions	Clean and replace the filter regularly

Packing List

Name	Unit	Quantity	Name	Unit	Quantity
Water purifier	set	1	User Manual	pcs	1
Water purifier faucet	package	1	Accessories kit	set	1
PE tube	set	1	Power adapter	pcs	1
Pressure tank	pcs	1	Seal rings	set	1

Installation Steps

After purchasing this device, an appointment can be made with our professional personnel for installation and debugging. Before installation, please make sure that sufficient and complete accessories are included in the package.

Figure 1

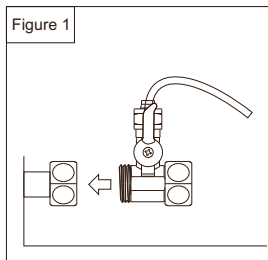

I. Install the three-way ball valve (see Figure 1)

1. Take out the three-way ball valve from the accessory box in the carton.
2. Close the water inlet valve and remove the connector (faucet or angle valve, etc.).
3. Connect the water inlet three-way valve and the ball valve (note that the threaded connection should be sealed with padding material and seal ring).
4. Reconnect the original water pipe.
5. Connect the PE pipe to the water outlet of the three-way ball valve, and reserve a certain length of the PE pipe.

II. Install the faucet (see Figure 2-3)

1. Confirm the installation position of the water purifier faucet and drill a hole (skip this step if the faucet installation hole has been reserved and the size meets the requirement).
2. Fix the faucet in the installation position. Ensure that the faucet base does not rotate, and the platform and the water pipe connections do not leak.
3. Connect the faucet of the water purifier with a PE pipe as shown in Figure 2, and reserve a certain length of the pipe.

Note: If the user wants to install the faucet of the water purifier on the wall, holes can be drilled at the location specified by the user according to the holes of the faucet hanger.

III. Connect the water lines and power supply (see Figure 4)

1. At the mounting position of the water purifier specified by the user, drill holes according to the hole positions shown in Figure 5, and then install and fix the water purifier (see Figure 5).
2. Connect the PE pipe from the three-way ball valve to the water inlet of the water purifier, and the water pipe should be connected securely in place to avoid water leakage.
3. Place the pressure tank reasonably according to the actual situation. First connect the straight push connector to the pressure tank, and then use the PE pipe to pass through the pipe clamp and connect the quick connector. A length of pipe section must be reserved, and connect the other end to the pressure tank port of the main unit.
4. Connect the wastewater drainage port of the water purifier to the sewage outlet designated by the user with a PE pipe.

Note: Do not install any valve on the waste water pipe.

5. Connect the other end of the PE pipe from the faucet to the purified water port and filtered water port of the water purifier.
6. Connect the power supply. First, connect the power adapter to the power interface of the water purifier, and then insert the power plug of the water purifier into the socket.

IV. Inspection and debugging

1. Close the pressure tank pipe clamp. Open the faucet and the water inlet ball valve of the water purifier to start working. It will start automatic flushing, and water is drained via the waste water pipe. After about 10 seconds, the flushing is over and water production is automatically started. Now, purified water flows out directly from the faucet through the stages of filters.
2. Stop the faucet for inspection. Turn off the faucet switch of the water purifier to stop the operation, and the waste water pipe will stop draining.
3. Pipeline inspection. During the trial operation, check the parts, components, and connections for leak and looseness.
4. Cleaning up. Arrange and secure the incoming and outgoing water pipes and waste water pipe, and clean up the site.
5. Flushing. When installing the purifier for the first time or replacing a new RO filter, after the water purifier is full with purified water, turn on the faucet to drain the first three tanks of water, let the fourth full tank of water stand for 2 hours, and then turn on the faucet to drain the water to ensure the purified water is safe, healthy, and tasty.

V. Use

After flushing, you can turn on the faucet of the purifier to take water. Note:

1. The faucet must be fully opened when used; otherwise the machine will start working frequently.
2. After using the pipe clamp, the severely creased part of the folded PE pipe needs to be cut off.

Figure 2

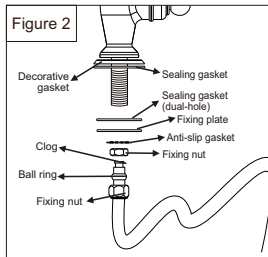

Figure 3

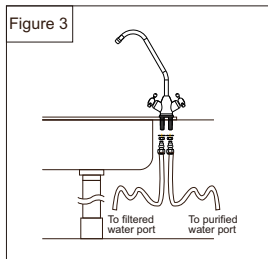

Figure 4

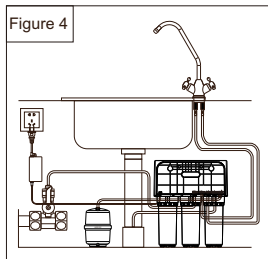

Figure 5



Filter Replacement

Please contact Angel after-sales service personnel when the filter needs to be replaced.

1. Turn off the power supply and the valve on the water inlet tee;
2. Clamp the inlet pipe of the pressure tank with a small pipe clamp to close the water pipeline of the pressure tank (as shown on the right);
3. Unplug the power cord, remove the water inlet pipe, wastewater pipe, and water outlet pipe; place the water purifier on the ground or workbench;
4. Use a special installation tool (wrench) to loosen the fastening rings on the filter housing counterclockwise;
5. Remove the used filter and replace it with a new one.
6. Tighten the filter housing and install the water purifier housing;
7. Fix the water purifier back in its original position.
8. Connect the inlet and outlet pipes and adjust the valves to the correct positions;
9. Open the water inlet valve, turn on the power, and then flush again according to the requirements.

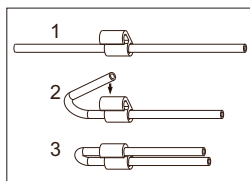

Declaration of Hazardous Substances

Part name	Hazardous substances					
	Lead (Pb)	Mercury (Hg)	Cadmium (Cd)	Chromium (Cr, VI)	Polybrominated biphenyl (PBBs)	Polybrominated diphenyl ether (PBDEs)
Circuit board	X	○	○	○	○	○
Power adapter	X	○	○	○	○	○
Accessories	X	○	○	○	○	○
Sensor	X	○	○	○	○	○
Main body	○	○	○	○	○	○
Filter	○	○	○	○	○	○
Pipeline connectors	○	○	○	○	○	○
Pressure tank	○	○	○	○	○	○

O: Indicates that this hazardous substance contained in all of the homogeneous materials for this part is below the limit requirement in GB/T 26572-2011.

X: Indicates that this hazardous substance contained in at least one of the homogeneous materials used for this part is above the limit specified in GB/T 26572-2011.

According to the electronic industry standard SJ/T11364-2014 and related regulations, this device and some internal or external components may bear an environment-friendly service life label. The service life labels on the device and the components may be different, and the service life labels on the components shall prevail over any different labels on the product.

 Power adapter  Dual Outlet Water Purifier

Repair Guide

Failure description	Cause analysis	Troubleshooting
Water purifier does not prepare water	Inlet valve is not open The pressure tank clamp is not opened Composite filter blockage RO membrane blockage The power supply is not connected Control board failure	Open the water inlet valve Open the pressure tank clamp Contact Angel after-sales service personnel to replace the filter in time Contact Angel after-sales service personnel to replace the filter in time Connect the power supply or contact Angel after-sales service personnel for repair Contact Angel after-sales service personnel for maintenance
Purifier leaks water	Damaged connector seal ring Damaged filter cartridge seal ring	Turn off the water source and contact Angel after-sales service personnel for repair Turn off the water source and contact Angel after-sales service personnel for repair
Water has an unpleasant taste or smell	Post-activated carbon filter fails The water purifier has not been used for a long time The water purifier was not flushed as required when it was installed Raw water has an unpleasant taste or smell	Contact Angel after-sales service personnel to replace the filter in time Drain the water with unpleasant taste or smell and re-prepare water Re-flush as required Confirm that the source water complies with Gb5749
Water pressure is low	Water supply pipeline leaks Pressure tank leaks	Turn off the water source and contact Angel after-sales service personnel for repair Contact Angel after-sales service personnel for repair
Waste water pipe does not drain	Inlet valve is not open Filter blockage Flush solenoid valve is damaged	Open the water inlet valve Contact Angel after-sales service personnel to replace the filter in time Contact Angel after-sales service personnel for maintenance
Wastewater pipe keeps draining	Damaged one-way valve Damaged inlet solenoid valve	Close the inlet valve and contact Angel after-sales service personnel for repair
Water purifier cannot be stopped	Severe RO membrane blockage Fatigue damage of high-pressure switch	Contact Angel after-sales service personnel to replace the filter in time Contact Angel after-sales service personnel to replace the part in time