

## ASSEMBLY INSTRUCTIONS



### CAUTION

◆ Inspect the wire insulation for any cuts, abrasions, or exposed copper that may have resulted during shipping. If there is a defect in the wire, do not attempt installation.

◆ Before starting installation of this fixture or removal of a previous fixture, disconnect the power by turning off the circuit breaker or by removing the fuse at the fuse box.



If you need further assistance, please contact us by Email: [customersupport@superiordecorinc.com](mailto:customersupport@superiordecorinc.com)

### TOOLS REQUIRED



Ladder



Safety glasses



Electrical tape



Phillips screwdriver



Flat blade screwdriver



Pliers

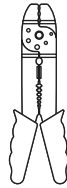

Wire strippers

### HARDWARE INCLUDED

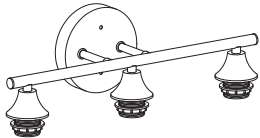

Fixture



Glass shade

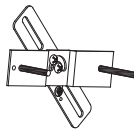

Mounting Unit



Ball Nuts



Mounting Screws



Wire Nuts

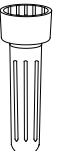

Tool

**\*PARTS SHOWN MAY DIFFER SLIGHTLY PER LIGHT FIXTURE**

### EXPLODED PARTS

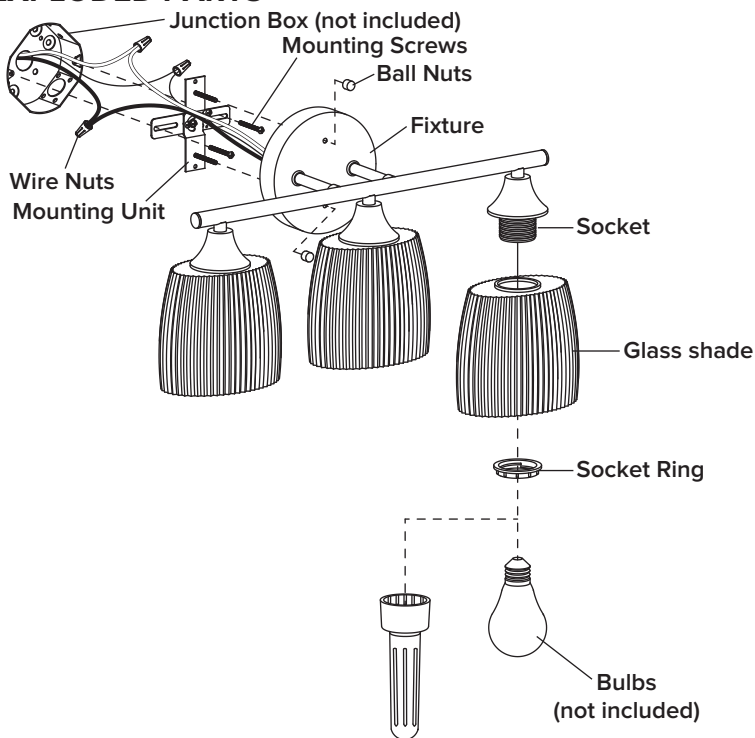

### INSTALLATION

#### STEP 1

Unscrew the **ball nuts** from the **mounting unit**. Use the **mounting screws** to attach the **mounting unit** to the junction box (not included).

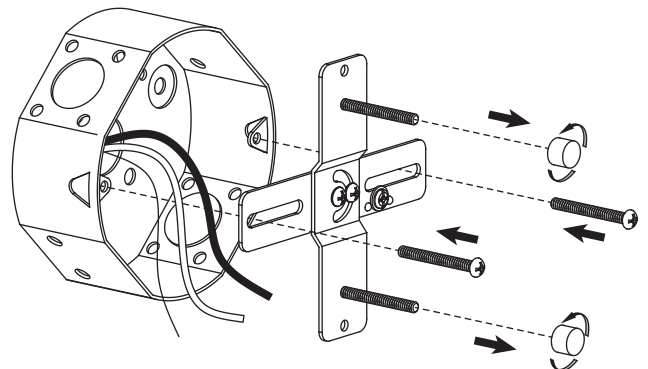

#### STEP 2

Make the electrical connection from the junction box (not included) to the **fixture**. Connect the ground wire to the **mounting unit** using the preinstalled green ground screw. Next, connect the positive, negative and ground wires with the supplied **wire nuts**. Secure with electrical tape.

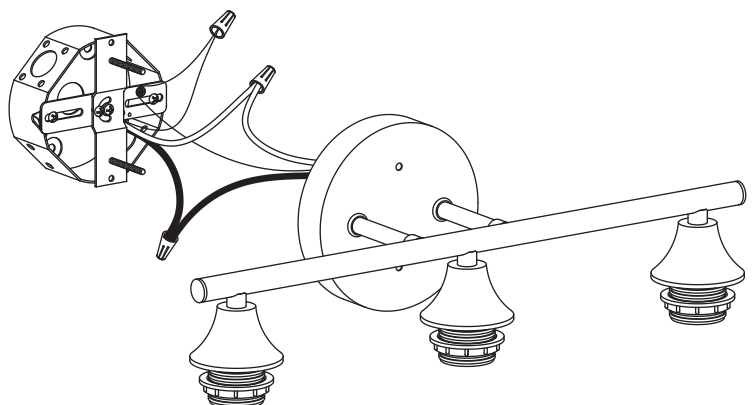
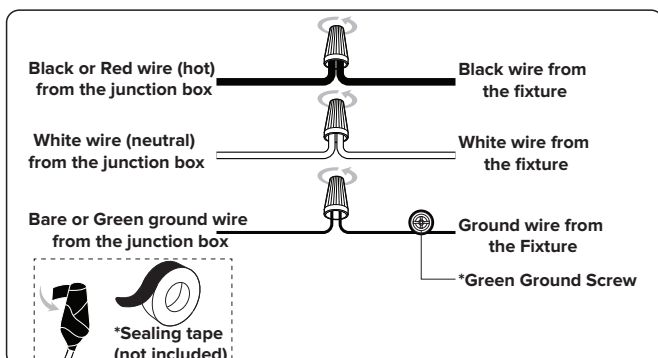

## ASSEMBLY INSTRUCTIONS (INSTALLATION)

\*junction box  
(not included)

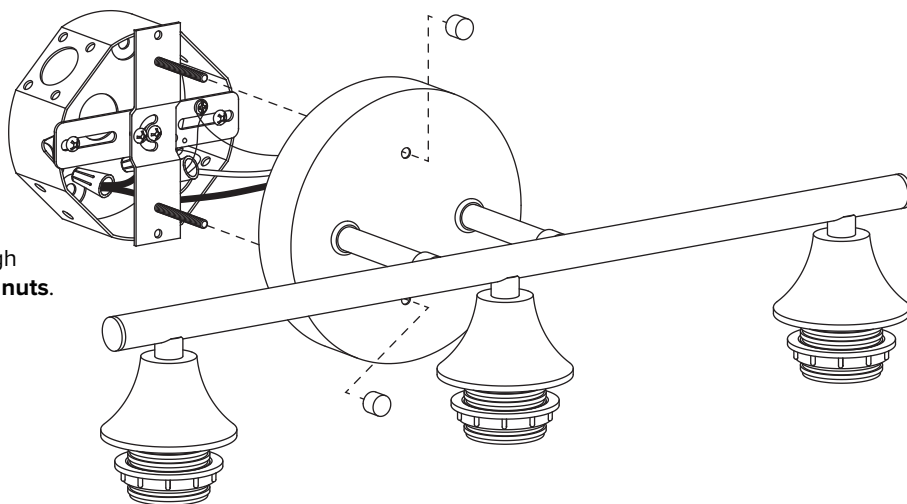

### STEP 3

Attach the **fixture** to the **mounting unit** through **screw holes** as shown, and secure it with **ball nuts**.

### STEP 4

Remove the **socket rings** from the socket.  
Insert **socket rings** into the tool.  
Put the **glass shade** to the socket of the **fixture**, screw **socket rings** onto the socket using the **tool** to secure the **glass shades**.

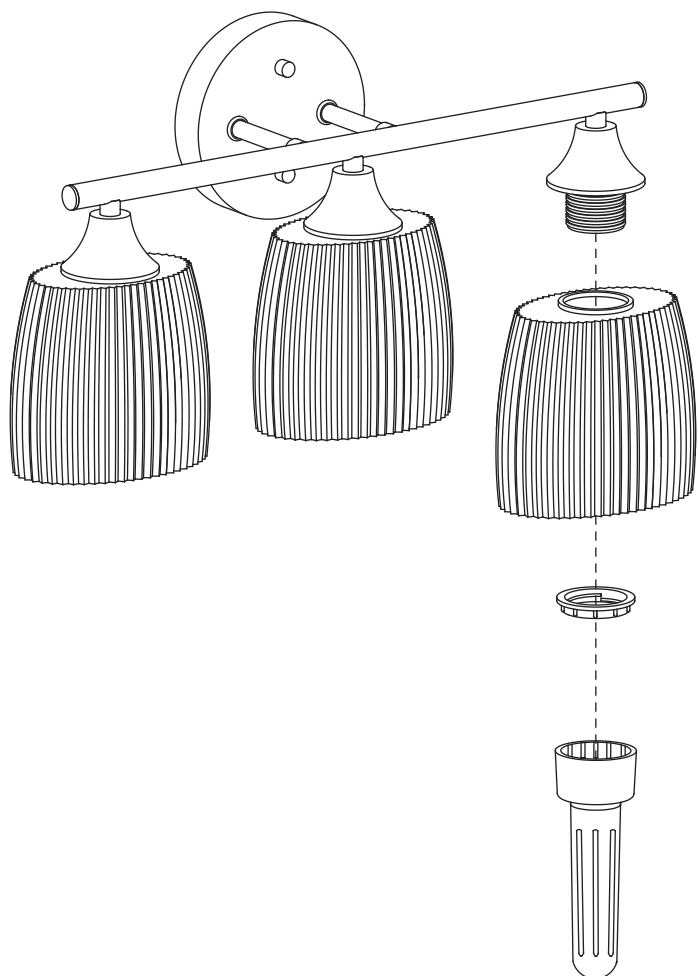

### STEP 5

Install bulbs (not included).

