

LED MIRROR WITH ANTI-FOG PAD

MODEL 75-011

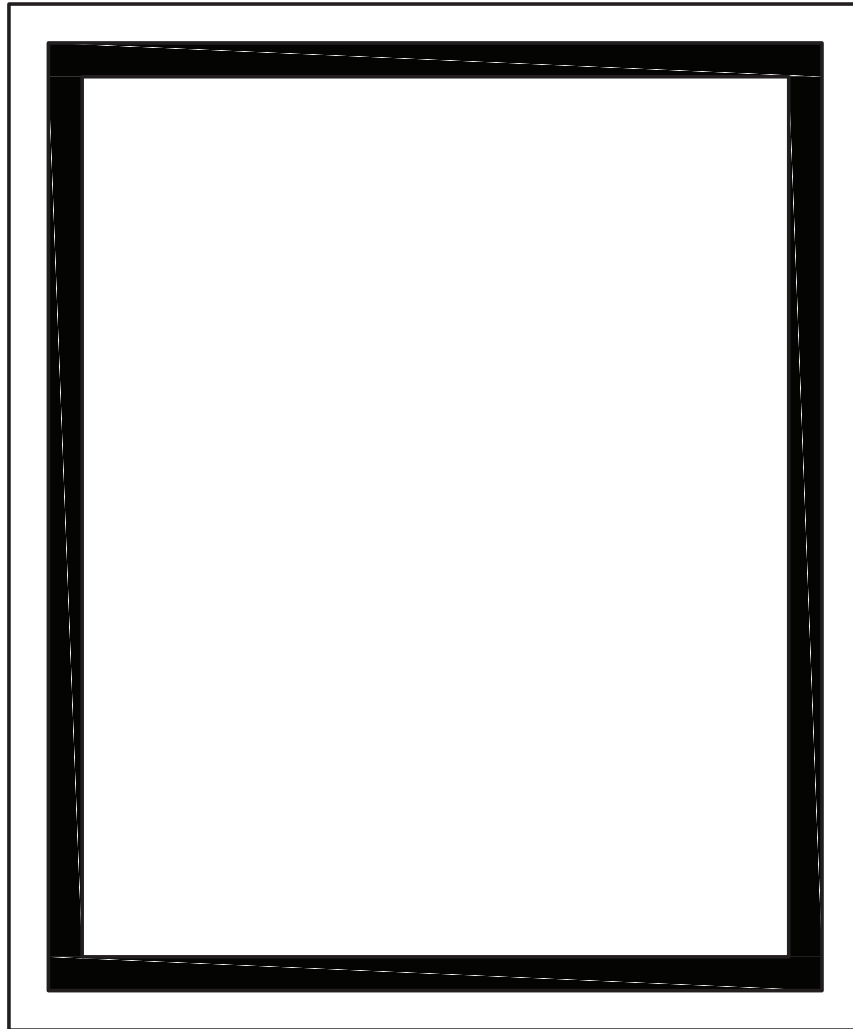

Questions, problems, missing parts? Before returning to your retailer, call our customer service department at 1-877-319-3757, 7:30 a.m. - 4:30 p.m., CST, Monday - Friday.

READ AND SAVE THESE INSTRUCTIONS

TABLE OF CONTENTS

Preparation 2

Safety Information 2

Package and Hardware Contents..... 2

Recommended Tools..... 3

Wiring Diagram..... 3

Cord Placement..... 3

Installation Instructions..... 3

Operating Instructions 4

Care and Maintenance 4

PREPARATION

Before beginning installation of product, make sure all parts are present. Compare parts with package contents list and hardware contents. If any part is missing or damaged, do not attempt to install the product. Contact customer service for replacement parts at 847-319-3757.

SAFETY INFORMATION

- Please read and understand this entire manual before attempting to assemble, operate or install the product.
- 1. Always disconnect the power supply prior to installing, servicing or removing the LED mirror.
 - 2. Installation work must be carried out by a qualified person(s) in accordance to all local and safety codes including the rules for fire rated construction.
 - 3. Follow all local building, safety and electrical codes as well as NEC (National Electrical Code) and OSHA (Occupational Safety and Health Act).
 - 4. Electric service supply must be 120 volts, 60 hertz.
 - 5. This unit must be properly grounded.
 - 6. Do not bend or kink the power wires.
 - 7. Exercise care to not damage existing wiring when cutting or drilling into walls or ceilings.
 - 8. Avoid putting sharp or hard objects against mirror surface. Damage and/or electrical injury may occur if punctured.
 - 9. Turn product off during storms or power surge scenarios as power surges may damage internal components.

PACKAGE AND HARDWARE CONTENTS

PART	DESCRIPTION	QTY
A	LED mirror	1
B	Wall anchors	4
C	Screws	4
D	Wire connectors	3

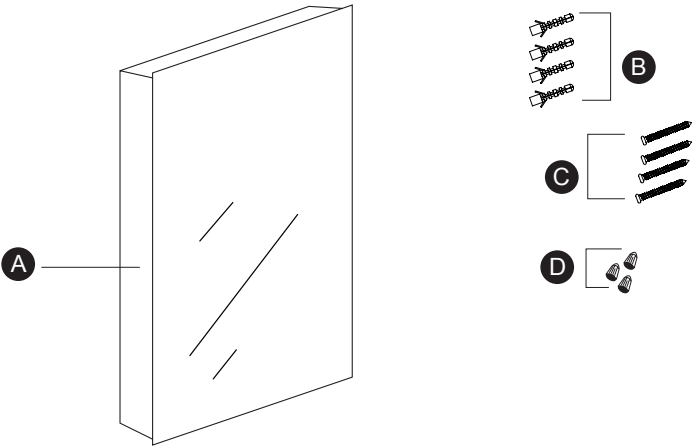

RECOMMENDED TOOLS (NOT INCLUDED)



Safety goggles



Tape measure



Phillips Screwdriver



Electric drill and drill bits



Level



Pencil



Hammer



Electrical tape

2

www.homeworksww.com

WIRING DIAGRAM

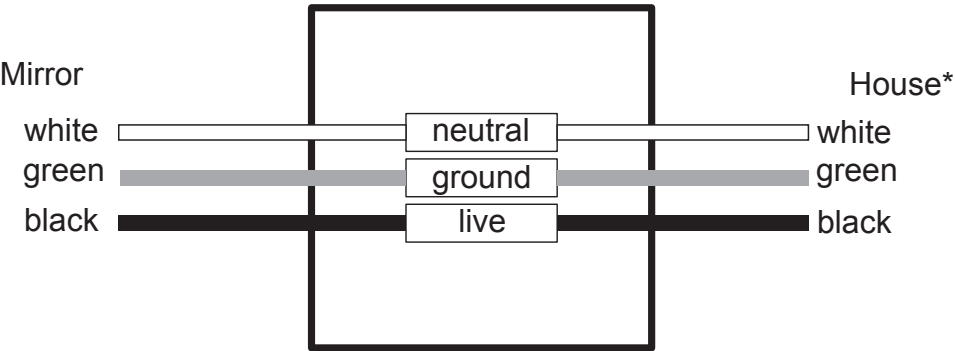

Installations may vary depending on how the previous mirror was installed and the presence of a power source. Supplies necessary for installation of your new mirror are not all included; however, most are available at your local home improvement or hardware store.

*House wires may vary in color. Please be sure to verify actual house wires with a certified electrician before installation.

CORD PLACEMENT

Item #	Size (in.) H x W	A (in.)	B (in.)	Wire Length (in.)
75-001	24 x 30	10.4	8.74	35.4

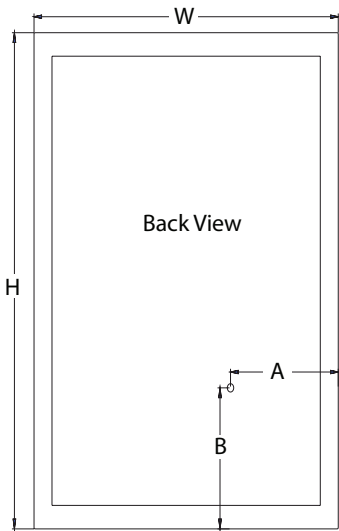

INSTALLATION INSTRUCTIONS

NOTE: Turn off power at circuit breaker or remove fuse before attempting installation.

1. Choose to mount your mirror in either a vertical (1-A) or horizontal (1-B) orientation. When orientation is chosen, measure the distance between the keyholes in the bracket as in vertical (1-A) or horizontal (1-B) orientation.
2. After measuring the distance between the keyholes on the mirror, mark mounting points on the wall in the appropriate spots (same distance apart as measured in step 1), as in 2-A or 2-B. Use a level to ensure that the points are straight.

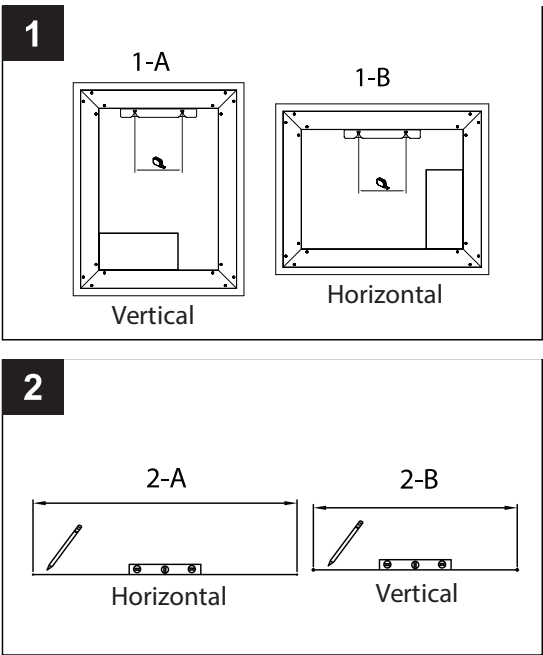

INSTALLATION INSTRUCTIONS

- Using a 7/32 in. drill bit (not included), drill holes that where marked in step 2 and insert included wall anchors.

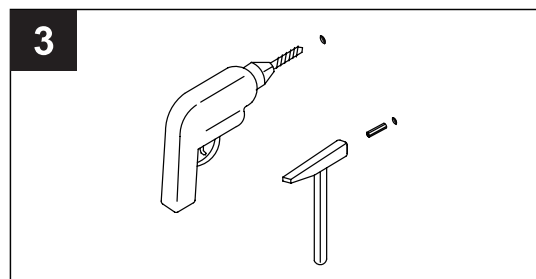

- Screw included screws into the wall anchors, leaving 3/8 in. space between the screw head and the wall.

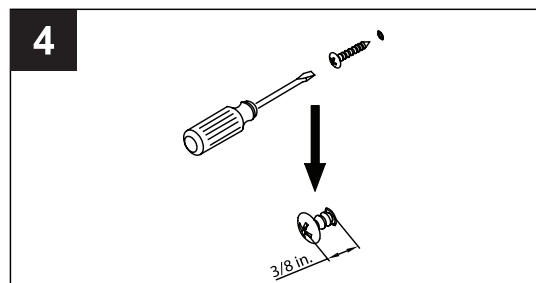

- Follow all local electrical codes and consult a qualified electrician. Check that the black, white and green wires are all exposed from the mirror. Connect the white wire on the mirror to the house white wire. Connect the black wire on the mirror to the black house wire. Connect the green ground wire on the mirror to the appropriate house ground wire.

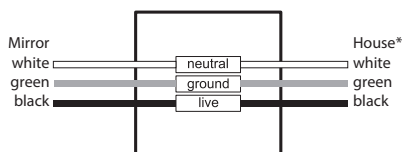

*House wires may vary in color. Please be sure to verify actual house wires with a certified electrician before installation.

- Insert the screw heads into the keyholes on the bracket then carefully let the mirror drop down so that the screw heads move into the small sections of the keyholes, securing the mirror in place.

Turn power back on at circuit breaker or replace fuse.

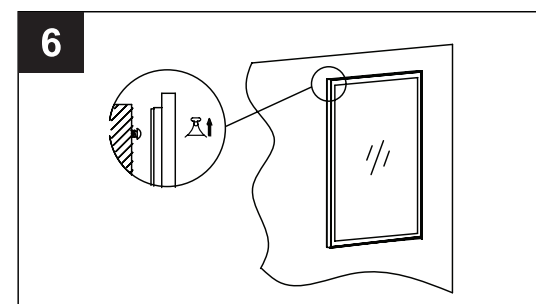
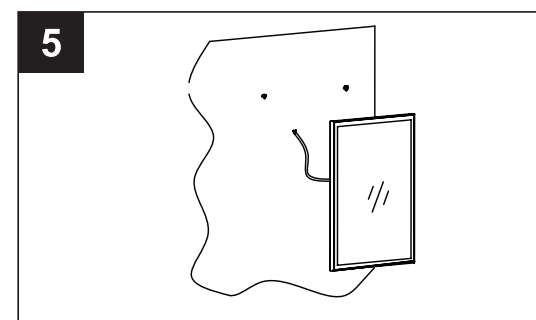

OPERATING INSTRUCTIONS

Turn on wall switch to turn light and defogger pad on.

NOTE: The defogger pad will only work when light is on. The defogger pad and light cannot be wired separately.

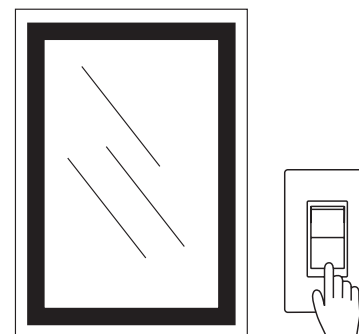

CARE AND MAINTENANCE

Clean periodically with a soft cloth and glass cleaner. Avoid spraying glass cleaner directly onto mirror. Avoid abrasive cleaners and harsh chemicals as they may damage the surface of the product.