

DREO | Ceiling Fan CLF513

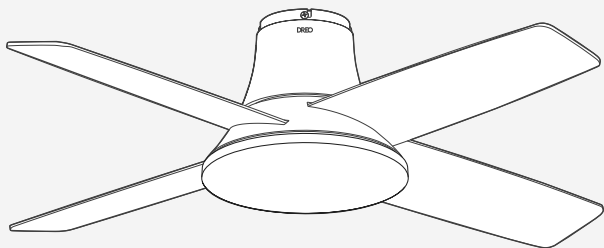

USER MANUAL

Thanks for Choosing

DREO!

Your support means the world to us.

We hope you enjoy our product as much as we did creating it.

CONTENTS

01 IMPORTANT SAFETY INSTRUCTIONS	1-2
02 PACKAGE CONTENTS	3
03 BEFORE INSTALLATION	4
04 ASSEMBLING THE CEILING BRACKET	5-6
05 HANGING YOUR CEILING FAN	7-8
06 ASSEMBLING THE BLADES	9
07 ASSEMBLING THE LIGHT KIT	10
08 USING YOUR CEILING FAN	11-14
09 CLEANING AND MAINTENANCE	15
10 TROUBLESHOOTING	16
11 DREO CUSTOMER CARE	17

IMPORTANT SAFETY INSTRUCTIONS

01

READ AND SAVE THESE INSTRUCTIONS

- 1. WARNING:** To Reduce The Risk Of Fire, Electric Shock, Or Personal Injury, Mount Directly To A Structural Framing Member Or To An Outlet Box Marked Acceptable for Fan Support of 15.9 kg (35 lbs). For Outlet Box Mounting, Use Mounting Screws Provided With The Outlet Box.
- To avoid possible electrical shock, before installing or servicing your fan, disconnect the power by turning off the circuit breakers to the outlet box and associated wall switch location. If you cannot lock the circuit breakers in the off position, securely fasten a prominent warning device, such as a tag, to the service panel.
- To reduce the risk of electric shock, this fan must be installed with an isolating wall control/switch.
- 4. WARNING:** To reduce the risk of personal injury, do not bend the blade brackets when installing the blade brackets, balancing the blades, or cleaning the fan. Do not insert foreign objects in between rotating fan blades.
- 5. Chemical burn hazard.** Keep batteries away from children. This remote contains a lithium button cell battery. If a new or used lithium button/coin cell battery is swallowed or enters the body, it can cause severe internal burns and can lead to death in as little as 2 hours. Always completely secure the battery compartment. If the battery compartment does not close securely, stop using the product, remove the batteries, and keep it away from children. If you think batteries might have been swallowed or placed inside any part of the body, seek immediate medical attention. Dispose of cells properly and keep away from children. Even used cells may cause injury.
- 6. Non-rechargeable batteries** are not to be recharged, Exhausted batteries are to be removed from the product.
- This appliance can be used by children aged from 8 years and above and persons with reduced physical, sensory or mental capabilities or lack of experience and knowledge if they have been given supervision or instruction concerning use of the appliance in a safe way and understand the hazards involved. Children shall not play with the appliance. Cleaning and user maintenance shall not be made by children without supervision. It is recommended that children be supervised to ensure that they are not using the appliance improperly.
- 8. WARNING:** To reduce the risk of fire or electric shock or injury to persons, do not use replacement parts that have not been recommended by the manufacturer (e.g. parts made at home using a 3D printer).
- Read all instructions and safety information before installing your new fan. Review the accompanying assembly diagrams.
- Before installing the fan, disconnect the power by removing fuses or turning off circuit breakers.
- Make sure all electrical connections comply with local law and the national electrical code. Please hire a qualified electrician or consult a do-it-yourself wiring handbook if you are unfamiliar with installing electrical wiring.
- Make sure the installation site is roomy enough to allow fan blades to rotate. There are at least seven feet from the floor to fan blades' tips.
- If you are mounting the fan on a ceiling outlet box, please use a metal outlet box. Secure the box directly to the building structure. The outlet box and its support must be able to support the rotating fan (at least 15.9 kg (35 lbs)). Do not use a plastic outlet box. Attach the mounting bracket using the ceiling outlet box's hardware.
- After installing the fan, make sure all the connections are secured so that the fan won't fall.
- Do not insert anything between fan blades while the fan is operating.
- Turn the fan off and wait for it to stop before reversing fan's rotating direction.
- 17. WARNING:** To reduce the risk of electrical shock and personal injury, do not install the fan on a sloped ceiling, and do not use this fan with any solid-state fan speed control device, or rheostat. You must install the outlet box using the two steel screws and lock washers coming with the fan.
- All wiring must be in accordance with national and local electrical codes ANSI/NFPA 70. If you are unfamiliar with wiring, use a qualified electrician.

19. After making the wire connections, the wires should be spread apart with the grounded conductor and the equipment-grounding conductor on one side of the outlet box and the ungrounded conductor on the other side of the outlet box.
20. The splices after being made should be turned upward and pushed carefully up into the outlet box.
21. Instructions for supply connections: the white conductor of a fan identified as grounded conductor to be connected to a grounded conductor of power supply, the black conductor of fan identified as ungrounded conductor to be connected to an ungrounded conductor of power supply, the green conductor of fan identified for equipment grounding to be connected to an equipment-grounding conductor.
22. The total weight of the fan install to outlet box is 5,9 kg, check that the outlet box is securely installed in place such that it is able to support at least the fan weight.
23. When mounted directly to the building structure, appliance installation shall not expose combustible material and do not install the appliance to a ceiling with combustible finish. The installation of the appliance cannot leave the wood of the rafters or any thermal insulation exposed to the interior of the room.
24. To Reduce The Risk Of Electric Shock, Disconnect The Electrical Supply Circuit To The Fan Before Installing Light Kit.

FOR HOUSEHOLD USE ONLY

Gentle Reminder:



Check the appliance regularly and refer to TROUBLESHOOTING or contact our customer support if it shows any of the following signs:

- Components or parts are damaged.
- Loud noise or unusual smell.

Specifications

Model No.	DR-HCF003
Power Supply	120V 60HZ
Rated Power	50W
Remote Control Battery	CR2025 3V

PACKAGE CONTENTS

02



To ensure a successful installation,
first **SCAN** the QR code to watch the installation video.
If you need help, we also provide support at 1.888.290.1688 or visit us at www.dreo.com.

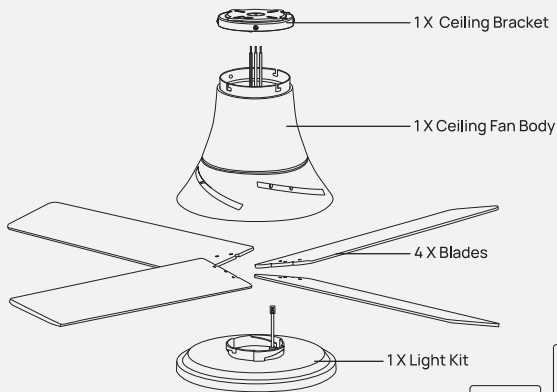

Quick Start
Guide

User Manual

1 Parts for Ceiling Bracket



2 Parts for Blades



3 Parts for Remote Control Holder

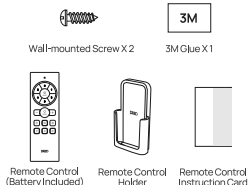

BEFORE INSTALLATION

03

TOOLS NEEDED (NOT INCLUDED)

Essential Tools for a Successful Installation:



Ladder



Phillips Screwdriver



Wire Stripper

Optional Tools:

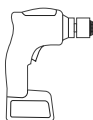

Drill



9/64" Drill Bit



! WARNING: Check the room dimensions

30 inches

from blade tip to nearest wall or obstruction

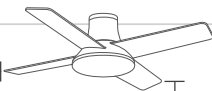

7 feet

from bottom edge of blade to the floor



! WARNING: Check the outlet box

You must be able to secure the fan to building structure or fan-rated outlet box.

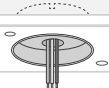

It is recommended to have a partner when installing the ceiling fan.

ASSEMBLING THE CEILING BRACKET

04



WARNING:

To prevent possible electrical shock, before installing the fan, disconnecting the power by removing fuses or turning off the circuit breakers to the outlet box associated with the wall switch location.

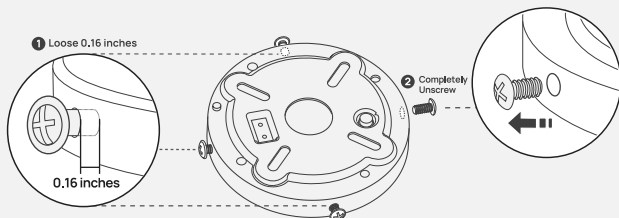

Gently **loosen** three out of the four screws on the ceiling bracket.
(keep them approximately **0.16 inches** away from the bracket)
Completely **unscrew** the remaining screw (remember to keep it safe) for later use.

Option 1:

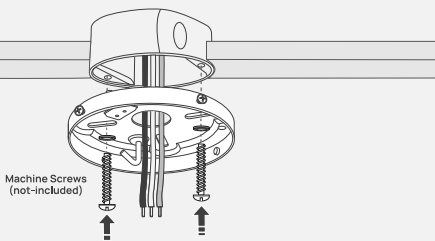

Use machine screws (If they are included in your outlet box, unscrew them and reuse them to secure the ceiling bracket) when:
Securing to **existing ceiling fan-rated outlet box**.
Make sure it is securely installed and is acceptable for fan support of 15.9 kg (35lbs) or less.

Ceiling Bracket → Hanging the Ceiling Fan → Blades → Light Kit

Option 2:

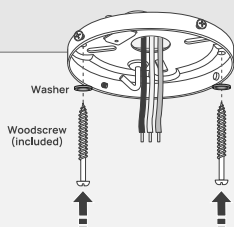

Use wood screws and washers when:

Securing to support structure with approved electrical outlet box.

Drill 9/64" pilot holes in **Support Structure** to aid in securing ceiling bracket.

Make sure to drill the holes in an horizontal line parallel to each other.

Ceiling Bracket → Hanging the Ceiling Fan → Blades → Light Kit

HANGING YOUR CEILING FAN

05



! WARNING: FAN FALL HAZARD

To prevent **SERIOUS INJURY** or **DEATH**:

- ALWAYS tighten setscrew with screwdrivers.
- DO NOT hand tighten setscrew.
- CHECK the setscrew is tight using screwdrivers each time you change fan direction.

1

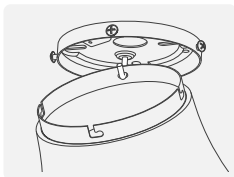
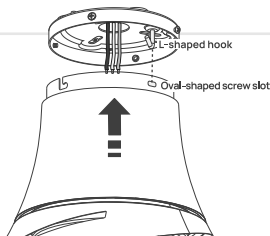

Position the ceiling fan body facing upward, align its **oval-shaped screw slot** with the **L-shaped hook** on the ceiling bracket, and hang it in place.

Release your grip once the fan is securely hung.

NOTICE: To prevent damage to fan, **ALWAYS** lift holding the fan body.

2

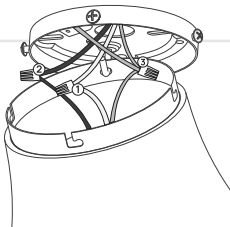

ACIN L	Black
ACIN N	White
⊕	Green

! WARNING:

The ceiling fan must be grounded. If the ground wire for the installation site is not present, immediately **STOP** installation and consult a qualified electrician. All wiring must be in accordance with national and local electrical codes ANSI/NFPA70. If you are unfamiliar with wiring or in doubt, consult a qualified electrician.

1. Connect the white (grounded) wire from the ceiling to the white wire from the fan.
2. Connect the black (ungrounded) wire from the ceiling to the black wire from the fan.
3. Connect the three grounding wires (green, green/yellow stripe, or bare copper) coming from the ceiling, downrod, and hanging bracket.

Ceiling Bracket → Hanging the Ceiling Fan → Blades → Light Kit

3

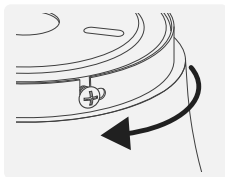
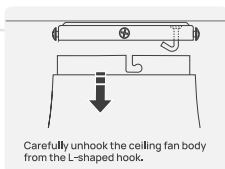
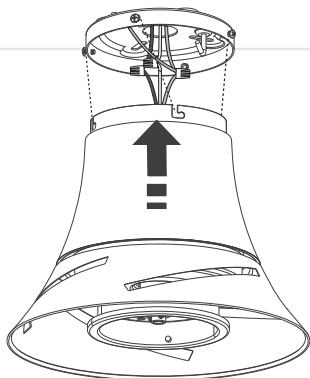

Align the three pre-loosened screws with the corresponding three L-shaped slots on the ceiling bracket. Slightly rotate counterclockwise to securely fasten them to the ceiling bracket. Ensure that every screw is firmly seated within the L-shaped slots.

4

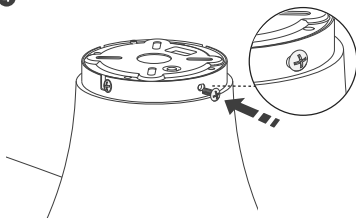

Align and secure the previously removed fourth screw with the oval-shaped slot on the ceiling bracket. Tighten the four screws in place using a screwdriver.

Ceiling Bracket → Hanging the Ceiling Fan → Blades → Light Kit

ASSEMBLING THE BLADES

06

1

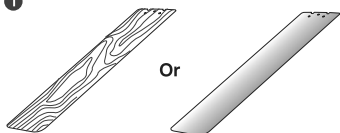

You have the freedom to select either the front or back side according to your preference.

Note: For better performance, utilize the fan blades consistently, whether using the front or reverse side.

2

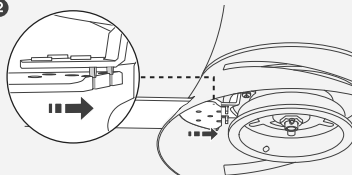

Make sure that the two blade slots align with the vertical tabs of the ceiling fan body.

3

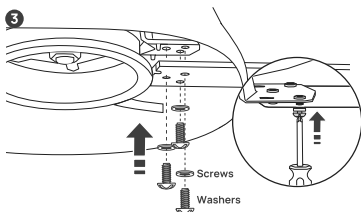

Partially insert the screws and washers into the blade's holes, and then use a screwdriver to securely tighten them.

4



Follow the above two steps to complete the assembly of the remaining three blades.

NOTE: Follow the instructions on the blade carefully. Incorrect installation could result in the fan not functioning properly.

Ceiling Bracket → Hanging the Ceiling Fan → **Blades** → Light Kit

ASSEMBLING THE LIGHT KIT

07



! WARNING: FAN FALL HAZARD

Make sure all screws are tight to secure the light fixture.

Following installation, ensure that the wide gap between the light kit and the middle ring is uniform.

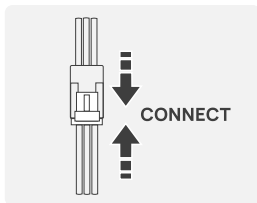
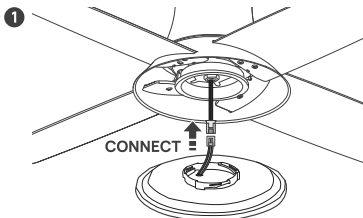

Connect the ports of the wires with matching colors from the ceiling fan body to the light kit.

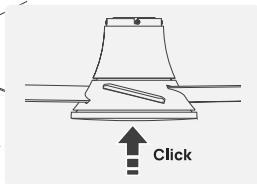
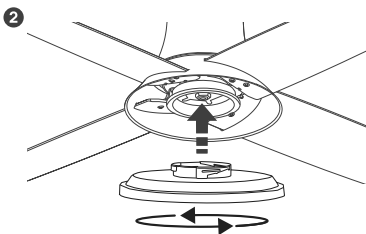

Rotate the light kit clockwise to securely fasten it into place.

Note: Make sure that you hear a distinctive "click" when fastening the light kit in place. There is approximately 3/16 inch wide gap between the middle ring and the light kit.

Ceiling Bracket → Hanging the Ceiling Fan → Blades → Light Kit



Congratulations!

You are ready to use your ceiling fan

USING YOUR CEILING FAN

08

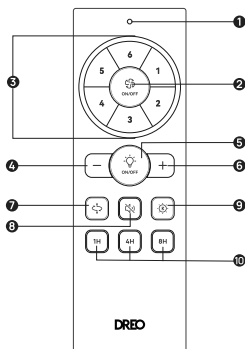

- ❶ Command Indicator
- ❷ Fan Power Button (On/Off)
- ❸ Fan Speed Settings (1 to 6)
- ❹ Decrease Brightness Button
- ❺ Light Power Button (On/Off)
- ❻ Increase Brightness Button
- ❼ Airflow Direction Button (Fan Must Be On)
- ❽ Mute Button
- ❾ Light Temperature Button
- ❿ Quick Timer Settings (1H - 4H - 8H)

Note:
When the remote control battery is low, the command indicator light will flash for a few seconds.

Remote Control Pairing

The remote control that shipped with your fan is already paired.

Note: When pairing a new remote control, you **MUST** disconnect power (at the wall switch, breaker, or fan from other ceiling fans within range) to prevent faulty operation.

Pairing a new remote control to an existing fan

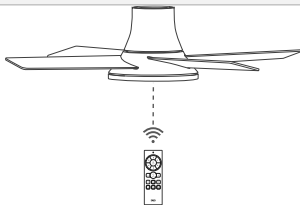

If you lose your remote control or purchase a new one, please follow the steps below to pair the control to your ceiling fan.

- Power cycle the fan by toggling the wall switch (or circuit breaker if needed). Within three minutes, long press the Light Power Button (❺) and the Fan Power Button (❷) on your remote for 3 seconds to pair it.
- If applicable, the fan will turn on the the lights will flash and stay on for three seconds, along with a continuous beep to indicate successful pairing.

Installing One Fan Operating on Multiple Remote Controls

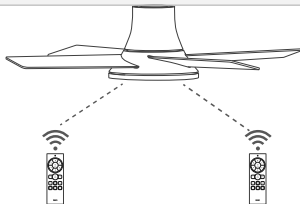

To have multiple remote controls operate one fan, you must pair each additional control to the receiver in the fan. The remote control that shipped with your fan is already paired.

- For each additional control, power cycle the fan by toggling the wall switch (or circuit breaker if needed). Within three minutes, long press the Light Power Button (⏻) and the Fan Power Button (🌀) on your remote for 3 seconds to pair it.
- If applicable, the fan will turn on and the lights will flash and stay on for three seconds, along with a continuous beep to indicate successful pairing.

Installing Multiple Fans Operating on a Single Remote Control

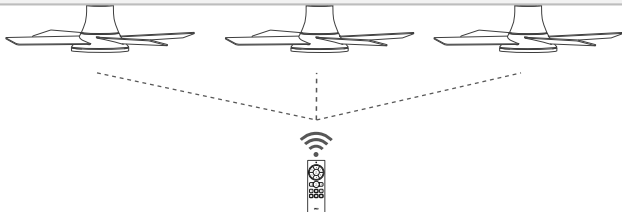

To have multiple fans operated by a single remote control, you must pair the remote control to each additional receiver. The receiver that shipped with your fan is already paired to the remote control.

- For each additional fan, ensure that a compatible receiver is installed. Disconnect power from all other fans while pairing.
- Power cycle the fan by toggling the wall switch (or circuit breaker if needed). Within three minutes, long press the Light Power Button (⏻) and the Fan Power Button (🌀) on your remote for 3 seconds to pair it.
- If applicable, the fan will turn on and the lights will flash and stay on for three seconds, along with a continuous beep to indicate successful pairing.

Battery Replacement

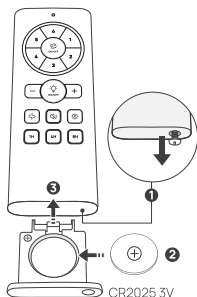

1. Unscrew the locking button with a Phillips screwdriver to remove the battery holder.

2. Replace with the same battery type with the (+) side facing up.

3. Push the holder in and tighten the screw until it is securely locked into place.

Note: If the indicator on the remote control doesn't turn on anymore, please consider replacing the battery.

WARNING

- **INGESTION HAZARD:** This product contains a button cell or coin battery.
- **DEATH** or serious injury can occur if ingested.
- A swallowed button cell or coin battery can cause Internal Chemical Burns in as little as **2 hours**.
- **KEEP** new and used batteries **OUT OF REACH OF CHILDREN**
- **Seek immediate medical attention** if a battery is suspected to be swallowed or inserted inside any part of the body.



- Remove and immediately recycle or dispose of used batteries according to local regulations and keep away from children. Do NOT dispose of batteries in household trash or incinerate.
- Even used batteries may cause severe injury or death.
- Call a local poison control center for treatment information.
- Compatible battery type: CR2025.
- Battery nominal voltage: 3.0 Vdc
- Non-rechargeable batteries are not to be recharged.
- Do not force discharge, recharge, disassemble, heat above (rated temperature: 140 °F) or incinerate. Doing so may result in injury due to venting, leakage or explosion resulting in chemical burns.
- Ensure the batteries are installed correctly according to polarity (+ and -).
- Do not mix old and new batteries, different brands or types of batteries, such as alkaline, carbon-zinc, or rechargeable batteries.
- Remove and immediately recycle or dispose of batteries from equipment not used for an extended period of time according to local regulations.
- Always completely secure the battery compartment. If the battery compartment does not close securely, stop using the product, remove the batteries, and keep them away from children.

Install the Remote Control Holder

Option 1:

1

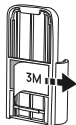

2

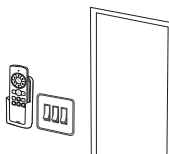
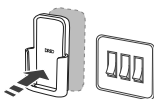

Peel off the 3M glue on the back of the holder to adhere it to the desired location.

Store your remote control.

Option 2:

1

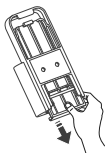

Slide the backboard downward to remove it.

2

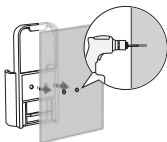

Use the two holes on the holder as a guide to drill two corresponding holes in the flat wall.

3



Align the two holes on the holder with the two holes on the wall.

4

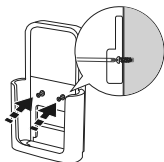

Insert the two screws into the holes and tighten them using a screwdriver.

5



Slide the backboard upward to reposition it.

6

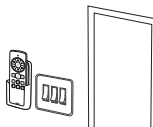

Store your remote control.

Additional Features



Memory

If the fan is turned OFF or disconnected from power, it will operate under the previous settings (except the timer setting) when it is turned ON again.

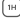
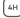
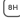

Timer

When the ceiling fan is ON/OFF, touch the timer button    on the remote control to set a timer (1H, 4H, 8H).

When the timer ends, the ceiling fan will stop/start running automatically.



Mute

Press the mute button  on the remote control to turn on/off button sounds.



Soft Light Mode

Long press the color temperature button  for 3 seconds.

CLEANING AND MAINTENANCE

09

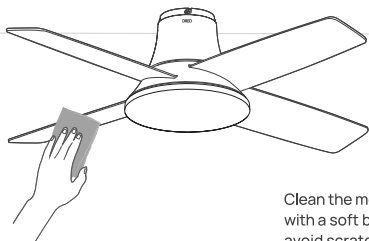

Clean the motor housing and blades with a soft brush or lint-free cloth to avoid scratching the finish.

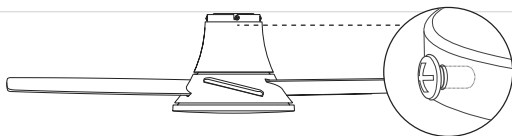

At least twice each year, lower the canopy to check the downrod assembly and tighten all screws on the fan.



- Shut off the main power supply before you begin any maintenance task.
- **DO NOT** use water or a damp cloth to clean the fan.
- Cleaning products may damage the finishes.

TROUBLESHOOTING

10

Problem	Solution
Fan Doesn't Work	<ul style="list-style-type: none">• Make sure the power switch is on.• Check the circuit breaker to ensure the power is turned on.• Make sure the blades spin freely.• Turn off the power at the circuit breaker, then loosen the screws on the ceiling bracket. Rotate the ceiling fan body clockwise and hang it on the L-shaped hook on the bracket. Check all connections according to the wiring diagram.
Excessive Wobbling	<ul style="list-style-type: none">• Make sure the blades are properly installed on the blade iron posts.• Turn the power off, support the fan carefully, and check that the screws on the ceiling bracket are properly seated.
Remote Control of Fan is Erratic	<ul style="list-style-type: none">• Make sure the battery is installed correctly.• If the command indicator light keeps flashing, indicating low battery, install a fresh battery.
Remote Only Works Close to Fan	<ul style="list-style-type: none">• Change battery
Noisy Operation	<ul style="list-style-type: none">• Make sure the blades are properly installed.• Check to see if any of the blades are cracked. If so, replace all of the blades.

If your problem is not listed or still persists,
please contact our Customer Support (see page 17)

DREO CUSTOMER CARE

11

Default 12-Month Warranty

This appliance is covered by Dreco warranty for 12 months from the date of its original purchase.

Extend Your Warranty

Extend your warranty by registering your new appliance on our website

<https://dreco.com/warranty>

The warranty will not apply in cases of:

- Accident, misuse, or repairs performed by unauthorized personnel.
- Any unit that has been tampered with or used for commercial purposes.
- Normal wear and tear of wearable parts.
- Use of force, damage caused by external influences.
- Damage caused by non-observance of the User Manual, e.g. connection to an unsuitable mains supply or noncompliance with the instructions.
- Partially or completely dismantled appliances.
- Defects caused by or resulting from damages from shipping or from repairs, service, or alteration to the product or any of its parts that have been performed by a repair person not authorized by DREO.
- We can only provide after-sales service for products that are sold by DREO or DREO authorized retailers and distributors. If you have purchased your unit from a different place, please contact your seller for return and warranty issues.

FCC STATEMENT

This device complies with Part 15 of the FCC Rules. Operation is subject to the following two conditions: (1) this device may not cause harmful interference, and (2) this device must accept any interference received, including interference that may cause undesired operation.

Please note that changes or modifications of this product is not expressly approved by the party responsible for compliance that could void the user's authority to operate the equipment.

NOTE: This equipment has been tested and found to comply with the limits for a Class B digital device, pursuant to Part 15 of the FCC Rules. These limits are designed to provide reasonable protection against harmful interference in a residential installation. This equipment generates, uses and can radiate radio frequency energy and, if not installed and used in accordance with the instructions, may cause harmful interference to radio communications. However, there is no guarantee that interference will not occur in a particular installation.

If this equipment does cause harmful interference to radio or television reception, which can be determined by turning the equipment off and on, the user is encouraged to try to correct the interference by one or more of the following measures:

- Reorient or relocate the receiving antenna.
- Increase the separation between the equipment and receiver.
- Connect the equipment into an outlet on a circuit different from that to which the receiver is connected.
- Consult the dealer or an experienced radio/TV technician for help.

Model No.: DR-HCF003
Rev_1.1_EN

We're Here to Help!

 (888) 290-1688 Mon - Fri, 9:00 am-5:00 pm PST/PDT

 support@dreco.com

 www.dreco.com

 Shenzhen Hesung Innovation Technology Co., LTD

 26F, Bldg A7, Creative City, Shenzhen, China



MADE IN CHINA



Intertek
5017816

www.dreo.com

Looking for help?

Contact us to get expert support.



support@dreo.com



[\(888\) 290-1688](tel:(888)290-1688)



www.dreo.com

Mon - Fri, 9:00am-5:00pm PST/PDT