

ELKAY[®]

SPECIFICATIONS

Harmony[®] Undermount Triple Bowl Sink Model ELUH4020

GENERAL

Highest quality sink formed of #18 (1.2mm) gauge, type 304 (18-8) nickel bearing stainless steel.

DESIGN FEATURES

Bowl Depth: 9-7/8" (251mm) (left bowl), 5" (127mm) (center), 7-7/8" (200mm) (right bowl).

Finish: Exposed surfaces are hand blended to a lustrous high lighted satin finish.

Underside: Fully protected by heavy duty Sound Guard[®] undercoating to reduce condensation and dampen sound.

OTHER

Drain Opening: 3-1/2" (89mm).

NOTE: All Elkay undermount sinks are designed to affix to the underside of any solid surface countertop.

OPTIONAL ACCESSORIES

Rinsing Baskets: LKWRB1418SS (left bowl), LKWRB1316SS (right bowl).

LKWERBSS (left and right bowl), LKWRB3717SS (center bowl)

Bottom Grids: LKWOBG1418SS (left bowl), LKWOBG1316SS (right bowl).

Cutting Boards: CBR1418, CBS1418 (left bowl), CB1613, CB1713, CBR1316, CBS1316 (right bowl), CB816, CBS715 (center bowl).

Drain: LK99

Utensil Caddy for Rinsing Basket: LKWUCSS

Mounting Clip: LKUCLIP8

Sink complies with ASME A112.19.3/ CSA B45.4



Sinks are listed by IAPMO[®] as meeting the applicable requirements of the Uniform Plumbing Code[®], International Plumbing Code[®], and National Plumbing Code of Canada.

SINK PACKAGE

MODEL	SINK	BOTTOM GRID	QTY	BOTTOM GRID	QTY	DRAIN	QTY
ELUH4020DBG	ELUH4020	LKWOBG1316SS	1	LKWOBG1418SS	1	LK99	2

SINK DIMENSIONS*

Model Number	Overall		Inside Left Bowl			Inside Center Bowl			Inside Right Bowl			Cutout in Countertop	Minimum Cabinet Size
	L	W	L	W	D	L	W	D	L	W	D		
ELUH4020	40 (1016mm)	20 1/2 (521mm)	14 (356mm)	18 (457mm)	9 7/8 (251mm)	7 1/2 (191mm)	15 3/4 (400mm)	5 (127mm)	13 1/2 (343mm)	16 (406mm)	7 7/8 (200mm)	See Template**	45 (1143mm)

*Length is left to right. Width is front to back.

**Template #1000001454 is packed with every sink.

Installation Profile of ELUH Triple Bowl Models

The template provided with each ELUH sink provides the only type of installation recommended by Elkay.

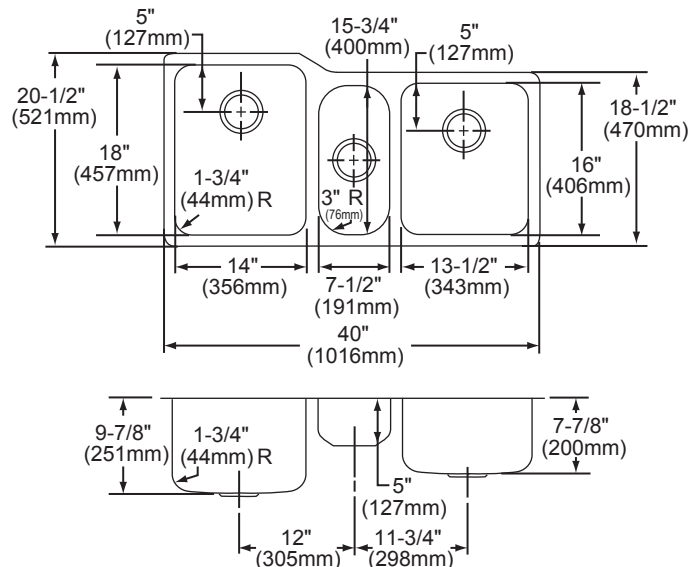
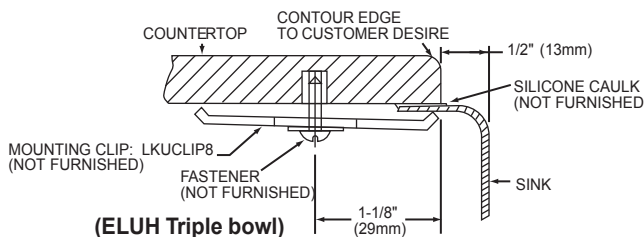

Model ELUH4020 Illustrated

In keeping with our policy of continuing product improvement, Elkay reserves the right to change product specifications without notice. Please visit elkay.com for the most current version of Elkay product specification sheets.

This specification describes an Elkay product with design, quality, and functional benefits to the user. When making a comparison of others producers offerings, be certain these features are not overlooked.