

AIRPLUS
USER MANUAL

Ultrasonic Humidifier

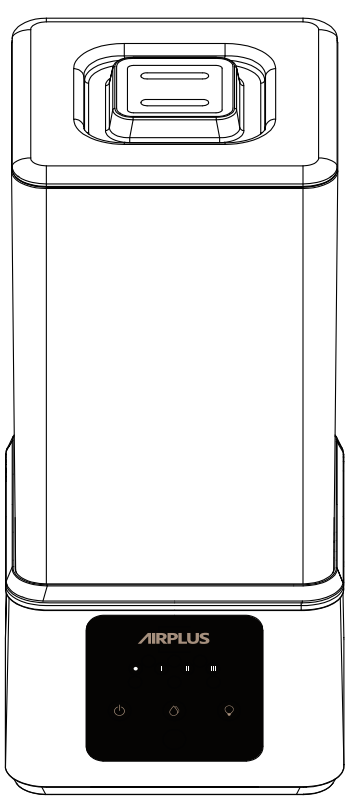

AIRPLUS

CONTENTS

SAFETY NOTICE	01-02
PARTS AND COMPONENTS	02
INSTRUCTIONS	03-05
CLEANING AND MAINTAINING	06-07
TROUBLESHOOTING	07
ABOUT WARRANTY	08



WARNINGS

This appliance can be used by children aged from 8 years and above and persons with reduced physical, sensory or mental capabilities or lack of experience and knowledge if they have been given supervision or instruction concerning use of the appliance in a safe way and understand the hazards involved. Children shall not play with the appliance. Cleaning and user maintenance shall not be made by children without supervision.

SAFETY NOTICE

Please read the instructions for this product carefully before using it. Any operation that does not conform to the contents of the specification may result in serious personal injury or damage to the product itself.



It is forbidden to place inflammable and explosive materials around the humidifier.



Do not place the humidifier near high temperature places.



Do not directly flush the humidifier with water; do not use detergents to clean the humidifier.



Please keep your hands dry when plugging in and out the power cord to avoid electric shocks. Make sure all parts are completely dry before reassembling or storing.

- If the power cord is broken, please send an email to us.airplus@gmail.com. We will send you a new replacement or a full refund.
- Do not start the machine when the water tank is dry or when the host is separated from the water tank.
- Place the humidifier on a hard horizontal surface.
- Do not add any additives, such as essential oil, into the water tank. If you need to use, please drop it on the essence cotton in the essence box.
- When the humidifier is working, do not touch the water in the water tank or parts in the water.
- Do not disassemble, refit or repair the internal parts by yourself.
- Do not climb or sit on the humidifier.
- Do not block the mist outlet, please keep the upper part of the mist outlet unblocked.
- Do not turn off the humidifier by directly pulling out the power plug.

01

AIRPLUS

ABOUT WARRANTY

Q: Do you have a warranty for this product?

A: We strictly abide by Amazon regulations which cover a full refund or a free replacement within 30 days of your purchase. Additionally, if there are any problems with this product, please always feel free to contact us at us.airplus@gmail.com and attach your Order ID to help us solve your problems more effectively. We promise our team always stands behind our product and we will try our best to offer you a better user experience.

08

When not in use for a long time:

- After shutdown, turn off the power switch and pull out the power plug.
- Pour out water in the tank; clean the host and water tank.
- Pack the humidifier in the packing box.
- Store the humidifier upright in a dry and ventilated place.

Reuse after long idle time:

- Clean the host and water tank; add proper amount of water into the water tank.
- Plug in the power cord and turn on the power switch.

Parts And Components

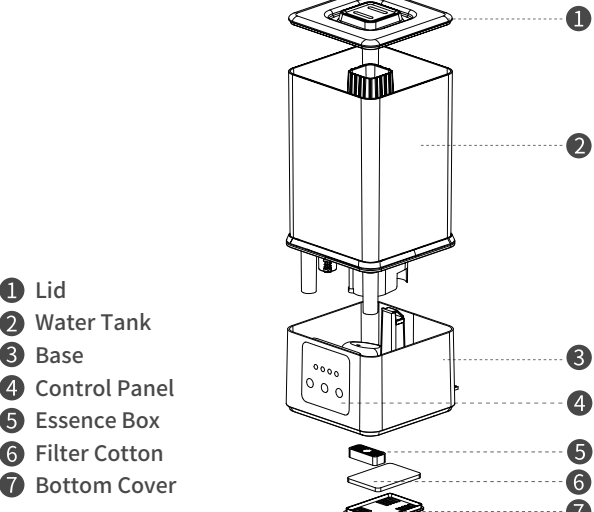

02

Troubleshooting

Issue	Possible Cause	Solution
Humidifier doesn't work	The power plug is not plugged in properly.	Plug in the power plug.
	There is no water in the water tank.	Add water into the water tank, but do not exceed the max line.
	Water tank is not in place.	Install the water tank in place.
The mist smells weird	The water is dirty, or the water has been in the tank for too long.	Clean the water tank and sink, and replace with clean water.
The humidification effect is not obvious	The air inlet is blocked by dust.	Dust the air inlet.
Abnormal noise appears	The humidifier is not placed horizontally (tilted or unstable).	Place the humidifier on a hard horizontal surface.
There is water in the water tank, but it shows a lack of water.	The excessive inclination of the humidifier causes the water level in the sink to be judged as too low, and the machine is automatically protected, so it stops.	Place the humidifier on a hard horizontal surface.

Please contact us.airplus@gmail.com if you have any additional questions.

07

Instructions

Power L M H
• I II III



Button	Function
	(1) In standby state, short press to turn on/off the humidifier. (2) When you turn on the humidifier, high mist level is selected by default, and the atmosphere light, Power light and corresponding mist level indicator light are on. (3) When you turn off the humidifier, the atmosphere light will go out as well.
	(1) Short press , the humidifier will cycle among Medium (M), low(L) and high(H) mist levels. (2) Mist level indicator light will be on according to the mist level you choose.
	(1) In the standby state, the atmosphere light is not on. Press to turn it on/off. (2) In the power on state, press the first time to turn off the atmosphere light, press the second time to turn off the corresponding mist level indicator light and Power light, and press the third time to turn on the atmosphere light and mist level light. It's going to cycle like this all the time. ★ Night light flashing (1) When there is no water in the water tank or little water, it is suggested to lower the mist level. (2) In the power on state, pick up the water tank, the atmosphere light flashes for 10 seconds and then shut down. (3) When you turn off the humidifier, the atmosphere light will flash for 10 seconds, and then the humidifier stops working.

- (1) If the indoor temperature is too low or the humidity is too high, it is suggested to lower the mist level.
- (2) The humidifier will not work when the water in the tank has not reached the base, or there is too little water in the base.

03

Cleaning And Maintaining

Attention:

- Unplug before cleaning.
- The scale and debris in the water tank must be cleaned regularly, and it is recommended to clean it every 2-3 weeks.

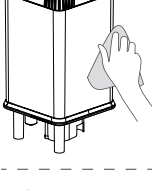

Water tank cleaning
Can be directly wiped with a clean soft wet cloth.

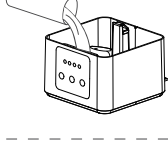

Sink and atomizer cleaning
Add clean water, and rinse after cleaning.

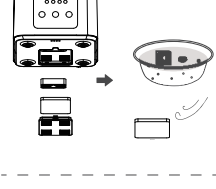

Essence cotton and filter cotton cleaning
Remove the essence cotton and filter cotton from the essence box, clean them with water and dry them.

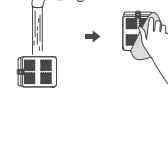

Essence box cleaning
Clean the essence box with water and dry it.

06

Use

Attention:

- Please pull out the power plug before adding water.
- The height of water shall not be higher than the Max line.
- Do not directly pour water into the mist nozzle or base.
- Please do not pull out the power plug when hands are wet to prevent electric shock.
- Do not add additives in water, such as essential oils, perfumes, drugs, etc.
- Use clean water or purified water with water temperature lower than 104 °F (distilled water is not suitable).

Steps to add water (Three methods)

① It's recommended to use the first method to add water for the first time.

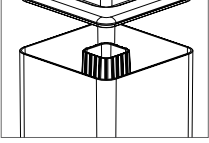

Remove the lid.

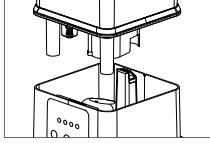

Remove the water tank.

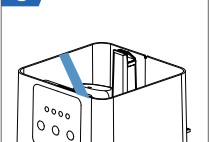

Remove the single-sided adhesive that fixes the rocker panel.

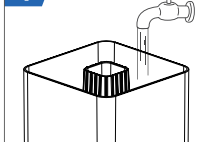

Place the water tank under the tap according to the figure.

04

② Remove the lid and add water into the water tank (Do not add water into the mist nozzle).

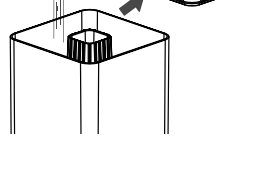

Water tank installation

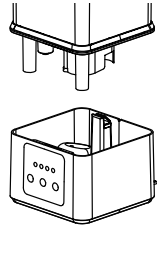

When the water tank is installed back to the base, the Max line of the water tank and the control panel should be installed the same side.

Mist direction adjustment

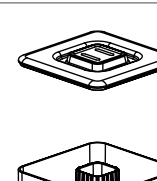

The direction of fog release can be adjusted by turning the cover for 90 degrees of rotation

05