

Shower Combination Set

TECHNOLOGY·ART·LIFT Instructions For using

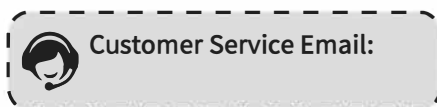
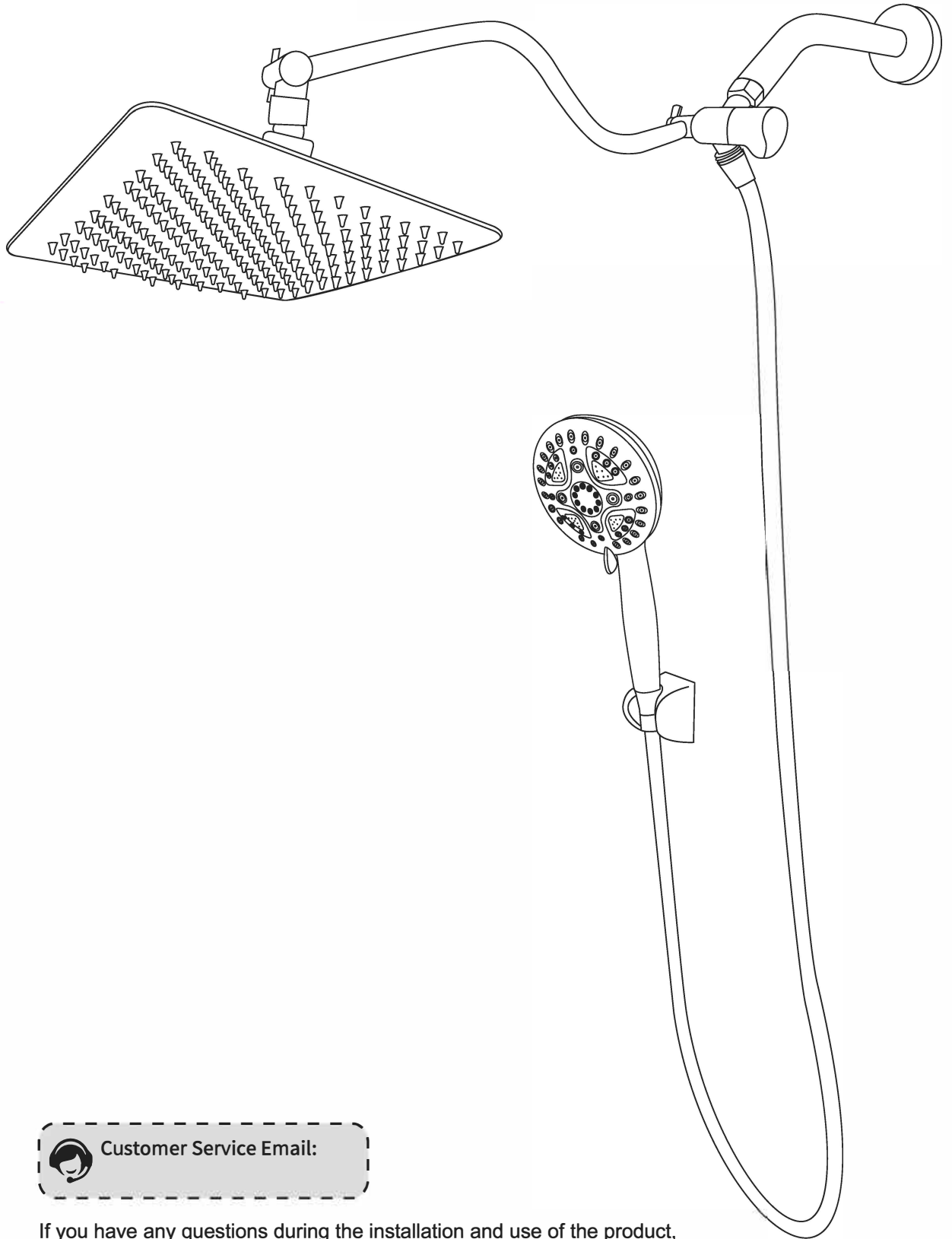

If you have any questions during the installation and use of the product,
please contact our customer service team.
Please provide order number to communicate with us.
We will reply to your message as soon as possible.

READ BEFORE INSTALLATION

Note: This manual is to tell you how to use and install your showerhead. Please check the package for damage at the first time you receive the product, and contact us if you find the product damaged timely.

PACKAGES INCLUDE

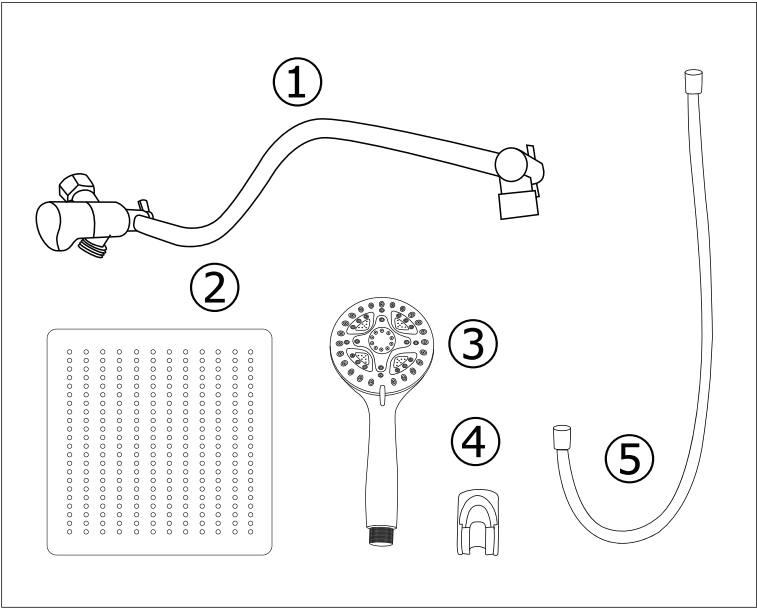

- 1.Double-headed rotatable shower arm* 1
- 2.12 Inch Rain Spray Shower * 1
- 3.7-mode Handheld Shower* 1
- 4.Non-marking,non-perforated base* 1
- 5.Stainless Steel Hose * 1

INSTALLATION PROCEDURE

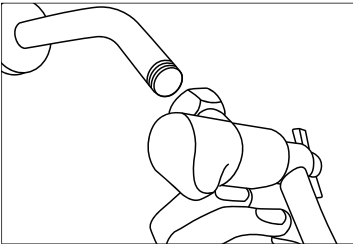

Step 1:
(1)Remove the old showerhead.
(2)Install the shower arm on the shower bracket and tighten the short nut.
(There is an adjustable angle knob on the side, so you can adjust the angle you like according to your needs.)

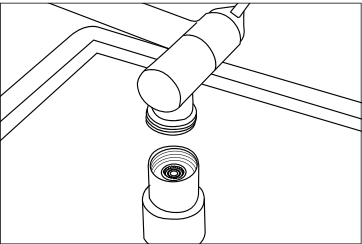

Step 2:
Install the rain spray shower on the other end of the shower arm.(There is an adjustable angle knob on the side, so you can adjust the angle you like according to your needs.)

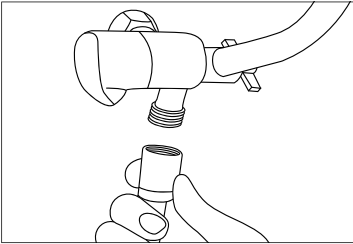

Step 3:
After installing the bracket, take the end of the hose and install it on the shower arm.

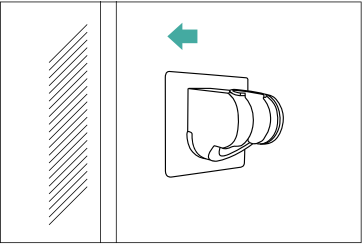

Step 4:
(1)Remove the no-staple base and tear off the plastic sheet.
(2)Find a height that is comfortable for you and glue the base to the wall.

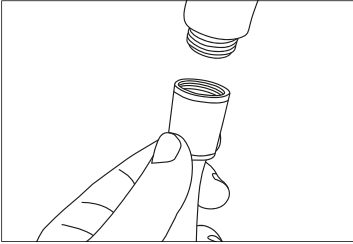

Step 5:
(1)Take out the handheld shower.
(2)Connect the other end of the hose to the handheld shower.

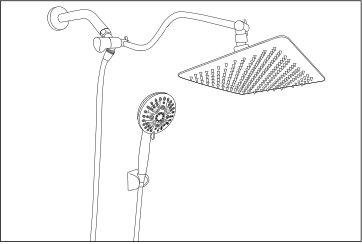

Step 6:
The shower combination has been installed.
Please enjoy it.

PRODUCT DESCRIPTION

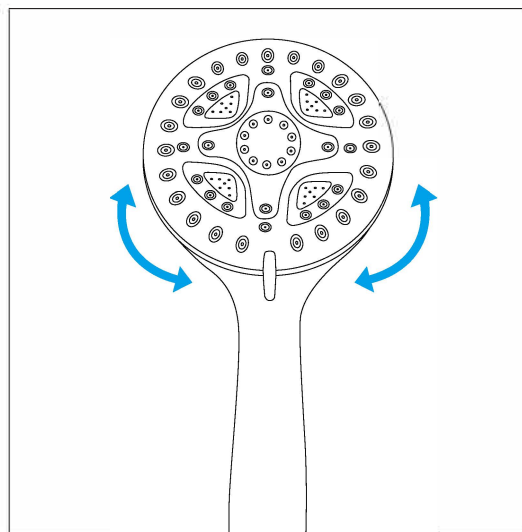
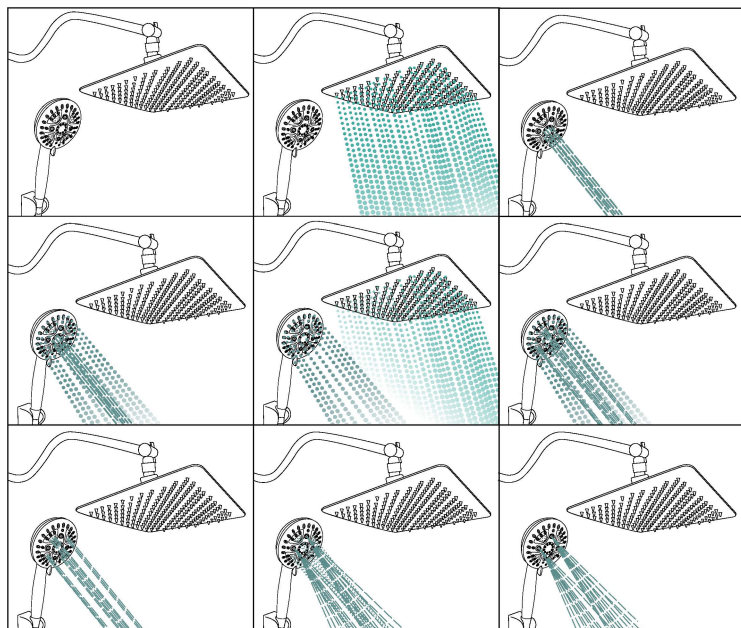

How to use?

Spray Selector

You can select your preferred spray pattern of the handheld shower by toggling the spray converter.

PRODUCT SIZE

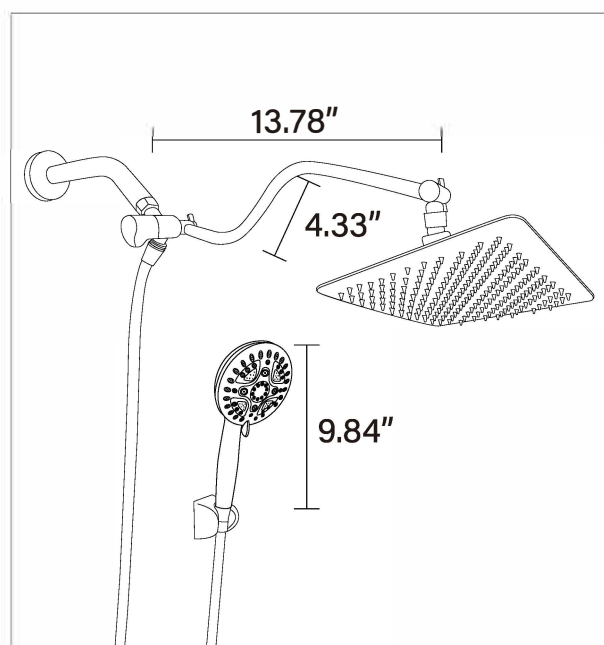
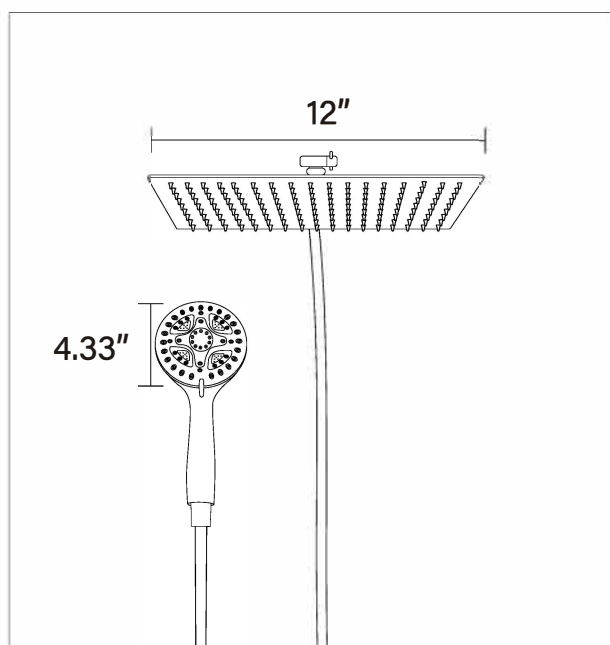

Diverter

The diverter is located on the lower part of the shower column, just above the shower hose connection. The diverter is used to switch from the rain shower head to the hand shower.

Simply press the Wings and turn the diverter until it stops changing functions.

The Shower combo allows the rain shower head and hand shower to operate independently or simultaneously.

The diverter allows for different shower combinations, giving you the ultimate control over your showering choices.

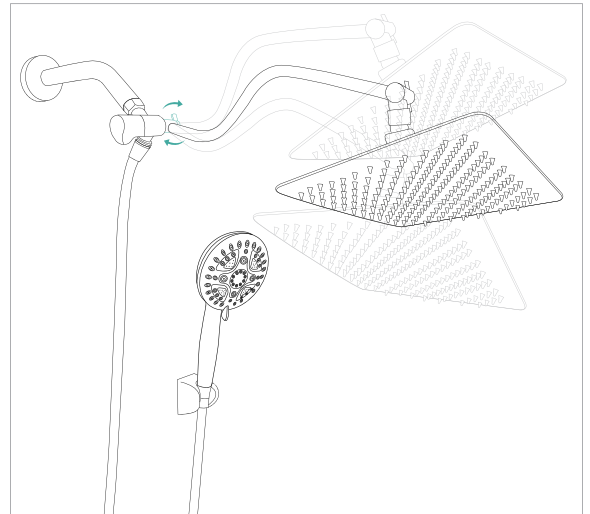

combination function

The hand shower has seven different functions that give you ultimate control over your showering experience. It has a wide spray, a concentrated spray and a pulsating massage, as well as two combination functions that combine a pulsating massage or a concentrated spray with a wide spray. You can use the handheld shower in place or remove it from the stand to reach all parts of your body. The handheld shower can be used in place alone or in combination with the rain shower head.

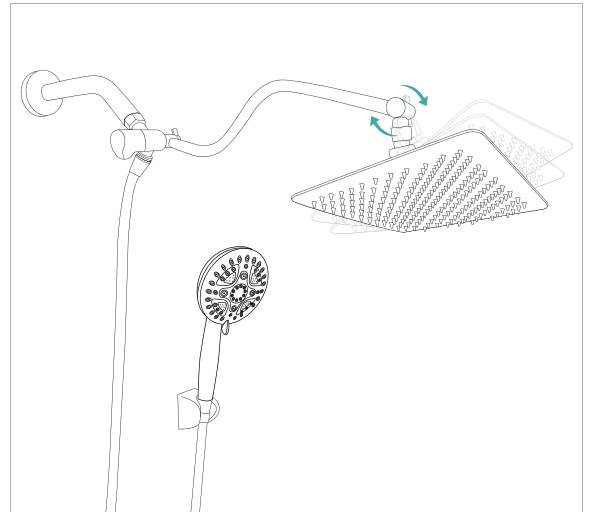

Add or remove water flow restrictor

What's this for? Flow restrictors are small devices in your shower head that restrict water flow as mandated by U.S. federal regulations to help conserve water. Users with low water pressure, however, can remove or do not add the flow restrictors in their shower heads to achieve higher flow rates.

The water flow restrictor is not pre-installed into the showerheads.

1. Turn the handle of the shower upwards so that you can see its water inlet.
2. Then put in the flow restrictor into a showerhead.
3. After installing the flow restrictor, our showerhead product has a flow rate of 1.8 GPM, which complies with the legal requirements for maximum flow rate in the United States.

