

285x210mm

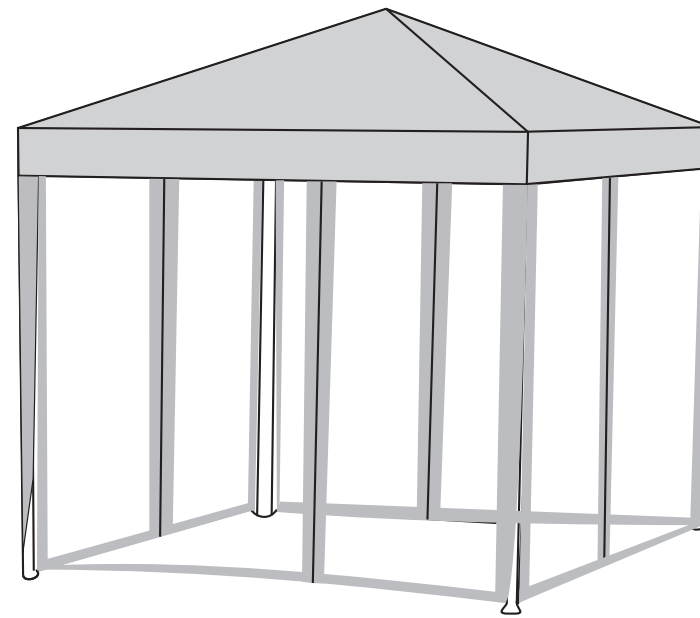

## USER'S MANUAL Canopy Tent

### PRODUCT ASSEMBLY

#### Open

Before the tent is open, 2 persons are needed to hold 4 corners of the tent to gently shake and to slightly spread the cross pole of the tent frame.

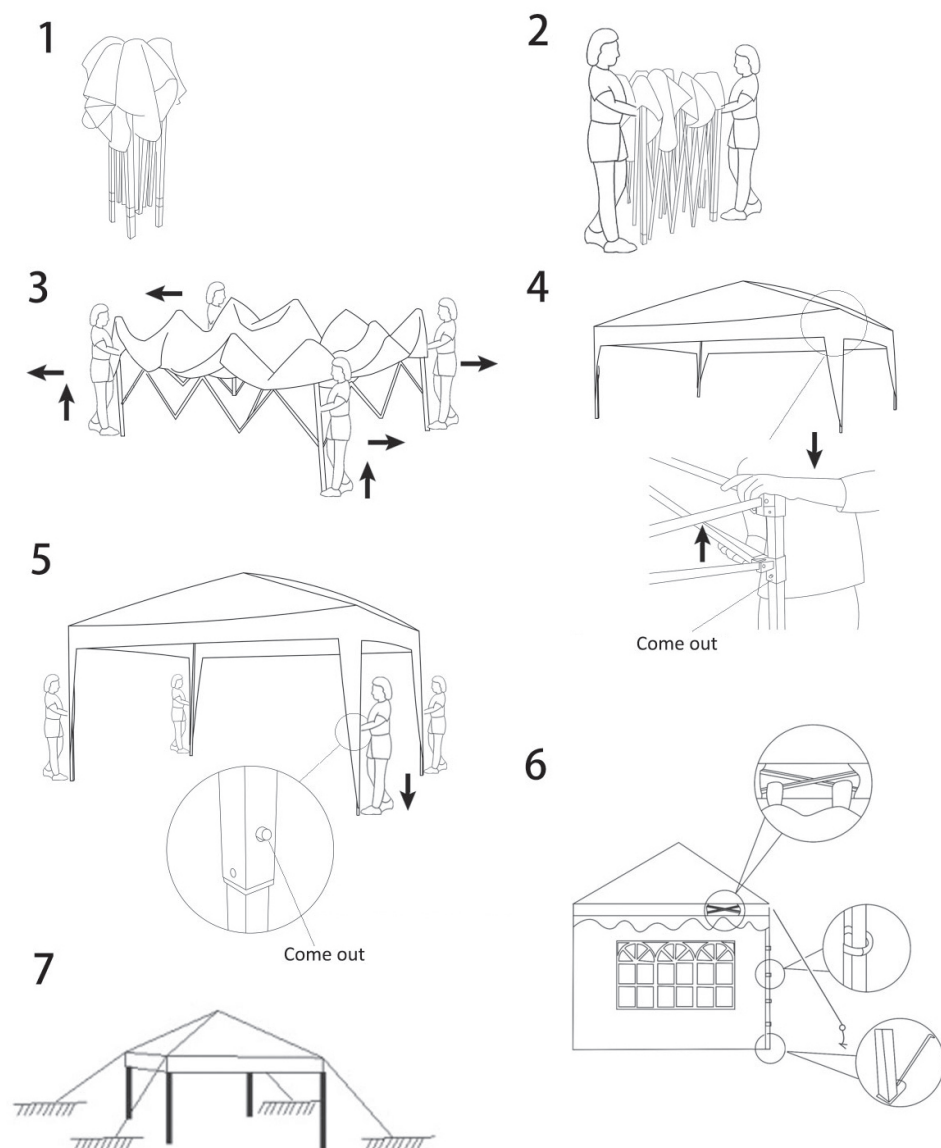

#### Close

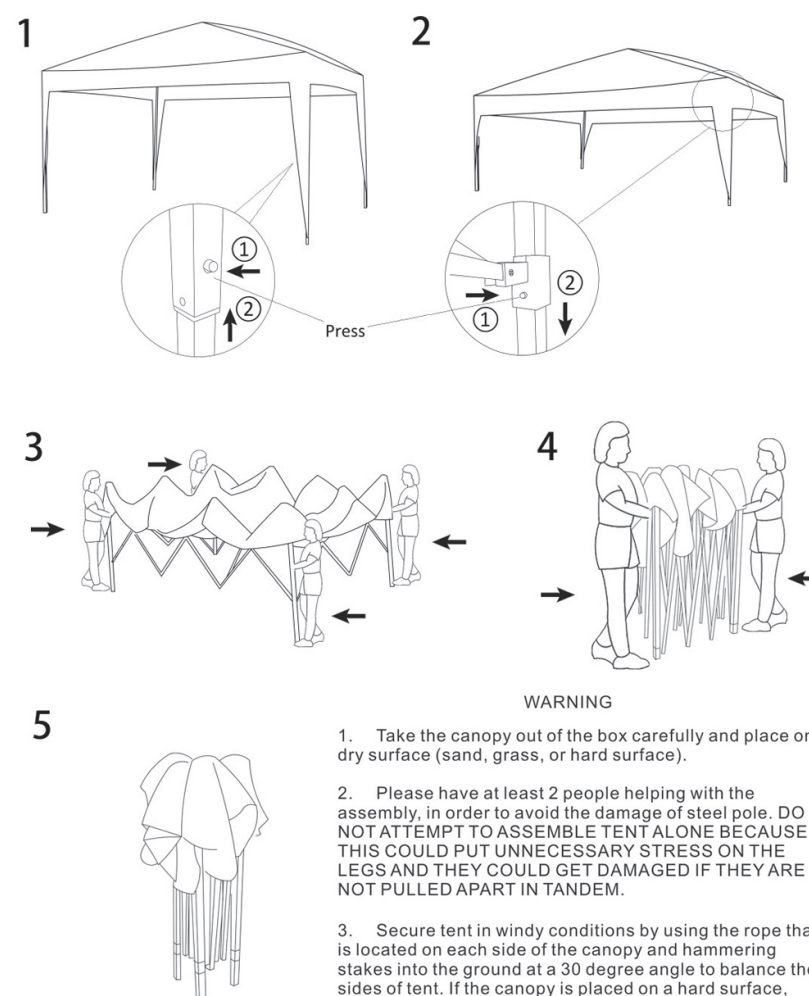

#### WARNING

1. Take the canopy out of the box carefully and place on dry surface (sand, grass, or hard surface).
2. Please have at least 2 people helping with the assembly, in order to avoid the damage of steel pole. DO NOT ATTEMPT TO ASSEMBLE TENT ALONE BECAUSE THIS COULD PUT UNNECESSARY STRESS ON THE LEGS AND THEY COULD GET DAMAGED IF THEY ARE NOT PULLED APART IN TANDEM.
3. Secure tent in windy conditions by using the rope that is located on each side of the canopy and hammering stakes into the ground at a 30 degree angle to balance the sides of tent. If the canopy is placed on a hard surface, secure the 4 sides with bricks or sand bags to weigh the canopy down.
4. DO NOT ASSEMBLE TENTS IN RAIN, SEVERE WIND OR SNOWY WEATHER CONDITIONS, BECAUSE THIS WILL DAMAGE YOUR TENT. It is the owner's responsibility if the tents are set-up and damaged during these conditions.
5. Store your canopy/tent in a cool dry place when not in use.