

R-4 INSTALLATION INSTRUCTIONS

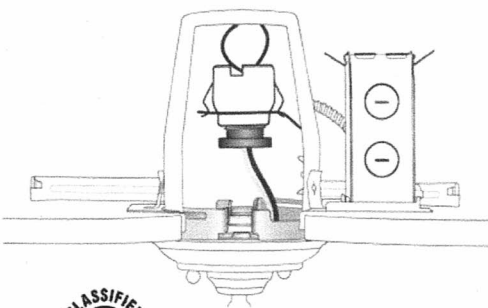

RECESSED CAN LIGHT CONVERSION KIT

www.TheCanConverter.com

*Please Read All Instructions Carefully
Before Beginning Installation*

THE CAN CONVERTER

WARNING

RISK OF ELECTRICAL SHOCK. Disconnect the power to the existing luminaire at the breaker box. The luminaire's wiring, ballasts or other electrical parts may be damaged when drilling for installation of the reflector kit hardware. Check for damage to the enclosed wiring and components. Do not alter, relocate or remove wiring, lamp holders, ballasts or any other electrical components. Install this kit only in luminaires that have the construction features and dimensions shown in the photographs and /or drawings. To prevent wire damage, do not expose wiring to the sheet metal of the can or other sharp objects. The Can Converter is not intended for installation on listed recessed incandescent luminaires installed on an inclined ceiling. Mount only on listed new construction cans with bar hangers. **DO NOT** install on T-bar suspended ceilings. This product is intended for luminaires with 50 lb. ratings or less. It is not intended for luminaires greater than 50 lbs. The reflector kit requires knowledge of lighting luminaire's electrical systems. If not qualified, do not attempt installation. Contact a qualified electrician

**This product is designed to work with cans
that utilize incandescent bulbs.**

TOOLS YOU WILL NEED



Phillips and Slotted
Screwdrivers



Wire Cutters



Safety Goggles



Marker



Power Drill

CONVERT ALL OF THESE RECESSED CAN LIGHT PRODUCTS

Capri	R4, R4ASIC
Elco	EL99
Elite	B4, B4IC
Halo	EI400AT, H99ICT, H99T EL99
Jimway	HBR2000BICAT
Juno	IC1, IC1S, IC1W, IC1P, TC1, TC1S
L&C Lighting	1105, 1179, LWSIC1
Nora	NS-401Q, NS-401QAT, NSIC-401AT
Prescolite	IBX4-120, BX4-120, FT4
Progress	P830-TG, P831-AT, P831-FB
Thomas	PS4, PS4ASIC, R4, R4ASIC

KIT CONTENTS



MOUNTING BRACKET ASSEMBLY
AND BRACKET SHOES

MOUNTING
BAR

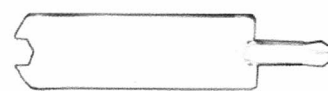
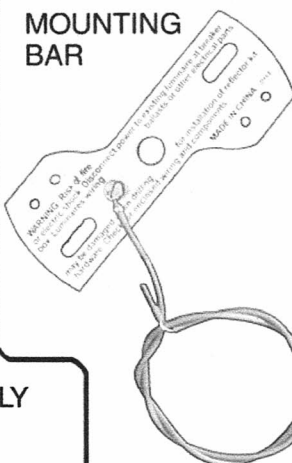

WRENCH



MOUNTING
SCREWS

GROUND
WIRE



BLACK
WIRE
HOT



WHITE
WIRE
NEUTRAL

POWER-OUTLET-ADAPTER



SELF-TAPPING
SCREWS

IMPORTANT: Verify proper can installation, bar hangers must be resting on ceiling

Acceptable Clearance

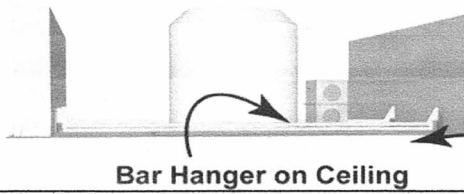

Not Acceptable Clearance

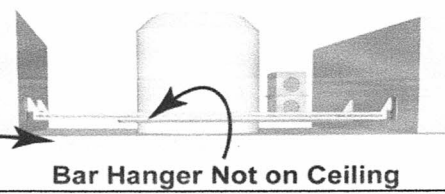

Bar Hanger on Ceiling

Bar Hanger Not on Ceiling



Turn off power at the breaker box

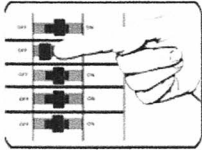

Use eye protection when working over your head

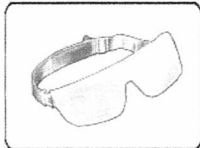

1. Remove the light bulb and can trim from the can light you will be replacing.

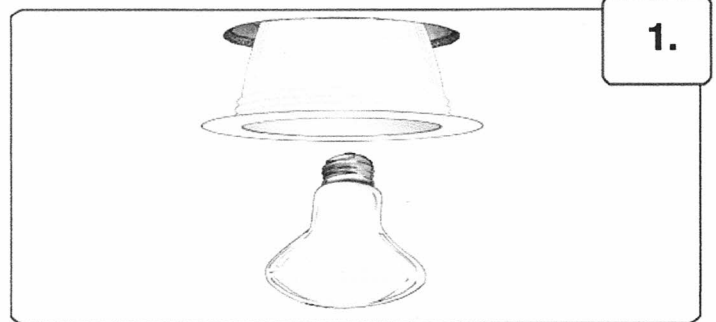

2. fig. A Within your existing can housing there may be a metal bracket that holds the light socket.

fig. B If it is adjustable, loosen the wing nut and slide the bracket to the top of the can housing. Tighten the wing-nut and screw the CAN CONVERTER power-outlet-adaptor into the socket

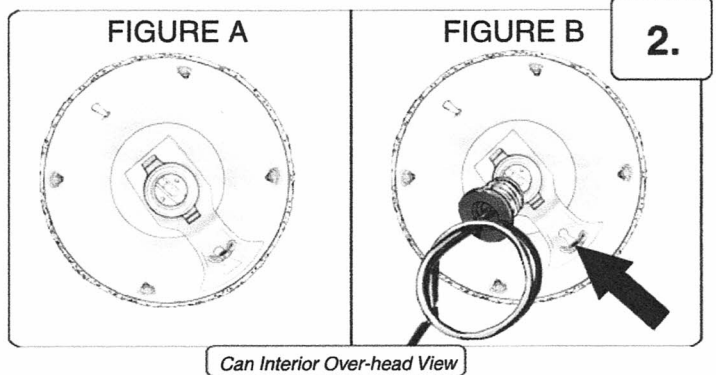

3. fig. A If your socket is NOT adjustable or there is no metal bracket, remove the socket from the trim then screw the power-outlet-adaptor into the socket.

fig. B If your socket is attached to the top of the can, screw the power-outlet-adaptor into the socket

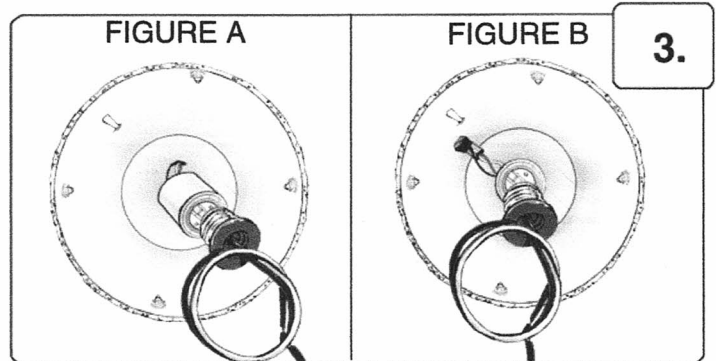

4. Remove the mounting bar from the mounting bracket and save the screws.

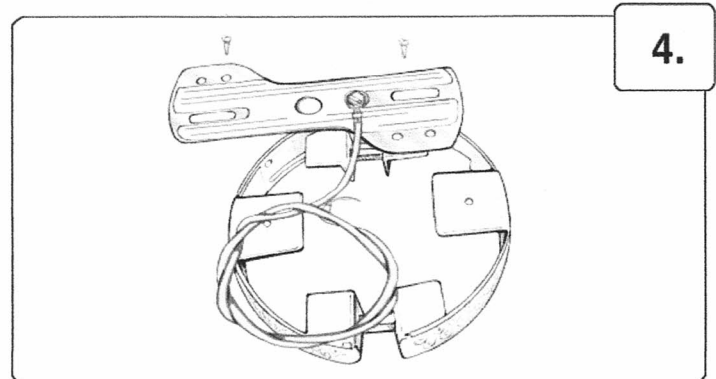

5. Set the mounting bracket assembly in the can. If the mounting bracket hits against a screw in the can, remove that screw.

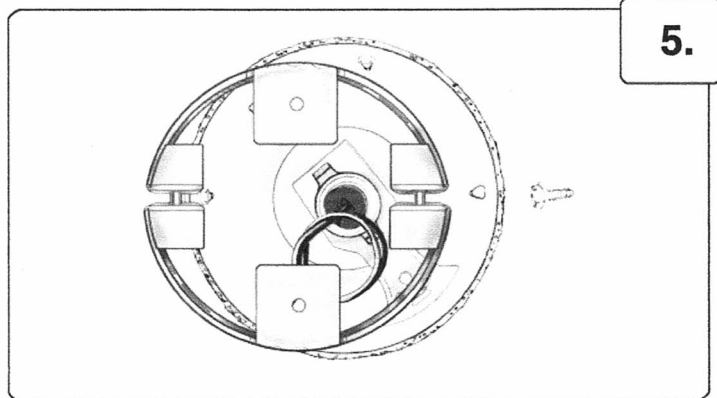

6. Using the wrench, expand the bracket shoes so that the mounting bracket fits snugly inside the wall of the can housing.

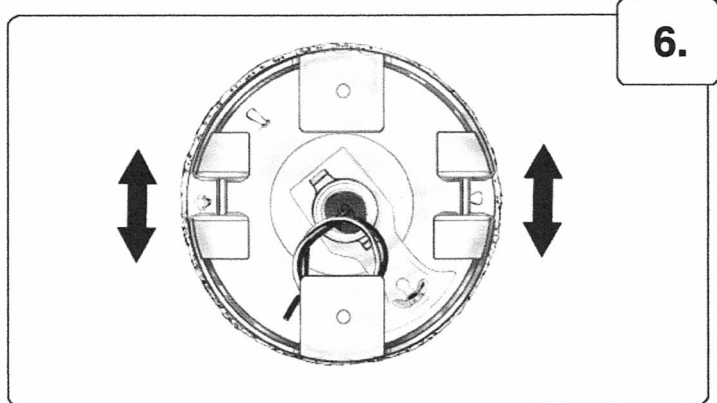

7. There are two holes on opposite sides of the mounting bracket. Using the self-tapping screws, screw all the way into the can housing to secure the mounting bracket.

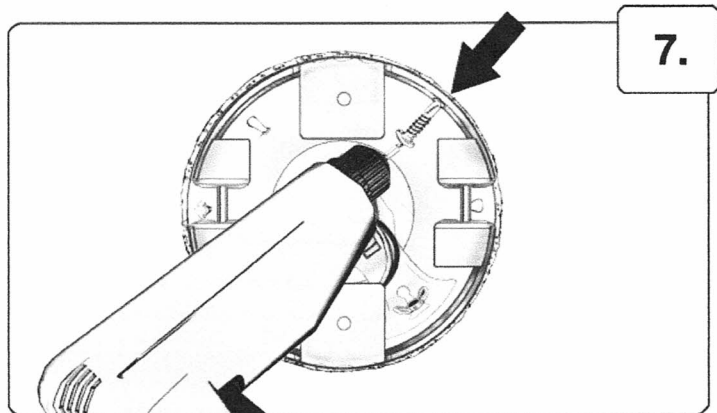

8. Extend the wires from the power-outlet-adaptor down to the base of the can

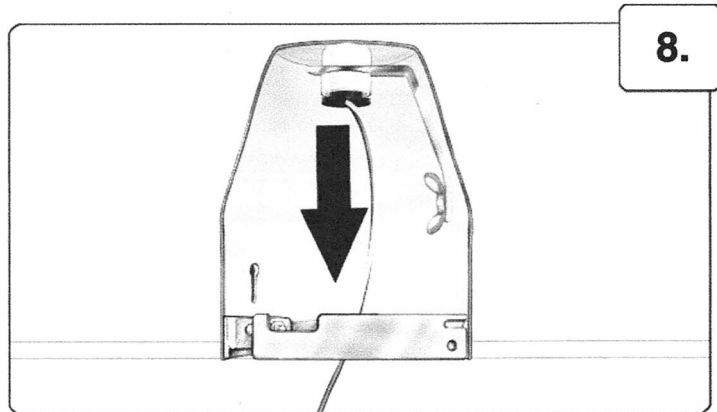

ALTERNATE INSTRUCTION PATH

Pre-assemble your new light fixture following the manufactures instructions. For chandelier installation continue to STEP 9 CHANDELIER. If you are installing a pendant, track lighting or other fixture that will be secured to a mounting bar, continue to STEP 9 PENDANT.

CHANDELIER INSTALLATION

9. fig. A Place the mounting bar against the light canopy and screw the threaded pipe into the mounting bar so that it extends 1/4" below the canopy.

fig. B Screw the brass nut onto the threaded pipe to secure it to the mounting bar. Screw the light hook onto the threaded pipe.

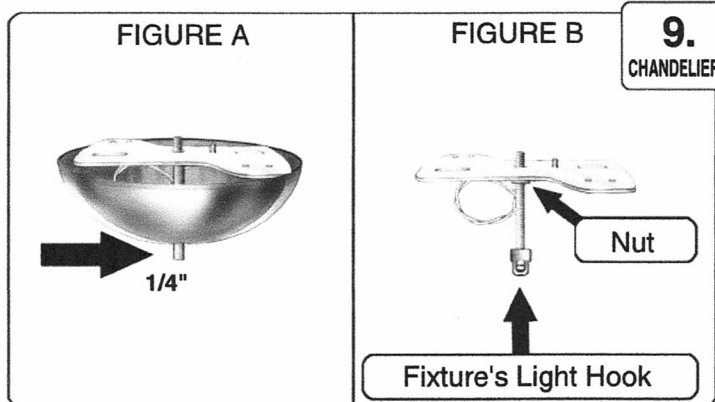

10. fig. A Raise your pre-assembled chandelier to the ceiling and cut the chain to the desired length. Thread the chandelier wires up through the chain. Run the chandelier nut and canopy through the chain and wires.

fig. B Thread the chandelier wires through the threaded pipe and attach the chain to the light hook.

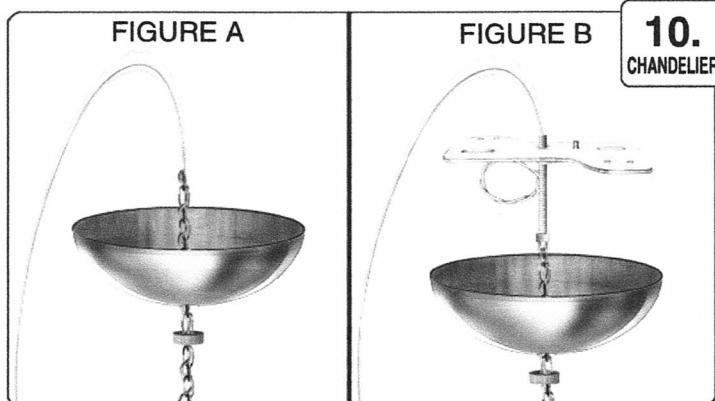

You may want to place your chandelier on a box on top of your ladder so that the chain will reach the ceiling.

11. Bring the light assembly up to the can and run the chandelier wiring down from the threaded pipe to rest below the mounting bar.

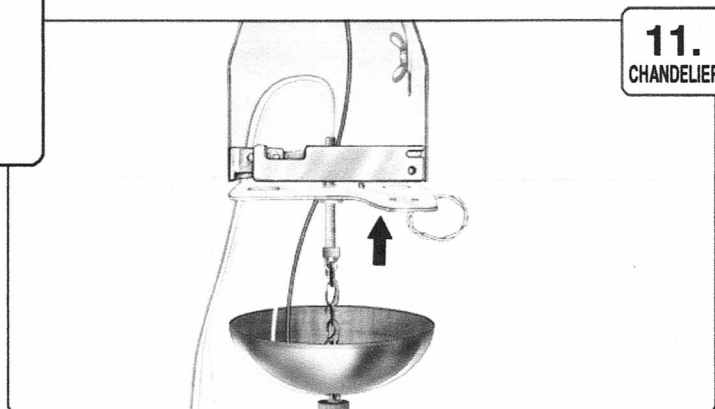

12. Using the small screws, attach the mounting bar to the mounting bracket. Cut the excess wiring just long enough to fit inside the canopy.

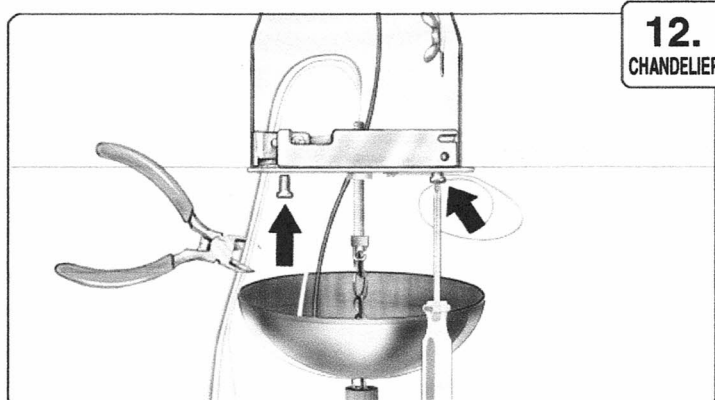

13. Using wire nuts, pair together the fixture's hot wire and the power-outlet-adapter's hot wire, the fixture's neutral wire and the power-outlet-adapter's neutral wire and the fixture's ground wire to the ground wire on the mounting bar.

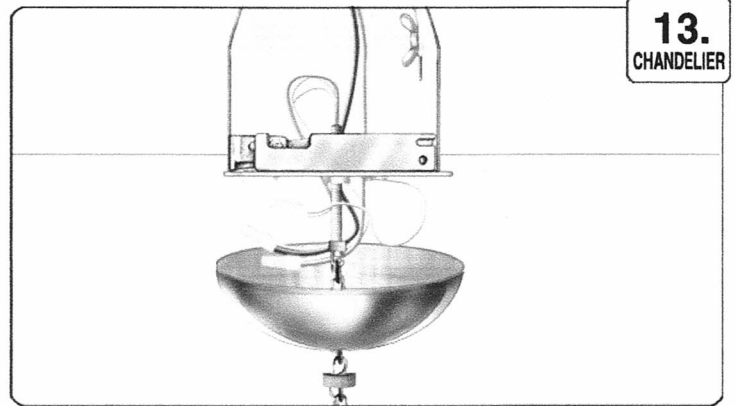

14. Tuck the wiring into the light canopy of your chandelier. Screw the large chandelier nut to the light hook to secure the canopy to the ceiling.

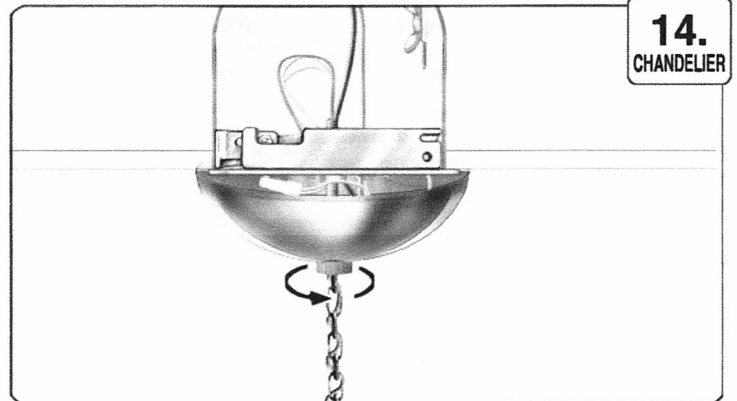

(Turn your power back on at the breaker box. Your installation is now complete)

PENDANT / FLUSH MOUNT INSTALLATION

9. Match the correct screw holes in the CAN CONVERTER mounting bar with the holes on your new fixture's light canopy. Screw the screws from your fixture into the correct holes on the mounting bar. The screw's heads will be on the inside of the can.

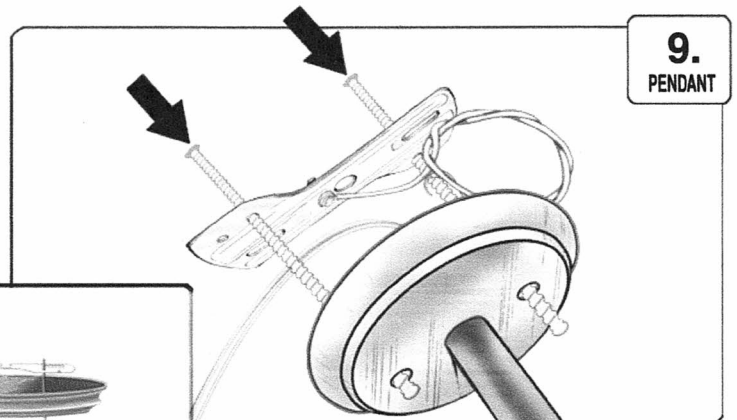

* If you are installing a flush mounted fixture, the long screws will screw in from the bottom up, through the light canopy.

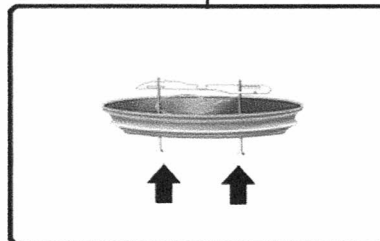

10. Using the small screws, attach the mounting bar to the mounting bracket assembly. The long screws from your new fixture will extend downward from the mounting bar.

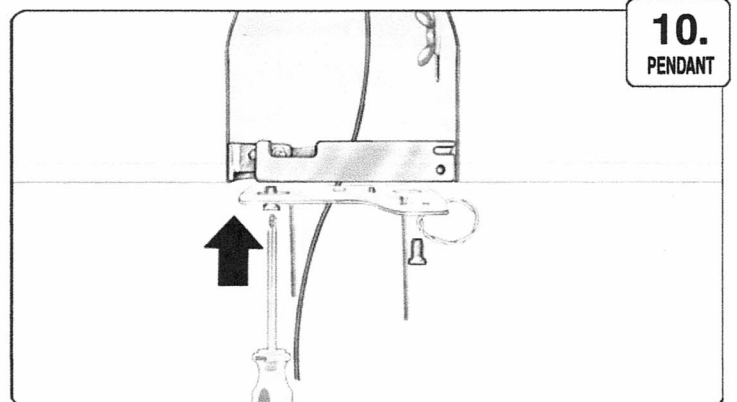

- 11.** Bring in your fixture and trim the excess wiring so that it will fit in the fixture's canopy. Using wire nuts, pair together the fixture's hot wire and the power-outlet-adaptor's hot wire, the fixture's neutral wire and the power-outlet-adaptor's neutral wire and the fixture's ground wire and the ground wire attached to the mounting bar.

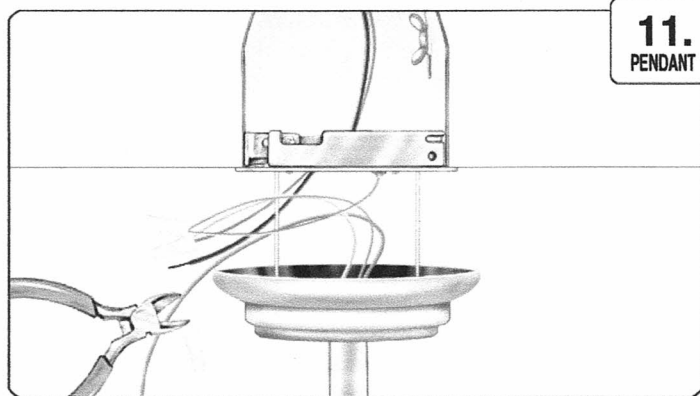

- 12.** Tuck the wiring into the fixture's canopy. Raise the canopy and fixture to the ceiling.

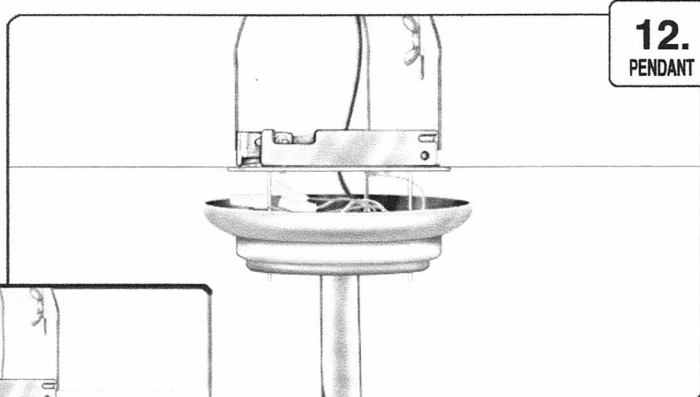

* If you are installing a flush mounted fixture, screw the long screws from the bottom up through the canopy and into the mounting bar.

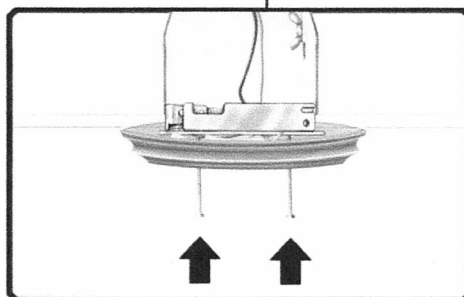

- 13.** Secure the fixture to the ceiling by attaching the fixture's decorative nuts to the extending screws. Alternately drive the nuts to the fully tightened position. The screws will back drive then stop when they are tightly in place.

(Turn your power back on at the breaker box. Your installation is now complete)

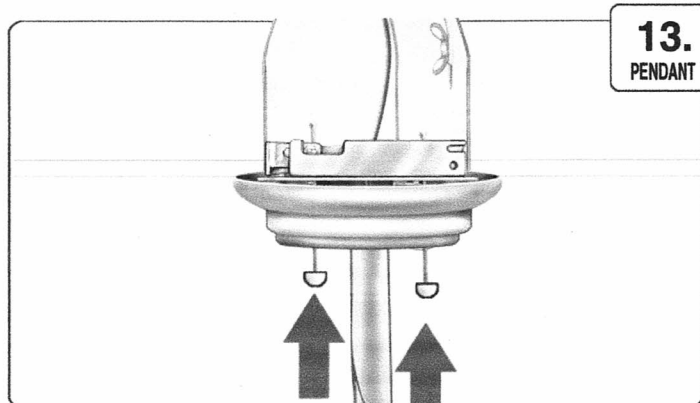

**Customer support is available Monday through Friday 9:00am to 5:00pm PST
at 866-409-9634**

**JSB Enterprises
Temecula, CA 92590
www.thecanconverter.com**