

## SENSOR SANITIZER/SOAP DISPENSER INSTALLATION

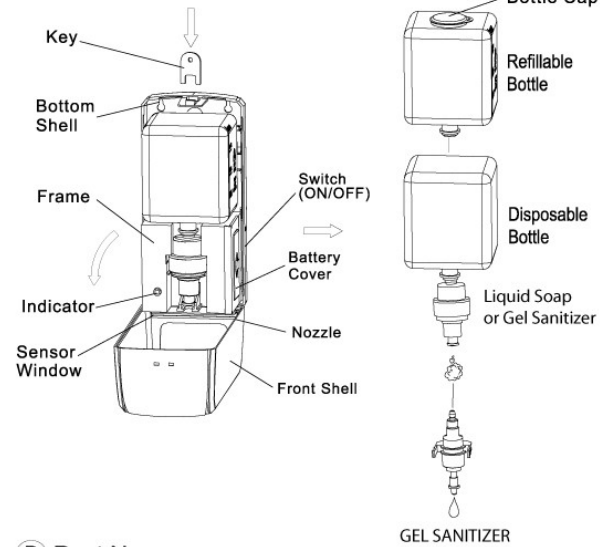

\* we have different shape but same installation.

### A Packing List



### B Part Name

### Recommended Installation Height

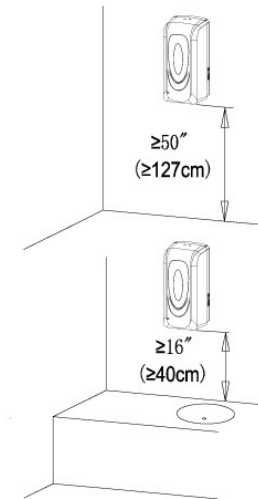

\* keep away from sunshine and humid place

### C Height from Floor/Table

### Installation with Screws

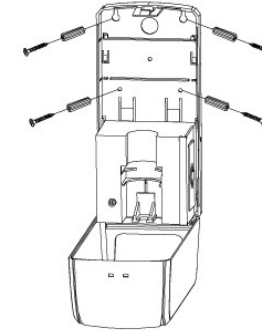

### D Way for Screw

### Install Batteries

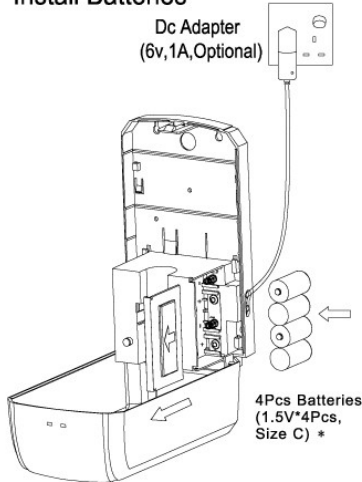

E \*The Standard Packing is not including DC Adapter and Batteries.

### Installation with Adhesive Backing (no screws)

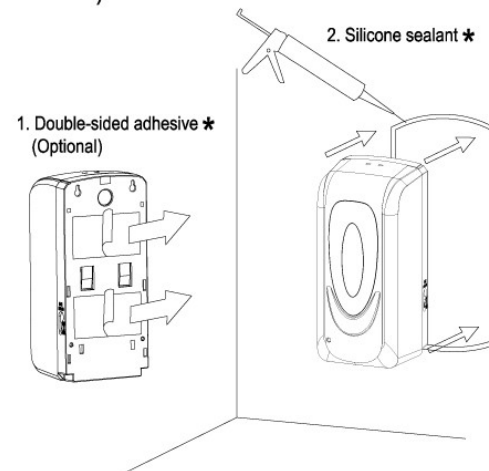

F \* The Standard Packing is not including Dual-Sided adhesive and silicone sealant.

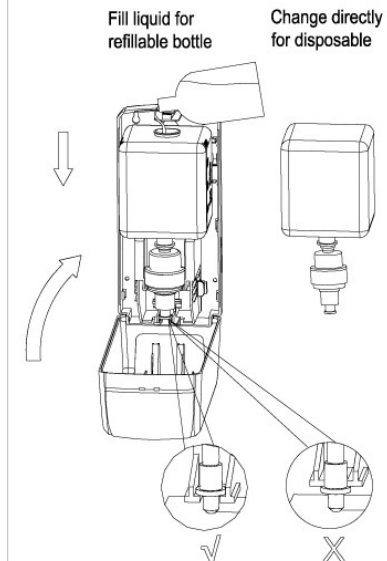

### G Fill Liquid

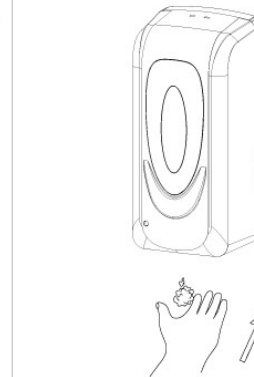

- UV disinfection
- LED Light:
  1. green color 5 seconds flush: working condition;
  2. red color 5 seconds flush: low power for battery and change;
  3. red color 2 seconds flush: something under sensor and remove it ;
- Sensing Distance: 8-12cm

### H Enjoy hand sanitizing