

# EZ Armor Double Side Light Door Application

Note: If installing new locks Door Shields should be installed prior to final lock assembly to prevent having to back track.

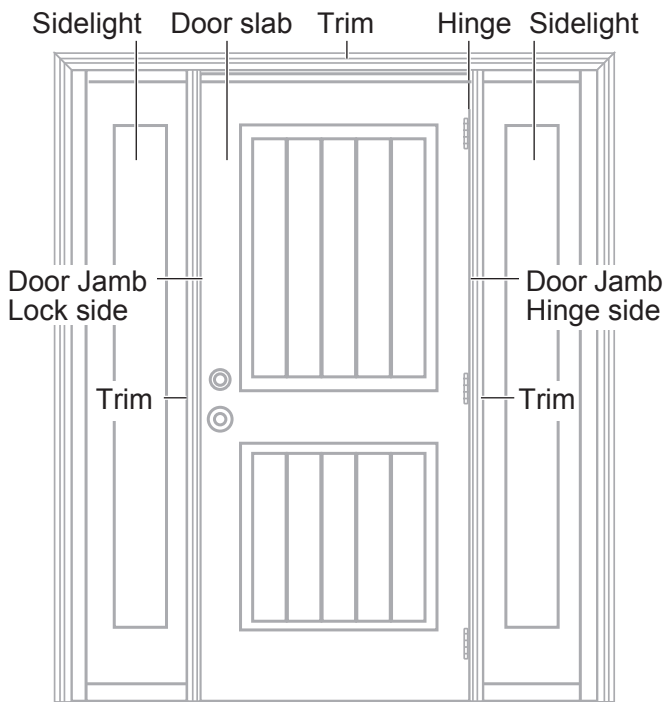

Questions? Call customer service at 1-888-582-2294 or visit [www.armorconcepts.com](http://www.armorconcepts.com)

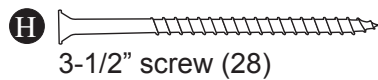
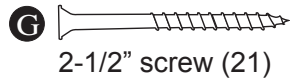
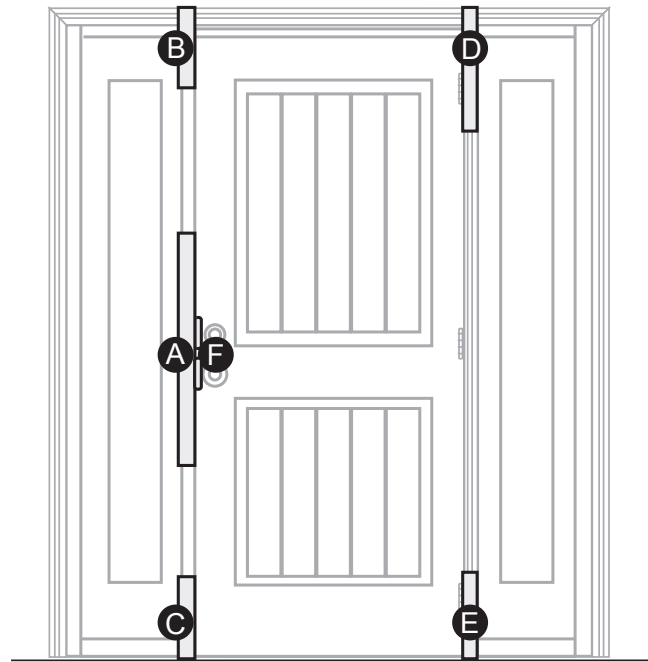
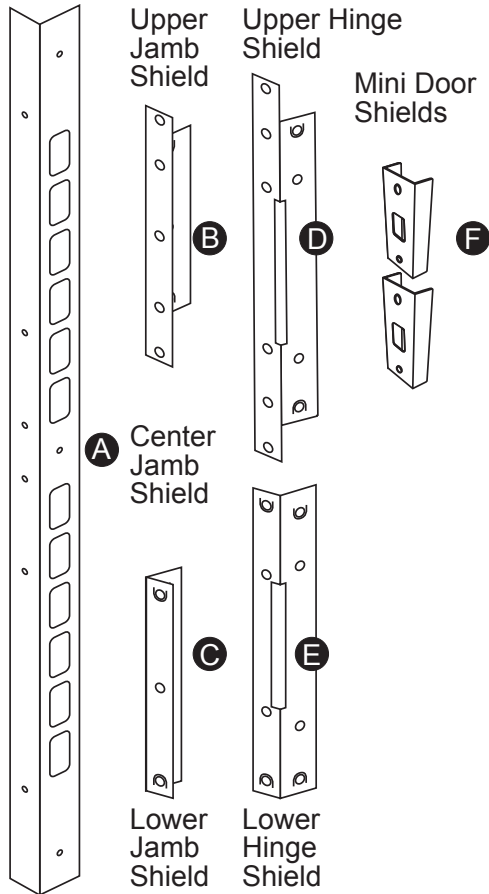

## SAFETY INFORMATION

### WARNING

- The use of work gloves and safety glasses is strongly recommended while installing this product. Wood and metal shaving/splinters can cause serious bodily injury.
- As with all products requiring installation, to reduce the possibility of accidental injury to you or others

FOLLOW ALL INSTALLATION INSTRUCTIONS contained herein accurately and carefully.

### PREPARATION

Before beginning assembly of product, make sure all parts are present. Compare parts with package contents list and diagram above. If any part is missing or damaged, do not attempt to assemble the product. Contact customer service for replacement parts at 1-888-582-2294 or visit [www.djarmor.com](http://www.djarmor.com).

### PAINTING INSTRUCTIONS

Note: It is recommended that Door Jamb Armor components be painted before being installed. They can be touched up as necessary after installation.

1. Using plain steel wool or a very fine emery cloth, gently rough the surface of the piece to be painted. You only want to rough the surface and break the gloss so that your paint will adhere to the surface. Do not totally remove the existing powder coating.
2. Clean the surface with a tack cloth or a cloth with a cleaner on it that will not leave a residue. Rubbing alcohol will work well for this application. You can also use mineral spirits but make sure that whatever you use does not cause an adverse reaction with the powder coating.
3. When components are clean and free of debris, you are ready to paint your pieces.
4. Ensure that all components are completely dry before handling or installing them.

### Tools required for assembly

- Variable speed drill, with screwdriver adapter and bits
- Pry bar
- Carpenter's level
- Claw foot hammer
- Soft face hammer
- Phillips screwdriver
- Flathead screwdriver
- Pair of work gloves per person assisting in installation
- Pair of safety glasses per person assisting in installation
- 9/64 in. and 11/64 in. drill bits
- 1/2 in. to 3/4 in. drill bit
- Razor knife
- Caulk

## Door Shield Installation

1. Slide the Mini Door Shield **F** onto the door position so the holes will go over the lock bolts.

2. Using the supplied 2-1/2" screws **G**, secure the Door Shield to the door slab using the hole above and below screw lock bolt holes.

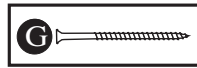
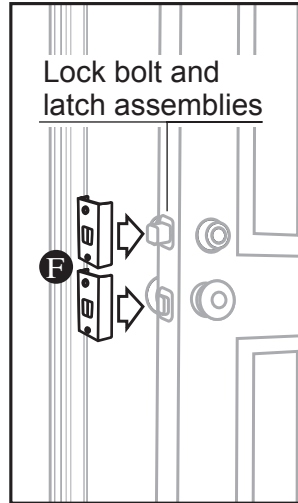

3. With the Door Shields in place, make sure the Door Shields are level and flush against the door slab on all sides.

4. Verify that the locks can function properly without interference from the Door Shields. If there is interference, adjust the Door Shields until the locks operate freely. If there is no interference, the installation is complete.

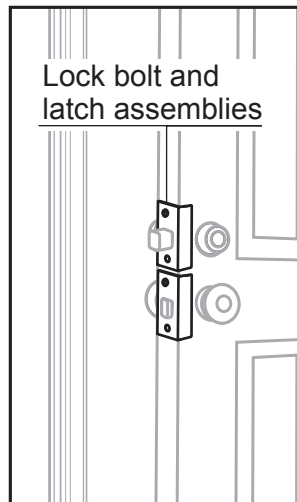

## Door Jamb Prep

**⚠ Note:** In all steps it is imperative to ensure that at no time any drilling or screw placement come in contact with the glass casement of the sidelight.

1. Carefully score along trim edges with sharp tool such as a razor knife.

2. Gently pry and remove interior door trim molding and all trim molding on the sidelight panels that is immediately adjacent to the door jamb exposing the door jamb separating the door and sidelights.

(This trim can and should be reinstalled upon installation completion.)

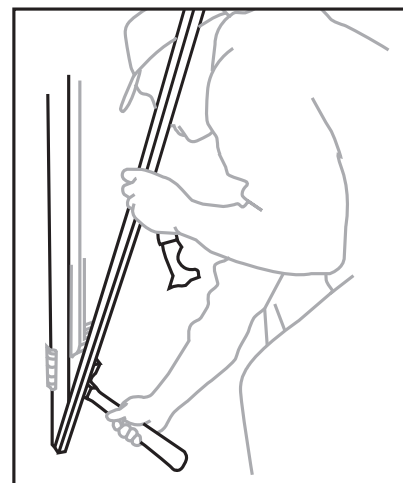
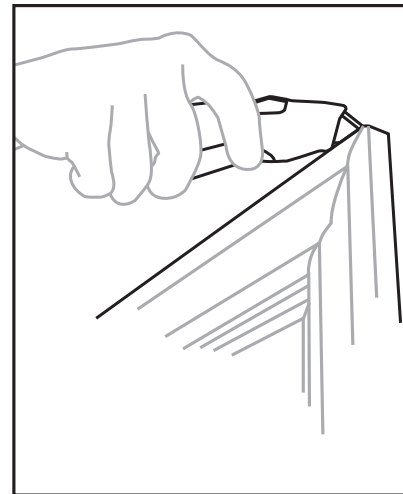

## Jamb Shield Installation Upper Lockside Shield

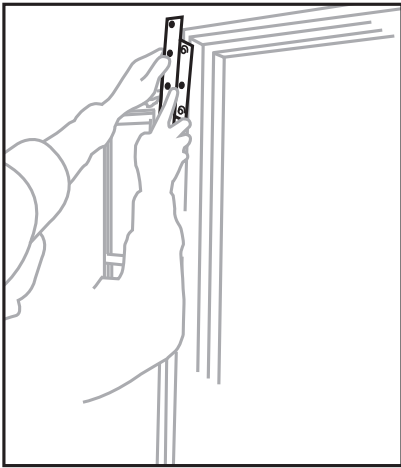

1. Locate the Upper Jamb Shield support **B**, (2) 2-1/2 inch **G** and (6) 3-1/2 inch screws **H**. Position the Upper Jamb Shield support on the door jamb with the long tabs turned vertically. The upper tab should extend upward over the upper jamb with the screw hole coming to rest on the rough frame above the door. The side with screw hole and rounded cutouts (fig. 1), should be on the door side of the door jamb and interface with the top of the door jamb.

2. Hold the piece in position on the jamb. Make sure the door side edge of the piece slides behind the weather stripping.

Once the support piece is positioned properly, locate and mark the center of the screw hole of the upper rounded cutout (fig. 1) on the door jamb.

3. Remove upper Jamb Shield and with a 1/2-inch drill bit, drill a 1/2-inch hole approximately 1/2-inch deep into the jamb at the marked location.

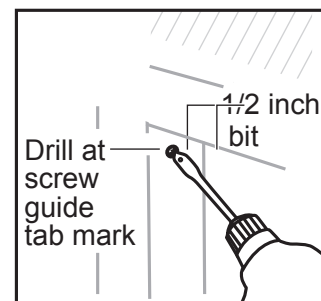
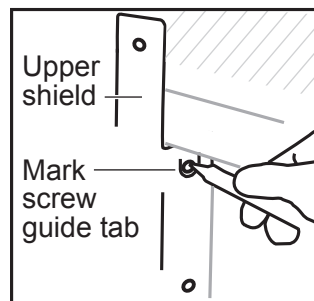
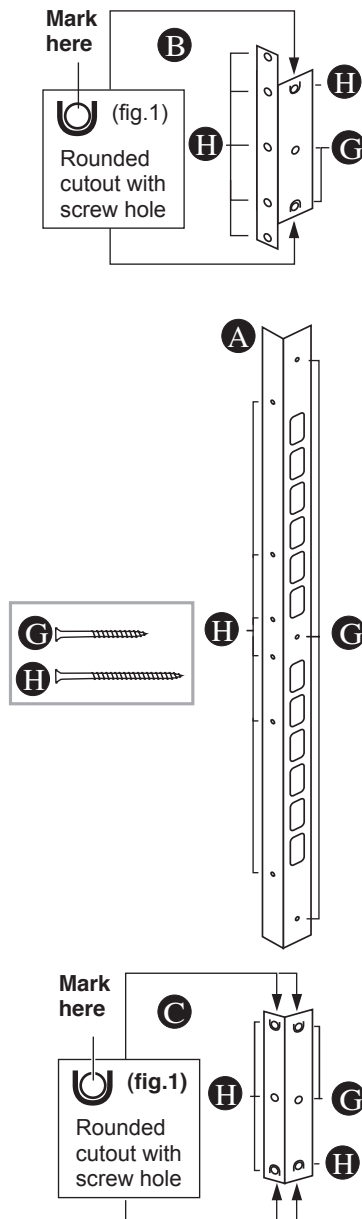

4. Re-install the support piece. Ensure the circular tab is positioned over the previously drilled hole as detailed in step 2.

5. While ensuring the piece stays aligned, pre-drill the holes on the interior trim edge of the support with a 11/64th-inch drill bit and install the supplied 3-1/2 inch screw **H**. The hole positioned over the rough frame should be predrilled and also receive a 3-1/2 inch screw.

6. Pre-drill the door side screw holes with 9/64th-inch drill bit and install the central side 2-1/2 inch screw **G** into the support on the jamb, as detailed.

**!** Be sure to use a screw that will not come into contact with the glass of the side light.

The side screws should go through both the support piece, the door jamb and extend into the adjacent side light panel.

7. With a pin punch or other appropriate blunt instrument and hammer, tap the cutout tab so that it bends into the predrilled 1/2-inch hole.

(If there is difficulty due to hole misalignment, enlarge the hole slightly to accommodate the bending of the tab)

The upper tab should be positioned so that when the screw is installed, maximum penetration into the upper rough frame can be realized.

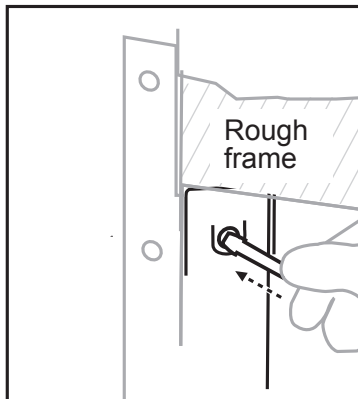
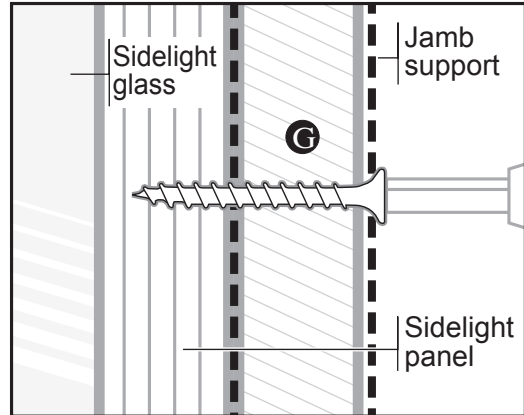
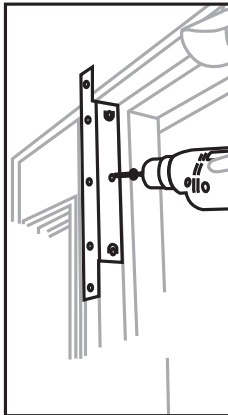
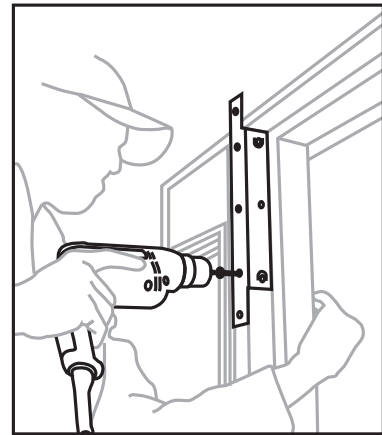
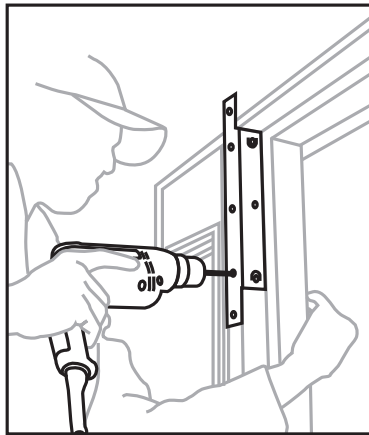

Screw guide tab

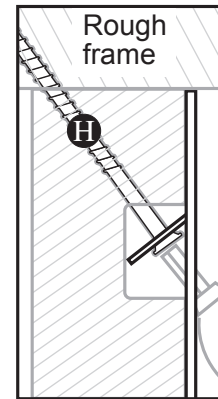
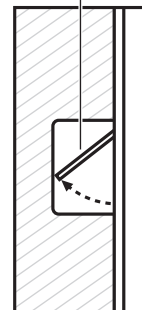

8. Pre-drill the hole in the upper tab with 9/64th-inch drill bit ensuring the drill bit goes on an upward angle through the vertical doorjamb, upper horizontal jamb and as far as possible into the upper rough frame. Secure the upper tab with the supplied 3-1/2 inch screw **H**.

9. Pre-drill remaining holes with 9/64th-inch or 11/64th-inch drill bit and insert screws, using 3-1/2 inch or 2-1/2 inch screws where appropriate.

**!** Again ensure the drilling and the screws will not contact the glass of the sidelight.

## Lower Lock Side Shield

1. Locate the Lower Jamb Shield support **C** for the same vertical door jamb, (2) 2-1/2 inch **G** and (4) 3-1/2 inch screws **H**.

2. Place the support on the lower portion of the door jamb, just off of the sill plate (between 1/16th-inch and 1/8th-inch if possible).

3. There are (4) rounded cutouts (fig. 1) with the screw holes in their center that will be located on the inside edge (2) and door side (2) of the support piece. The lower cutouts will be positioned to attain maximum penetration into the floor at the bottom.

4. Hold the piece in position on the jamb making sure the long leg extends along the door side of the door jamb. Ensure the door side edge of the support leg slides behind the weather stripping.

5. Take notice of the rounded cutouts with the screw hole in their center (fig. 1). Once the support piece is positioned properly, mark the center of the rounded cutouts with the screw hole in their center on the door jamb.

6. Remove shield and, with the 1/2 inch drill bit (only on the lower marked locations) drill 1/2-inch holes approximately 1/2-inch deep into the jamb at the lower marked locations.

As with the Upper Jamb Support, repeat the re-install, align and punching of circular tabs. This will only be done on the lower tabs in this instance and not the upper tabs.

Angle the lower tabs to obtain maximum penetration into the sill plate and floor. 11/64th-inch drill bit in the lower tabs ensuring the drill bit goes on a downward angle through the vertical door jamb, sill plate and as far as possible into the floor.

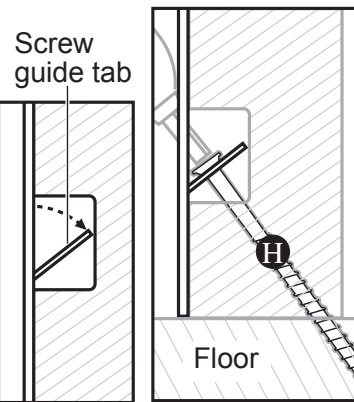
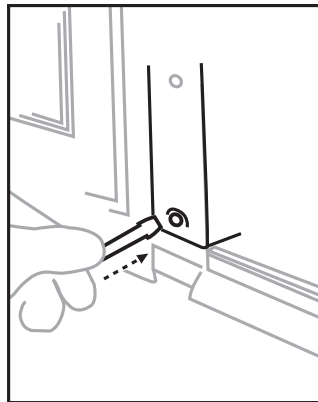
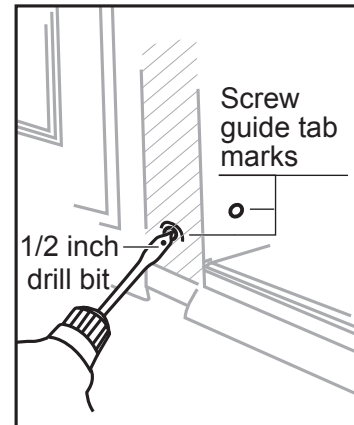
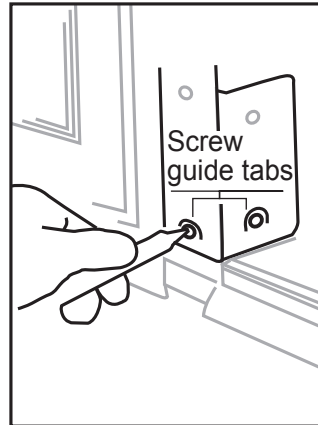
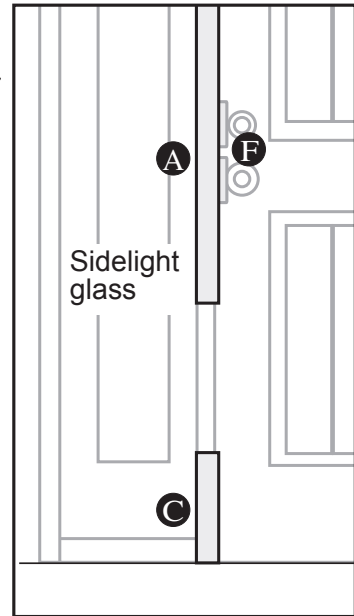
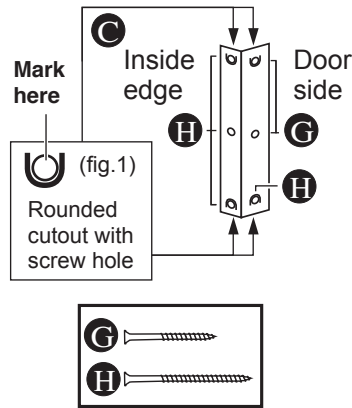

8. Secure the tabs with a supplied 3-1/2 inch screws **H**.

9. Pre-drill remaining holes with 9/64th-inch or 11/64th-inch drill bit and insert screws, using 3-1/2 inch or 2-1/2 inch screws where appropriate.

**⚠** Be sure to use a screw that will not come into contact with the glass of the side light.

## Center Lockside Shield

1. Locate the Center Jamb Shield support piece **A** with multiple cutouts along one side, (3) 2-1/2 inch **G** and (6) 3-1/2 inch **H** screws.

2. Position the piece along the center section of the lock side door jamb ensuring the lock bolt holes of the door jamb are aligned with the appropriate cutouts on the piece. With the component flush against the interior edge of the door jamb, predrill with 9/64th-inch drill bit and install the central side screw, from the door side, with the supplied 2-1/2 inch screw **G**.

Repeat for top and bottom screw holes.

**⚠** Be sure to use a screw that will not come into contact with the glass of the side light.

3. Pre-drill the holes on the interior 11/64th-inch drill bit and secure the Shield in place with the supplied 3-1/2 inch screws **H**.

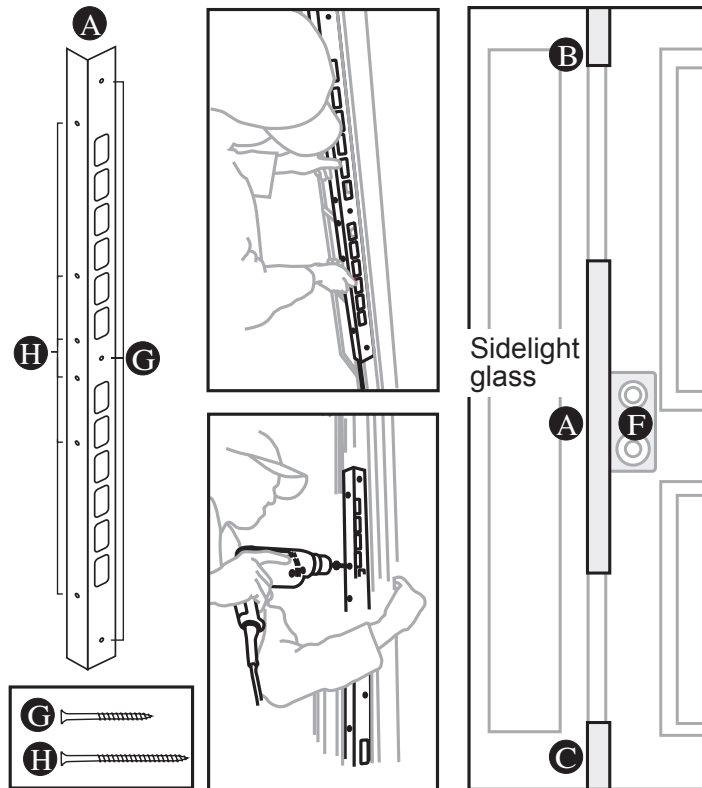

4. Clean all debris from the lock bolt holes and ensure the lock operates freely and engages smoothly into the holes of the Center Jamb Shield and door jamb.

## Upper Hinge Shield

1. Find the upper Hinge Shield support **D**, (5) 2-1/2 inch **G** and (7) 3-1/2 inch **H** screws.

2. Remove the screws attaching the upper hinge to the door. Save these screws as they will be needed to reattach the hinge to the door.

3. With the door hinge plate free, maneuver the support between the door and the jamb so that the unsecured hinge plate goes through the opening in the support.

4. Position the upper Hinge Shield on the doorjamb. One of the long tabs at the end of the piece should extend upward and the rounded cutout, with the screw hole in its center, (**fig. 1**) is located at the top of the door jamb and interfacing with the edge of the door slab.

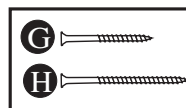
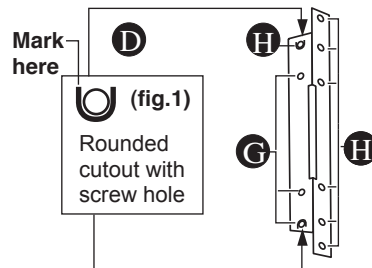

The upper tab should extend upward over the upper jamb with the screw hole coming to rest on the rough frame above the door. The lower tab should extend along and be flush with the interior edge of the door jamb.

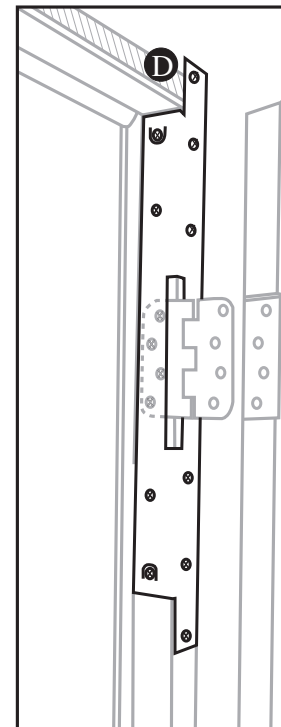



5. Hold the piece in position on the jamb, making sure that the long leg extends along the door side of the door jamb. Make sure the door side edge of the piece slides behind weather stripping.

Once the support piece is positioned properly, locate and mark the center of the top screw hole of the rounded cutout (**fig.1**) on the doorjamb.

6. Remove upper Hinge Shield. With a 1/2-inch drill bit, drill a 1/2-inch hole approximately 1/2-inch deep into the jamb at the marked location.

7. Remove the two screws, from the upper jamb side hinge plate, closest to the weatherstripping. Pre-drill these holes with the 9/64-inch drill bit. Now drive a 2-1/2 inch screw **G** into each of these holes, ensuring the screw heads come to rest flush the hinge plate.

8. Re-install the support piece and ensure it is located so the circular tab is positioned over the previously drilled hole and the piece is still properly positioned, as detailed in step 5.  
(If there is difficulty due to hole misalignment, enlarge the hole slightly to accommodate the bending of the tab)

9. With a pin punch or other appropriate blunt instrument and hammer, tap the cutout tab so that it bends into the predrilled 1/2-inch hole.

The upper tab should be positioned so that when the screw is installed, maximum penetration into the upper rough frame can be realized.

10. Pre-drill the hole in the upper tab ensuring the drill bit goes on an upward angle through the vertical door jamb, upper horizontal jamb and as far as possible into the upper rough frame. Then secure the upper tab with the supplied 3-1/2 inch screw **H**.

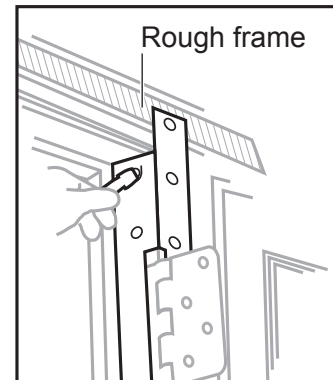
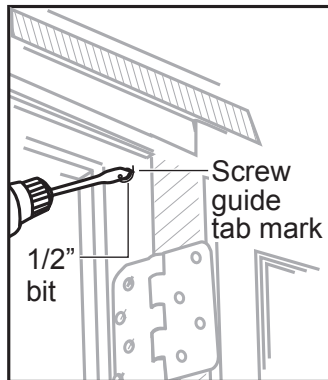
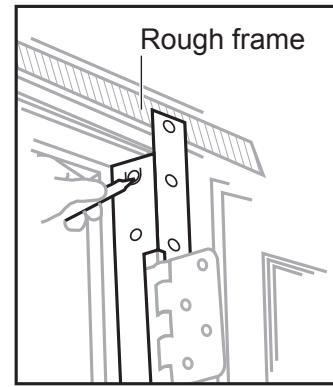
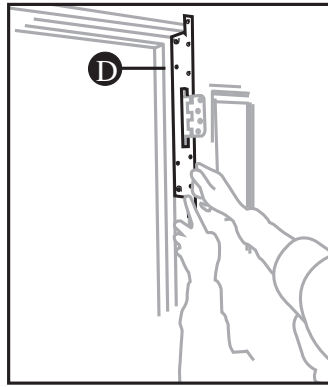

NOTE: Above, door is removed for illustrative purposes only. Application or hinge shield should not require removal of door.

11. Again, while ensuring drilling and screws do not contact the glass of the sidelight, predrill with 9/64th-inch drill bit and install all other screws as detailed.

12. Reattach the hinge to the door with the previously removed screws.

**⚠ Be sure to use a screw that will not come into contact with the glass of the side light.**

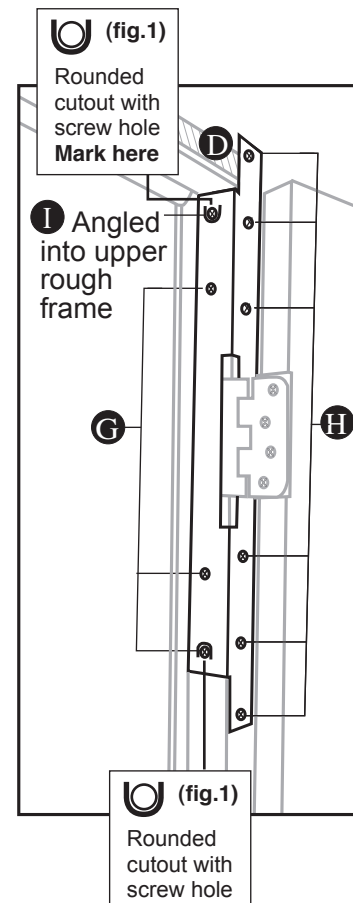



## Lower Hinge Shield

1. Locate the lower Hinge Shield support **E**, (5) 2-1/2" **G** and (5) 3-1/2" **H** screws.

2. Remove the screws attaching the lower hinge to the door. Save these screws as they will be needed to reattach the hinge to the door.

3. With the door hinge plate free, maneuver the support between the door and the jamb so that the unsecured hinge plate goes through the opening in the support.

4. There are four (4) rounded cutouts (**fig. 1**) with the screw holes in their center that will be located on the inside edge (2) and door side (2) of the support piece. The lower tabs will be positioned so as to attain maximum penetration into the floor.

5. Hold the piece in position on the jamb. Ensure the door side edge of the support slides behind the weather stripping.

Once the support piece is positioned properly, mark the center of the rounded cutout of the lower tabs on the door jamb (**fig. 1**).

6. Remove shield and with a 1/2-inch drill bit, drill 1/2-inch holes approximately 1/2-inch deep into the jamb at the marked locations.

7. Remove the two screws from the lower jamb side hinge plate, closest to the weatherstripping. Pre-drill these holes with the 9/64-inch drill bit. Now drive a 2-1/2 inch screw **G** into each of these holes, ensuring the screw heads come to rest flush the hinge plate.

8. As with the upper Hinge Shield, repeat the re-install, align and punching of the circular tabs.

Angle the lower tabs to obtain maximum penetration into the sill plate and floor.

9. Pre-drill center holes with a 11/64th-inch drill bit in the lower tabs ensuring the drill bit goes on a downward angle through the vertical door jamb, sill plate and as far as possible into the floor.

10. Secure the lower tabs with a supplied 3-1/2 inch screws **H**.

11. Pre-drill with 9/64th-inch drill bit and install all other screws as detailed.

**⚠ Be sure to use a screw that will not come into contact with the glass of the side light.**

12. Reattach the hinge to the door with the previously removed screws.

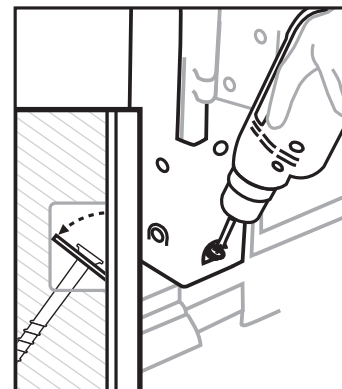
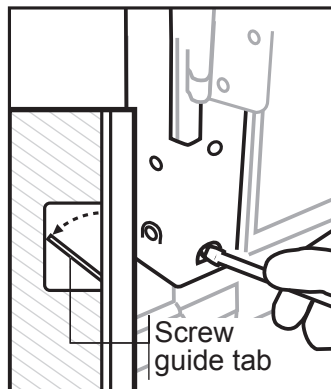
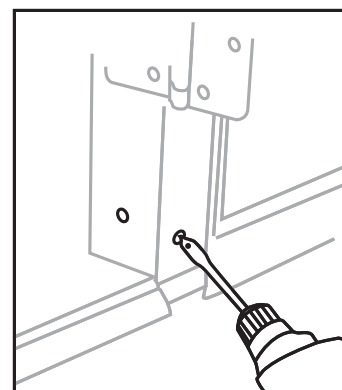
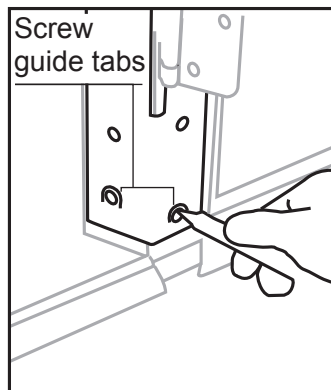
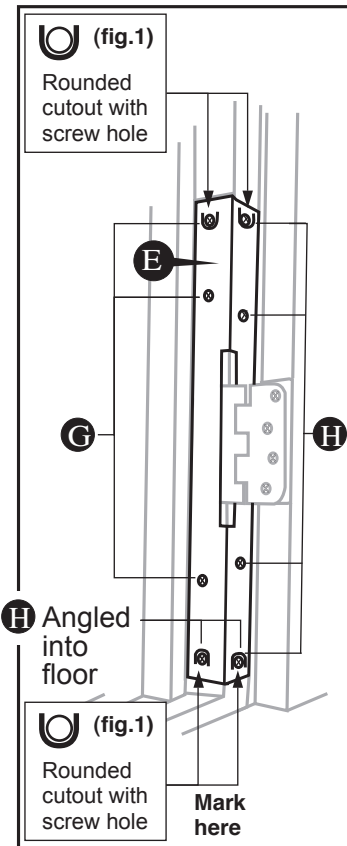

## Finishing

1. Once installation is complete verify the door is true and operates correctly. If not take the necessary steps to ensure proper operation and then proceed.
2. Install the interior trim molding and caulk as necessary.

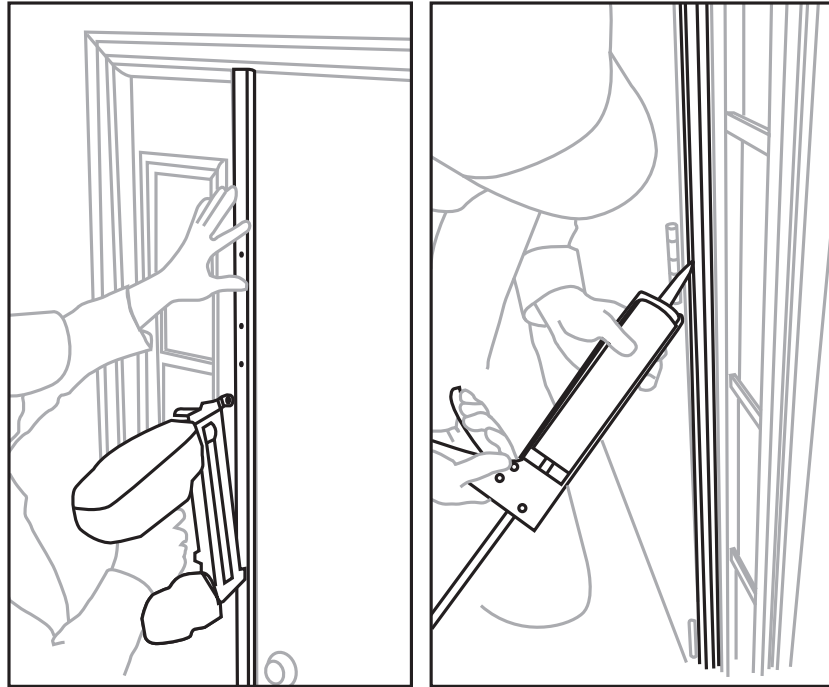

NOTES: \_\_\_\_\_

[illegible]

**Armor Concepts has products for most style doors**  
**For more products and information, contact Armor Concepts, LLC**  
Call customer service at 1-888-582-2294 or visit [www.armorconcepts.com](http://www.armorconcepts.com)



**Fix it Once...Secure it Forever**  
**Door Jamb Armor**  
**The Ultimate Door Security and Repair Solution**  
Armor Concepts LLC • (888) 582-2294