



07600C

Please read the following instructions carefully.

Keep this instruction manual for future reference.

For technical support, contact us at **1-401-671-651**

or **www.summerinfant.com/contact**

Tools required: Phillips head screwdriver,
measuring tape (not included), and wrench (included).

For use with children from 6 - 24 months.

Keep small parts away from children.

Adult assembly required.

Fits openings from 28.5 in. - 48 in. wide.

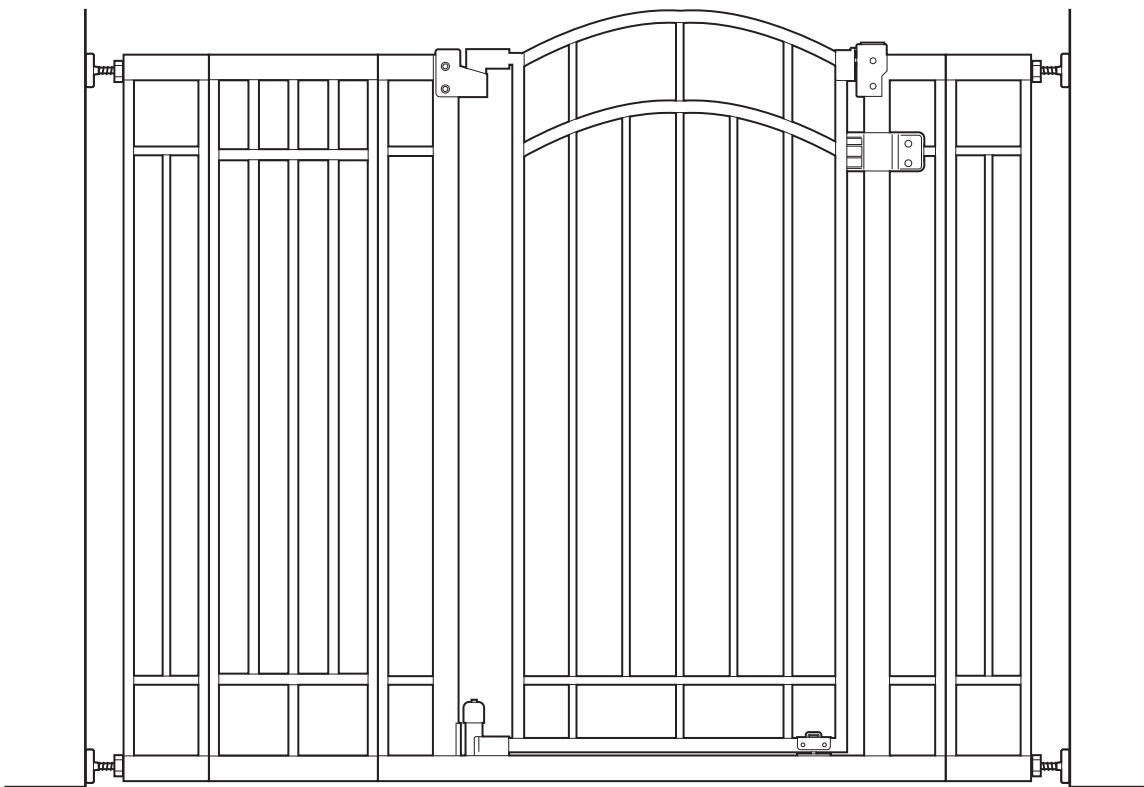

Multi-Use Deco Extra Tall Walk-Thru Gate

INSTRUCTION MANUAL

Thank you for purchasing the Multi-Use Deco Extra Tall Walk-Thru Gate from Summer Infant. This gate allows you to create and maintain a secure environment for your child just about anywhere in your home. It has a hinged swinging door that opens easily in either direction with one hand, as well as hold-open and auto-close features for added convenience.

WARNING

- Children have died or been seriously injured when gate is not securely installed. **ALWAYS** install and use gate as directed using all required parts.
- **STOP** using when a child can climb over or dislodge the gate.
- Use only with the locking/latching mechanism securely engaged.
- To prevent falls, never use at top of stairs without wall mounting cups and door stopper.
- **NEVER** use to keep child away from pool.
- **NEVER** leave child unattended.
- Always close and lock the gate behind you.
- This product will not necessarily prevent all accidents.
- Do not use if any components are missing or damaged.
- Adult assembly required. Exercise care when unpacking and assembling product.

 **CAUTION:** KEEP SMALL PARTS OUT OF CHILD'S REACH.
IMPORTANT – Read the instructions carefully before use and keep them for future reference.

components:

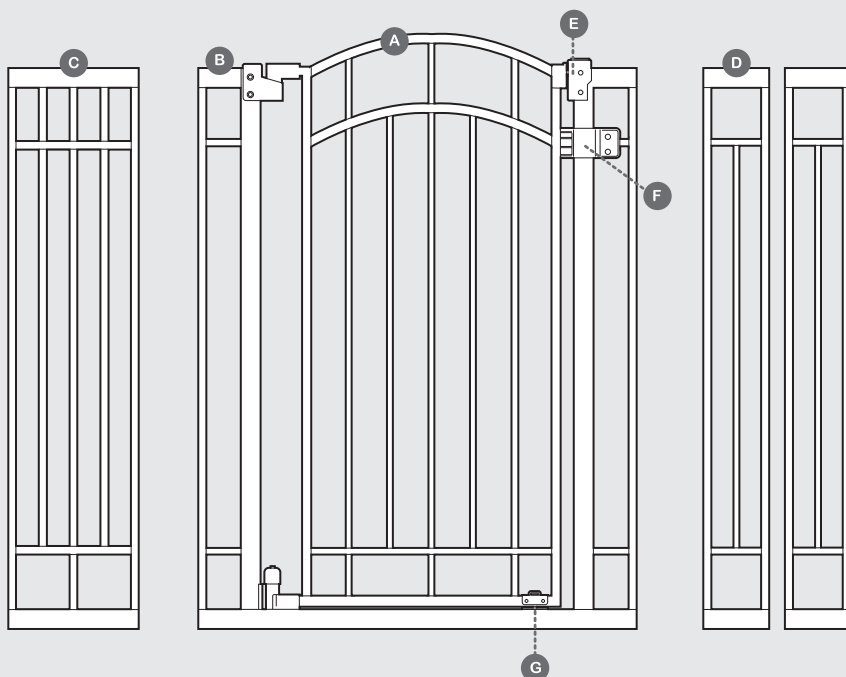

- | | |
|-------------------------------------|--|
| A Gate Door | H Extension Pins (6) |
| B Gate Frame | I Tension Bolts with Tension Nuts (4) |
| C Long Extension Frame | J Adhesive Mounting Pads (4) |
| D Short Extension Frames (2) | K Wall Cups (4) |
| E Top Latch | L Wall Anchors (4) |
| F Door Stop | M Screws (4) |
| G Lower Latch | N Wrench |

hardware:

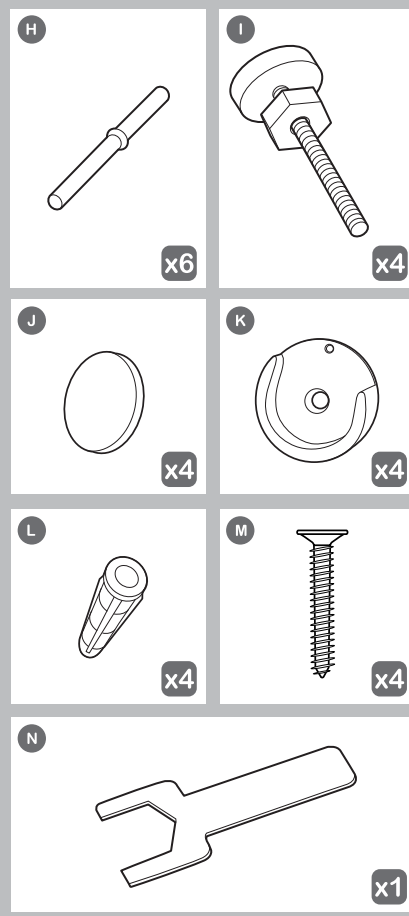

gate configurations (choose which best fits your scenario):



Measure the width of the opening where you intend to install the gate. Refer to the following illustrations to determine the correct installation configuration. Baseboard molding may change which configuration is appropriate.



WARNING

NEVER install three extension frames on the same side of the gate.

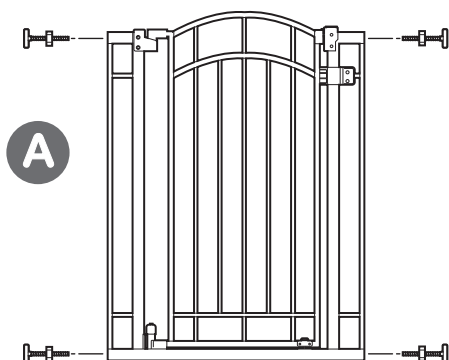

(28.5 in.- 32 in.) without extension frames

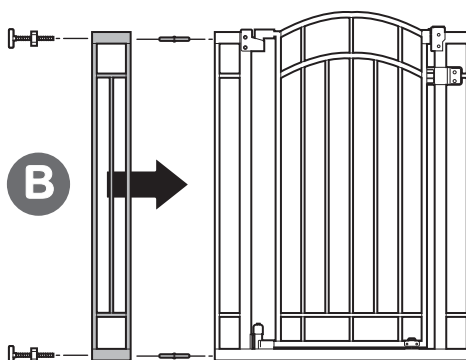

(32.5 in.- 36 in.) with one short extension frame

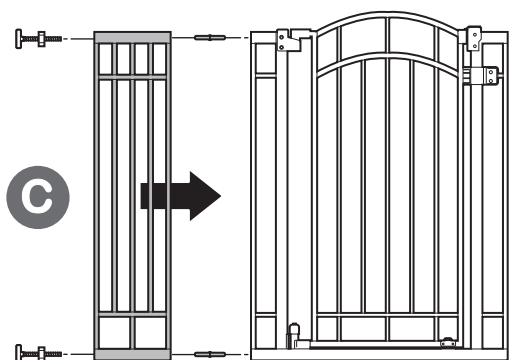

(36.5 in.- 40 in.) with one long extension frame

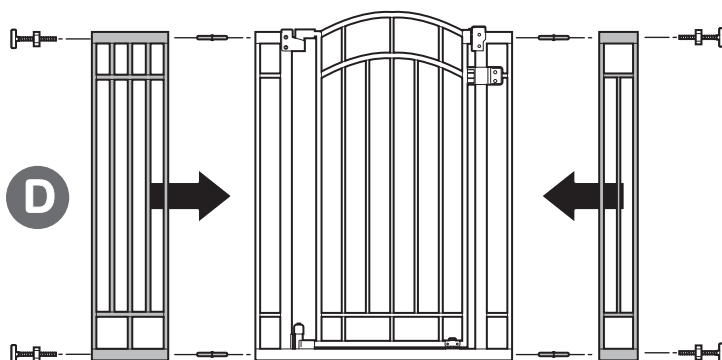

(40.5 in.- 44 in.) with one short and the long extension frames

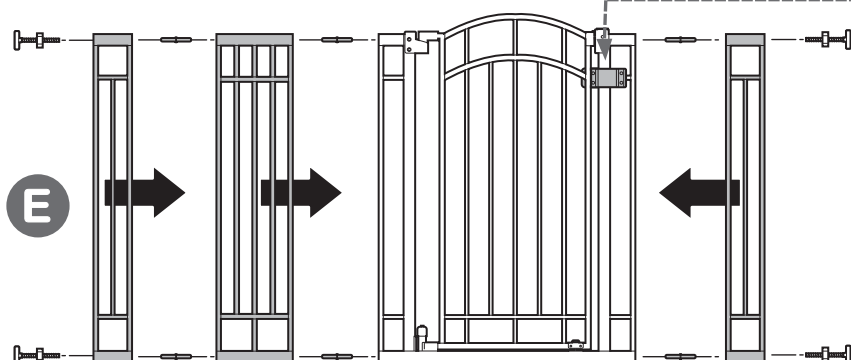

(44.5 in.- 48 in.) with both short and the long extension frames

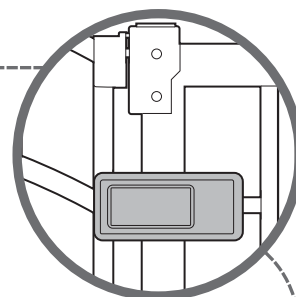

Important: Gate includes a door stop (part F in components) which prevents the the gate from swinging open in one direction. When installing the gate at the top of stairs, be sure that the door stop is on the stairway side of the gate so the door cannot open over the stairs. While the door stop comes fully assembled on gate, it can be removed and installed on either side of gate frame.

When gate is not used at top of stairs, door stop may be removed to allow gate door to open in either direction.



Note: This instruction book illustrates installation of gate configuration E.

- If choosing gate configuration A, skip step 4.
- If choosing gate configuration B, add only one short gate extension to either side of the gate frame in step 4.
- If choosing gate configuration C, add only the large gate extension to either side of the gate frame in step 4.
- If choosing gate configuration D, add only one short gate extension and the long extension to either side of the gate frame in step 4.

installation:



- If choosing gate configuration A, skip this step.
- If choosing gate configuration B, add only one short gate extension to either side of the gate frame.
- If choosing gate configuration C, add only the large gate extension to either side of the gate frame.
- If choosing gate configuration D, add only one short gate extension and the long extension to either side of the gate frame.

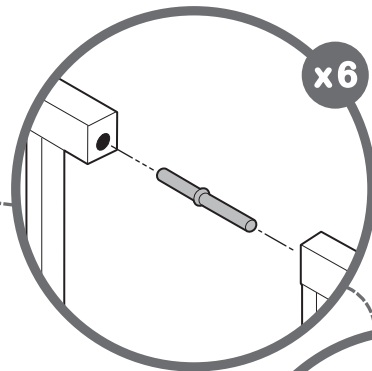
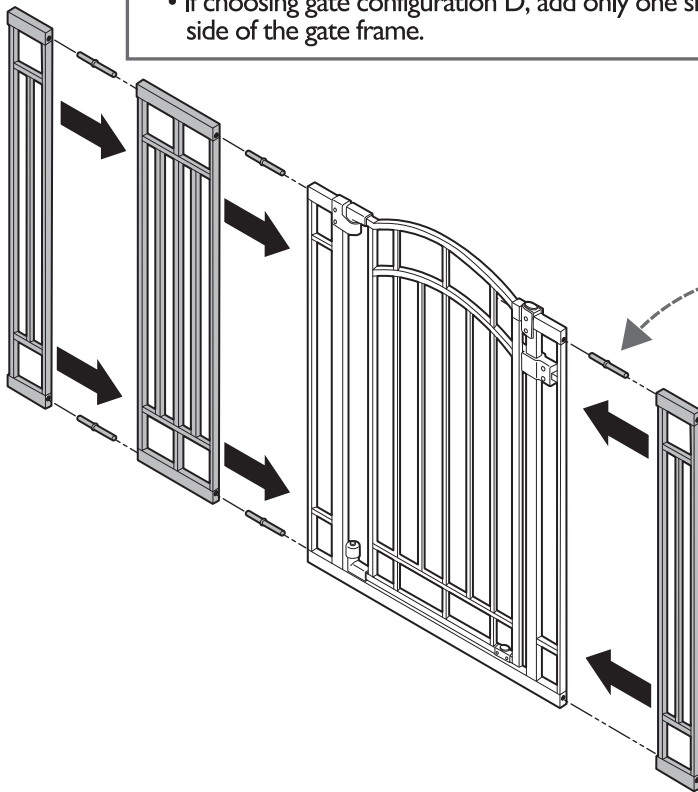

Connect the extension frames to gate frame by inserting the pins into the holes in the gate and extension frames.

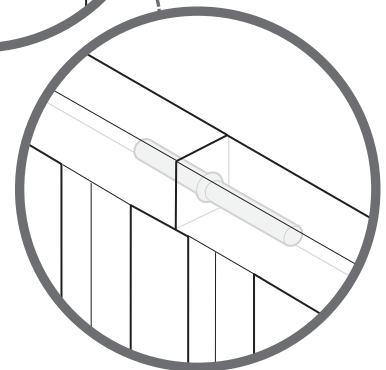

4

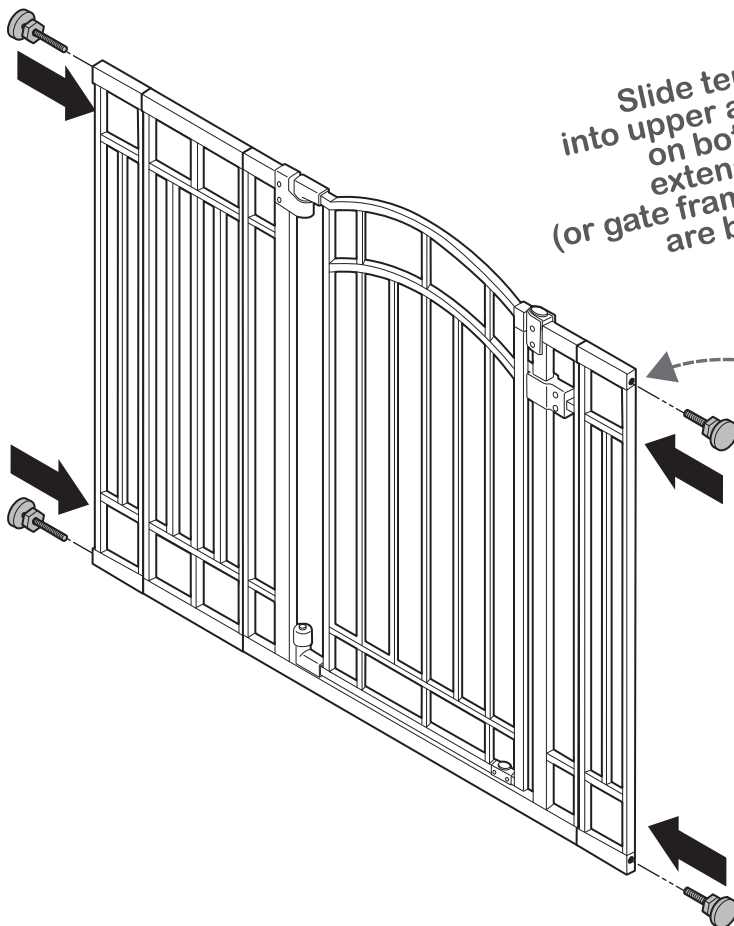

Slide tension bolts into upper and lower holes on both sides of extension frames (or gate frame if no extensions are being used).

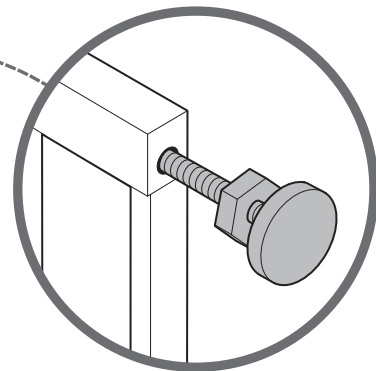

5

installation (continued):

Stand the gate
in the center
of the opening.
Make sure the bottom
of the gate is completely
flush to the floor.
Slide tension bolts out
until they contact
the door frame
or wall on
both sides.

Check distances
A & B. They should
never exceed
2.75 in.

Make sure door stop is facing desired direction.
For top of stair use, door stop must be on stair
side of gate. Gate door must open away from
stairs.

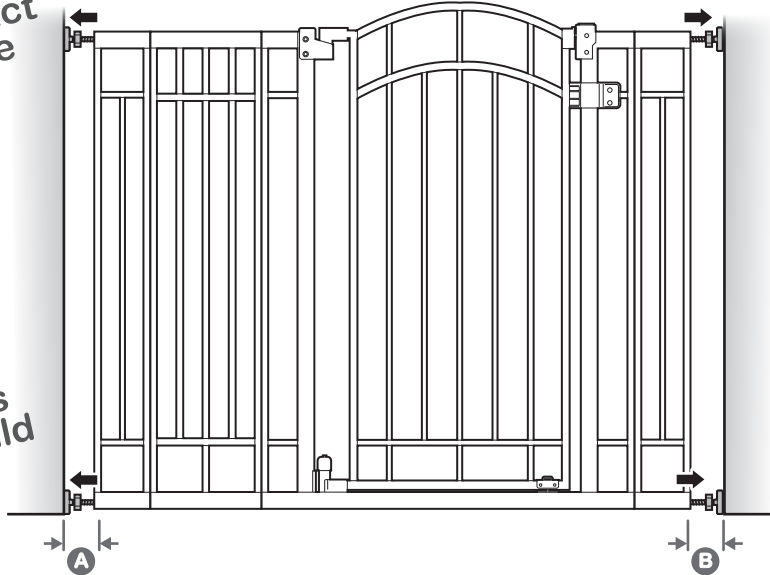
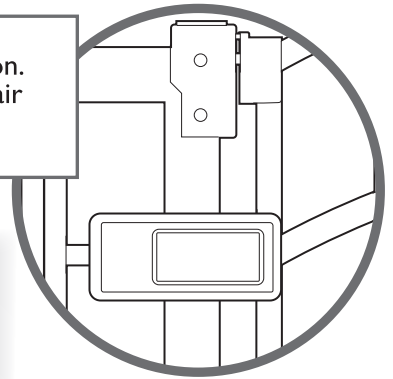

IMPORTANT

The distance between
the gate and the wall
should never exceed
2.75 in.

6

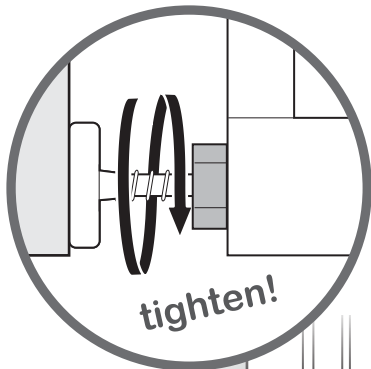

Use the tension nuts
to tighten both of the
bottom tension bolts.

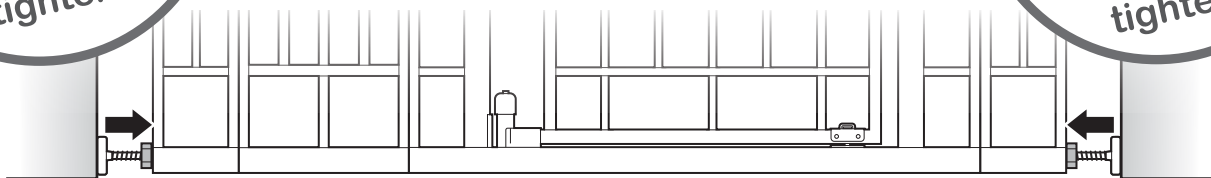
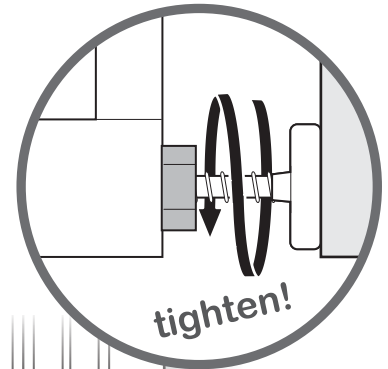

7

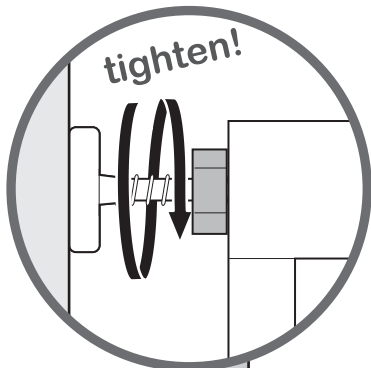

Use the tension nuts
to tighten both of the
top tension bolts.

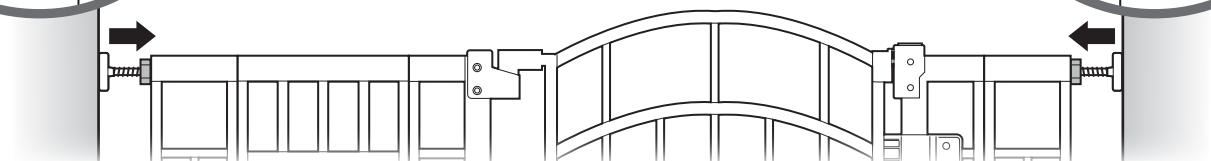
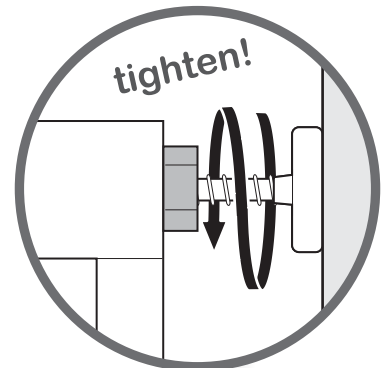

8

STOP! wall cup/top of stairs installation:

WARNING

For use at top of stairs, wall cup installation is **MANDATORY**.

Follow these wall cup installation instructions when using gate at **TOP OF STAIRS (MANDATORY)**, or if using wall cups for a standard opening (optional). If opting not to use wall cups for a standard opening, skip ahead to step 17.

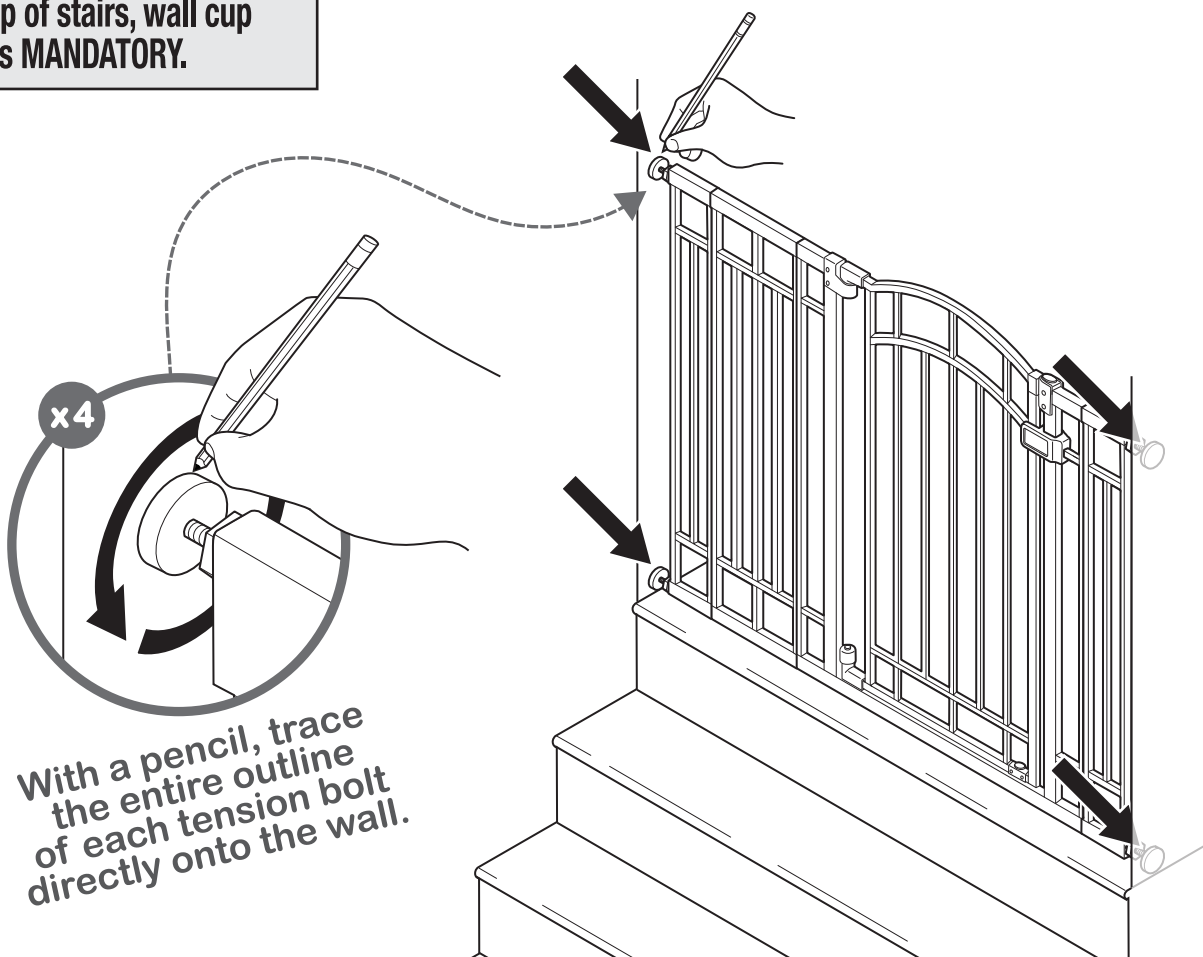

9

Loosen the lower and upper tension nuts and remove gate.

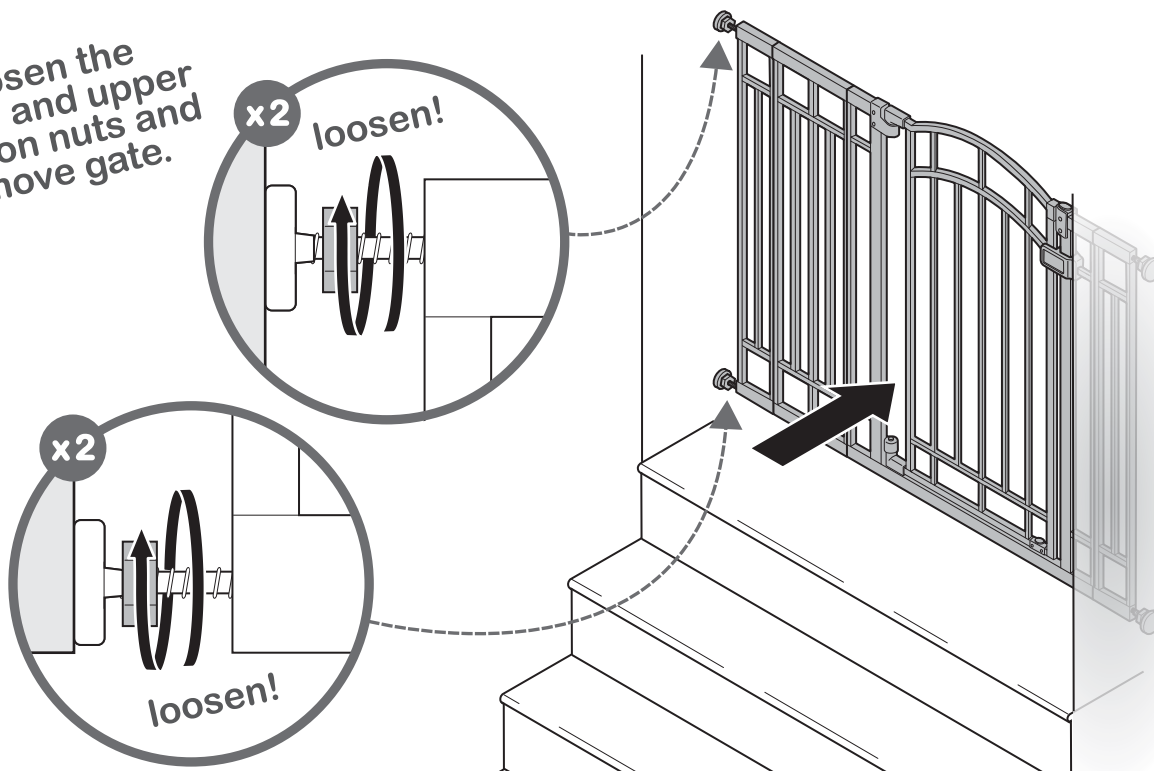

10

wall cup/top of stairs installation (continued):

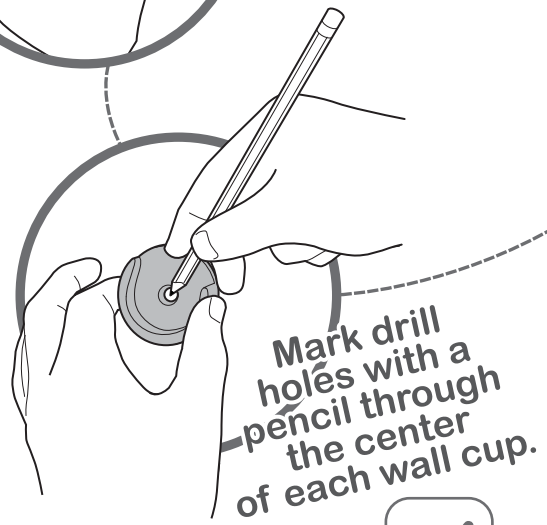
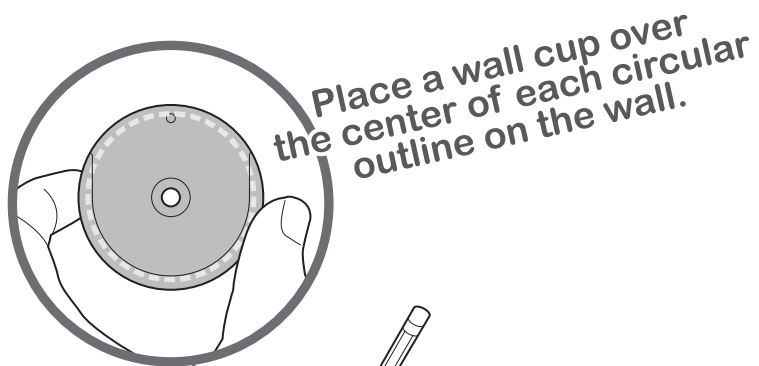

x4

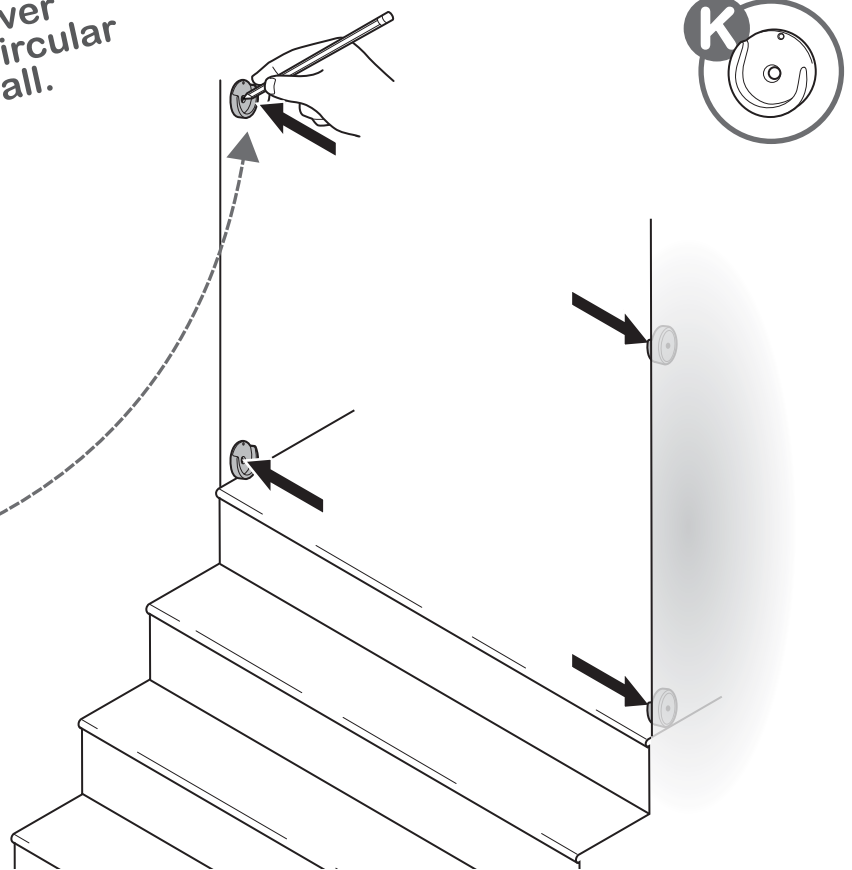

11



Note: If mounting directly into wood, skip this step.

1st
Drill a 7/32" pilot hole into each of the 4 center marks.

2nd
Insert wall anchors into pilot holes.

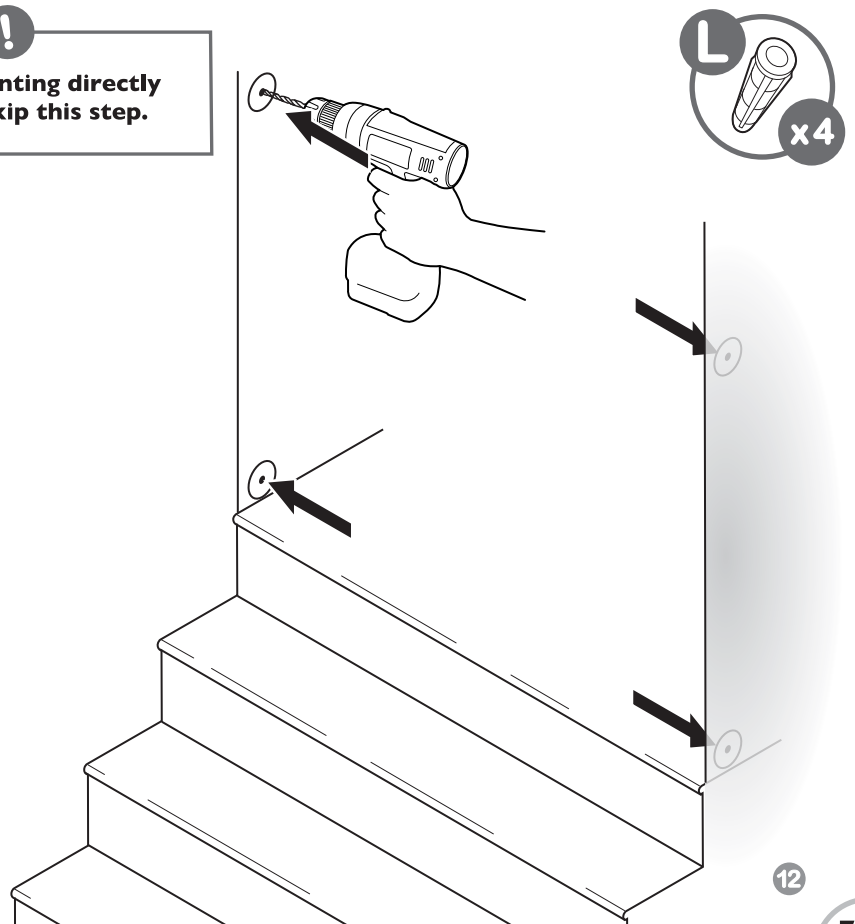

12

wall cup/top of stairs installation (continued):

1st
Remove backing
from one side of each
adhesive mounting pad.

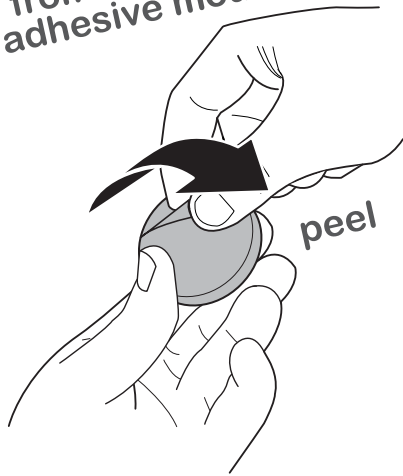

2nd
Attach one pad to
the back of each
wall cup.

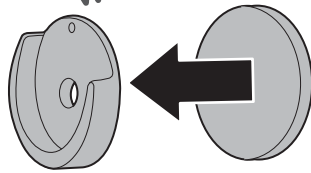

3rd
Remove
backing.

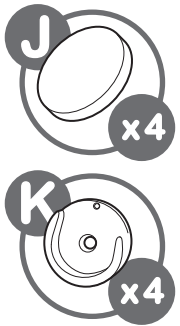
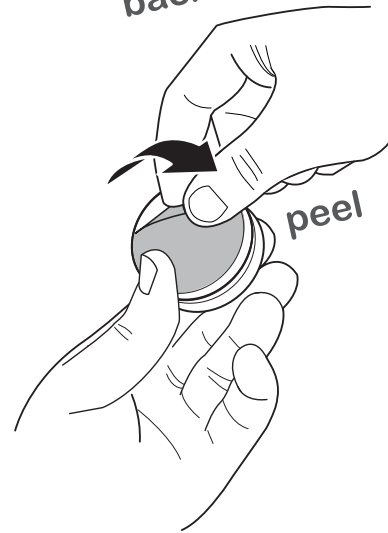

13

Align the wall cups so
the center hole
is placed directly
over the wall anchor.
Stick the wall cups
to the wall.

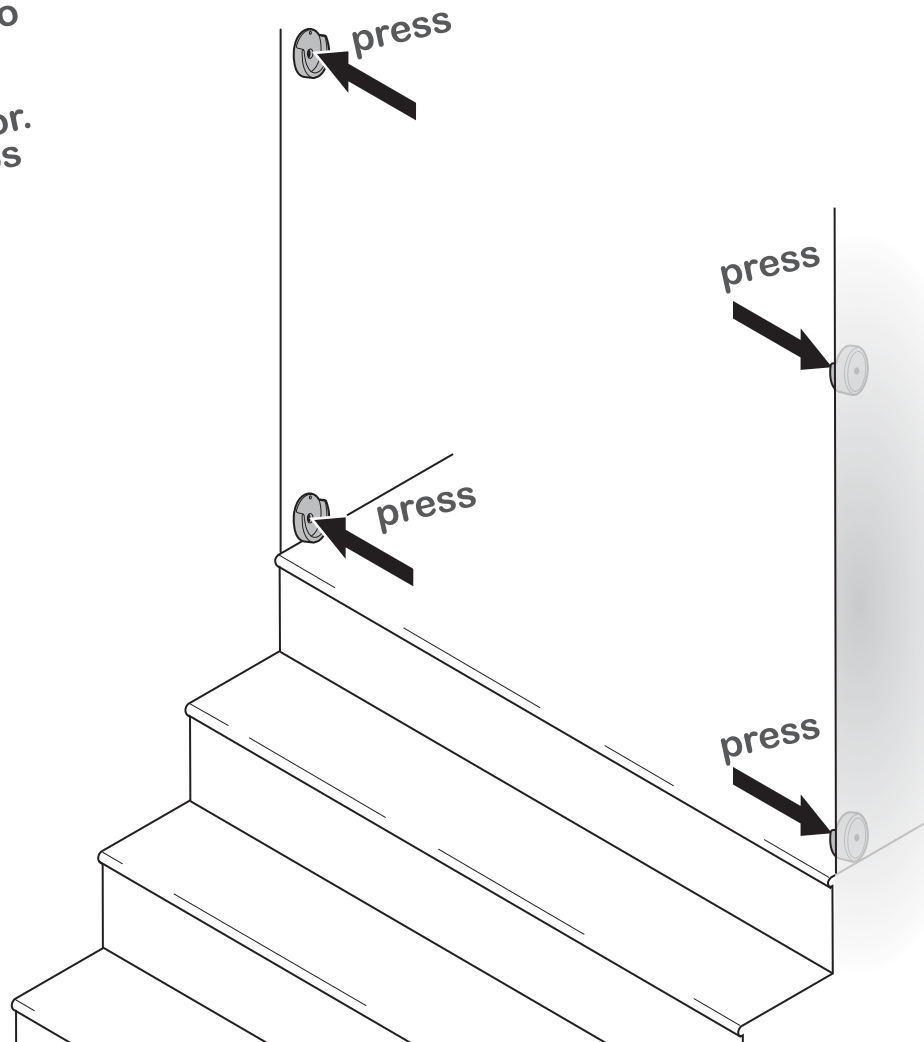
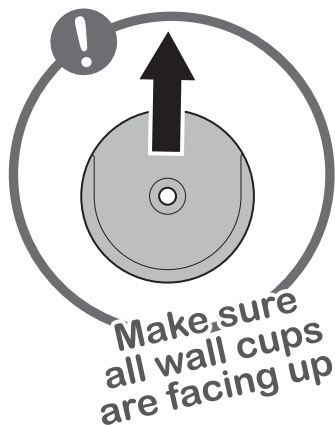

wall cup/top of stairs installation (continued):



Screw
wall cups
into wall.

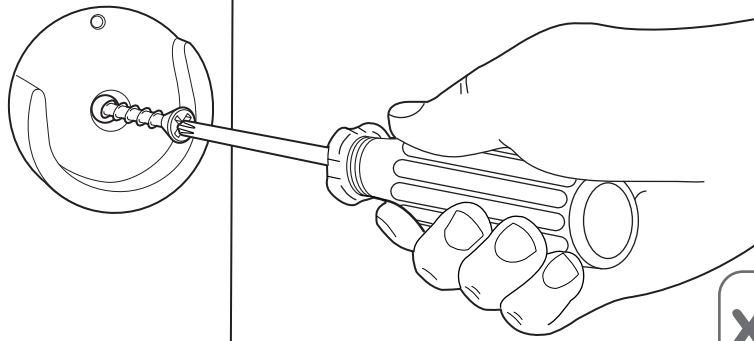
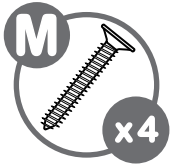

x4

15

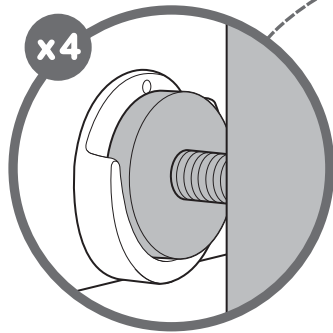

Repeat "installation"
steps on page 5.
The 4 tension bolts
will rest within
each wall cup.



IMPORTANT

NEVER open gate door over stairs.

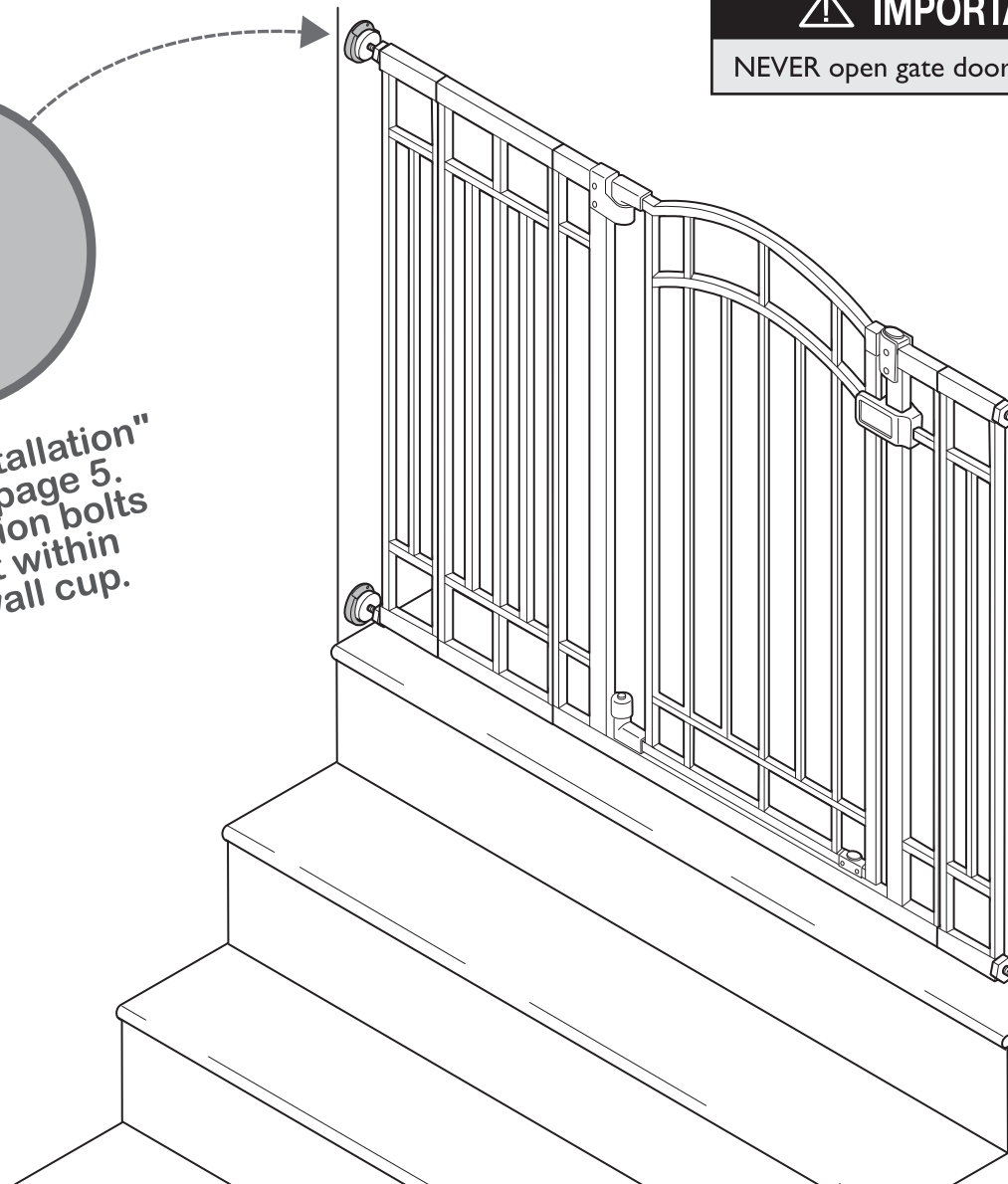

16

wall cup/top of stairs installation (continued):

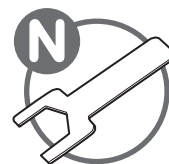

Tighten all 4
tension nuts
with the provided
wrench.

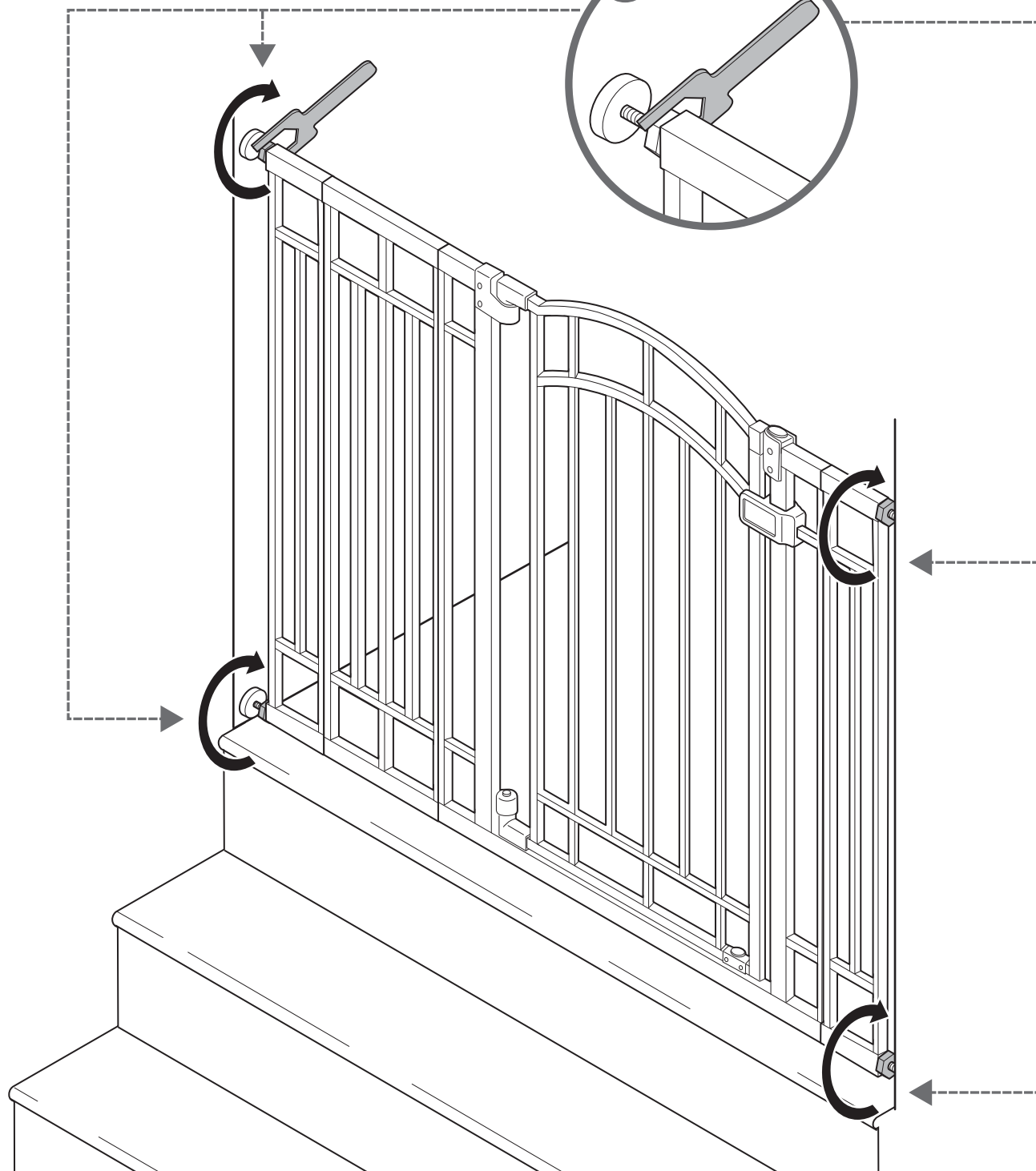
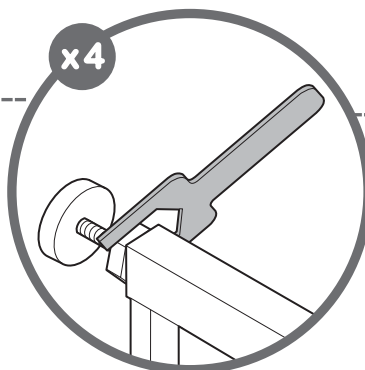

FINISHED!

testing the installation:

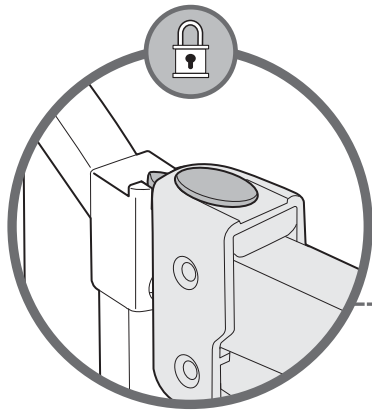

1st
Close the gate.
Make sure the
upper and lower
latches lock
securely.

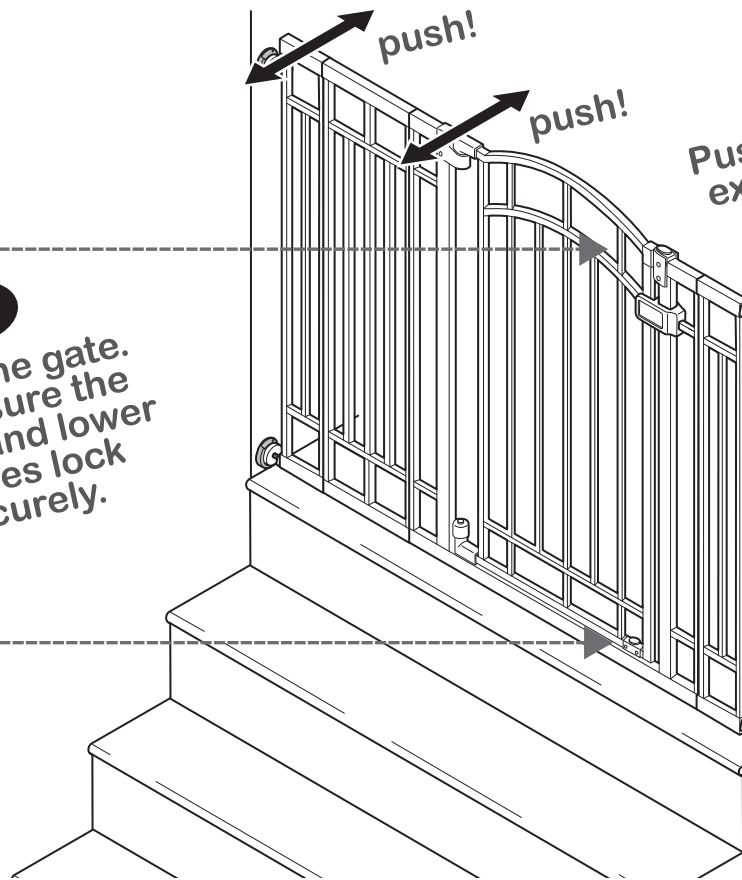
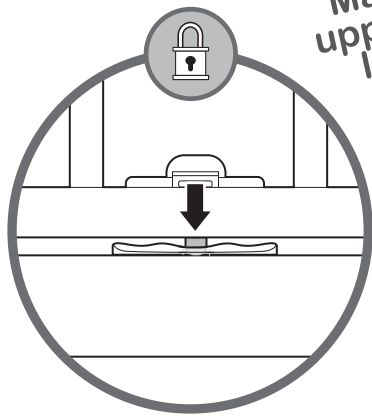

2nd
Push the gate and
extension frames
to check
stability.

operation:



to unlock gate:

Slide locking tab back
to release, lift gate
door open.

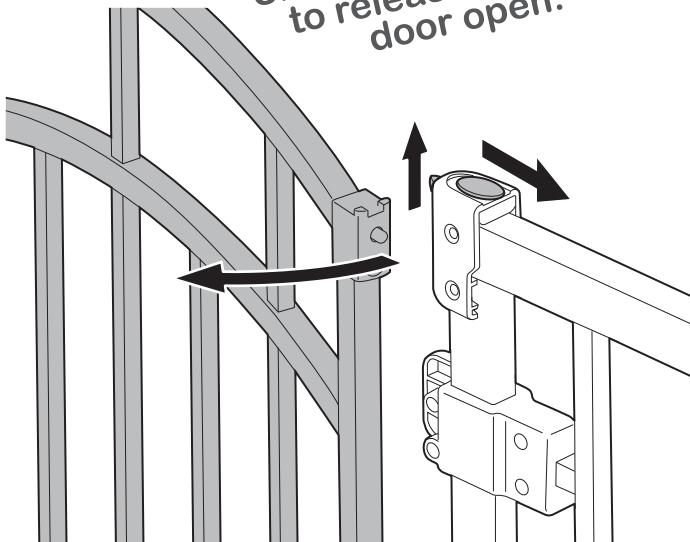

hold open feature:

To activate,
open gate door
at least 90° in
either direction.

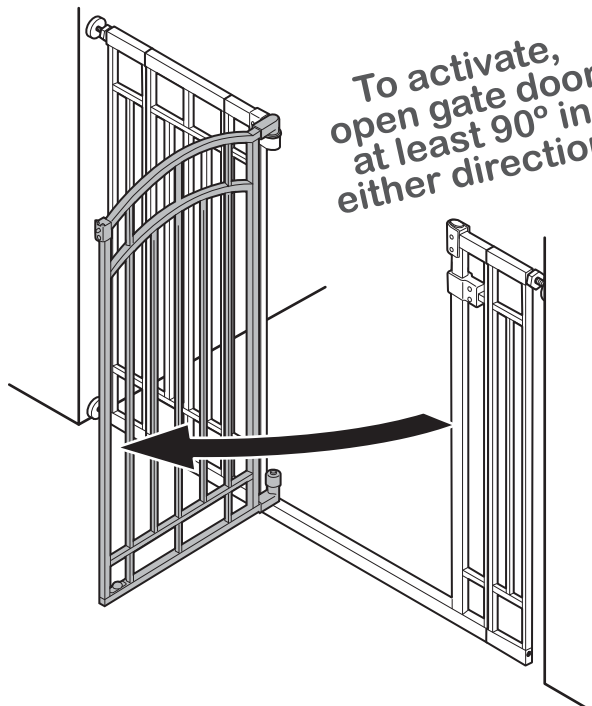

troubleshooting:

If the gate does not close properly:

1. Gate is not properly aligned in the door frame.

Solution: Make sure the gate is properly aligned on the door frame. To adjust the gate's alignment, loosen all four tension bolts and reposition gate so that it matches the "correct" image. Re-tighten tension bolts.

2. Pressure of tension bolts needs to be adjusted.

Solution: Loosen or tighten the upper tension bolts. Ensure the upper latch engages securely when the gate swings closed and that it can be released properly when the sliding lock tab is pushed back.

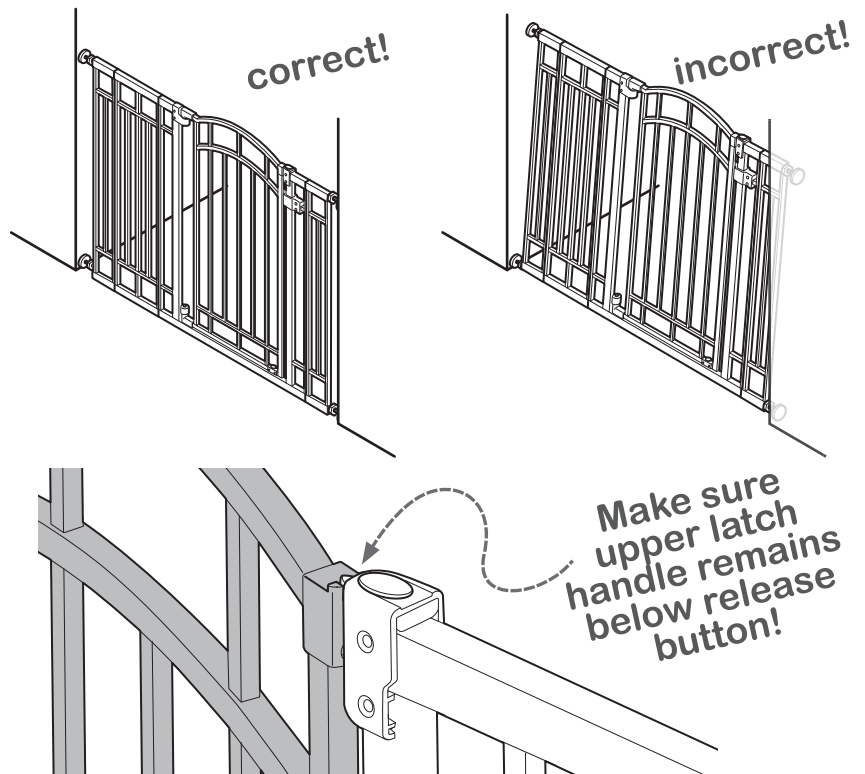

maintenance:

- Regularly check tension bolts to make sure the gate is securely in place.
- Do not use the gate if any components are damaged or missing.
- Surface clean with a damp cloth or sponge using mild detergent and warm water.

Summer Infant stands behind all of its products. If you are not completely satisfied or have any questions, please contact our Consumer Relations Team at **1-401-671-6551** or **www.summerinfant.com/contact**

Summer Infant (USA), Inc.

1275 Park East Drive
Woonsocket, RI 02895 USA
1-401-671-6551
© 2018 Summer Infant, Inc.

Please retain information
for future reference.
Colors and styles may vary.
MADE IN CHINA.