



Thank you for selecting JELD-WEN products. Attached are JELD-WEN's recommended installation instructions for Wood Pocket Door Frames. Read these instructions thoroughly before beginning. They are designed to work in most existing applications, however; existing conditions may require changes to these instructions. If changes are needed, they are made at the installer's risk. For installations other than indicated in these instructions, contact a building professional.

NOTE TO INSTALLER: Provide a copy of these instructions to the building owner. By installing this product, you acknowledge the terms and conditions of the limited warranty as part of the terms of the sale.

SAFETY AND HANDLING

Safety

- Read and fully understand **ALL** manufacturers' instructions before beginning.
- **DO NOT** work alone. **Two or more people are required.** Use safe lifting techniques.
- Wear protective gear (e.g. safety glasses, gloves, ear protection, etc.).
- Operate hand/power tools safely and follow manufacturer's operating instructions.
- Be cautious of plumbing and electrical lines when cutting into walls.

Materials & Handling

- Inspect the product for cosmetic damage and verify correct size.
- Heed material manufacturers' handling and application instructions.
- Handle in a vertical position; **DO NOT** carry flat or drag on the floor.
- **DO NOT** put stress on joints, corners or frames.
- Store in a dry, well-ventilated area in a vertical, leaning position to allow air circulation; **DO NOT** stack horizontally.
- Protect from exposure to direct sunlight during storage.

IF INJURY OCCURS, IMMEDIATELY SEEK MEDICAL ATTENTION!

MATERIALS AND TOOLS

Included Parts

- | | |
|----------------------------------|----------------------------------|
| • A - Face jamb | • F - Lock nut |
| • B - Top Track | • G - Hanger bracket |
| • C - Pre-assembled pocket frame | • H - (4) 1 1/2" pan head screws |
| • D - Wheel hanger | • I - Nylon guide |
| • E - Adjusting bolt | • J - Adjusting wrench |

Needed Tools

- | | |
|----------------------------------|----------------|
| • Tape measure | • Hammer |
| • Utility knife | • Screw gun |
| • Level (4' minimum recommended) | • 3 pound maul |

Needed Materials

- | | |
|-------------------|----------------------|
| • #10 x 2" screws | • Finishing supplies |
|-------------------|----------------------|

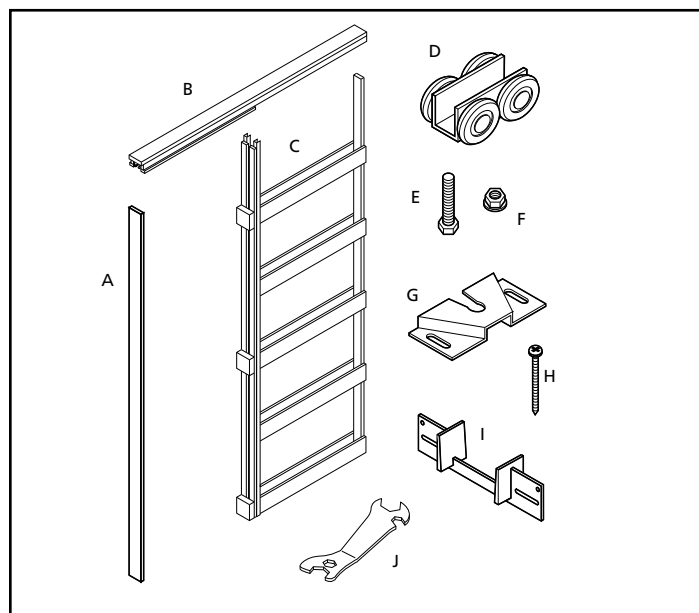

POCKET DOOR FRAME DIMENSIONS

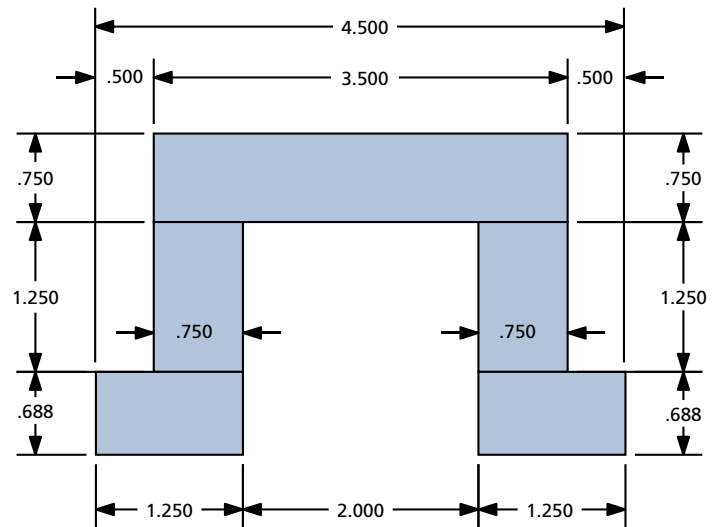

INSTALL FRAME

1. Remove the old door frame from the wall. Cut back the drywall to match the new opening.
2. Remove the floor plate and non-load-bearing wall studs.

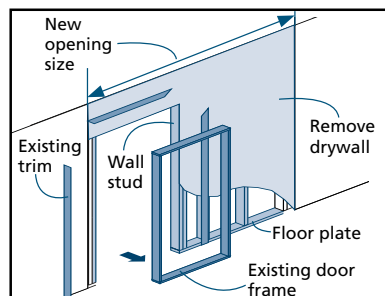

3. Frame the new rough opening with a new header and jambs as needed.

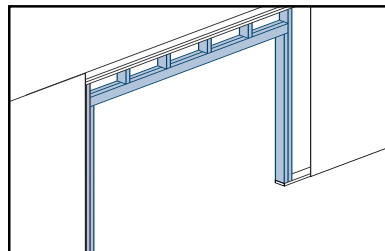

4. Finish the top track and face jamb as desired. Attach the top track to the pre-assembled pocket frame. The vertical split jamb aligns with the top track. Attach with screws.

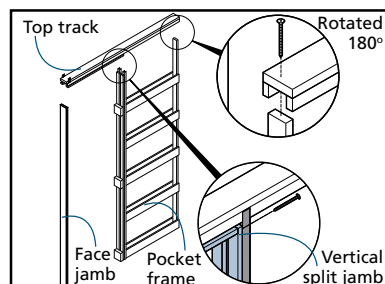

5. Set pocket frame and face jamb into the rough opening. Shim 4" from the corners and at 24" maximum intervals until square, level, and plumb.

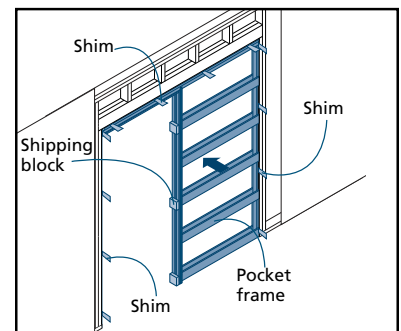

6. Drive a #10 x 2" screw through the pocket frame and each shim. Remove the shipping blocks.
7. Attach the nylon guide to the split jamb with nails.

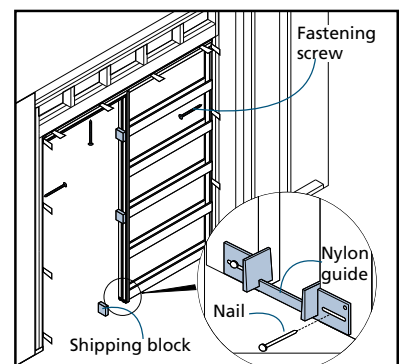

INSTALL FRAME (CONTINUED)

8. Install the hanger brackets on top of the door centered at 2 1/2" from each end.

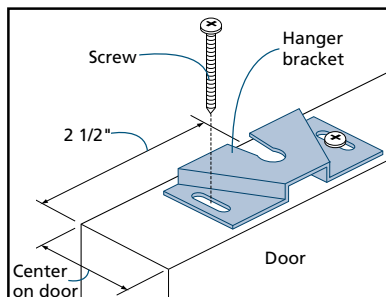

9. Slide the rollers into the top track.
10. Hang the door in the track. Lift and slide the hanger bracket onto the adjusting bolt head. To align the door, turn the adjusting bolt head with a wrench. When finished adjusting, tighten the lock nut down onto the bracket.

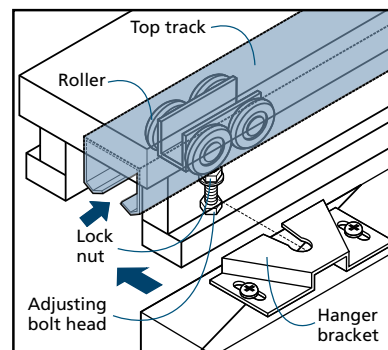

Please visit jeld-wen.com for warranty and care and maintenance information.

Thank you for choosing

JELD-WEN