

INSTALLATION

Product Manual

Version: KF260135-01



IMPORTANT INFORMATION!

please read the entire manual before starting to assemble and/or using this product. follow the manual thoroughly and keep it for further reference.



AVOID SCRATCHES!

In order to avoid scratching this furniture should be assembled on a soft layer-could be a rug.



IMPROVE EFFICIENCY !

Try to find a partner to install with you, which can speed up the installation efficiency and shorten the time.

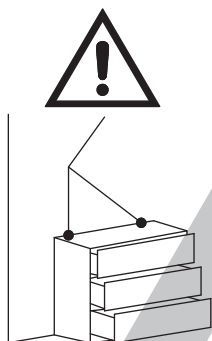

ANTI-TOPPLE WARNING !

Overturned furniture can cause serious or fatal crush injuries. To prevent tipping over, be sure to use the wall attachment, if not included with this product. Please purchase the wall attachment that fit your wall. If unsure, seek professional advice. Please read and follow each step of the instructions carefully.

IMPORTANT !

It is important that any product which is assembled using any kind of screw is re-tightened 2 weeks after assembly, and once every 3 months - in order to assure stability through-out the lifespan of the product.

For regular maintenance and cleaning of the product, for the frame, please use a rag dipped in neutral detergent to fully wipe it, and then dry it with a clean rag. For glass materials, wipe with a rag dampened with water glass cleaner, and then dry with a dry rag.

Do not use an electric screwdriver, and do not use too much force when installing, because the board is easy to break.

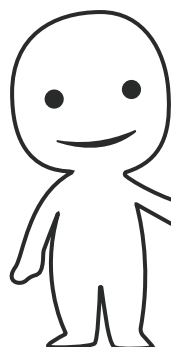

Please prepare the following tools

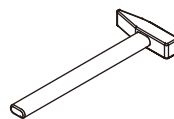
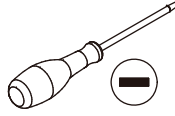
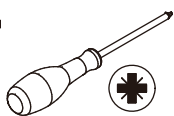
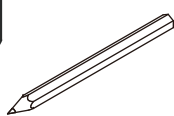

When installing, please carefully confirm whether each screw corresponds to the manual, accessories with similar shapes can be distinguished by size

Ax70

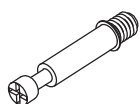

Ø6x35mm

Bx78

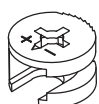

Ø15x10mm

Cx76

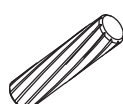

Ø6x30mm

Dx28



Ø4x35mm

Ex32



Ø3.5x12mm

Fx10



Gx6

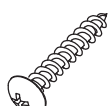

Ø4x25mm

Hx4



Ø4x15mm

Jx4

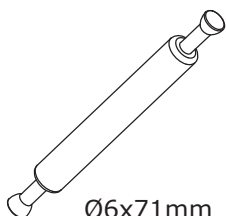

Ø6x71mm

Kx4

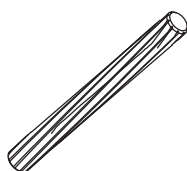

Ø6x50mm

Lx4



Mx2

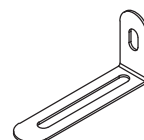

Nx4



Ø4x12mm

Px2



Qx18



Rx58



Ø2.5x12mm

Sx16

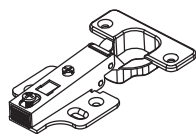

Tx96



Ø4x14mm

CLx2

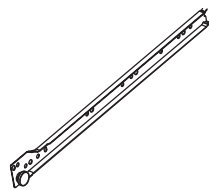

L350mm

CRx2

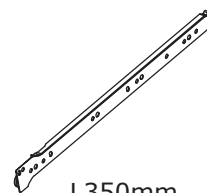

L350mm

DLx2

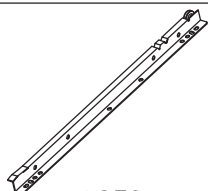

L350mm

DRx2



L350mm

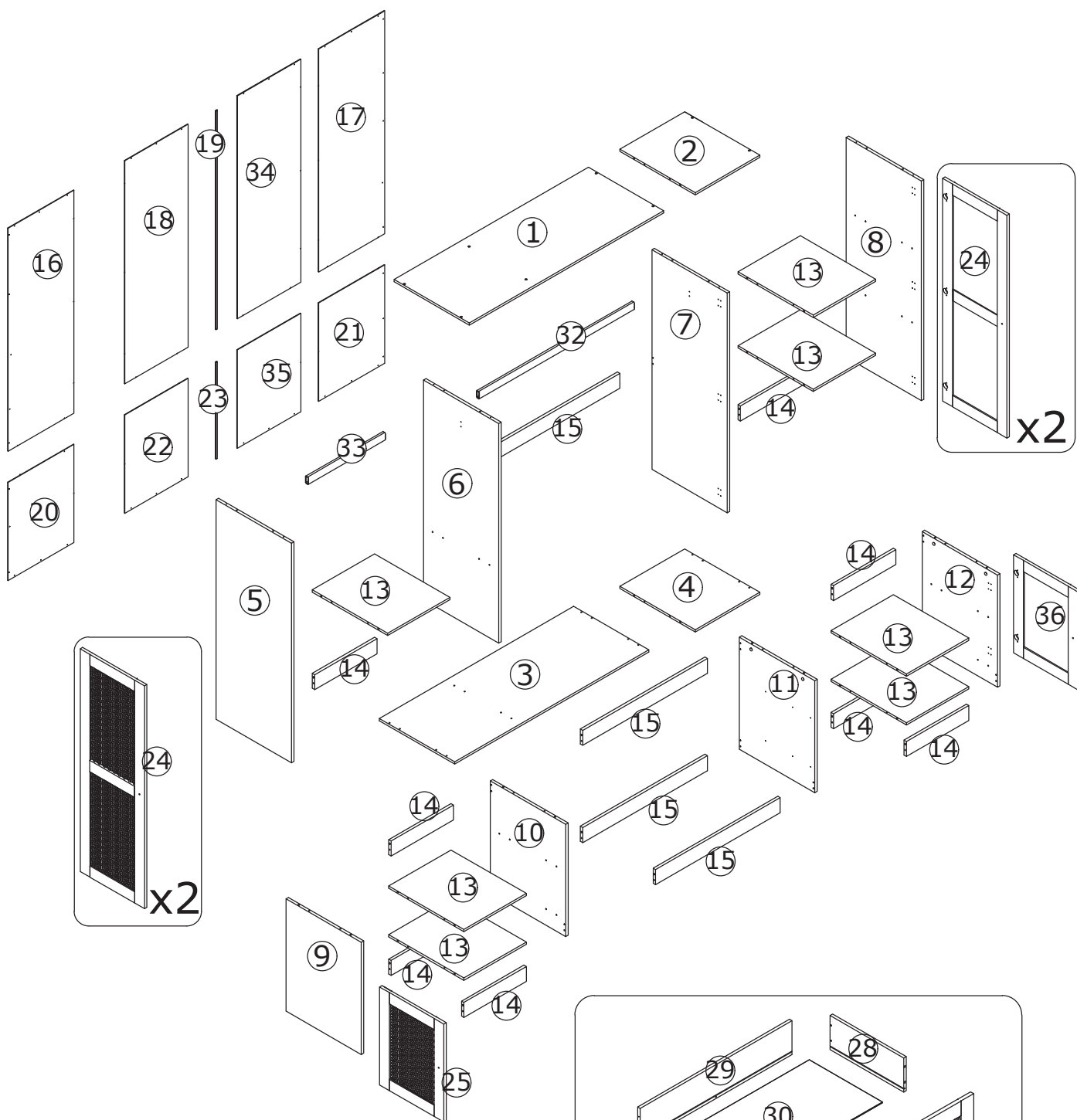

⚠ WARNING

Children have died from furniture tipover. To reduce the risk of furniture tipover:

- ALWAYS install Anti-tip device provided.
- NEVER put a TV on this product.
- NEVER allow children to stand, climb or hang on drawers, doors, or shelves.
- NEVER open more than one drawer at a time.
- Place heaviest items in the lowest drawers.

*This is a permanent label.
Do not remove!*

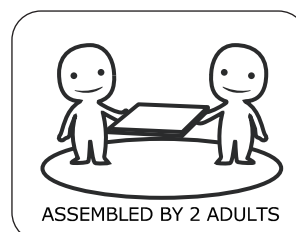
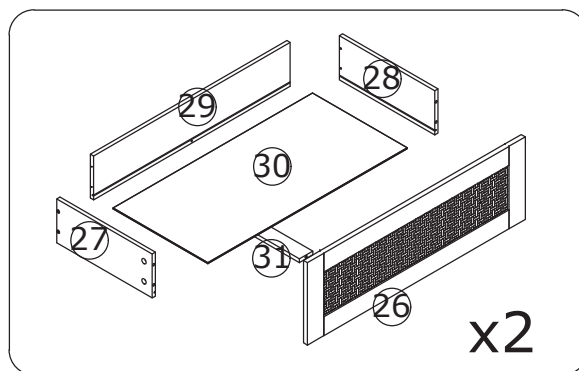

1

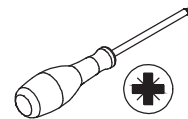
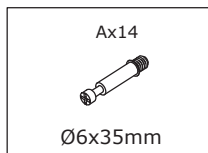

Screw Cam Bolt(A) into plate 9 and 12 as shown.

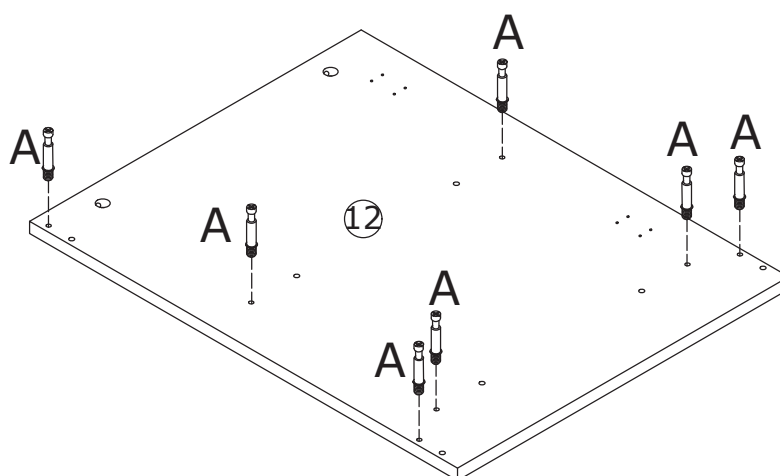
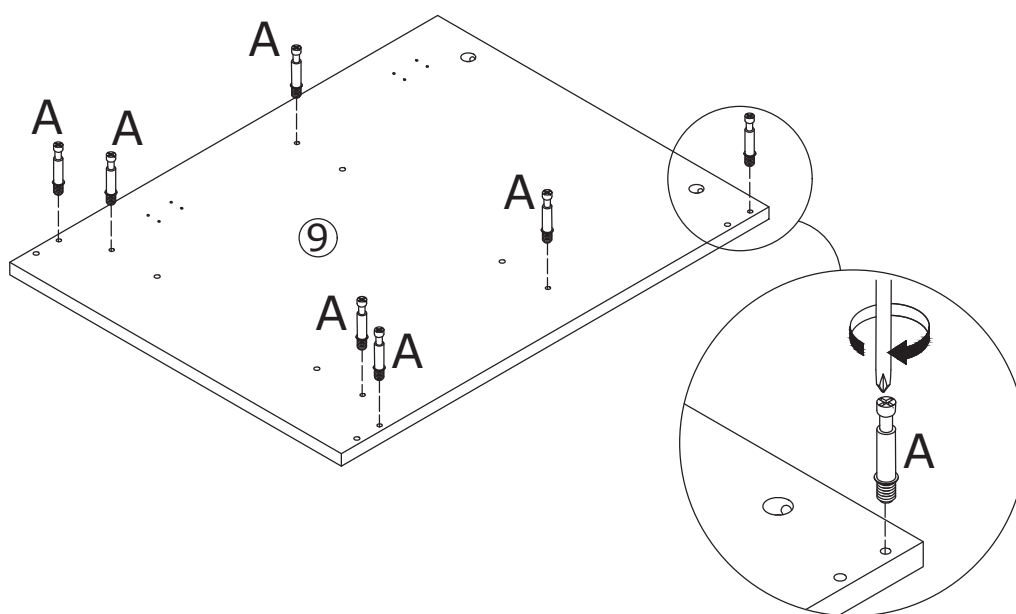
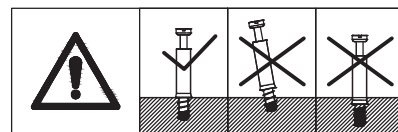

2



Attach the component to plate 13 with wooden dowel(C),
 put cam lock(B) into holes in plate 13, Connect
 board 13 and 9 turn clockwise to tighten
 as shown.
 Put cam lock(B) into holes in plate 13, Connect
 board 13 and 12 turn clockwise to tighten
 as shown.

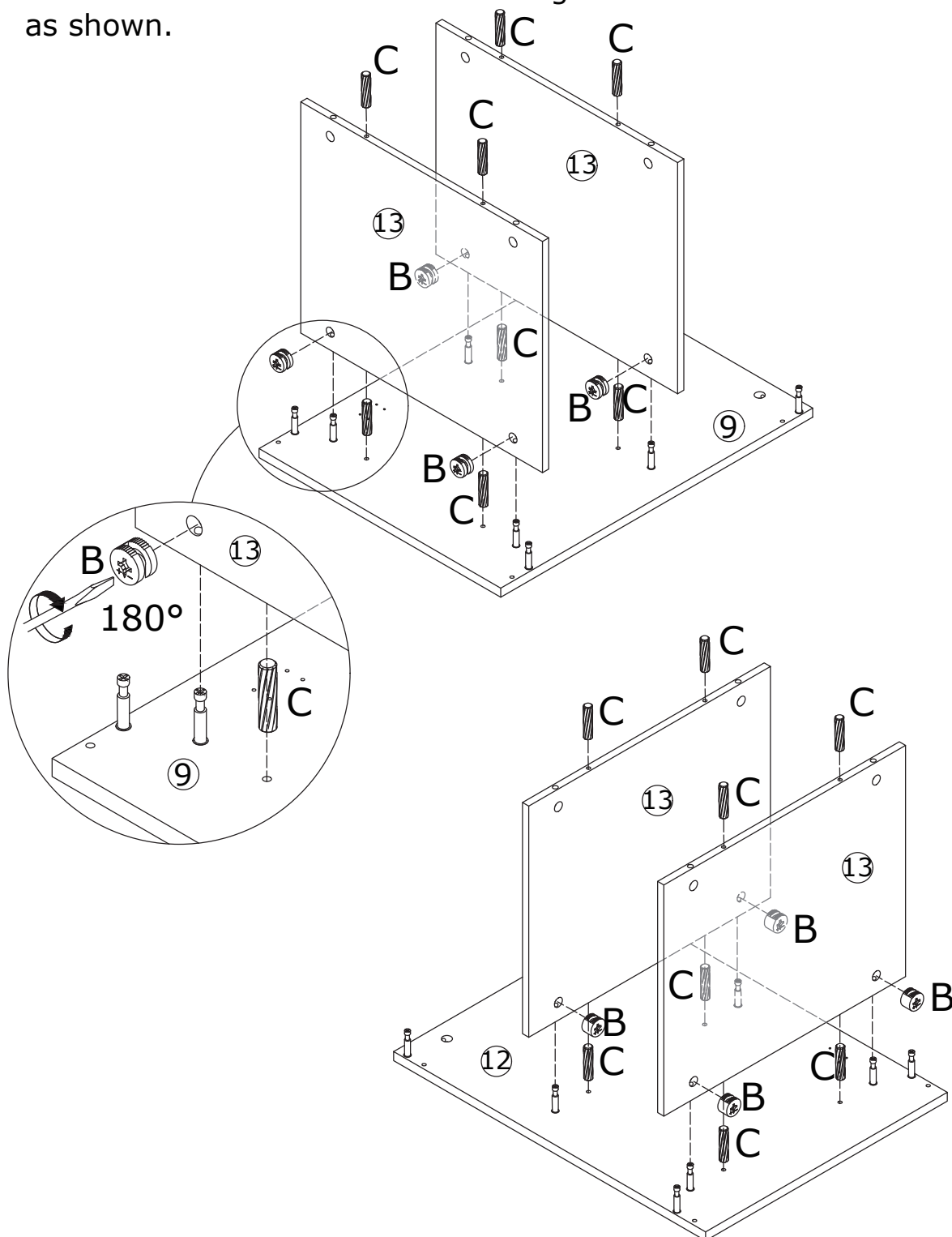
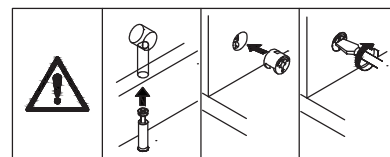

3



Attach the component to plate 14 with wooden dowel(C),
 put cam lock(B) into holes in plate 14, Connect
 board 14 and 9 turn clockwise to tighten
 as shown.
 Put cam lock(B) into holes in plate 14, Connect
 board 14 and 12 turn clockwise to tighten
 as shown.

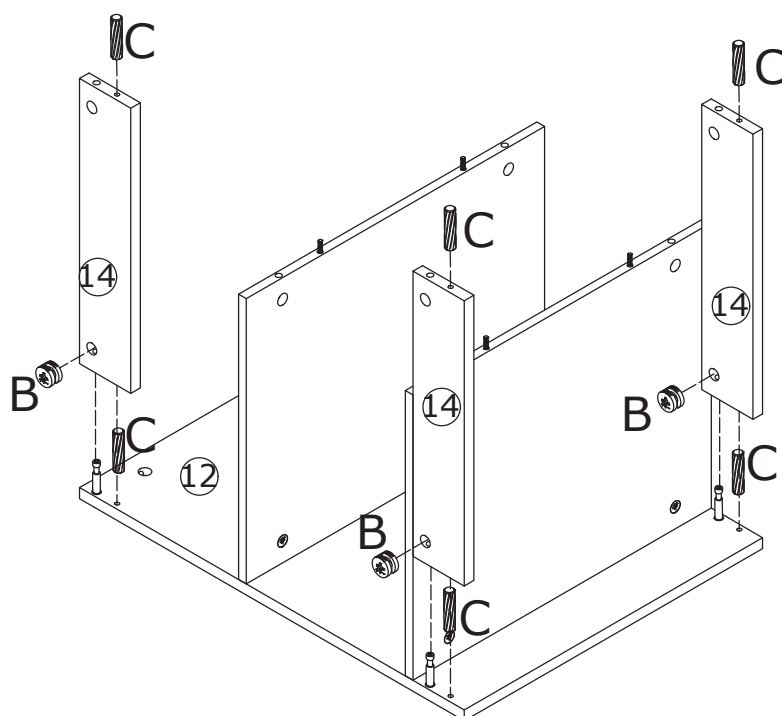
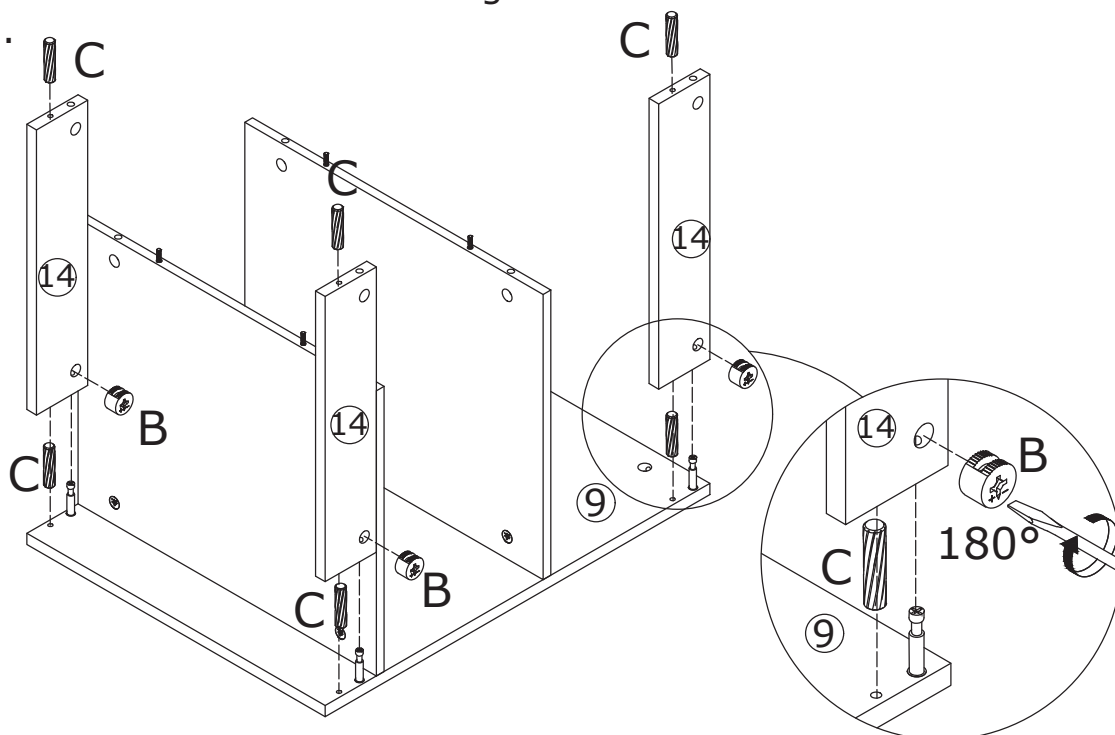
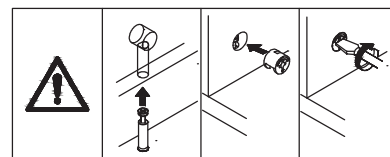

4

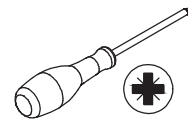

Screw Cam Bolt(A) into plate 10 and 11 as shown.

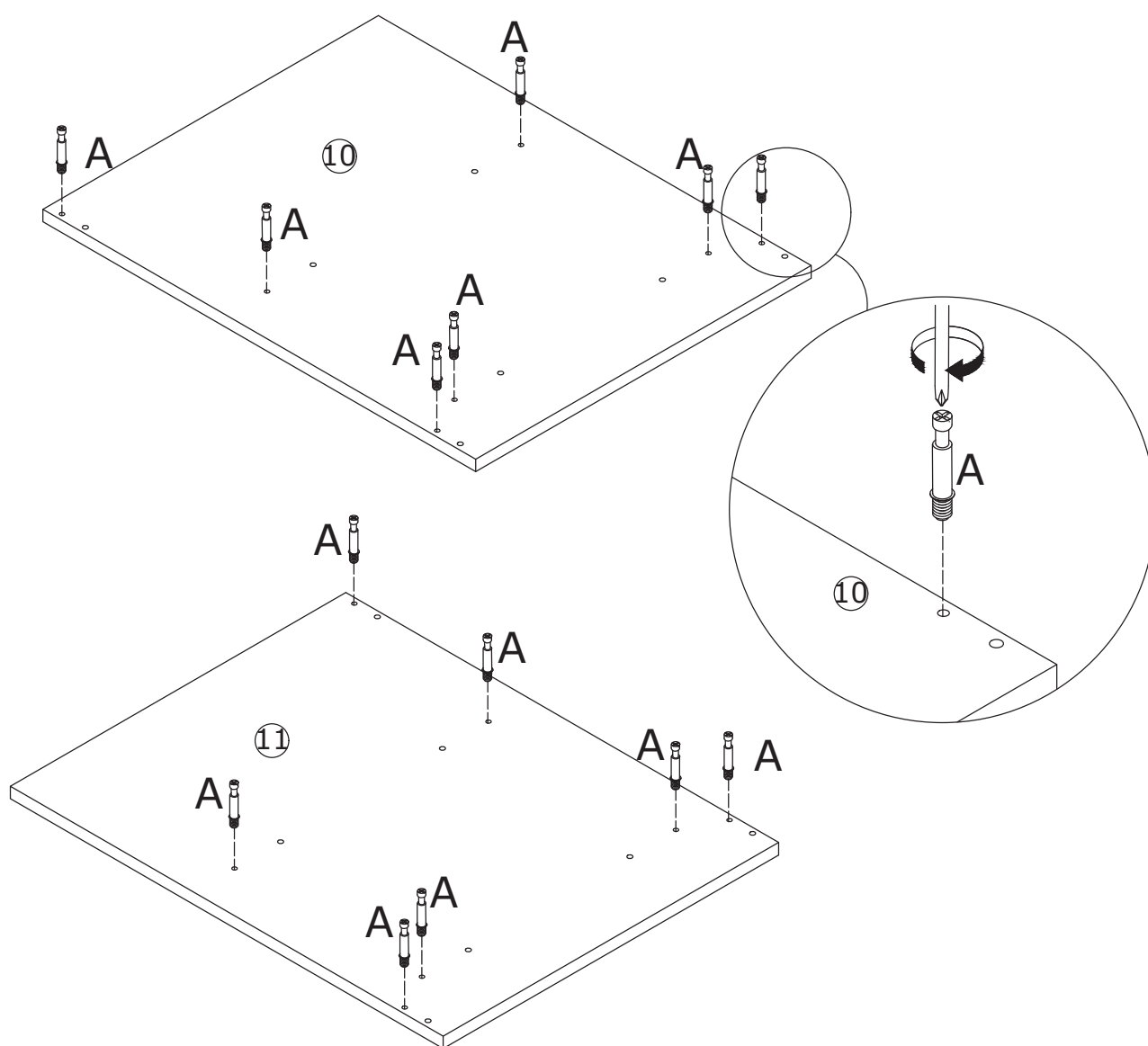
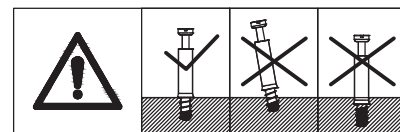

5

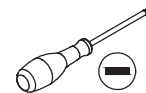
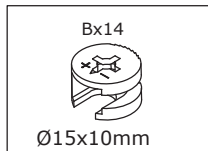

Put cam lock(B) into holes in plate 13 and 14 ,Connect board13 、 14and 10 turn clockwise to tighten as shown.

Put cam lock(B) into holes in plate 13 and 14 ,Connect board13 、 14and 11 turn clockwise to tighten as shown.

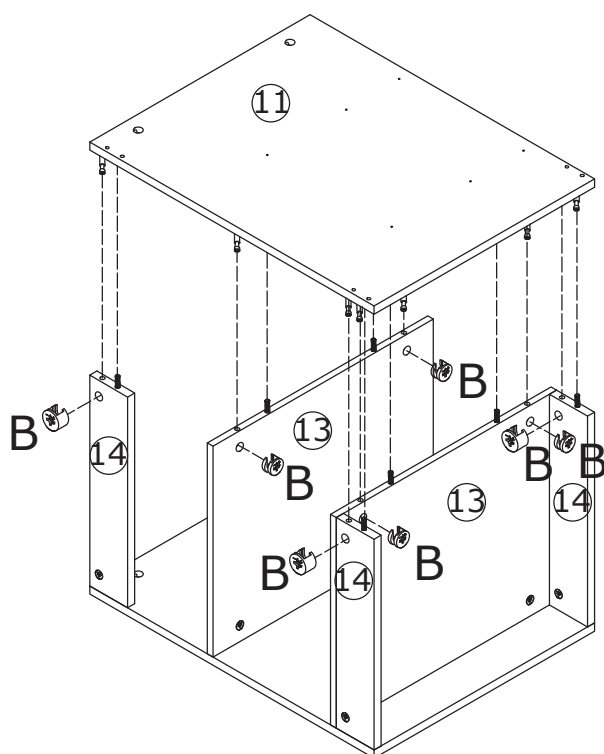
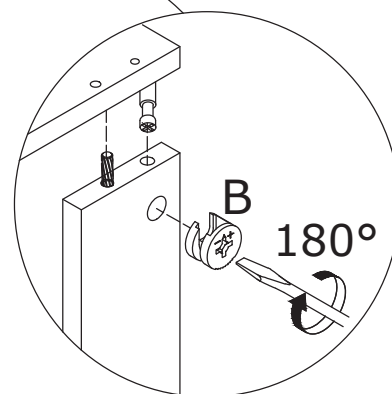
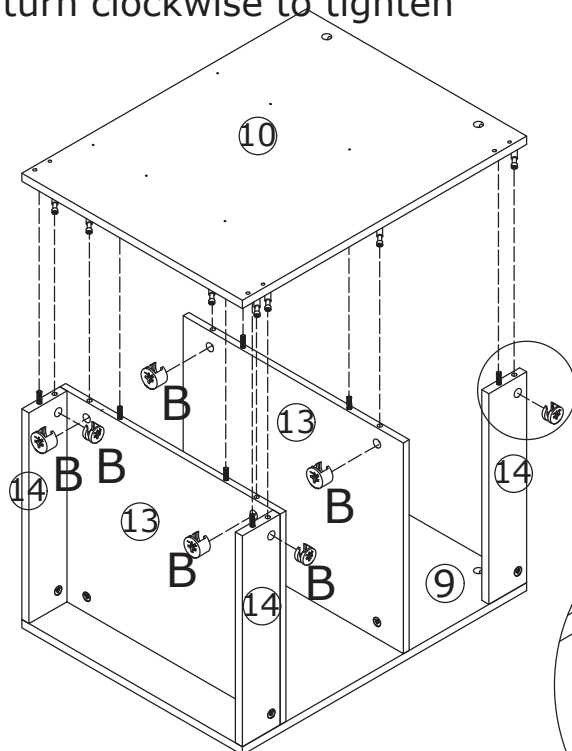
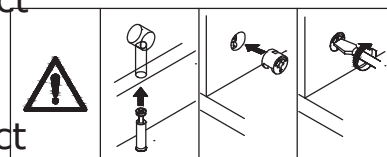

6

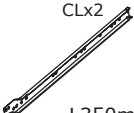
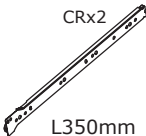
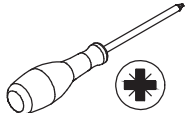
<p>Ex12</p>  <p>Ø3.5x12mm</p>	<p>CLx2</p>  <p>L350mm</p>	<p>CRx2</p>  <p>L350mm</p>	
--	---	---	---

Fix the four slide rails (CL) in their respective positions

Lock the 10 boards with screws (E), as shown

Fix the four slide rails (CR) in their respective positions

Lock the 11th boards with screws (E), as shown

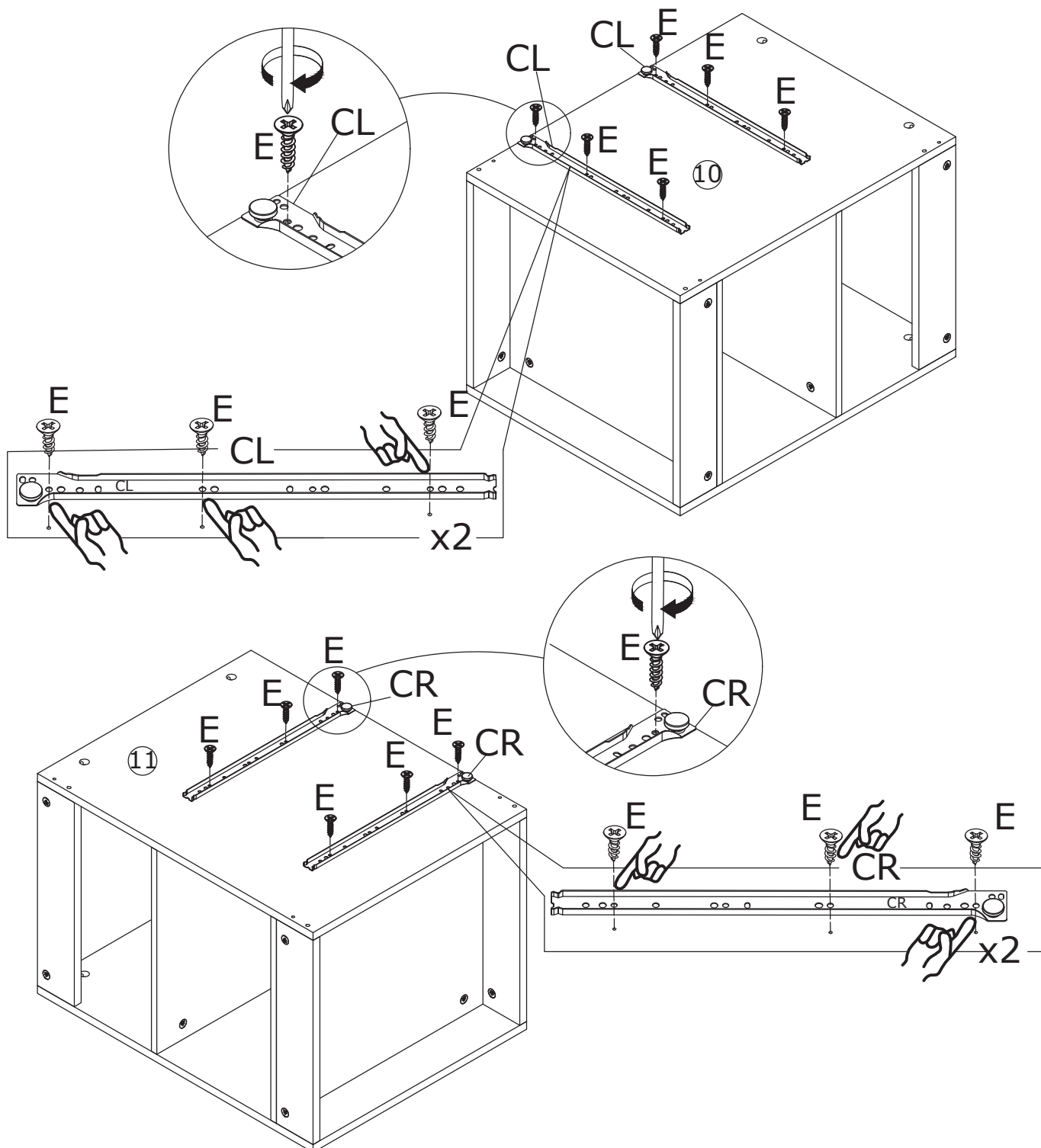

7

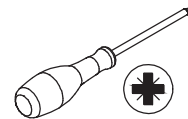
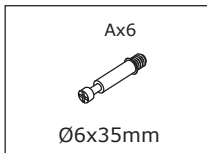

Screw Cam Bolt(A) into plate 10 and 11 as shown.

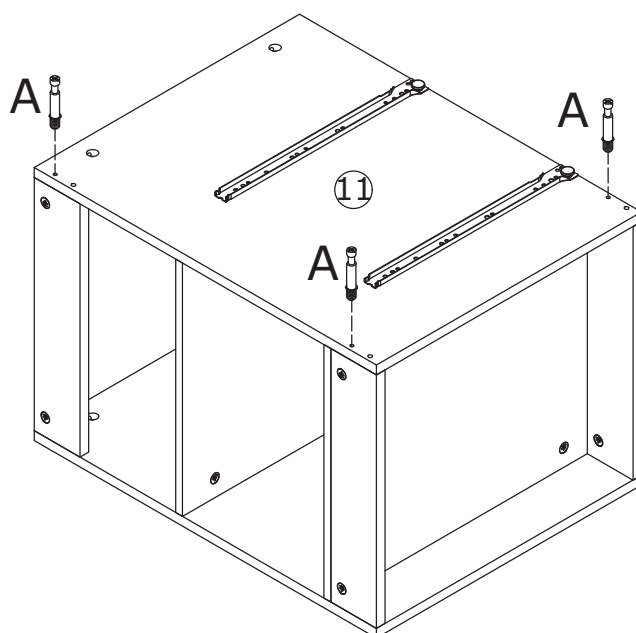
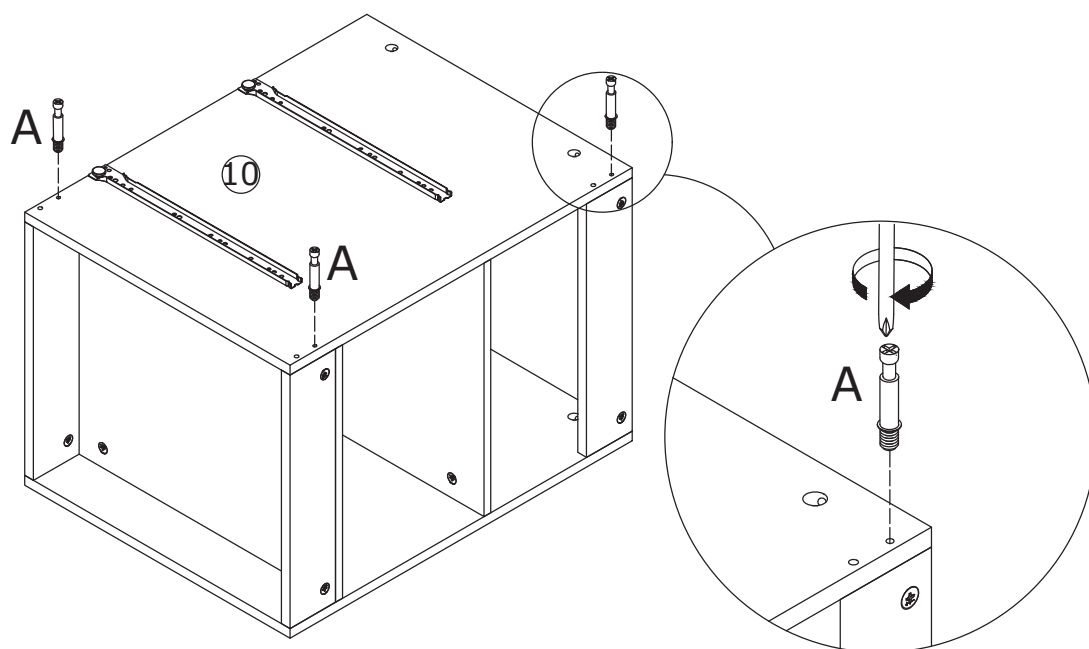
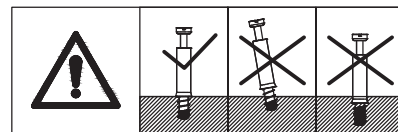

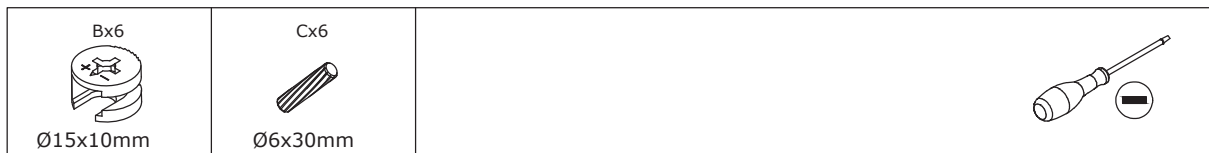

8

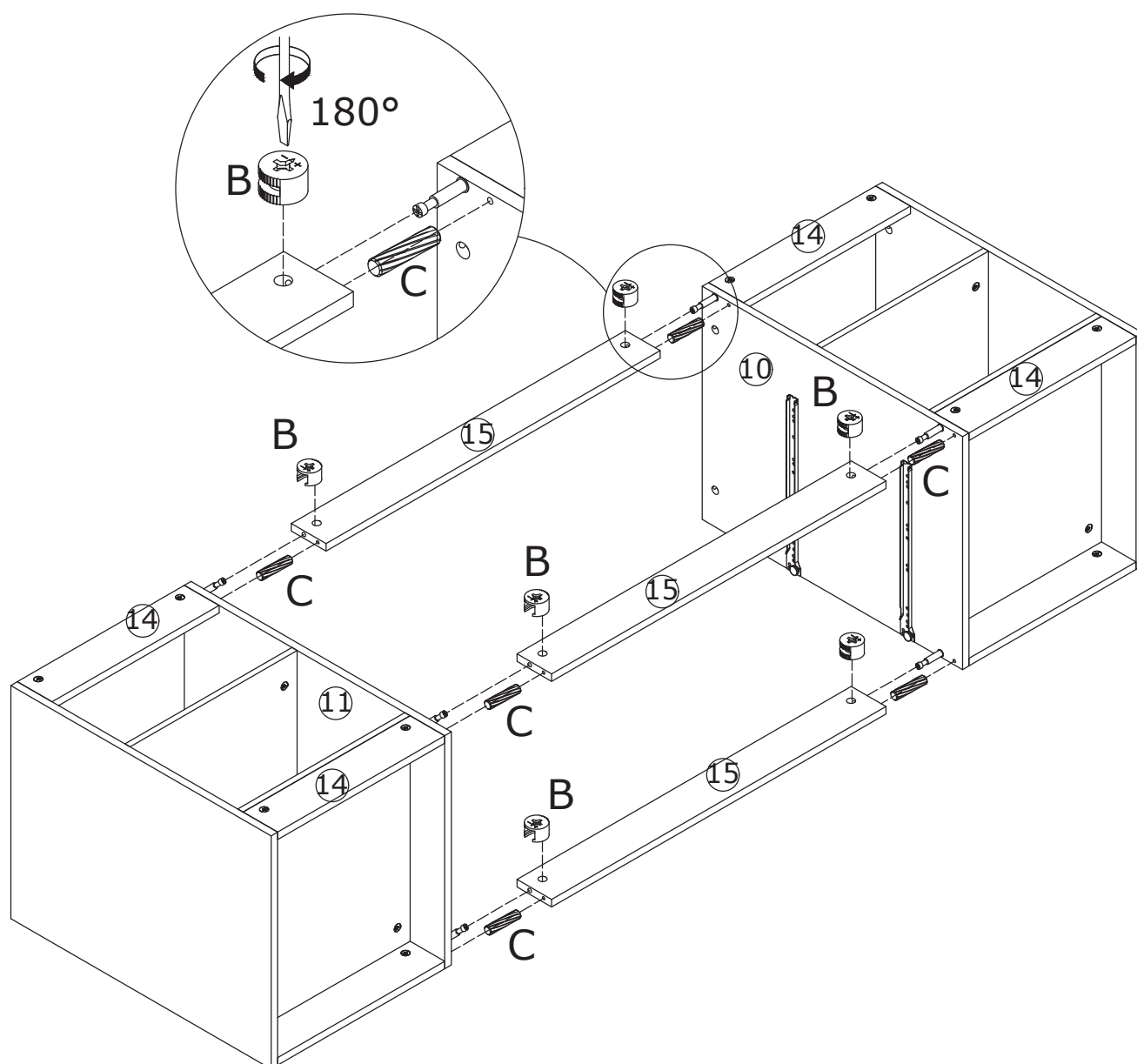
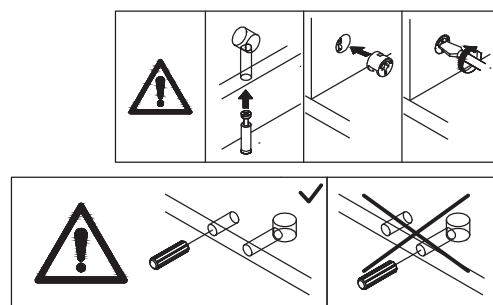

Attach the component to plate 15 with wooden dowel(C), put cam lock(B) into holes in plate 15, Connect board 10、11 and 15 turn clockwise to tighten as shown.

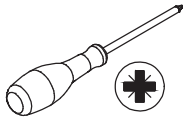

9

<p>Ax16</p>  <p>Ø6x35mm</p>	<p>Ex4</p>  <p>Ø3.5x12mm</p>	<p>Lx2</p> 	
--	---	--	---

Screw Cam Bolt(A) into plate 5、6、7and 8 as shown.

Use screw "E" to fix the clothes hanger "L to board 5

Use screw "E" to fix the clothes hanger "L to board 6

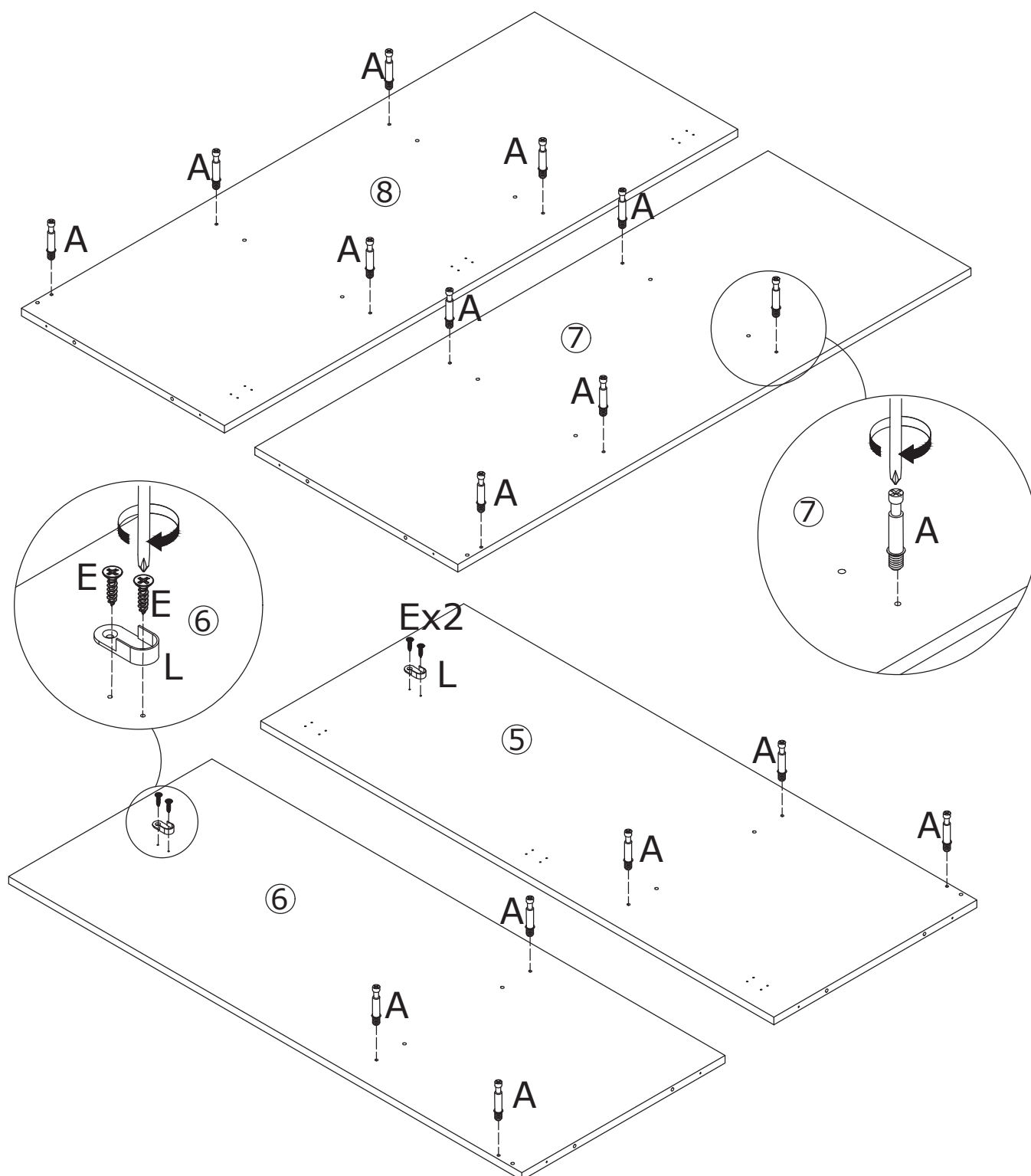

10



Attach the component to plate 13、14 with wooden dowel(C),
Put cam lock(B) into holes in plate 13, 14, and
Connect the 7th and 8th side panels to the 13th and 14th
turn clockwise to tighten as shown.

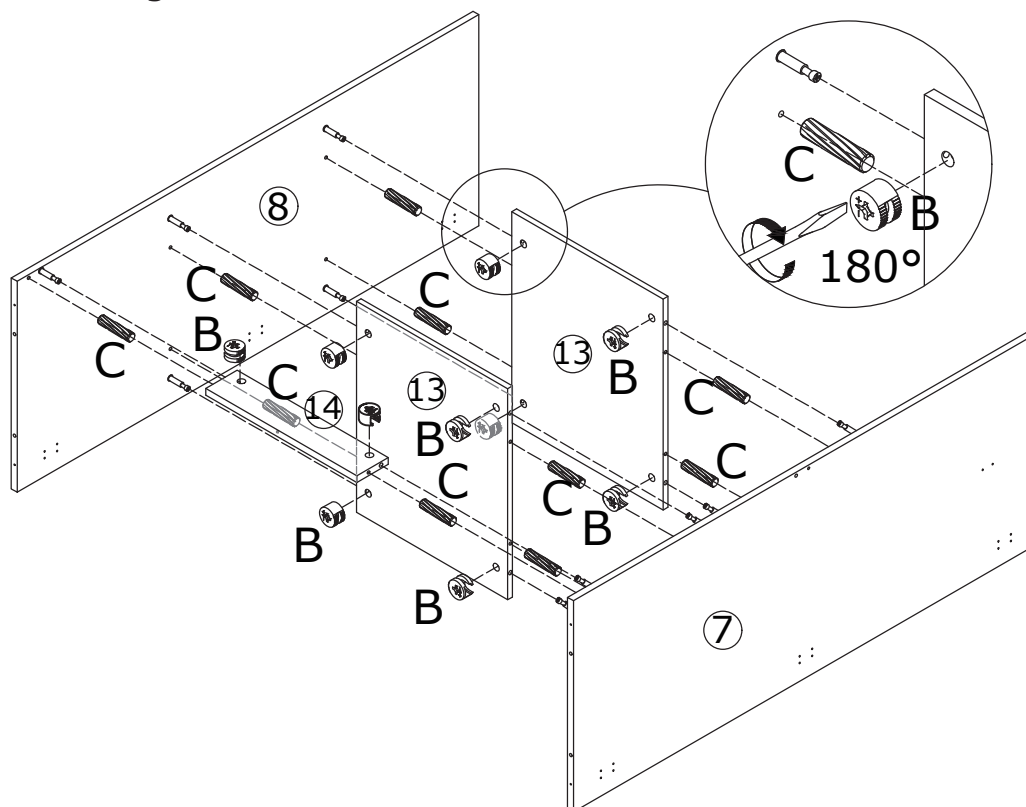
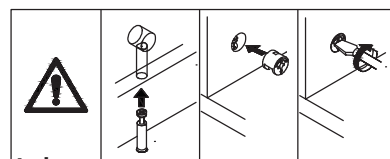

Attach the component to plate 5、6 with wooden dowel(C),
Put cam lock(B) into holes in plate 13, 14, and Connect the 5th
and 6th side panels to the 13th
and 14th turn clockwise to
tighten as shown.

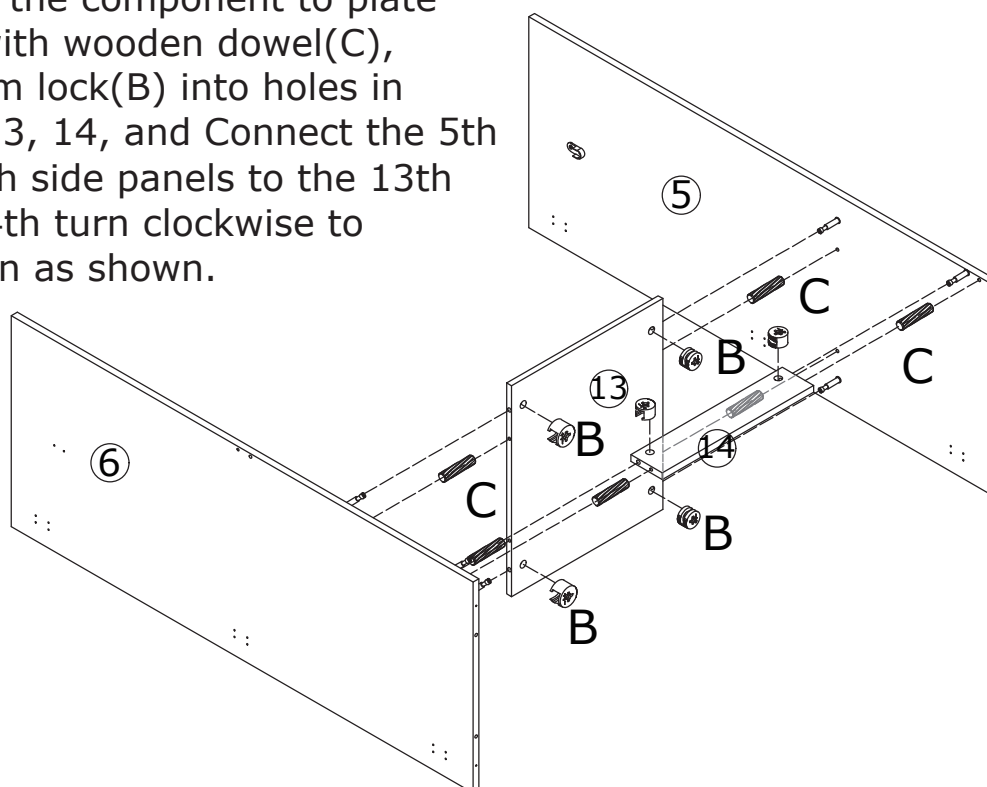

11

Ax2
Ø6x35mm

Ex4
Ø3.5x12mm

Lx2

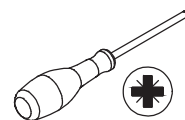

Screw Cam Bolt(A) into plate 6 and 7 as shown.

Use screw "E" to fix the clothes hanger "L" to board 7

Use screw "E" to fix the clothes hanger "L" to board 6

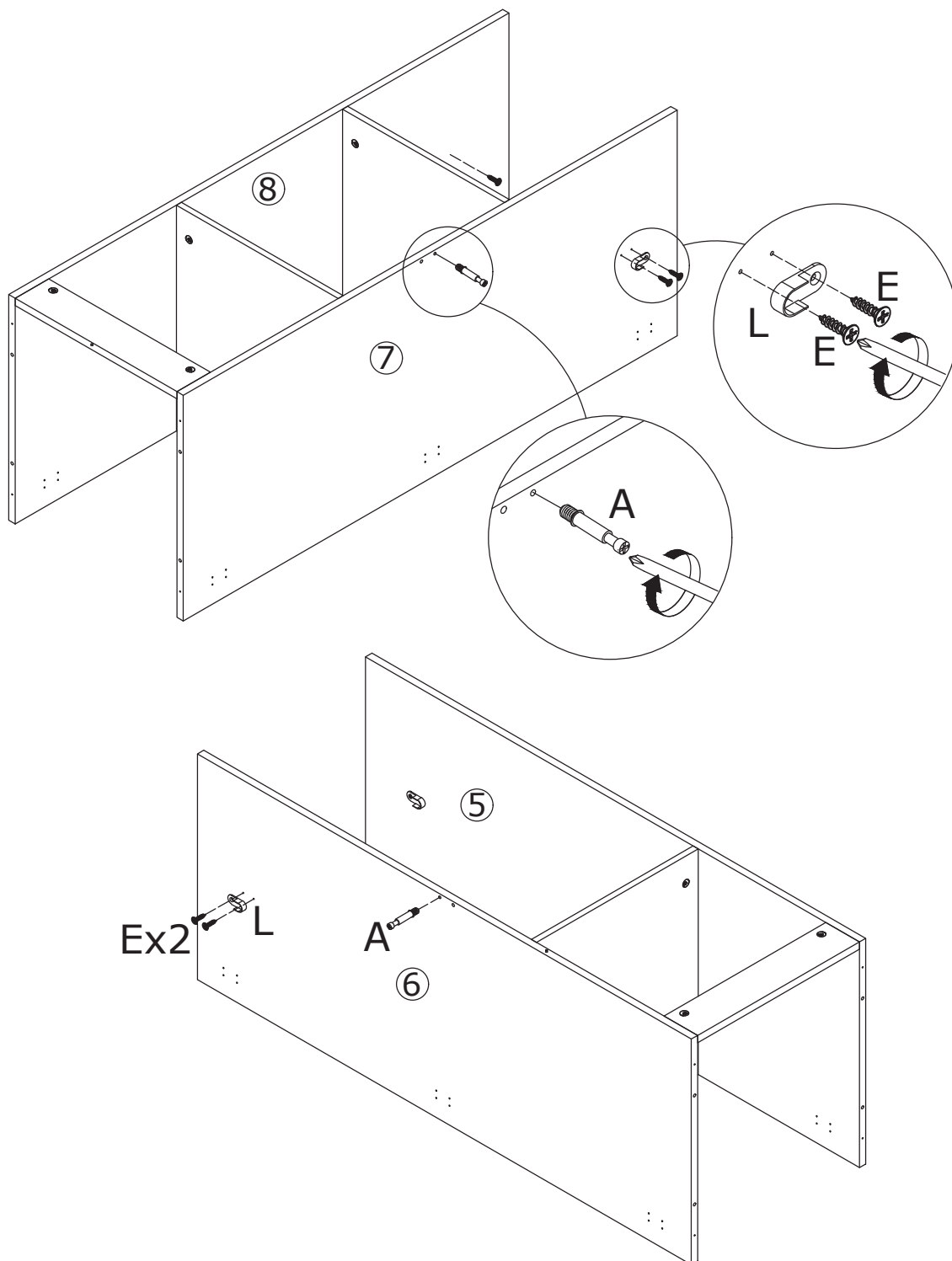
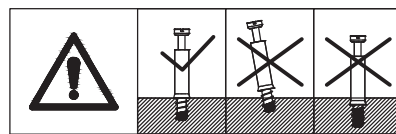

12



Attach the component to plate 15 with wooden dowel (C), put cam lock (B) into holes in plate 15, Connect board 6, 7 and 15 turn clockwise to tighten as shown.

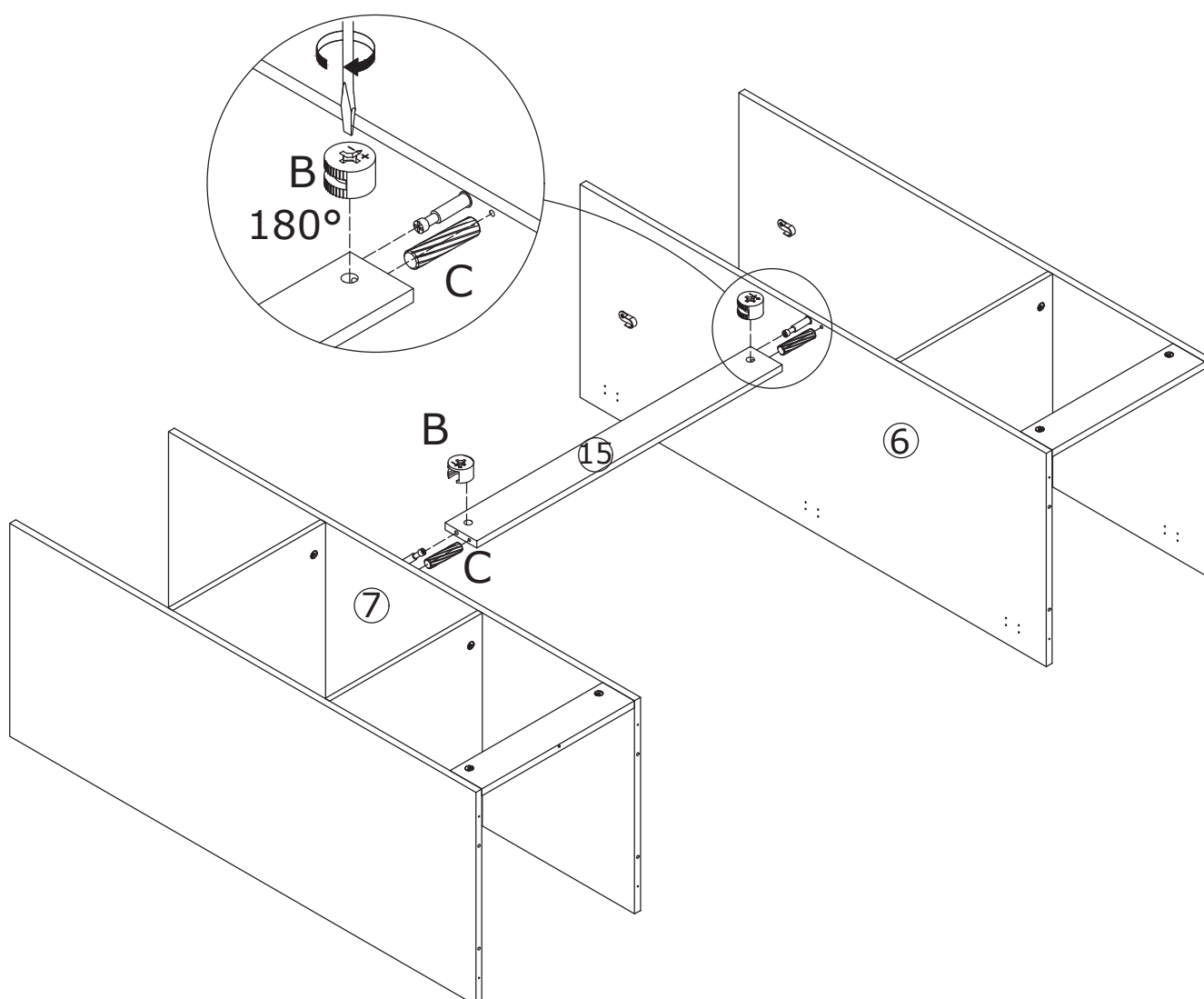
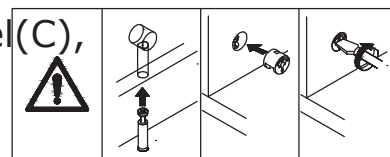

13



Attach the component to plate 2 and 4 with Long wooden dowel(K),
Insert the cam lock (B) into the holes of plate 2 and plate 4 respectively, then insert the double headed screw "J", and finally turn clockwise to tighten, as shown in the figure.

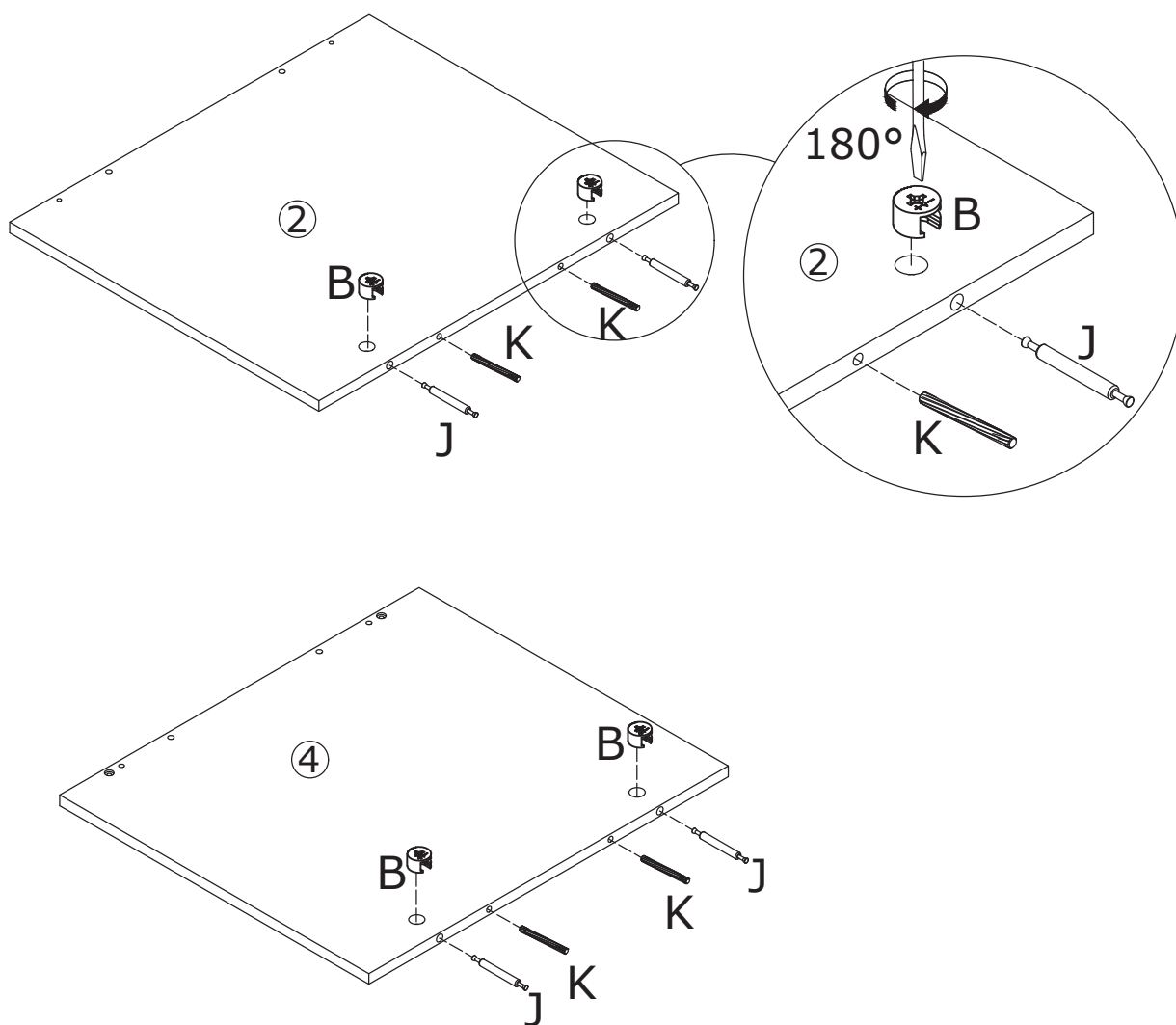
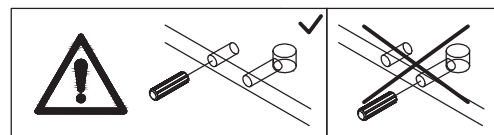
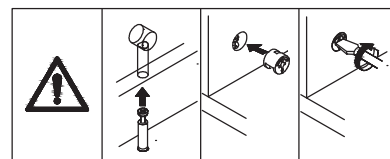

14

Ax8
Ø6x35mm

Bx4
Ø15x10mm





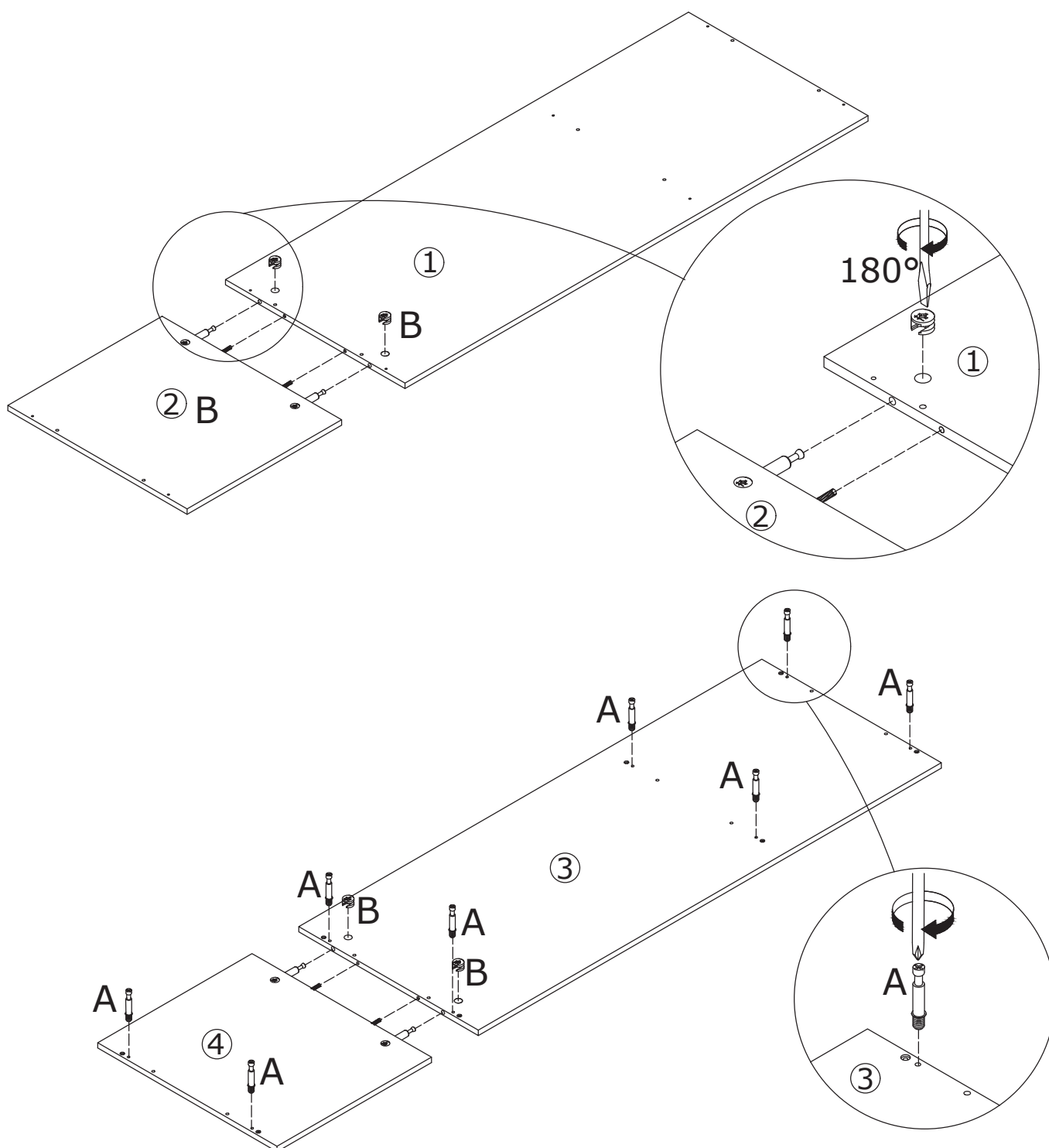
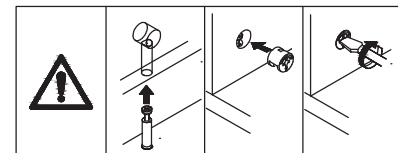
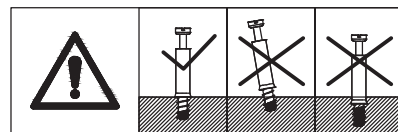

Put cam lock(B) into holes in plate 1 turn clockwise to tighten, Connect board 1 and board 2 as shown.

Put cam lock(B) into holes in plate 3 ,and turn clockwise to tighten, Connect board 3 and board 4 as shown.

Screw Cam Bolt(A) into plate 3 and 4 as shown.

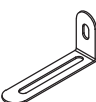

15

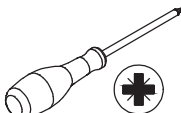
<p>Cx8</p>  <p>Ø6x30mm</p>	<p>Dx8</p>  <p>Ø4x35mm</p>	<p>Mx2</p> 	<p>Nx4</p>  <p>Ø4x12mm</p>	
---	---	--	---	---

Attach the component to plate 5、6、7 and 8 with wooden dowel(C),
Then use screws (D) to lock the 1rd and 2th plates with the 5th, 6th, 7th,
and 8th plates as shown.
Use screw "N" to lock the anti collapse iron plate "M"
onto the 1nd and 2nd board as shown.

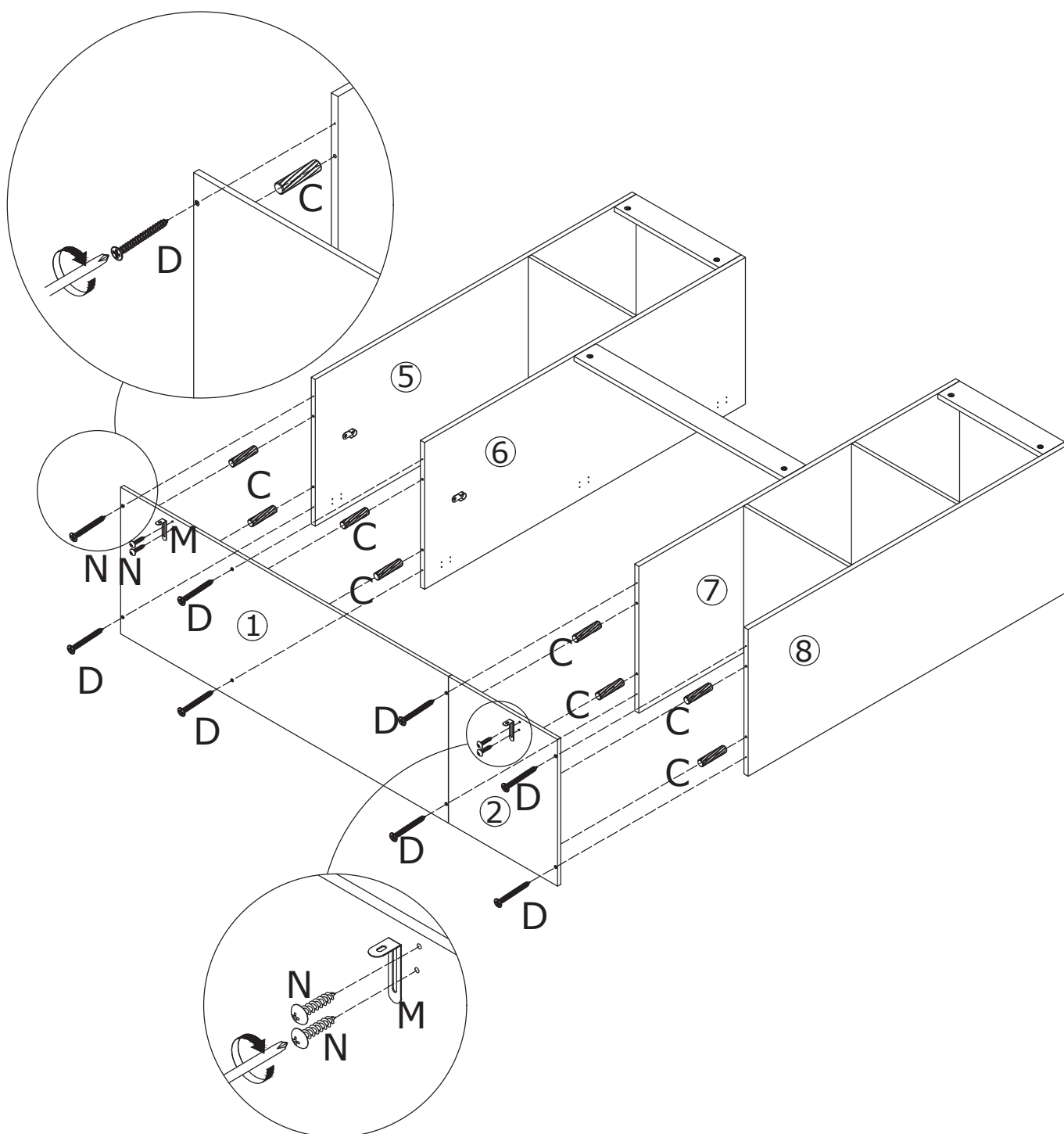

16



Attach the component to plate 5、6、7 and 8 with wooden dowel(C),
Then use screws (D) to lock the 3rd and 4th plates with the 5th, 6th, 7th,
and 8th plates as shown.

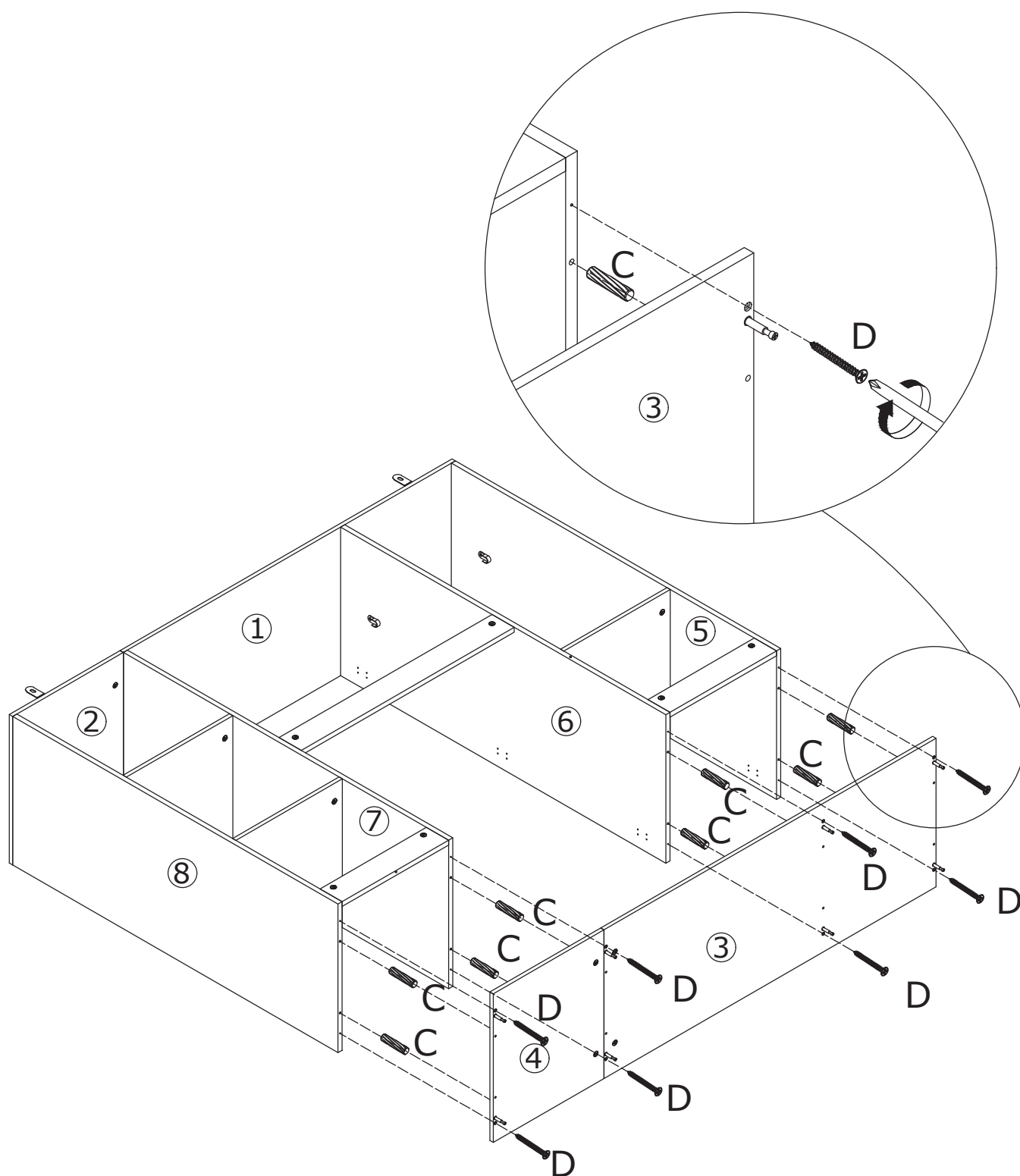

17

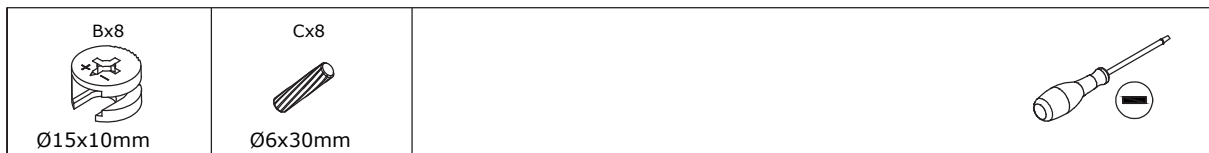

Attach the component to plate 9、10、11 and 12 with wooden dowel(C), put cam lock(B) into holes in plate 9, 10, 11, 12 and turn clockwise to tighten as shown.

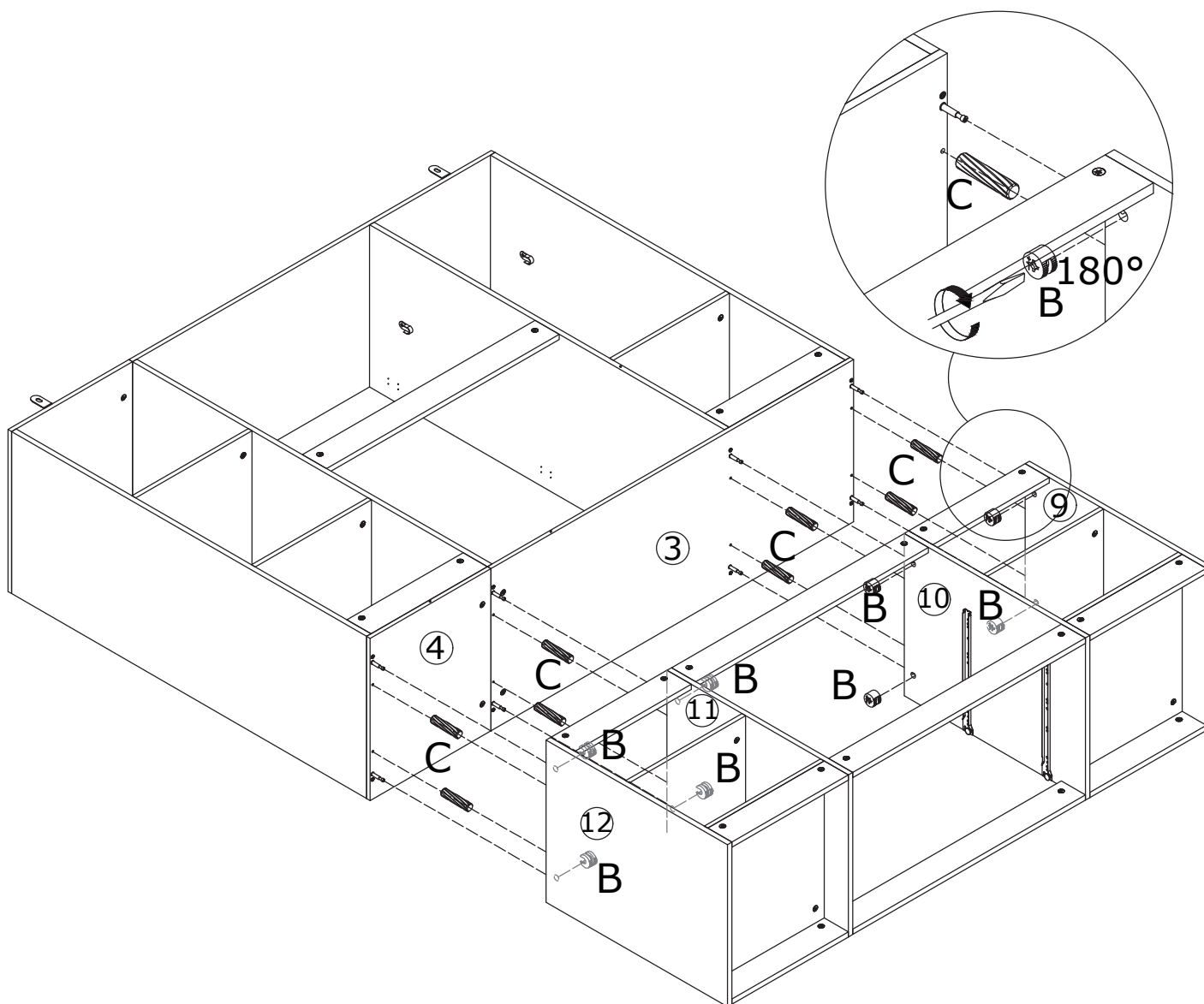
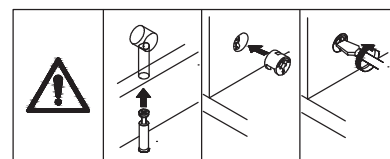

18

Qx18



Rx58



Ø2.5x12mm

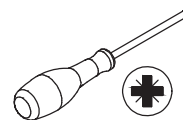

Fix back plate 16, 17, 18 19 and plank 34 using screw(R) at first.
 Fix back plate 20, 21, 22 , 23 and plank 35 using screw(R) at first.
 Fix each plate 16, 17 18 and 34 together using part(Q) with
 screw(R)as shown.
 Fix each plate 20, 21 , 22 and 35 together using part(Q)
 with screw(R)as shown.

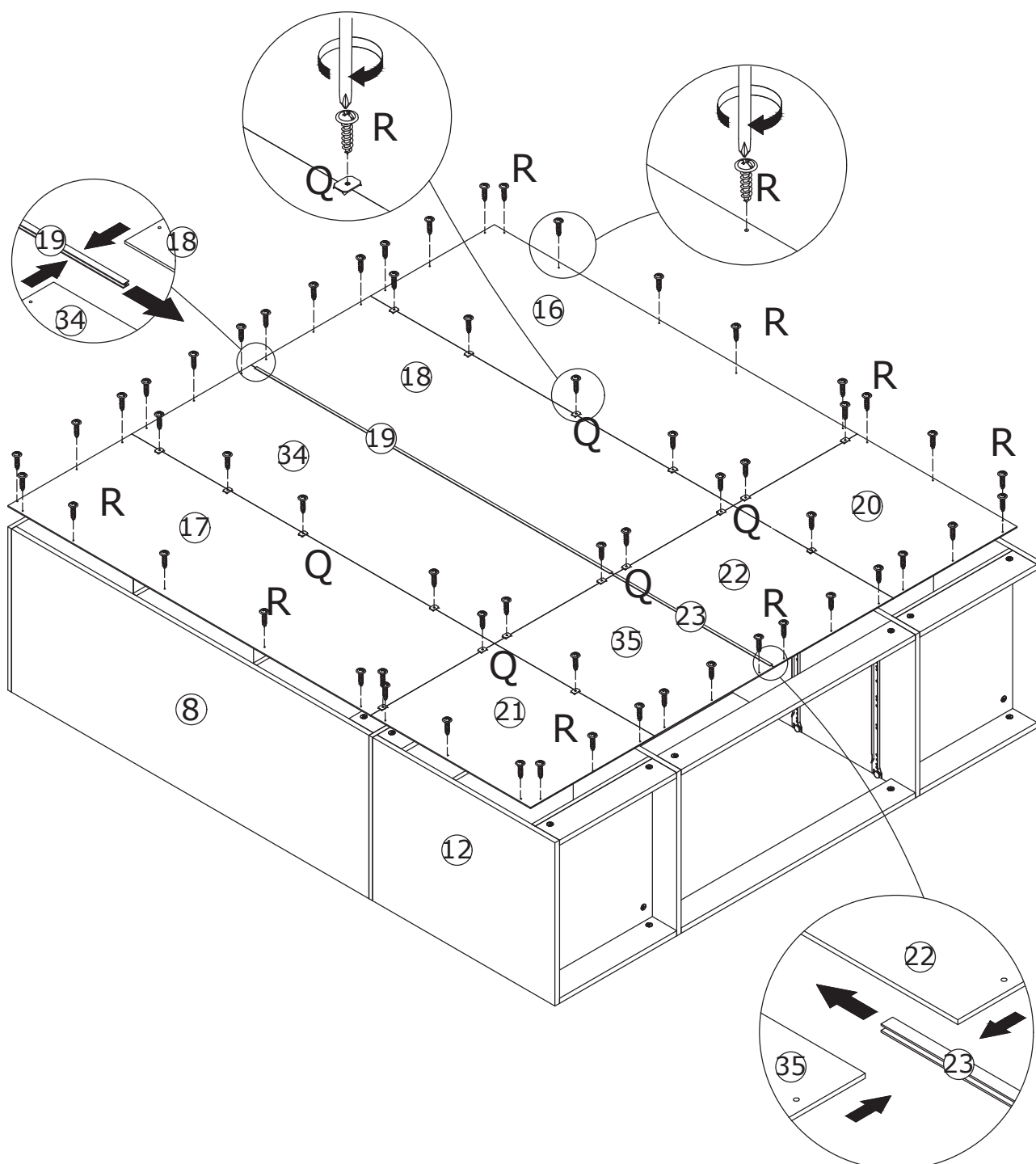

19

Two people are required to lift the cabinet at the same time, otherwise the uneven force will cause the hole to split.

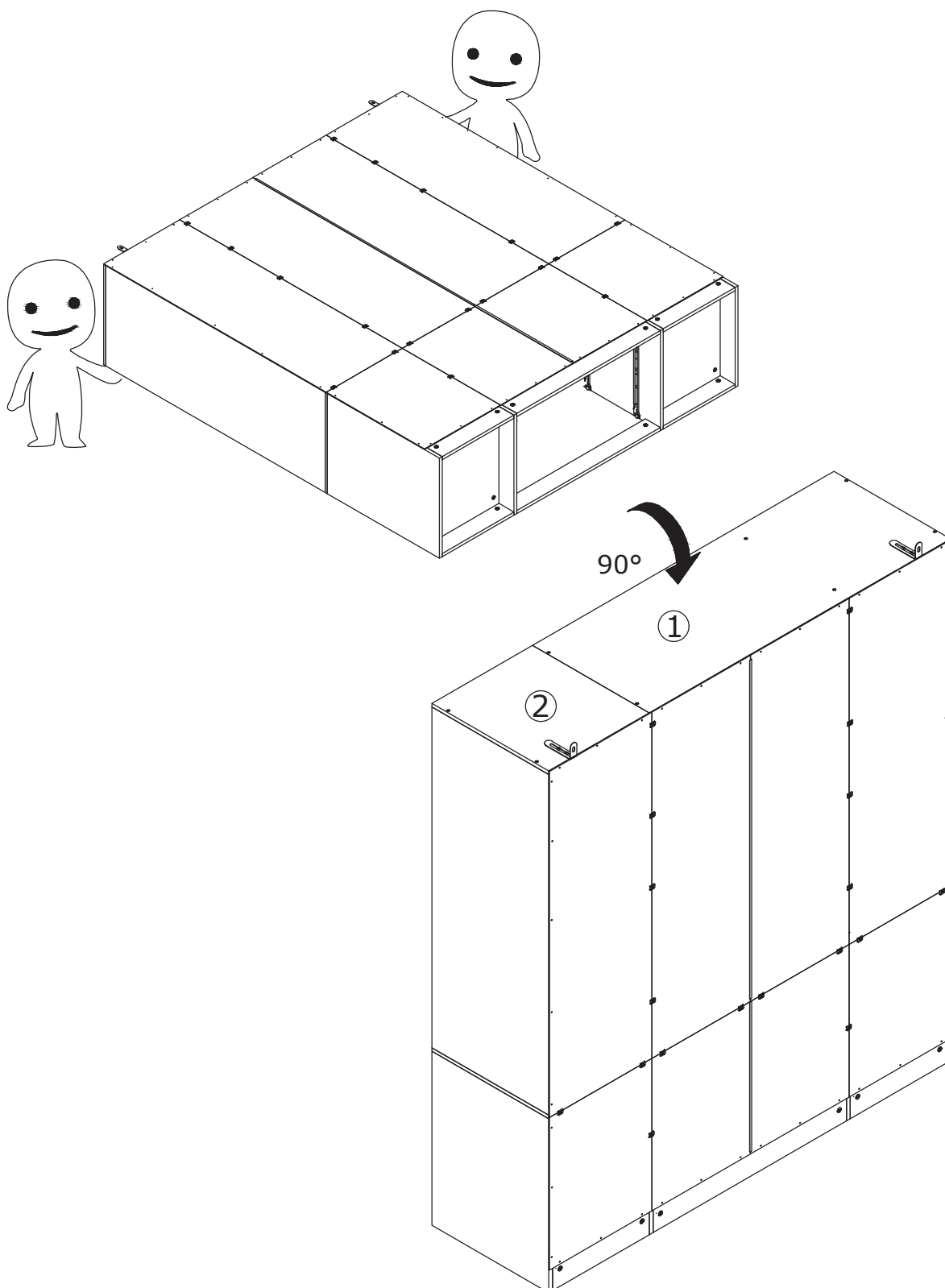

20

Dx10
Ø4x35mm

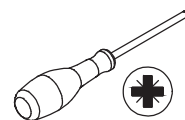

Please connect board 29 to boards 27, 28, and 31 respectively
Use screws (D) as shown in the figure, as shown.

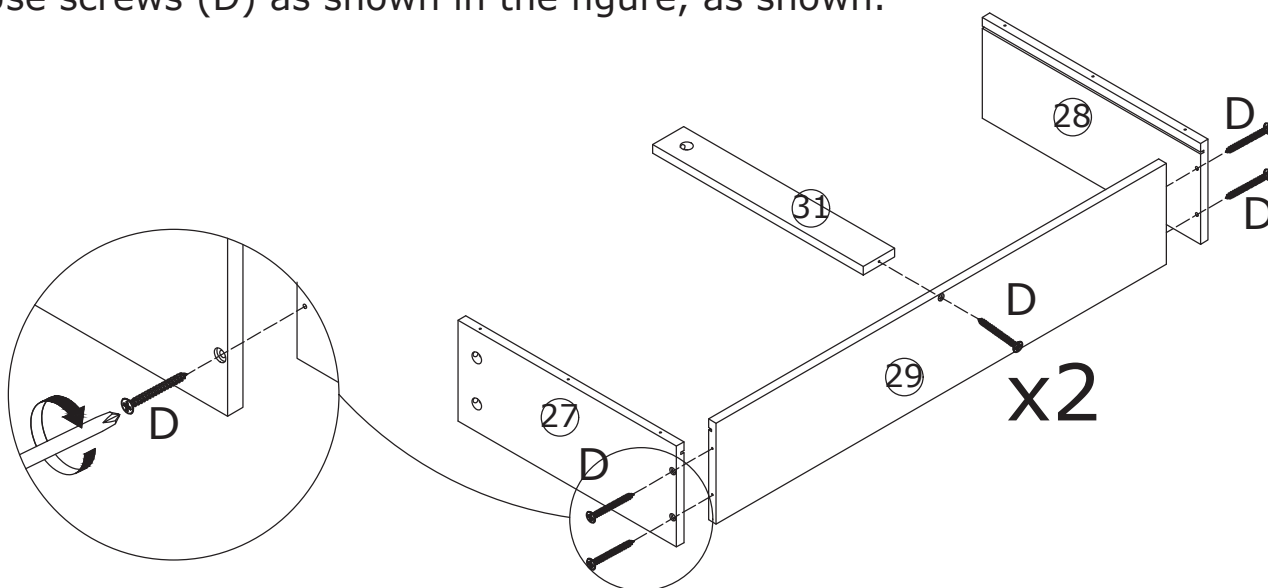

21

Please insert plate 30 into the bottom plate slot of plates 27 and 28, as shown.

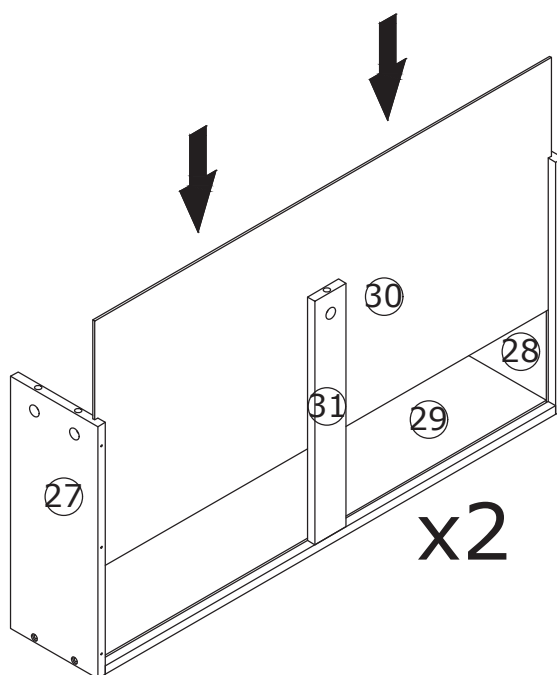

22

Ax10
Ø6x35mm

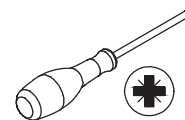

Cam Bolt (A) to plate 26 with a cross screwdriver, as shown.

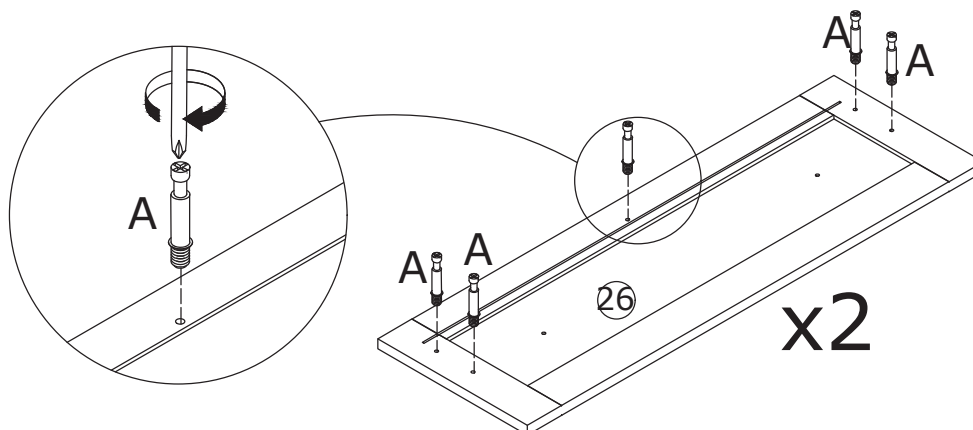
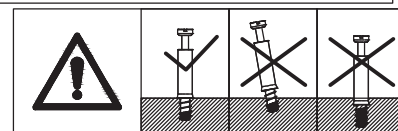

23

Bx10
Ø15x10mm

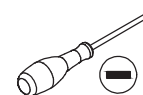

Please cover plates 26 on plates 27, 28, and 31 lock them with a cam lock (B) as shown.

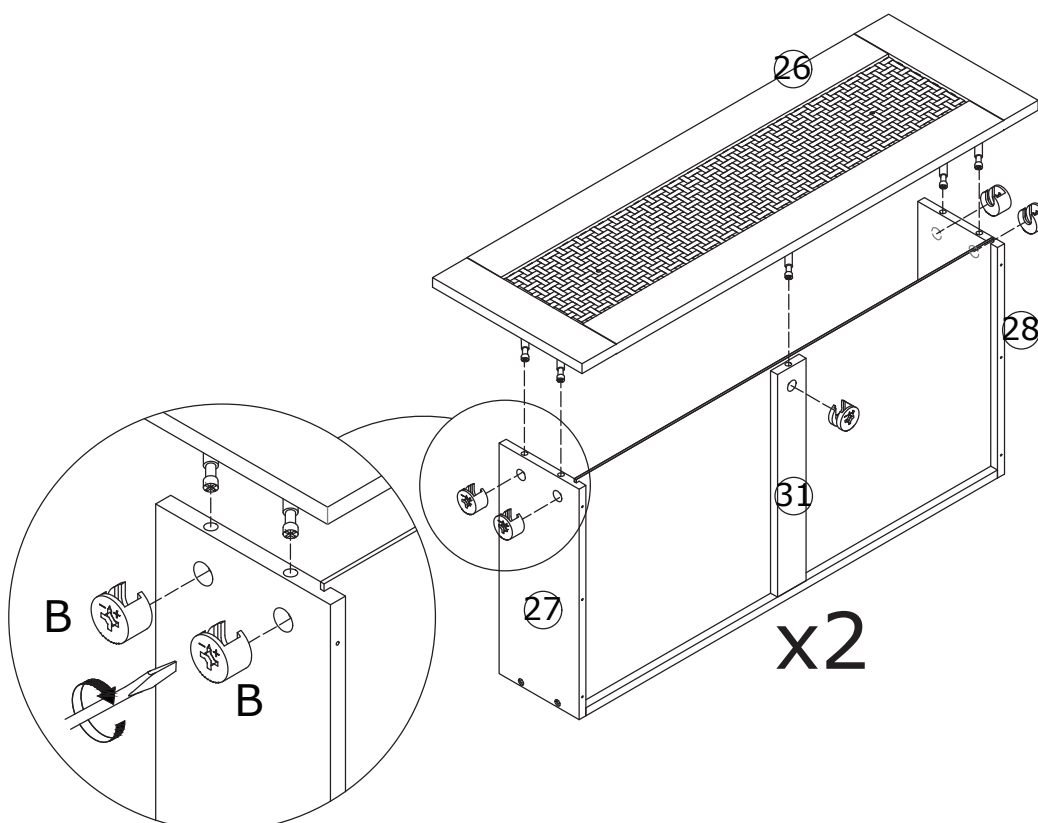
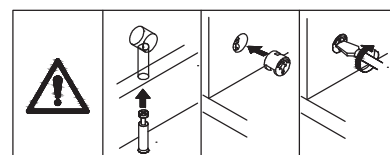

24

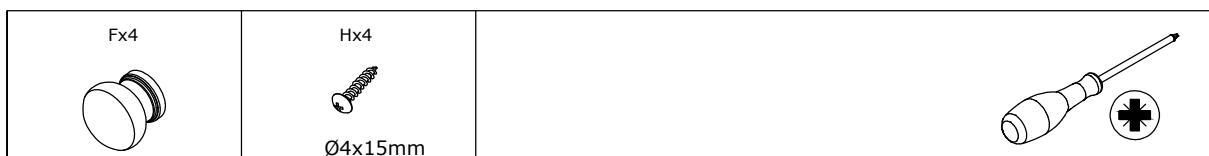

Please thread the "H" screw through plate 26 respectively and lock it with the "F" handle, as shown.

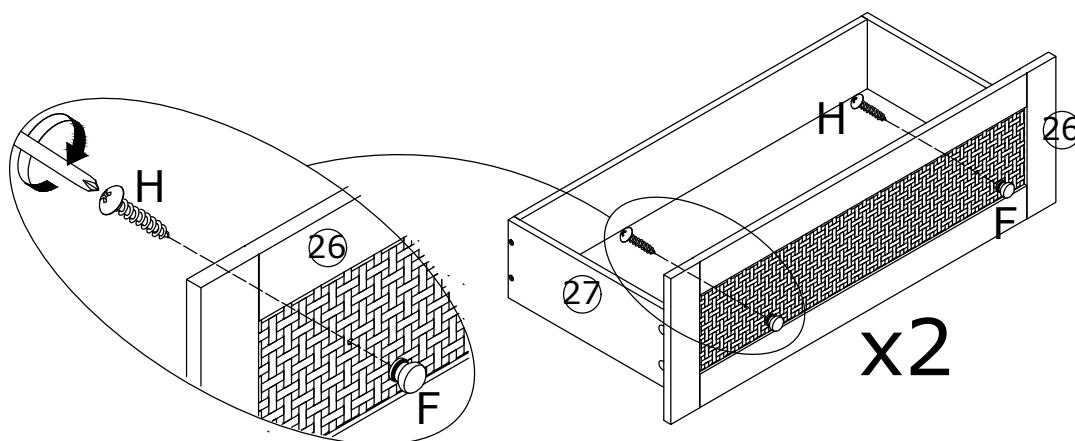

25

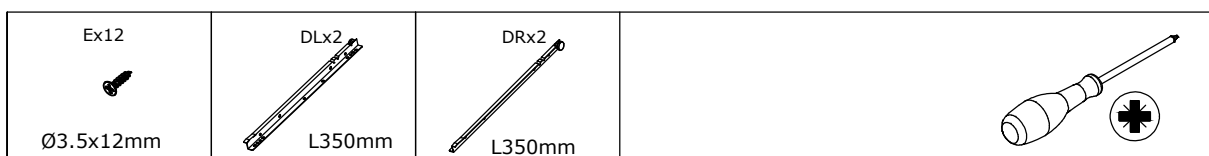

Please lock the slide rail (DL) to board 27 with screw (E), and the slide rail (DR) to board 28 with screw (E), as shown.

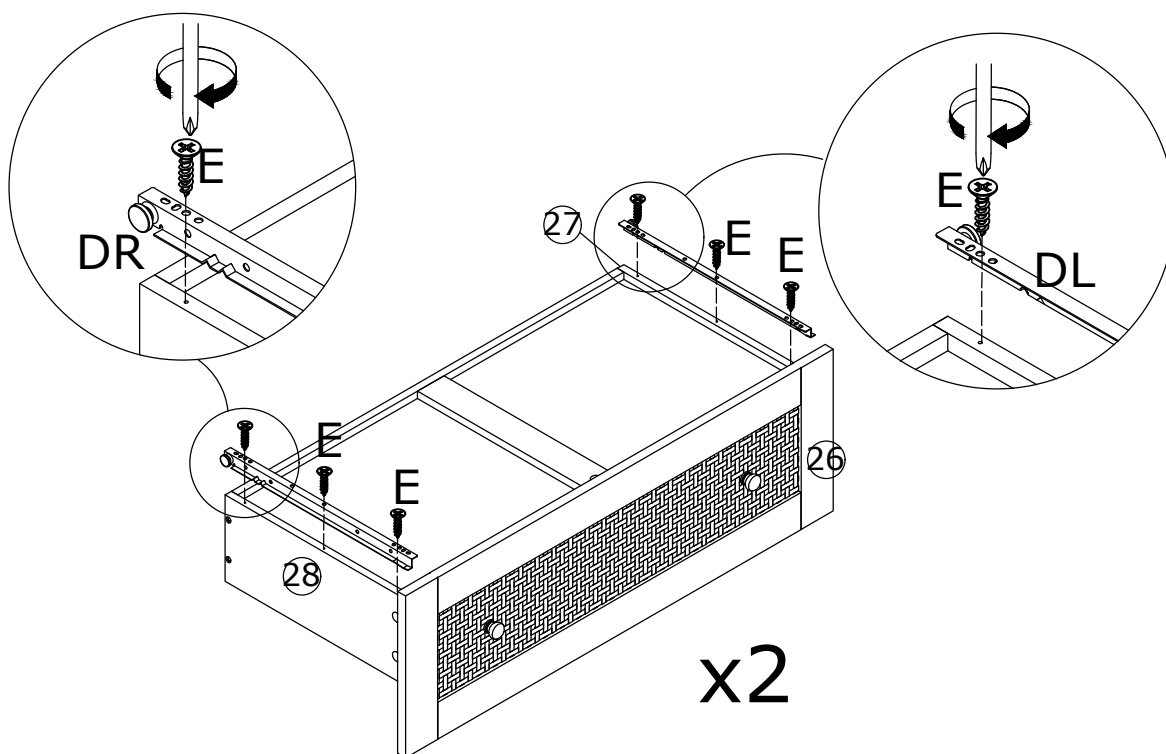

26

Align rails, slide the drawer . Place clothing rod 32 and 33 in.

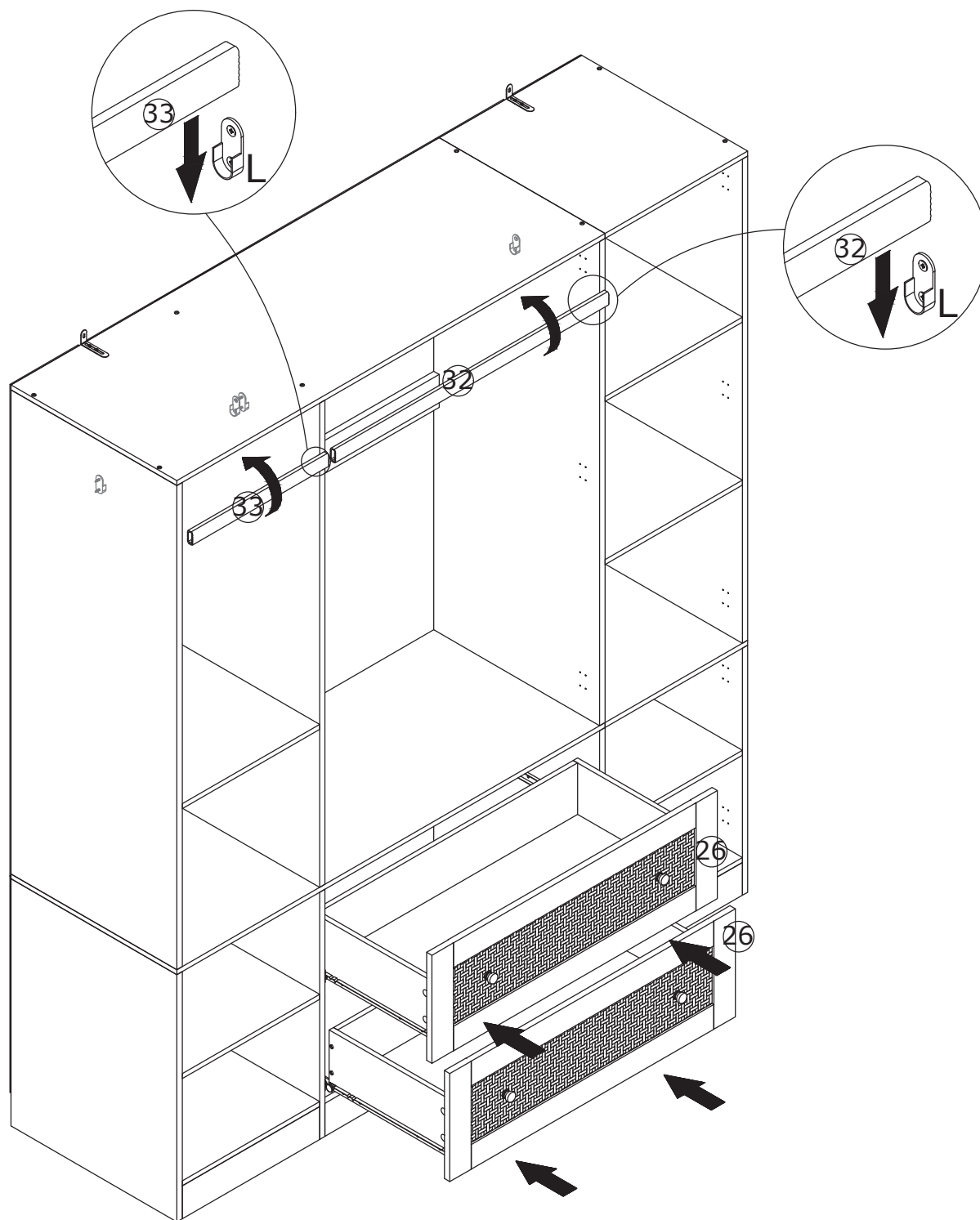

27

Fx6



Gx6



Ø4x25mm

Sx16



Ø4x25mm

Tx32



Ø4x14mm

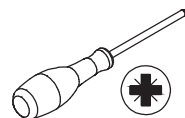

Fix hinge(S) to plate 24、25 and 36 using screw(T) as shown.
Fix knob(F) to these plates using screw(G) as shown.

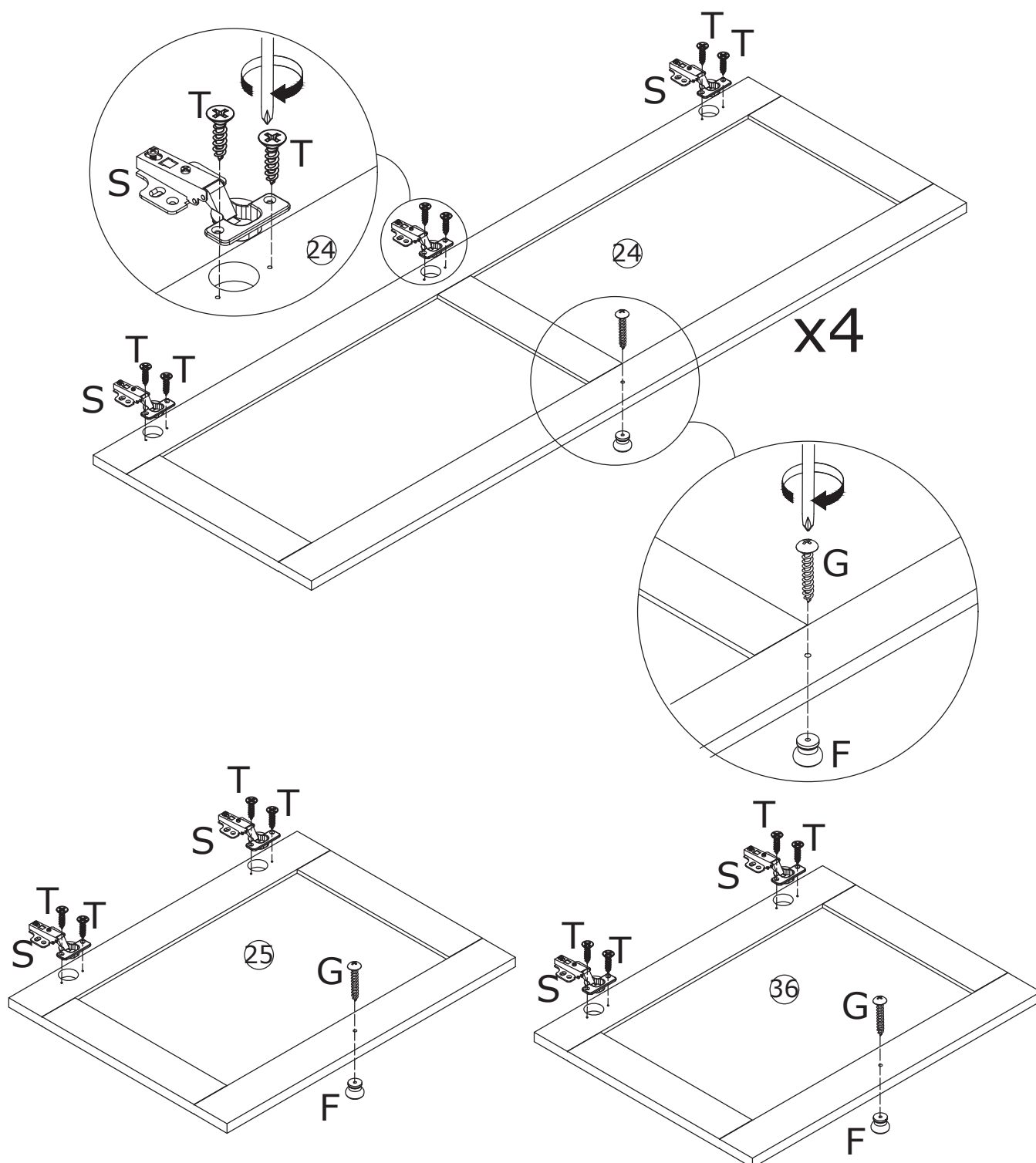

28

Tx24



Ø4x14mm

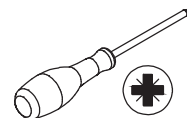

Attach door plate 24 to plate 6; door plate 24 to plate 7 by fixing hinge using screw(E) as shown.

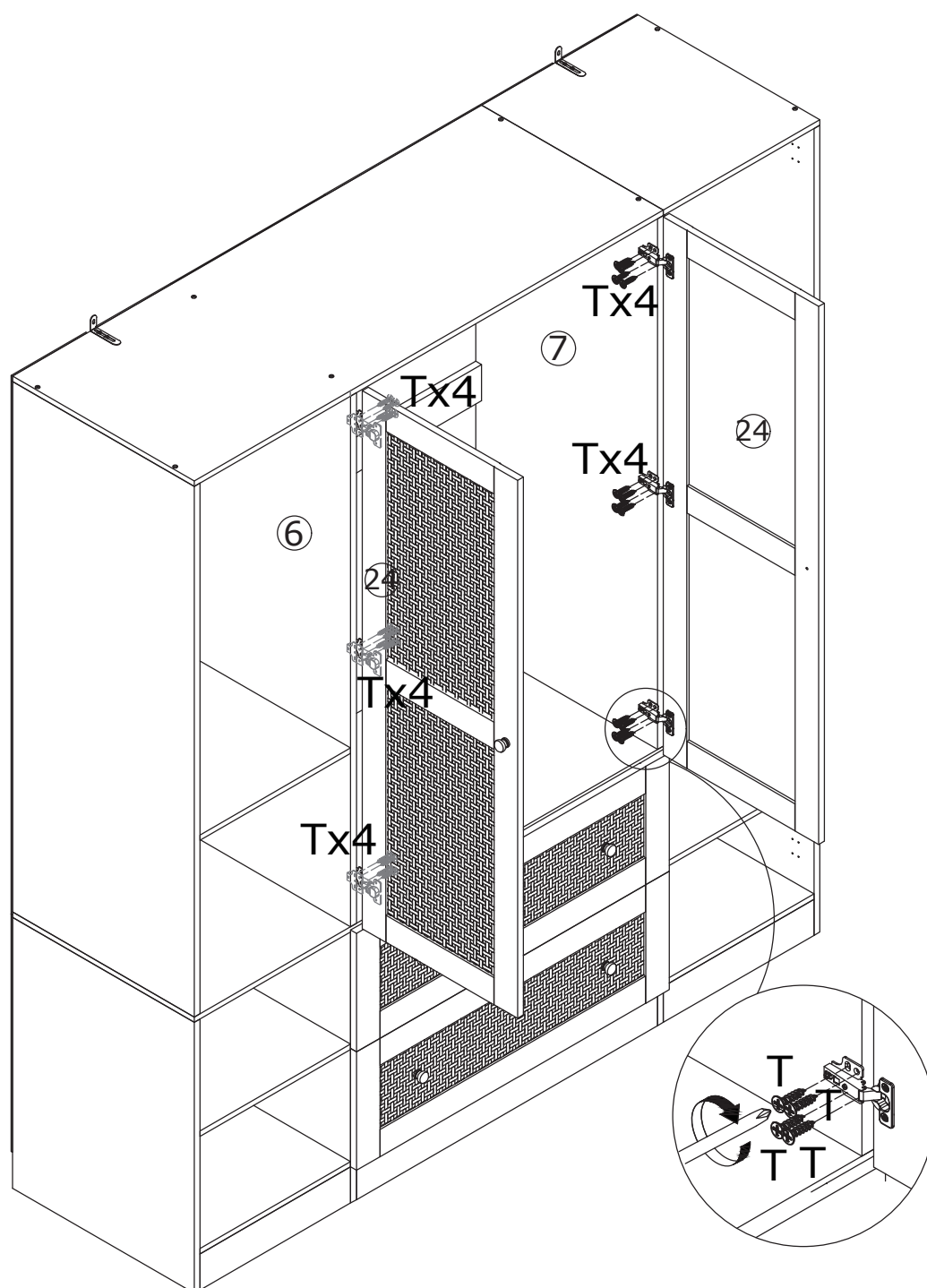

29

Tx24



Ø4x14mm

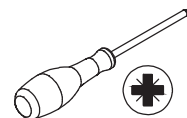

Attach door plate 24 to plate 5; door plate 24 to plate 8 by fixing hinge using screw(E) as shown.

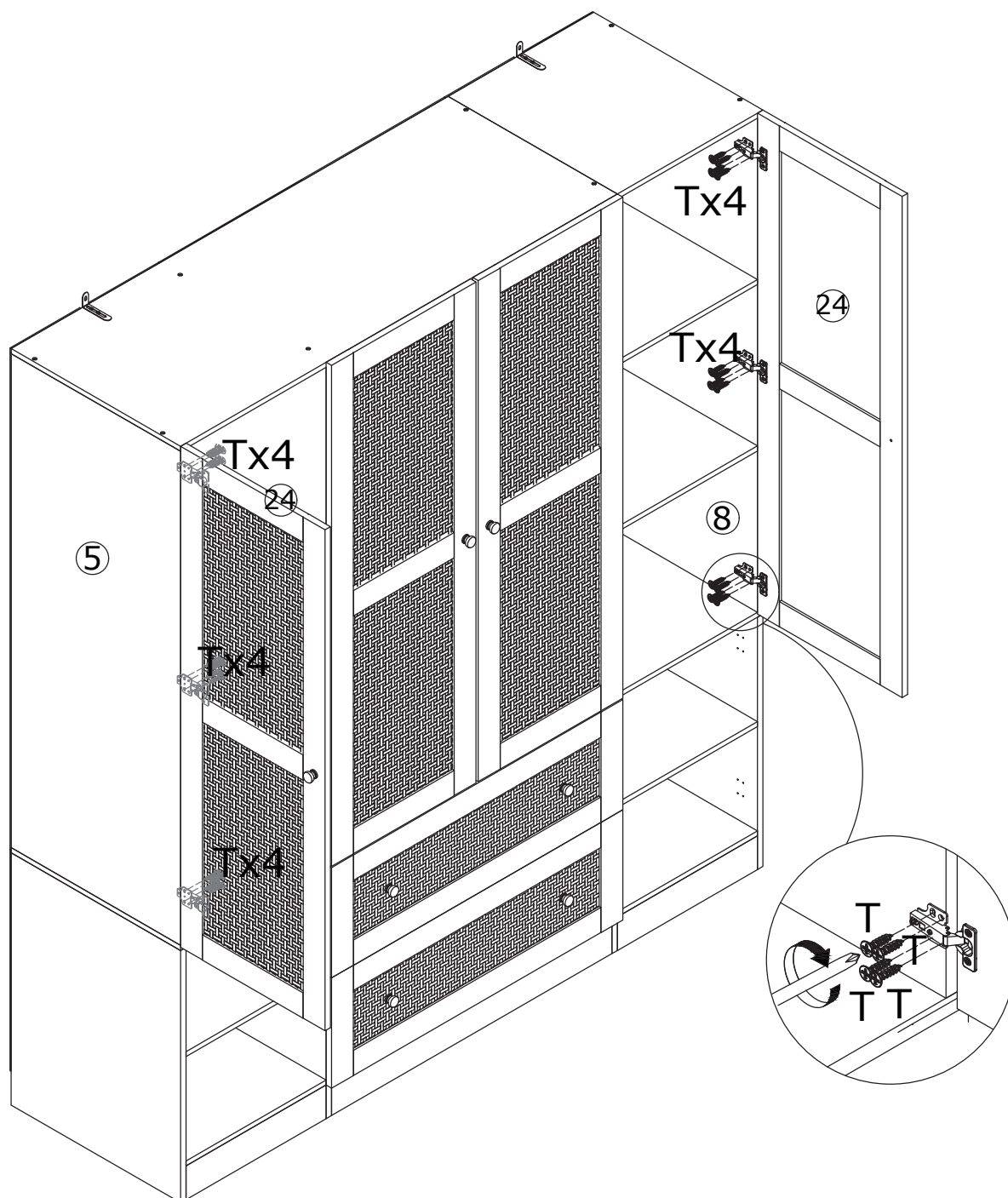

30

Tx16



Ø4x14mm

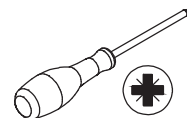

Attach door plate 25 to plate 9; door plate 36 to plate 12 by fixing hinge using screw(E) as shown.

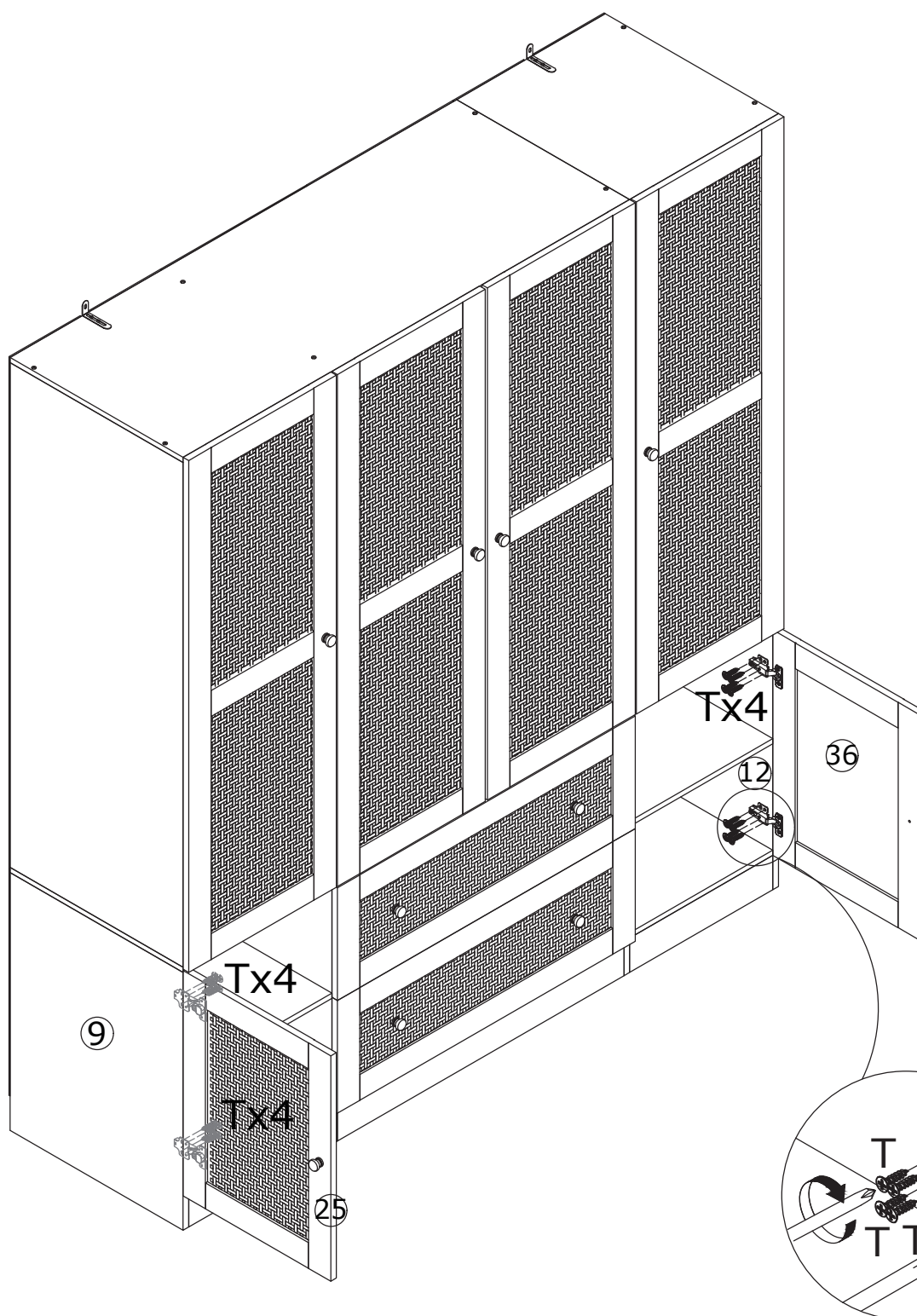

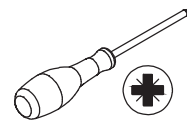

If doors are still not aligned if the hinges are properly correctly, please watch the video.

<https://youtu.be/n0Lb36SoODM>

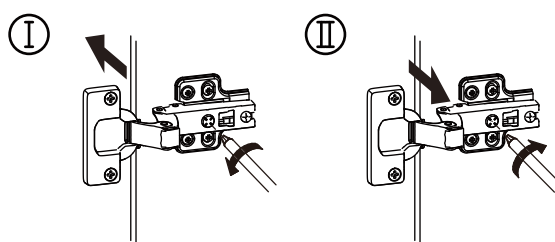
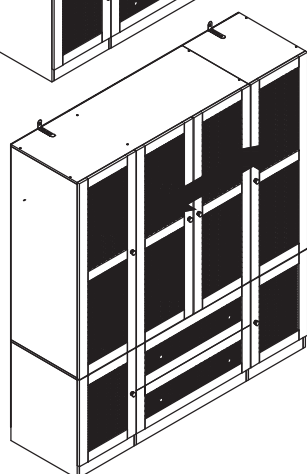
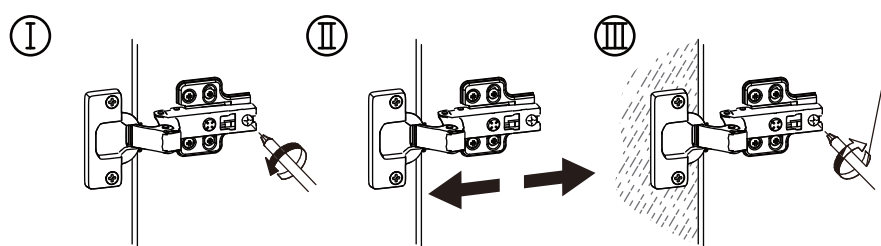
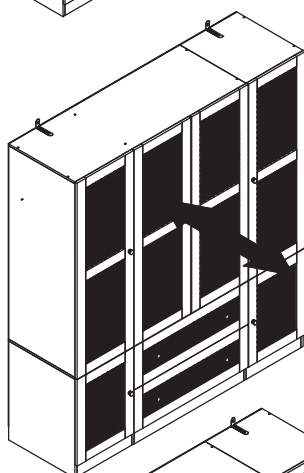
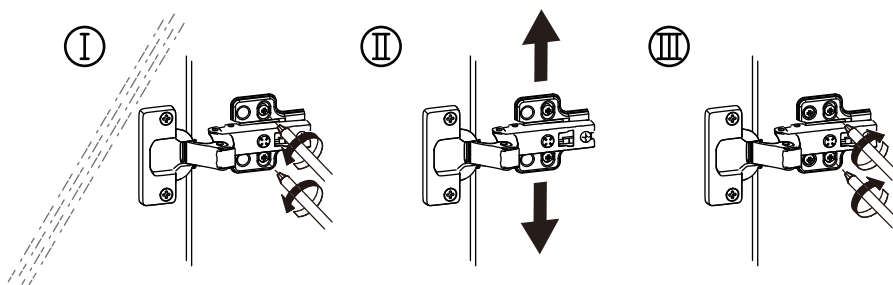
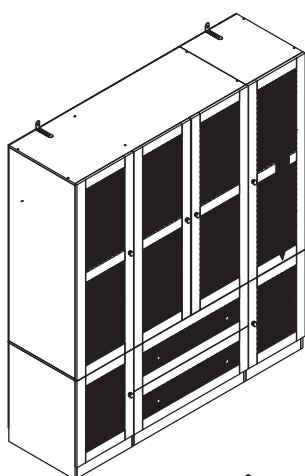
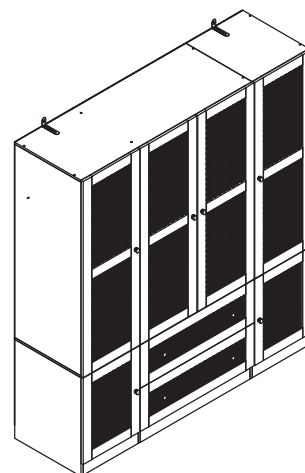

32

Dx2
Ø4x35mm

Px2

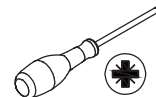
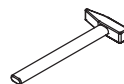
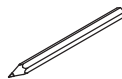

Install anti-tipping device as shown. Once assembled lift furniture into place, do not drag.

Use a drill to create a small hole lining up with the top of the safety strap (M). Fasten to wall using wall anchor (P), wall screw unit is balanced and steady before use.

You're done, enjoy.

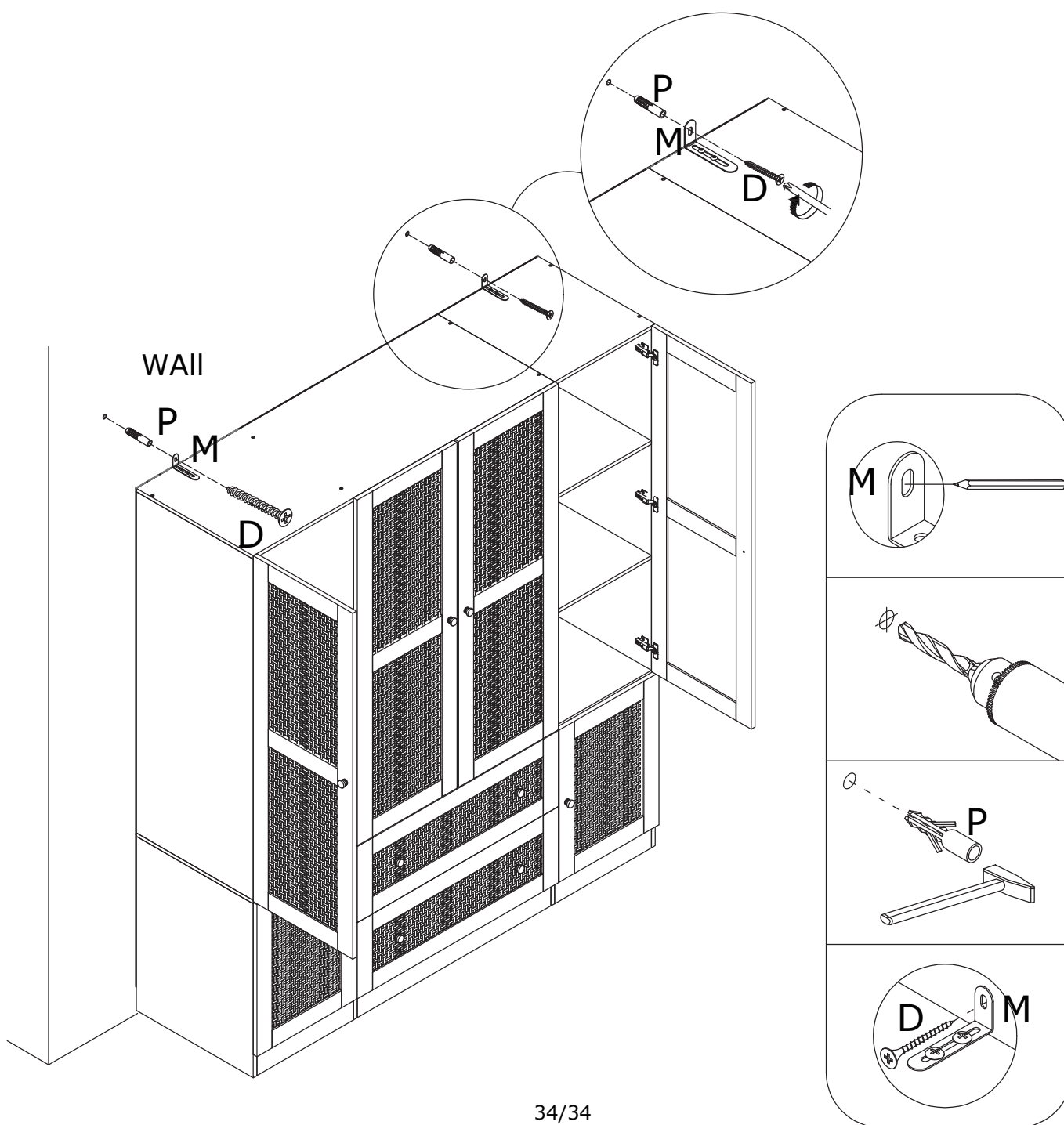

WARRANTY

WARRANTY CLAIMS

- There is a 30-day warranty for broken furniture or any other problems that do not work properly. The warranty will start from the date of purchase which must be verified by proof of purchase.
- Before making a claim, we may be able to answer your query, simply call us. Please leave your purchase order number, along with some details of the problem, if you want a replacement part. We will arrange within 48 hours. If there is out of stock, we will reply with a shipping date.
- The product must be used in accordance with the instructions provided. For health reasons.
- For other reasons, if the furniture needs to be returned, it must be cleaned and dried and operated within 30 days of receipt.

Type of Warranty Claim

- Failure to follow the furniture instructions will invalidate the warranty. Attention please.
- Does not include damage during installation, but includes damage during transportation.

Scope of responsibility

- Shall not bear any responsibility for misuse or user damage and / or loss of parts during the installation of furniture.
- After using, the damage and scratches of the furniture are not covered by the warranty.

The Warranty Relates to All Bought in The Us and Covers The Following Areas

- Sheet parts: 1 month from the date of purchase.
- Electrical parts: 1 month from the date of purchase.

RETURNS

CHANGED YOUR MIND AND NEED TO RETURN YOUR ITEM?

PLEASE FOLLOW THE BELOW INSTRUCTIONS:

- If you have purchased and have simply changed your mind, follow the retailer's instructions for returns.

DEFECTIVE ITEMS

- If your item is defective in any way, i.e. it doesn't work but you can't identify why, in the first instance, please call us.

DAMAGED ITEMS

- If you receive an order with obvious shipping damage from the retailer, then we suggest the delivery is refused. If the delivery has been accepted and then shipping damage is found, please follow the specific instructions advised by the retailer.
In all circumstances please save all packaging material and paperwork for the order. Please be aware that if you dispose of packaging material or attempt to return the merchandise without contacting the fulfiller, you jeopardise your chances of making a claim, and you may not receive a credit for the return.

AFTER-SALES CONTACT



feedbackstation@163.com



(303)800-6387