

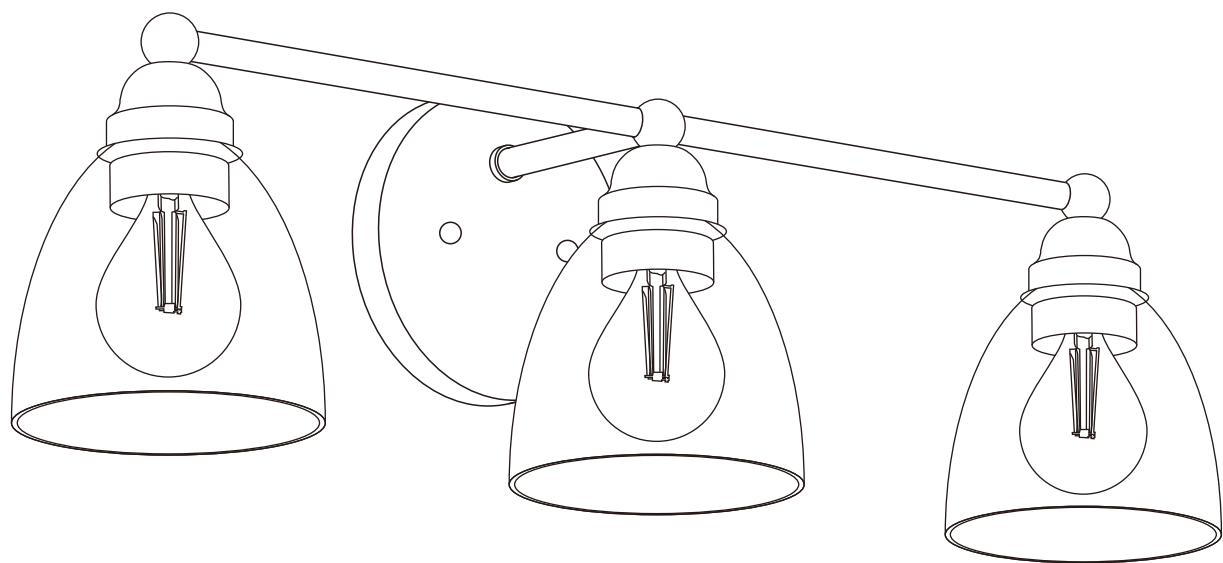

# USE AND CARE GUIDE





———— WALL LAMP ————

## Pre-Installation

### PACKAGE CONTENTS

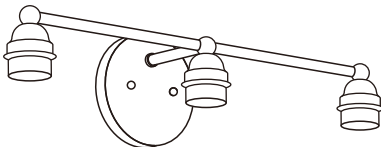
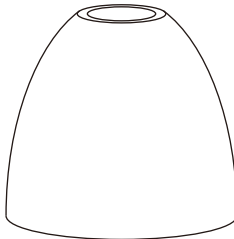
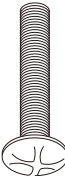
 NOTE:Hardware not shown to actual size.

						<div>CC</div> <div>DD</div> <div>X2X3</div>		
A	Lamp holder	1	B	Lampshade	3	Parts		

# Installing the Light



**WARNING:** To avoid possible electrical shock, turn the electricity off at the main fuse box before wiring. If you feel you do not have enough electrical wiring knowledge or experience, contact a licensed electrician.

- Remove the hanging plate (BB) by rotating the nut (AA) on the lamp holder.

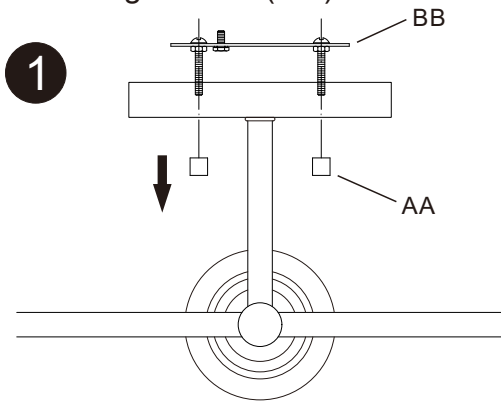

- Use screws (CC) to fix the hanging board to the junction box and extend the wires of the junction box outside the box.

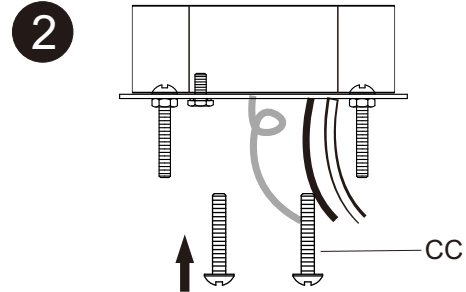

- Connect the wires using wiring nuts (DD) as shown.
- Use electrical tape to secure each wiring nut (DD).

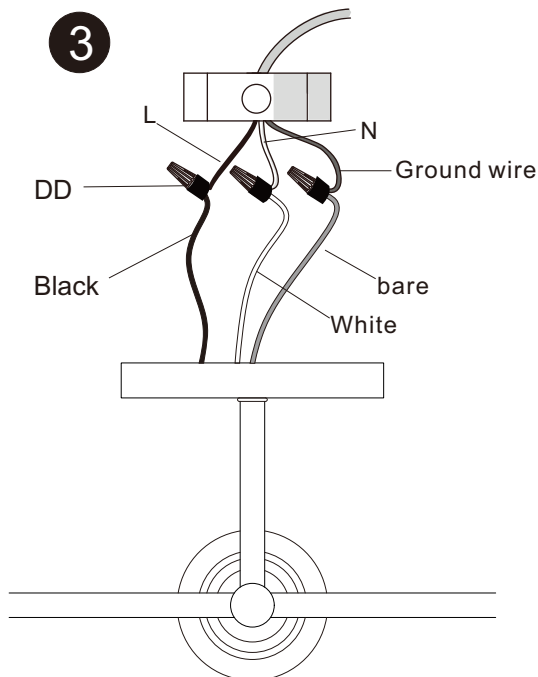

- Install the lamp onto the hanging board (BB) using nuts (AA).

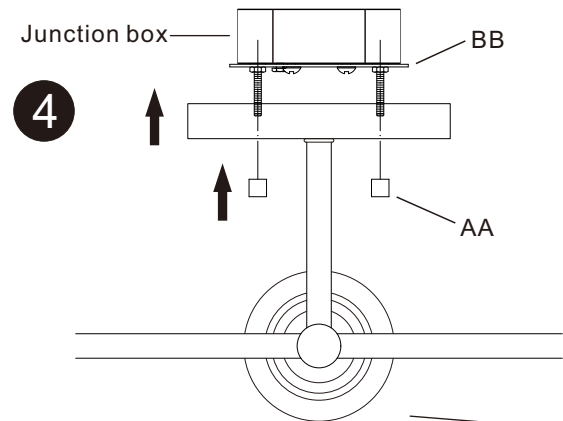

- Install the lampshade and bulb as shown. (Light bulbs need to be purchased by oneself.)

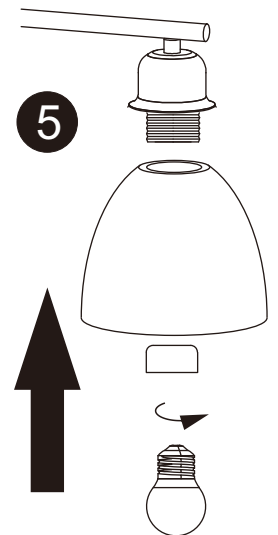

## Tips

- For daily cleaning, you can use a damp cloth to wipe the surface without using corrosive chemicals.
- Electrical products must be discarded in an environmentally friendly area.