

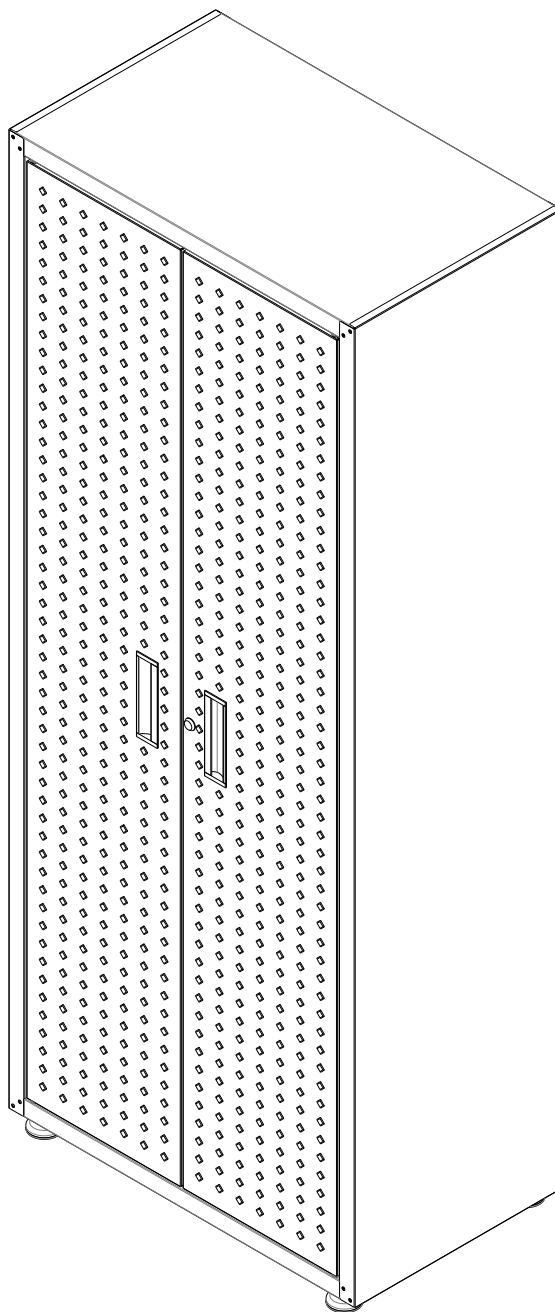

MANHATTAN
COMFORT

ASSEMBLY HANDBOOK- FORTRESS 74.8" TALL GARAGE CABINET



1GMCF



Stuck? Questions? We are here to help.
1-888-230-2225
help@manhattancomfort.com



View our assembly video online
www.manhattancomfort.com

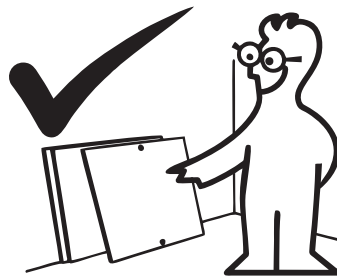
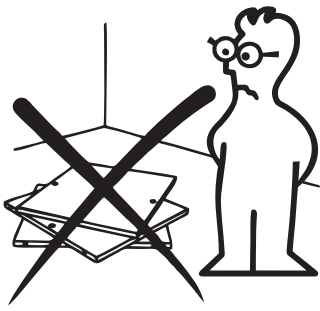

In order to ease the assembly, you should separate and identify the parts first

Necessary hardware for the assembly, leveling and safety

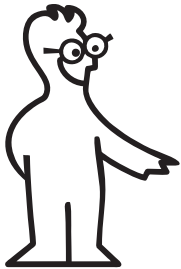

* Included in the kit

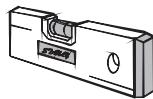

* Not included in the kit

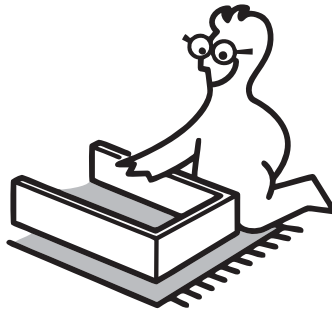
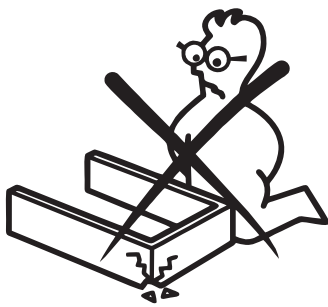
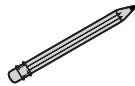

Do not place the parts directly onto the floor. Use a cardboard sheet or a mat to place the parts, during the separation and assembly.

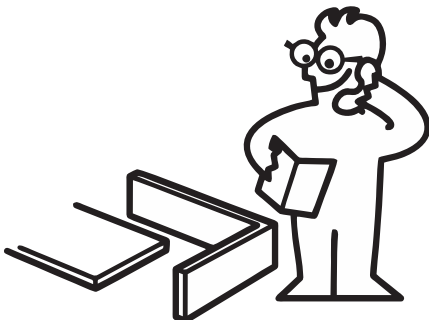

Stuck? Questions? We are here to help.
1-888-230-2225
help@manhattancomfort.com



View our assembly video online
www.manhattancomfort.com

IMPORTANT

In order to avoid severe or even fatal injuries, follow the instructions carefully.

This furniture should be fixed onto the wall, so to avoid possible drops.

Different types of walls demand different types of hardware.

Hardware to fix the furniture to the drywall is included in the kit.

Should your wall be different, please, ask for advice at the hardware store.

ASSEMBLY HANDBOOK TALL CUPBOARD - FORTRESS 74.8" TALL GARAGE CABINET

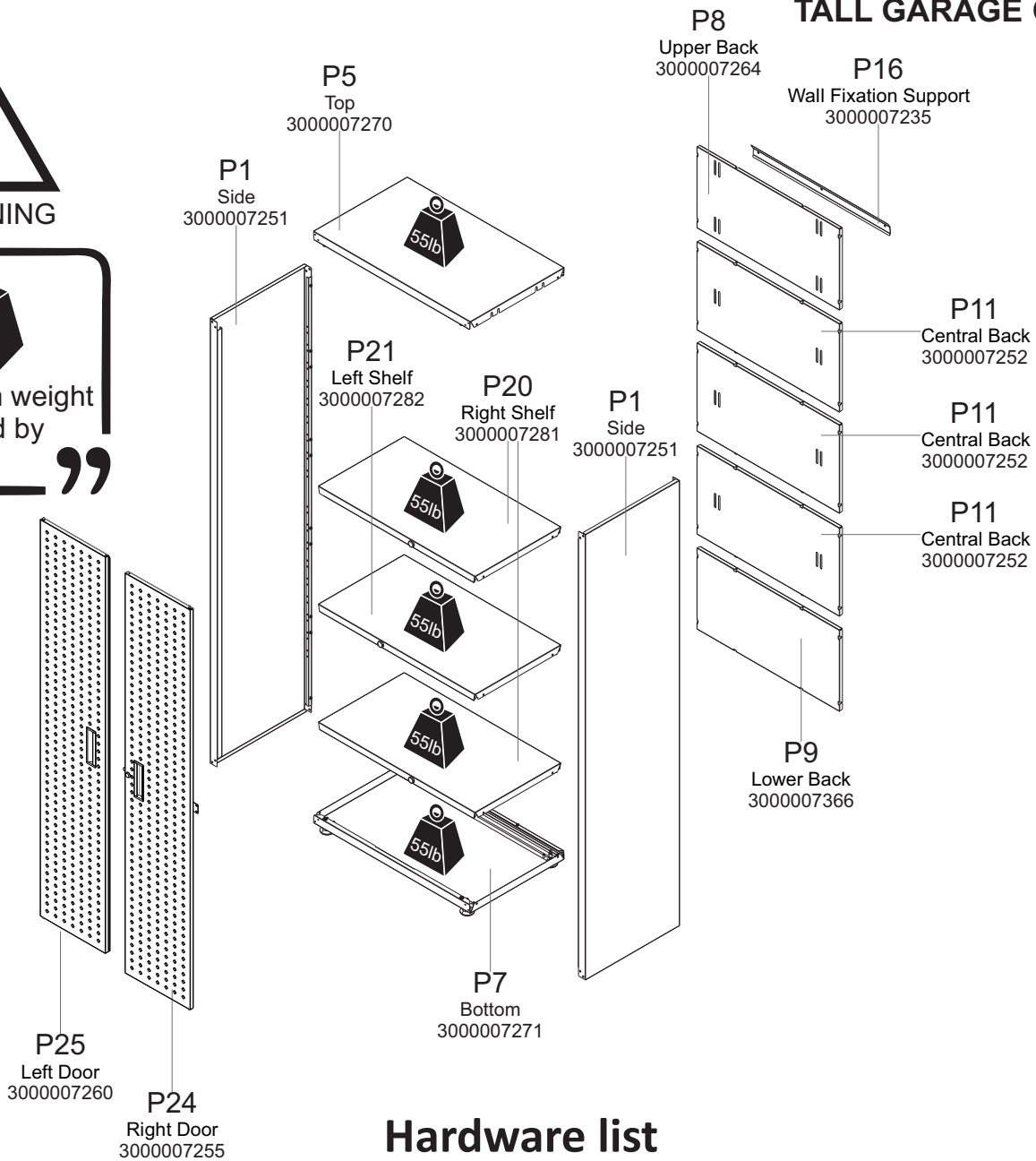

Hardware list

F1
1000009500

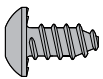

Qty. 20

F2
1000009499

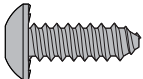

Qty. 4

F5
1000008616

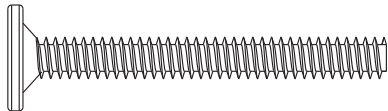

Qty. 3

F7
1000008301

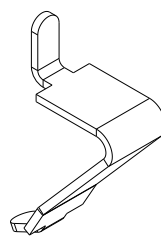

Qty. 12

F15
1000008280

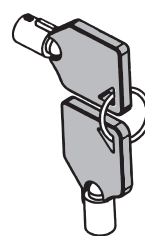

Qty. 1

F13
1000009033

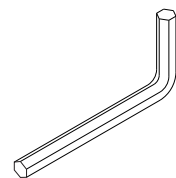

Qty. 1

F12
1000008373

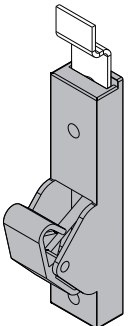

Qty. 2

F17
1000008285



Qty. 1

F9
1000008368

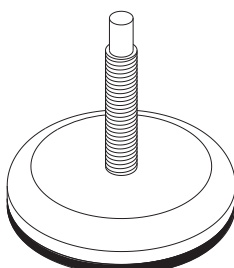

Qty. 4

F14
1000008297

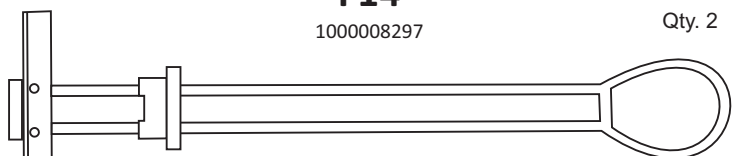

Qty. 3

- STEP 1**
- 1 - Fit part **P5** inside part **P1**
 - 2 - Fit both parts in the frontal side, with **F1**

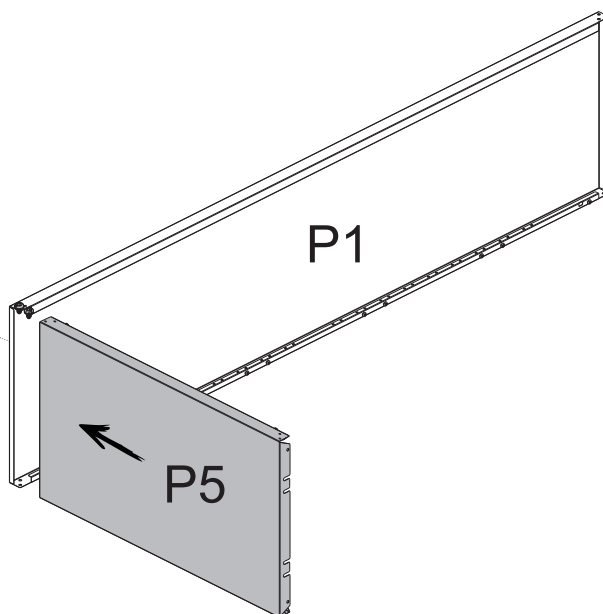
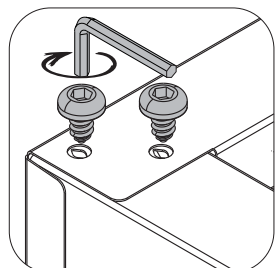
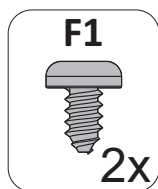

-
- STEP 2**
- 1 - Fit part **P7** inside part **P1**
 - 2 - Fit both parts in the frontal side, with part **F1**

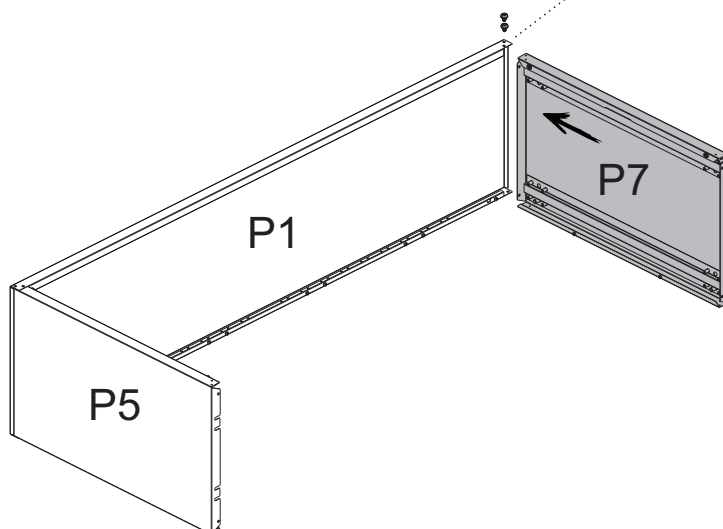
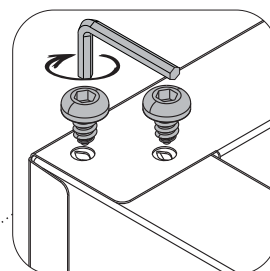
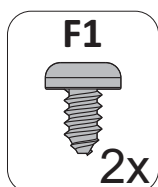

STEP 3

1 - Fit part **P1** to part **P5** and **P7**

2 - Fit part **P1** to parts **P5** and **P7** at the frontal side, with **F1**

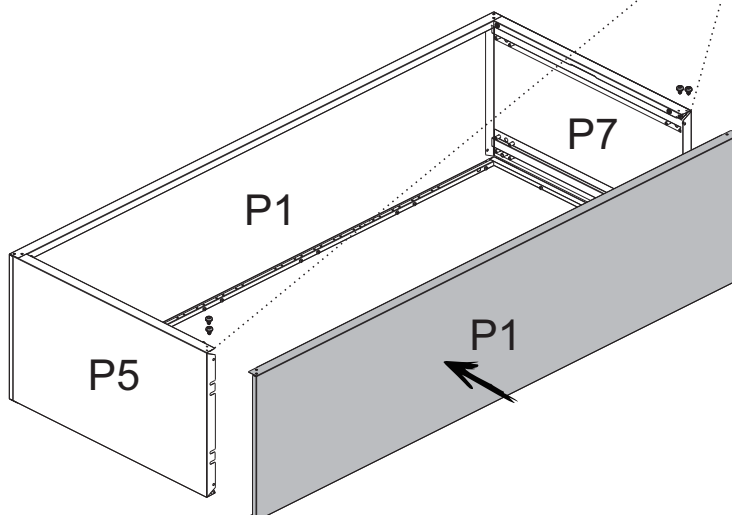
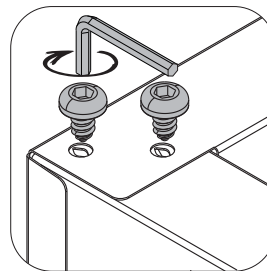
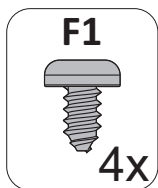

STEP 4

1 - Turn the cupboard with the back side upwards

2 - Fit parts **P1** to parts **P5** and **P7** with **F1**

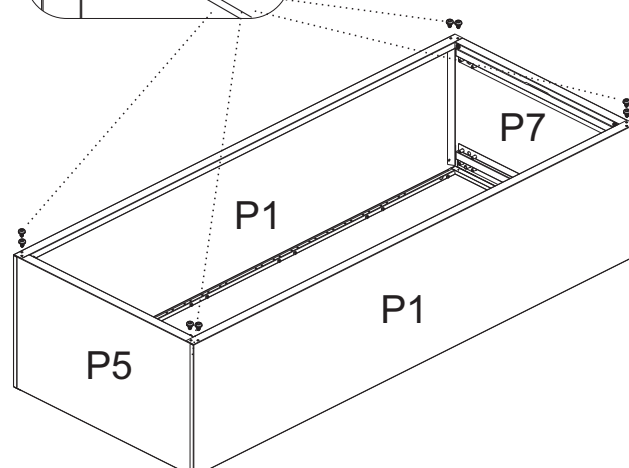
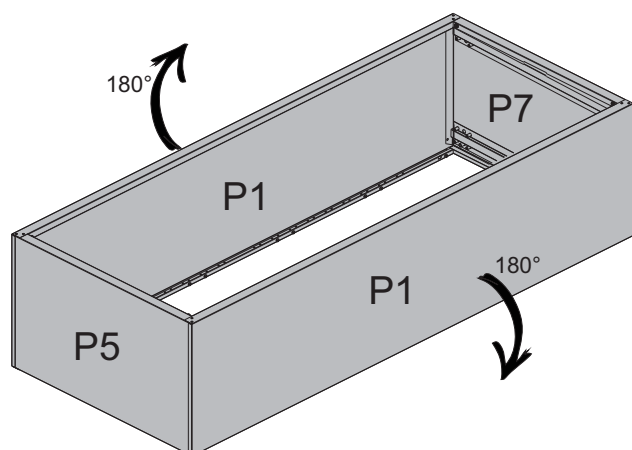
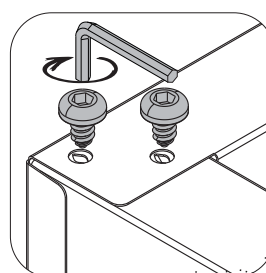
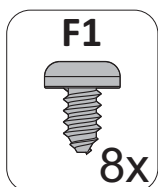

STEP 5

- 1 - Fit part **P8** into part **P5** and parts **P1**
- 2 - Check that all fits are supported over the bolts
- 3 - After fitting the parts, screw the bolts until locked



WARNING

“
Position part **P8** on
the **P4** side for
mounting the
cabinet.”

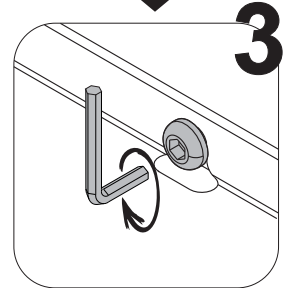
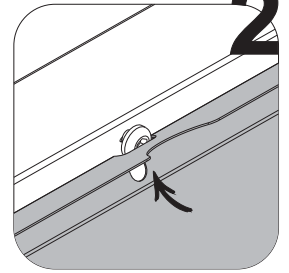
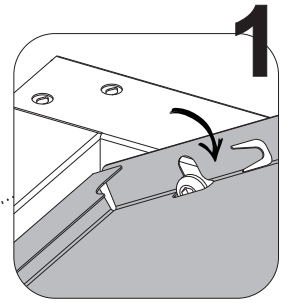
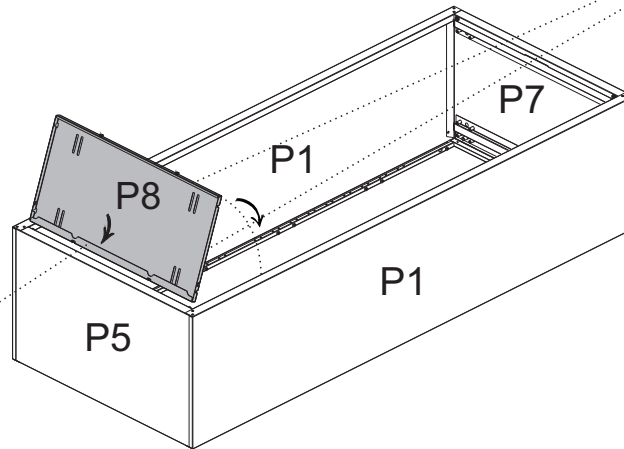

STEP 6

- 1 - With the end of **F13**, smash the safety claw, locking part **P8** to part **P1**.

F13

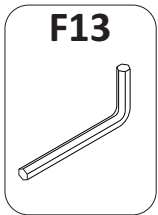

WARNING

“
To avoid possible
falls, this safety
claw should be
fixed.”

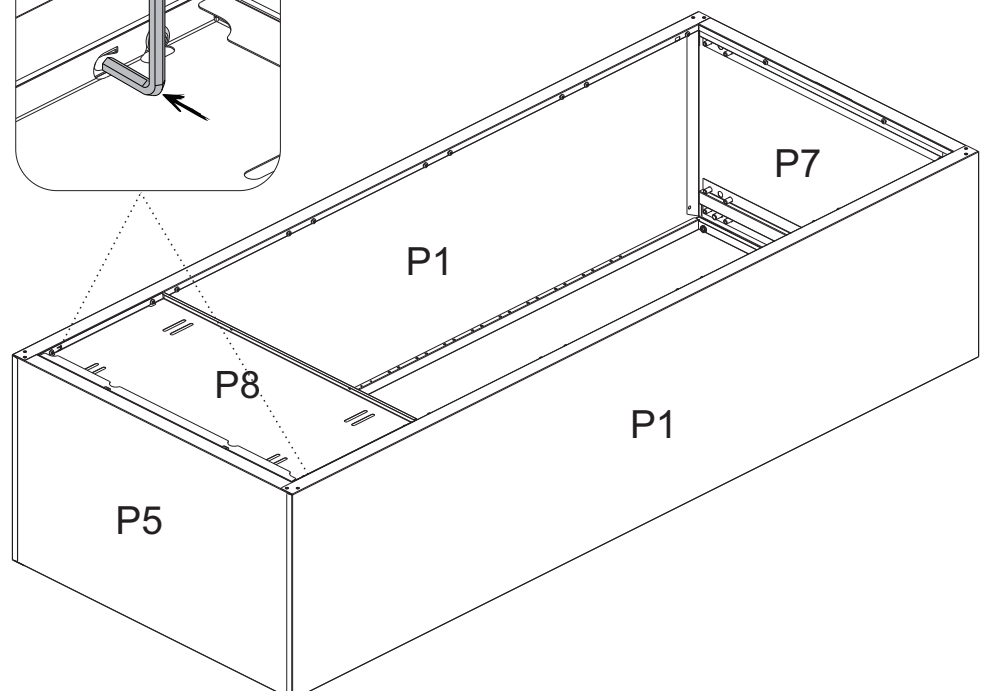
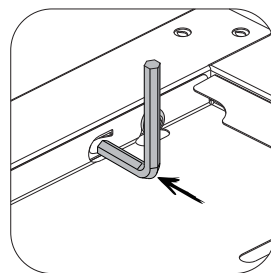

STEP 7

- 1 - Fit parts **P11** inside parts **P1** and **P8**, as illustrated here below.
Check that all fits are supported over the bolts
- 2 - After fitting the parts, screw the bolts until locked

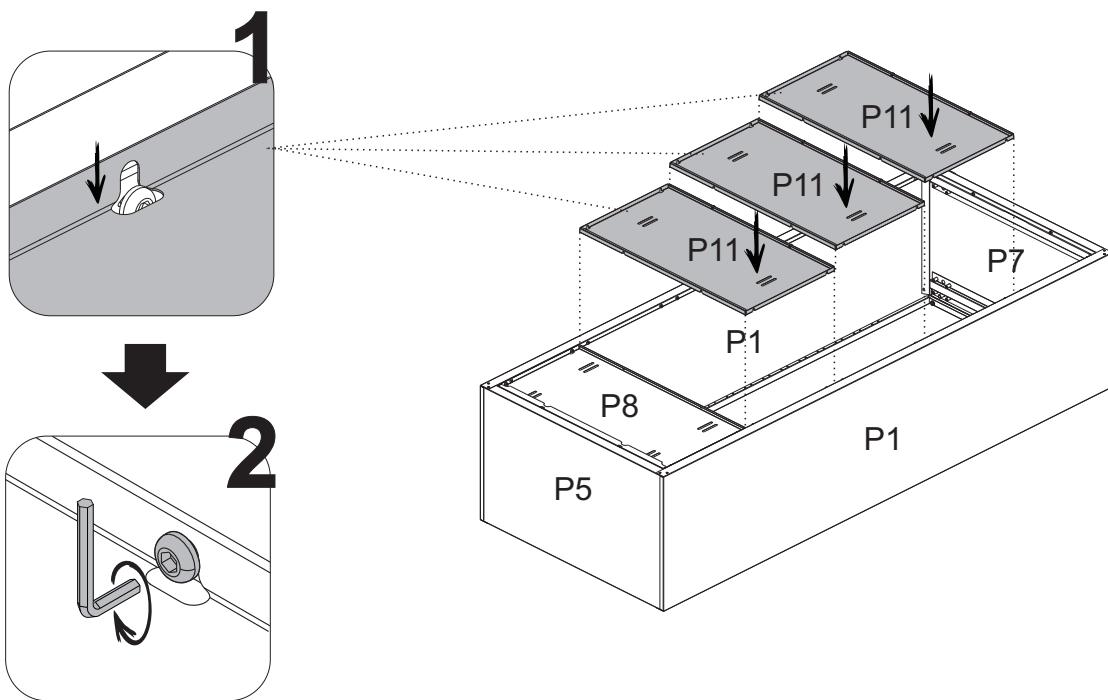

STEP 8

- 1 - Fit part **P9** inside parts **P1**, **P11** and **P7**.
Check that all fits are supported over the bolts.
- 2 - After fitting the parts, screw the bolts until locked

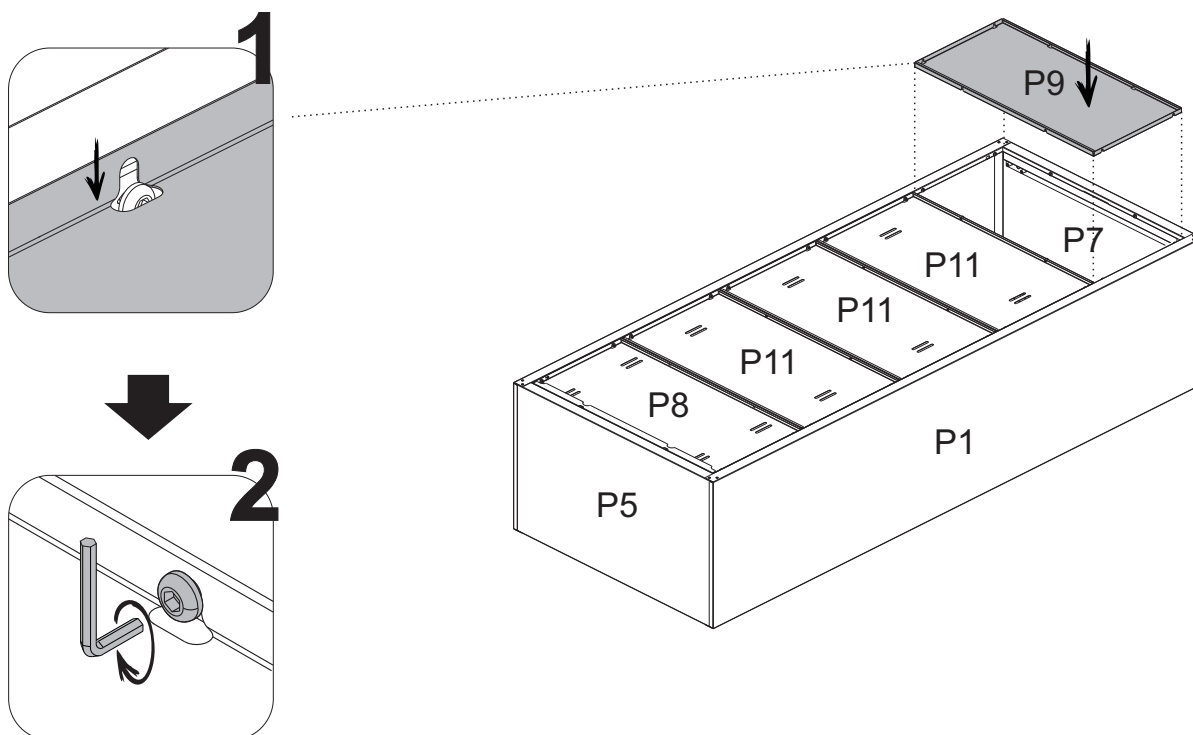

STEP 9

1 - To assembly the cabinet with shoe fit the accessory in part **P7** as illustrated here below and turn to screw. To level the height or the cabinet, turn the shoe either clockwise or counterclockwise to align it.

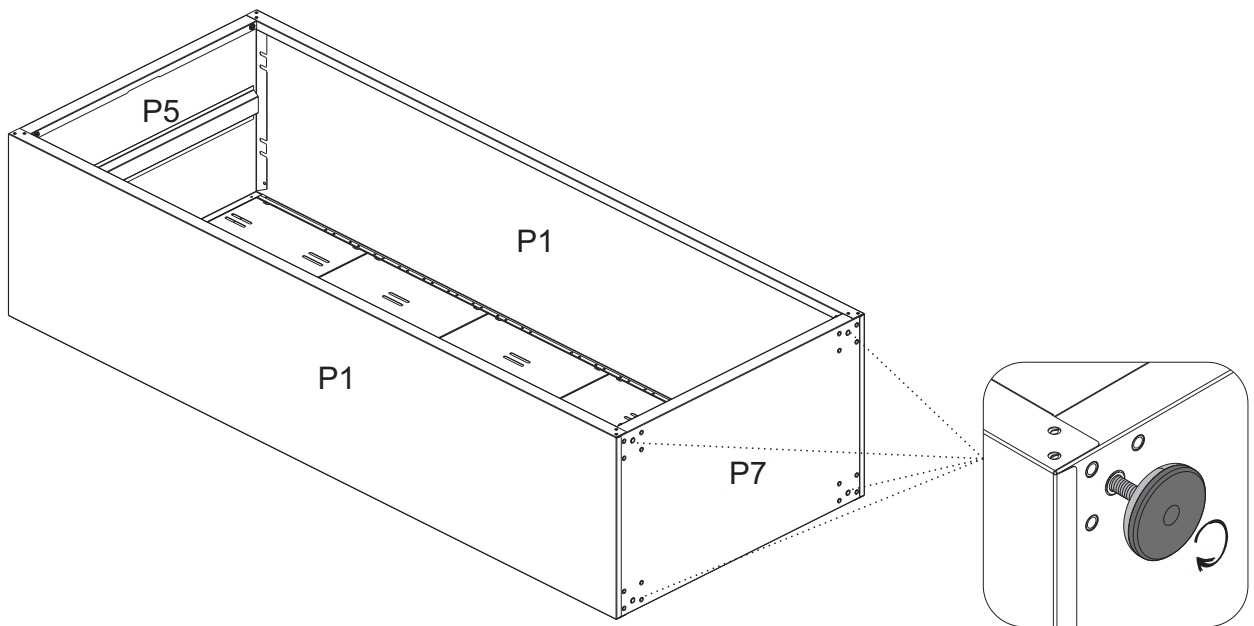
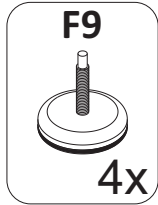

STEP 10

- 1- Turn the cupboard so that it will stand in the position of use
- 2- Fix **F7** to parts **P1**, as shown here below

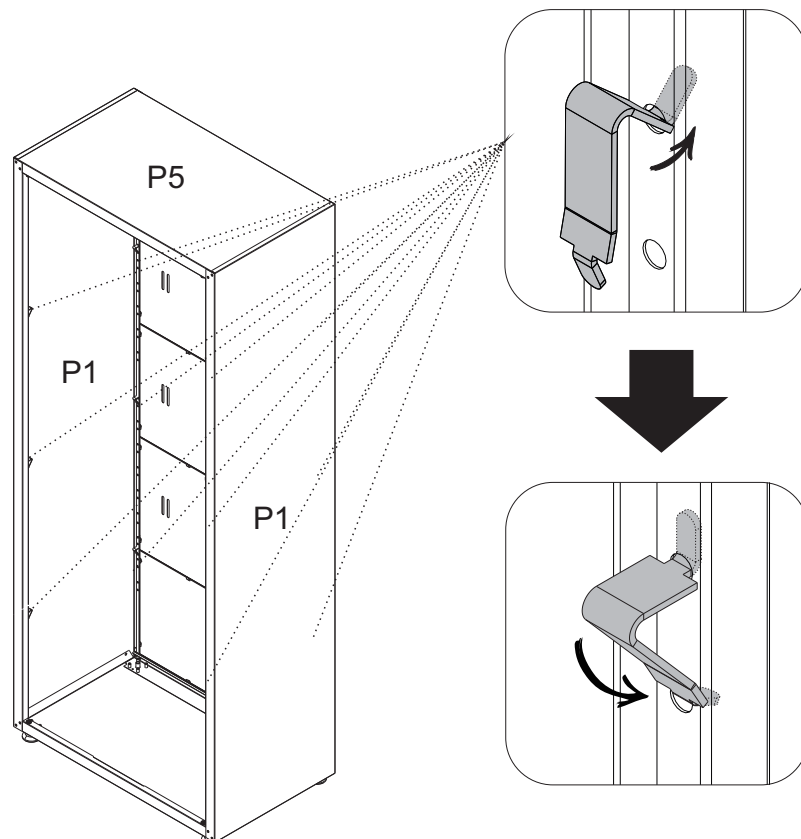
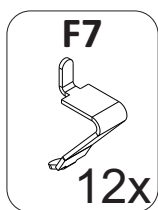

STEP 11

- 1 - Fit the lower part **P20** in diagonal position to insert it inside the cupboard
- 2 - Lean part **P20** in part **P1** and place it over the **F7** detailed in the figure here below
- 3 - Lower the other side of part **P20**, leaning it over the left **F7**
- 4 - Repeat above steps for all parts **P20** and **P21**

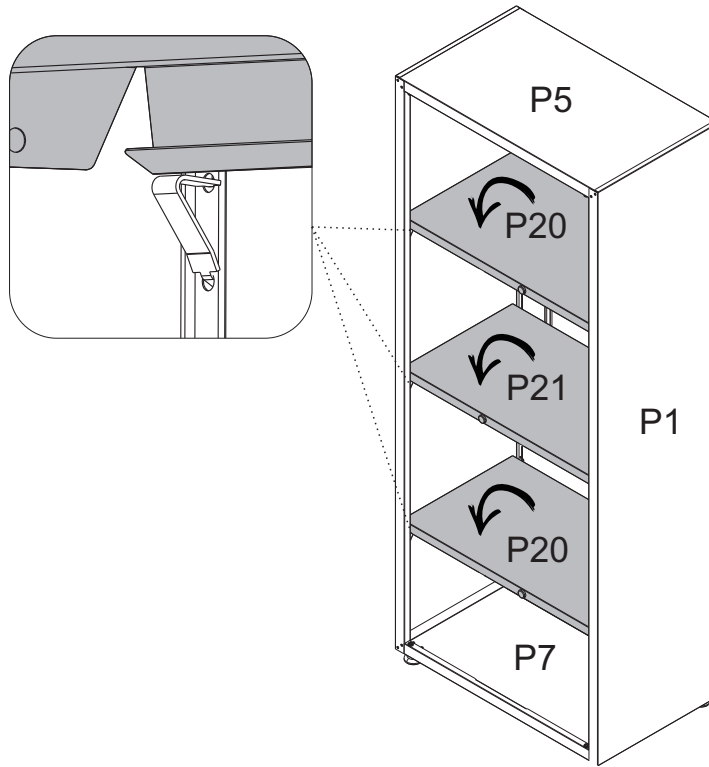
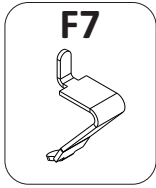

STEP 12

- 1 - Align part **P16** at an approximate height of 72 1/2" from the floor
- 2 - Align the part using a level
- 3 - Mark the wall using holes of part **P16**, aided by a pencil

- 4 - Withdraw the part
- 5 - Drill the wall where marked on the wall, with the pencil using a drill with a 1/2" (13 mm) drill



WARNING

“The cupboard must be fixed onto the wall”

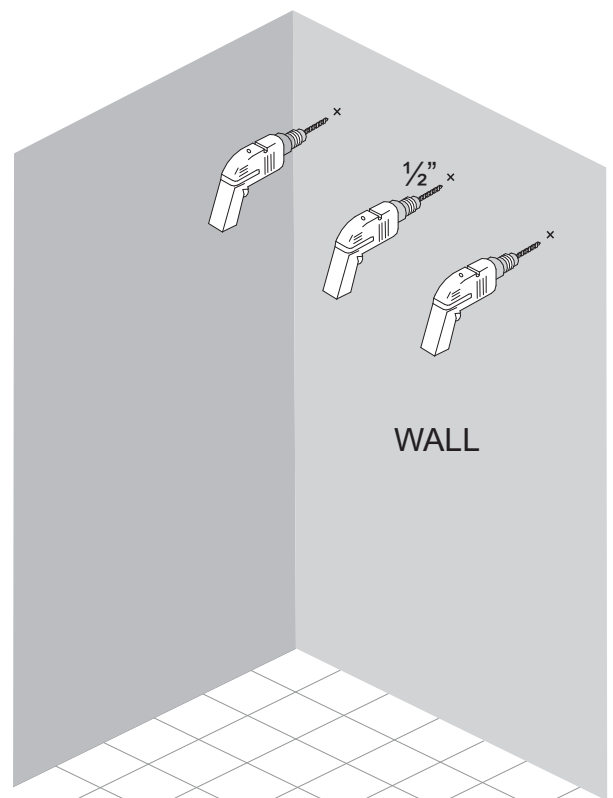
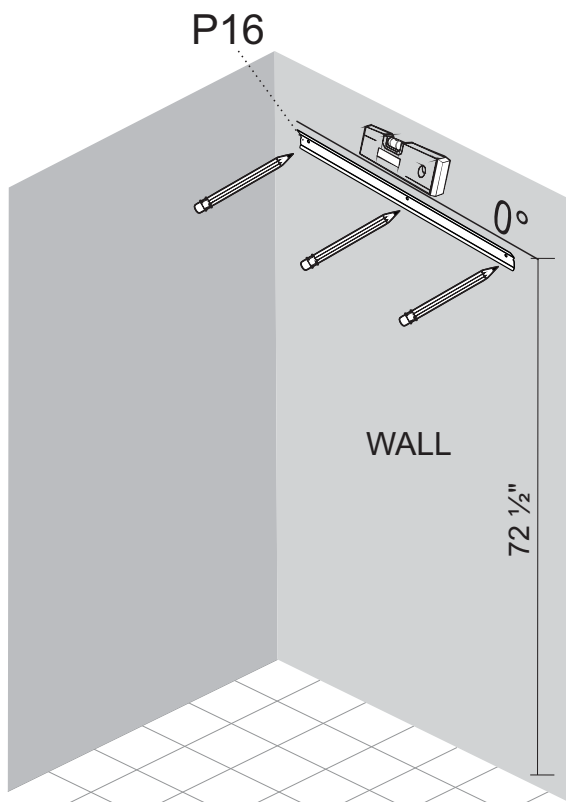

STEP 13

F14

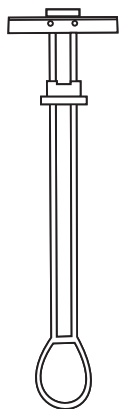

3x

1 - Insert the metal part of the bushing into the hole until it overcomes the wall.

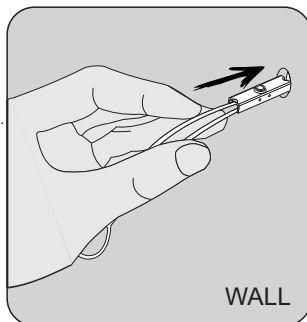
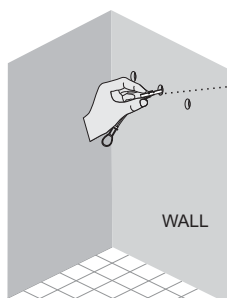

2 - Pull the bushing driving it against the wall and then push the plastic ring until it leans close to the wall

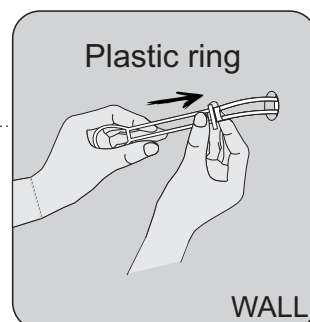
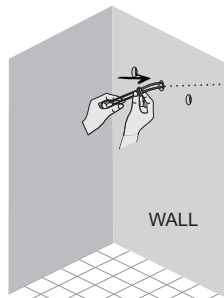

3 - Break the bushing's rods

1

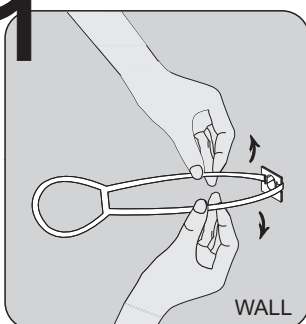
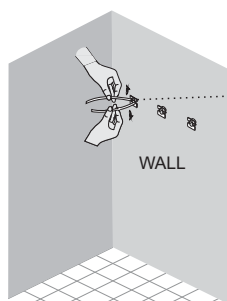

2

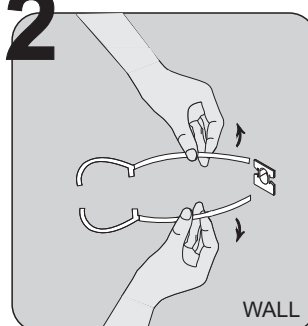

STEP 14

F5

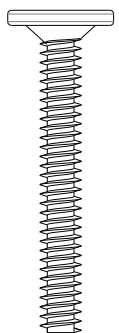

3x

1 - Align part **P16** to the bushings and fix them with **F5**

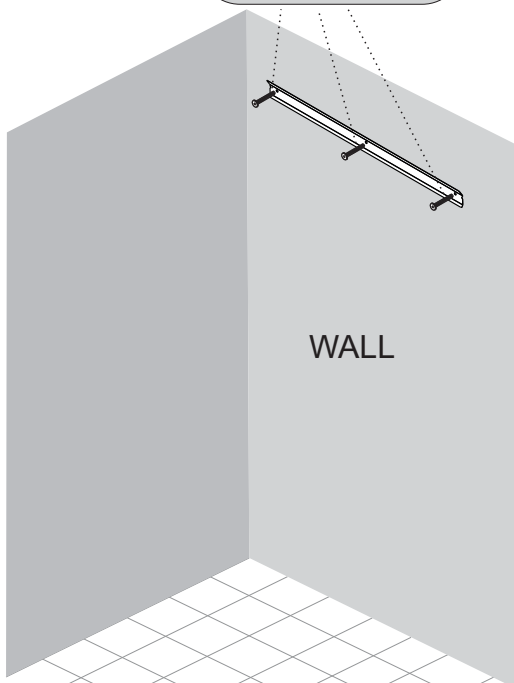
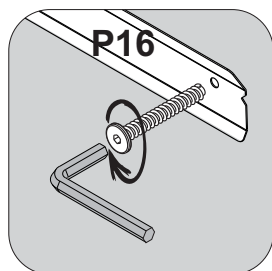

2 - Fix the cupboard to part **P16**, held to the wall. Part **P8** tab shall be used to this purpose.

3 - Adjust feet

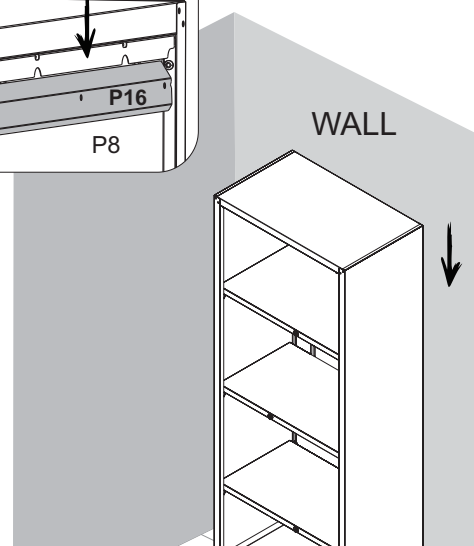
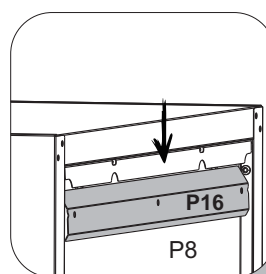
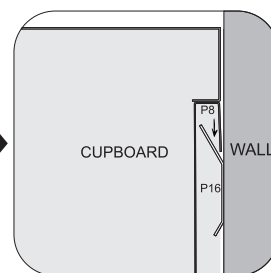
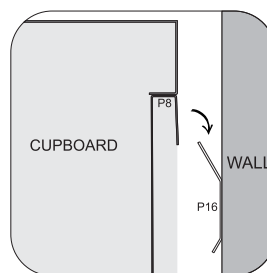

STEP 15

- 1 - To assembly the doors, fit door **P24** lower hinge bolt inside the bushing fixed in part **P7**
- 2 - Then, pull down the pin of door **P24** upper hinge; align the door and release the pin to fit the bushing fixed in part **P5**
- 3 - Repeat the step for part **P25**

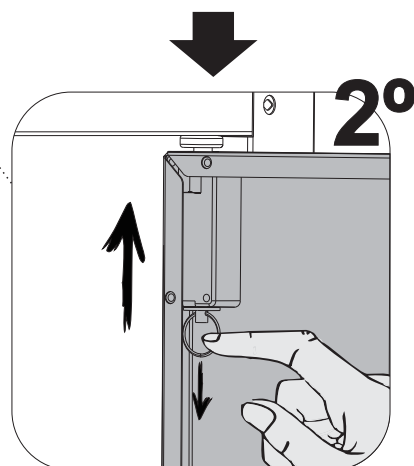
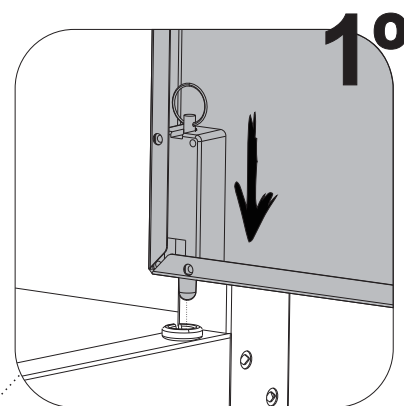
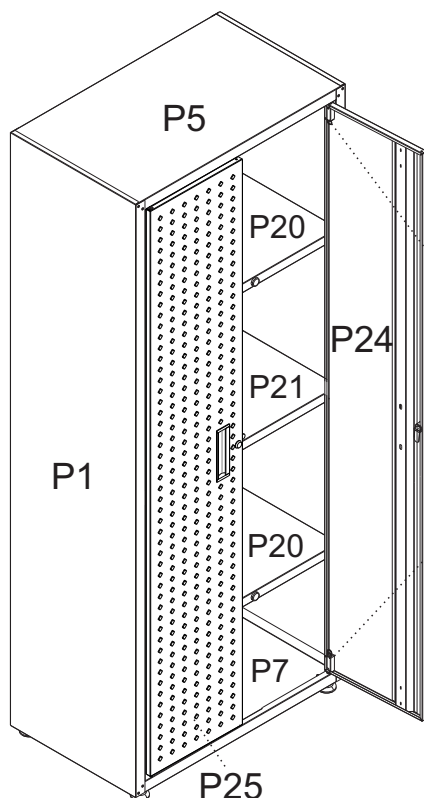

STEP 16

- 1 - Turn the central hinge tab until it leans onto **P1** hinge back part. Align the hinge tab and **P1** holes and fix it with **F1**
- 2 - Repeat the step for part **P25**

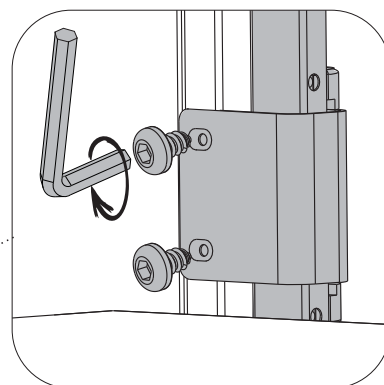
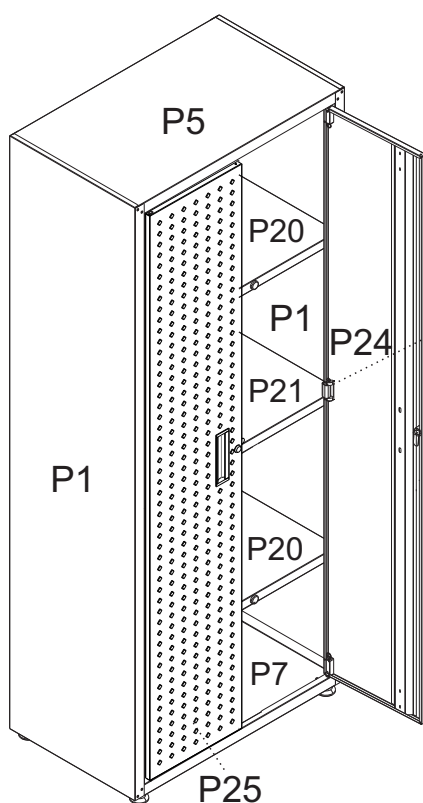
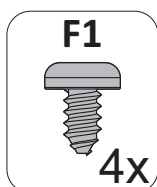

STEP 17

- 1 - Fit **F12** to the inside of part **P25**, with **F2**
- 2 - Adjusting the position of the locking tongue

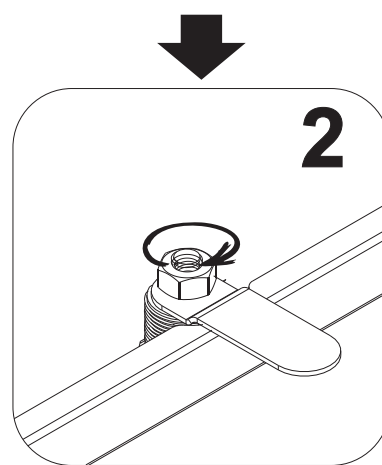
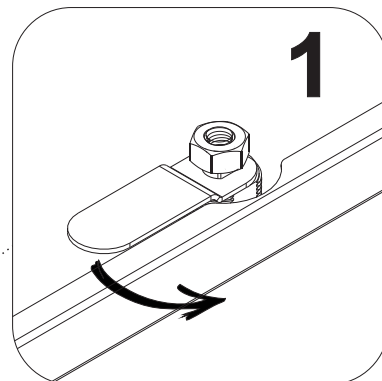
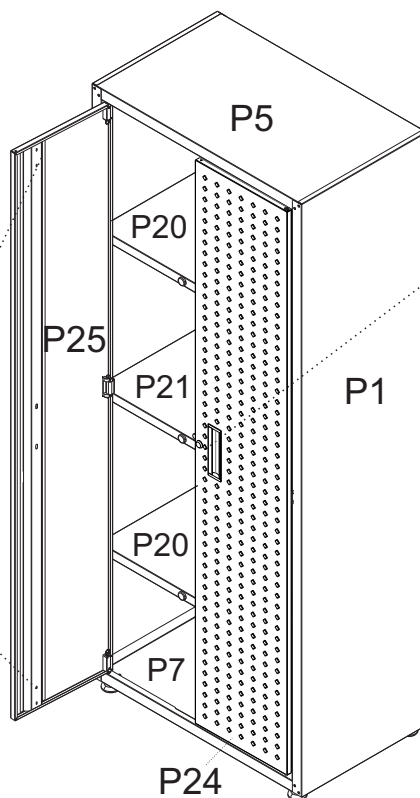
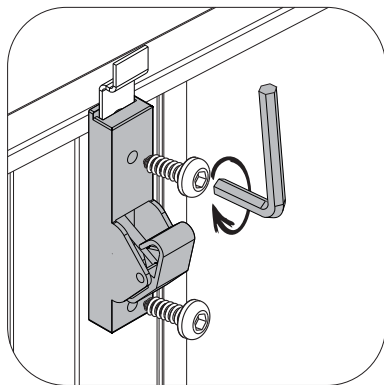
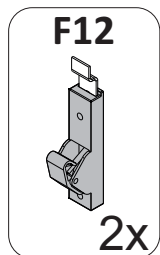
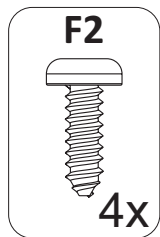

STEP 18

- 1 - Insert product log

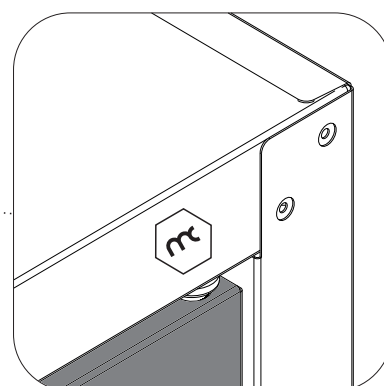
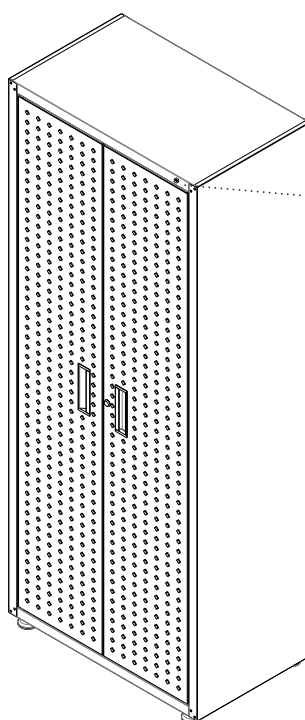
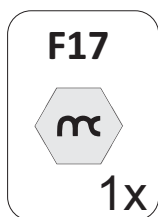



MANHATTAN
COMFORT

ASSEMBLY HANDBOOK – FORTRESS 31.5" MOBILE GARAGE CABINET WITH DRAWER AND SHELVES

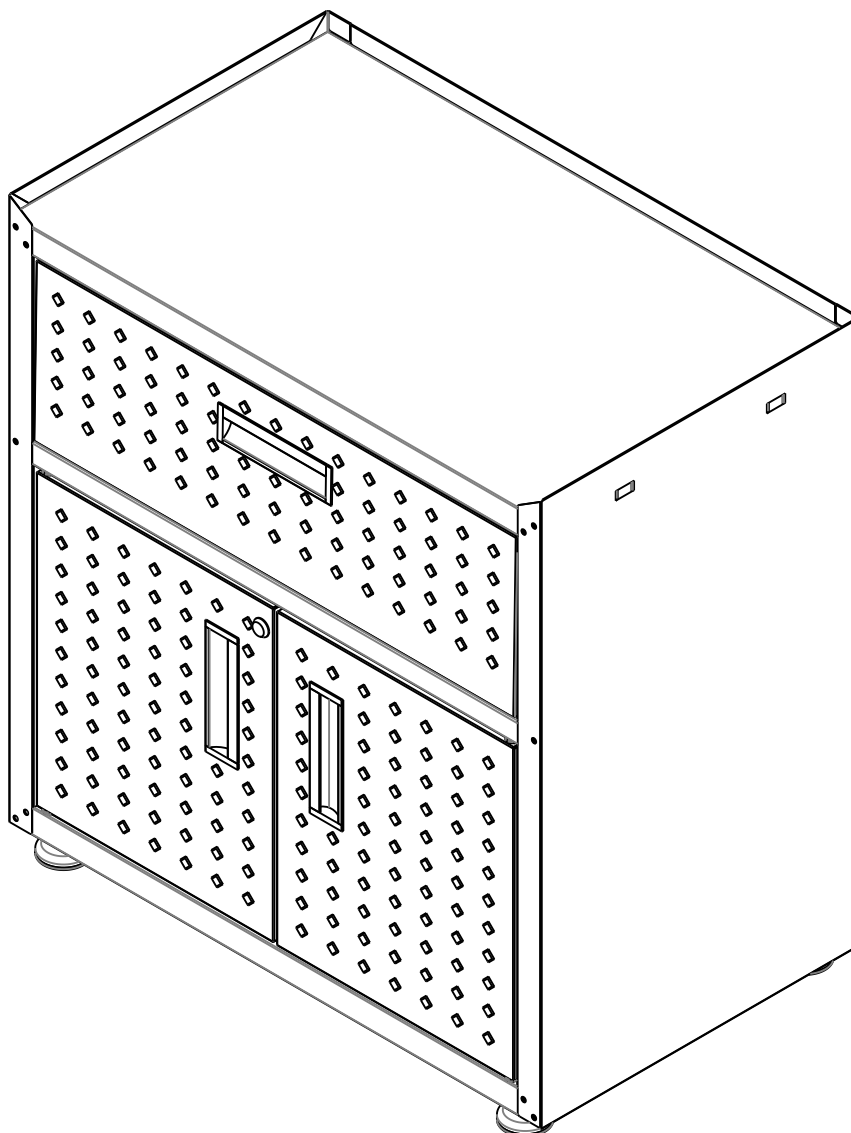

2GMCF



Stuck? Questions? We are here to help.
1-888-230-2225
help@manhattancomfort.com



View our assembly video online
www.manhattancomfort.com

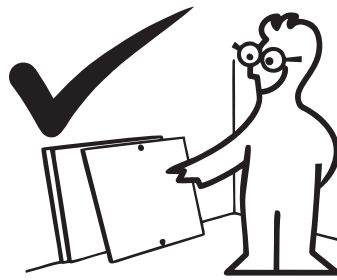
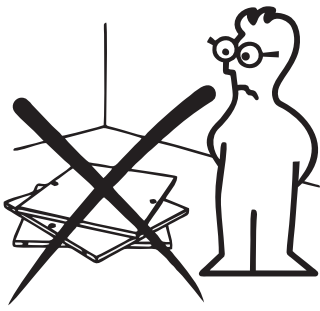

In order to ease the assembly,
you should separate and identify the parts first

Necessary hardware for the assembly

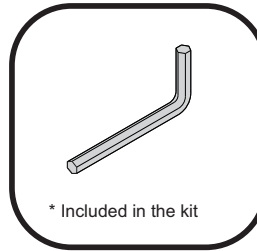
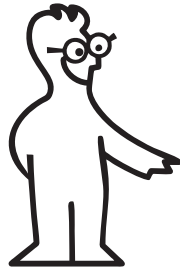

* Included in the kit

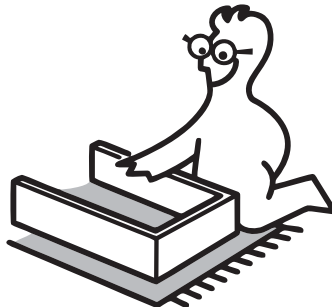
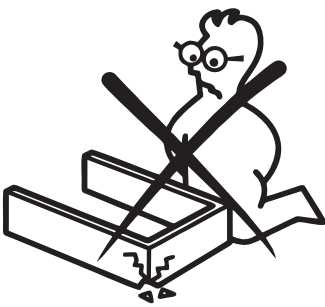

Do not place the parts directly onto the floor.
Use a cardboard sheet or a mat to place the
parts, during the separation and assembly.



Stuck? Questions? We are here to help.
1-888-230-2225
help@manhattancomfort.com



View our assembly video online
www.manhattancomfort.com

IMPORTANT

In order to avoid severe or even fatal injuries, follow the instructions carefully.

ASSEMBLY HANDBOOK – FORTRESS 31.5" MOBILE GARAGE CABINET WITH DRAWER AND SHELVES



WARNING

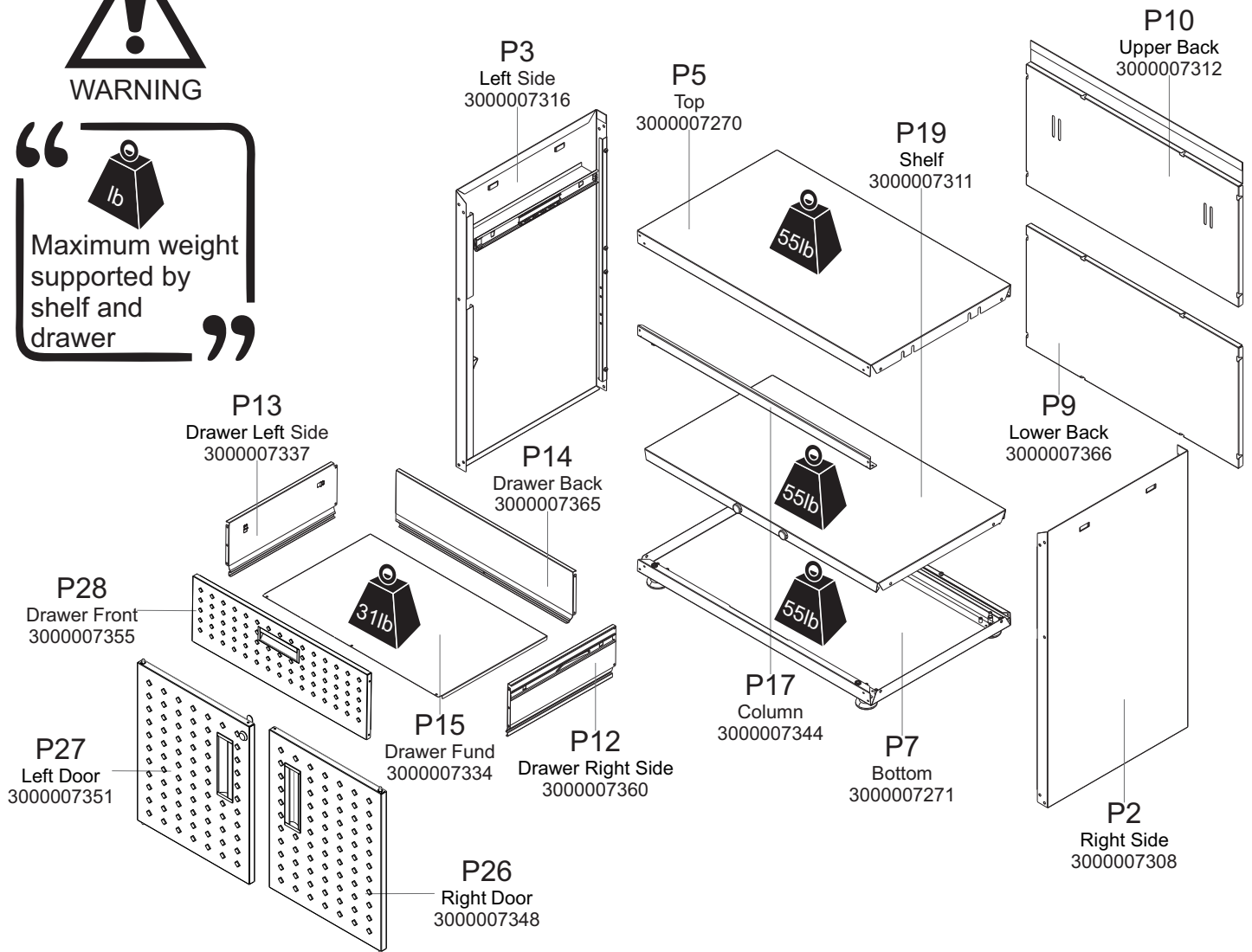

Hardware list

F1

1000009500

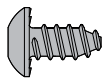

Qty. 30

F7

1000008301

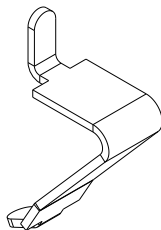

Qty. 4

F15

1000008280

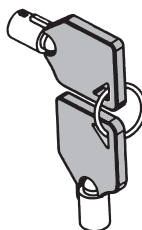

Qty. 1

F13

1000009033

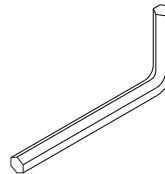

Qty. 1

F17

1000008285



F9

1000008368

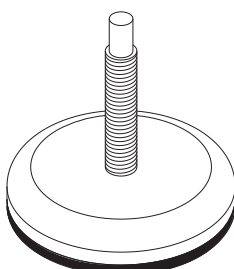

Qty. 4

F3

1000008391

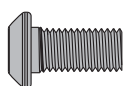

Qty. 16

F10

1000008352

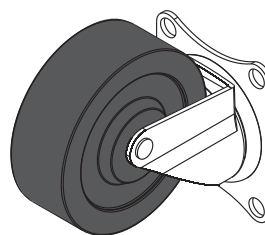

Qty. 2

F11

1000008354

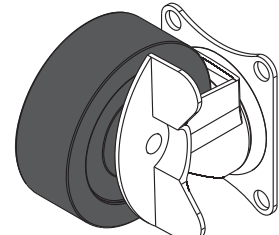

Qty. 2

* Only in cabinets without caster

* Only in cabinets with caster

STEP 1

- 1 - Fit part **P7** inside part **P3**
- 2 - Fit both parts in the frontal side, with **F1**

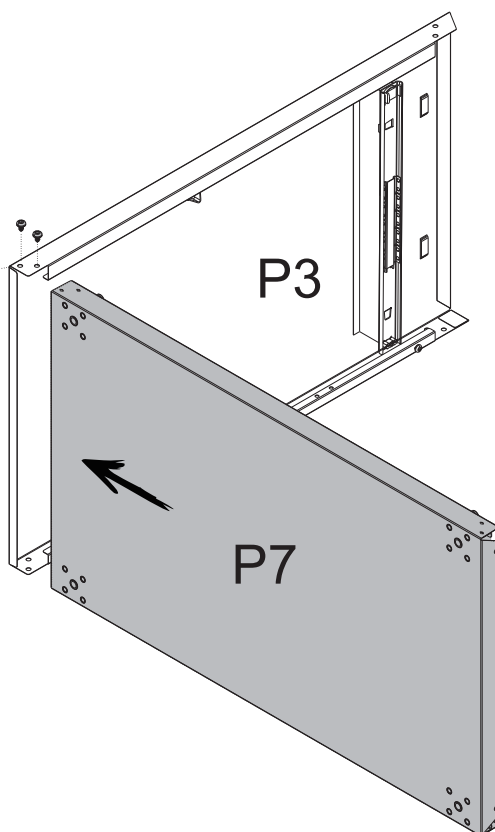
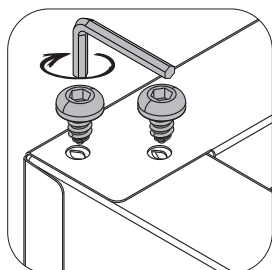
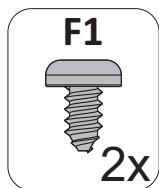

STEP 2

- 1 - Fit part **P2** inside part **P7**
- 2 - Fit both parts in the frontal side, with **F1**

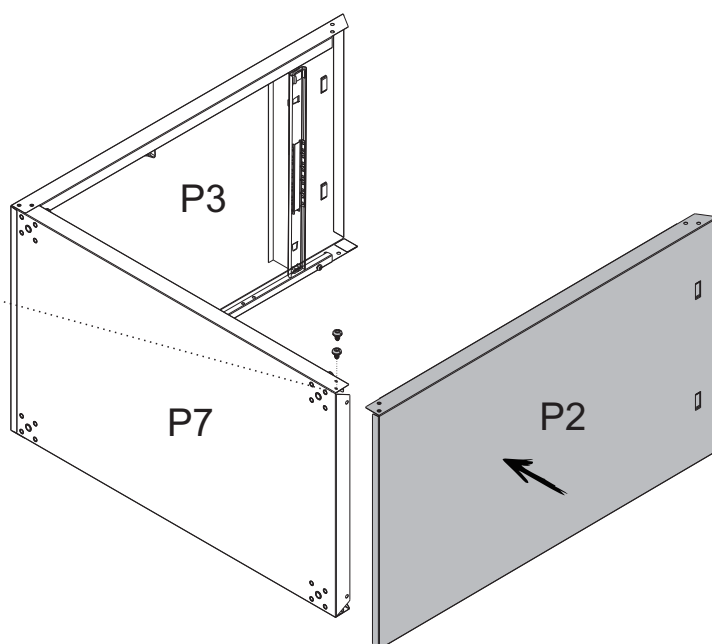
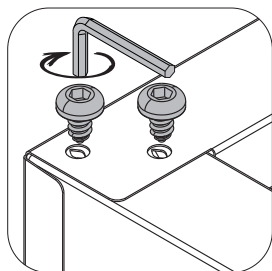
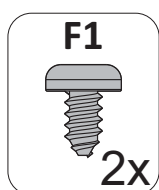

STEP 3

- 1 - Fit part **P5** between part **P2** and **P3**
- 2 - Check that all 4 tabs have been fitted
- 3 - Fit part **P5** to parts **P2** and **P3**, at the frontal side, with **F1**

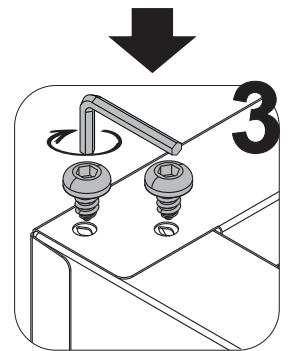
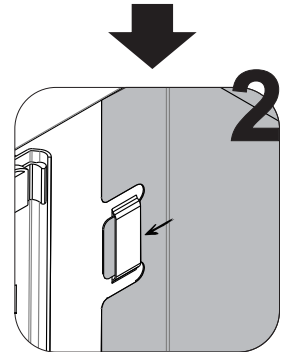
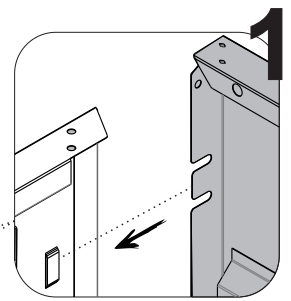
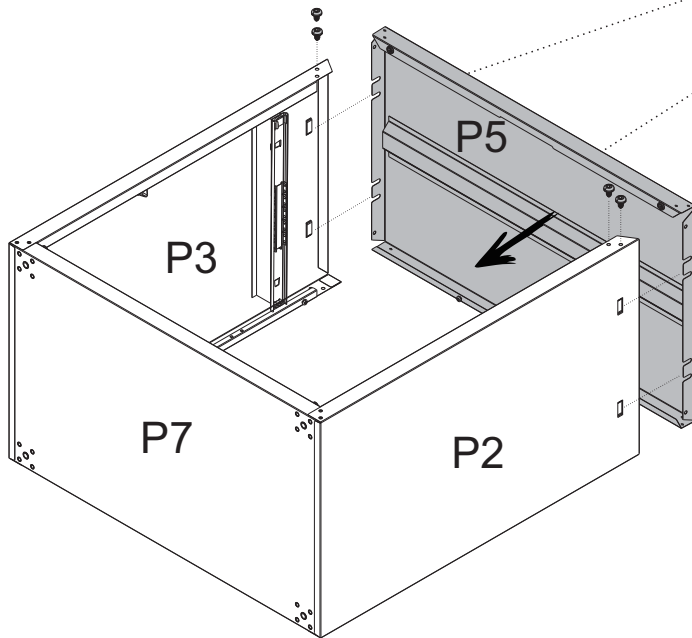
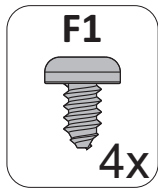

STEP 4

- 1 - Turn the cabinet with the back side upwards

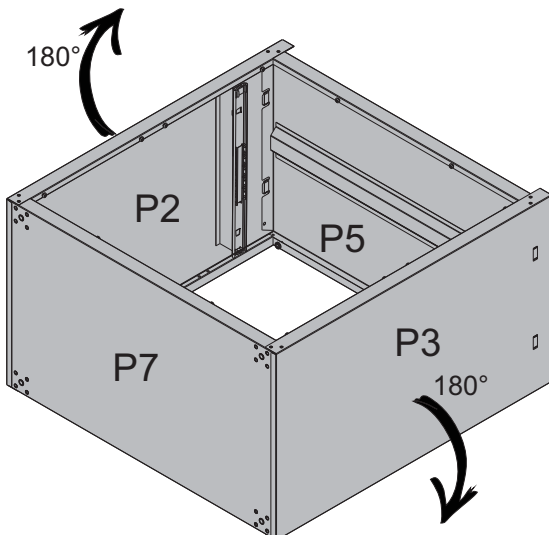
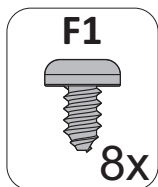

- 2 - Fit parts **P2** and **P3** to parts **P5** and **P7** with **F1**

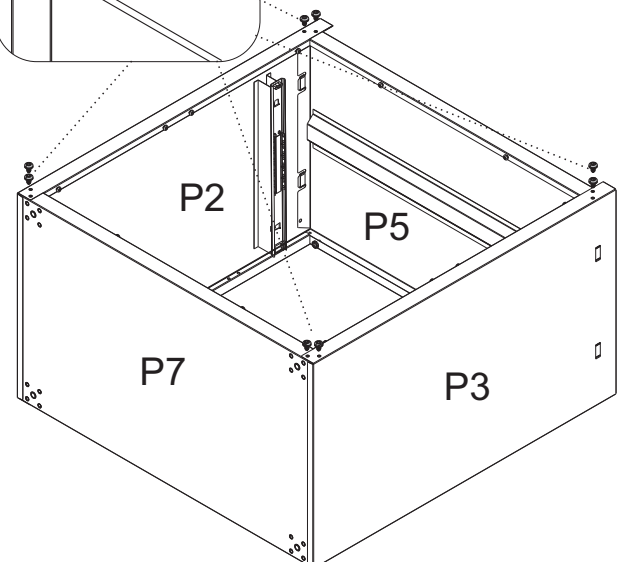
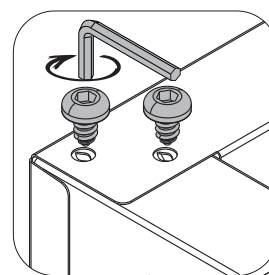

STEP 5

- 1 - Fit part **P10** into parts **P2**, **P3** and **P5**
Check that all fits are supported over the bolts
- 2 - After fitting the parts, screw the bolts until locked

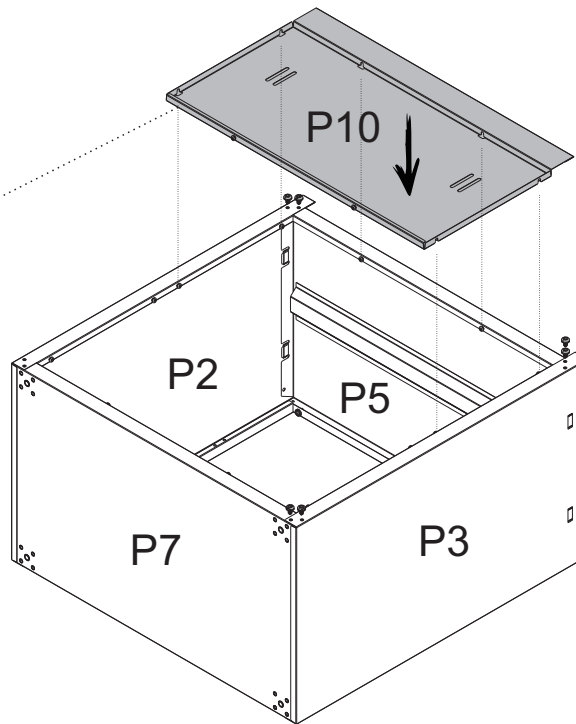
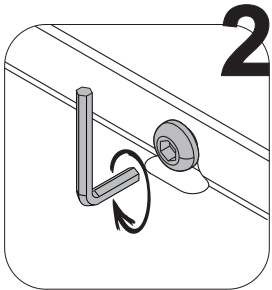
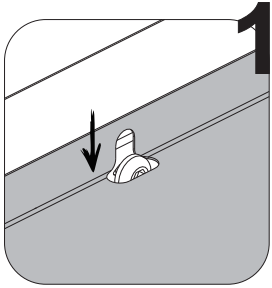

“Position part P10 on the P5 side for mounting the cabinet.”

- ## STEP 6
- 1 - Fit part **P9** into parts **P2**, **P3** and **P7**
Check that all fits are supported over the bolts
 - 2 - After fitting the parts, screw the bolts until locked

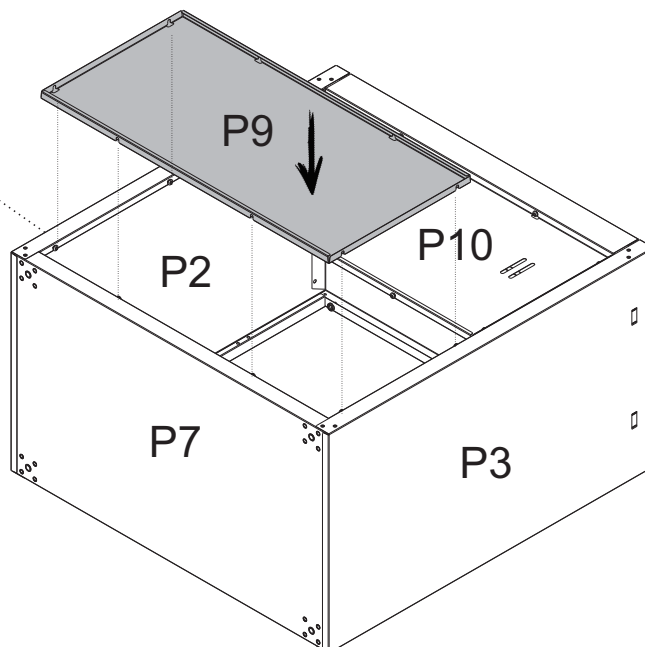
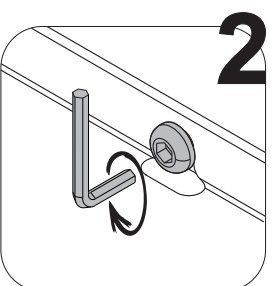
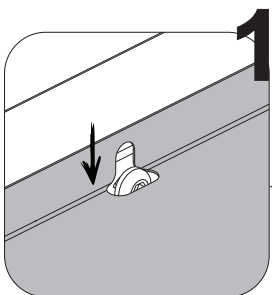

STEP 7

1 - To assembly the cabinet with shoe fit the accessory **F9** in part **P7** as illustrated here below and turn to screw. To level the height or the cabinet, turn the shoe either clockwise or counterclockwise to align it.

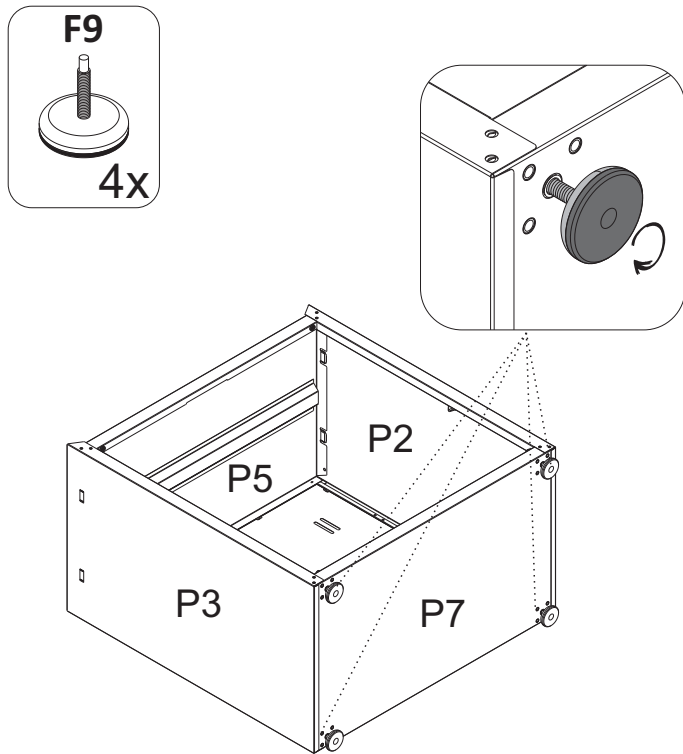

* Only in cabinets without caster

2 - To assembly the cabinet with caster, align the **F10** and **F11** to the holes in part **P7** and fix them with **F3**

3 - **WARNING:** Casters with lock (**F11**) must be fitted in the frontal side of the cabinet

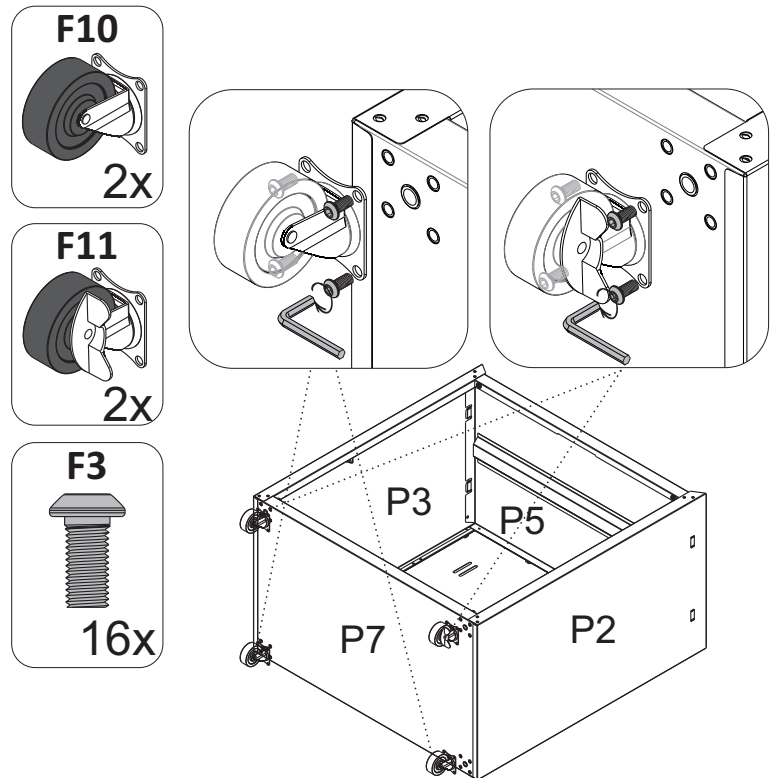

* Only in cabinets with caster

STEP 8

- 1- Turn the cupboard so that it will stand in the position of use
- 2- Fix **F7** to parts **P2** and **P3**, as shown here below

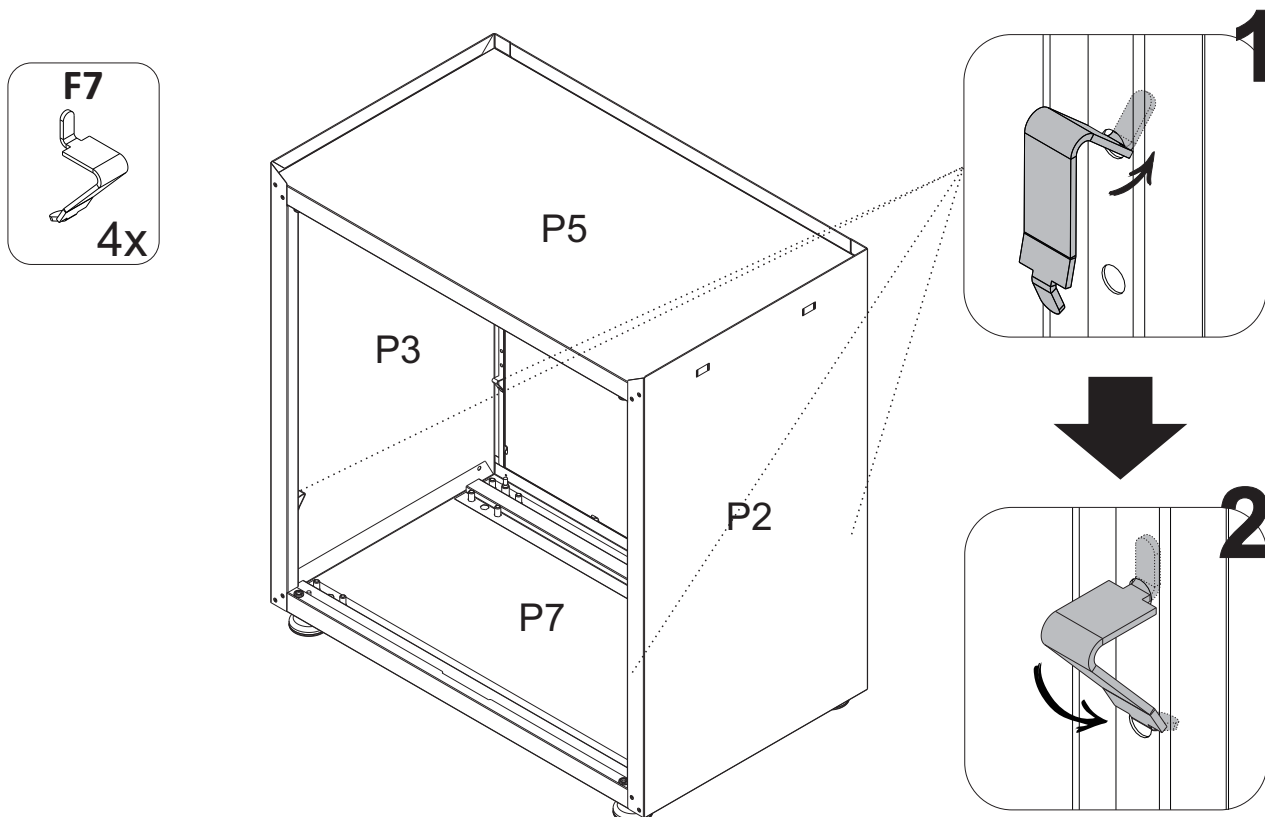

STEP 9

- 1 - Fit the lower part **P19** in diagonal position to insert it inside the cupboard
- 2 - Lean part **P19** in part **P2**, **P3** and place it over the **F7** detailed in the figure here below
- 3 - Lower the other side of part **P19**, leaning it over the left **F7**

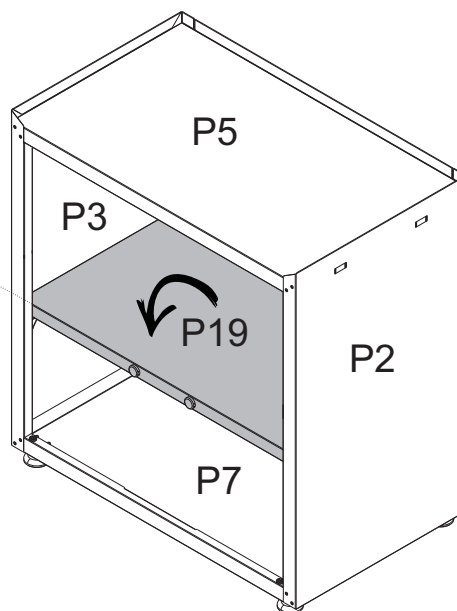
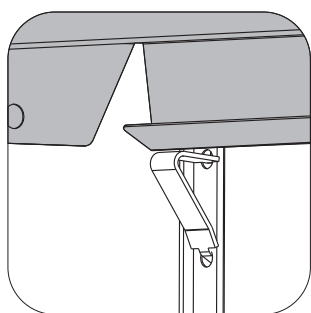
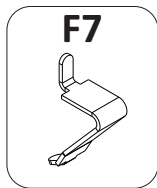

STEP 10

- 1 - Insert part **P17** inside the cabinet, in diagonal position.
Fit part **P17** in cut-offs of parts **P2** and **P3**, as detailed here below
- 3 - Fix part **P17** in parts **P2** and **P3**, with **F1**

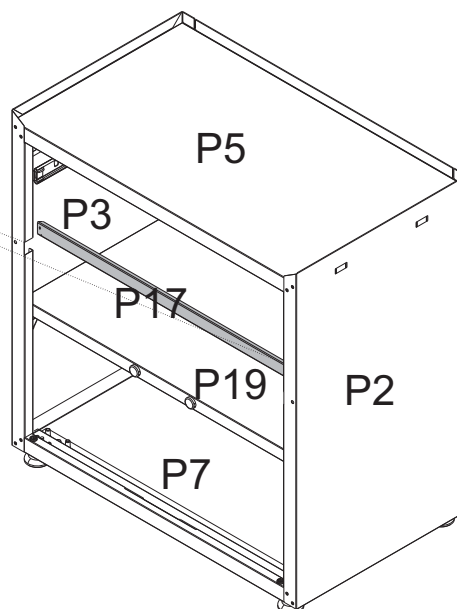
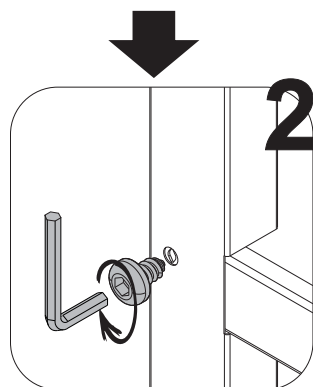
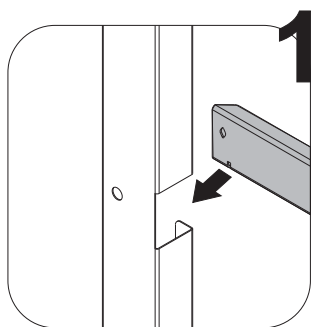
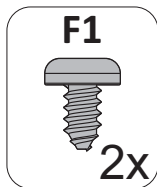

- STEP 11**
- 1 - To assembly the doors, fit door **P26** lower hinge bolt inside the bushing fixed in part **P7**
 - 2 - Then, pull down the pin of door **P26** upper hinge; align the door and release the pin to fit the bushing fixed in part **P17**
 - 3 - Repeat the step for part **P27**

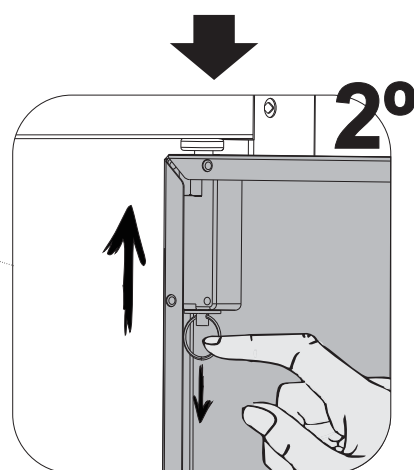
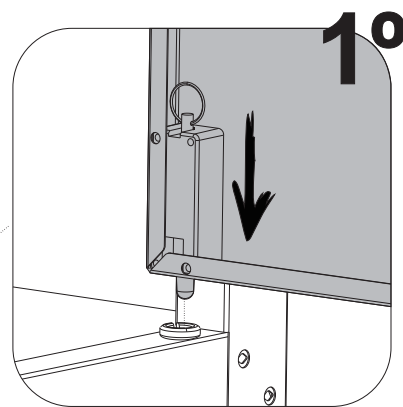
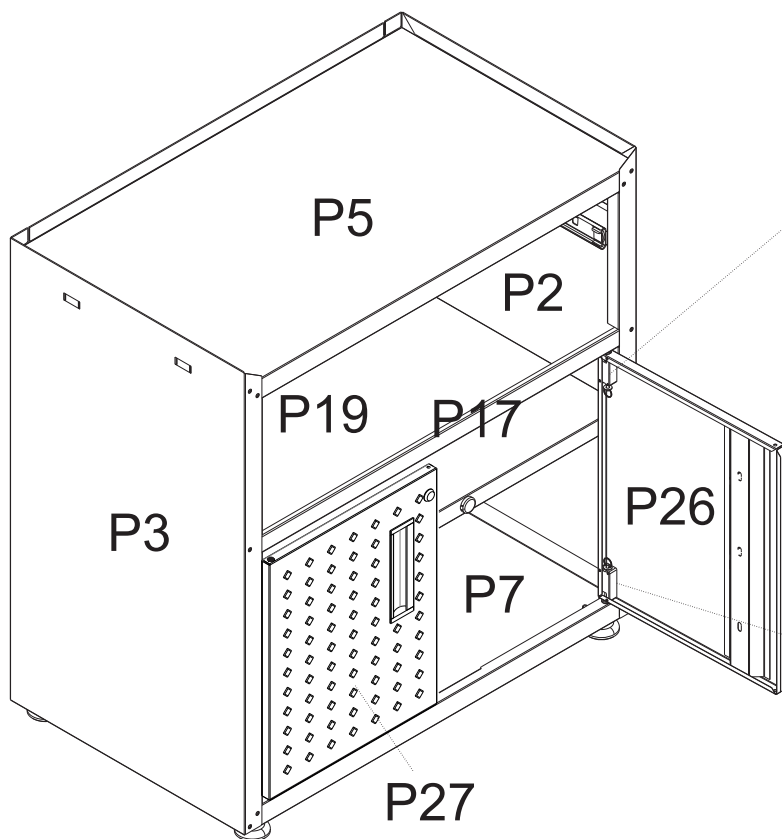

STEP 12

- 1 - Fit part **P15** to part **P28**
- 2 - Fit them with **F1**

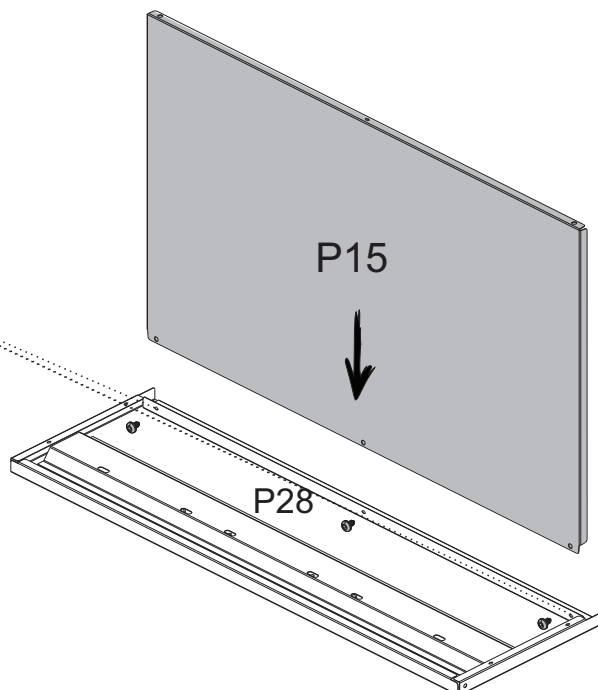
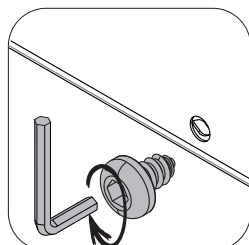
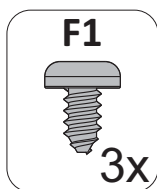

- STEP 13**
- 1 - Align parts **P12** and **P13** to part **P15**, until it leans against part **P28**
 - 2 - Fit them with **F1**

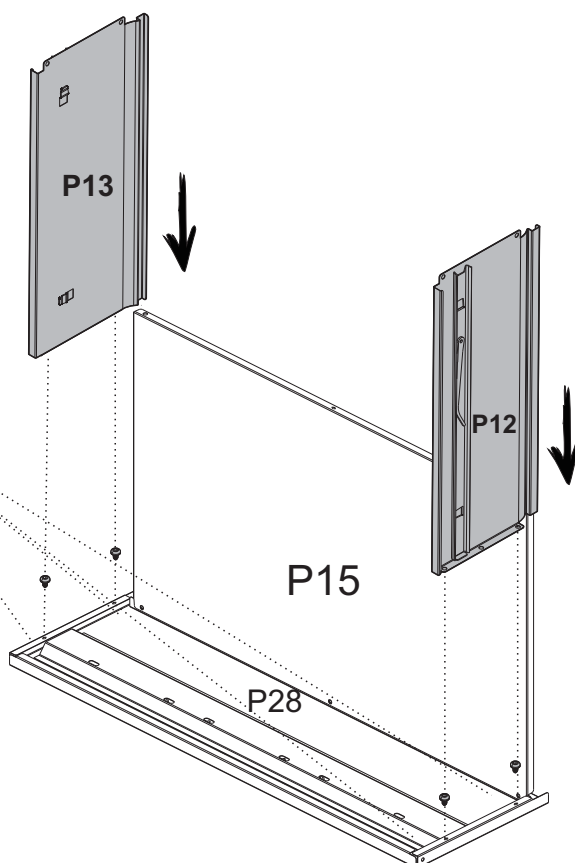
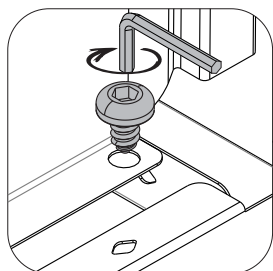
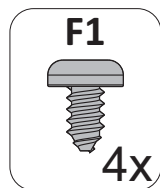

STEP 14

- 1 - Insert part **P14** over part **P15** and between parts **P12** and **P13**
- 2 - Then, fix part **P14** to parts **P12**, **P13** and **P15**, with **F1**

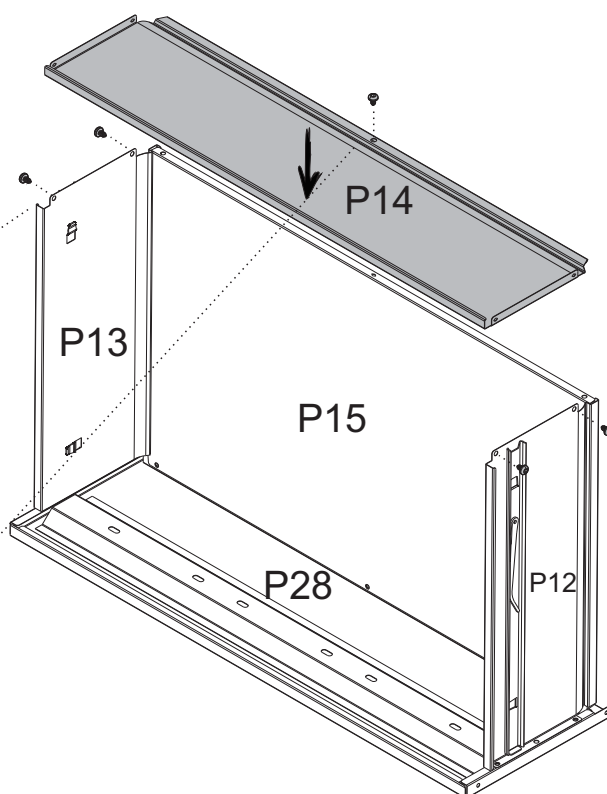
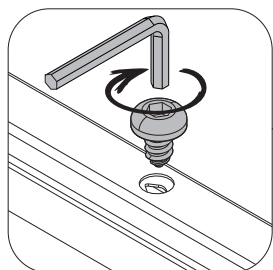
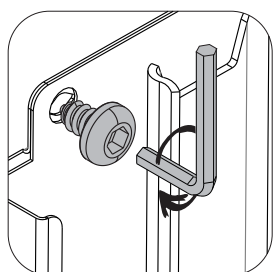
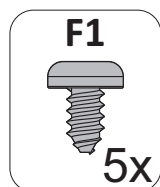

STEP 14

- 1 - Fit the drawers – already assembled – between parts **P2** and **P3**, through the slidings
- 2 - Check that slidings of both sides are properly fitted. Move the drawer, opening and closing it, testing

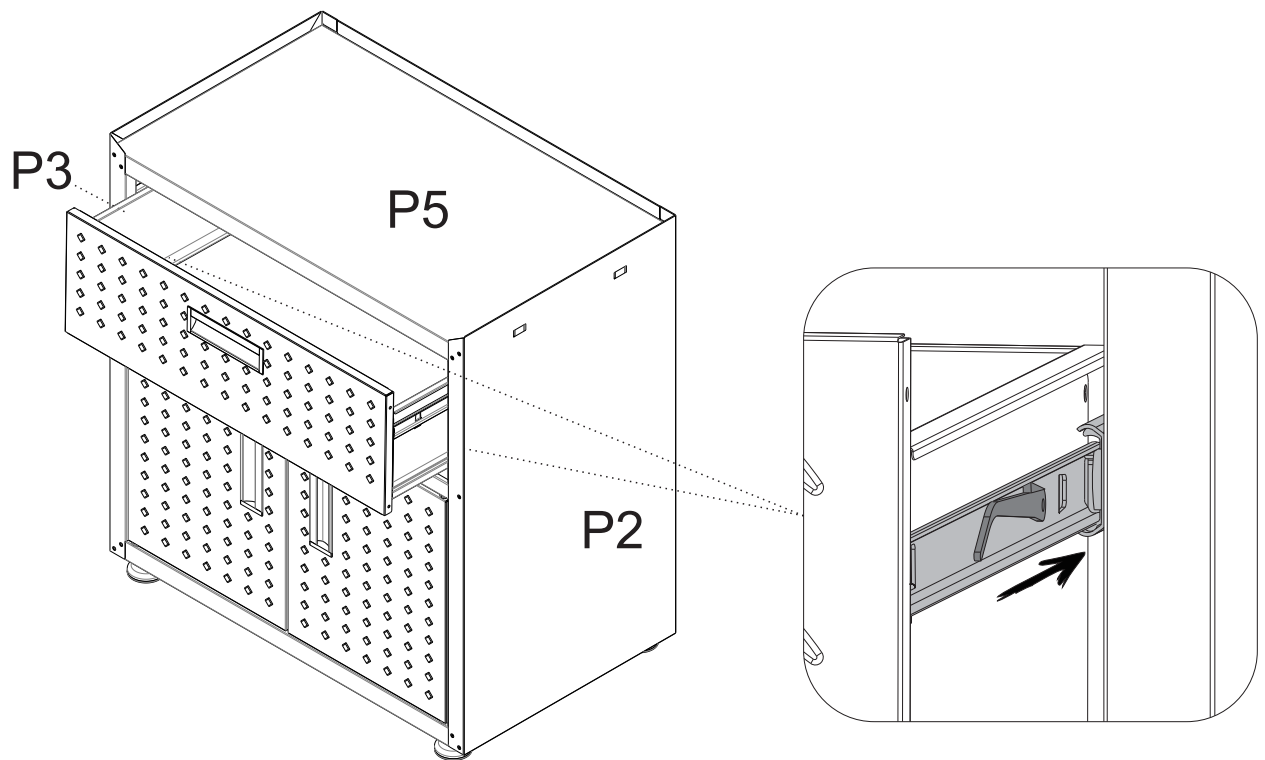

STEP 15

- 1 -Insert product log

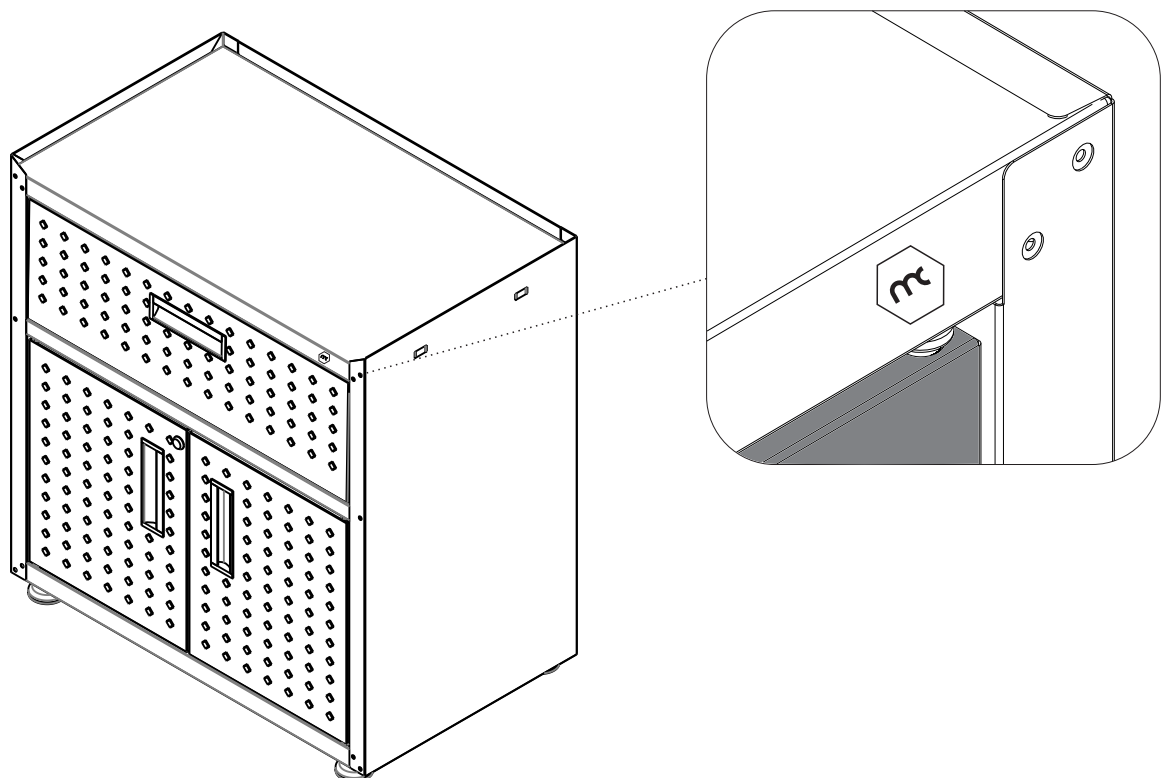



MANHATTAN
COMFORT

ASSEMBLY HANDBOOK - FORTRESS 31.5" MOBILE GARAGE CABINET WITH SHELVESS

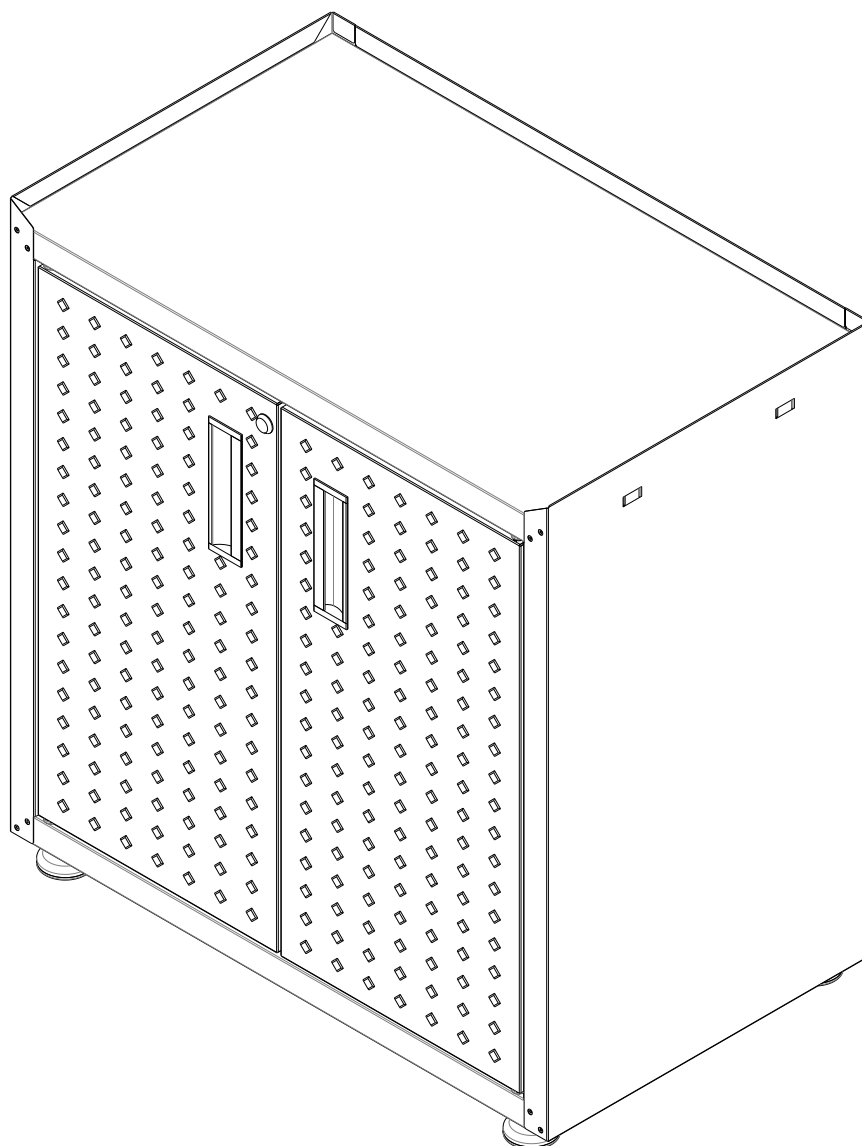

3GMCF



Stuck? Questions? We are here to help.
1-888-230-2225
help@manhattancomfort.com



View our assembly video online
www.manhattancomfort.com

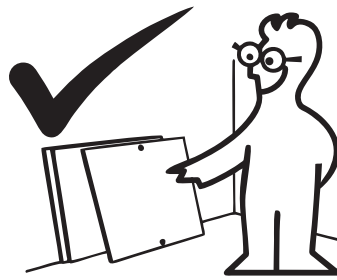
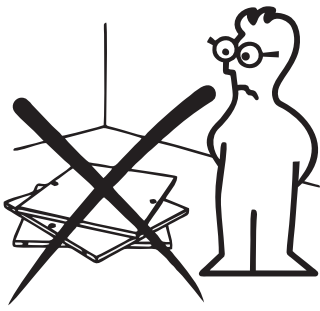

In order to ease the assembly,
you should separate and identify the parts first

Necessary hardware for the assembly

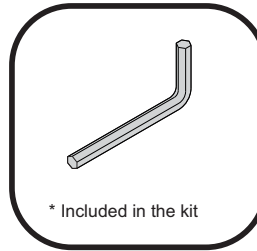
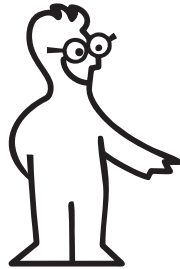

* Included in the kit

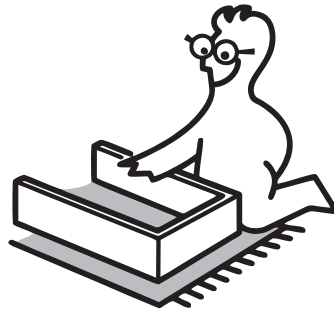
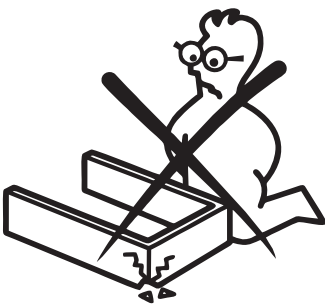

Do not place the parts directly onto the floor.
Use a cardboard sheet or a mat to place the
parts, during the separation and assembly.



Stuck? Questions? We are here to help.
1-888-230-2225
help@manhattancomfort.com



View our assembly video online
www.manhattancomfort.com

IMPORTANT

In order to avoid severe or even fatal injuries, follow the instructions carefully.

ASSEMBLY HANDBOOK - FORTRESS 31.5" MOBILE GARAGE
CABINET WITH SHELVES

P10
Upper Back
3000007312



WARNING

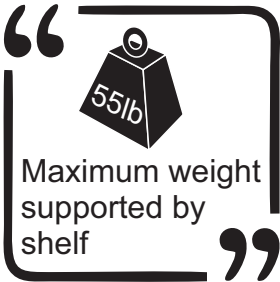

P3
Left Side
3000007316

P5
Top
3000007270

P19
Shelf
3000007311

P9
Lower Back
3000007366

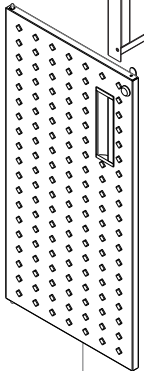

P22
Left Door
3000007302

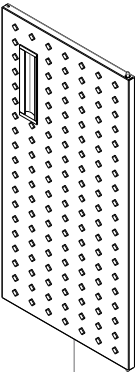

P23
Right Door
3000007304

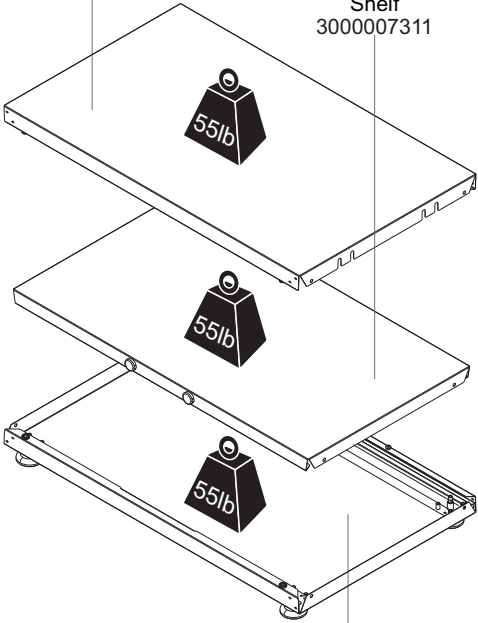

P7
Bottom
3000007271

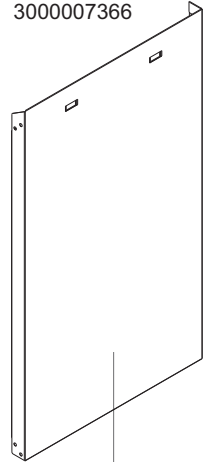

P2
Right Side
3000007308

Hardware list

F1

1000009500



Qty. 16

F7

1000008301

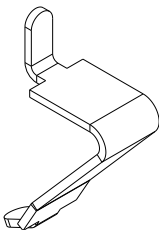

Qty. 4

F15

1000008280

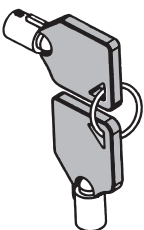

Qty. 1

F13

1000009033

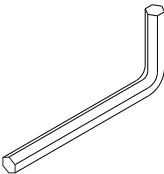

Qty. 1

F17

1000008285



F9

1000008368

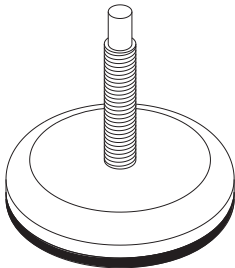

Qty. 4

F3

1000008391

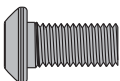

Qty. 16

F10

1000008352

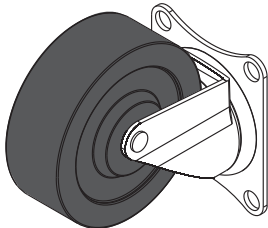

Qty. 2

F11

1000008354

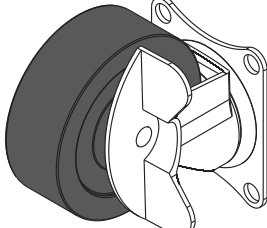

Qty. 2

* Only in cabinets without caster

* Only in cabinets with caster

STEP 1

- 1 - Fit part **P7** inside part **P3**
- 2 - Fit both parts in the frontal side, with **F1**

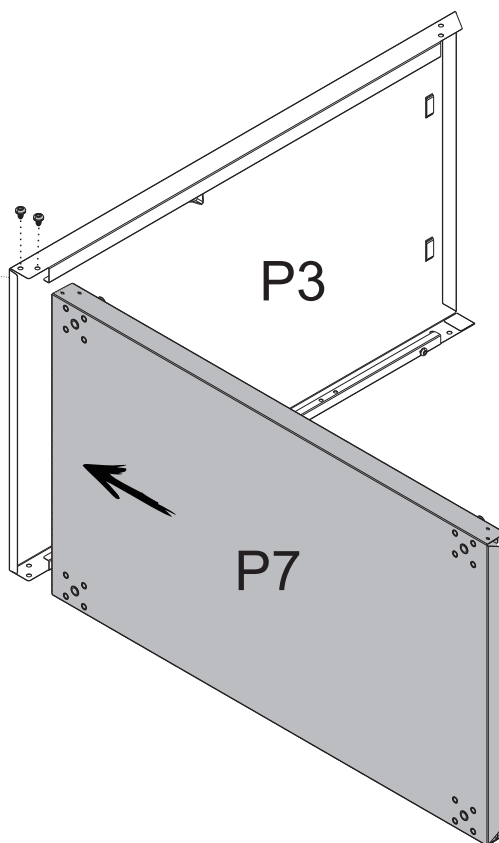
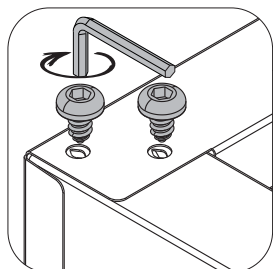
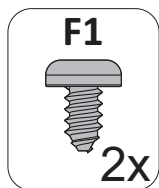

STEP 2

- 1 - Fit part **P2** inside part **P7**
- 2 - Fit both parts in the frontal side, with **F1**

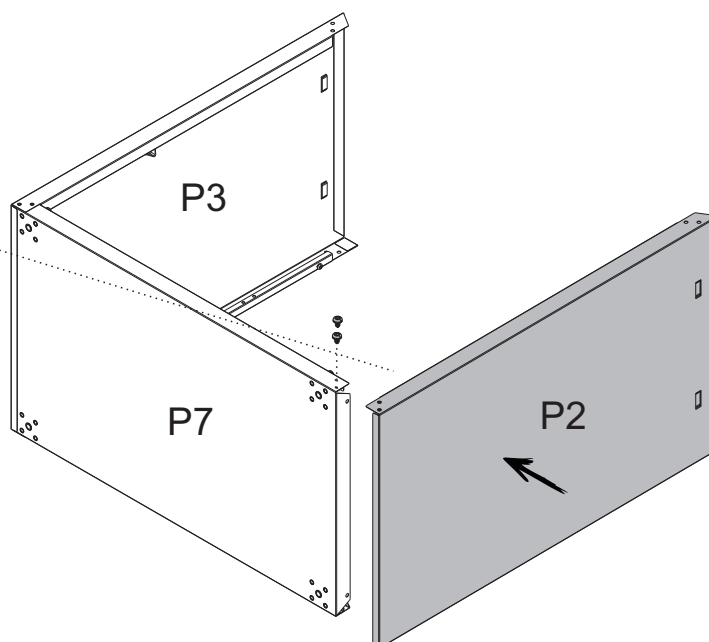
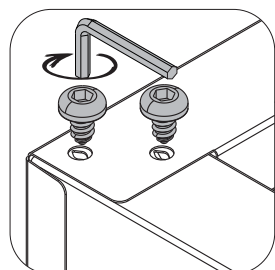
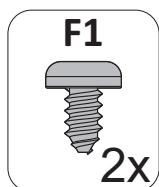

STEP 3

- 1 - Fit part **P5** between part **P2** and **P3**
- 2 - Check that all 4 tabs have been fitted
- 3 - Fit part **P5** to parts **P2** and **P3**, at the frontal side, with **F1**

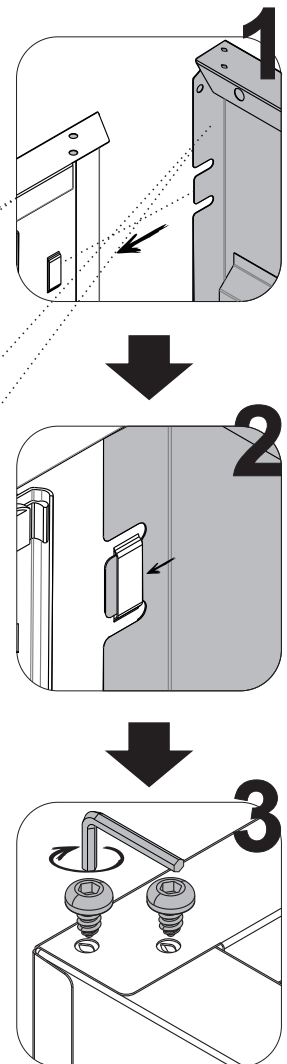
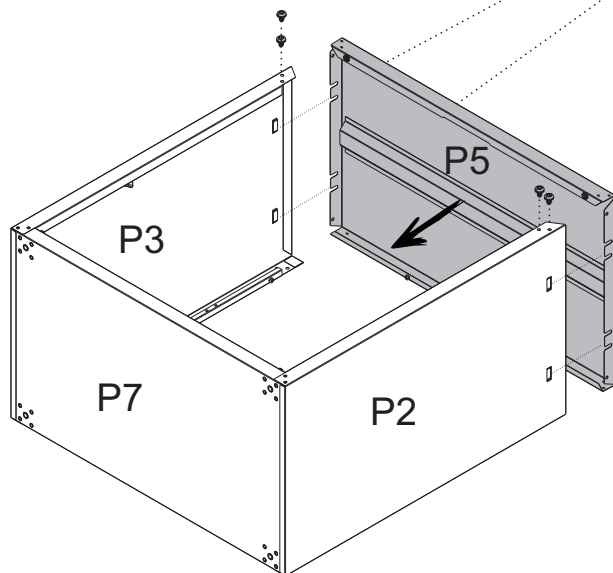
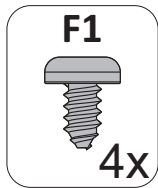

STEP 4

- 1 - Turn the cabinet with the back side upwards

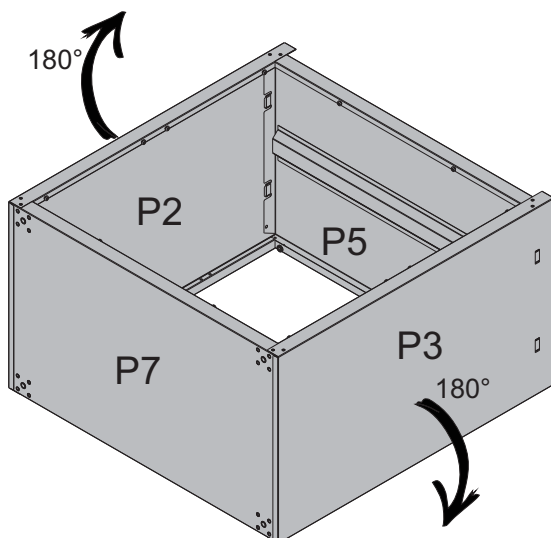
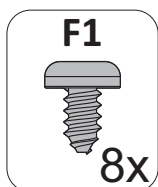

- 2 - Fit parts **P2** and **P3** to parts **P5** and **P7** with **F1**

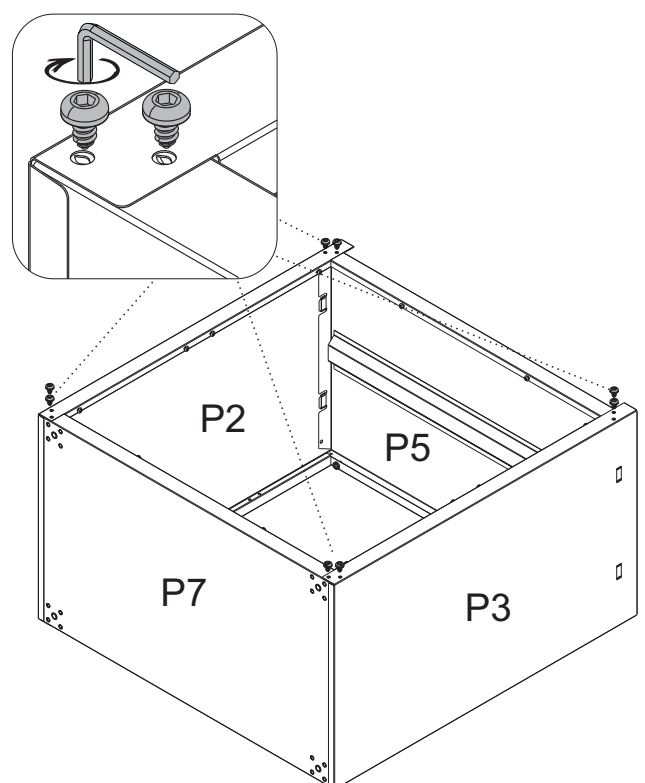

STEP 5

- 1 - Fit part **P10** into parts **P2**, **P3** and **P5**
Check that all fits are supported over the bolts
- 2 - After fitting the parts, screw the bolts until locked



“Position part P10 on the P5 side for mounting the”

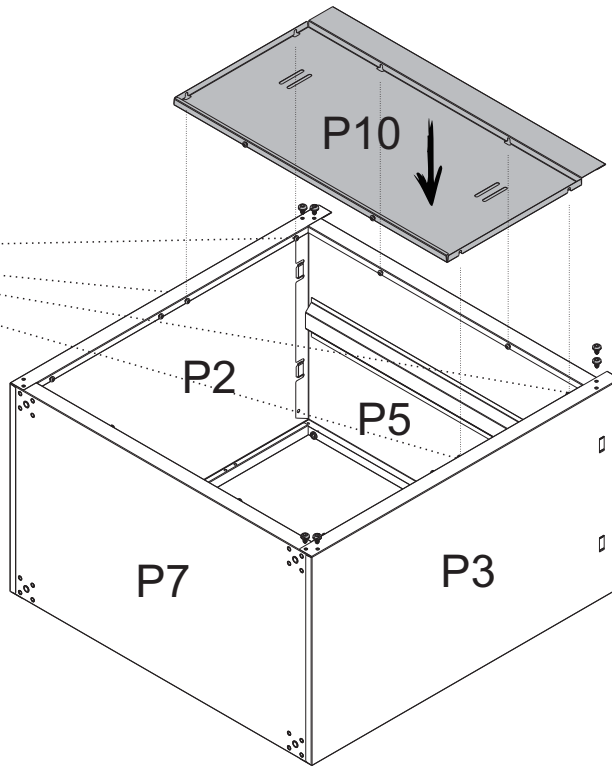
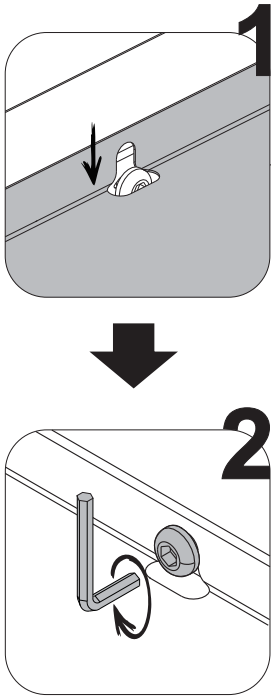

- ## STEP 6
- 1 - Fit part **P9** into parts **P2**, **P3** and **P7**
Check that all fits are supported over the bolts

- 2 - After fitting the parts, screw the bolts until locked

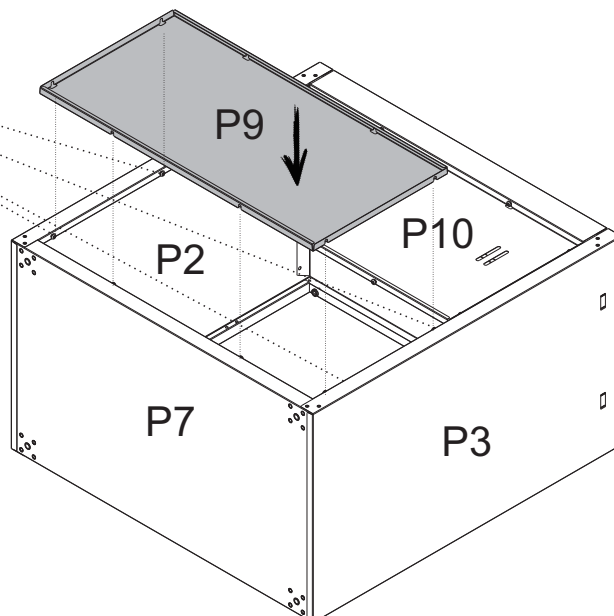
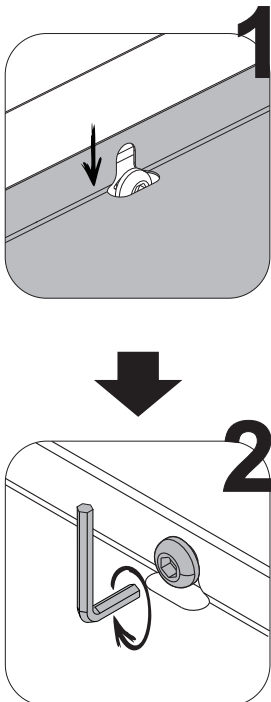

STEP 7

1 - To assembly the cabinet with shoe fit the accessory **F9** in part **P7** as illustrated here below and turn to screw. To level the height or the cabinet, turn the shoe either clockwise or counterclockwise to align it.

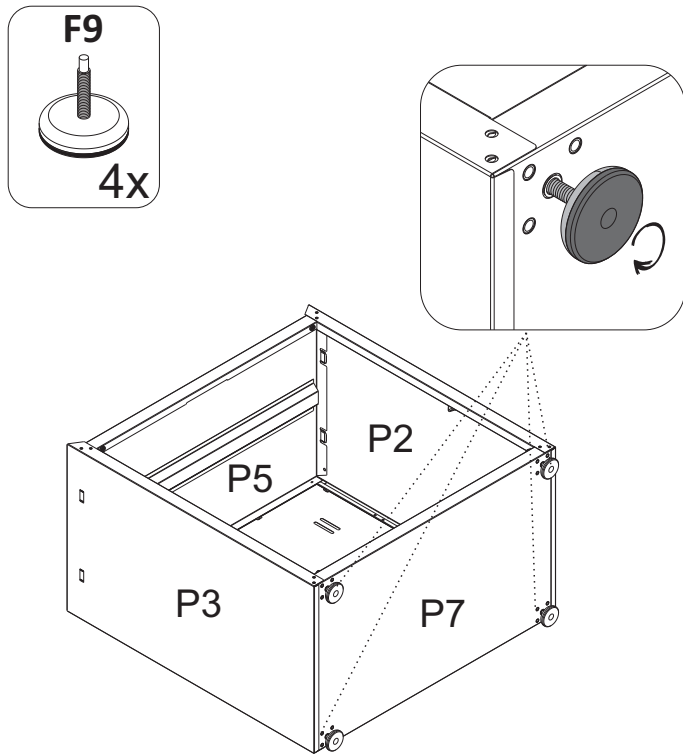

* Only in cabinets without caster

2 - To assembly the cabinet with caster, align the **F10** and **F11** to the holes in part **P7** and fix them with **F3**

3 - **WARNING:** Casters with lock (**F11**) must be fitted in the frontal side of the cabinet

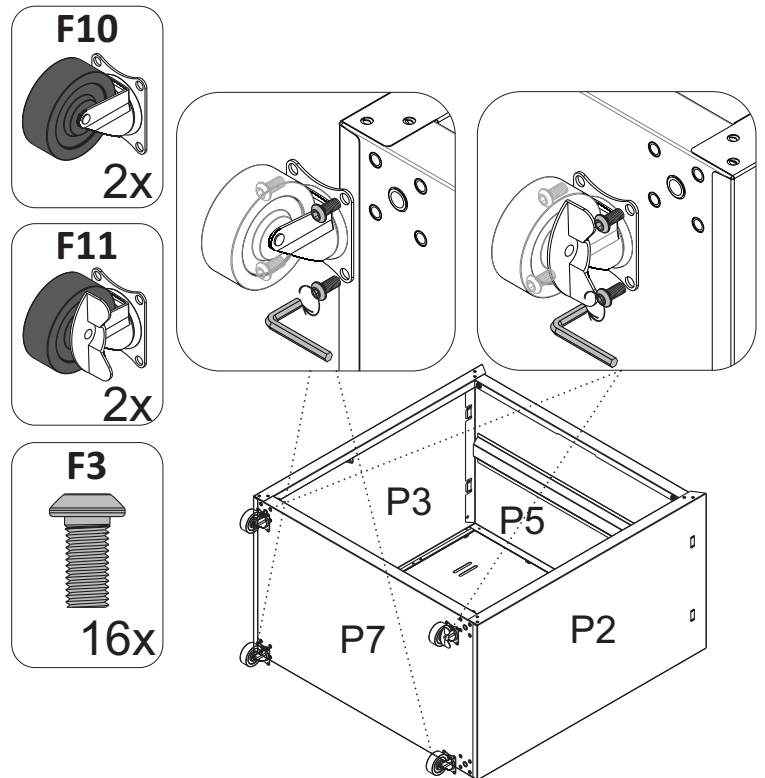

* Only in cabinets with caster

STEP 8

- 1- Turn the cupboard so that it will stand in the position of use
- 2- Fix **F7** to parts **P2** and **P3**, as shown here below

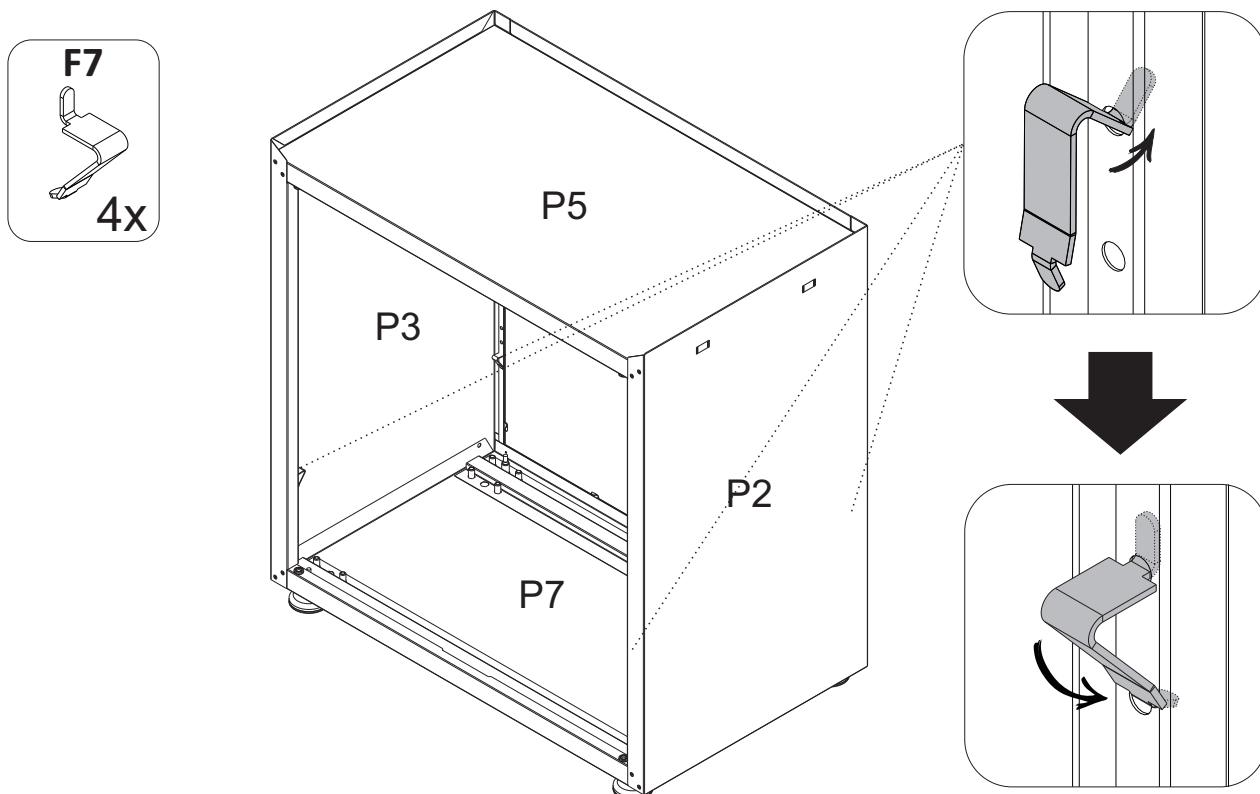

STEP 9

- 1 - Fit the lower part **P19** in diagonal position to insert it inside the cupboard
- 2 - Lean part **P19** in part **P2**, **P3** and place it over the **F7** detailed in the figure here below
- 3 - Lower the other side of part **P19**, leaning it over the left **F7**

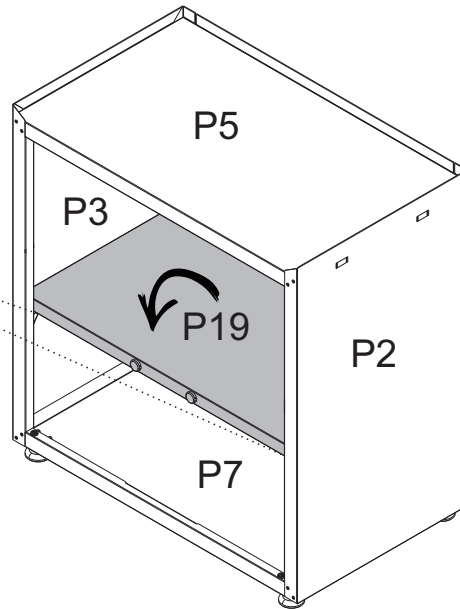
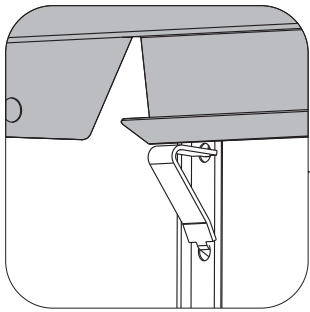
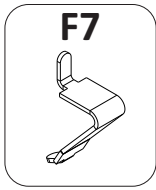

STEP 10

- 1 - To assembly the doors, fit door **P23** lower hinge bolt inside the bushing fixed in part **P7**. Then, pull down the pin of door **P23** upper hinge; align the door and release the pin to fit the bushing fixed in part **P5**
- 2 - Repeat the step for part **P22**
- 3 - Insert product log

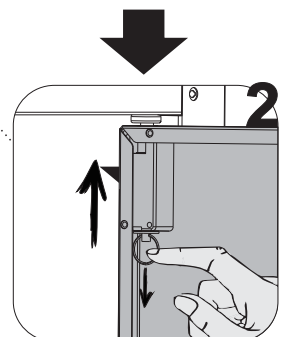
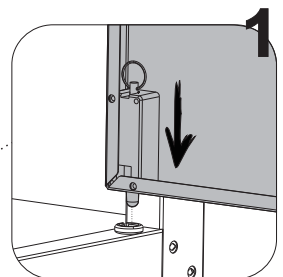
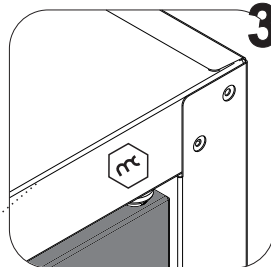
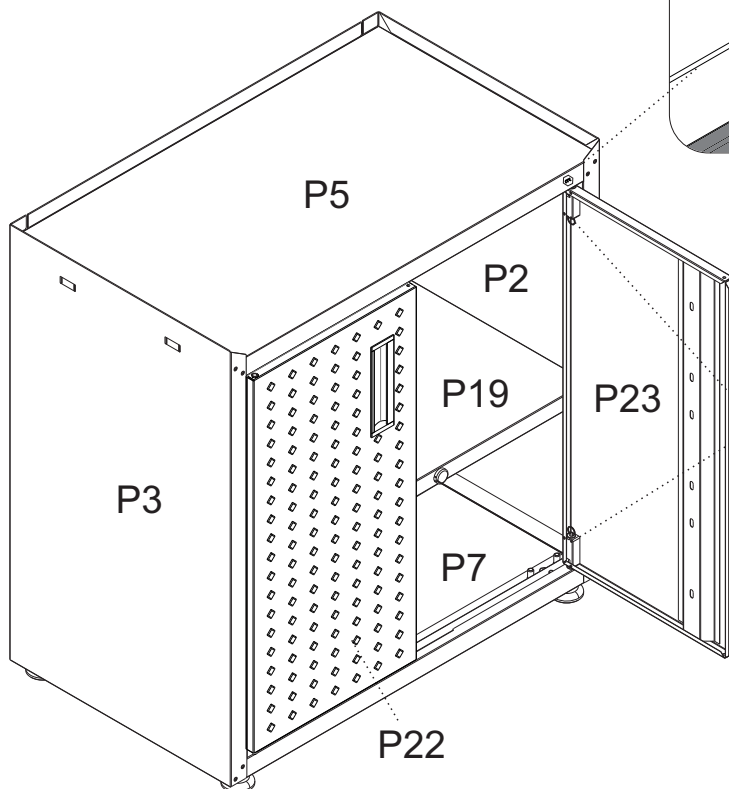
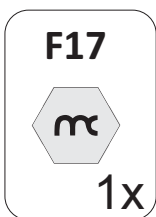



MANHATTAN
COMFORT

ASSEMBLY HANDBOOK - FORTRESS FLOATING GARAGE CABINET

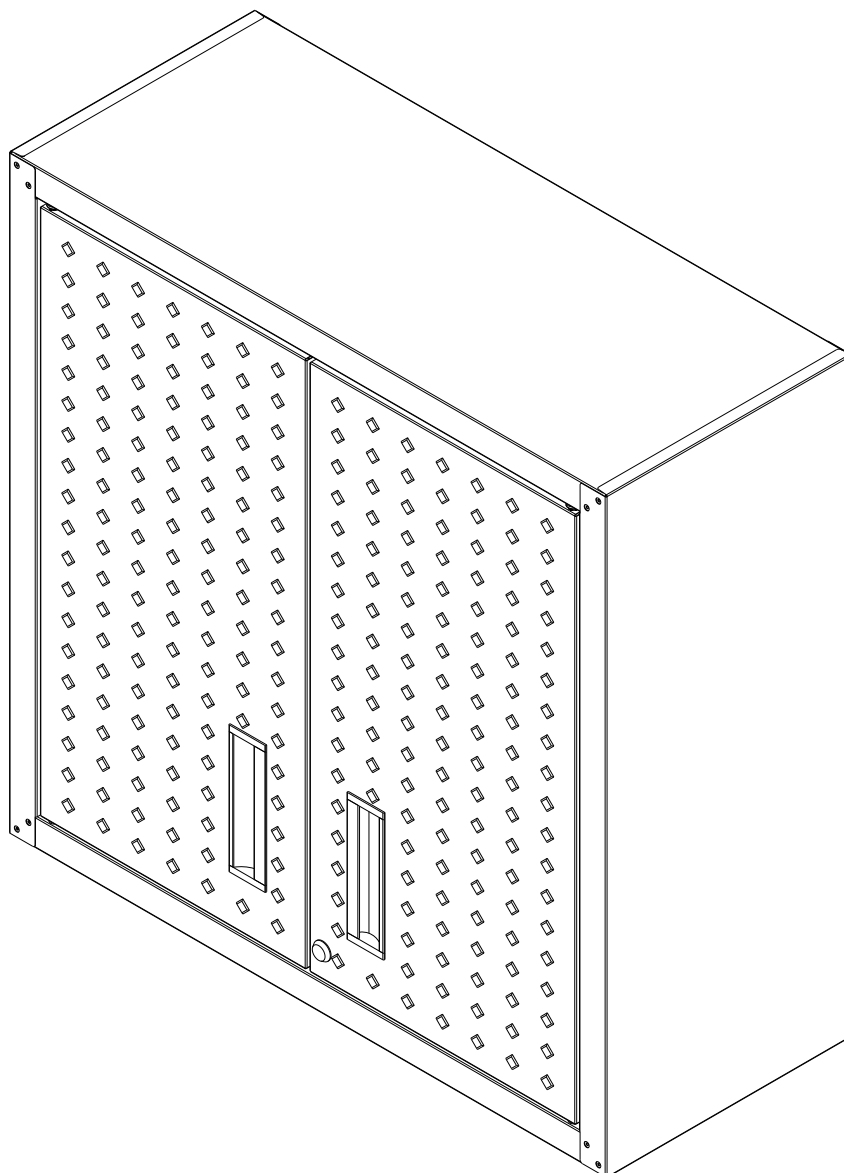

5GMC



Stuck? Questions? We are here to help.
1-888-230-2225
help@manhattancomfort.com



View our assembly video online
www.manhattancomfort.com

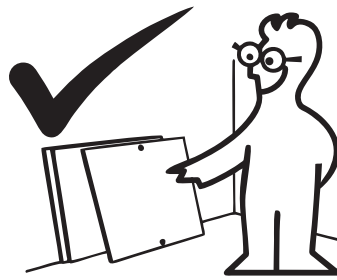
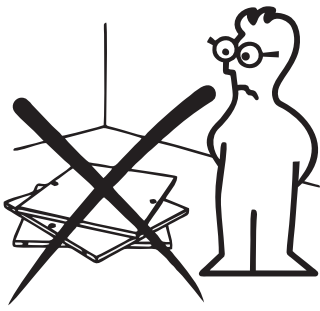

In order to ease the assembly,
you should separate and identify the parts first

Necessary hardware for the assembly, leveling and safety

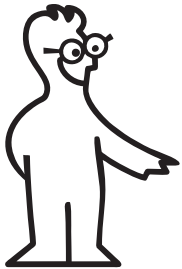

* Included in the kit

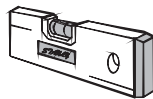

* Not included in the kit

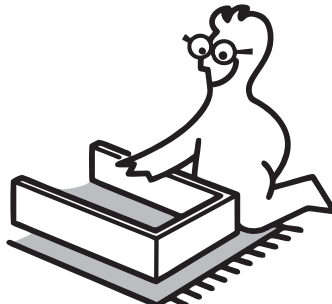
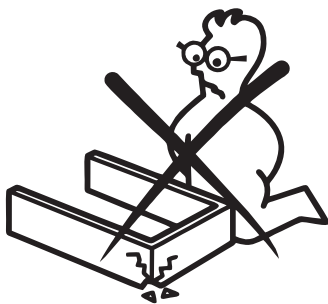

Do not place the parts directly onto the floor.
Use a cardboard sheet or a mat to place the
parts, during the separation and assembly.



Stuck? Questions? We are here to help.
1-888-230-2225
help@manhattancomfort.com



View our assembly video online
www.manhattancomfort.com

IMPORTANT

In order to avoid severe or even fatal injuries, follow the instructions carefully.

This furniture should be fixed onto the wall, so to avoid possible drops.

Different types of walls demand different types of hardware.

Hardware to fix the furniture to the drywall is included in the kit.

Should your wall be different, please, ask for advice at the hardware store.

ASSEMBLY HANDBOOK WALL CUPBOARD - FORTRESS FLOATING GARAGE CABINET



WARNING

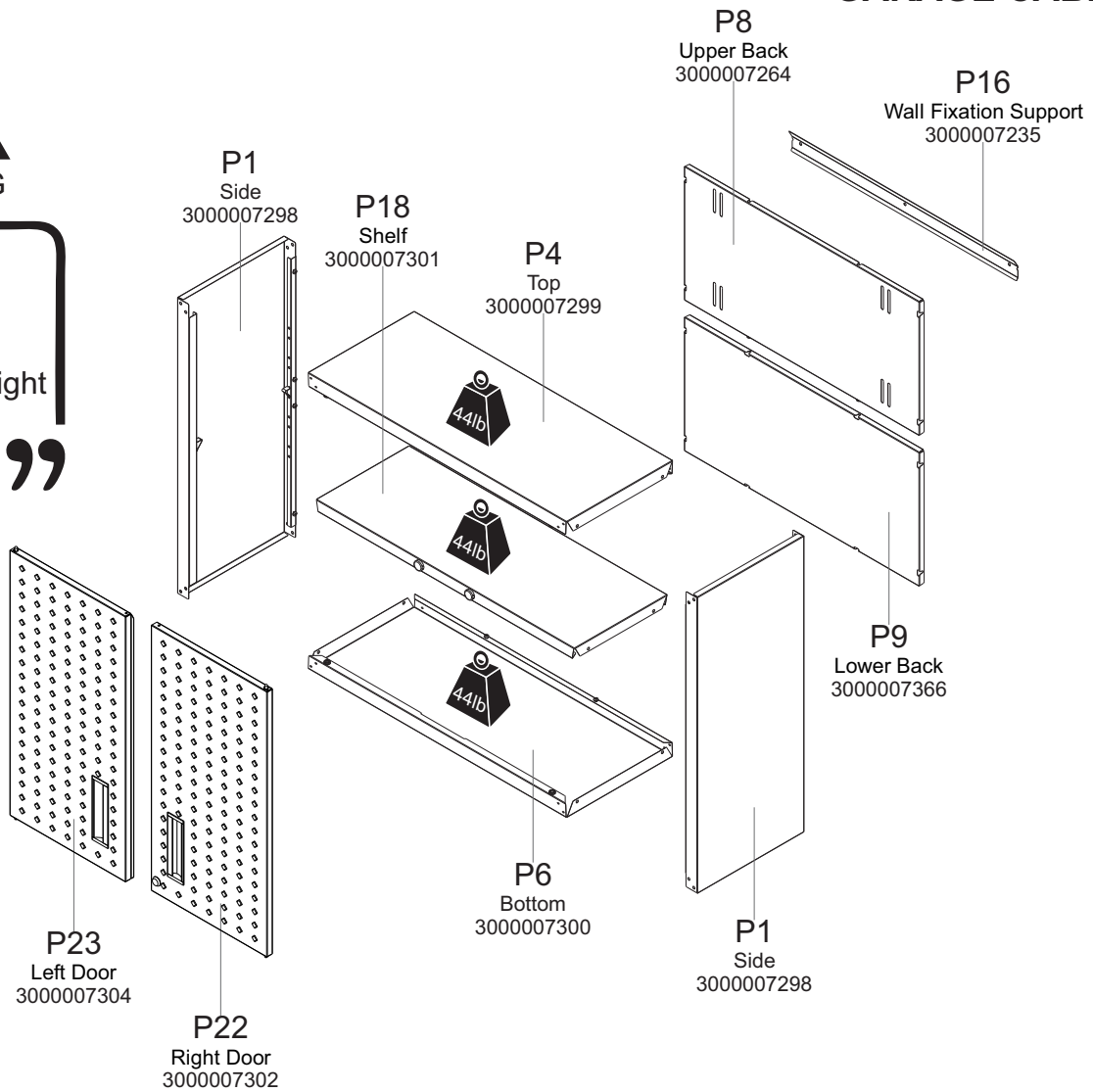

Hardware list

F1
1000009500

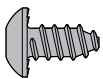

Qty. 16

F5
1000008616

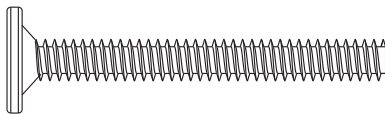

Qty. 3

F7
1000008301

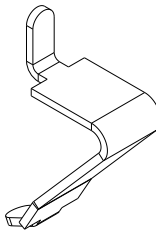

Qty. 4

F15
1000008280

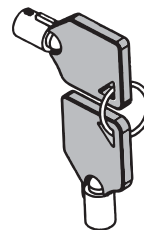

Qty. 1

F13
1000009033

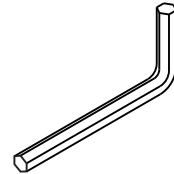

Qty. 1

F17
1000008285



Qty. 1

F14
1000008297

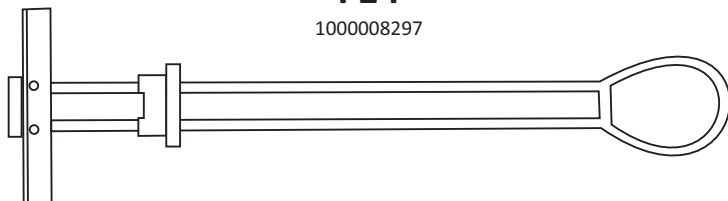

Qty. 3

STEP 1

1 - Fit part **P4** inside part **P1**

2 - Fit both parts in the frontal side, with **F1**

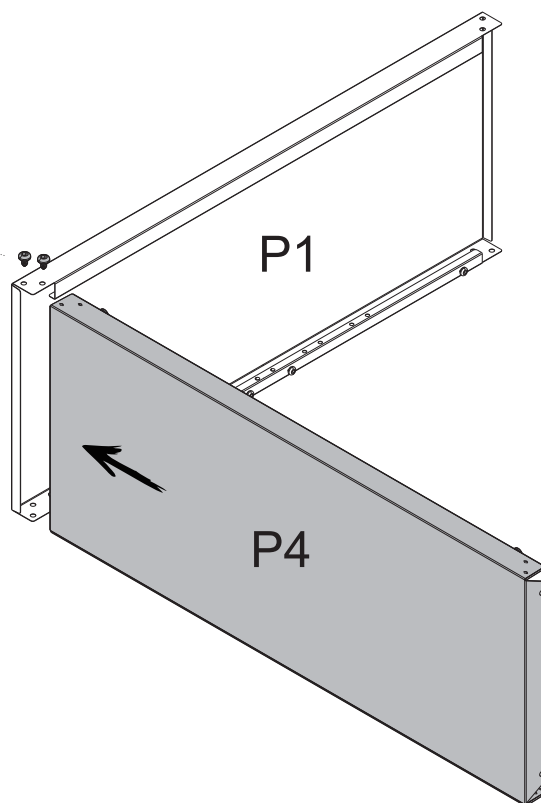
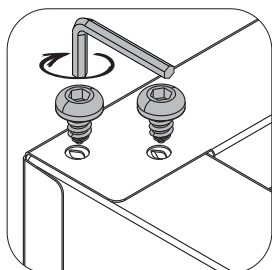
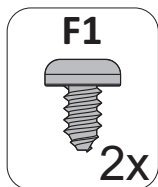

STEP 2

1 - Fit part **P6** inside part **P1**

2 - Fit both parts in the frontal side, with part **F1**

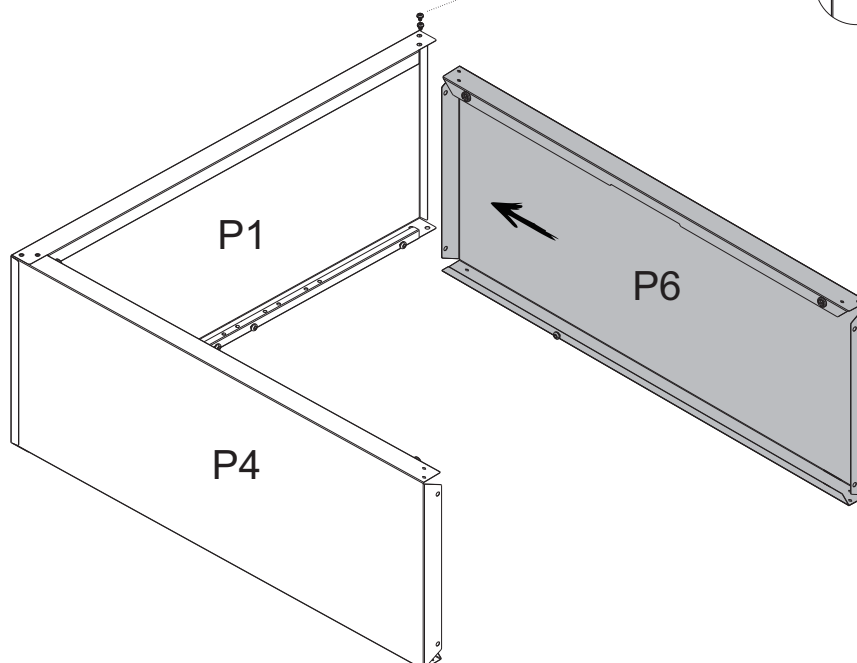
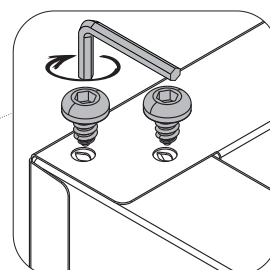
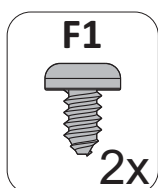

STEP 3

- 1 - Fit part **P1** to part **P4** and part **P6**
- 2 - Fit part **P1** to part **P4** and part **P6**, at the frontal side, with **F1**

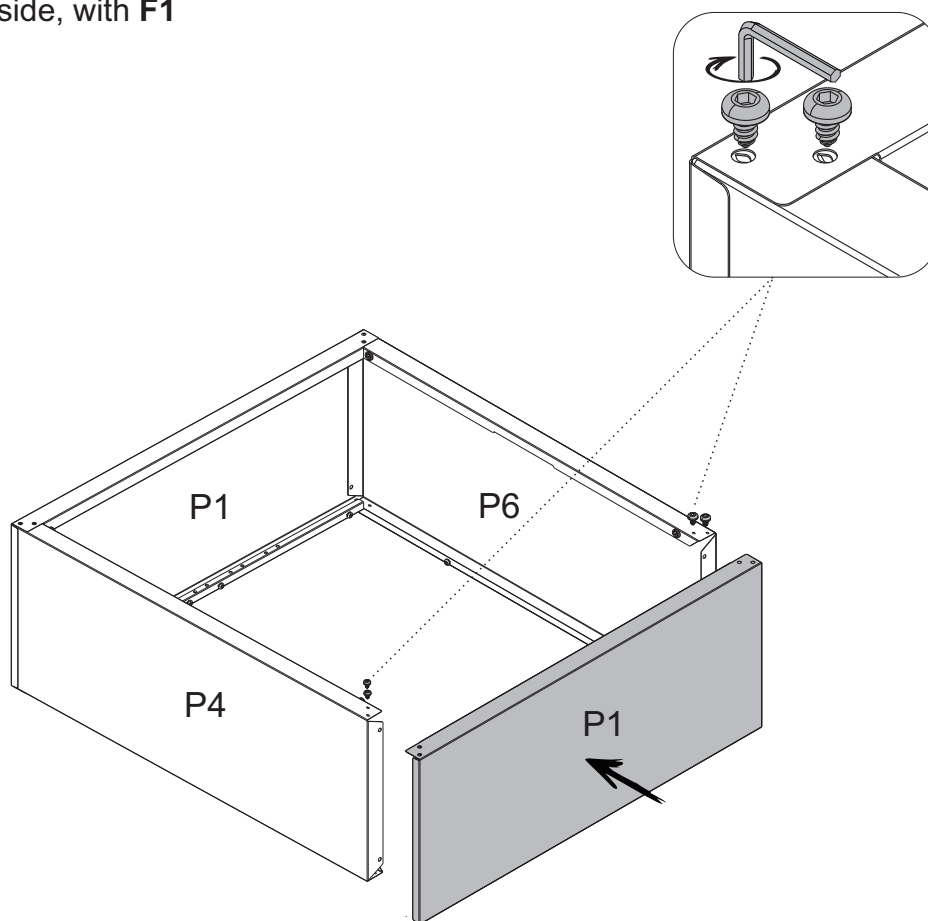
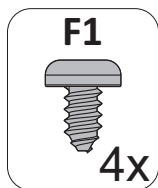

STEP 4

- 1 - Turn the cupboard with the back side upwards

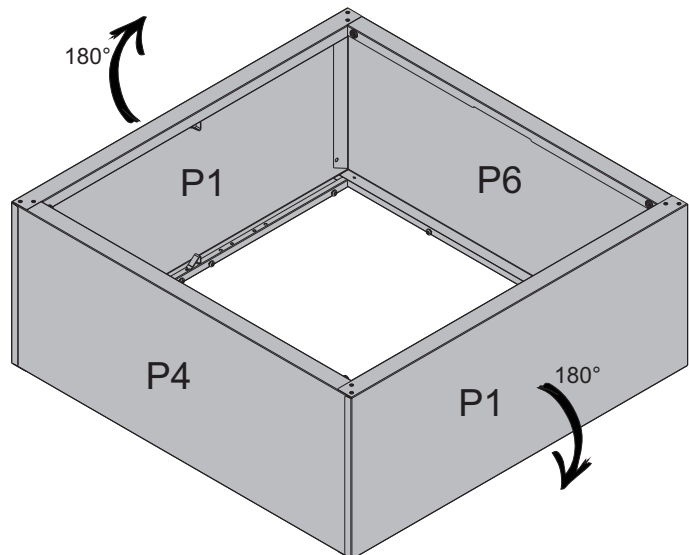
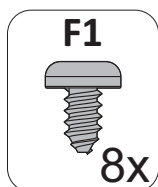

- 2 - Fit part **P1** to part **P4** and part **P6**, at the frontal side, with **F1**

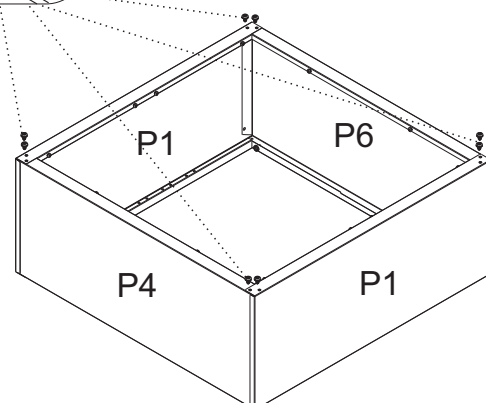
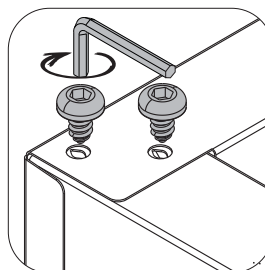

STEP 5

- 1 - Fit part **P8** into part **P4** and parts **P1**
- 2 - Check that all fits are supported over the bolts
- 3 - After fitting the parts, screw the bolts until locked



WARNING

“

Position part **P8** on the **P4** side for mounting the cabinet.

”

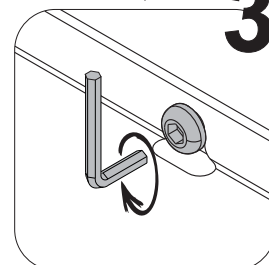
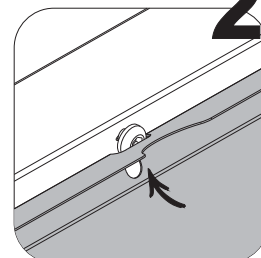
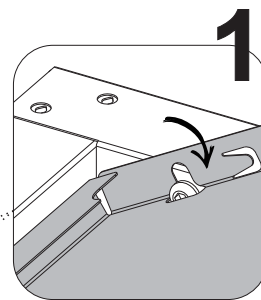
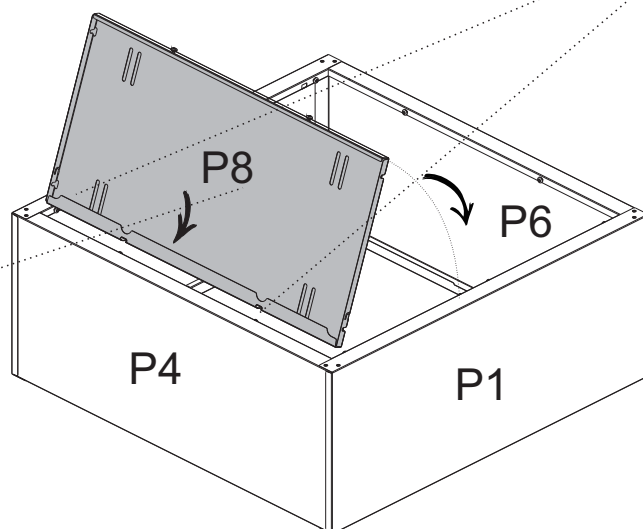

STEP 6

- 1 - With the end of **F13**, smash the safety claw, locking part **P8** to part **P1**.

F13

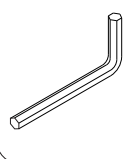

WARNING

“

To avoid possible falls, this safety claw should be fixed.

”

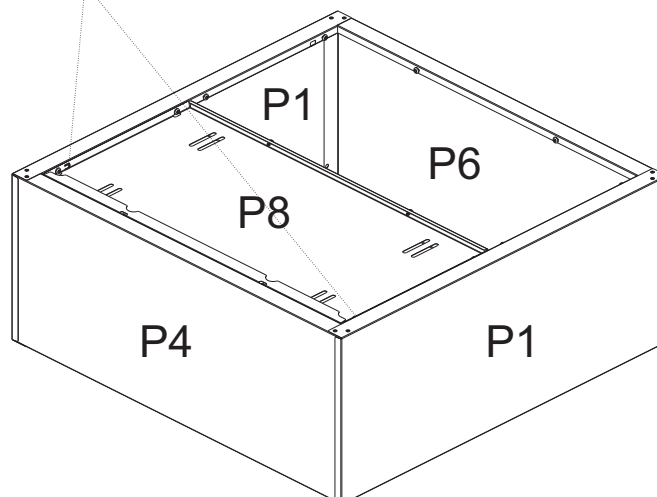
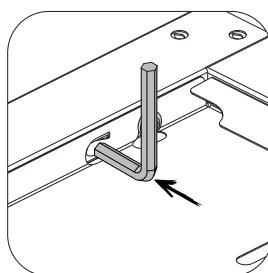

STEP 7

- 1 - Fit part **P9** inside parts **P1**, **P6** and **P8**.
Check that all fits are supported over the bolts
- 2 - After fitting the parts, screw the bolts until locked

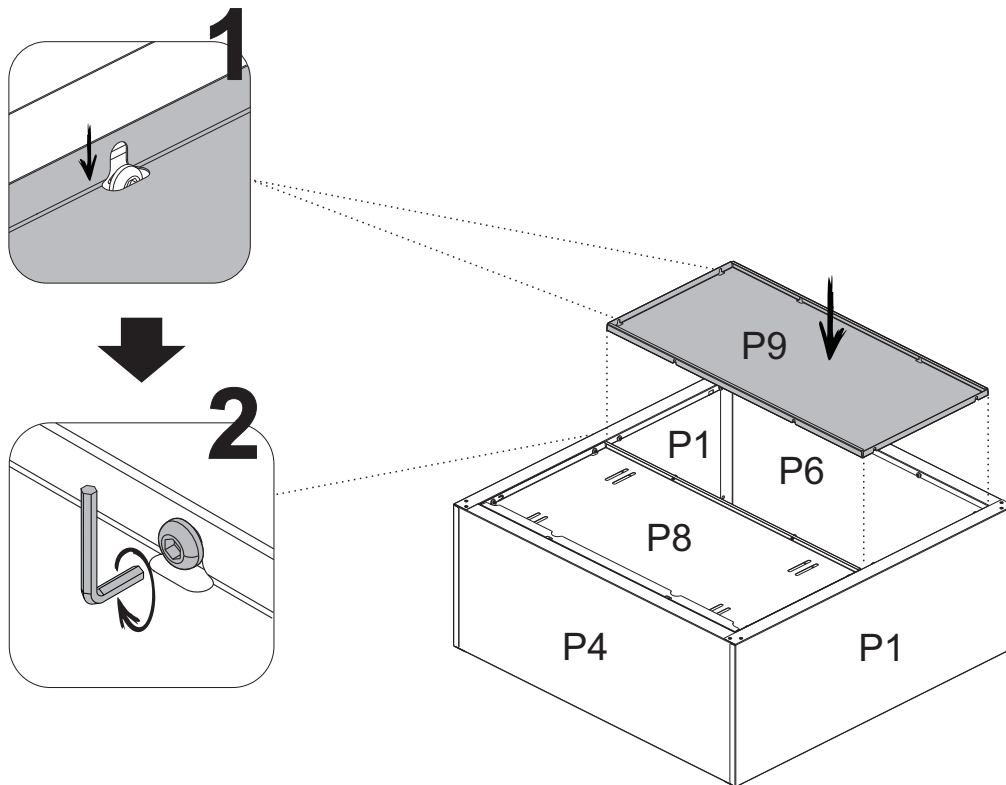

STEP 8

- 1- Turn the cupboard so that it will stand in the position of use
- 2- Fix **F7** to parts **P1**, as shown here below

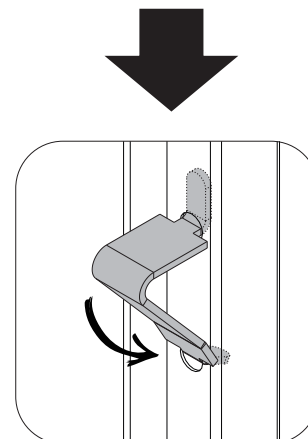
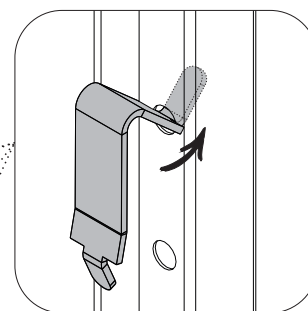
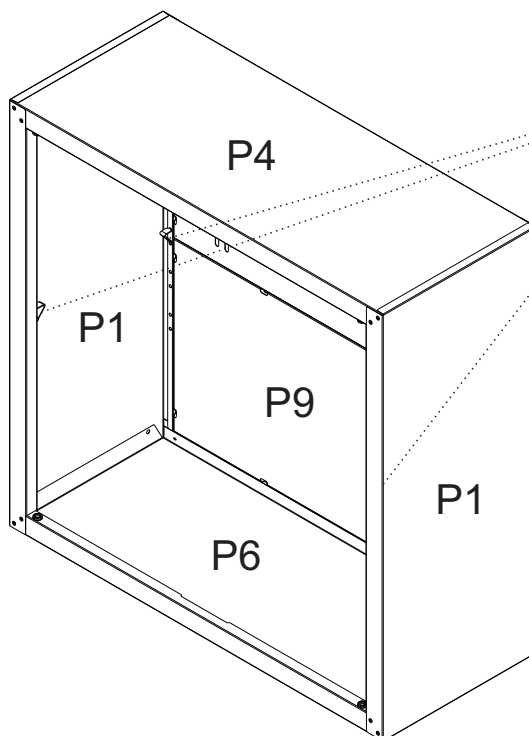
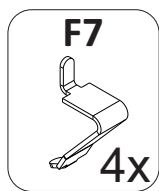

STEP 9 1 - Place part **P18** diagonally so it fits inside the cupboard

2 - Lean part **P18** to part **P1** and place it over the **F7** detailed in the illustration here below

3 - Bend the other side of part **P18** down, leaning it over the left **F7**

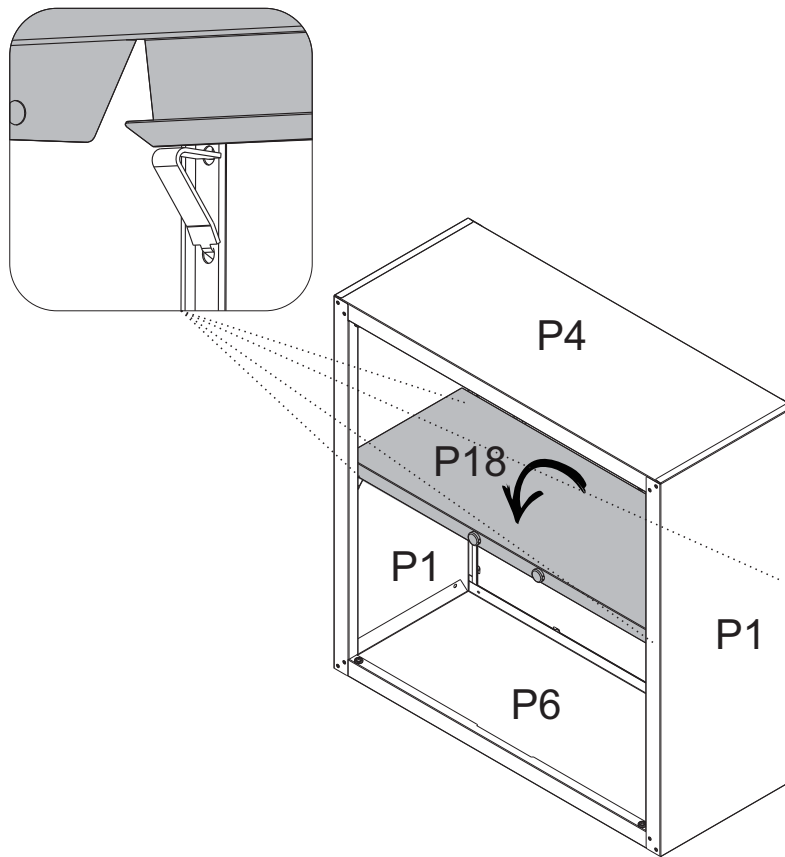
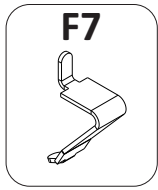

- STEP 10**
- 1 - Align part **P16** at an approximate height of 72 1/2" from the floor
 - 2 - Align the part using a level
 - 3 - Mark the wall using holes of part **P16**, aided by a pencil

- 4 - Drill the wall where marked on the wall, with the pencil using a drill with a 1/2" (13 mm) drill



WARNING

“The cupboard must be fixed onto the wall”

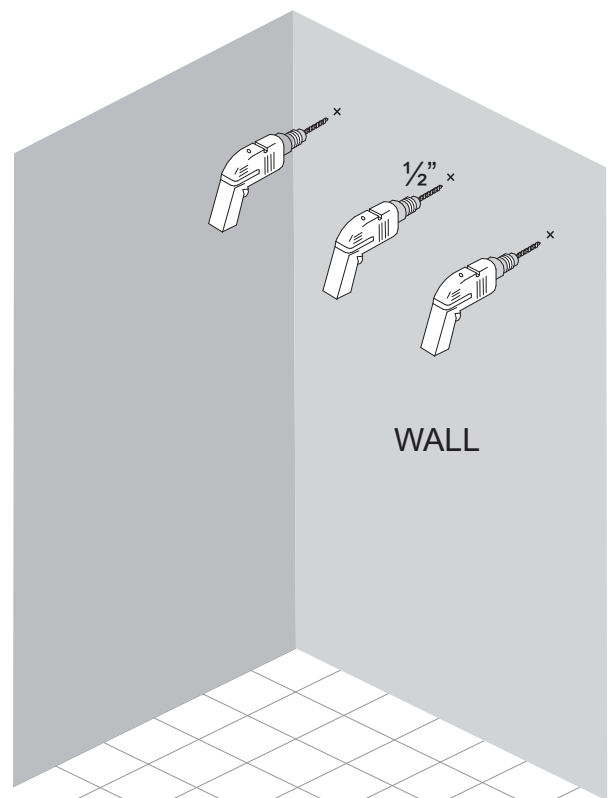
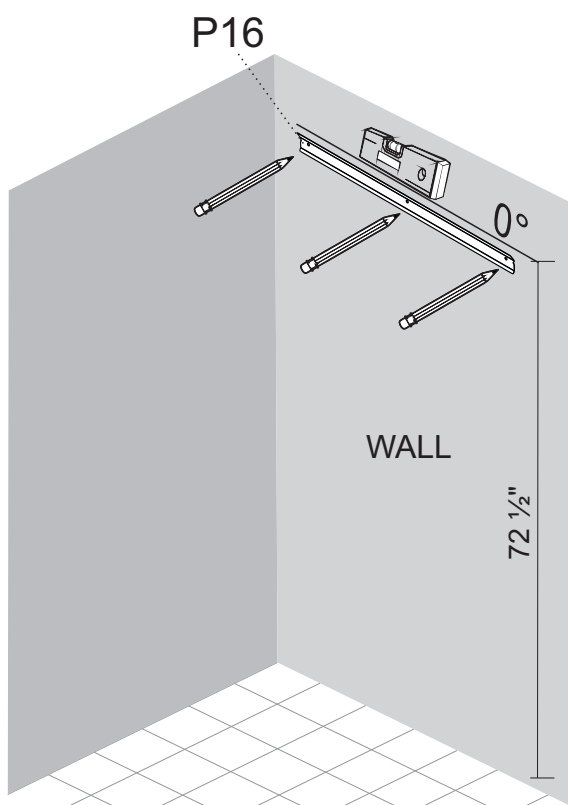

STEP 11

1 - Insert the metal part of the bushing into the hole until it overcomes the wall.

2 - Pull the bushing driving it against the wall and then push the plastic ring until it leans close to the wall

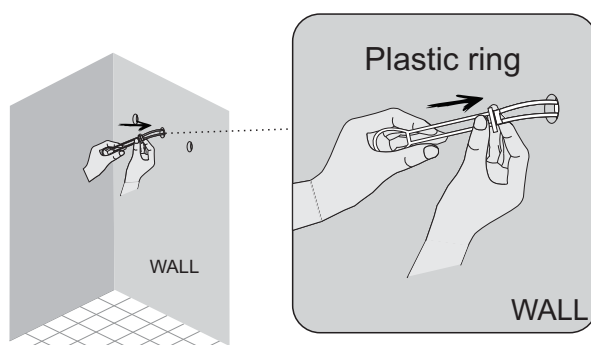
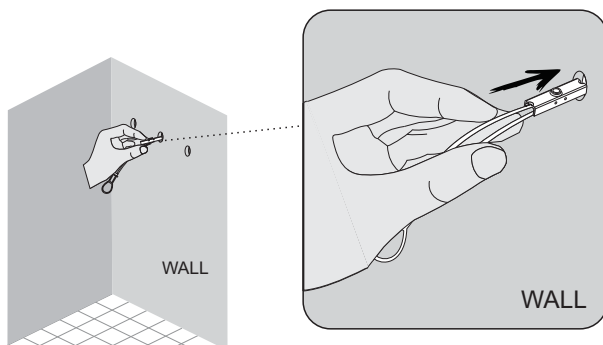
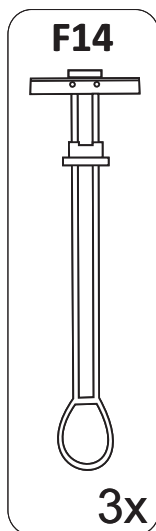

3 - Break the bushing's rods

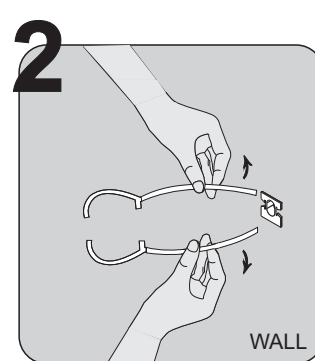
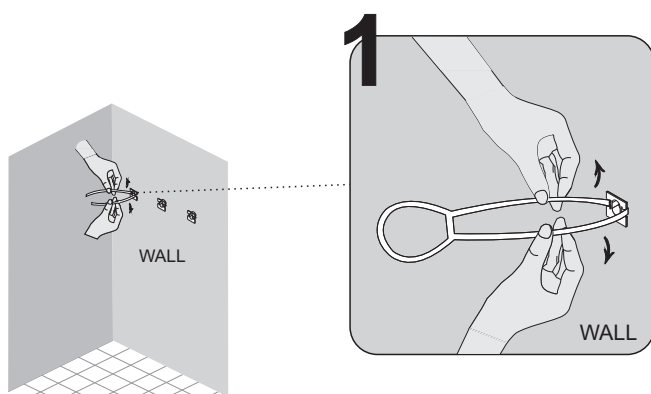

STEP 12

1 - Align part **P16** to the bushings and fix them with **F5**

2 - Fix the cupboard to part **P16**, held to the wall. Part **P8** tab shall be used to this purpose

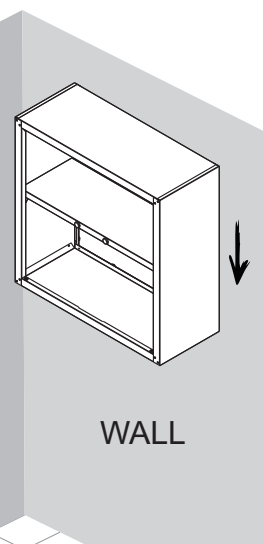
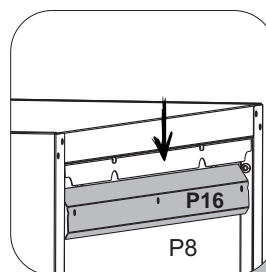
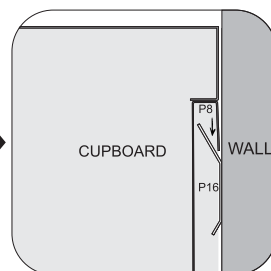
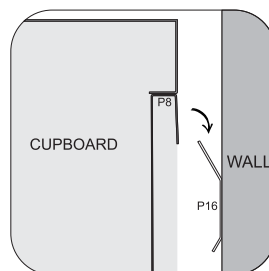
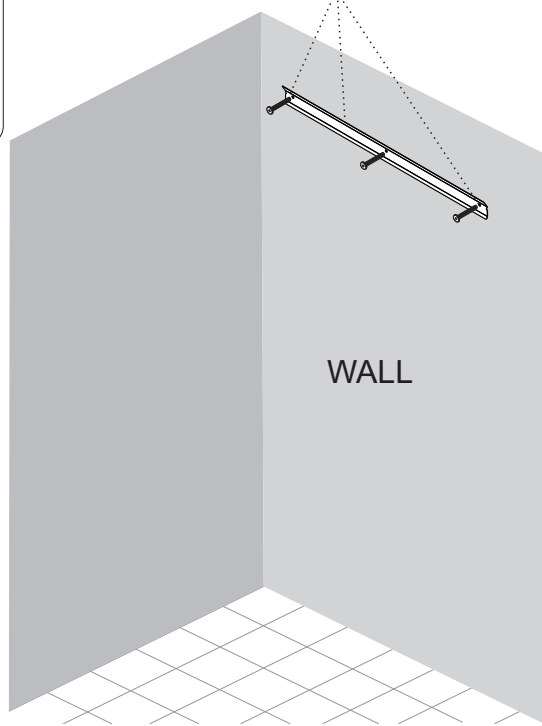
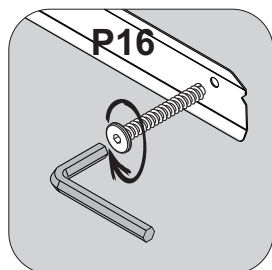
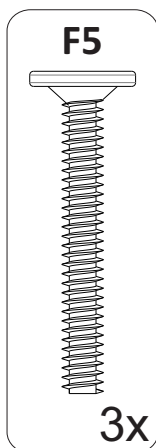

STEP 13

- 1 - To assembly the doors, fit door **P22** lower hinge bolt inside the bushing fixed in part **P6**
- 2 - Then, pull the pin of door **P22** upper hinge down; align the door and release the pin to fit the bushing fixed in part **P4**
- 3 - Repeat the step for part **P23**

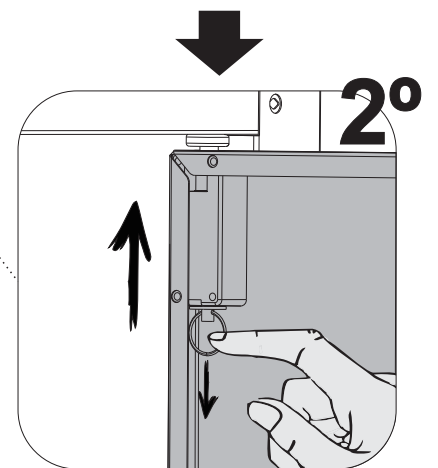
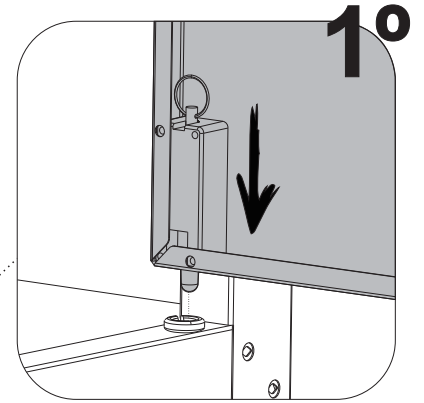
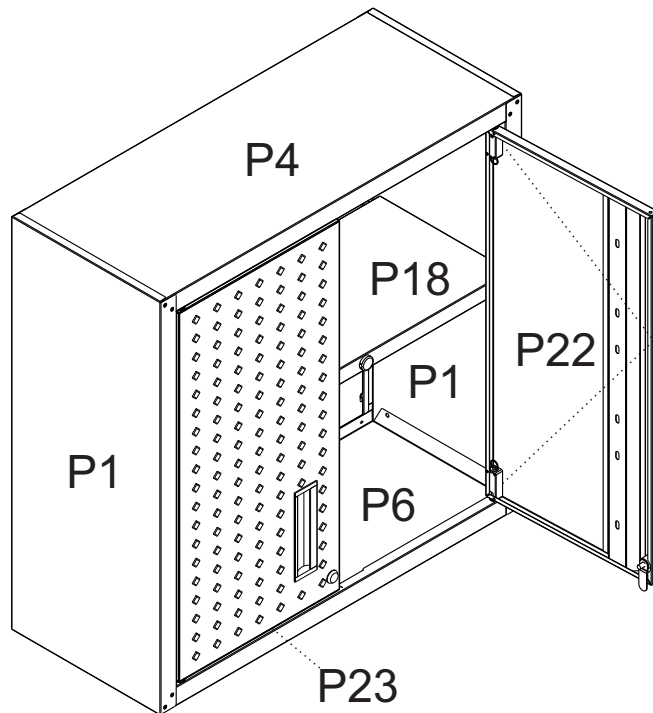

STEP 14

- 1 -Insert product log

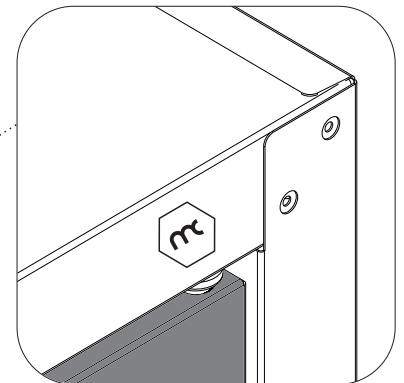
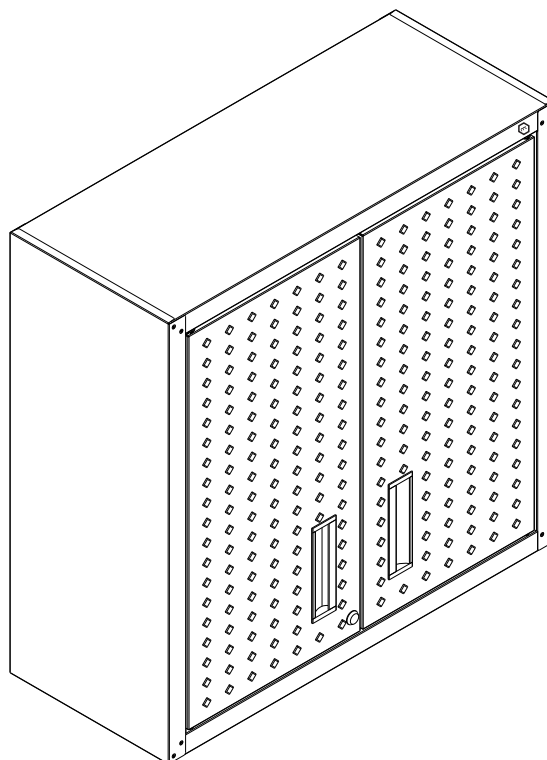
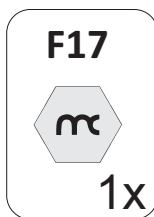



MANHATTAN
COMFORT

ASSEMBLY HANDBOOK – FORTRESS GARAGE TABLE

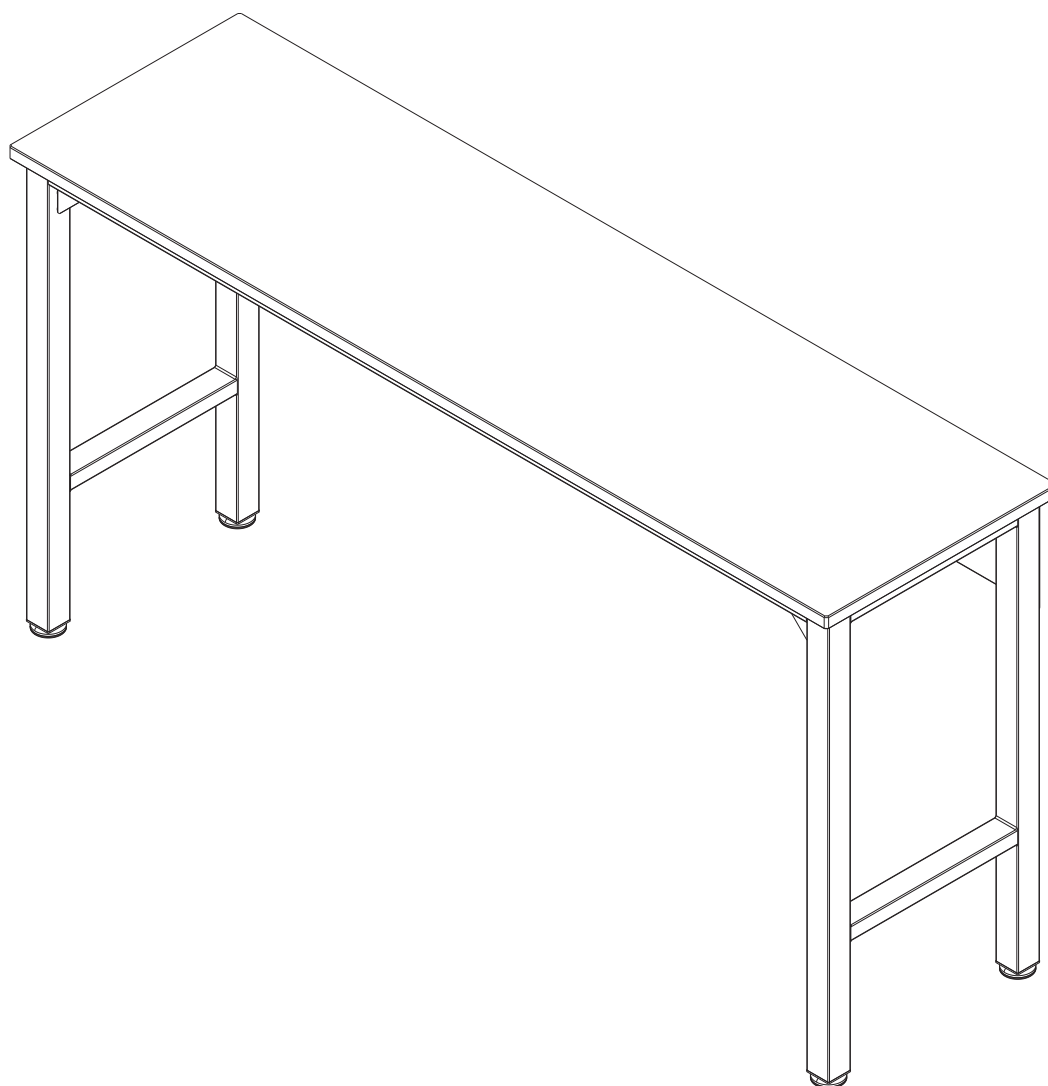

6GMC



Stuck? Questions? We are here to help.
1-888-230-2225
help@manhattancomfort.com



View our assembly video online
www.manhattancomfort.com

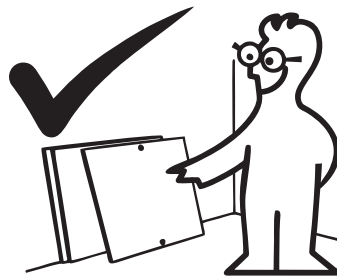
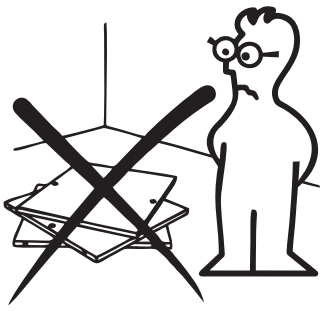

In order to ease the assembly,
you should separate and identify the parts first

Necessary hardware for the assembly

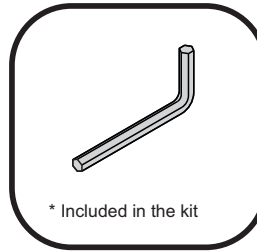
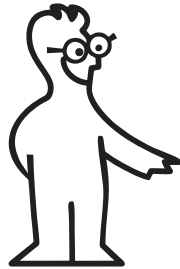

* Included in the kit

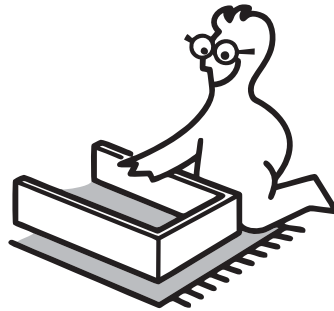
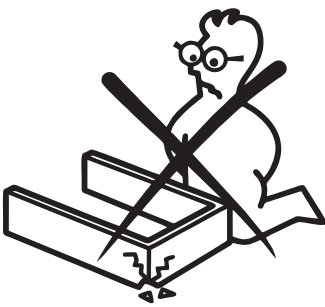

Do not place the parts directly onto the floor.
Use a cardboard sheet or a mat to place the
parts, during the separation and assembly.

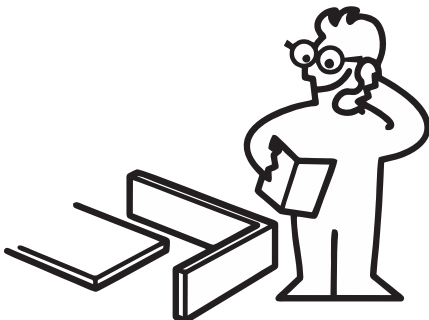

Stuck? Questions? We are here to help.
1-888-230-2225
help@manhattancomfort.com

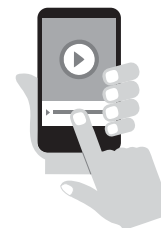

View our assembly video online
www.manhattancomfort.com

IMPORTANT

In order to avoid severe or even fatal injuries, follow the instructions carefully.

ASSEMBLY HANDBOOK – FORTRESS GARAGE TABLE

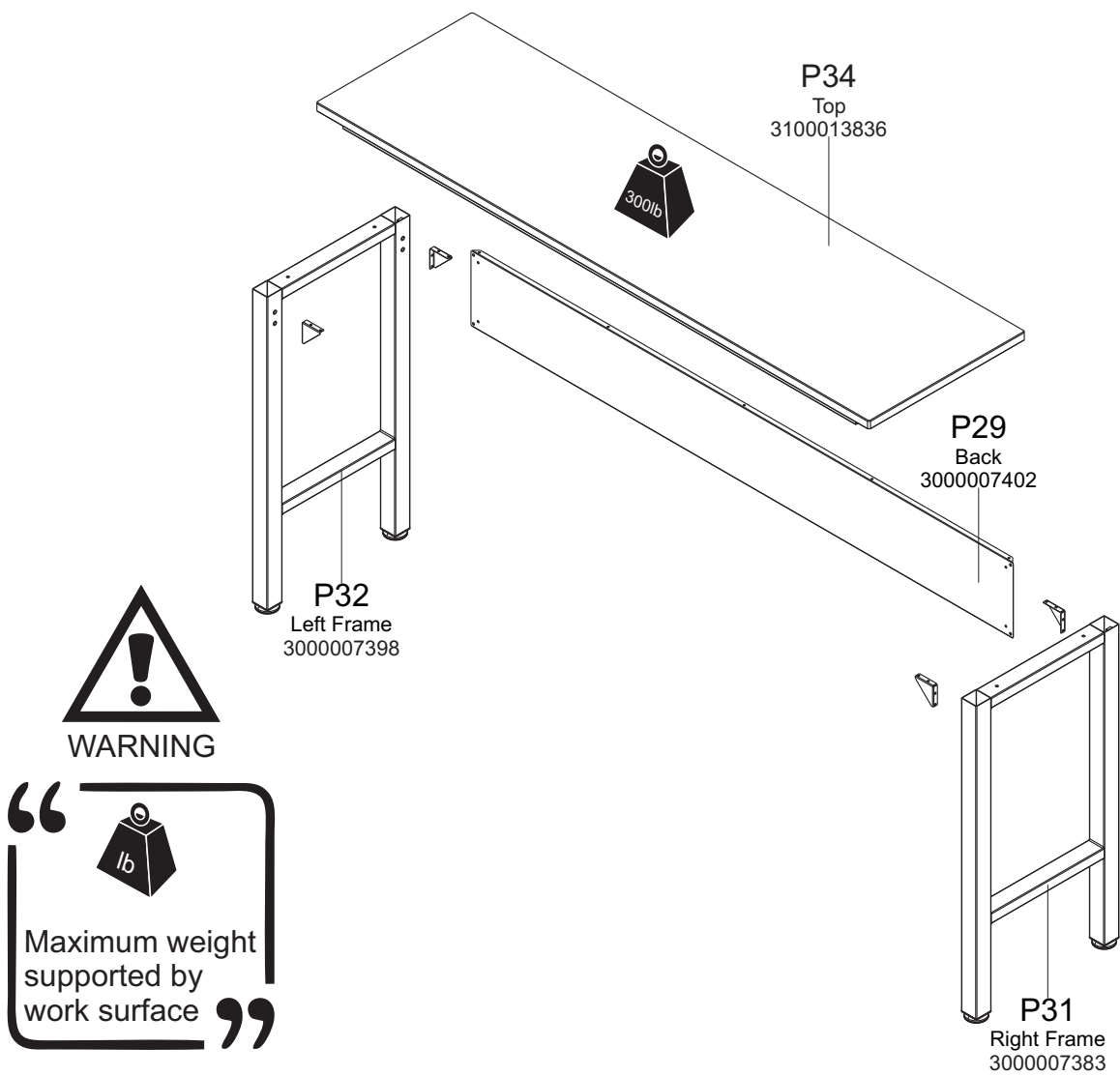

Hardware list

F2
1000009499

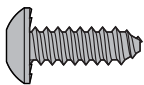

Qty. 3

F3
1000008391

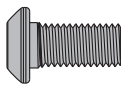

Qty. 20

F8
1000008387



Qty. 20

F4
1000008299

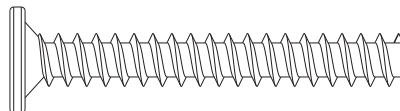

Qty. 4

F9
1000008368

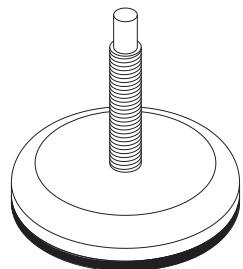

Qty. 4

F13
1000009033

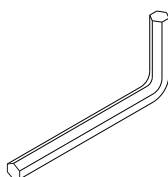

Qty. 1

F16
3000007407

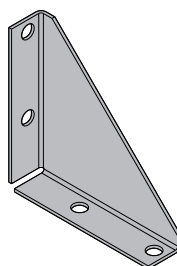

Qty. 4

F17
1000008285



Qty. 1

STEP 1

1. Fit the shoes to frame **P32** and **P31** base and turn to screw. To level the height or the table, turn the shoe clockwise or counterclockwise until is aligned

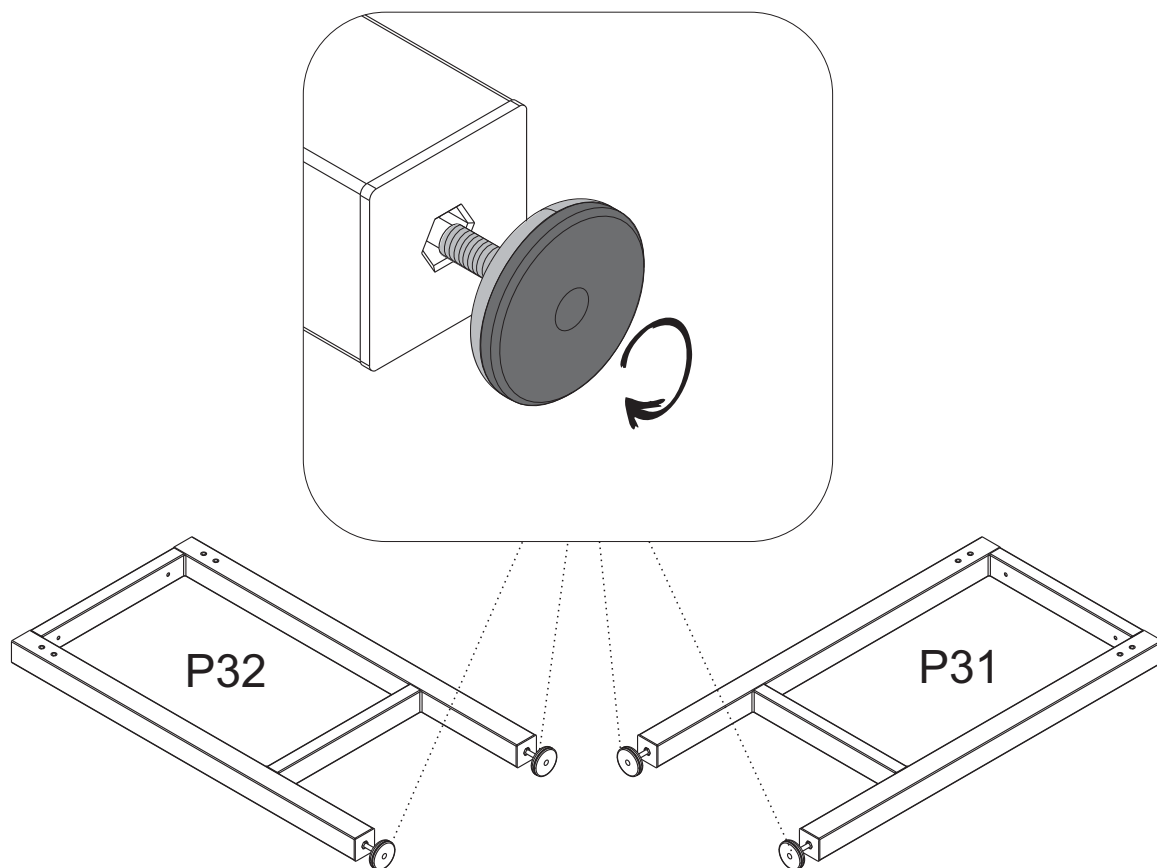
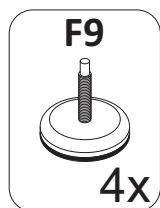

STEP 2

1. Align corner brackets **F16** to the upper sides of frames **P31** and **P32** and fix them with **F3** and **F8**

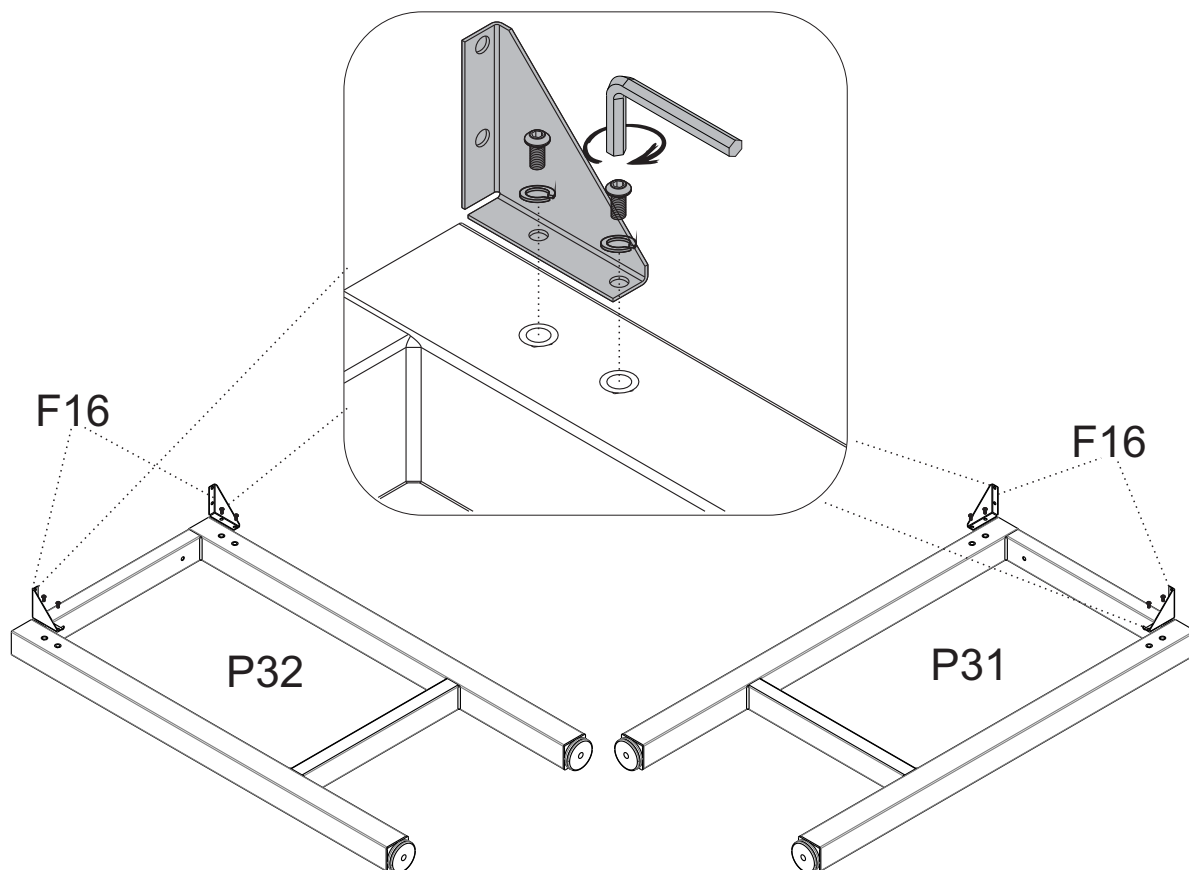
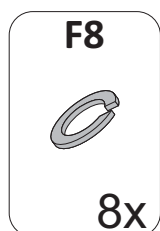
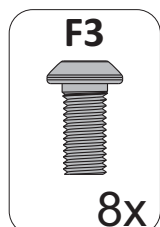
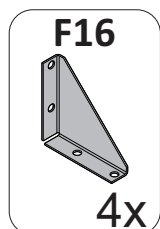

STEP 3

1.Align frames **P31** and **P32** to **P34**

2.Fix corner brackets **F16** to the metallic part of **P34**, with **F3** and **F8**

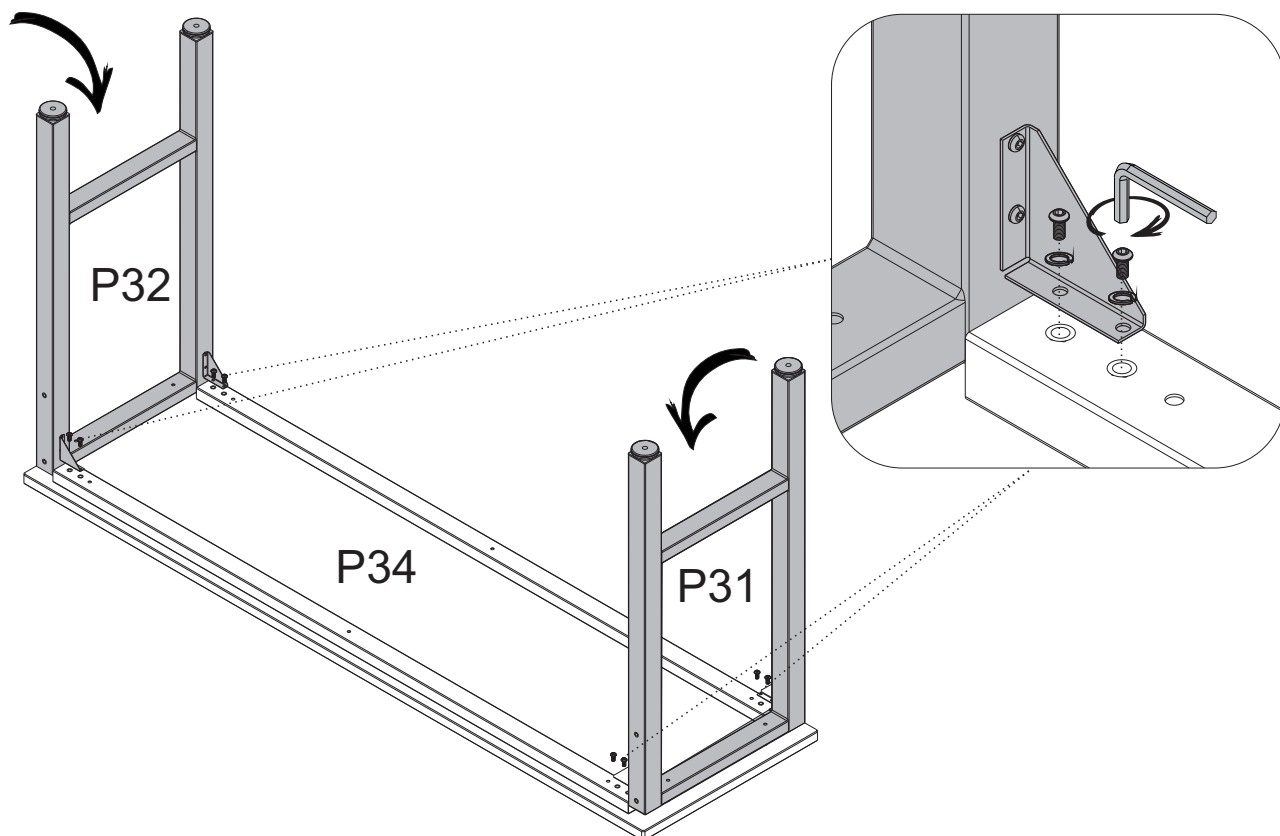
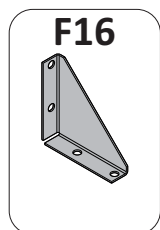
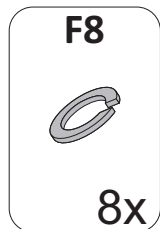
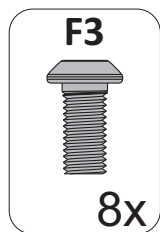

STEP 4

1.Then, fix frames **P31** and **P32** to the wooden part of part **P34**, with **F4**

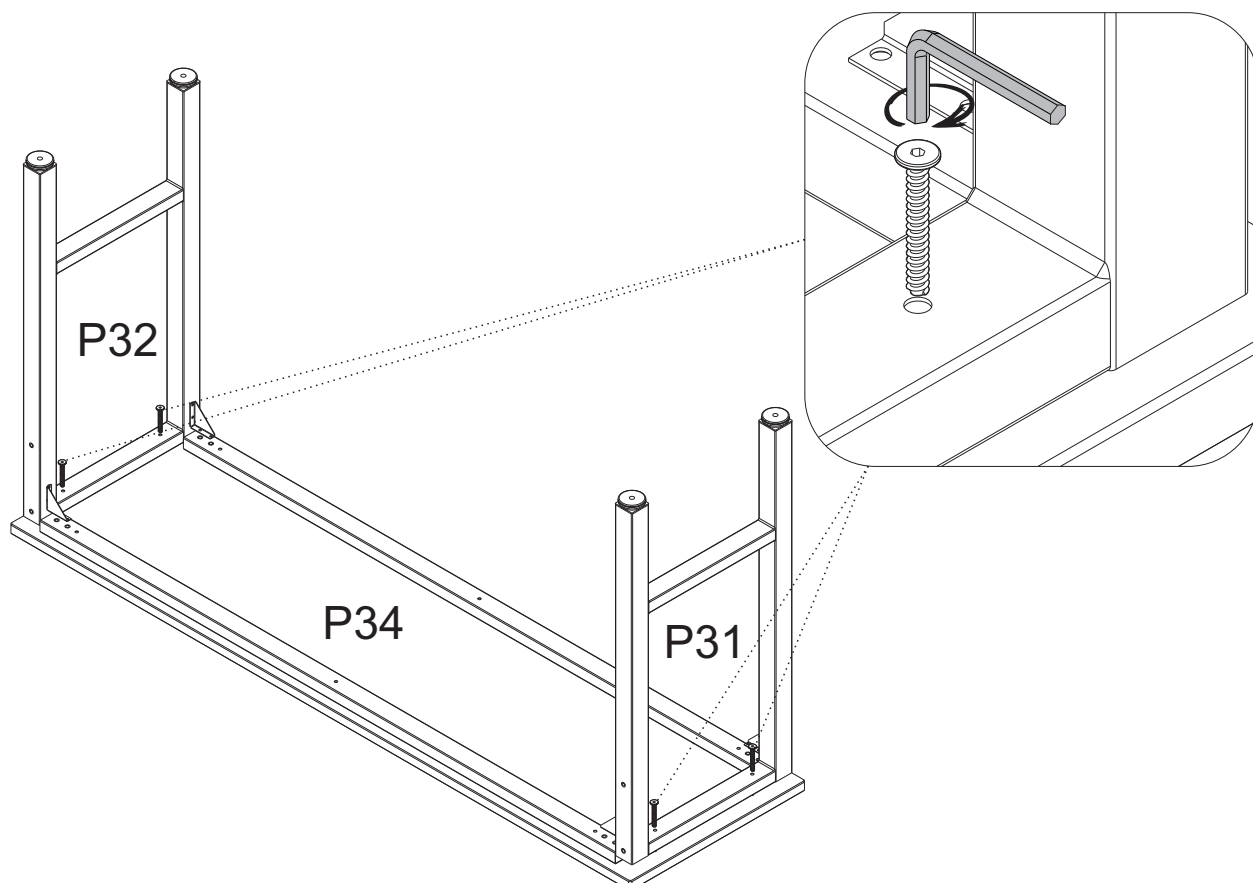
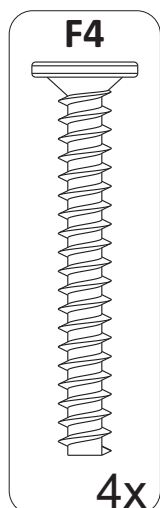

STEP 5

- 1.Align the part **P29** to frames **P31** and **P32**
- 2.Fix part **P29** to frames **P31** and **P32** with **F3** and **F8**

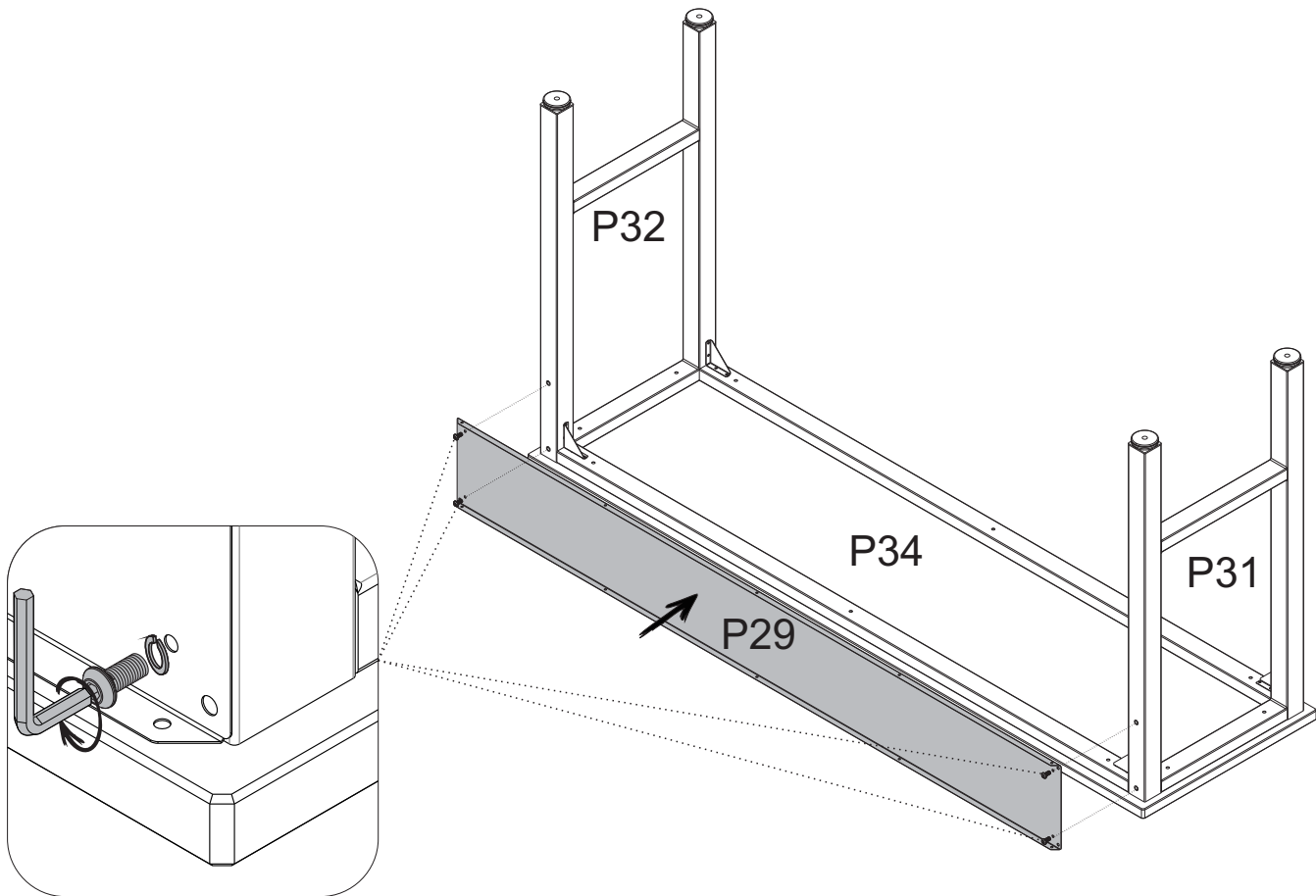
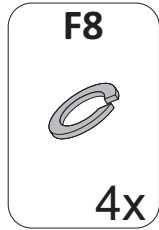
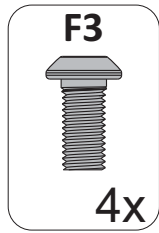

STEP 6

- 1.Fix part **P29** to part **P34** wooden side, with **F2**

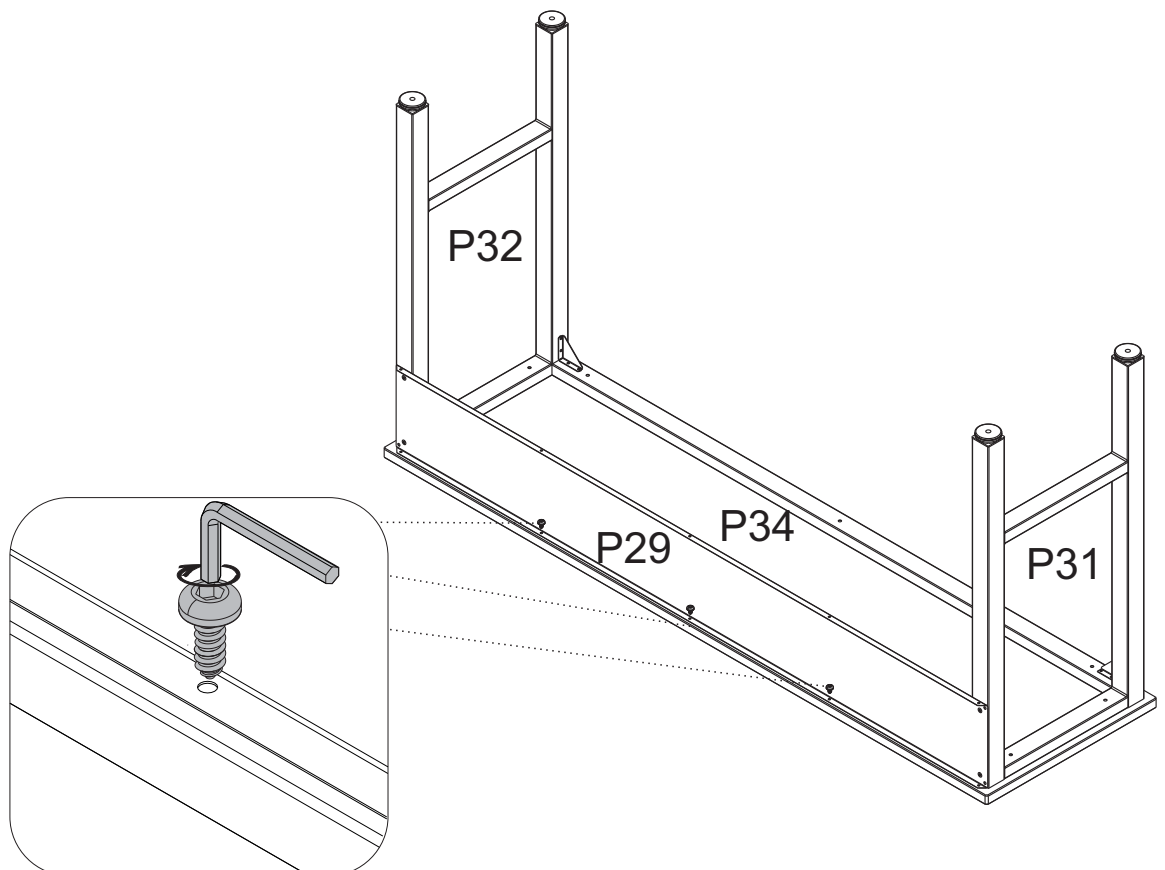
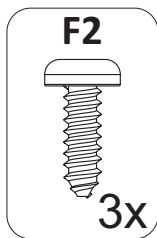

STEP 7

1 -Insert product log

