

VEVOR[®]

TOUGH TOOLS, HALF PRICE

Technical Support and E-Warranty Certificate www.vevor.com/support

INSTRUCTION FOR POLYCARBONATE AWNINGS

We continue to be committed to provide you tools with competitive price.

"Save Half", "Half Price" or any other similar expressions used by us only represents an estimate of savings you might benefit from buying certain tools with us compared to the major top brands and does not necessarily mean to cover all categories of tools offered by us. You are kindly reminded to verify carefully when you are placing an order with us if you are actually saving half in comparison with the top major brands.

VEVOR[®]

TOUGH TOOLS, HALF PRICE

POLYCARBONATE
AWNINGS

CZPC40X40T

CZPC40X40B

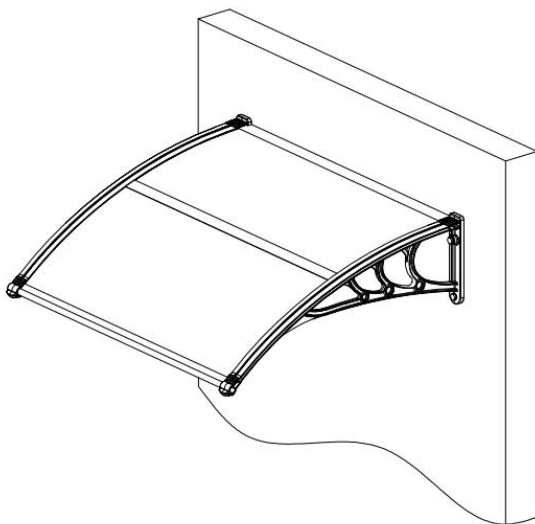

NEED HELP? CONTACT US!

Have product questions? Need technical support? Please feel free to contact us:

Technical Support and E-Warranty Certificate www.vevor.com/support

This is the original instruction, please read all manual instructions carefully before operating. VEVOR reserves a clear interpretation of our user manual. The appearance of the product shall be subject to the product you received. Please forgive us that we won't inform you again if there are any technology or software updates on our product.

SAFETY INFORMATION

- Make sure to keep sufficient distance to the water pipe as well as gas and power lines to avoid possible damage. Please check the area for the water pipe, power cables and gas lines. Ask your local authority for further information if needed.
- In order to ensure your own safety, please make sure to wear a helmet, gloves and solid shoes when installing this product.
- Please keep small spare parts out of children's reach.
- The awnings should only be assembled by at least two adults. Please keep children away from the awnings while assembling it to protect them.

SPECIFICATIONS

Model	CZPC40X40T
Product Size	40×40in
Color	Transparent

Model	CZPC40X40B
Product Size	40×40in
Color	Brown

TOOLS

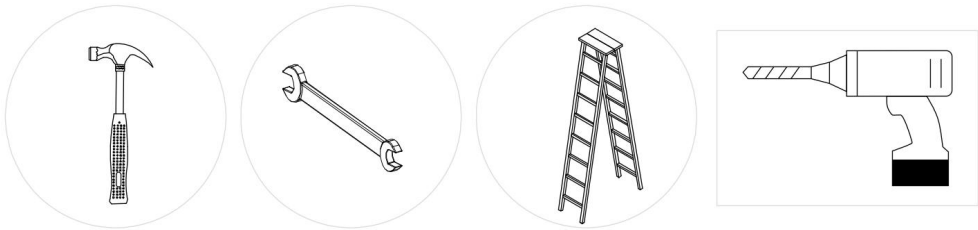

IMPORTANT

People needed for installation work.

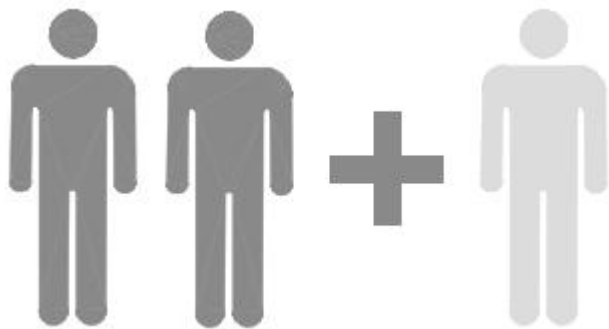

COMPONENTS

NO.	Drawing	Qty	Indication	NO.	Drawing	Qty	Indication
①		2	Board	④		1	Back Fixing Bar
②		1	Frontal Fixing Bar	⑤		4	Setscrew
③		2	Bracket	⑥		1	Alu. Connecting Rod
				⑦		4	Bolt M4×25
				⑧		2	Locating hole sticker

Assembly Instructions

STEP1

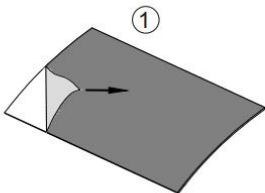

STEP2

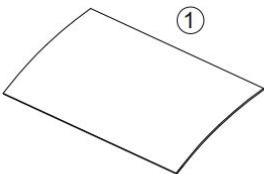

STEP3

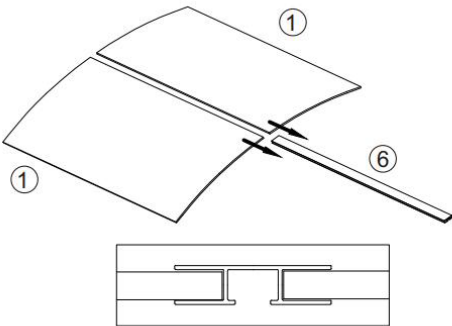

STEP4

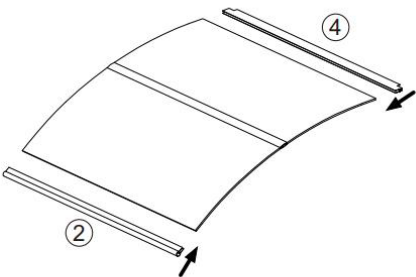

STEP5

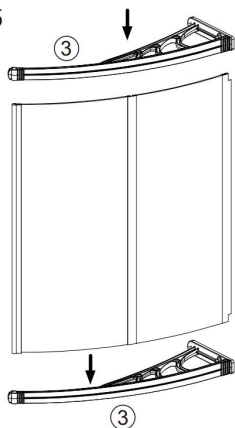

STEP6

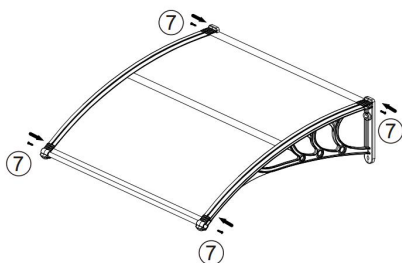

STEP7

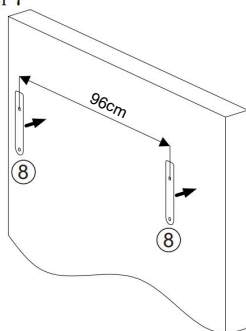

STEP8

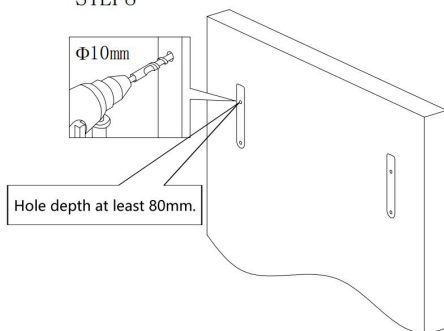

STEP9

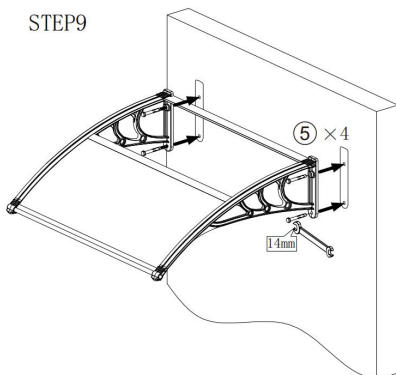

STEP10

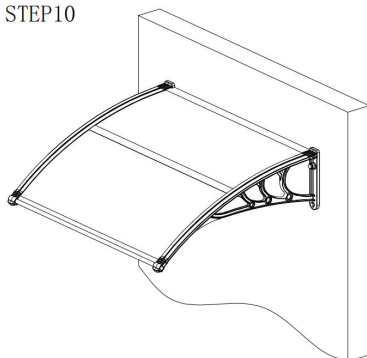

Notice: Users can increase the glass glue fixing on both sides of the bracket and the edge of the wall according to the requirements of the product to extend the service life of the product.

Imported to USA: Sanven Technology Ltd. Suite 250, 9166 Anaheim Place,
Rancho Cucamonga, CA 91730

VEVOR[®]

TOUGH TOOLS, HALF PRICE

Technical Support and E-Warranty Certificate

www.vevor.com/support