

USE AND CARE

MODEL:

SAT-401BH SAT-401BH-A USE & CARE SECTION

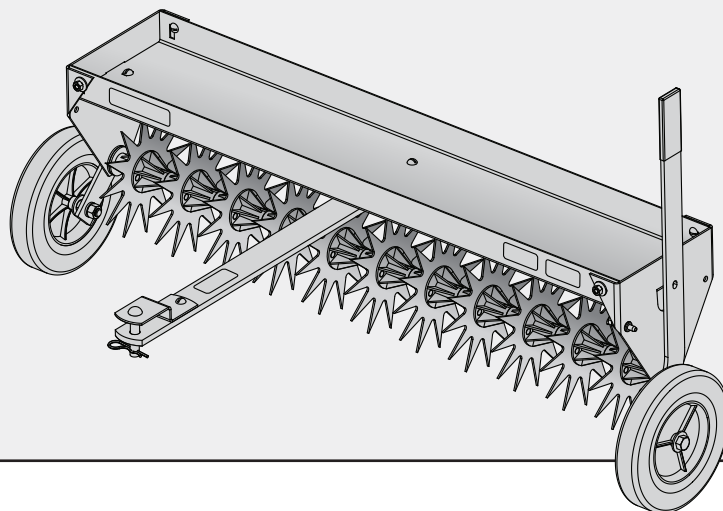

SPECIFICATIONS

Empty Weight 42 lbs.

Maximum
Load 150 lbs.

Maximum
Towed Weight 192 lbs.

SPEED

Best Operating
Speed 3 mph (*or less*)

Maximum
Towing Speed 5 mph.

CAUTION: Avoid injury while installing & removing!



Make sure feet and hands are clear of Tine Tips. Keep body parts away from under drawbar. Do not attempt to disconnect aerator from towing vehicle with weight on the tray.

INSTALLING

1. Park machine safely.
(*See towing vehicle manual*).
2. Align aerator clevis (25) with towing machine drawbar.
3. Install drawbar pin (21) through clevis and machine drawbar. Secure drawbar pin with Hairpin Cotter (24).

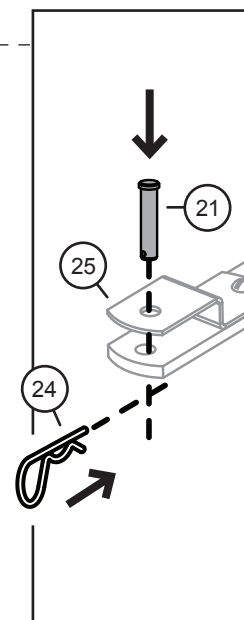

REMOVING

1. Secure towing vehicle parking brake.
(*See towing vehicle manual*).
2. Place Aerator in the Transport Position.
3. Unload Aerator tray.
4. Remove cotter pin and drawbar pin.
5. Push aerator away from towing vehicle.
6. Install drawbar pin and cotter pin to towbar for storage.

USE AND CARE

USAGE



CAUTION: AVOID INJURY!

Avoid damage to tines. Do not tow the aerator across concrete or asphalt driveways and walkways.

CAUTION: Excessive towed load can cause loss of control on slopes. Stopping distance increases with speed and the weight of the towed load.

CAUTION: Total towed weight must not exceed combined weight of towing vehicle, ballast and operator.

FREQUENCY

Aeration is not accomplished in a single pass. It will normally take several passes over the lawn.

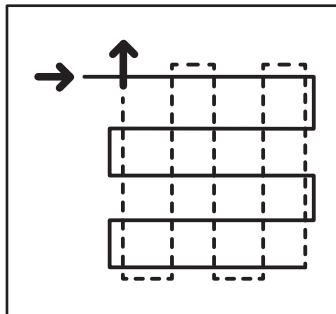

Alternating the direction by 90° will improve the aeration effect. The aerator may be used in an independent operation or may be used when mowing your lawn.



REPLACEMENT TINES ARE AVAILABLE

Part Number: **1018833-SER**

USING THE WEIGHT TRAY

The following maximum loaded weight capacity is the weight of the aerator plus the weight loaded in the tray:

WEIGHT CAPACITY

42 lbs. EMPTY
150 lbs. MAXIMUM LOAD
192 lbs. MAXIMUM TOWED WEIGHT



CAUTION: AVOID INJURY! THE AERATOR TINES ARE VERY SHARP.

Keep body parts away from under drawbar. Do not attempt to disconnect aerator from towing vehicle with weight on the tray.

Towing capacity will vary with weight of towing vehicle and operator. Add the weight of your machine to operator weight to find the maximum capacity for towing.

DEPTH / PENETRATION

- Weight should be added to tray after installing to the towing machine.
- Weight should be secured by rope, straps, or other suitable means to contain the weight in the tray.
- Weight tray maximum capacity = 150 pounds.
- **Moderate soil moisture is important for proper tine penetration.**
 - Extremely **DRY** conditions will not permit tine penetration and may damage the tines.
 - Extremely **WET** conditions will cause full penetration of tines (up to tine bearings). This condition will cut slots in the turf.

USE AND CARE

MAINTENANCE

- After the first 30 minutes of use check all fasteners for tightness.
- Tines are manufactured with galvanized steel to resist wear of abrasive soil. Striking objects can cause tines to curl or break. Contact our Customer Service Department to purchase replacement Tines (Part # 1018833-SER).
- Aerator is essentially maintenance free. However as with any steel product, it can rust. Apply a light coat of oil on tines after use to prevent rust. For rust appearing on painted surfaces, sand lightly and coat with enamel.
- Periodically remove debris that builds up between tines.
- Apply lubricating oil at each tine and bearing before use.



STORAGE

CAUTION: AVOID INJURY! THE AERATOR TINES ARE VERY SHARP.



Care should be taken when choosing a storage location for this product. Store Aerator in low traffic aisle ways.

- Store Aerator with tine points facing the wall or ground.
- Store Aerator on the ground or low to the ground.
- Do not store Aerator hanging from the wall, ceiling or with Tine points facing outward.
- Product packaging can be used to offer a protective area around the Tines.
- Drawbar is a trip hazard. Avoid leaving drawbar in aisle ways and walking paths.

SERVICE

QUALITY CONTINUES WITH QUALITY SERVICE

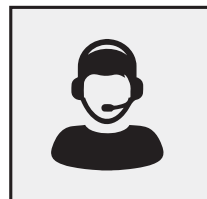

If you have installation questions, are missing parts or need replacement parts, don't go back to the store!

Please find your product serial number and model number, then contact our Customer Service department:



In North America and Canada call
Toll-Free: **877-728-8224**



Chat online: **www.brinly.com**



Email: **customerservice@brinly.com**

ONLINE: BRINLY.COM

Additional info and videos are available on our website. Please visit the URL above OR scan this QR code.

SAT-401BH
SAT-401BH-A

