

Shark

**Navigator[®]
Lift-Away[®] DELUXE**

NV360 Series

OWNER'S GUIDE



IMPORTANT SAFETY INSTRUCTIONS

HOUSEHOLD USE ONLY

To reduce the risk of electric shock, this vacuum cleaner has a polarized plug (one blade is wider than the other). As a safety feature, this plug will fit into a polarized outlet only one way. If the plug does not fit fully into the outlet, reverse the plug. If it still does not fit, contact a qualified electrician. DO NOT force into outlet or try to modify to fit.

⚠ WARNING

TO REDUCE THE RISK OF FIRE, ELECTRIC SHOCK OR INJURY:

When using an electrical appliance, basic precautions should always be followed, including the following:

- Your vacuum cleaner may consist of a motorized nozzle, wand, hose, and/or vacuum pod. This device contains electrical connections, electrical wiring, and moving parts that potentially present risk to the user.
- Use only identical replacement parts.
- Carefully observe and follow the instructions provided below to avoid improper use of the appliance. **DO NOT** use the vacuum for any purpose other than those described in this manual.
- Before use, carefully inspect all parts for any damage. **DO NOT** use if any parts are damaged.
- The use of an extension cord is **NOT** recommended.
- This vacuum cleaner contains no serviceable parts.

USE WARNINGS

- **DO NOT** allow the appliance to be used by children. Close supervision is necessary when used near children. This is not a toy.
- Always turn off the vacuum cleaner before connecting or disconnecting any motorized nozzles or other accessories.
- **DO NOT** handle plug or vacuum cleaner with wet hands.
- **DO NOT** use without filters in place.

- Only use Shark® branded filters and accessories.
- **DO NOT** damage the power cord:
 - a) **DO NOT** pull or carry vacuum cleaner by the cord or use the cord as a handle.
 - b) **DO NOT** unplug by pulling on cord. Grasp the plug, not the cord.
 - c) **DO NOT** run the vacuum cleaner over the power cord, close a door on the cord, pull the cord around sharp corners, or leave the cord near heated surfaces.
- **DO NOT** put any objects into nozzle or accessory openings. **DO NOT** use with any opening blocked; keep free of dust, lint, hair, and anything that may reduce airflow.
- **DO NOT** use if nozzle or accessory airflow is restricted. If the air paths or the motorized floor nozzle become blocked, turn the vacuum cleaner off and unplug from electrical outlet. Remove all obstructions before you plug in and turn on the unit again.
- Keep nozzle and all vacuum openings away from hair, face, fingers, uncovered feet, or loose clothing.
- **DO NOT** use if vacuum cleaner is not working as it should, or has been dropped, damaged, left outdoors, or dropped into water.
- Use extra care when cleaning on stairs.

SAVE THESE INSTRUCTIONS

READ ALL INSTRUCTIONS BEFORE USE

- **DO NOT** leave the vacuum cleaner unattended while plugged in.
- When powered on, keep the vacuum cleaner moving over the carpet surface at all times to avoid damaging the carpet fibers.
- **DO NOT** place vacuum cleaner on unstable surfaces such as chairs or tables.
- Your Shark® vacuum may not be designed to stand up on its own. When taking a break from cleaning, you may need to lean it against furniture or a wall, or lay it flat on the floor. Using the vacuum for an application where the unit lacks stability may result in personal injury.
- **DO NOT** use to pick up:
 - a) Liquids
 - b) Large objects
 - c) Hard or sharp objects (glass, nails, screws, or coins)
 - d) Large quantities of dust (drywall dust, fireplace ash, or embers). **DO NOT** use as an attachment to power tools for dust collection.
 - e) Smoking or burning objects (hot coals, cigarette butts, or matches)
 - f) Flammable or combustible materials (lighter fluid, gasoline, or kerosene)
 - g) Toxic materials (chlorine bleach, ammonia, or drain cleaner)
- **DO NOT** use in the following areas:
 - a) Poorly lit areas
 - b) Wet or damp surfaces
 - c) Outdoor areas
 - d) Spaces that are enclosed and may contain explosive or toxic fumes or vapors (lighter fluid, gasoline, kerosene, paint, paint thinners, mothproofing substances, or flammable dust)
- Turn off all controls before plugging in or unplugging the vacuum.
- Unplug from electrical outlet when not in use and before any maintenance or cleaning.
- Hand wash with water only. Washing with cleaning chemicals could damage the unit.
- During cleaning or routine maintenance, **DO NOT** cut anything other than hair, fibers, or string wrapped around the brushroll.
- Allow all filters to air-dry completely before replacing in the vacuum to prevent liquid from being drawn into electric parts.
- Make sure the dust cup and all filters are in place after routine maintenance.
- If provided, secure the power cord around the two cord hooks during storage.

SAVE THESE INSTRUCTIONS

WHAT DOES THE BRUSHROLL INDICATOR LIGHT MEAN?

Solid Green

The brushroll is on and working as it should.

Solid Red

Turn off the vacuum and unplug it, then remove any blockages in the nozzle.

Flashing Red

Turn off the vacuum, unplug it, and remove any blockages. Let the vacuum cool down for at least 60 minutes before restarting. See Troubleshooting section for more information.

No Light

The brushroll is off.

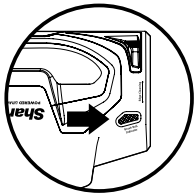

STEP 1

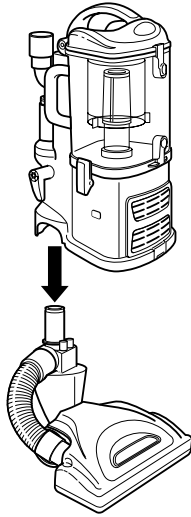

- 1 Place the floor nozzle on a level surface. Align the opening on the Lift-Away® pod with the tube on the floor nozzle, then lower pod until it clicks into place.

When attaching the motorized floor nozzle, ensure that the latching mechanism is fully locked in place to ensure electrical connection has been made.

STEP 2

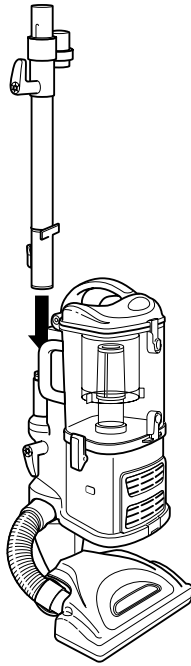

- 2 Insert the extension wand into the tube on the back of the Lift-Away pod, pressing it in until it clicks into place.
- 3 Slide the accessory holder (positioned

STEP 3

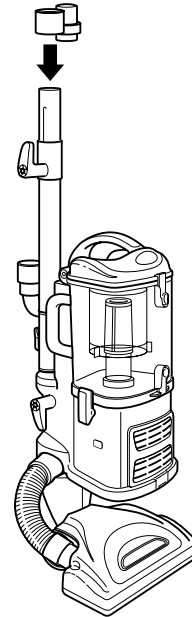

- 4 Insert the handle into the top of the extension wand until it clicks into place.

opposite the upper cord wrap) over the extension wand. Align the tab on the holder with the groove in the wand and slide it down.

STEP 4

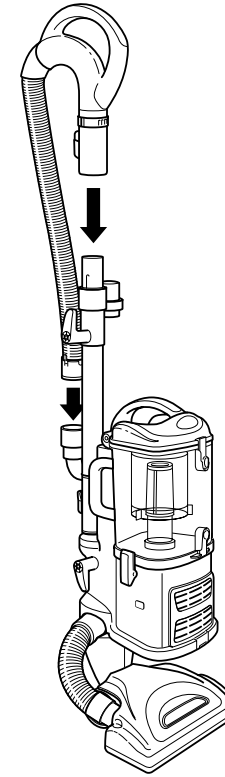

STEP 5

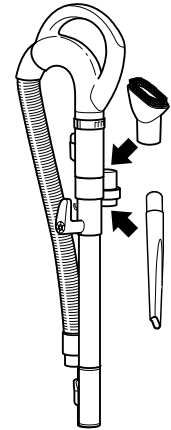

- 5 Store the dusting brush and the crevice tool on the mounts on the accessory holder.

USING YOUR VACUUM IN UPRIGHT MODE

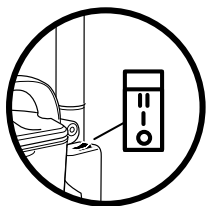

- II Brushroll ON (Carpets & Area Rugs)
- I Suction Only (Bare Floors)
- OFF

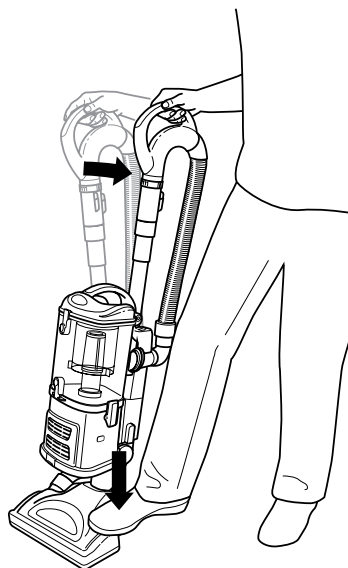

- 1 Quickly release the power cord by rotating the upper cord hook located on the back of the wand.
- 2 Press the On/Off switch to position I (Suction Only) to vacuum bare floors or to the position II to engage the motorized brushroll for vacuuming carpets and rugs.
- 3 Gently step on the floor nozzle and tilt the handle back.

NOTE: The brushroll will not spin unless the nozzle is flat against the floor and the handle is tilted back.
- 4 To turn off the power, press the switch to the ○ position.

AVAILABLE ACCESSORIES

- A 8" Crevice Tool**
Clean in corners and other tight spaces or reach baseboards and ceilings with this slim crevice tool.
- B Dusting Brush**
This brush dusts and cleans delicate surfaces. Great for use on fans, blinds, lampshades, and keyboards.
- C Pet Power Brush**
The turbine brush loosens and removes pet hair and debris from carpets, and powerfully deep-cleans dander out of upholstery and other surfaces.
- D Upholstery Tool**
Picks up hair, dust, and large debris from mattresses, couches, curtains, lampshades, and other delicate upholstered fabrics.
- E Pet Multi-Tool**
A single convertible tool for cleaning tough pet messes two ways: use the stiff bristle brush to clean stuck-on debris, or take off the bristles to reveal an upholstery tool perfect for removing stubborn pet hair and large piles of debris.
- F Duster Crevice Tool**
Two cleaning tools in one. The crevice tool gives you extended reach to clean in tight spaces, while the soft brush is ideal for dusting delicate surfaces.
- G Under-Appliance Wand**
Clean under and behind hard-to-move appliances and furniture with this adjustable 36" tool. Flip the extension piece over to clean the underside of appliances.
- H Anti-Allergen Dust Brush**
This brush features nylon fiber bristles specifically designed for removing fine dust and allergen particles from the most delicate surfaces.
- I Home & Car Detail Kit**
Deep-clean your car like a professional detailer, or clean hard-to-reach areas in your home. Micro-sized tools let you clean around delicate objects and access the tightest spaces like car vents and computer keyboards.
- J Accessory Bag**
This convenient accessory storage bag measures 32 cm x 70 cm and fits the Under-Appliance Wand. Smaller size available at sharkaccessories.com.

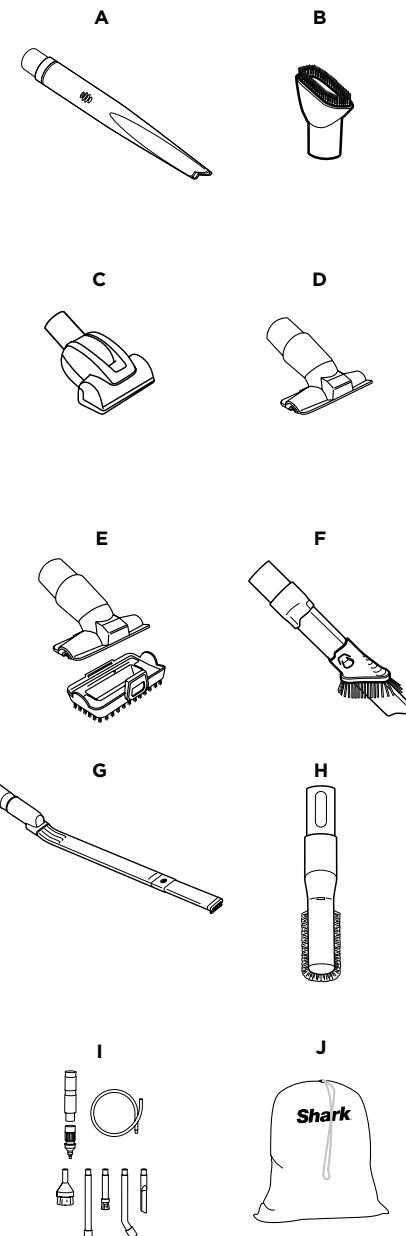

NOTE: Not all accessories come with all units. For a list of the accessories included with this model, see the top inside flap of the box. To order additional accessories, visit sharkaccessories.com.

USING YOUR VACUUM IN LIFT-AWAY® MODE

NOTE: Use the handle on top of the dust cup to lift and carry the vacuum.

SUCTION CONTROL COLLAR

Due to the huge suction power of this vacuum, it may become necessary at times to adjust the suction control collar on the handle. If the vacuum seems difficult to push or pull, if it is lifting up area rugs, or if you are cleaning delicate above-floor surfaces such as drapes, reduce the suction by rotating the collar counterclockwise. Rotate the collar clockwise to increase suction for vacuuming floors and when using the Air-Driven Pet Brush.

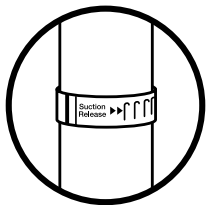

STEP 1

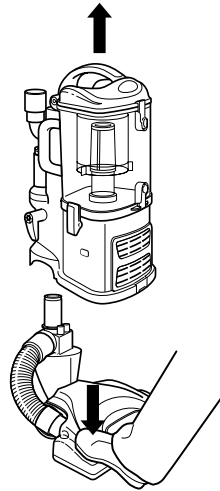

- 1 Detach the portable Lift-Away pod from the floor nozzle by pressing the red release button on the side of the pod. Gently step on the nozzle while lifting off the pod.

- 2 To clean above-floor areas with the handle, detach it from the wand by pressing the Handle Release button.

To clean with a longer reach, detach the extension wand from the pod by pressing the wand release button.

STEP 2

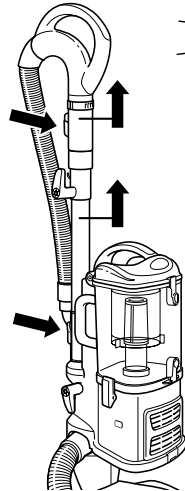

- 3 Accessories to either the extension wand or the handle.

- 4 Press the On/Off switch to the position I for above-floor cleaning.

STEPS 3 + 4

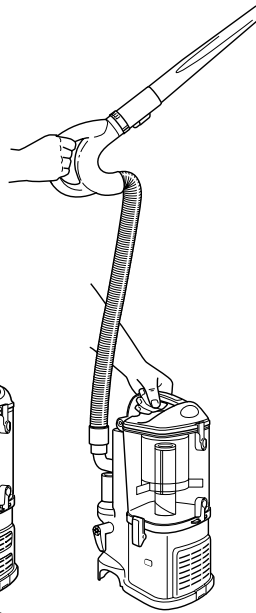

ABOVE-FLOOR CLEANING

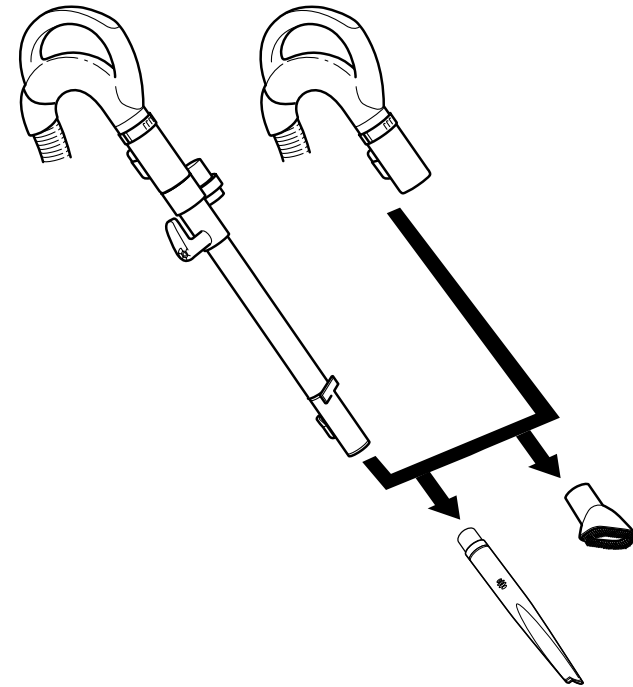

CLEAN ABOVE THE FLOOR IN UPRIGHT VAC OR PORTABLE LIFT-AWAY® MODE

- 1 Press the handle release button to lift the handle out of the wand, or press the wand release button to detach the wand from the pod.
- 2 Attach accessories to either the extension wand or the handle.
- 3 Press the On/Off switch to the position I for above-floor cleaning.

NOTE: Ensure vacuum is in upright position. DO NOT use position II when cleaning above the floor in the upright vac mode as this will engage the brushroll. The brushroll may damage your floor if run for a prolonged period of time in one area.

STORAGE

NOTE: Regularly rinse and replace the filters to maintain your vacuum's suction power.

To prevent damage from cleaning chemicals, rinse filters with cold water only. Allow all filters to air-dry for at least 24 hours before reinstalling them to prevent liquid from being drawn into electric parts.

IMPORTANT: DO NOT use soap when cleaning the filters.

RECOMMENDED CLEANING SCHEDULE:

Dust Cup

Empty after each time you vacuum.

Pre-Motor Filter Kit

XFF350 (Foam & Felt)
Clean every 3 months.

Post-Motor Filter

XHF350 (HEPA)
Clean every 2 years.

- 1 Reattach the pod to the nozzle to return to upright vac mode.
- 2 Rotate the upper cord hook to its upright position and coil the power cord loosely around the upper and lower cord hooks. Clip the plug onto the cord to secure.
- 3 Store the dusting brush and the crevice tool on the mounts on the accessory holder.
- 4 Store your vacuum cleaner safely in a cool, dry area where it will not be a hazard.

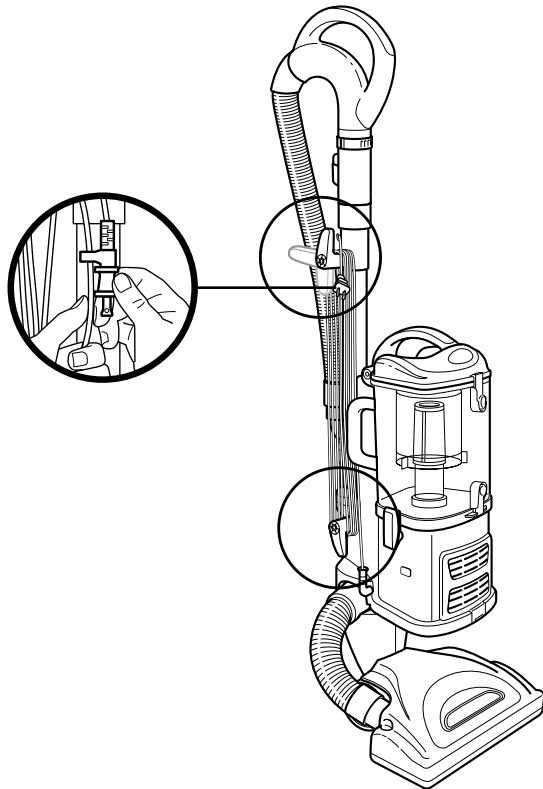

MAINTENANCE

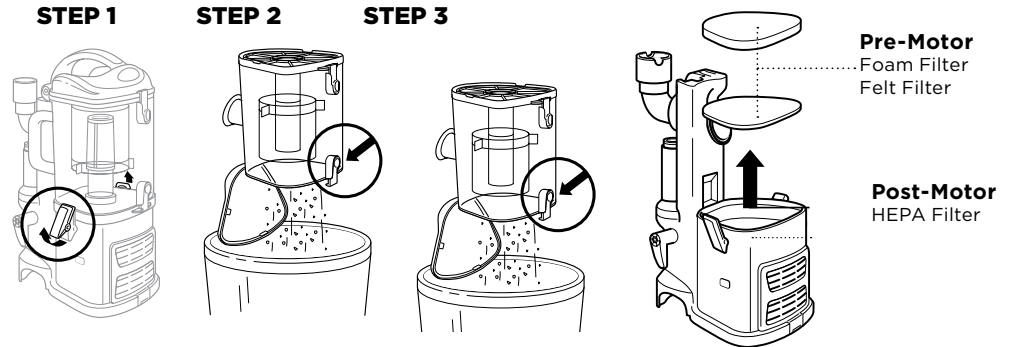

EMPTYING THE DUST CUP

The dust cup needs to be emptied each time you vacuum and periodically during cleaning, when the dust cup appears full.

- 1 To remove the dust cup, lift the latches on the side.
- 2 Hold the dust cup over a trash receptacle and press the bottom-door release button. Tap gently to empty contents. Press the door shut again until it clicks.
- 3 If needed, turn the dust cup upside down over the trash receptacle and press the top-door release button. Tap gently to remove contents.

Use a dry cloth or paper towel to remove debris stuck to the screen inside the dust cup. Press the door shut again until it clicks.

- 4 Replace the dust cup on top of the pod. Hook the two latches onto the tabs on the sides of the dust cup and push down to lock.

CLEANING THE PRE-MOTOR FILTERS

- 1 Remove the dust cup.
- 2 Pull the 2 filters out from the top of the pod.
- 3 Rinse the filters thoroughly in lukewarm water until the water runs clear.
- 4 Squeeze out excess water and let air-dry for at least 24 hours before replacing.
- 5 Place the felt filter in first, then the foam filter.
- 6 Replace the dust cup.

NOTE: DO NOT put the filter in the washing machine or dishwasher.

NOTE: The material in the filter will discolor over time. This is normal, and will not affect the performance of the filter.

⚠ WARNING: To reduce the risk of shock and unintended operation, turn off power and unplug the power cord before performing any maintenance.

NOTE: DO NOT use soap when cleaning the filters. Hand wash filters only with water to prevent damage from cleaning chemicals. Allow ALL filters to air-dry completely before replacing them in the vacuum to prevent liquid from being drawn into electric parts. **DO NOT** use a hair dryer or other heating methods to dry.

STEP 1

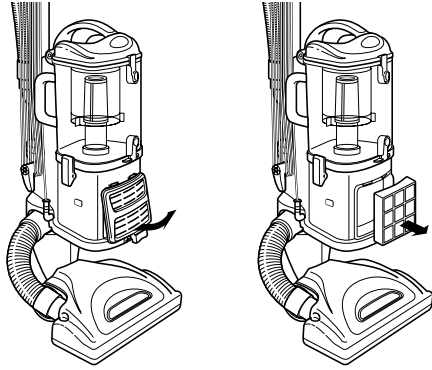

STEP 2



STEP 3

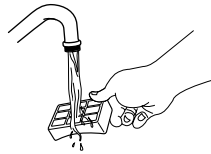

CLEANING THE POST-MOTOR HEPA FILTER

- 1** Remove the filter cover from the front of the vacuum by pulling up on the tab and pulling the cover away from the vacuum. Take out the HEPA filter by pulling it straight out.
- 2** Turn the filter over so that the dirty side is on the bottom and vigorously tap it clean against a garbage can to remove any dust.
- 3** Hold the filter under the tap with the dirty side facing down. Rinse with lukewarm water until the water runs clear. Allow filter to air-dry for 24 hours.
- 4** Once the HEPA filter is dry, reinstall it.
- 5** Replace the cover by inserting the two tabs into the holes at the top and then swinging the cover down until it clicks into place.

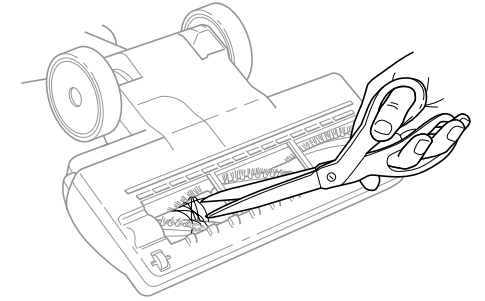
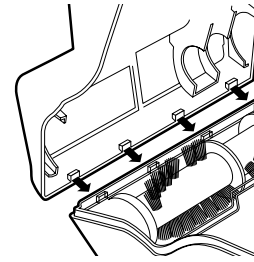

CLEANING THE AIR-DRIVEN PET BRUSH

- 1** Slide the locking latch forward and gently tilt brush housing upward to remove.
- 2** Carefully remove any blockages or debris and use scissors to cut away any buildup of hair or string around the rotating bristle brush.
- 3** To reassemble, insert the tabs on the front edge of the bottom cover into the matching holes in the top half and tilt it back down until it clicks into place.

CLEANING THE MOTORIZED FLOOR NOZZLE

To clean the floor nozzle, first turn off the vacuum and unplug it. Detach the pod from the floor nozzle and remove any blockages. Clear away debris, and remove any fibers or hair wrapped around the brushroll.

Reconnect the nozzle, plug in the vacuum, and turn on the power.

MAINTENANCE



TIP: Make sure you are working in a well-lit area and use a flashlight to help search for blockages.

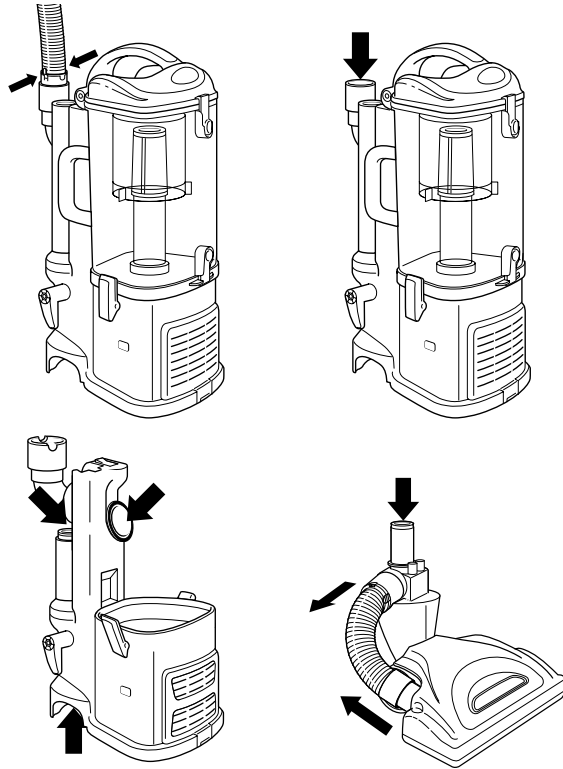

CHECKING FOR BLOCKAGES

Blockages may cause your vacuum to overheat and shut down. To prevent this from happening, check potential blockage areas after heavy use, or if you detect a loss of suction or poor cleaning performance.

- 1 Detach the stretch hose from the back of the portable Lift-Away® pod by squeezing the tabs together and pulling up. Check the hose and pod openings for blockages.
- 2 Remove the dust cup and extension wand and separate the portable Lift-Away pod from the motorized floor nozzle. Check all openings for any blockages.
- 3 Detach the hose on the motorized floor nozzle at the top by squeezing the tabs together and pulling out, and at the bottom by pulling out the connector. Check all openings for any blockages.

TROUBLESHOOTING

⚠ WARNING: To reduce the risk of shock and unintended operation, turn off power and unplug unit before servicing.

Vacuum is not picking up debris. No suction or light suction.
(Refer to Maintenance section for more information.)

- Check the filters to see if they need cleaning. Follow instructions for rinsing and completely air-drying the filters before reinstalling them.
- The dust cup may be full. Empty the dust cup.
- Clear any blockages in the hose, hose connections, nozzle, wand, pod, or accessories. See Checking for Blockages section for more information.
- Remove any string, carpet fibers, or hair that may be wrapped around the brushroll.
- Rotate the suction control collar on the handle clockwise to increase suction power.

Vacuum lifts area rugs.

- Turn off unit to disengage the brushroll. Move switch to position **I** (bare floors) for suction-only cleaning, and turn unit back on.
- Suction is powerful. Take care when vacuuming area rugs or rugs with delicately sewn edges.
- Rotate the suction control collar on the handle counterclockwise to decrease suction power.

Brushroll does not spin.

- If the brushroll indicator light turns red, immediately turn off the vacuum and unplug it. Remove the pod from the floor nozzle and clear any blockages. Reconnect the nozzle, plug in the vacuum, and turn on the power.
- With the power on, recline the handle, which will automatically turn on the brushroll.
- Make sure the On/Off switch is set to position **II**, Brushroll ON.

Vacuum turns off on its own or indicator light flashes red.

- If your vacuum overheats, the thermostat will automatically turn off the motor. Follow these steps to restart:
 1. Turn off the vacuum and unplug it.
 2. Empty the dust cup and clean the filters. See Emptying the Dust Cup and Cleaning and Replacing the Filters sections.
 3. Check for blockages in the (hose, wand, accessories, nozzle, and inlet openings.)
 4. Allow the unit to cool for a minimum of 60 minutes.
 5. Plug in the vacuum and turn it on.

FIVE (5) YEAR LIMITED WARRANTY

REGISTER YOUR PURCHASE

 registryourshark.com

 Scan QR code using mobile device



Benefits of registering your product and creating an account:

- Get easier, faster product support and access to warranty information
- Access troubleshooting and product care instructions
- Be among the first to know about exclusive product promotions

TIP: You can find the model and serial numbers on the QR code label on the bottom of the back of the vacuum pod.

RECORD THIS INFORMATION

Model Number: _____

Serial Number: _____

Date of Purchase: _____
(Keep receipt)

Store of Purchase: _____

TECHNICAL SPECIFICATIONS

Voltage: 120V~ 60Hz

Watts: 1200W

The Five (5) Year Limited Warranty applies to purchases made from authorized retailers of **SharkNinja Operating LLC**. Warranty coverage applies to the original owner and to the original product only and is not transferable.

SharkNinja warrants that the unit shall be free from defects in material and workmanship for a period of five (5) years from the date of purchase when it is used under normal household conditions and maintained according to the requirements outlined in the Owner's Guide, subject to the following conditions and exclusions:

What is covered by this warranty?

1. The original unit and/or non-wearable components deemed defective, in SharkNinja's sole discretion, will be repaired or replaced up to five (5) years from the original purchase date.
2. In the event a replacement unit is issued, the warranty coverage ends six (6) months following the receipt date of the replacement unit or the remainder of the existing warranty, whichever is later. SharkNinja reserves the right to replace the unit with one of equal or greater value.

What is not covered by this warranty?

1. Normal wear and tear of wearable parts (such as foam filters, HEPA filters, pads, etc.), which require regular maintenance and/or replacement to ensure the proper functioning of your unit, are not covered by this warranty. Replacement parts are available for purchase at sharkaccessories.com.
2. Any unit that has been tampered with or used for commercial purposes.
3. Damage caused by misuse (e.g., vacuuming up water or other liquids), abuse, negligent handling, failure to perform required maintenance (e.g., not cleaning the filters), or damage due to mishandling in transit.
4. Consequential and incidental damages.
5. Defects caused by repair persons not authorized by SharkNinja. These defects include damages caused in the process of shipping, altering, or repairing the SharkNinja product (or any of its parts) when the repair is performed by a repair person not authorized by SharkNinja.
6. Products purchased, used, or operated outside North America.

How to get service

If your appliance fails to operate properly while in use under normal household conditions within the warranty period, visit sharkclean.com/support for product care and maintenance self-help. Our Customer Service Specialists are also available at **1-800-798-7398** to assist with product support and warranty service options, including the possibility of upgrading to our VIP warranty service options for select product categories.

SharkNinja will cover the cost for the customer to send in the unit to us for repair or replacement. A fee of \$24.95 (subject to change) will be charged when SharkNinja ships the repaired or replacement unit.

How to initiate a warranty claim

You must call **1-800-798-7398** to initiate a warranty claim. You will need the receipt as proof of purchase. A Customer Service Specialist will provide you with return and packing instruction information.

How state law applies

This warranty gives you specific legal rights, and you also may have other rights that vary from state to state. Some states do not permit the exclusion or limitation of incidental or consequential damages, so the above may not apply to you.

SharkNinja Operating LLC
US: Needham, MA 02494
CAN: Ville St-Laurent, QC H4S 1A7
1-800-798-7398
sharkclean.com

Illustrations may differ from actual product. We are constantly striving to improve our products; therefore the specifications contained herein are subject to change without notice.

LIFT-AWAY, SHARK, and SHARK NAVIGATOR are registered trademarks of SharkNinja Operating LLC.

NAVIGATOR is a trademark of SharkNinja Operating LLC.

For SharkNinja U.S. Patent information visit sharkninja.com/uspatents

