



ITEM #3856481/3856480/5737478

MODEL #42473/42474/43387

OXFORD CEILING FAN

Español p. 23

ATTACH YOUR RECEIPT HERE

HARBOR BREEZE and logo design are trademarks or registered trademarks of LF, LLC. All rights reserved.

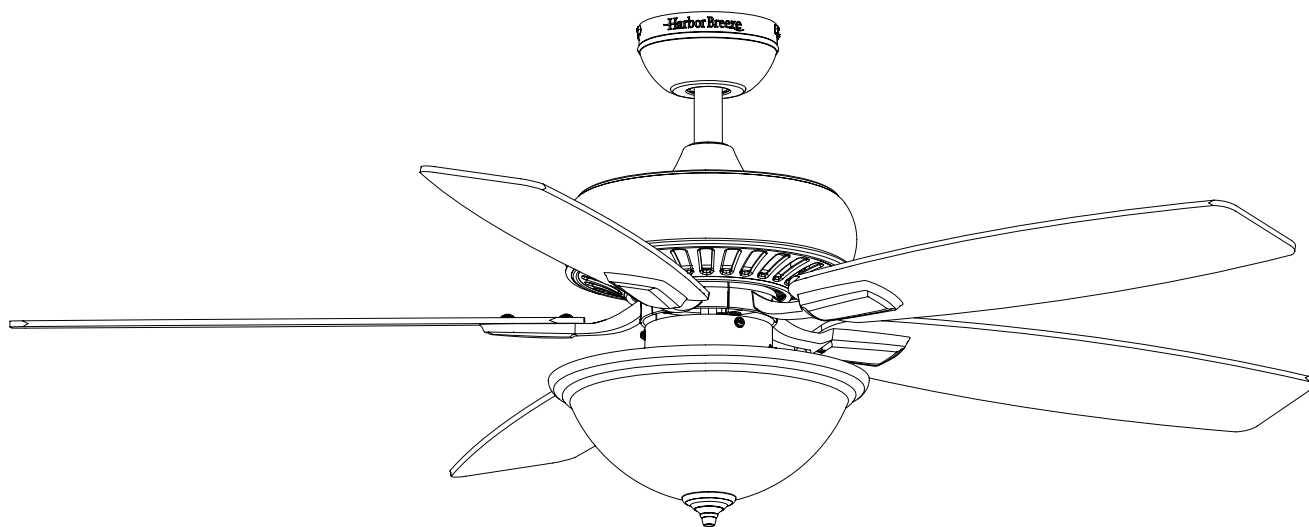

Intertek

Purchase Date _____

Thank you for purchasing this HARBOR BREEZE product.

Questions, problems, or missing parts?

Before returning, contact us at:

888-251-1003, 8 a.m. - 8 p.m., EST, Monday - Sunday or at **ascs@lowes.com**.

TABLE OF CONTENTS

Package Contents 3

Hardware Contents 4

Safety Information 5

Preparation 6

Initial Installation 7

Standard or Angled Mounting Instructions. 9

Wiring 11

Final Installation. 12

Operating Instructions 17

Care and Maintenance 19

Troubleshooting. 19

Limited Lifetime Warranty 21

Replacement Parts List 22

PACKAGE CONTENTS

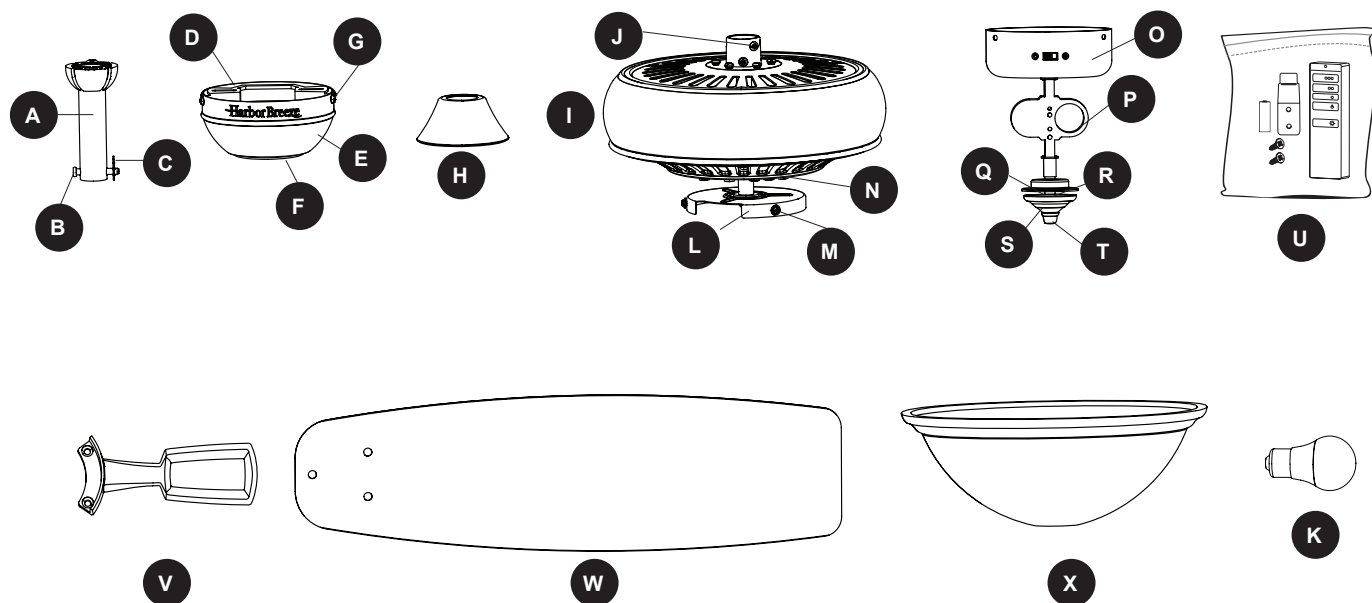

PART	DESCRIPTION	QUANTITY
A	Downrod	1
B	Downrod Pin (preassembled to Downrod [A])	1
C	Downrod Clip (preassembled to Downrod [A])	1
D	Mounting Bracket (preassembled to Canopy [E])	1
E	Canopy	1
F	Canopy Cover (preassembled to Canopy [E])	1
G	Mounting Bracket Screw (preassembled to Mounting Bracket [D])	4
H	Yoke Cover	1
I	Motor Assembly	1
J	Set Screw (preassembled to Motor Assembly [I])	2
K	Bulb	2
L	Fitter Plate (preassembled to Motor Assembly [I])	1
M	Fitter Plate Screw (preassembled to Fitter Plate [L])	3
N	Motor Screw (preassembled to Motor Assembly [I])	10
O	Switch Housing (preassembled to the Light Kit [P])	1
P	Light Kit	1
Q	Hex Nut (preassembled to the Light Kit [P])	1
R	Rubber Washer (preassembled to the Light Kit [P])	1
S	Finial Cap (preassembled to the Light Kit [P])	1
T	Finial (preassembled to the Light Kit [P])	1
U	Remote Pack	1
V	Blade Arm	5
W	Blade	5
X	Glass Bowl	1

HARDWARE CONTENTS (shown actual size)

AA



Wire
Connector
Qty. 3
+ 1 extra

BB



Blade Screw
Qty. 15
+ 1 extra

CC

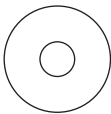

Blade Washer
Qty. 15
+ 1 extra

EE



Plug Button
Qty. 1

XX

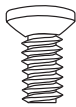

Motor Screw
1 extra



SAFETY INFORMATION

Please read and understand this entire manual before attempting to assemble, operate, or install the product.

- Before you begin installing the fan, disconnect the power by removing fuses or turning off the circuit breakers.
- Make sure that all electrical connections comply with local codes, ordinances, the National Electrical Code, and ANSI/NFPA 70-199. Hire a qualified electrician or consult a do-it-yourself wiring handbook if you are unfamiliar with installing electrical wiring.
- Make sure the installation site you choose allows a minimum clearance of 7 ft. from the blades to the floor and at least 30 in. from the end of the blades to any obstruction.
- The net weight of this fan is: 17.7 lbs.



DANGER: When using an existing outlet box, make sure the outlet box is securely attached to the building structure and can support the full weight of the fan. Failure to do this can result in serious injury or death. The stability of the outlet box is essential in minimizing wobble and noise in the fan after installation is complete.



WARNING: To avoid personal injury, the use of gloves may be necessary while handling fan parts with sharp edges.



WARNING: Using a full-range dimmer switch to control fan speed will cause a loud humming noise from the fan. To reduce the risk of fire or electric shock, do NOT use a full-range dimmer switch to control the fan speed.



WARNING: To reduce the risk of fire, electric shock, or personal injury, mount the fan to an outlet box marked “ACCEPTABLE FOR FAN SUPPORT” and use the mounting screws provided with the outlet box. Most outlet boxes commonly used for the support of lighting fixtures are not acceptable for fan support and may need to be replaced. Consult a qualified electrician if in doubt. Secure the outlet box directly to the building structure. The outlet box and its support must be able to support the moving weight of the fan (at least 35 lbs.).



WARNING: To reduce the risk of fire, electrical shock, or personal injury, wire connectors provided with this fan are designed to accept only one 12 gauge house wire and two lead wires from the fan. If your house wire is larger than 12-gauge or there is more than one house wire to connect to the two fan lead wires, consult an electrician for the proper size wire connectors to use.



WARNING: To reduce the risk of fire, electric shock, or personal injury, do not bend the blade arms when installing them, balancing the blades, or cleaning the fan. Do not insert objects between the rotating fan blades.



WARNING: To reduce the risk of personal injury, use only parts provided with this fan. The use of parts OTHER than those provided with this fan will void the warranty.



SAFETY INFORMATION

CAUTION: Read all instructions and safety information before installing your new fan. Review the accompanying assembly diagrams.

CAUTION: Be sure the outlet box is properly grounded or that a ground (green or bare) wire is present.

CAUTION: Carefully check all screws, bolts and nuts on the fan motor assembly to ensure they are secured.

CAUTION: This device complies with part 15 of the FCC Rules. Operation is subject to the following two conditions: (1) This device may not cause harmful interference, and (2) this device must accept any interference received, including interference that may cause undesired operation.

CAUTION: This equipment has been tested and found to comply with the limits for a Class B digital device, pursuant to Part 15 of the FCC Rules. These limits are designed to provide reasonable protection against harmful interference in a residential installation. This equipment generates, uses and can radiate radio frequency energy and, if not installed and used in accordance with the instructions, may cause harmful interference to radio communications. However, there is no guarantee that interference will not occur in a particular installation. If this equipment does cause harmful interference to radio or television reception, which can be determined by turning the equipment off and on, the user is encouraged to try to correct the interference by one or more of the following measures:

--Reorient or relocate the receiving antenna.

--Increase the separation between the equipment and receiver.

--Connect the equipment into an outlet on a circuit different from that to which the receiver is connected.

--Consult the dealer or an experienced radio/TV technician for help. Please note changes or modifications not expressly approved by the party responsible for compliance could void the user's authority to operate the equipment.

HKC-US
3350 Players Club Parkway, Suite 225
Memphis, TN 38125
1-888-251-1003

PREPARATION

Before beginning the assembly of this product, ensure that all parts are present. Compare all parts with the package contents list and hardware contents list. If any part is missing or damaged, do not attempt to assemble the product.

Estimated Assembly Time: 120 minutes

Tools Required for Assembly (not included): Electrical Tape, Phillips Screwdriver, Pliers, Safety Glasses, Step Ladder and Wire Strippers

Helpful Tools (not included): AC Tester Light, Tape Measure, Wiring Handbook and Wire Cutters

INITIAL INSTALLATION

1. Turn off the circuit breakers and the wall switch to the fan supply line leads.

⚠ DANGER: Failure to disconnect the power supply prior to installation may result in serious injury or death.

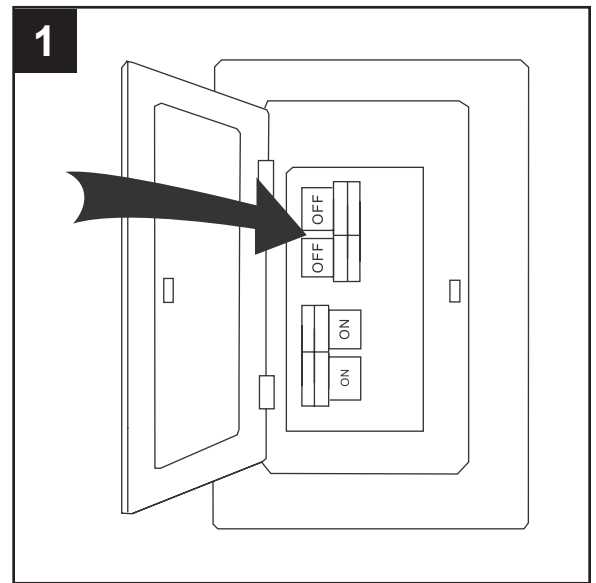

2. Determine the mounting method to use.

Standard Mounting is best suited for ceilings 8 ft. or higher. For taller ceilings you may want to use a longer downrod (sold separately).

Angle mounting is best suited for angled or vaulted ceilings. A longer downrod is sometimes necessary to ensure proper blade clearance. **Important:** If using the angle mount, check to ensure the ceiling angle is not steeper than 16°.

Flushmount installation is not available for this item.

Closemount installation is not available for this item.

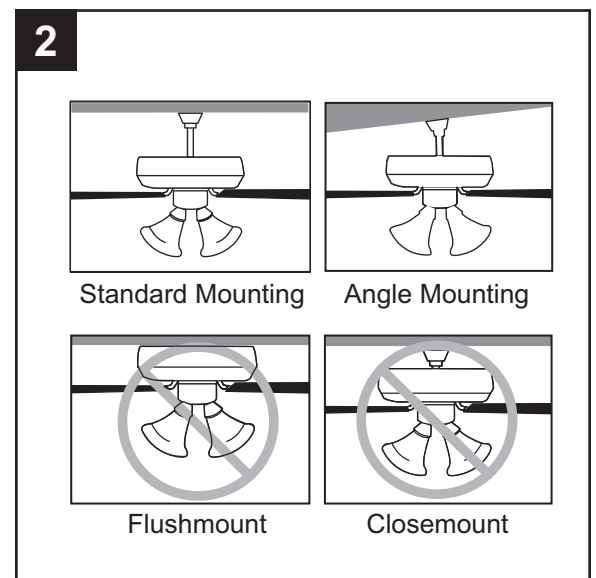

3. Ensure that the blades (W) will be at least 30 in. from any obstructions. Also check the downrod (A) length to ensure the blades (W) will be at least 7 ft. above the floor.

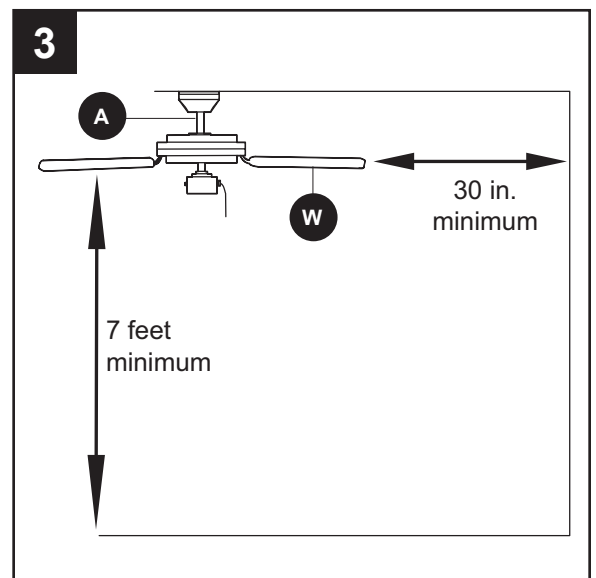

INITIAL INSTALLATION

- Loosen all four mounting bracket screws (G), then completely remove the two mounting bracket screws (G) from the round holes of canopy (E). Set aside for later use.

Detach mounting bracket (D) from canopy (E).

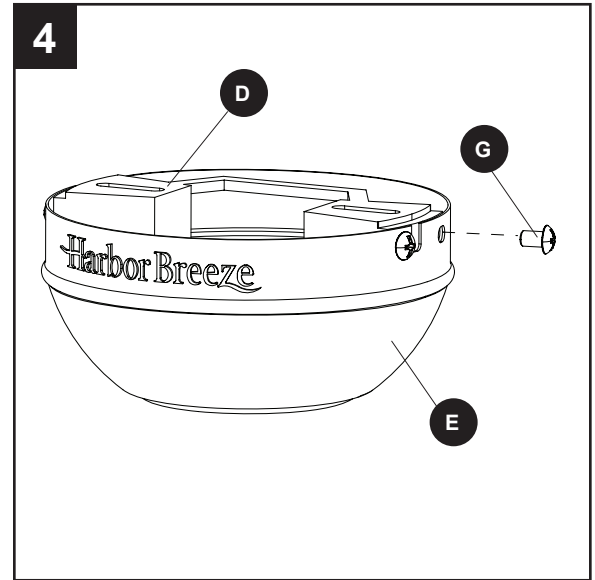

- Attach mounting bracket (D) to outlet box (not included) using screws and washers provided with the outlet box.

CAUTION: It is very important you use the proper hardware when installing the mounting bracket (D) as it will support the fan.

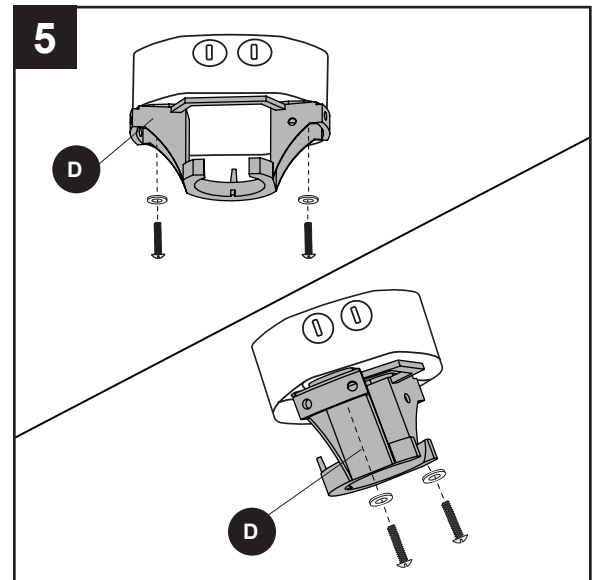

- Remove the 10 preassembled motor screws (N) and five preassembled motor blocks from the underside of the motor assembly (I). Discard the motor blocks but save the motor screws (N) for later.

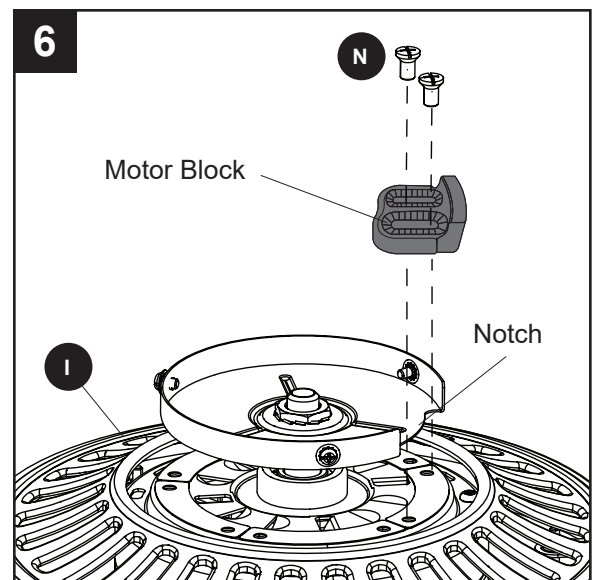

STANDARD OR ANGLED MOUNTING INSTRUCTIONS

1. Remove the downrod clip (C) and downrod pin (B) from the downrod (A). Then partially loosen the set screws (J) in the yoke at the top of the motor assembly (I).

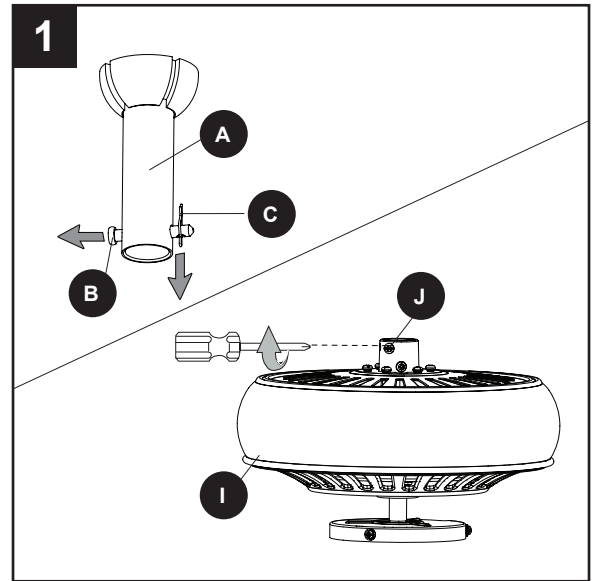

2. Insert the downrod (A) through the canopy (E) and yoke cover (H). Feed the wires from the motor assembly (I) through the downrod (A).

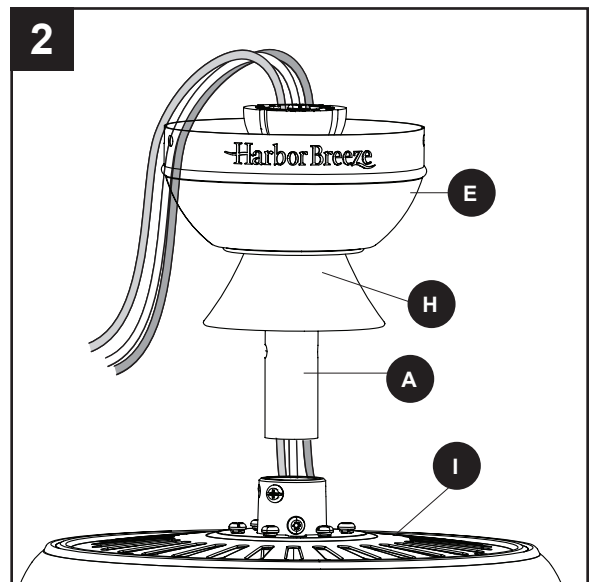

3. Slide the downrod (A) into the yoke of the motor assembly (I), align the holes, then re-install the downrod pin (B) and downrod clip (C). Secure with set screws (J) and slide the yoke cover (H) down until it rests on top of the motor assembly (I).

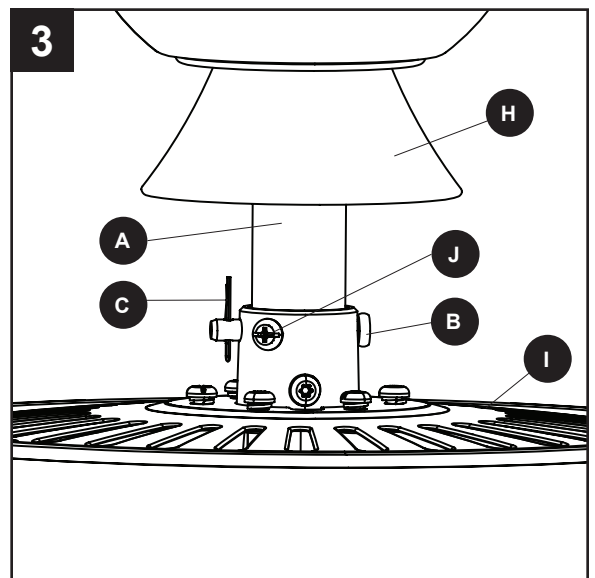

STANDARD OR ANGLED MOUNTING INSTRUCTIONS

4. Depending on the length of downrod you use, you may need to cut the lead wires back to simplify the wiring. If you decide to cut back the lead wires, it is suggested that you do so in the following manner: Take the lead wires and make sure that you have pulled them all the way through the top of the downrod and measure 8 in. of lead wire, and then cut the excess wire off with wire cutters (not included).

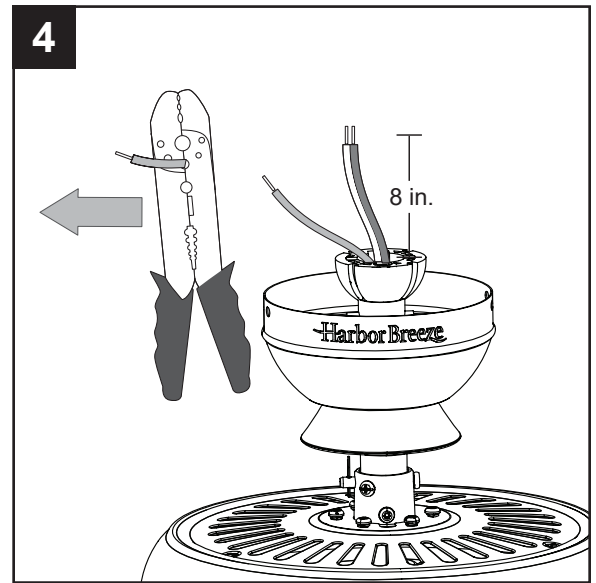

5. If you decided to cut back the lead wire in Step 4, strip 1/2 in. of insulation from the end of the white wire. Twist the stripped ends of each strand of wire within the insulation with pliers (not included). Repeat this step for black wire.

Important: If you did not cut back the lead wires in Step 4, Step 5 is not necessary and you may proceed to Step 6.

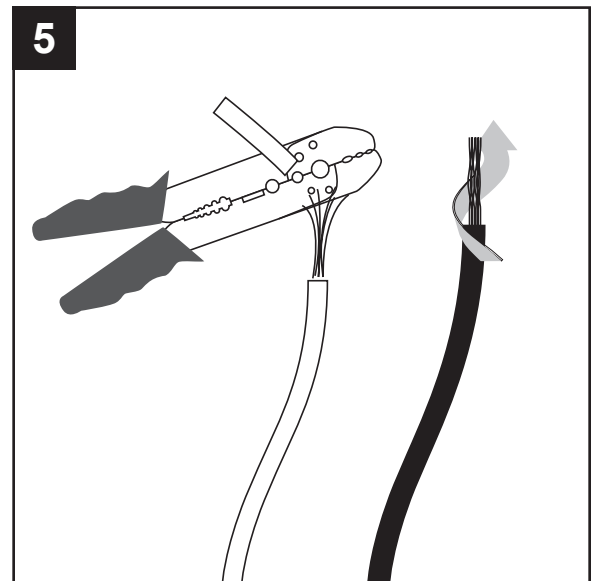

6. Install the ball end of the downrod (A) into the opening of mounting bracket (D). Align one of the four slots in the downrod (A) with the tab in the mounting bracket (D).

Note: The downrod (A) should not rotate if installed correctly.

! DANGER: Failure to align the slot in the downrod (A) with the tab of the mounting bracket (D) could cause the fan to fall, resulting in serious injury or death. Proceed to the **Wiring** on page 11.

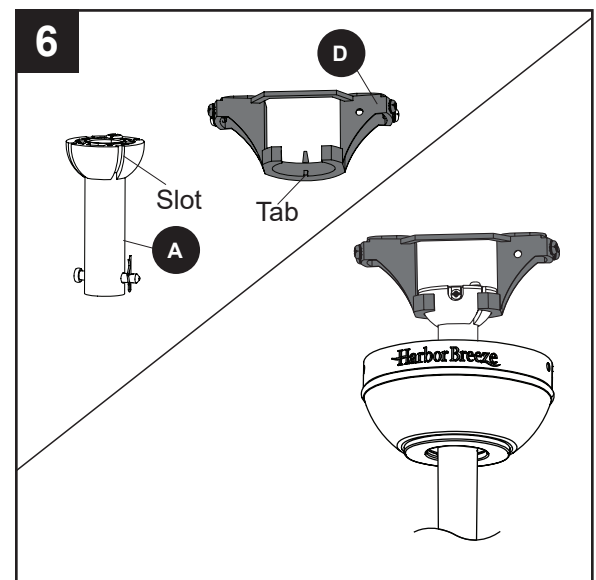

WIRING

⚠ WARNING: To reduce the risk of fire, electrical shock or personal injury, wire connectors provided with this fan are designed to accept only one 12-gauge house wire and two lead wires from the fan. If your house wire is larger than 12-gauge and there is more than one house wire to connect to the two fan lead wires, consult an electrician for the proper size wire connectors to use. **CAUTION:** Be sure the outlet box is properly grounded or that a ground (green or bare) wire is present.

1. Connect supply and fan wires according to the diagram and these steps:

- Connect the Green wires from the downrod (A) and the mounting bracket (D) to the Bare/Green (ground) supply wire.
- Connect the White wire from the fan to the White (neutral) supply wire.
- Connect the Black wire from the fan to the Black (hot) supply wire.
- Secure all wiring connections together with wire connectors (AA).

Note: The Black wire is power for the fan. The White wire is neutral. The Green wire is the ground wire. If household supply wires are different colors than referred to above, it is recommended a professional electrician determines the proper wiring.

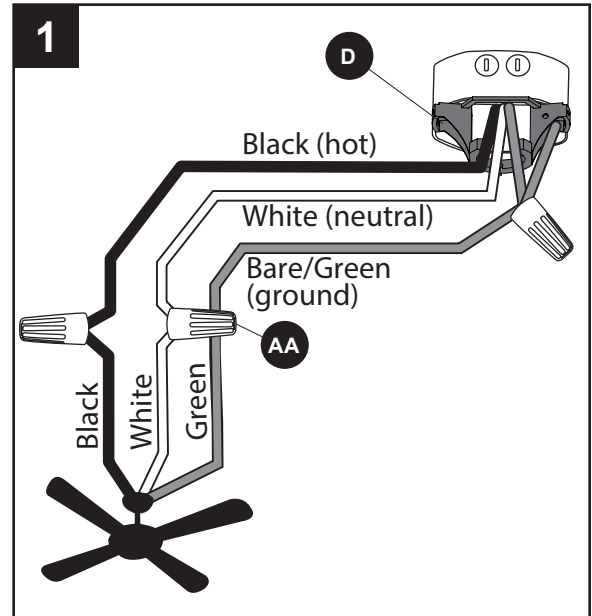

Hardware Used



Wire Connector



x 3

2. Wrap electrical tape (not included) around each individual wire connector (AA) down to the wire.

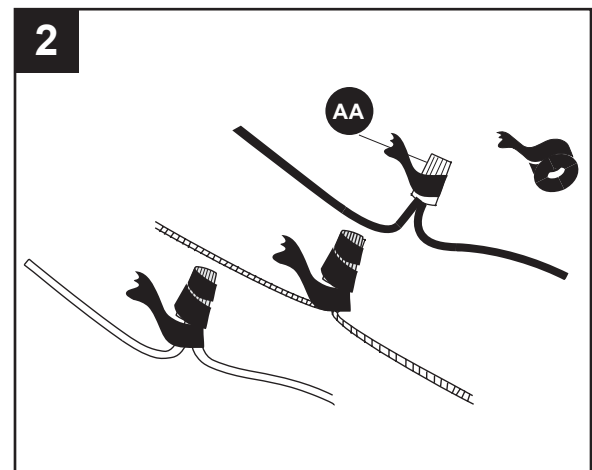

3. Turn the spliced/taped wires upward and gently push the wires and wire connectors into the outlet box.

⚠ WARNING: Ensure no bare wire strands are visible after making connections. Place Green and White wire connections on opposite sides of outlet box from the Black wire connections.

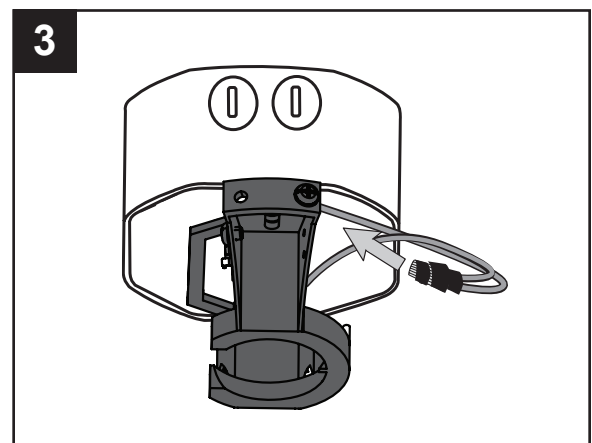

FINAL INSTALLATION

1. Align the canopy (E) over the loosened mounting bracket screws (G) preassembled on mounting bracket (D). Place the keyholes of the canopy (E) onto the mounting bracket screws (G) and rotate the canopy (E) clockwise.

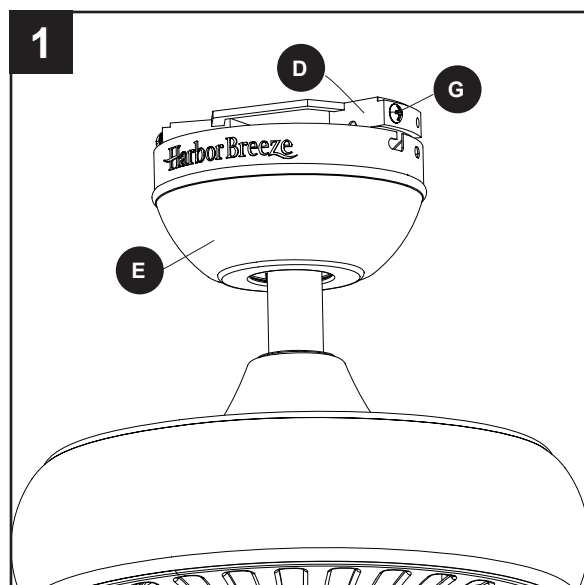

2. Secure the canopy (E) with the mounting bracket screws (G) previously removed (Step 4, page 8). Tighten all mounting bracket screws (G) securely.

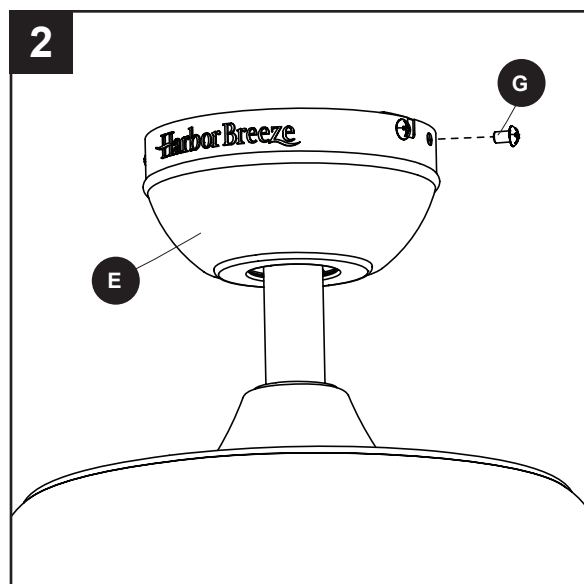

FINAL INSTALLATION

- Partially insert three blade screws (BB) along with three blade washers (CC) through one blade (W) and into one blade arm (V). Tighten each blade screw (BB) with a Phillips screwdriver (not included), starting with the one in the middle. Repeat this step for the remaining blades (W) and blade arms (V).

Hardware Used

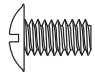
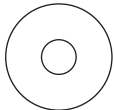
BB	Blade Screw		x 15
CC	Blade Washer		x 15

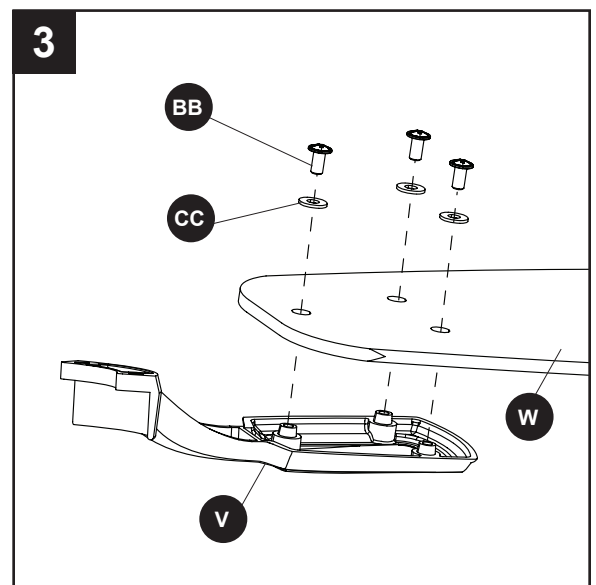

- Install the blade arm (V) to the underside of the motor assembly (I) with motor screws (N) previously removed (Step 6, page 8). Tighten with Phillips screwdriver (not included).

Repeat for each blade arm (V).

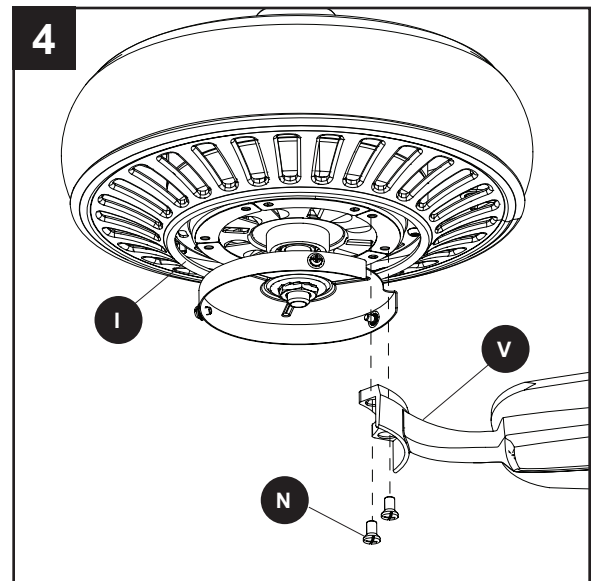

- Remove the fitter plate screws (M) preassembled to the fitter plate (L). Then, connect the 6-pin connectors from the fitter plate (L) and the light kit (P).

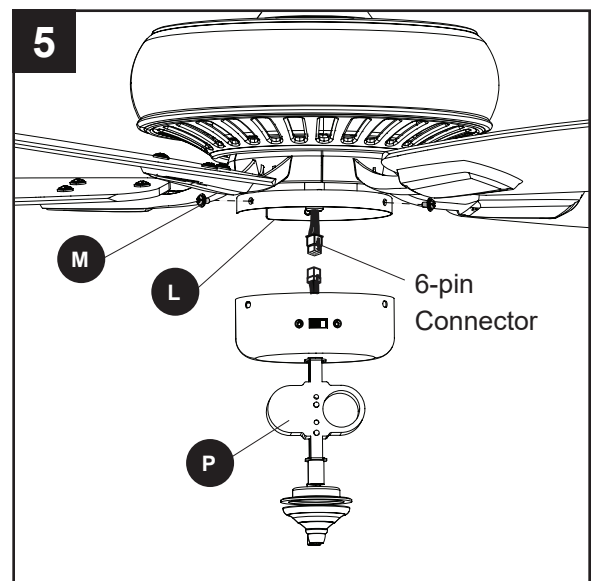

FINAL INSTALLATION

- Secure the switch housing (O) along with light kit (P) to the fitter plate (L) using the previously removed fitter plate screws (M).

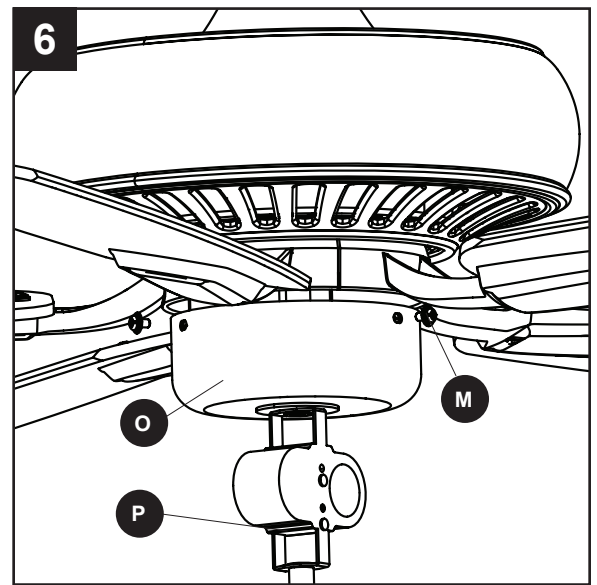

- Install bulbs (K) into the sockets of the light kit (P).
Important: Make sure to allow the bulbs (K) and light kit (P) to cool before you replace the bulbs.

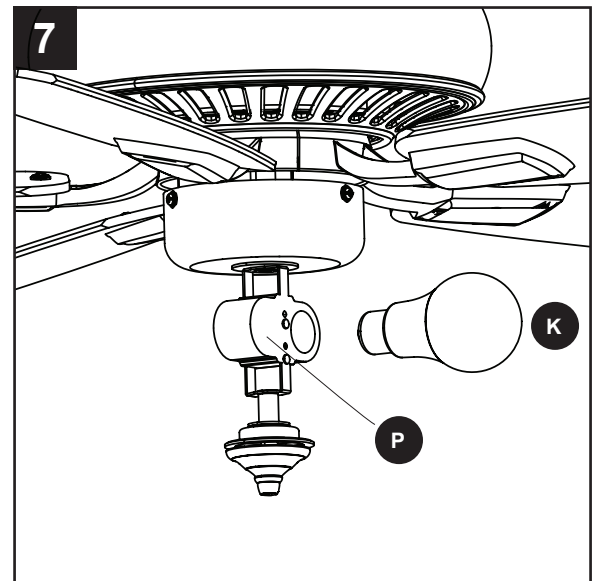

- Remove the preassembled finial (T), finial cap (S), hex nut (Q) and rubber washer (R) from the light kit (P). Lift the glass bowl (X) onto the threaded rod at the bottom of the light kit (P).

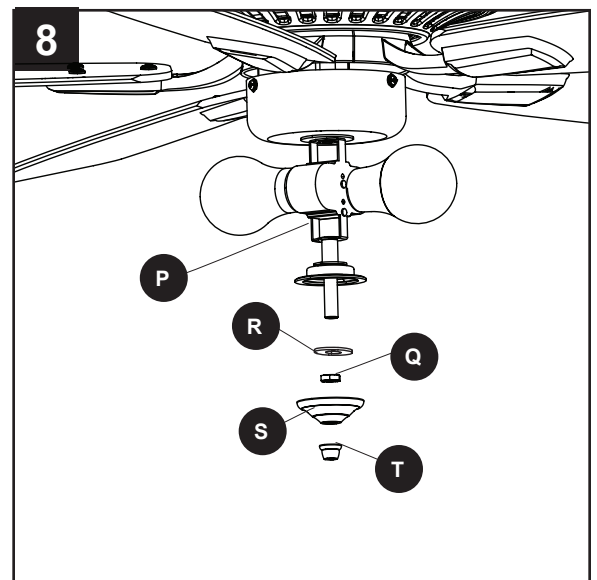

FINAL INSTALLATION

9. Secure glass bowl (X) with rubber washer (R) and hex nut (Q). Then attach finial cap (S) and finial (T).

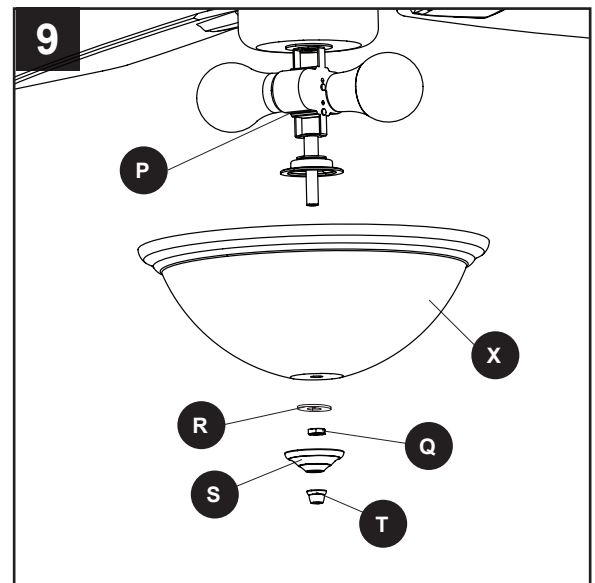

10. To install the fan without the light kit (P), remove the hex nut and lock washer from the rod on the inside of the switch housing cap (O). Remove light kit (P) from the switch housing cap (O) and discard, then install the plug button (EE) into the center hole of the switch housing cap (O).

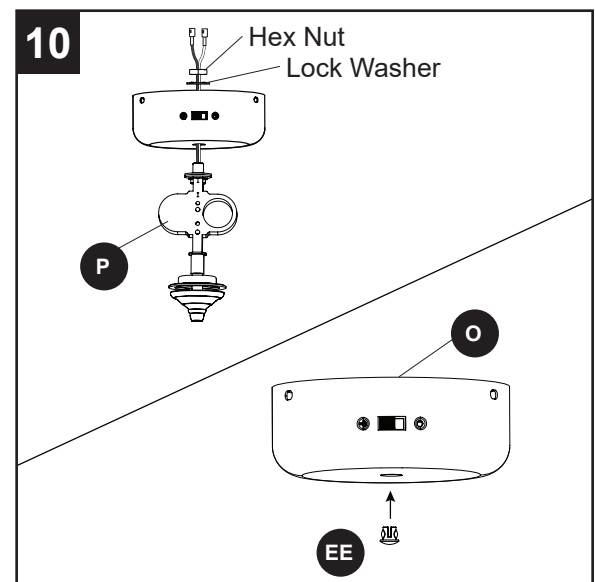

Hardware Used

- EE** Plug Button  x 1

11. Remove the three fitter plate screws (M) from the fitter plate (L). Connect the 6-pin connectors from the fitter plate (L) and the light kit (P). Then, attach the switch housing (O) to the fitter plate (L) using the fitter plate screws (M).

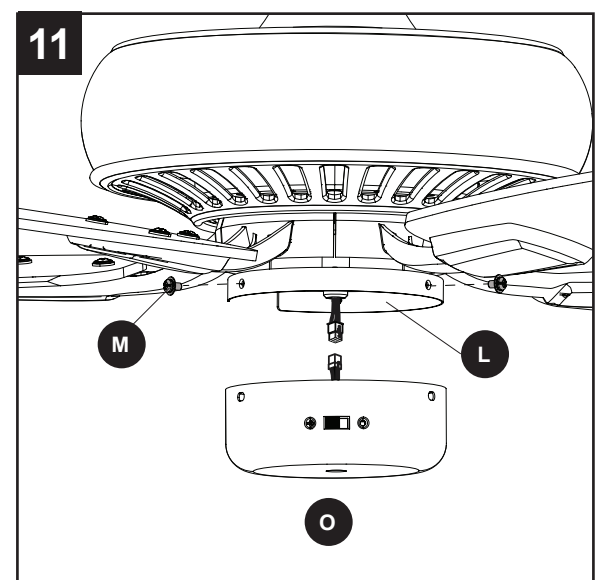

FINAL INSTALLATION

12. If you wish to install the wall bracket from remote pack (U), choose desired location and insert screws from remote pack (U) into holes of wall bracket and into installation site. Store the remote from remote pack (U) on the wall bracket by placing the slot on the back of the remote onto the wall bracket.

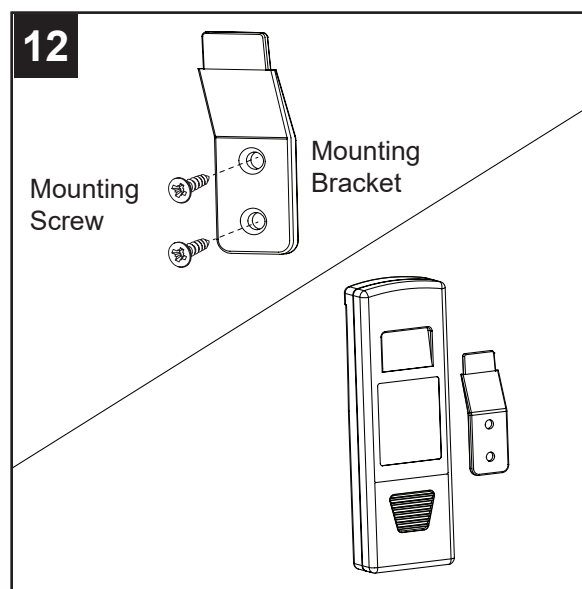

13. Turn on power supply to the fan.

Assembly is complete.

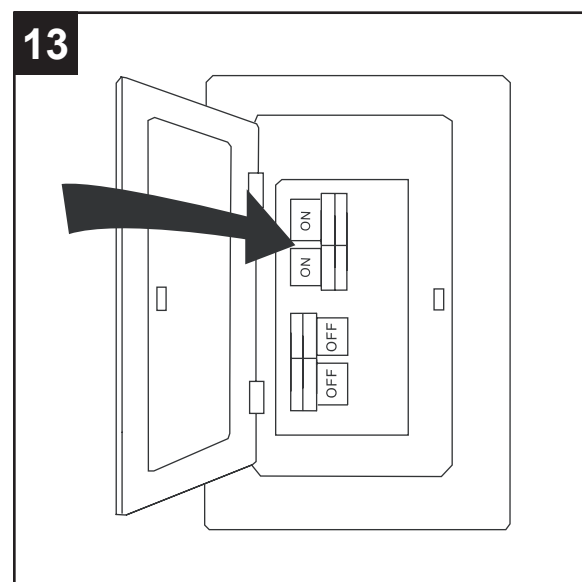

OPERATING INSTRUCTIONS

1. Remove the battery cover from the back of the remote found in remote pack (U). Insert the battery from remote pack (U) into the remote; ensuring the polarity of the battery matches the polarity indicated in the battery compartment -- positive (+) to positive (+) and negative (-) to negative (-). Replace the battery cover and press the fan power button on the remote to ensure the LED indicator illuminates and the remote turns on the fan.

Note: If remote doesn't turn on the fan, see TROUBLESHOOTING (page 20).

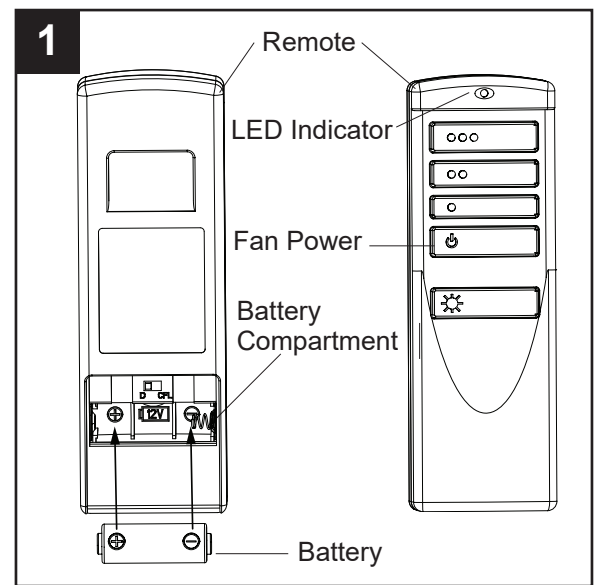

2. To operate the fan using the remote, press and release the following buttons:

- 1 - High fan speed
- 2 - Medium fan speed
- 3 - Low fan speed
- 4 - Fan Power - Turns the fan off.

Light Delay Off mode - Press and hold the fan power button (4) for five seconds, which will turn off light after one minute.

- 5 - Light Control: Tap light control button to turn the light off and on. Press and hold light control button to dim or brighten the lights.
- 6 - D/CFL Switch - set to "D" at the factory. The switch should remain in the "D" position to ensure the LED bulb is dimmable.

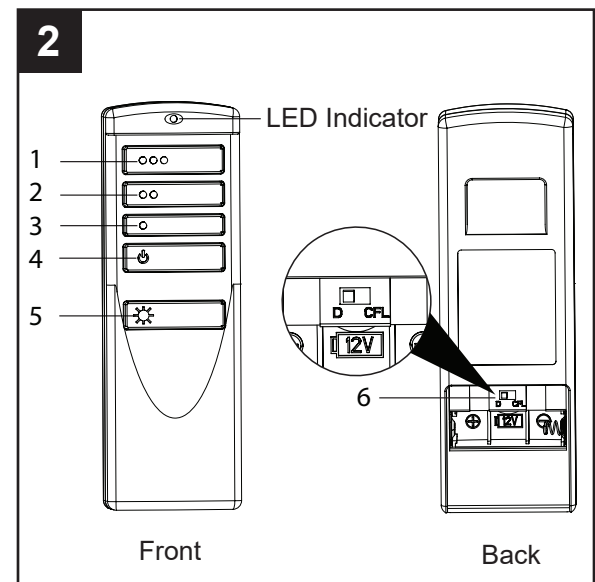

OPERATING INSTRUCTIONS

3. Using a ceiling fan will allow you to raise your thermostat setting in summer and lower your thermostat setting in winter without feeling a difference in your comfort.

In warmer weather, push the reverse switch left to display a sun icon, which will result in downward airflow creating a wind chill effect (Fig. 3a).

In cooler weather, push the reverse switch right to display a snowflake icon, which will result in upward airflow that can help move hot air off the ceiling area (Fig. 3b).

Important: The reverse switch must be set either completely left or right for the fan to function correctly. If the reverse switch is set in the middle position, the fan will not operate (Fig. 3c).

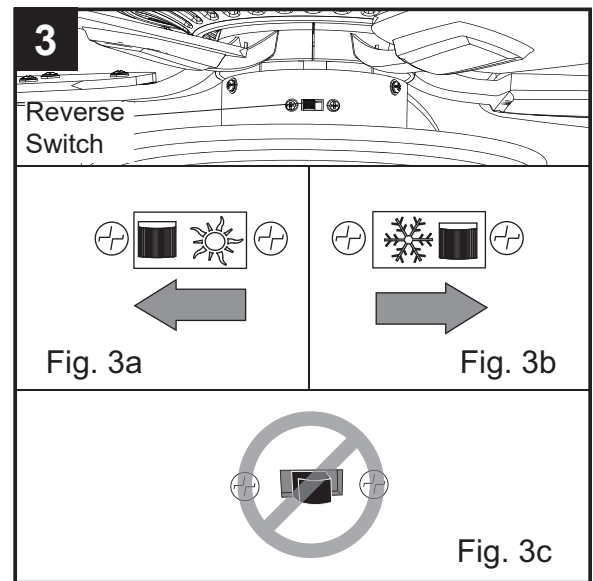

CARE AND MAINTENANCE

At least twice each year, lower the canopy to check the downrod assembly, and then tighten all screws on the fan. Clean the motor housing with only a soft brush or lint-free cloth to avoid scratching the finish. Clean the blades with a lint-free cloth.

Bulb Replacement: Use 60-watt max. E26-base LED, CFL or incandescent bulbs. Halogen bulbs are not recommended for this item.

Battery Replacement for Remote: Use an A23, 12-volt alkaline battery. Exhausted batteries should be removed from remote. Non-rechargeable batteries should not be recharged. Do not dispose of batteries in fire, as they may explode or leak.

Important: Shut off the main power supply before you begin any maintenance task. Do not use water or a damp cloth to clean the fan.

TROUBLESHOOTING

PROBLEM	POSSIBLE CAUSE	CORRECTIVE ACTION
The fan does not move.	<ol style="list-style-type: none">1. The reverse switch is not engaged.2. The wall switch is turned off.3. The power is off or the fuse (breaker) is blown.4. There is a faulty wire connection.	<ol style="list-style-type: none">1. Firmly push the reverse switch to either the left or right.2. Make sure the wall switch is turned on.3. Turn the power on or check the fuse (breaker).4. Turn the power off and check all connections at the ceiling outlet box.
The fan is noisy.	<ol style="list-style-type: none">1. The blades are loose.2. There is a cracked blade.3. The wall control is not compatible with the fan.4. The outlet box is not secure.5. The mounting bracket is not secure.	<ol style="list-style-type: none">1. Check and tighten all screws that hold the fan blades to the blade arms and the motor.2. Replace the cracked blade.3. Do not use a full range dimmer switch to control the fan speed.4. Ensure the outlet box is secured to the building structure.5. Ensure the mounting bracket is secured to the outlet box and that the screws are tight.

TROUBLESHOOTING

PROBLEM	POSSIBLE CAUSE	CORRECTIVE ACTION
There is excessive wobbling.	<ol style="list-style-type: none"> 1. The blades and/or blade are loose. 2. The blades are unbalanced. 3. The fan mounting is not secure. 4. The fan is too close to the vaulted ceiling. 5. The set screw on the motor housing yoke is loose. 	<ol style="list-style-type: none"> 1. Check and tighten all screws that hold the fan blades to the blade arms and the blade arms to the motor. 2. Switch one blade with a blade from the opposite side. Or balance the fan using a blade balancing kit (sold separately). 3. Turn off the power. Loosen the canopy and verify that the mounting bracket is secure to the electrical outlet box. The bracket must be flush without movement against the outlet box. 4. Use a longer downrod (sold separately) or move the fan to another location. 5. Lift up the yoke cover and tighten the set screw to the yoke until secure.
The fan operates correctly, but the lights are not working (if applicable).	<ol style="list-style-type: none"> 1. The bulb(s) not installed correctly. 2. The light kit wire plugs are not connected properly. 3. There is a faulty wire connection. 	<ol style="list-style-type: none"> 1. Re-install the bulb(s). 2. Ensure that the 6-pin connectors in the light kit fitter are connected properly. 3. Turn the power off and check all connections at the ceiling outlet box.
Remote control does not work.	<ol style="list-style-type: none"> 1. Power surge may have cleared memory and remote needs to be re-synced to the receiver. 2. Battery in remote control needs to be replaced. 3. Interference from another remote. 	<ol style="list-style-type: none"> 1. Turn off the main power, then turn it back on. Within 30 seconds, press and hold the high and low speed buttons on the remote at the same time for 5 seconds. The LED indicator will flash 3 times, signaling a successful synchronization. Once complete, the fan will start on the low speed with the light (if applicable) off. 2. Insert new 12V battery in battery compartment of the remote control (see page 17). 3. If there are several fans in proximity, turn power off to other fans and re-sync the remote (see Corrective Action 1 above).

LIMITED LIFETIME WARRANTY

Set forth below, the manufacturer warrants the fan motor for this ceiling fan to be free from defects in workmanship and material for the life of the product. Also, subject to the limitations below, the manufacturer warrants all ceiling fan parts ("ceiling fan parts" excludes the motor and parts made in whole or in part with glass) to be free from defects in workmanship and material for a period of one year after the date of purchase by the original purchaser at retail.

All claims must be made by the original purchaser from an authorized dealer, whether such purchaser purchased the product through a store or contractor. Ceiling fan part defects must be reported within the first year from the date of purchase. Parts made in whole or in part with glass and the finishes of metal and other surfaces are not warranted.

Purchasers are responsible for all costs of removing and reinstalling the product. Any damage to any part caused by ordinary wear and tear, accident, misuse, or improper installation, is not covered by this warranty. The manufacturer assumes no responsibility whatsoever for fan installation. Any service performed by a non-licensed electrician will render the warranty invalid.

The manufacturer's sole responsibility shall be to repair or replace the motor, parts, or product within the terms stated above. The manufacturer shall not be liable for any loss or damage of any kind, including any incidental or consequential damages resulting directly or indirectly, from any breach of warranty, express or implied, or any other failure of this product. Some states do not allow the exclusion or limitation of incidental or consequential damages so this limitation may not apply to you.

If the original purchaser ceases to own the fan, this warranty is voided.

Should the purchaser encounter a problem with your fan related to defects in workmanship or materials within the warranty period associated with the defective part, the manufacturer agrees to replace the defective part without charge, or at its option, to replace the ceiling fan with a comparable or superior model.

The manufacturer's warranties are limited to the written warranties set out in this ceiling fan limited lifetime warranty. All other express and implied warranties, including, without limitation, the implied warranty of fitness for a particular purpose and the implied warranty of merchantability is disclaimed. Some states do not allow the disclaimer of implied warranties, so this disclaimer may not apply to you.

REPLACEMENT PARTS LIST

For replacement parts, call the customer service department at **888-251-1003**, 8 a.m. - 8 p.m., EST, Monday - Sunday. You could also contact us at **ascs@lowes.com**.

PART	DESCRIPTION	#3856481	#3856480	#5737478	COVERED UNDER WARRANTY
A	Downrod	4L000005220	4L000015470	4L000018960	YES - 1 YEAR
D	Mounting Bracket	4L000006410	4L000006350	4L000006350	YES - 1 YEAR
E	Canopy	4L000002220	4L000008280	4L000016090	YES - 1 YEAR
F	Canopy Cover	4L000000830	4L000008290	4L000010400	YES - 1 YEAR
H	Yoke Cover	4A000005540	4A000003540	4A000009350	YES - 1 YEAR
P	Light Kit	4L000015420	4L000015430	4L000018950	YES - 1 YEAR
U	Remote Pack	4L000015440	4L000015440	4L000015440	YES - 1 YEAR
X	Glass Bowl	4A166210001	4A166210001	4A166210001	NO
V	Blade Arm (x5)	4L073720004	4L073720001	4L073720003	YES - 1 YEAR
W	Blade (x5)	4L086160001	4L086160002	4L086160003	YES - 1 YEAR
HW	Hardware Kit	4L000015460	4L000015450	4L000018970	NO

