

Closet Rod Pulldown System

an *SefaCo.* Store
1-877-275-9111

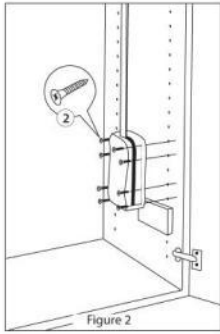

Figure 2

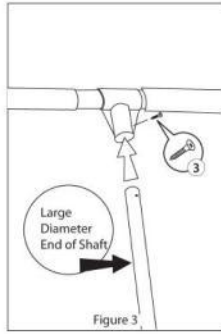

Figure 3

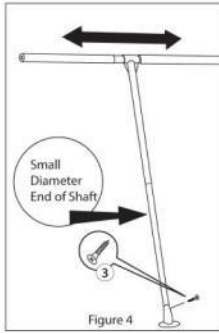

Figure 4

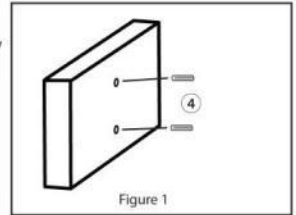

Figure 1

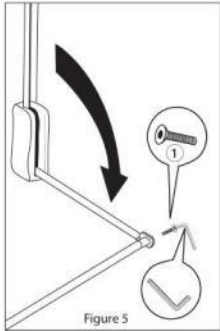

Figure 5

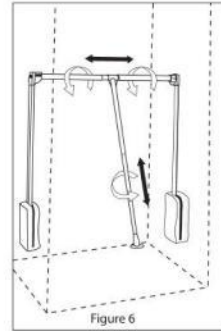

Figure 6



Items in this box:

1. Insert the wooden dowels into the wooden positioner block.
2. Insert the positioner into the system holes at the desired height, immediately below where the Pulldown Mechanism is to be placed. Arm of Mechanism should be mounted no closer than 11" to the back of the cabinet.
3. Using the wooden guide for height, place the right side mechanism into position and insert a minimum of 8 screws (2), for best results use 12 screws (2) See Figure 2.
4. Repeat with Left Side.
5. Assemble hanging pole by using screw (3) as shown in Figure 3.
6. Attach handle using provided screw (3), as shown in Figure 4.
7. Pull down the arm of the unit and place the plastic bracket on the end of both arms. Insert the telescopic hanging rod into one side and secure with hex head bolt (1), see Figure 5. Twist as shown in Figure 6 to adjust hanging rod, attach the other side in the same manner
8. Twist as shown in Figure 6 to adjust the length of the handle.