



ZIPPITY

Easy Does It!

PORTABLE PUPPY FENCE KIT 2-PACK (22"H X 44"W)

ASSEMBLY INSTRUCTIONS ZP19055

30 MIN

*Approximate assembly time for 2
fence panels*

*Want to see a video on how to
assemble this product?*

Scan the QR code

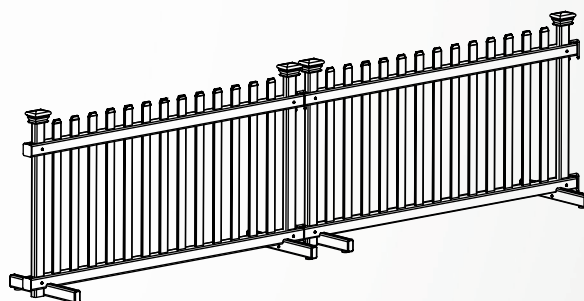

GENERAL INFORMATION



IMPORTANT

- Check the inside of the larger pieces in your box for other materials packed inside.
- When assembling components, place on a non-abrasive surface (i.e. shipping box) to avoid scratching.
- We recommend an area approximately 5'x 8' for unobstructed assembling.
- You should not need to use excessive force when assembling components.

MISSING OR DAMAGED PARTS?

VISIT OUR WEBSITE FIRST, SO WE CAN HELP YOU RIGHT AWAY!

Although great care has been taken to ensure proper packaging and handling of this product, occasionally problems occur. If you discover any missing, damaged or defective parts, please visit our website to order replacement parts. If you experience any further trouble with your product, please contact our customer service department.

 parts.nychbrands.com

 support@zippity-outdoor.com

 **704-892-5222 / 877-234-6196**

Customer service agents are available to take calls weekdays from 9am-5pm EST. If you call outside of business hours, please leave a voicemail.

To help you quickly and accurately, please have reference item number **ZP19055** and the specific part name which can be found on page 4. It is helpful if you can provide the batch lot which is a stamped number inside the box.

NEED ASSEMBLY HELP?

If you are having problems with the assembly or installation of this product, we are happy to assist you with the process, **so please give us a call at 704-892-5222 / 877-234-6196.**

NEED TO RETURN?

If for some reason you need to return this product, please allow us to help resolve your issues first. If you still decide to return the product, **you will need to initiate the return from the company you originally purchased from.**

Detailed Product Dimensions & Specifications

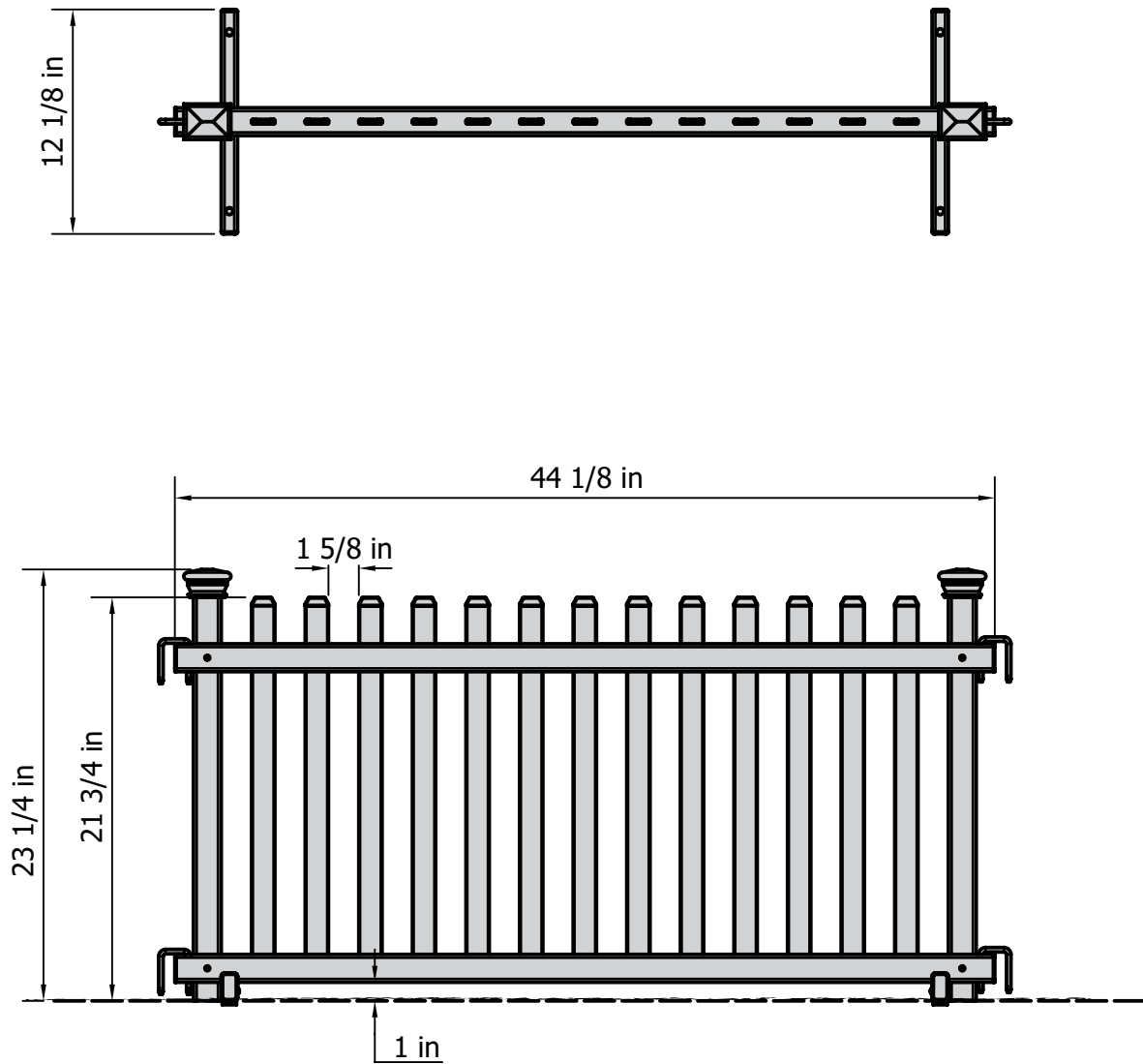

STEP 1: LAY OUT MATERIALS

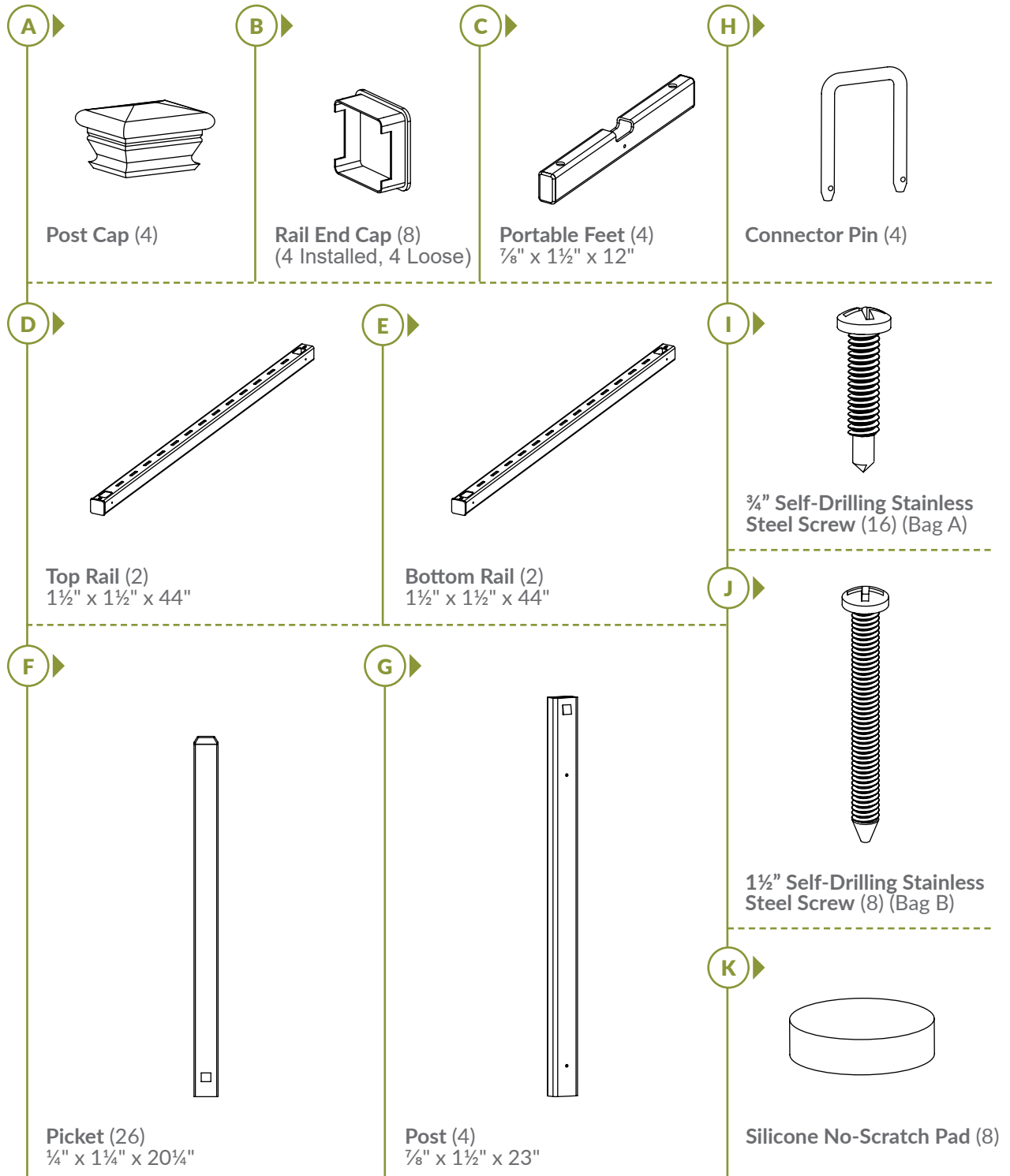

STEP 2: ASSEMBLE FENCE FRAME

STEP 2.1

1. Identify the Top Rail (D) and the Bottom Rail (E) as shown below.
2. Insert two loose Rail End Caps (B). Make sure they are oriented as illustrated.

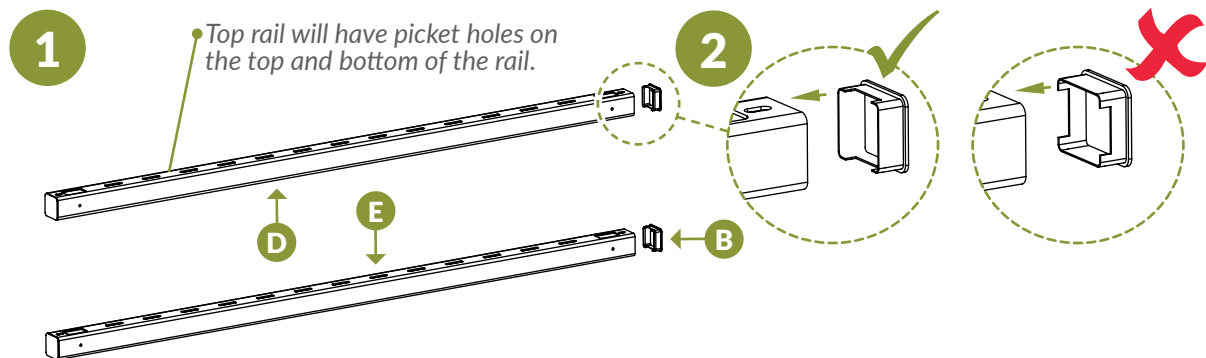

STEP 2.2

1. Orient (2) Posts (G) as shown.
2. Slide the top rail down the posts aligning the pre-drilled holes.
3. Drive (4) 3/4" Self-Drilling Stainless Steel Screws (I) into the pre-drilled holes.

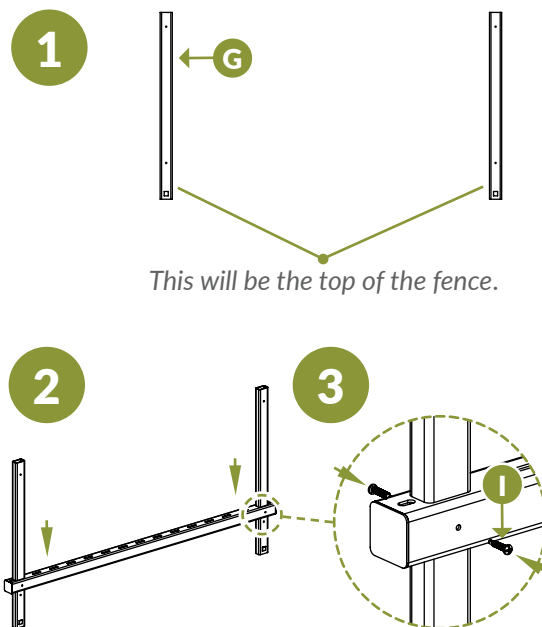

STEP 2.3

1. Slide the bottom rail down the posts until the pre-drilled holes align.
2. Drive (4) 3/4" self-drilling stainless steel screws into the holes.

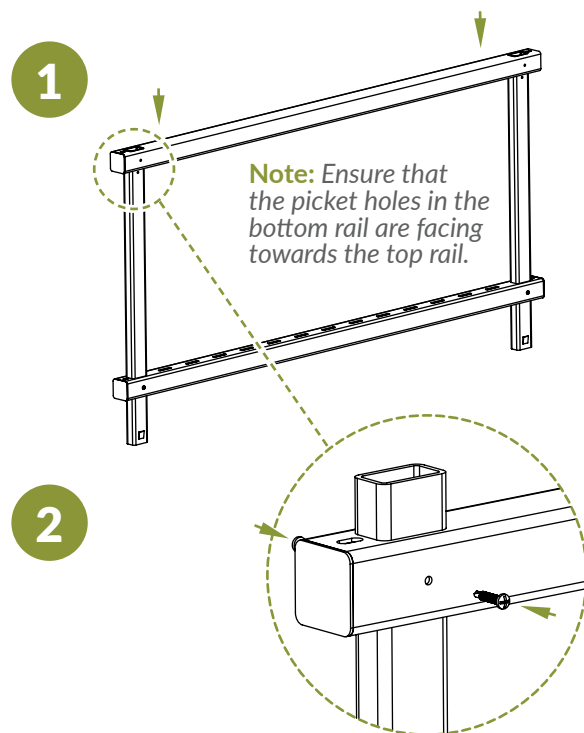

STEP 3: INSERT THE PICKETS

STEP 3.1 ▶

- ▶ 1. Rotate the fence frame so that the post tabs are facing up.
2. Insert (13) Pickets (F) into the picket holes in the top and bottom rails.

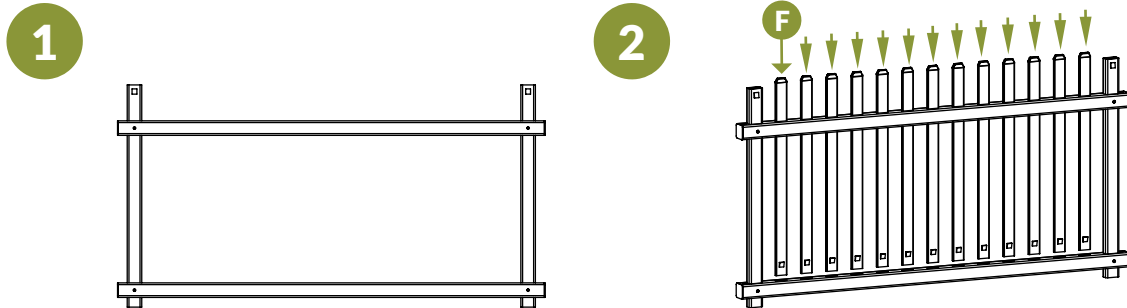

STEP 4: ATTACH THE FEET

STEP 4.1 ▶

- ▶ 1. Identify the Portable Feet (C). If you plan to use your portable fence indoors, identify (4) of the Silicon No-Scratch Pads (K).
2. Remove the adhesive cover from the pads and stick two pads on the far ends of the underside of each foot as shown below.

Note: This step is only needed for indoor applications.

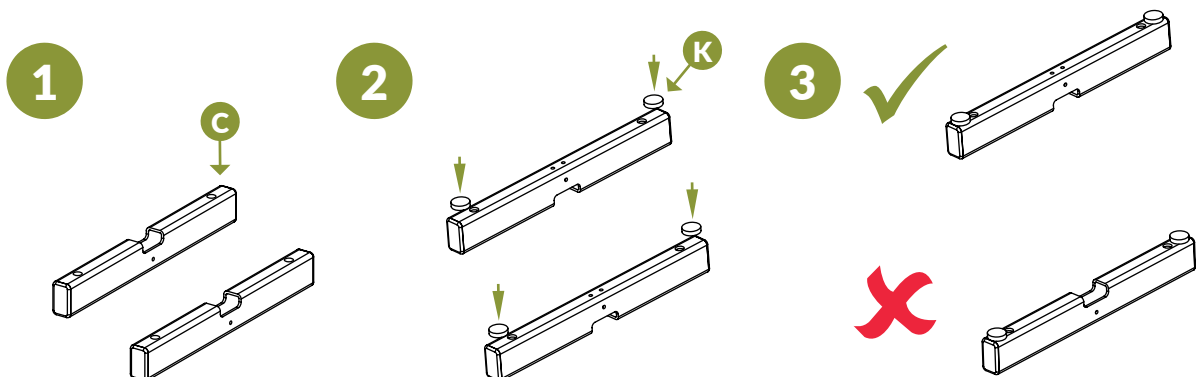

STEP 4.2A ▶

Corner/Angled Application:

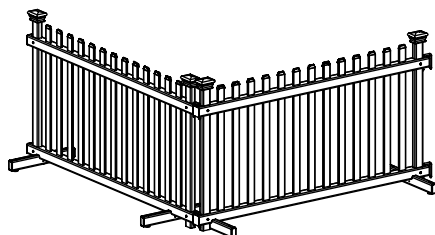

- ▶ 1. Take one of the portable feet and slide the notched end into the underside of the bottom rail.
2. Position the foot so that it is at least 4½" from the edge of one of the posts. Drive (2) 1½" Self-Drilling Stainless Steel Screws (J) through the pre-drilled holes in the underside of the portable foot.
3. Take the other portable foot and slide the notched end into the underside of the rail.
4. Slide the foot until it touches the other post and drive (1) 1½" self-drilling stainless steel screw into the pre-drilled hole in the side of the portable foot.

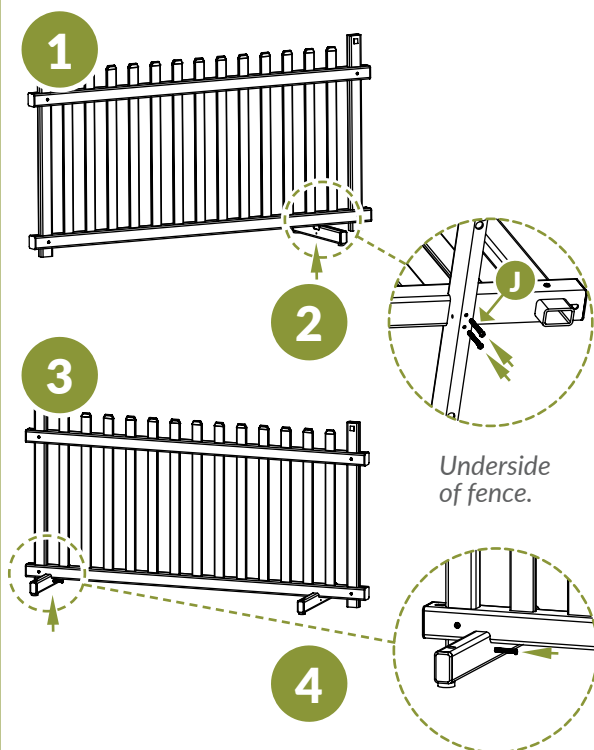

STEP 4.2B ▶

In-Line Application:

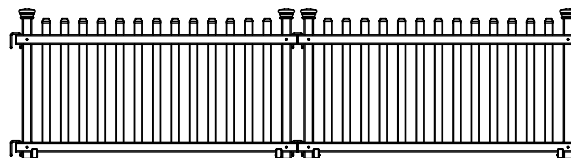

- ▶ 1. Take a portable foot and slide the notched end under the bottom rail. Slide the foot so that it is touching the side of the post.
2. Drive one 1½" Self-Drilling Stainless Steel Screw (J) into the pre-drilled hole in the side of the foot.
3. Repeat this process on the other side of the fence panel.

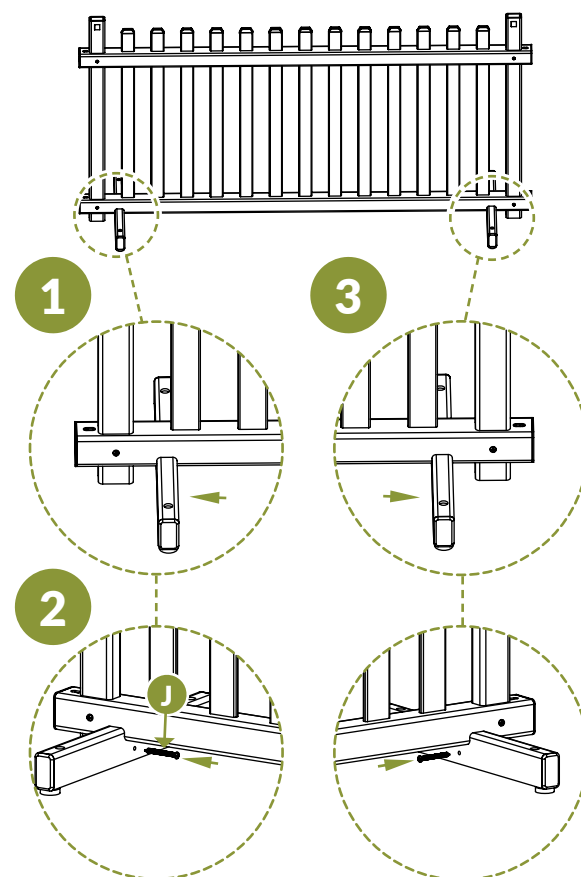

STEP 5: ASSEMBLE SECOND FENCE PANEL

STEP 5.1 ▶

- ▶ Repeat steps 2-4 to assemble the second fence panel.

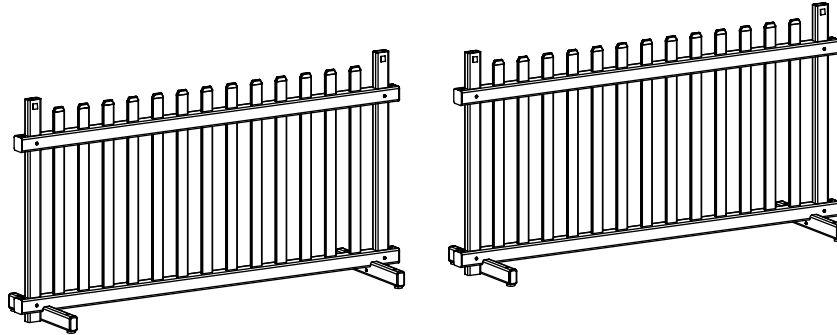

STEP 6: CONNECT THE PANELS

STEP 6.1 ▶

- ▶ Connect the two fence panels using the Connector Pins (H) as shown below.

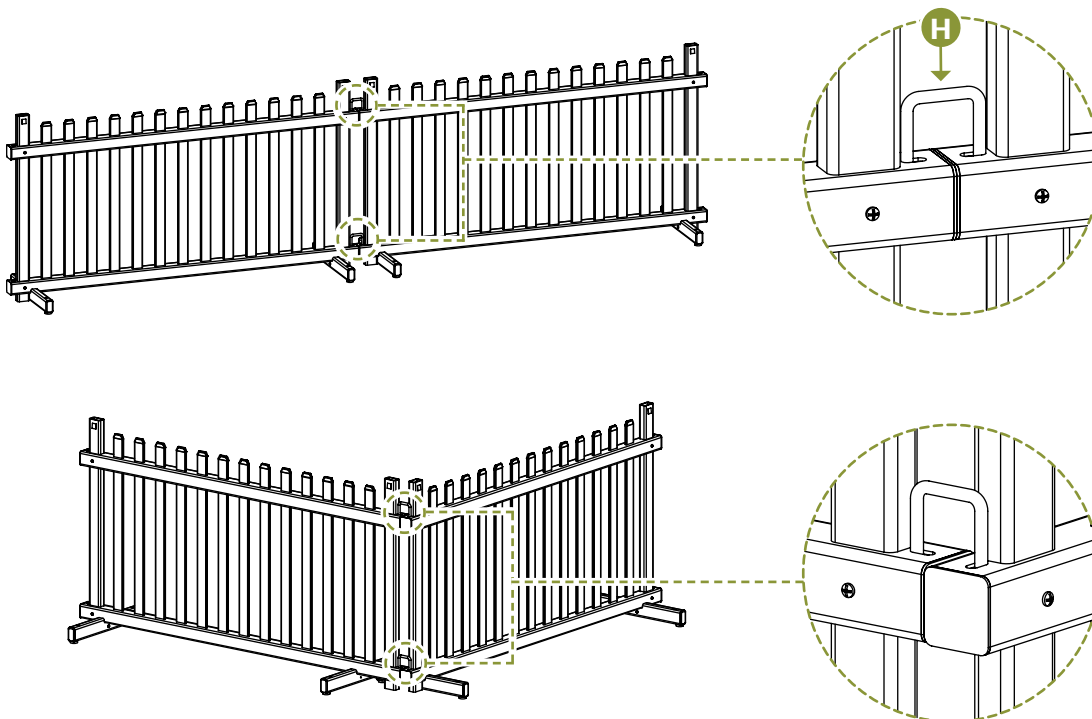

STEP 7: ATTACH POST CAPS

STEP 7.1 ▶

- Insert (4) Post Caps (A) over the top of the posts until the post cap snaps into the tabs of the post.

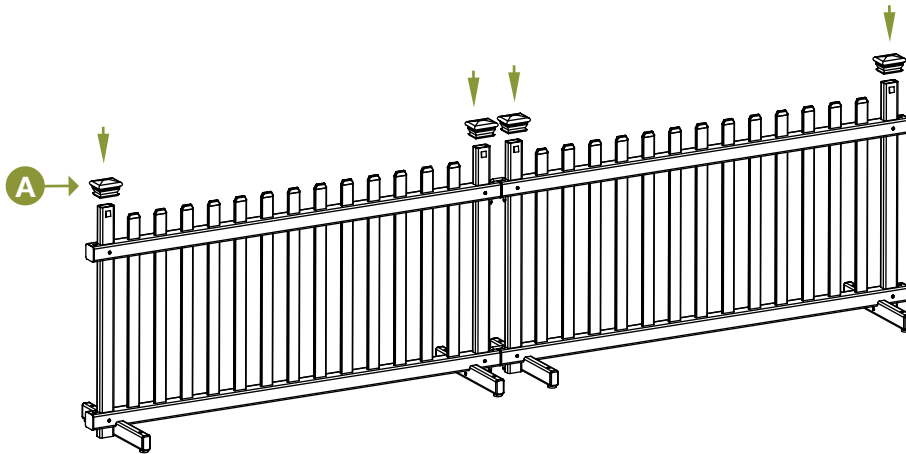

OPTIONAL STEP 8: SECURE PANELS

STEP 8.1 ▶

- If you wish to more permanently secure your portable fence you may take the following steps to do so:

1. If you are mounting on grass and want to further secure your fence, you can drive a $\frac{1}{2}$ " diameter rebar stake (not included) into the two holes in each portable foot.
2. Secure a zip tie or cotter pin (not included) through the holes in the connector pin to prevent it from being able to be removed.

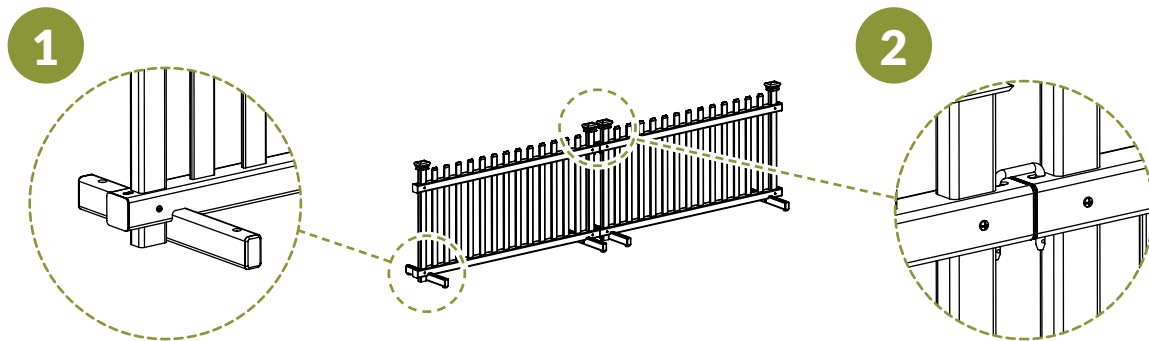

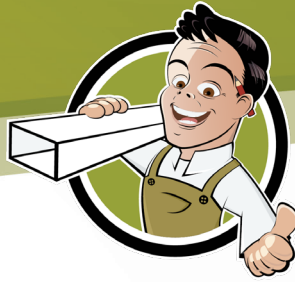

ZIPPITY

Easy Does It!



6935 Reames Rd. Ste. K.
Charlotte, NC 28216



support@zippity-outdoor.com

704-892-5222
877-234-6196



WWW.ZIPPITY-OUTDOOR.COM