

# aqva

## S U P P L Y

### LINEAR DRAINS

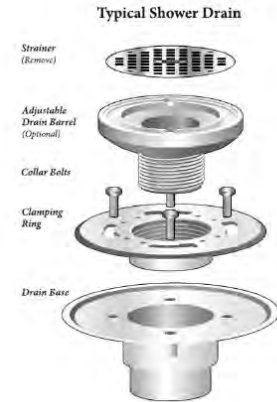
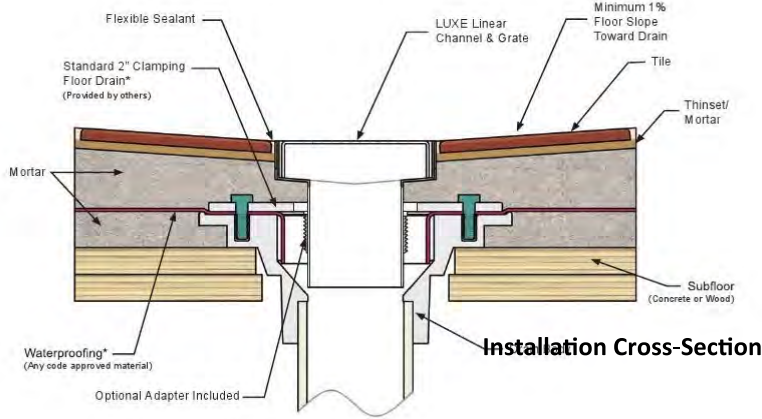

An exploded view of a typical shower flanged drain assembly is shown below. This assembly can be made from PVC, cast iron or other composite materials. Linear drain will only replace the strainer.

## Installation Instructions

**STEP 1 :** Pre-slope shower pan and install waterproofing per manufacturer's instructions; any waterproofing material or procedure can be utilized (i.e. vinyl, CPE membrane, roll/paint on, metal pan, hot mop, surface sheet membrane, etc.). Perform leak test as required.

**STEP 2:** AQVA Linear Drains standard channel width is 3 3/16" (85mm). Confirm rough opening is approximately 2" wider than drain length to accommodate backer board and wall tile thickness (e.g. a 38" rough opening will close to near 36" finish opening based on thickness of materials)

**STEP 3:** Cut any 2x4 to length for use as a linear drain placeholder; this allows for about an 1/8" (3mm) gap around the channel's perimeter to apply a bead of flexible sealant. Note: Channel depths are 1.25" (30mm) for the tile insert and 0.8125" (20.64mm) for square pattern and wedgewire.

**STEP 4:** Build mortar bed and install tile to create a 1-2% grade towards drain.

**STEP 5:** Install tile into tile insert tray [TILE INSERT DRAINS ONLY]

**STEP 6:** Remove 2x4, clean out void and install AQVA Linear Drain channel as you would any tile building up and supporting as necessary with mortar. Ensure drain channel is level and just slightly below (1/16" or less) adjacent line.

**STEP 7:** Line perimeter of linear drain channel with a color-matched flexible waterproof sealant; this will allow the stainless steel to expand and contract without cracking the grout or tiles.



Linear drains simply require pitching the floor towards the drain site. Allowing for placement options not limited to the center of the shower, curbless designs and easier installation with all flooring options including large format tiles.





EXCLUSIVELY FOR



# aqua

## S U P P L Y

### LINEAR DRAINS

Grate	Length	Width	Height	Lowes Item ID	Model ID
WedgeWire 	26"	3 3/16"	13/16"	646945	763440
	30"	3 3/16"	13/16"	646948	763441
	36"	3 3/16"	13/16"	646946	763442
	40"	3 3/16"	13/16"	646943	763443
	48"	3 3/16"	13/16"	646947	763444
	60"	3 3/16"	13/16"	646944	763445
Tile Insert 	26"	3 3/16"	1 1/4"	585856	392688
	30"	3 3/16"	1 1/4"	579848	392689
	36"	3 3/16"	1 1/4"	579849	392690
	40"	3 3/16"	1 1/4"	579850	392691
	48"	3 3/16"	1 1/4"	579851	392692
	60"	3 3/16"	1 1/4"	579852	392693
Square Pattern 	26"	3 3/16"	13/16"	579859	672333
	30"	3 3/16"	13/16"	579858	672334
	36"	3 3/16"	13/16"	579856	672335
	40"	3 3/16"	13/16"	579855	672336
	48"	3 3/16"	13/16"	579854	672337
	60"	3 3/16"	13/16"	579853	672338



- 100% stainless steel construction - grate & channel body
- Installs like tile into tile bed
- Independent of waterproofing materials and procedures
- Compatible with all standard 2" floor drains
- Central 2" outlet
- Universal Design
- ADA Compliant
- Satin Stainless Finish

EXCLUSIVELY FOR

