



Installation Instructions

for Vinyl Windows with Integral Flush Fin (JII-90024)



Thank you for selecting JELD-WEN products. Attached are JELD-WEN's recommended installation instructions for vinyl windows with an integral flush fin. Not all window types may be installed into every wall condition in all areas. Consult your local building code official for applicable building codes and regulations. Local building code requirements supersede recommended installation instructions. Areas such as Florida and the Texas TDI region have different anchoring requirements based on product certification. For information on specific products, visit www.floridabuilding.org or www.tdi.texas.gov and follow the anchoring schedule given in the drawings for the product instead of the anchoring schedule in this document.

Horizontal Slider

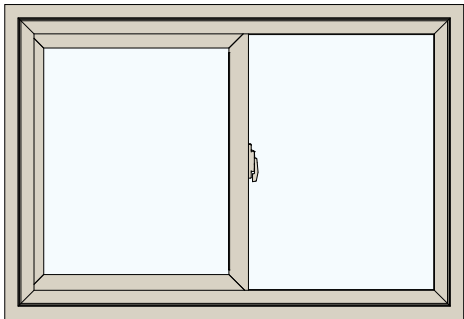

Picture

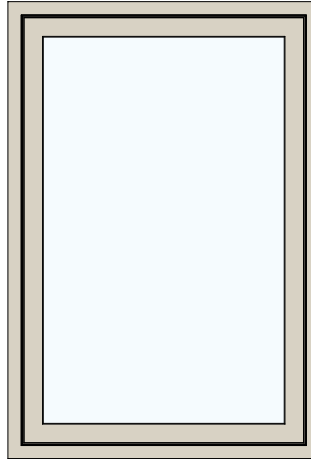

Single Hung

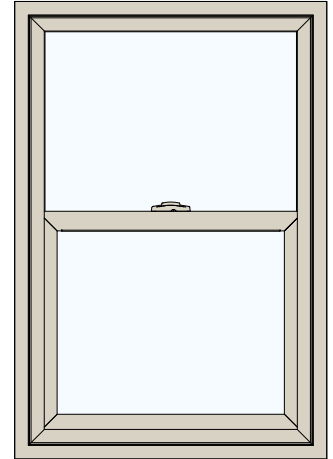

IMPORTANT INFORMATION | TABLE OF CONTENTS | GLOSSARY

PLEASE NOTE: Installations where the sill is higher than 35 feet above ground level, or any product installation into a wall condition not specifically addressed in these instructions, must be designed by an architect or structural engineer. Failure to install windows into a square, level, and plumb openings could result in denial of warranty claims for operational or performance problems.

NOTE TO INSTALLER: Provide a copy of these instructions to the building owner. By installing this product, you acknowledge the terms and conditions of the limited product warranty as part of the terms of the sale.

Table of Contents

Safety and Handling	2
Materials and Tools	3
Inspect Product	3
Inspect Rough Opening (R.O.)	4
Install Sill Pan	5
Temporarily Fasten and Shim Product	5
Fasten Product (Size and Spacing)	6
Install Drip Cap	7
Create "Interior" Air Seal	7

Glossary

Backer Rod (backing material)

A material (e.g. foam rod), placed into a joint primarily to control the depth of the sealant.

Buck

A wood framework attached to the masonry inside a window or patio door rough opening.

Flush Fin Window

A window without a nailing fin that has a face flange (trim only). Flush fin windows may also be known as flange, stucco flange or Florida flange windows.

Installation Clip

A vinyl accessory that snaps into the accessory groove of some fixed windows and is used to secure the window to the rough opening.

Shiplap

The layering method in which each layer overlaps the layer below it so that water runs down the outside.

Weep Hole (weep channel)

The visible exit or entry part of a water drainage system used to direct and drain water out of a window.

SAFETY AND HANDLING

Safety

- Read and fully understand ALL manufacturers' instructions before beginning. Failure to follow proper installation instructions may result in the denial of warranty claims for operational or performance problems.
- Do not work alone. Two or more people are required. Use safe lifting techniques.
- Use caution when handling glass. Broken or cracked glass can cause serious injury.
- Wear protective gear (e.g. safety glasses, gloves, ear protection, etc.).
- Operate hand/power tools safely and follow the manufacturer's operating instructions.
- Use caution when working at elevated heights.
- If disturbing existing paint, take proper precautions if lead paint is suspected (commonly used before 1979). Your regional EPA (www.epa.gov/lead) or Consumer Product Safety Commission offices provide information regarding regulations and lead protection.



WARNING: Drilling, sawing, sanding or machining wood products can expose you to wood dust, a substance known to the State of California to cause cancer. Avoid inhaling wood dust or use a dust mask or other safeguards for personal protection. For more information go to www.P65Warnings.ca.gov/wood.

Window Handling

- Make sure operable windows are locked prior to installation.
- Heed material manufacturers' handling and application instructions.
- Handle in a vertical position; do not carry flat or drag on the floor.
- Do not put stress on joints, corners or frames.
- Store window in a dry, well-ventilated area in vertical, leaning position to allow air circulation; do not stack horizontally.
- Protect from exposure to direct sunlight during storage.
- Install only into vertical walls and when conditions and sheathing are dry.

IF INJURY OCCURS, IMMEDIATELY SEEK MEDICAL ATTENTION!

MATERIALS AND TOOLS

Needed Materials

JELD-WEN exterior window and door products should be installed in accordance with JELD-WEN's recommended installation instructions, which are printed on the product label or can be found on our website: www.jeld-wen.com.

NOTE: Alternative installation methods and flashing systems may be utilized at the installer's or owner's discretion and, in such situations, the installation should be done in accordance with the flashing manufacturer's instructions. Follow all material manufacturers' instructions for proper use and compatibility. When using flashing, spray adhesive/primer, sealant and foam products, we recommend using the same manufacturer and verifying compatibility. It is the End User's responsibility to determine if dissimilar materials are compatible with the substrates in the application.

- #8 pan-head or washer head, corrosion resistant screw. Minimum embedment of 1 1/4" into the structural framing (or as required by local code).
- For securing the sill in masonry applications, 3/16" self-tapping concrete screws (gasket head optional or as required by local code). Minimum embedment of 1 1/4" into the structural framing (or as required by code). Apply sealant to the self-tapping concrete screw threads and head of the screw.
- Sealant: We recommend OSI® QUAD® Max Sealant or equivalent (for interior air seal). This can be used in any application and can be painted or ordered in a color matched product if desired.

- Polyurethane low expansion window and door foam: We recommend OSI® QUAD® Foam or equivalent (for interior air seal).
- Backer rod: 1/8" larger than the widest portion of the gap (used in conjunction with sealant bead for interior air seal).
- Non-compressible or non-water degradable shims.

Additional Materials Needed if Installing into an Existing Window Frame:

- Continuous support member comprised of composite or solid wood (cedar or redwood recommended).

Existing Aluminum Window:

- Dimensions should be 1/2" shorter than the length of the sill track and 1/4" taller than the depth of the track.

Existing Wood Window:

- Dimensions should be 1/4" thick, length of the existing frame sill minus 1" and the width of the new vinyl window side jamb minus 1/4".

Potential Needed Tools

- Utility knife/shears
- J-roller
- Hammer
- Tape measure
- Caulking gun
- Level (4' minimum recommended)
- Drill with bits
- Pry bar
- Screwdriver
- Hacksaw
- Putty knife

1

INSPECT PRODUCT

Remove Packaging

- Remove shipping materials such as corner covers, shipping blocks, shrink wrap or pads. If there is a protective film on the glass, do not remove it until the installation and construction are complete.
- Do not remove the installation label until after the inspection of the job is complete.

Inspect Window

- Cosmetic damage.
- Product squareness (diagonal measurements not more than 1/4" different).
- Correct product (size, color, grid pattern, handing, glazing, energy-efficiency requirements, etc.).
- Cracked frame welds or other frame damage.
- Splits, cracks, holes, missing sections or other damage.

If any of the above conditions represent a concern, or if you expect environmental conditions to exceed the window's performance rating, do not install the window. Contact your dealer or distributor for recommendations.

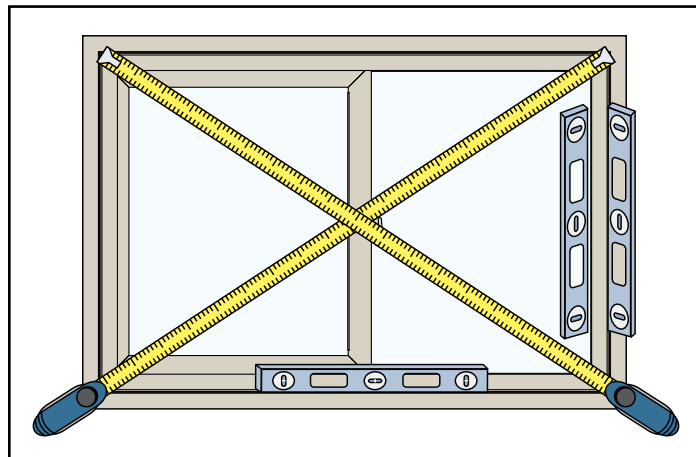

2

INSPECT ROUGH OPENING (R.O.)

- Verify the width and height of the rough opening is 1/2" - 5/8" larger than the window width and height.
- Verify the rough opening is square. The (A) and (B) measurements should be the same. Suggested deviation from square is no more than 1/4".
- Verify the rough opening is level and plumb (C, D and E).
- The rough opening sill should not be crowned or sagged (D), but rather level or sloped (positive slope) to the exterior.
- The exterior face of the rough opening should be in a single plane (E) with less than 1/8" twist from corner to corner.

Verify Square, Level and Plumb

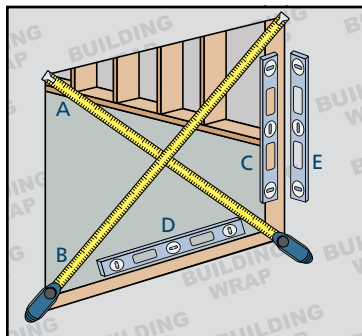

For Retrofit Installations

Verify the rough opening framing or existing window frame is structurally sound. Contact your local waste management entities for proper disposal or recycling of products being removed.

This installation guide addresses masonry/block wall, sheathed wall, open-stud construction and existing window frame. If installing into an opening other than what is identified, consult a building professional.

Masonry/Block Wall Construction

This installation assumes that a framework of studs (often called a buck) has already been properly fastened in a weatherproof manner to the concrete/masonry wall.

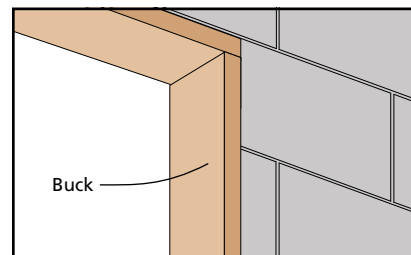

Fully Sheathed Wall Construction

Sheathing is applied to the exterior of the wall framing. The window will be mounted into the rough opening in a weatherproof manner.

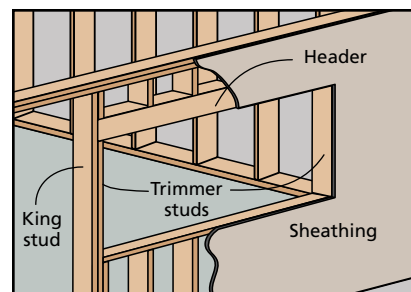

Open-Stud Construction

Sheathing is absent and building wrap is applied atop of the wall framing. The window will be mounted into the rough opening in a weatherproof manner.

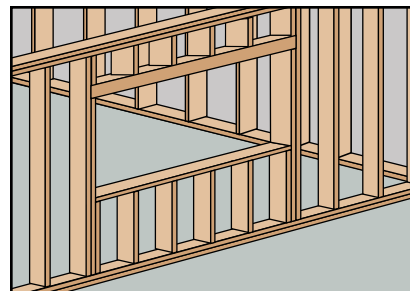

Existing Window Frame Installation

Existing window frame is left in place and the window will be installed into the frame in a weatherproof manner. Flush fin windows must be installed onto a surface with at least a 3/8" wide exterior face. This face must be flush with or protrude past the exterior wall surface.

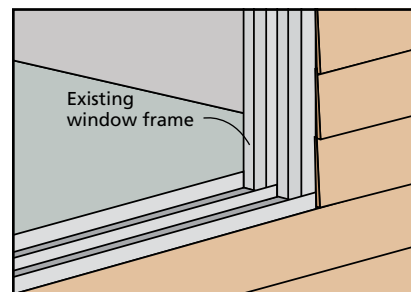

3

INSTALL SILL PAN

Prepare Rough Opening-Shimming

1. Install a sill pan in a weatherproof manner on the rough sill (refer to **ASTM 2112** for types of sill pans). Always allow water to drain out of the pan and onto the building wrap, drainage plane or to the exterior.
2. Apply a continuous bead of sealant to the interior of the upturned leg of the sill pan (if using a rigid sill pan).
3. Place shims on the sill pan as needed to level the window and prevent sagging or bowing. Shims should be aligned in the following fashion:
 - Near the exterior edge of the sill pan.
 - 1 shim placed 3/4" to 1" in from each side wall of the sill pan.
 - No more than 24 inches on-center between additional shims.
 - For mulled units ensure there is a shim located 1/2" either side of the mull joint.
 - Shims may be held in place with sealant.
 - Steps may not pertain to existing aluminum frames or a sloped sill.

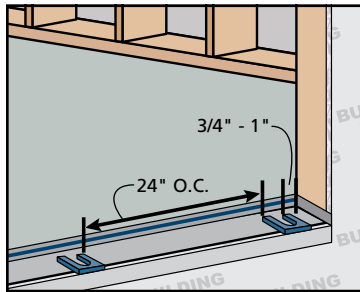
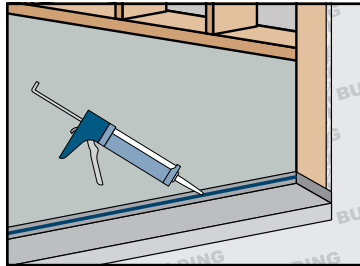
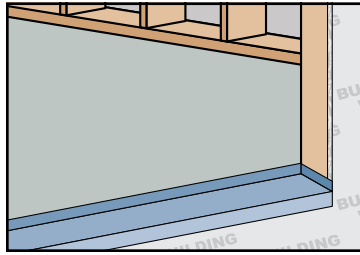

Prepare Rough Opening-Existing Window Frame

1. Remove the sashes and/or glass from the existing window frame.
2. Remove all hardware and window components not a part of the frame (meeting stile, jamb liners, locking mechanisms or other hardware etc.).

If Installing into an Aluminum Window Frame:

1. Seal all four corners of the window frame as shown.
2. Notch grooves across the bottom of the continuous support (see materials list) to allow for water drainage through the weep holes. Set the continuous support into the exterior sill track, creating a level surface at the sill.

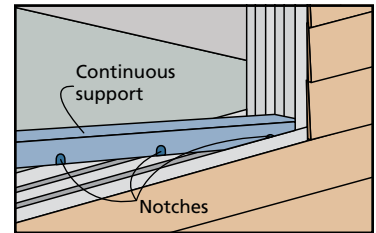
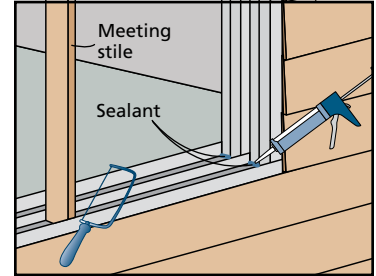

4

TEMPORARILY FASTEN AND SHIM PRODUCT

WARNING! To avoid injury, use at least two people to install. Adequately support the window until fully installed.

Sealant Application

1. Apply sealant to the backside of the flush fin. Sealant should be applied in a **continuous** fashion along both sides and across the top. Sealant should be applied in a **discontinuous** manner along the bottom (to allow for drainage).
2. If installing into an existing window frame, apply a 3/8" bead of sealant to the exterior face of the opening. Leave gaps at any weep holes if installing into an existing frame.
3. Place window in the opening, making sure the window rests on the shims or the continuous support and makes positive contact with the sealant.

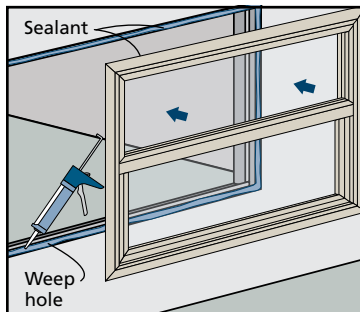

Shim Application

1. Shim within 4" - 6" of each corner on the side and head jamb. Apply additional shims to the side and head of jambs as necessary to ensure the window position within the opening is plumb, level and square. Larger windows typically required additional shims.
2. Shim at each interlock/center of the side jambs.
3. Inspect the window for plumb, level, square and twist. Test the window for proper operation (remove and reinstall if necessary).
4. Shims can be secured with sealant or adhesive.

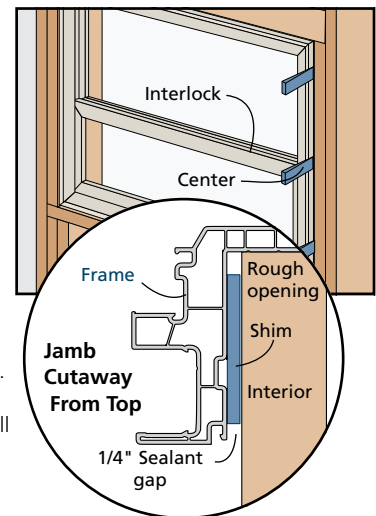

5

FASTEN PRODUCT (SIZE AND SPACING)

NOTE: Areas such as Florida and the Texas TDI region have different anchoring requirements based on product certification. For information on specific products, visit www.floridabuilding.org or www.tdi.texas.gov and follow the anchoring schedule given in the drawings for the product instead of the anchoring schedule in this document.

Frame Preparation

- Remove the track filler, if present.
- Mark fastener locations within the frame track using the spacing given below in "Fastener Locations", or as required by local code.
- Use a pencil to mark each fastener location within the window frame.

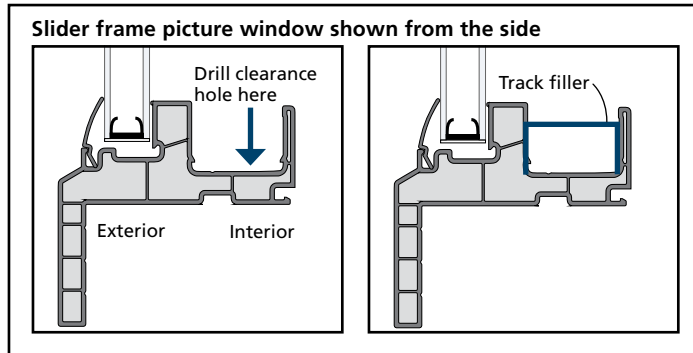

Fastener Location Table

Products are fastened according to performance rating (some holes may be pre-drilled). The performance rating is located on the purchase paperwork or gold AAMA label fixed somewhere on the frame, generally in the head jamb. Look for something like this example: R-PG20-122X76 (48X30)-HS. If this label is missing, use the PG50 and above fastener pattern.

PG20	3" - 6" from the corners and every 24" on-center.
PG35	3" - 6" from each corner and every 18" on-center.
PG50 and above	3" - 6" from each corner and every 12" on-center.
Continuous Head and Sill above PG35	The first 4" from center, on both sides, must be fastened every 2" .

Drill Clearance Holes

At each fastener location, drill a 3/8" clearance hole through ONLY the first wall of the frame to allow the screw head to pass through. Do not drill through the outer wall of the window frame.

NOTE: Dust plugs (designed to cover a 3/8" hole) can be applied to the pre-drilled holes at each fastener location.

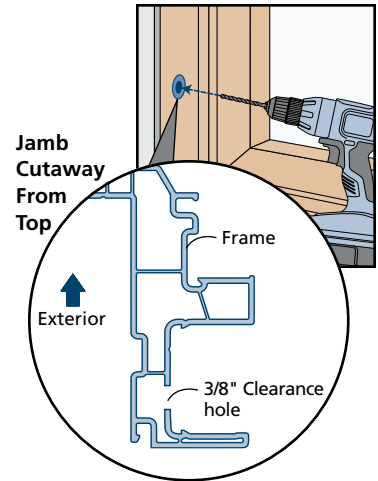

Installation Clips

As an alternative to through frame fastening installation clips can be used. Installation clips should be attached to the "interior" of the frame at the same spacing called out for fastener location (called out in the Fastener Location Table). Shimming is still required with the use of installation clips.

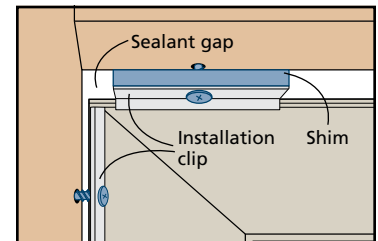

Fasten Window

1. From the interior, secure one of the upper frame corners by placing a fastener through the frame or installation clip. Drive a fastener until snug (do not dent the vinyl).
2. Inspect window for square, level and plumb (adjust shims or remove and reinstall if necessary).
3. Fasten window in a similar manner through the remaining corners, and then through the rest of the fastener locations. **If installing fasteners in the sill, apply sealant to the screw threads and the head of the screw in the window frame (use more sealant as necessary to completely seal the screw head to the frame), or use a gasket head screw.**
4. Insert dust plugs into fastener clearance holes not located in any operating track. Seal plugs in the sill with sealant. Replace track fillers if applicable.

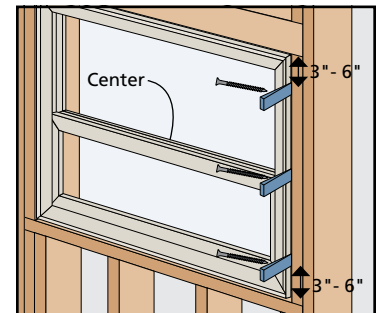

Fasten Window

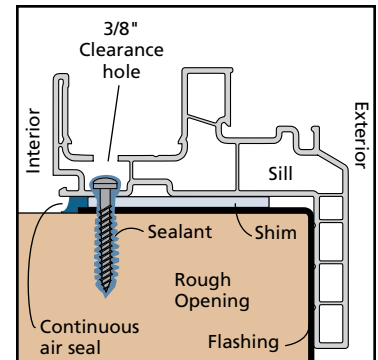

6

INSTALL DRIP CAP

The use of a drip cap on all window/door products is recommended, regardless if supplied. A drip cap is **required** on any *vertical* muller/joined products, regardless if supplied. **NOTE:** A drip cap may not be suitable for some product lines (e.g. brickmould vinyl, flush fin, vinyl flat casing), regardless these product lines need to be incorporated into the wall in a weather-shedding manner.

7

CREATE "INTERIOR" AIR SEAL

Continuous Air Seal

NOTE: Shims may need to be cut back, so the interior air seal is "**continuous**" between the window frame and the rough opening or existing window frame.

Create a continuous air seal on the interior by integrating the rough opening or the existing window frame and the window frame with low expansion polyurethane foam or backer rod and sealant. If needed, apply additional sealant between the sill pan or rough sill and the window frame.

After Installation

- **Ensure weep holes/channels are clear of debris for proper water drainage. Do not seal weep holes/channels.**
- Install exterior wall surface per manufacturer's guidelines.
- Leave an expansion/contraction gap of approximately 3/8" between the window frame and final exterior wall surface (siding, stucco, etc.). For a finished look and additional protection, seal this gap on the sides with backer rod and sealant. If sealant is applied above the drip cap ensure the sealant bead is discontinuous to allow for drainage.
- Protect recently installed units from damage from plaster, paint, etc.

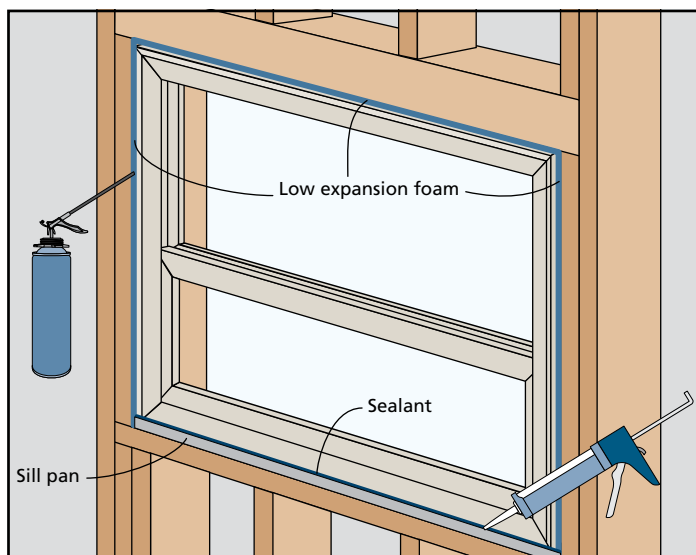

Please visit jeld-wen.com for warranty and care and maintenance information.

Thank you for choosing

