

CAMO[®]
The Better Way to Build a Deck

**NEW
PRODUCTS**

TRAINING GUIDE 2024



TRAINING GUIDE

CONTENTS

FASTENING SYSTEMS



CLIPDRIVE™

STAND-UP DECK CLIP FASTENING SYSTEM

THE BETTER WAY TO FASTEN CAMO UNIVERSAL DECK CLIPS.

PAGES 4-7

FOR USE WITH CAMO UNIVERSAL DECK CLIPS



NEVER-MISS® GUIDE

DECK CLIP FASTENING SYSTEM

INCLUDED IN 450 CT AND 900 CT PAILS OF CAMO UNIVERSAL DECK CLIPS.

PAGES 8-17

FOR USE WITH CAMO UNIVERSAL DECK CLIPS



DRIVE

STAND-UP 3-IN-1 FASTENING SYSTEM

SAVE TIME WITH THE AWARD-WINNING CAMO DRIVE® TOOL.

PAGES 18-25

FOR USE WITH CAMO COLLATED EDGE + FACE SCREWS OR CAMO UNIVERSAL DECK CLIPS



MARKSMAN®

HIDDEN EDGE SCREW FASTENING SYSTEM

ACHIEVE A FASTENER-FREE SURFACE ON SQUARE EDGE DECKING.

PAGES 32-37

FOR USE WITH CAMO EDGE SCREWS



ACCESSORIES

DECK TAPE

SELF-ADHESIVE LINED BUTYL TAPE



PAGES 38-39



BLOCK

THE BETTER FLOATING FOUNDATION

PAGES 40-43



PAGES 26-31 BOARD BENDING & LOCKING TOOL

ACCESSORIES



MARKSMAN®

Achieve a fastener-free surface on square edge decking with this easy and affordable hidden fastening system. MARKSMAN Tools automatically establish spacing between boards and direct CAMO Edge Screws into the edge of the board, leaving a smooth deck surface. Plus, the MARKSMAN system is backed by a CAMO warranty for use in leading deck boards.

INTRODUCTION	33
MARKSMAN PRO TOOLS	34
MARKSMAN EDGE	36



Get to know your MARKSMAN tools

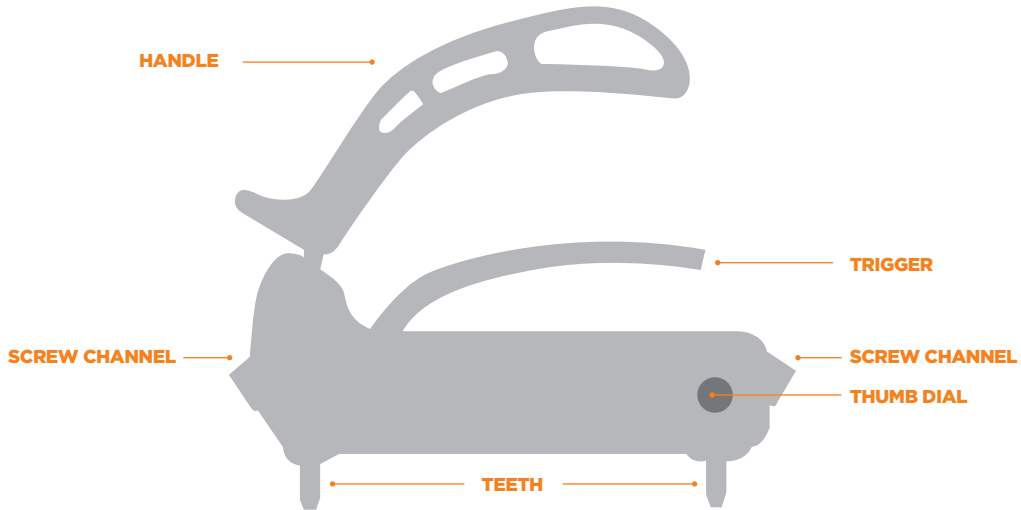

MARKSMAN PRO®



MARKSMAN PRO-X1



MARKSMAN PRO-NB

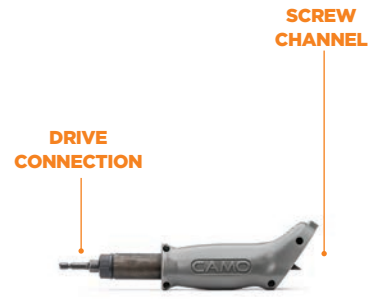





MARKSMAN® EDGE

MARKSMAN tools are for exclusive use with CAMO Edge Screws



WHICH TOOL SHOULD I USE?

	MARKSMAN PRO	MARKSMAN PRO-X1	MARKSMAN PRO-NB	MARKSMAN EDGE
Tool				
Gap	3/16 in	1/16 in	3/16 in	None
Board Width	5-1/4 to 5-3/4 in	5-1/4 to 5-3/4 in	3-1/4 to 5 in	Any
Compatible Boards	KDAT Composite PVC Capped Composite (with pre-drilling) Cedar Redwood Hardwood (with pre-drilling)	Pressure Treated	KDAT Composite PVC Capped Composite (with pre-drilling) Cedar Redwood Hardwood (with pre-drilling)	Pressure Treated

Setup for MARKSMAN Pro Tools



A INSERT T-15 BIT



Insert the T-15 driver bit into your drill. Do not use an impact driver.

B IF YOU'RE PRE-DRILLING*, INSERT THE PRE-DRILL BIT



Speed up the job by attaching the pre-drill bit to another drill.*

C ADJUST DRILL



Adjust drill to the highest speed setting.

D ADJUST SPACER TEETH



Adjust the spacer teeth on the tool with the thumb dial to fit your board.

*Pre-drilling is required for capped composite and hardwoods.

How to fasten Edge Screws

BEFORE YOU BEGIN

Where Edge fastening with the MARKSMAN Pro Tools isn't possible, use CAMO Premium Deck or Composite Screws. Go to page 54 for full instructions.



SCAN TO WATCH THE HOW-TO VIDEO

1



PLACE TOOL

Place the tool on the board so it's in line with the joist. If you are NOT pre-drilling, skip to step 3.

2



DRILL HOLE*

If pre-drilling, run the pre-drill bit through both screw channels*.

***Pre-drilling is required for capped composite and hardwoods.**

3



LOAD SCREWS

Load an Edge screw into both screw channels.

4



DRIVE

Drive the screw in on both sides letting the screw do the work. The shoulder on the bit will stop the screw from overdriving.

Setup for MARKSMAN EDGE



A ATTACH YOUR DRILL



Attach the Drive Connection to your drill.

NOTE: The MARKSMAN EDGE tool leaves no gap between boards. If you desire a gap, place secondary spacers before fastening.

How to fasten Edge screws

BEFORE YOU BEGIN

Where Edge fastening with the MARKSMAN EDGE isn't possible, use CAMO Premium Deck or Composite Screws. Go to page 54 for full instructions.



1 LOAD A SCREW

Load an Edge screw into the magnetized screw channel.



2 PLACE TOOL ON BOARD

Align the screw channel with the joist, ensuring the face of the tool is flat. Tooth should be on the edge of the board.



3 DRIVE

Drive the screw until it's fully seated in the board.



CAMO[®]

The Better Way to Build a Deck

For more information, visit camofasteners.com or
contact us at 800-968-6245 or info@camofasteners.com.

ITEM #0345989