

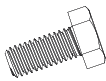

# Instructions for Ranch Series 300lb Hopper

Thank you for your purchase of a Moultrie Ranch Series 300lb Hopper. Please read this sheet before operating the unit. If you should have any questions about this product or any other Moultrie product, please contact us using the information on the back of this sheet. Allow us to better serve you by activating your 1-year warranty online at <http://www.moultriefeeders.com/warranty>.



Short M6 Bolt  
M6 x 1 x 14  
Qty. 16



M6 Lock Nut  
M6 x 1  
Qty. 16

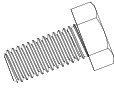

Short M8 Bolt  
M8 x 1.25 x 14  
Qty. 8



M8 Lock Nut  
M8 x 1.25  
Qty. 16

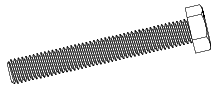

Long M8 Bolt  
M8 x 1.25 x 50  
Qty. 8

## A ASSEMBLE THE HOPPER

**1** Remove all hardware from packaging.

**2** Gather all 4 hopper panels and the hopper cone.

Place the cone on its side, with the front arrow pointing either **Left** or **Right**. Attach both face panels to the cone using (4) M6 Short Bolts and (4) M6 Lock Nut. *Hand tighten only.*

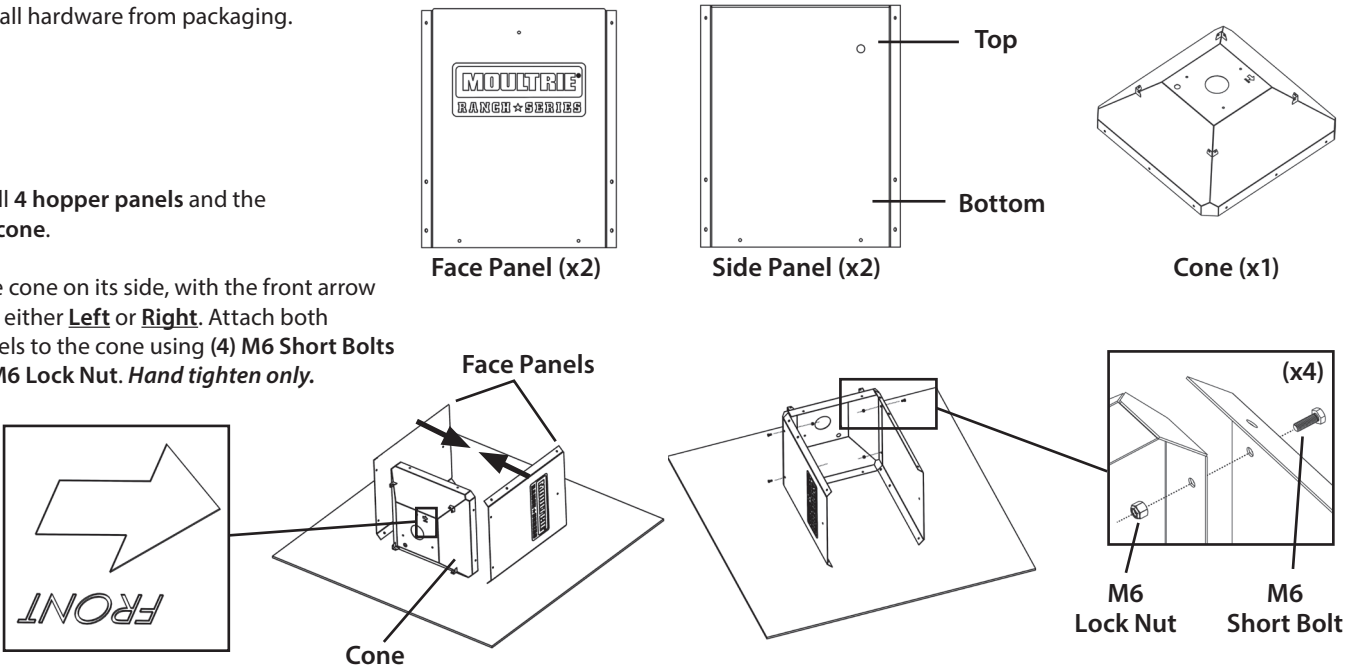

Place a face panel on top of the cone and overlapping the side panels. Align the bolt holes in the cone with the (2) lower holes in the face panel. Secure using (2) Short M6 Bolts and (2) M6 Lock Nuts. *Hand tighten only.*

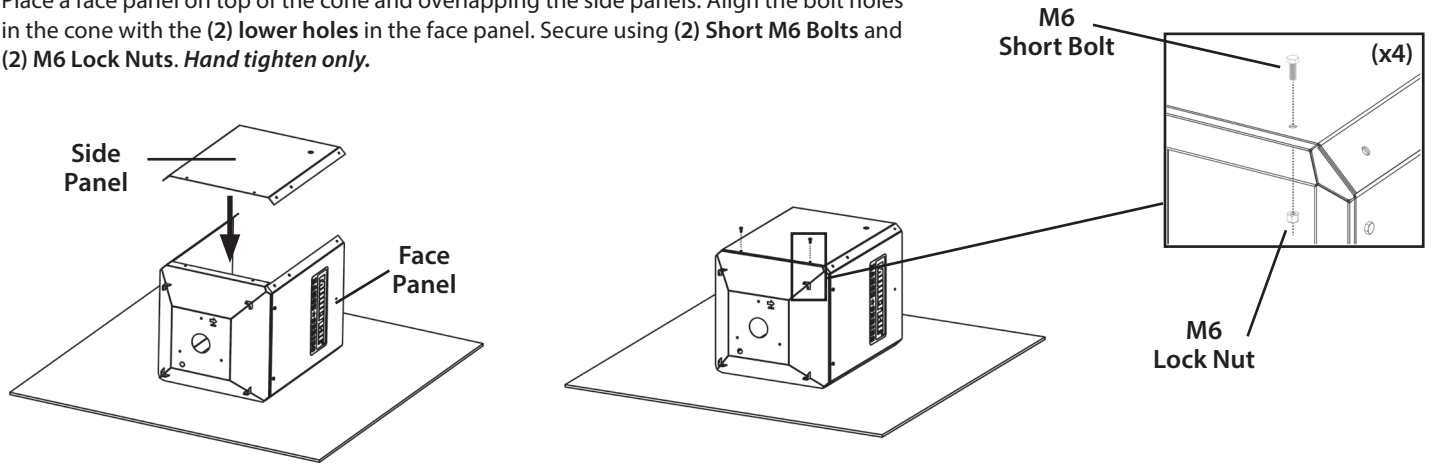

Flip the hopper over and install the remaining face panel following the same procedure above.

## OPTIONAL: (2) Solar Panel Mounts are included with the kit. Install during this step if you choose to use them. (Not included with Gravity Kit)

Stand the hopper upright with the cone flat on the floor. Align the bolt holes in the top (4) corners. Secure with (4) Short M6 Bolts and (4) M6 Lock Nuts. *Hand tighten only.*

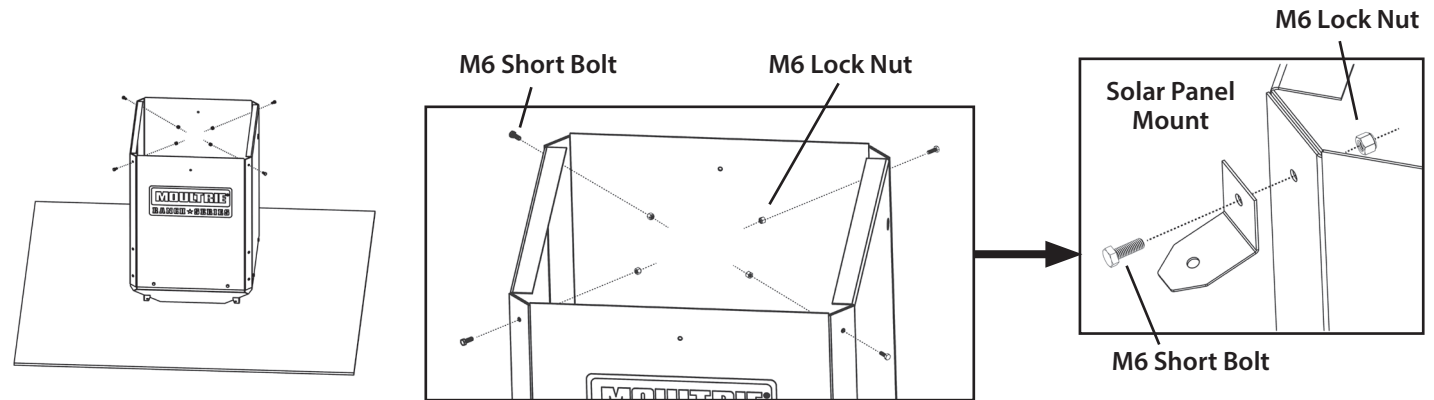

3

Place the (4) **leg brackets** against the corner bracket mounting holes as shown, align the holes and insert (2) **short M8 bolts** from the outside of each leg bracket into the hopper. Secure with a hand-tight **M8 lock nut** on each bolt (8).

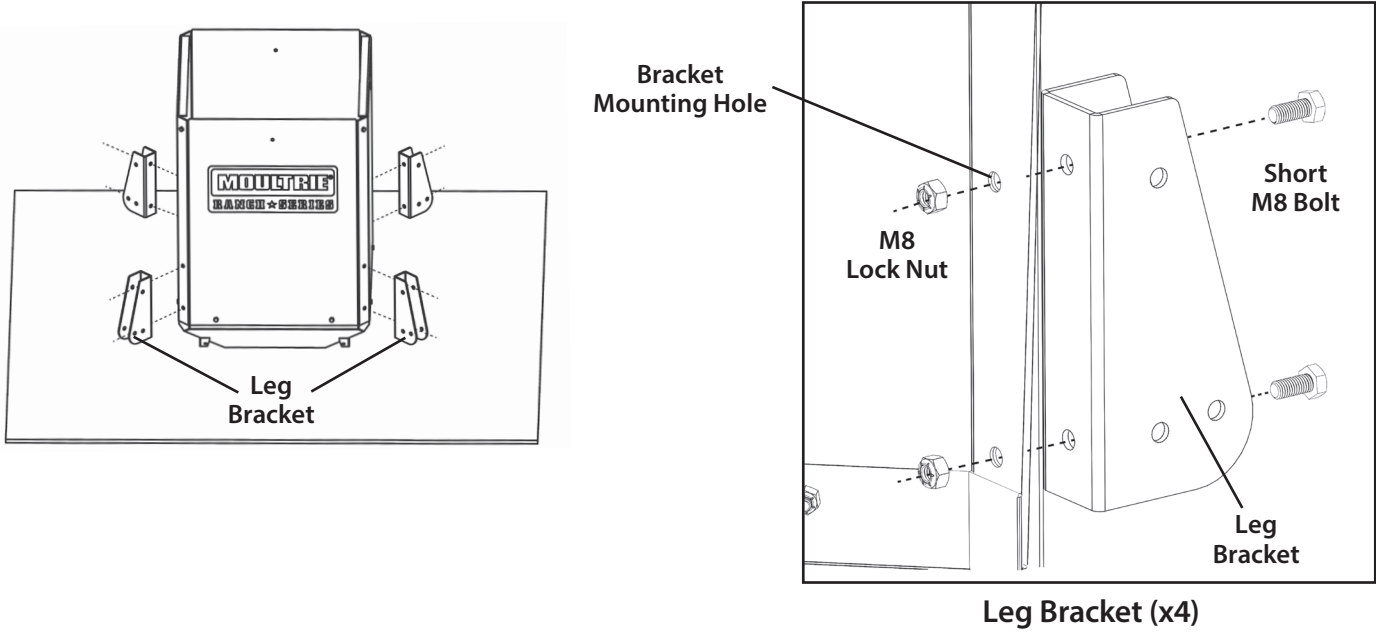

4

Go back and tighten all previously installed bolts. **M6 bolts** will require a 10mm wrench, **M8 bolts** (leg bracket) will require a 13mm wrench. **Note: Do not overtighten.**

5

Install the **Face Panel Tabs** (2) to both the face panels, using a short **M6 bolt** and a **lock nut**. Tighten with a 10mm wrench. The “lip” should point upwards to create a hanger for the lid handle while filling feeder.

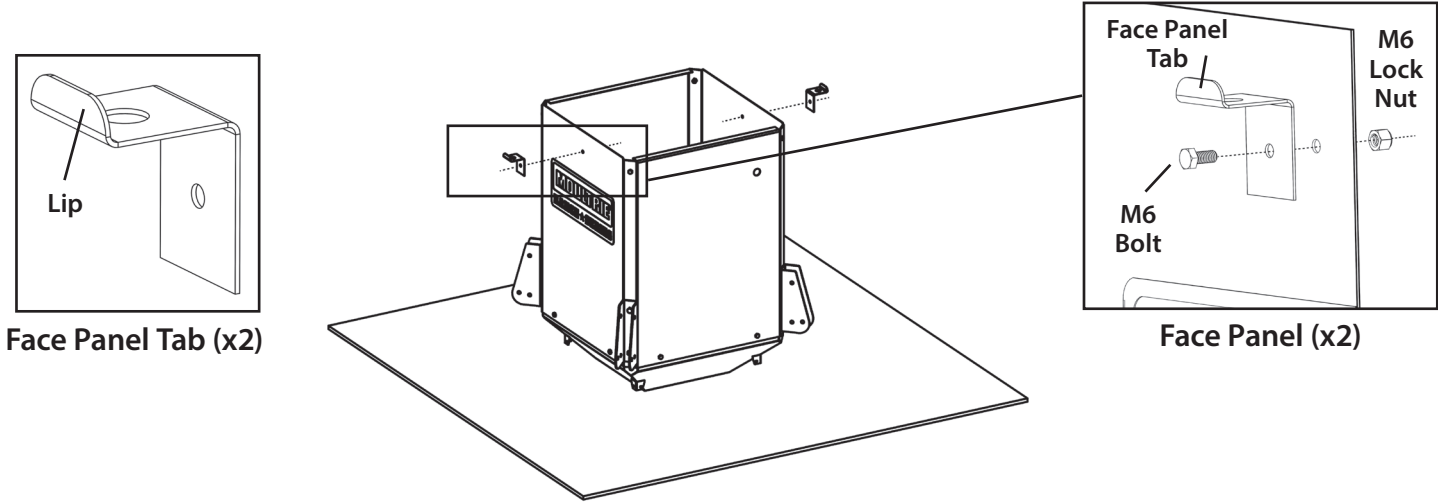

## B ASSEMBLE & INSTALL THE LEGS

1

Collect all 4 **Top-Leg sections**. Insert each section into a leg bracket. Set the leg angle to either 0° or 15° (*15° recommended for most installations*). Secure each with (2) **long M8 bolts** and (2) **M8 lock nuts**. Tighten using a 13mm wrench.

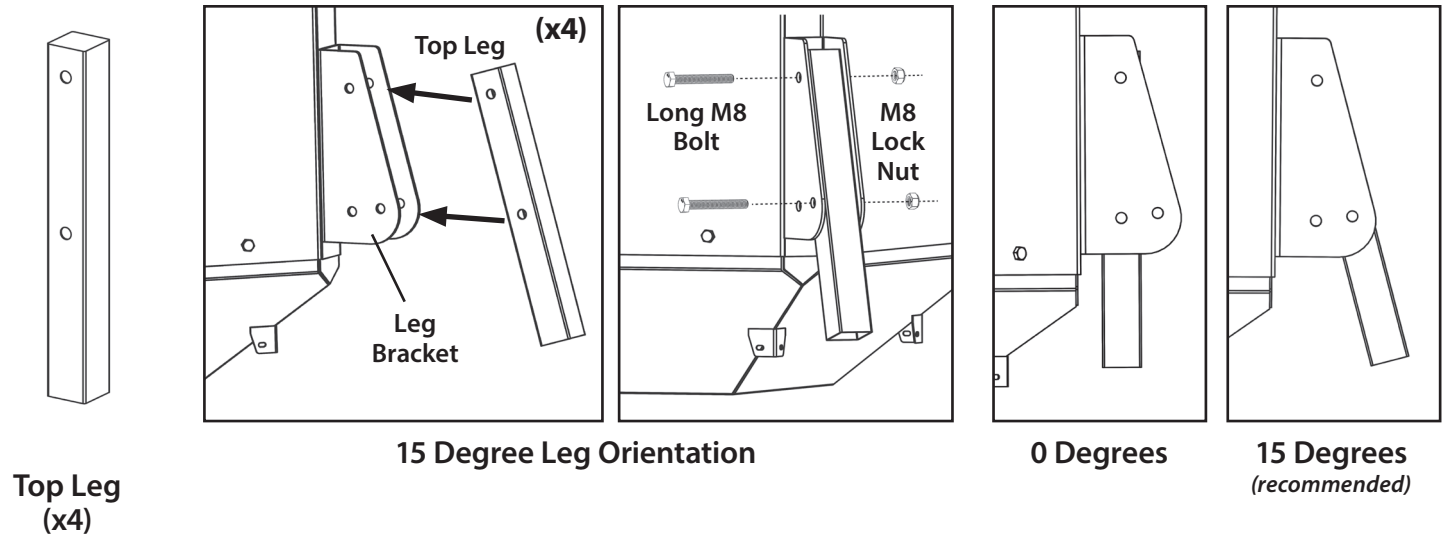

2

Insert the remaining leg sections into the (4) top-leg sections. Tap firmly on the end of the legs when joining leg sections; this will help to keep them locked together.

Leg Section

Leg Sections

Top Leg

(x4)

## C INSTALL FEEDER KIT ONTO HOPPER

See additional feeder kit instructions for installation.

## D INSTALL INTERNAL FUNNEL

After installing your feeder kit onto your hopper, insert the **internal funnel** into the **hopper**, letting the self-alignment ring lock it into place at the bottom of the hopper cone.

**NOTE:** Make sure internal funnel is fully seated at hopper exit, and placed at the very bottom of the hopper. Funnel alignment is critical to proper feeder operation.

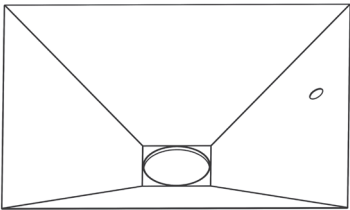

Internal Funnel

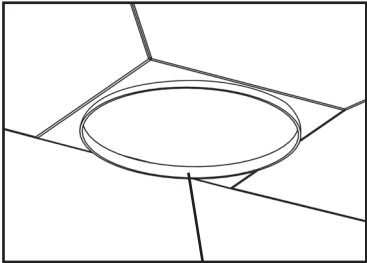

Self-Alignment Ring

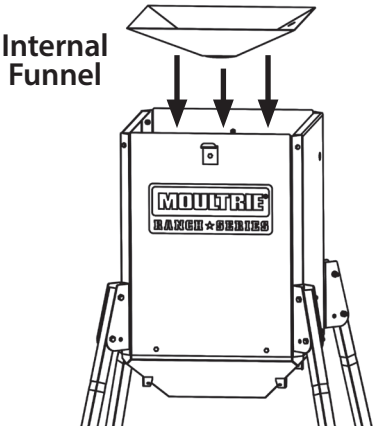

## E ASSEMBLE & INSTALL THE LID

1

Install the **Lid Tabs (2)** to the mounting holes on the lid by inserting a short M6 bolt from the **INSIDE** of the lid and securing with a lock nut tightened with a 10mm wrench. These will enable you to lock your feeder lid using most standard locks.

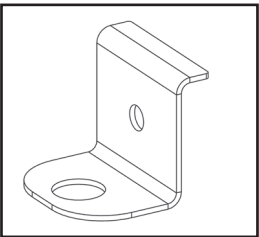

Lid Tab (x2)

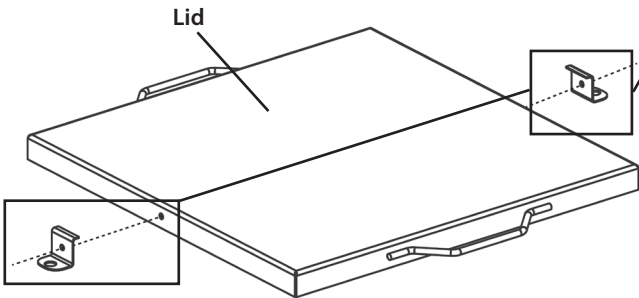

Lid

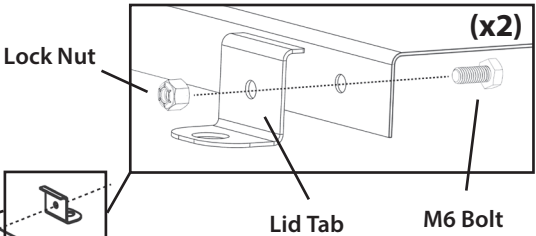

Lock Nut

Lid Tab

M6 Bolt

(x2)

2

Place the lid assembly on top of the feeder with the tabs aligned. The handles should be on the sides of the feeder.

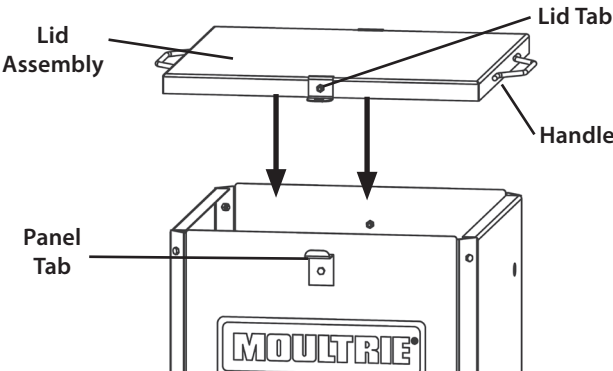

Lid Assembly

Lid Tab

Handle

Panel Tab

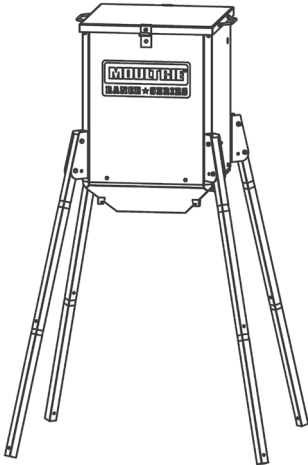

Our Service Department will gladly answer any questions you have.  
[www.moultriefeeders.com/support](http://www.moultriefeeders.com/support)



# Instructions for Ranch Series Gravity Feeder Kit

Thank you for your purchase of a Moultrie Ranch Series Gravity Feeder Kit. Please read this sheet before operating the unit. If you should have any questions about this product or any other Moultrie product, please contact us using the information on the back of this sheet. Allow us to better serve you by activating your 1-year warranty online at <http://www.moultriefeeders.com/warranty>.

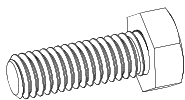

Hex Bolt  
M6 x 1 x 18  
Qty. 9



Flat Washer  
M6  
Qty. 6\*

\* 3 only required if mounting to a hopper other than Moultrie Ranch Series

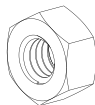

Hex Nut  
M6 x 1  
Qty. 9\*\*

\*\* 3 only required if mounting to a hopper other than Moultrie Ranch Series

## A ASSEMBLE FEEDER KIT

1 Remove all hardware from packaging.

2 Fit the Extension Tube to the top of the gravity head, aligning the 3 bolt holes.

NOTE: Extension Tube can be left off if a higher feeding elevation is desired.

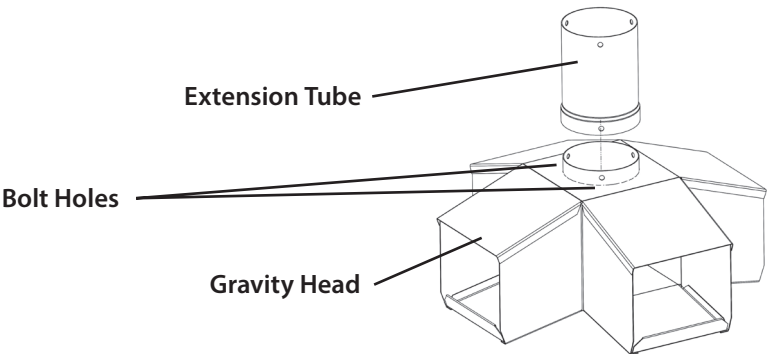

3 From the outside of the extension tube, Insert the (3) M6 bolts through the holes from Step 3. Secure with the supplied hex nuts on the inside of the tube. Once all three bolts are in place and hex nuts are finger tight, fully tighten with 10mm wrench.

ONLY TIGHTEN AFTER ALL 3 BOLTS ARE INSTALLED (10mm wrench)

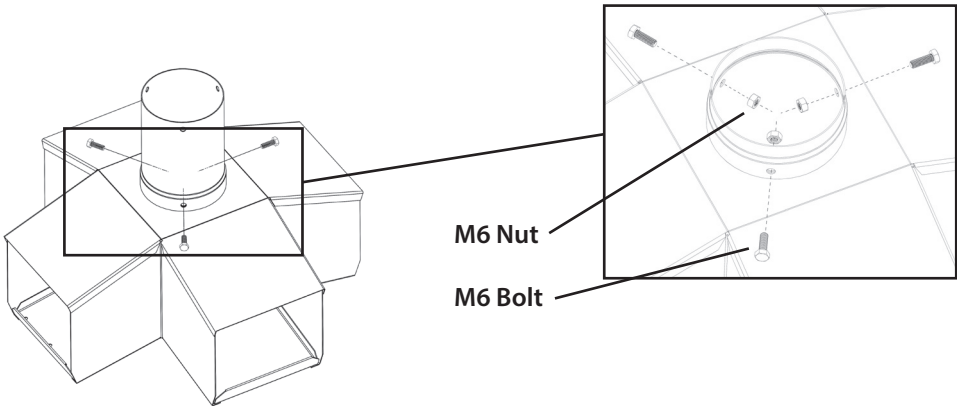

4 Following the same procedure from Step 3, attach the Mounting Plate (ribs facing downward) to the top of the Extension Tube.

ONLY TIGHTEN AFTER ALL 3 BOLTS ARE INSTALLED (10mm wrench)

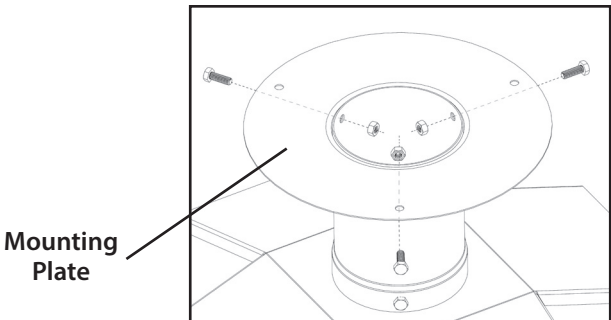

5

The kit is now ready to be installed to your hopper. Rotate the kit so that the 4 feed chutes are all spaced evenly between the feeder legs. Align the (3) pre-installed mounting nuts in the bottom of the hopper with the (3) holes in the mounting plate, then secure the kit using (3) Hex Bolts and (3) Flat Washers.

ONLY TIGHTEN AFTER ALL 3 BOLTS ARE INSTALLED (10mm wrench)

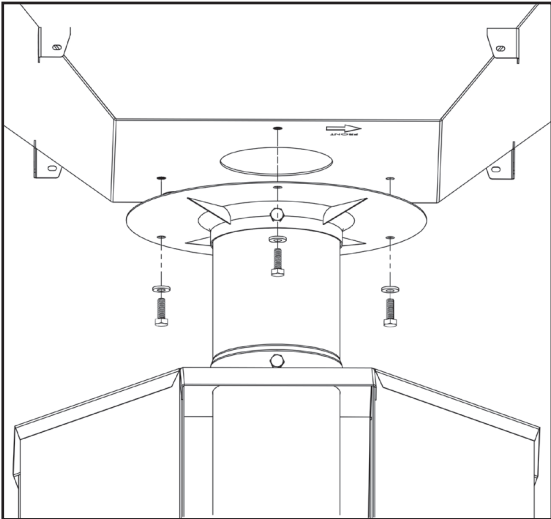

Align hardware with mounting plate holes and lift kit to hopper

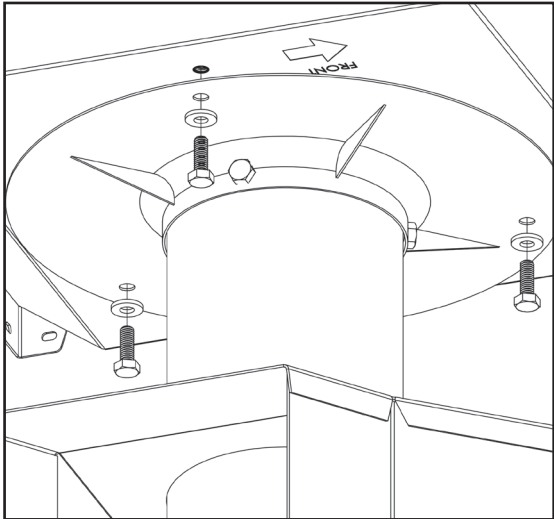

Insert a bolt and washer into each threaded nut

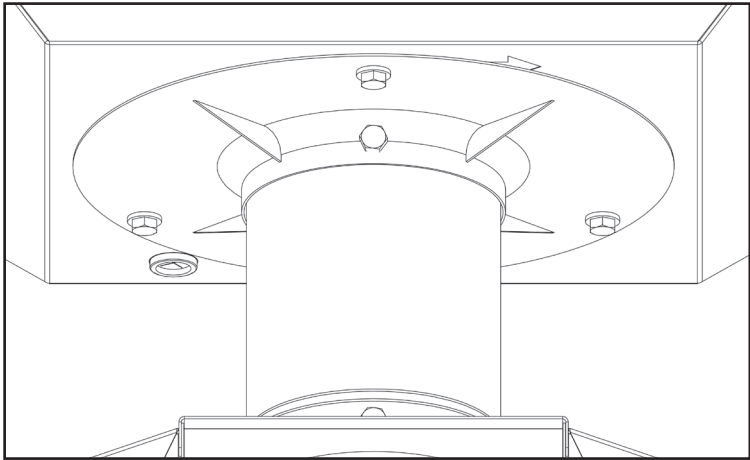

Tighten all mounting hardware



Our Service Department will gladly answer any questions you have.  
[www.moultriefeeders.com/support](http://www.moultriefeeders.com/support)