



Food/Waste Disposal Counter Top Switch

WARRANTY

one year replacement warranty



TYPICAL INSTALLATION

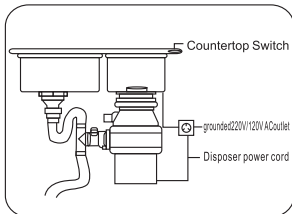

FINISHES INCLUDED

- Power module with grounded outlet
- One air switch button
- 5 Ft Long Air Tube
- 3 Ft Power cable
- Set Screws

STEP1: Mount Push Button

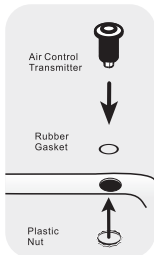

•Mount the push button directly through a standard sink hole
-OR- drill a minimum 1-1/4" hole.

•Place the rubber gasket between push button and the top of sink counter.

•Tighten the plastic nut under the sink counter to ensure a watertight seal.

•NOTE: If your sink hole is larger than the diameter of our button, please buy a stainless steel washer and put it between push button and rubber gasket.

STEP2: Attach Air Tube



•Attach air tubing between push button and power module.

•Make sure two sides of air tube have been connected well but not too tight

STEP3: Plug in Power Module

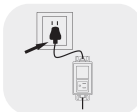

•Plug power module into a dedicated, grounded 220V/120V AC outlet which is continuously energized.

STEP4: Connect Power Module and Disposer

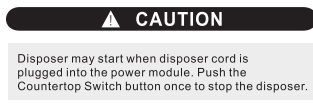

⚠ CAUTION

Disposer may start when disposer cord is plugged into the power module. Push the Countertop Switch button once to stop the disposer.

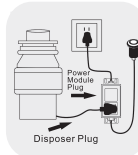

•Plug disposer cord into power module.

•Press push button to ensure that the Countertop Switch can turn the disposer on and off.

•Be sure that the control system is operating properly before using the unit.

•One push on, another push off. If you have any problem, please be free to contact us.