

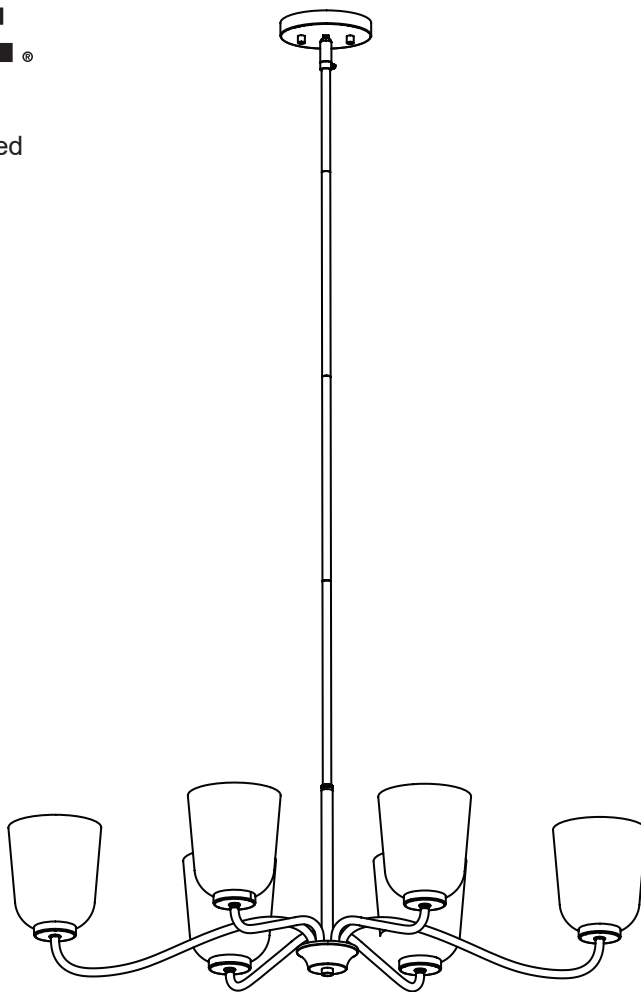

PROJECT SOURCE and logo design are trademarks or registered trademarks of LF, LLC. All rights reserved.

ITEM #5055172, 5108197, 5101827  
**6-LIGHT CHANDELIER**  
MODEL #42657, 42663, 42664

**Español p. 10**



**ATTACH YOUR RECEIPT HERE**

Purchase Date \_\_\_\_\_



**Questions, problems, missing parts?** Before returning to your retailer, call our customer service department at 866-389-8827, 8 a.m. - 8 p.m., EST, Monday - Sunday. You could also contact us at [www.lowespartsplus.com](http://www.lowespartsplus.com).

SC22393

**TABLE OF CONTENTS**

---

Package Contents. . . . . 3

Hardware Contents. . . . . 3

Preparation . . . . . 3

Safety Information. . . . . 4

Assembly Instructions. . . . . 5

Troubleshooting. . . . . 9

Warranty. . . . . 9

**PACKAGE CONTENTS** (not drawn to scale)

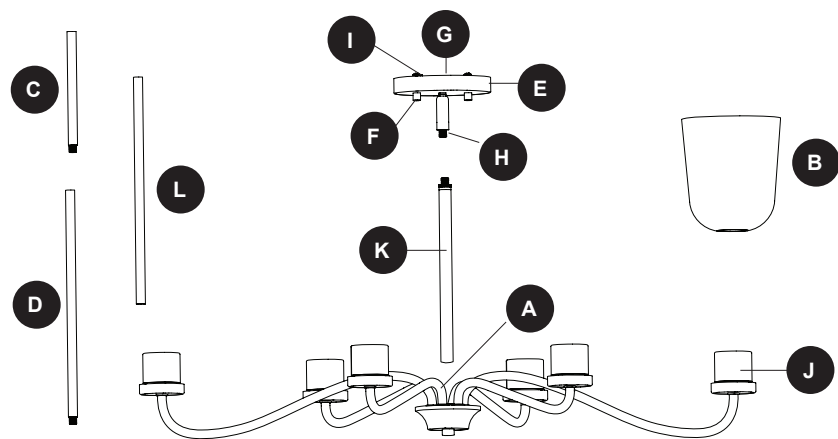

PART	DESCRIPTION	QUANTITY
A	Fixture	1
B	Shade	6
C	Short Rod	1
D	Long Rod With Threads	2
E	Ceiling Plate	1
F	Screw Cap (preassembled to Mounting Screw [I])	2
G	Mounting Bracket	1
H	Threaded Rod (preassembled to Ceiling Plate [E])	1
I	Mounting Screw (preassembled to Mounting Bracket [G])	2
J	Socket Ring (preassembled to Fixture [A])	6
K	Center Rod	1
L	Long Rod Without Threads	1

**HARDWARE CONTENTS**

AA



Wire Connector  
Qty. 3

RR



Mounting Screw  
Qty. 2

**PREPARATION**

**Estimated Assembly Time:** 60 minutes

Tools Required for Assembly (not included):

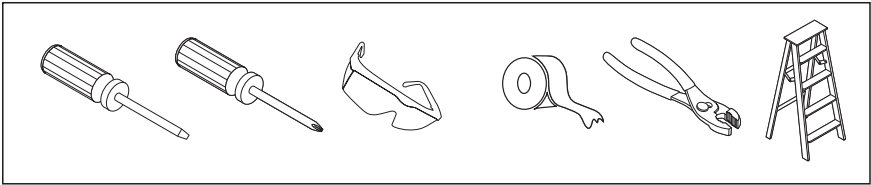

Helpful Tools (not included)

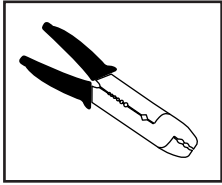

## SAFETY INFORMATION

---

Please read and understand this entire manual before attempting to assemble, operate or install the product. Failure to do so could lead to electrical shock, fire or other injuries that could be hazardous or even fatal.

- Before you begin installing the light kit, disconnect the power by removing fuses or turning off the circuit breakers.
- Make sure that all electrical connections comply with local codes, ordinances, the National Electrical Code, and ANSI/NFPA 70-199. Hire a qualified electrician or consult a do-it-yourself wiring handbook if you are unfamiliar with installing electrical wiring.
- The net weight of the light kit is 14.09 lb.
- This fixture is intended for indoor locations. It is not suitable for outdoor or damp locations.

### **DANGER:**

- DO NOT connect this fixture to an electrical system that does not provide a means for equipment grounding. Never use a fixture in a two-wire system that is not grounded. Installing a fixture into an electrical system not having a proper grounding means could cause metal parts of the fixture to carry electrical currents if any of the fixture wires, wire connections or splices were to become broken, cut or loose during the mounting or normal operation of the fixture. Under this condition, anyone coming in contact with the fixture would be subject to electrical shock, which could cause serious injury or death.
- DO NOT connect the bare or green insulation fixture ground wire to the black (hot) current-carrying wire or the white neutral house wire. Connection of the bare or green fixture ground wire to the black or white house wires may cause metal parts of the fixture to carry electrical currents. Under this condition anyone coming in contact with the fixture will receive electrical shock, which could cause serious injury or death.
- DO NOT damage or cut the wire insulation (covering) during installation of the fixture. DO NOT permit wires to contact any surface having a sharp edge. To do so may damage or cut the wire insulation, which could cause serious injury or death from electrical shock.

### **WARNING:**

- All electrical connections must be in agreement with local codes and ordinances, the National Electric Code (NEC) and ANSI/NFPA 70-1999. Contact your municipal building department to learn about your local codes, permits and/or inspections. Risk of fire - most dwellings built before 1985 have supply wire rated for 140°F. Consult a qualified electrician before installation.
- To avoid personal injury, the use of gloves may be necessary while handling fixture parts with sharp edges.
- DO NOT suspend any fixture by the house wires. A fixture must always be mounted directly to a an outlet box. Wire connectors will not support the weight of a fixture. Suspending a fixture by the house wires and wire connectors will result in the fixture falling, with the possibility of personal injury and the danger of electrical shock or fire.
- To reduce the risk of fire, electrical shock, or personal injury, each wire connector used with this light kit should accept only one 18-gauge wire from the light fixture and one 18-gauge wire from the outlet box. If there are three or more wires to connect or any of the wires is larger than 18 gauges, consult an electrician for the proper size wire connectors to use.

## ASSEMBLY INSTRUCTIONS

1. Turn off the circuit breakers and the wall switch to the supply line leads.



**DANGER:** Failure to disconnect the power supply prior to installation may result in serious injury or death.

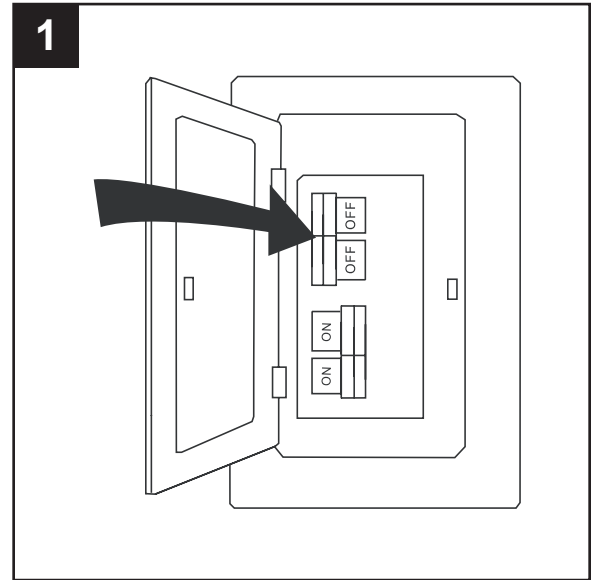

2. Remove the screw caps (F) from the mounting screws (I) preassembled to the mounting bracket (G) and save for later. Remove the mounting bracket (G) from the ceiling plate (E).

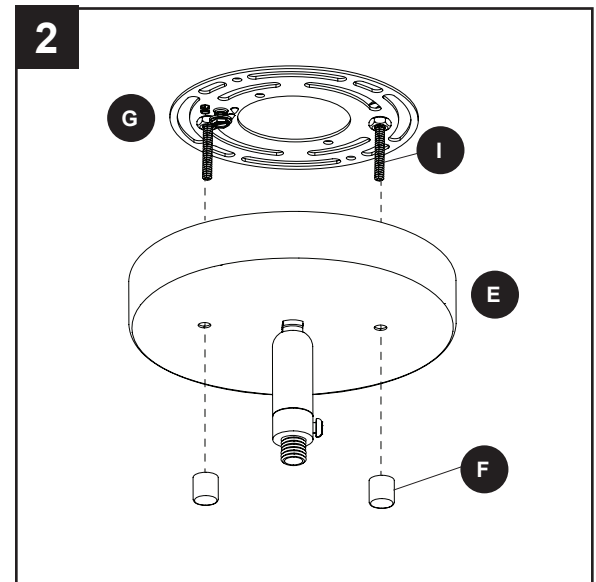

3. Attach the mounting bracket (G) to the outlet box using the mounting screws (RR).

### Hardware Used



Mounting  
Screw



x 2

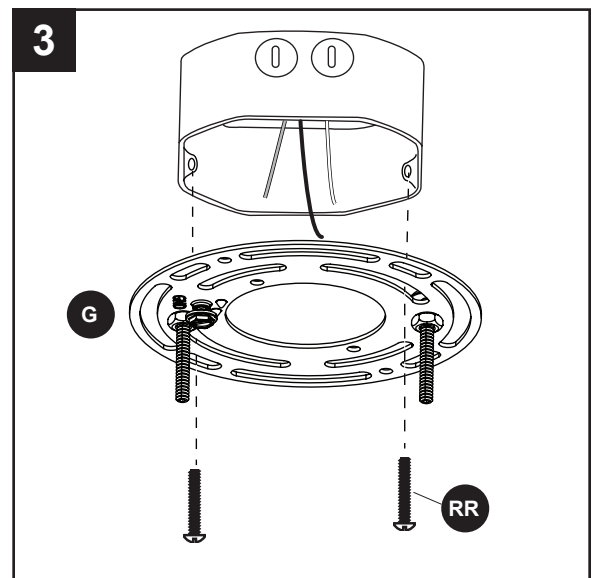

## ASSEMBLY INSTRUCTIONS

- Swivel the arms of the fixture (A) so there is equal distance between the arms.

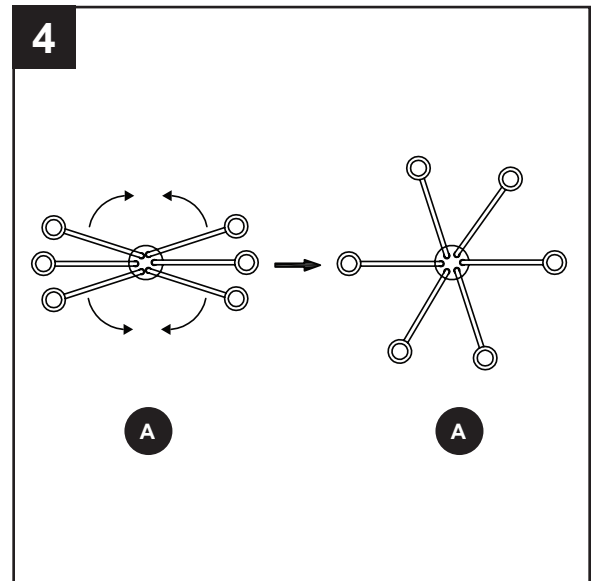

- Feed the wires from fixture (A) through the center rod (K). Then twist the center rod (K) clockwise into the center of fixture (A) until secure.

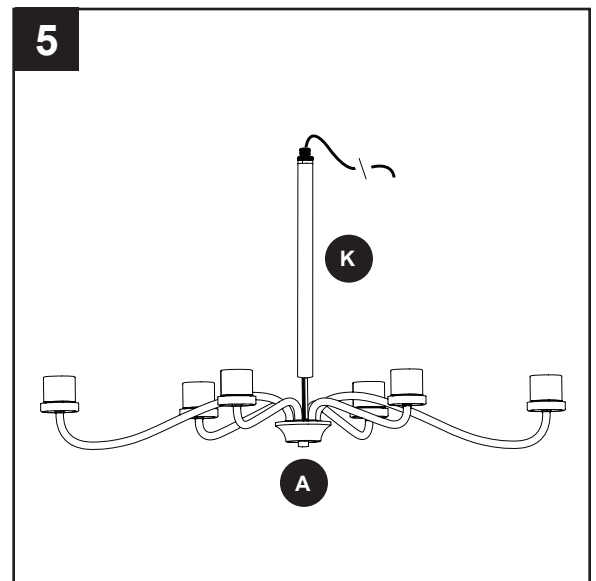

- Determine which combination of rods to use based on the desired length of the fixture. Then, feed the wires from fixture (A) through center hole in long rod without threads (L), long rods with threads (D), short rod (C), and out through the top of the ceiling plate (E). Then connect the rods by twisting them in a clockwise direction.

**Note:** The long rod without threads (L) will be closest to center rod (K). Should you decide not to utilize any long rods with threads (D) or the long rod without threads (L), you will need to remove the threads preassembled to short rod (C) in order to connect it directly to center rod (K).

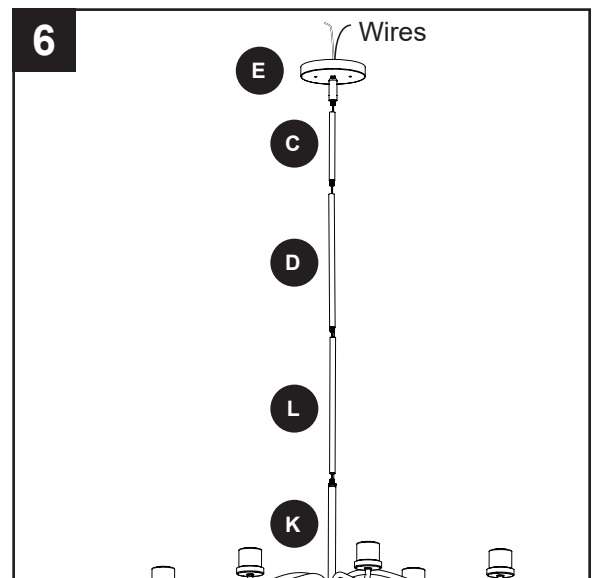

## ASSEMBLY INSTRUCTIONS

7. Connect supply and fixture (A) wires according to the diagram and these steps:
- Loosen the ground screw preassembled to mounting bracket (G) and wrap copper wire from fixture (A) around the ground screw. Retighten the ground screw.
  - Connect the Bare Copper from the fixture to the Bare/Green (ground) supply wire.
  - Connect the White wire from the fixture to the White (neutral) supply wire.
  - Connect the Black wire from the fixture to the Black (hot) supply wire.

Secure all wiring connections together with wire connectors (AA).

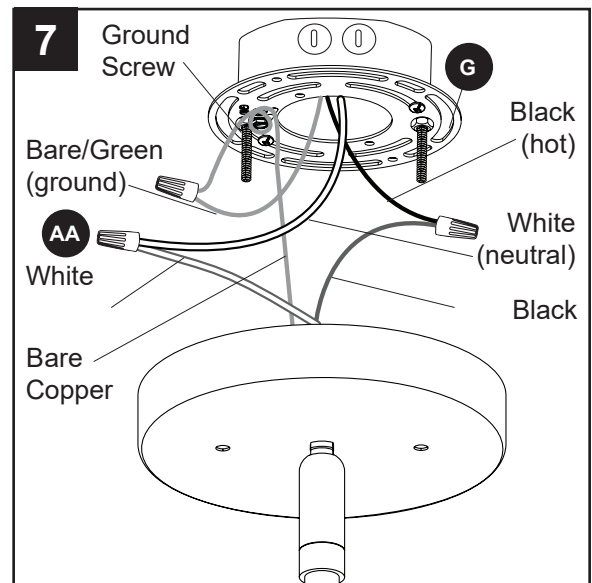

8. Wrap electrical tape (not included) around each individual wire connectors (AA) down to the wire. Turn the spliced/taped wires upward and gently push the wires and wire connectors (AA) into the outlet box.
- WARNING:** Ensure no bare wire strands are visible after making connections. Place the ground and neutral supply wire connections on opposite sides of outlet box from the hot wire connection.

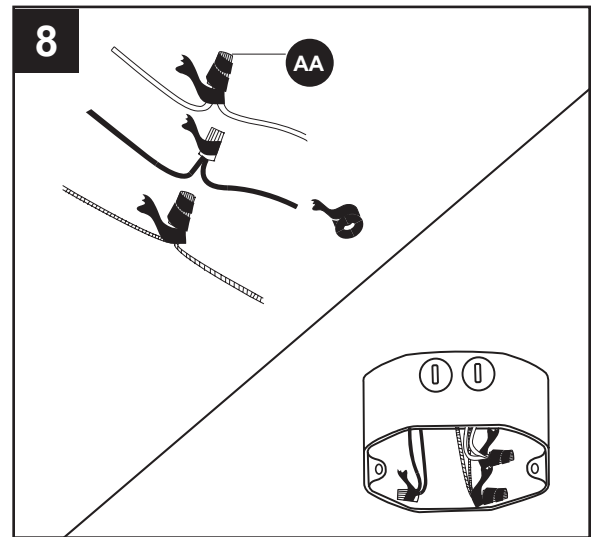

9. Lift the ceiling plate (E) onto the mounting screws (I) preassembled to the mounting bracket (G). Then use the screw caps (F) to secure the ceiling plate (E) to the mounting bracket (G). **Note:** If the ceiling plate (E) is not flush against the ceiling, remove the ceiling plate (E) and loosen the hex nuts to allow the mounting screw (I) length to be adjusted. Once adjusted retighten the hex nuts and reinstall the ceiling plate (E).

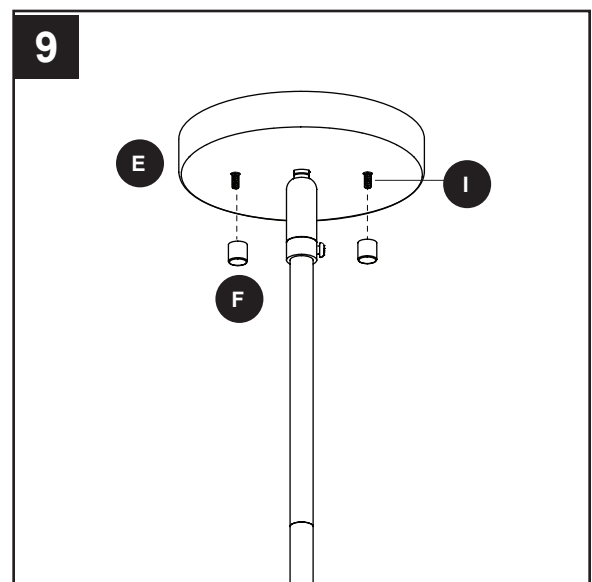

## ASSEMBLY INSTRUCTIONS

10. Turn socket ring (J) counterclockwise to remove from the socket of fixture (A). Place shade (B) over socket and secure with socket ring (J) by turning in a clockwise direction.

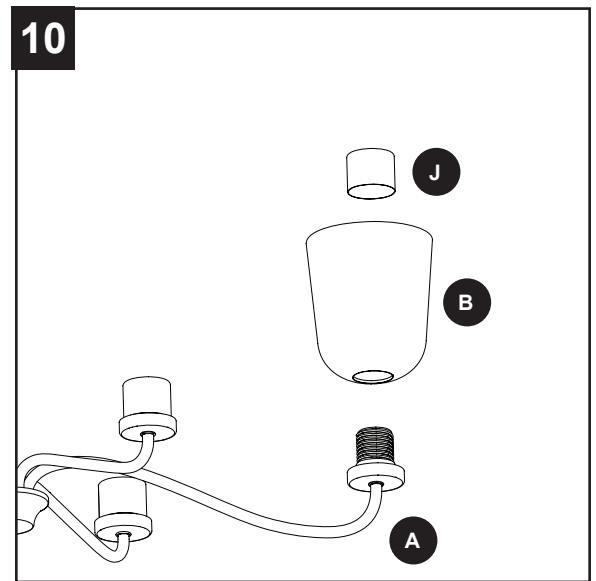

11. Insert E26-base bulbs (sold separately) into the sockets of the fixture (A).

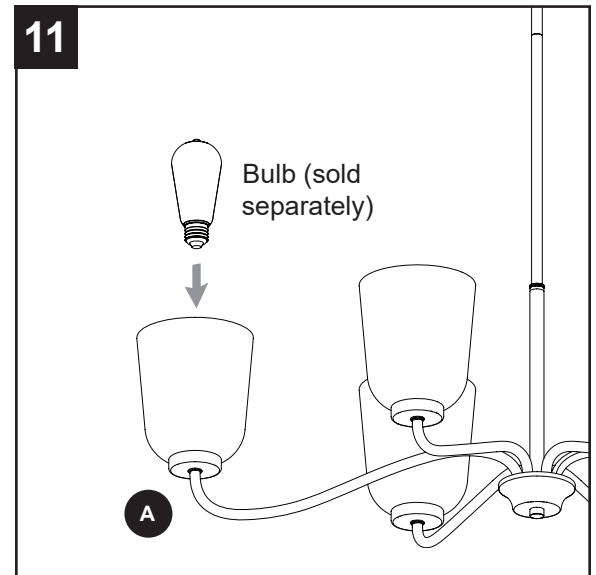

12. Restore the power to the circuit breakers and the wall switch to the supply line leads.

Assembly is complete.

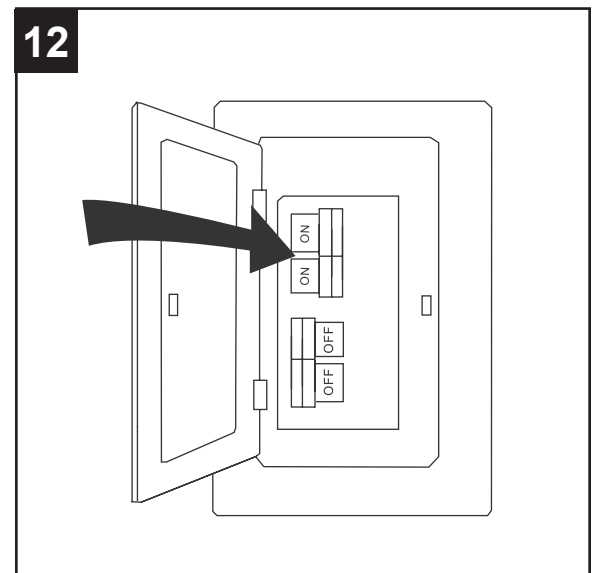



## TROUBLESHOOTING

---

PROBLEM	POSSIBLE CAUSE	CORRECTIVE ACTION
Bulbs will not light.	1. Fixture may be wired incorrectly. 2. Worn or broken bulbs.	1. Check wiring. 2. Replace bulbs.
Ceiling plate (E) does not sit flush with ceiling.	Edge of outlet box may not be flush with ceiling.	If the ceiling plate (E) is not flush against the ceiling, remove the ceiling plate (E) and loosen the hex nuts to allow the mounting screw (I) length to be adjusted. Once adjusted retighten the hex nuts and reinstall the ceiling plate (I).

## THREE-YEAR LIMITED WARRANTY

---

The manufacturer warrants all of its lighting fixtures against defects in materials and workmanship for three (3) years from the date of purchase. If within this period the product is found to be defective, take a copy of the bill of sale as a proof of purchase and the product in its original carton to the place of purchase. The manufacturer will, at its option, repair, replace or refund the purchase price to the consumer. All costs of installation and removal of the fixture is the responsibility of the consumer. This warranty does not cover fixtures becoming defective due to misuse, accidental damage or improper handling and/or installation and specifically excludes liability for direct, incidental or consequential damages. As some states do not allow exclusions of limitations on an implied warranty, the above exclusion and limitation may not apply. This warranty gives you specific rights and you may also have other rights which may vary from state to state.