



STURBRIDGE

VINYL YARD AND
POOL GATE WITH
STAINLESS STEEL
HARDWARE
(48"H X 48"W)

60 MIN

Approximate assembly time

*Want to see a video on how to
assemble this product?*

Scan the QR code



ASSEMBLY INSTRUCTIONS

BL19104

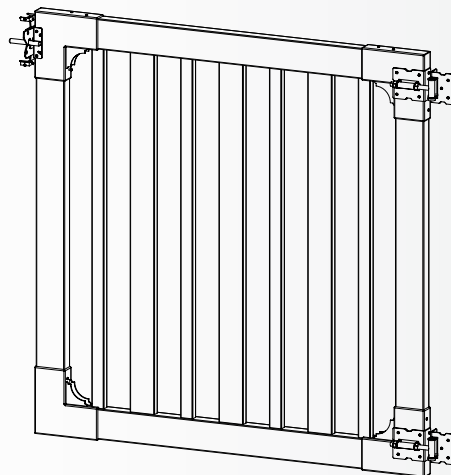

GENERAL INFORMATION



IMPORTANT

- ⊕ Check the inside of the larger pieces in your box for other materials packed inside.
- ⊕ When assembling components, place on a non-abrasive surface (i.e. shipping box) to avoid scratching.
- ⊕ We recommend an area approximately 5'x 8' for unobstructed assembling.
- ⊕ You should not need to use excessive force when assembling components.

MISSING OR DAMAGED PARTS?

VISIT OUR WEBSITE FIRST, SO WE CAN HELP YOU RIGHT AWAY!

Although great care has been taken to ensure proper packaging and handling of this product, occasionally problems occur. If you discover any missing, damaged, or defective parts, please visit our website to order replacement parts. If you experience any further trouble with your product, please contact our customer service department.

 parts.nychbrands.com

 hmmm@wambamfence.com

 **704-892-5222 / 877-778-5733**

Customer service agents are available to take calls weekdays from 9am-5pm EST. If you call outside of business hours, please leave a voicemail.

To help you quickly and accurately, please have reference item number **BL19104** and the specific part name which can be found on page 5. It is helpful if you can provide the batch lot which is a stamped number on the inside of the box.

NEED ASSEMBLY HELP?

If you are having problems with the assembly or installation of this product, we are happy to assist you with the process, **so please give us a call at 704-892-5222 / 877-778-5733.**

NEED TO RETURN?

If for some reason you need to return this product, please allow us to help resolve your issues first. If you still decide to return the product, **you will need to initiate the return from the company you originally purchased from.**

GENERAL INFORMATION

1. Read over fence instructions first.

Your gate and fence will work better together if you first take the time to read and understand your fence.

2. Pre-assemble the gate frame.

Please do not screw the gate frame together until you have temporarily assembled the gate frame. In other words, do a dry run first. This will ensure:

1. That you have everything necessary to complete the gate.
2. That you will have assembled the gate frame in the correct order.
3. All of the pieces fit and function properly.
4. The gate height and width are similar to the measurements shown on page four.

It's easier to troubleshoot when things are not screwed together. After you assemble your gate correctly, please disassemble as necessary, and use the 1¼" self-drilling stainless steel screws to permanently assemble the gate.

3. Install your gate posts before your fence posts.

Your fence panels will be more forgiving for a custom fit than your gate. Position and install your gate posts before you do anything else.

4. Do not hang your gate system off a single non-supported post.

Your gate will perform better and last longer if your hinge post is connected to a panel of fence that is connected to another post. This way, the weight strain will be transferred onto two posts versus just one. Installing fence panels on both sides of your gate is ideal in all situations. If this is not possible because of space restrictions, please contact us for alternative solutions.

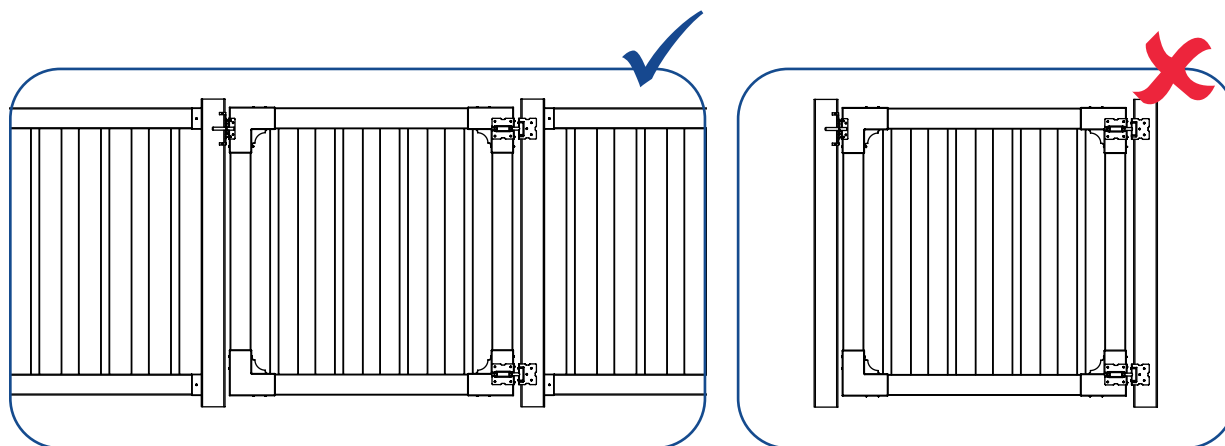

DETAILED PRODUCT DIMENSIONS AND SPECIFICATIONS

Profile Dimensions

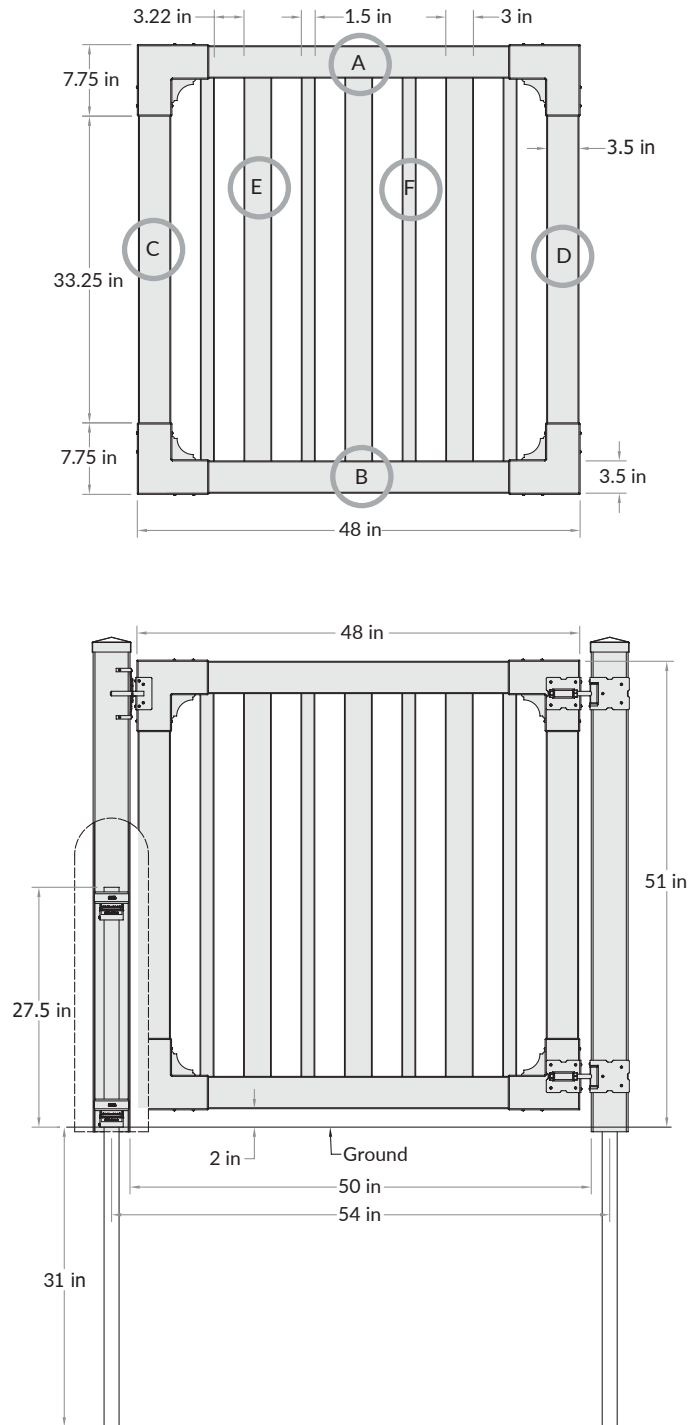
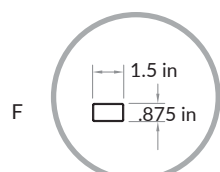
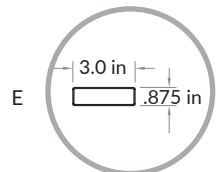
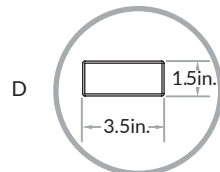
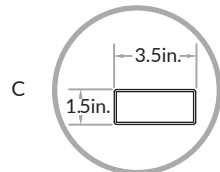
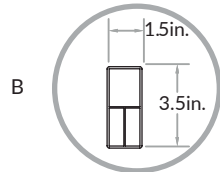
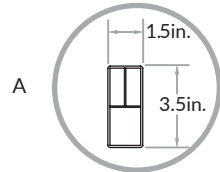

STEP 1: LAY OUT MATERIALS

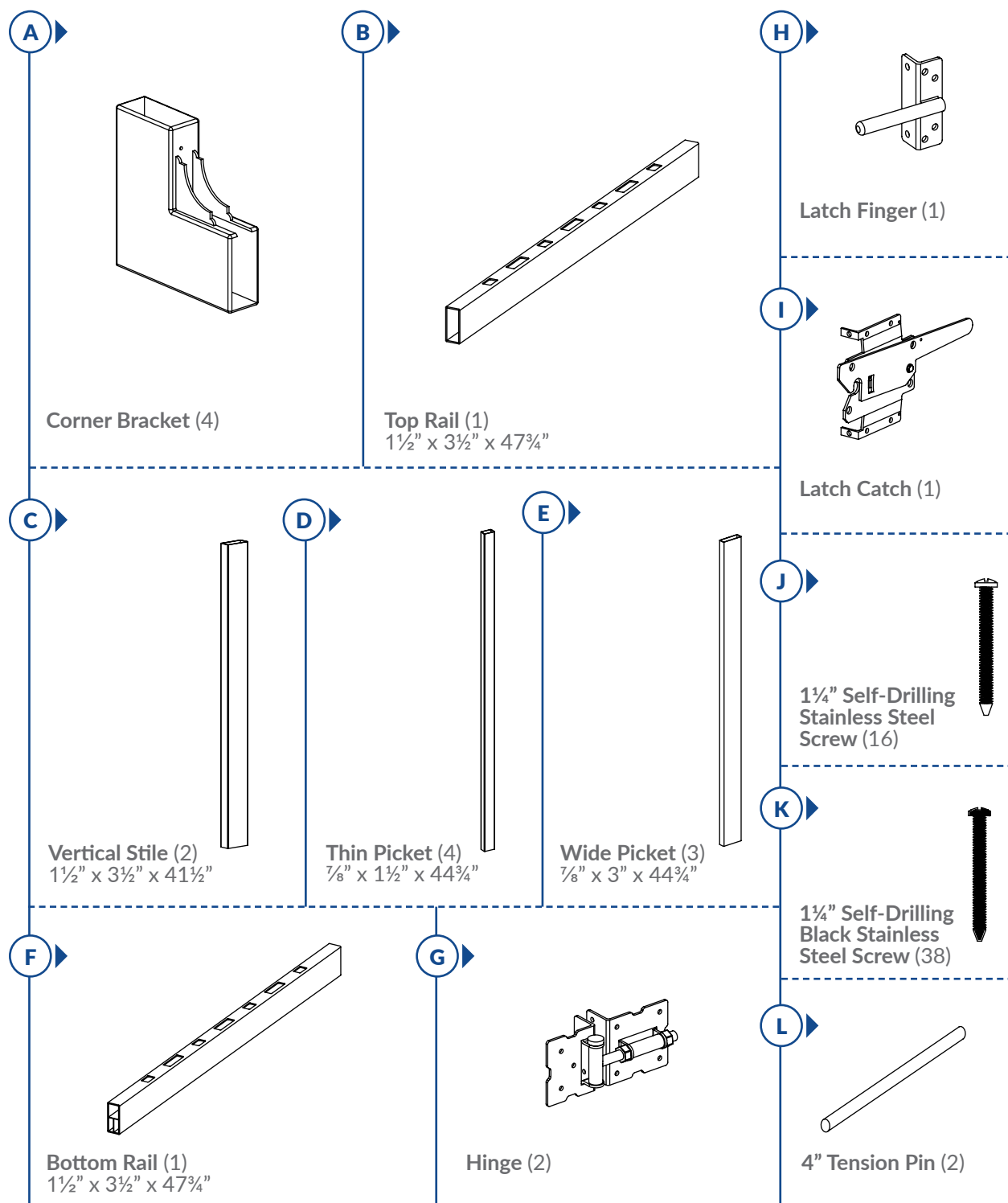

STEP 2: ASSEMBLE GATE FRAME

STEP 2.1 ▶

▶ Insert the Bottom Rail (F) all the way into the Corner Bracket (A) until it hits the back of the corner bracket as illustrated.

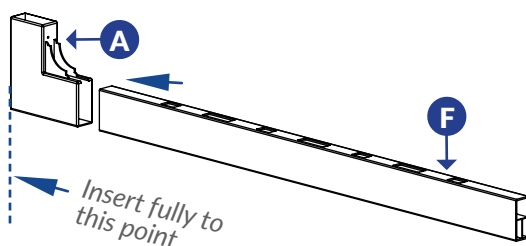

STEP 2.2 ▶

▶ Insert the bottom rail all the way into the opposite corner bracket until it hits the back as illustrated.

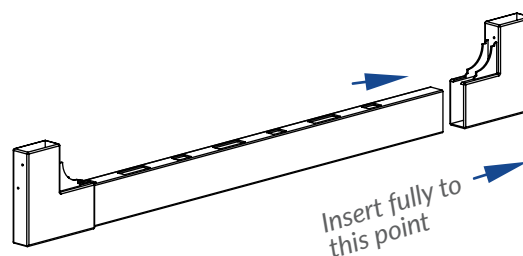

STEP 2.3 ▶

▶ Ensure the bottom rail hits the back of the bottom brackets as illustrated. Measure the distance between the two bottom brackets to ensure the width is 48 inches.

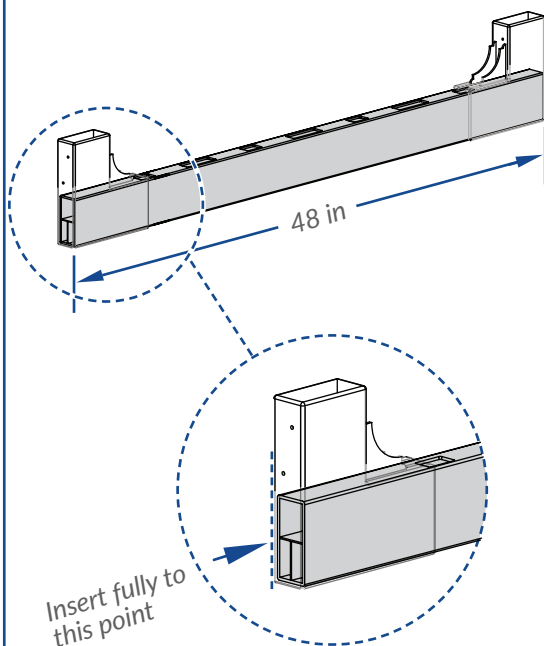

STEP 2.4 ▶

▶ Insert (2) Vertical Stiles (C) into the gate bottom brackets until they hit the bottom rail.

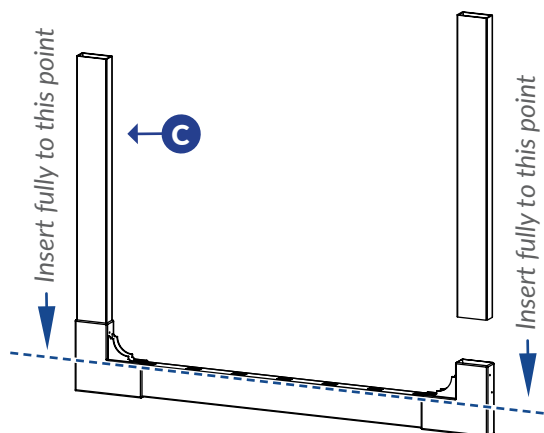

STEP 2.5 ▶

▶ Insert the Top Rail (**B**) all the way into a corner bracket until it hits the corner of the bracket as illustrated.

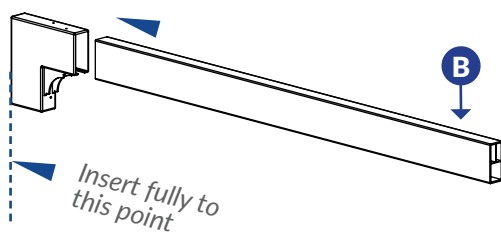
**STEP 2.6** ▶

▶ Insert the top rail all the way into the opposite corner bracket until it hits the corner of the bracket as illustrated.

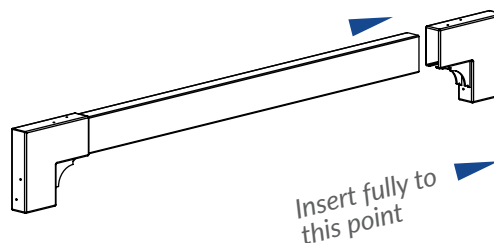
**STEP 3: INSERT PICKETS AND ATTACH GATE FRAME TOP****STEP 3.1** ▶

▶ Insert Thin Pickets (**D**) and Wide Pickets (**E**) into the bottom rail as shown.

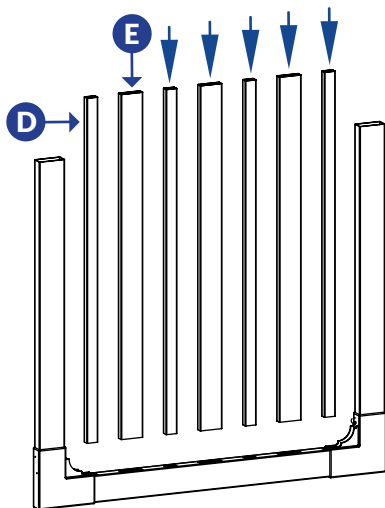
**STEP 3.2** ▶

▶ Slide the assembled gate frame top down over the pickets and verticle stiles.

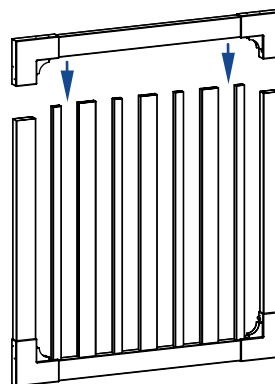

Completely assembled gate frame

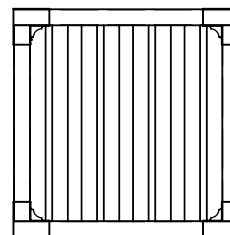

STEP 4: SCREW GATE FRAME TOGETHER

STEP 4.1 ▶

▶ Fasten the gate frame together using (16) 1 ¼" Self-Drilling Stainless Steel Screws (J).

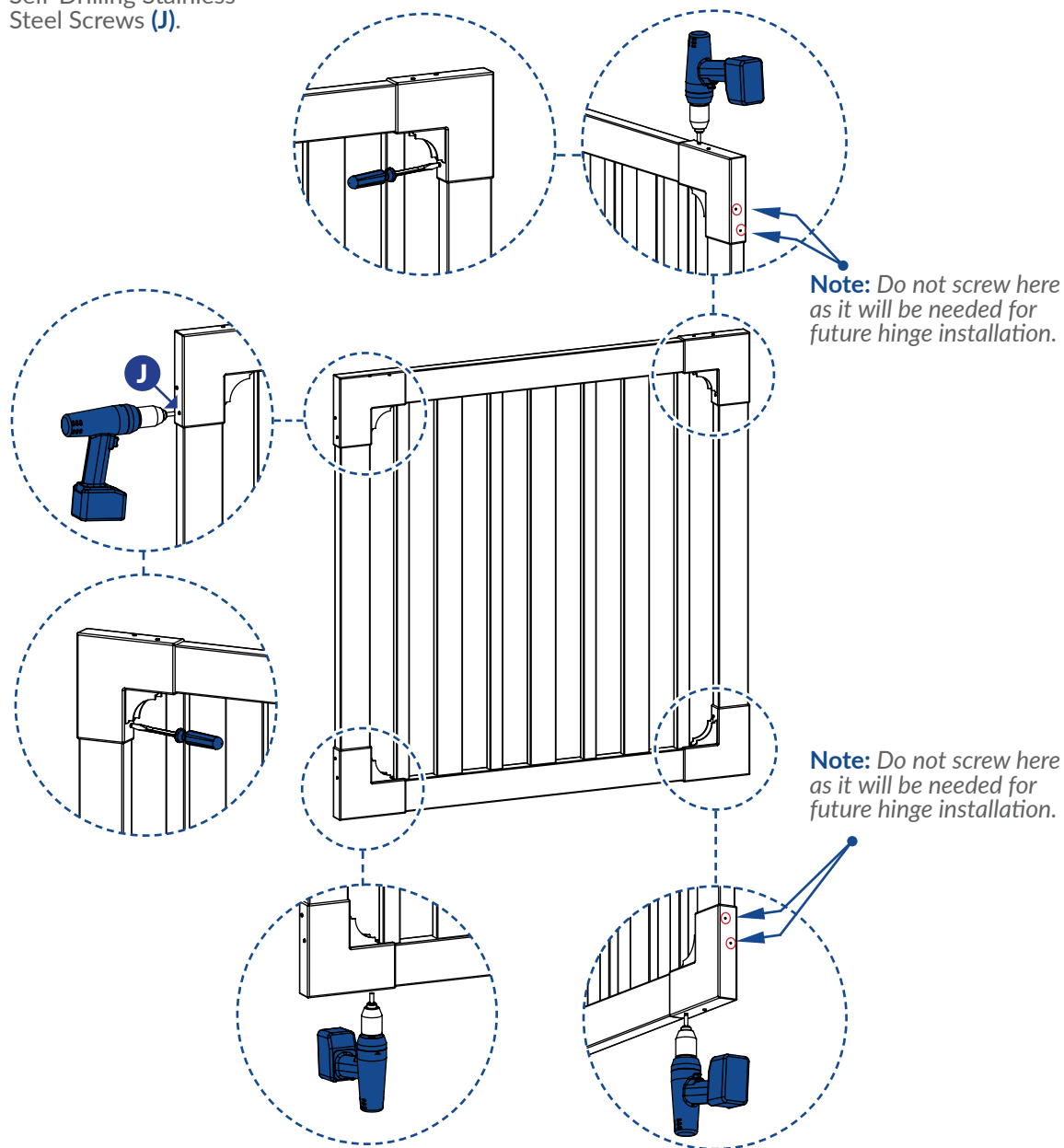

STEP 5: FASTEN GATE HINGES AND GATE LATCH

STEP 5.1 ▶

1. Fasten (2) Hinges (**G**) onto the corner brackets with (8) 1 ¼" Self-Drilling Black Stainless Steel Screws (**K**).
2. Fasten the Latch Finger (**H**) onto the upper corner bracket with (6) 1 ¼" Self-Drilling Black Stainless Steel Screws.

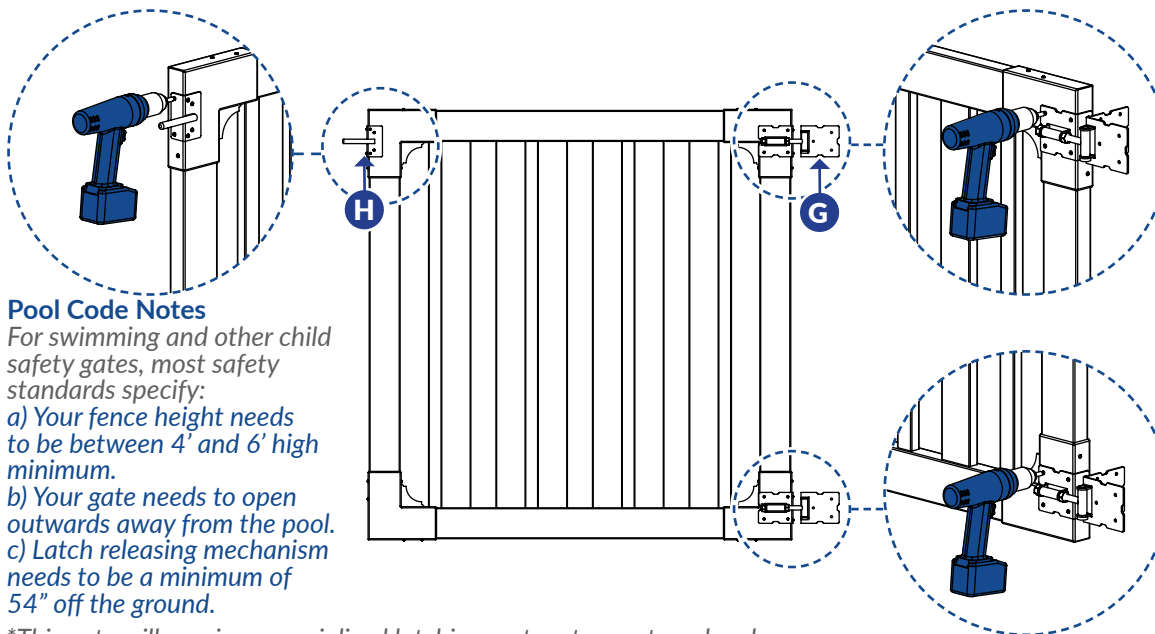

Pool Code Notes

For swimming and other child safety gates, most safety standards specify:

- a) Your fence height needs to be between 4' and 6' high minimum.
- b) Your gate needs to open outwards away from the pool.
- c) Latch releasing mechanism needs to be a minimum of 54" off the ground.

*This gate will require a specialized latching system to meet pool code.

Use MagnaLatch Top Pull Hardware (not included).

MagnaLatch Top Pull Code is # MLTPS2BGA.

*Always confirm these and other requirements with the appropriate authorities in your area. Code will change from one location to another across the country.

STEP 6: ALIGN AND SECURE GATE HINGES TO POSTS

STEP 6.1 ▶

- ▶ Use temporary spacers or blocks to rest the gate on.

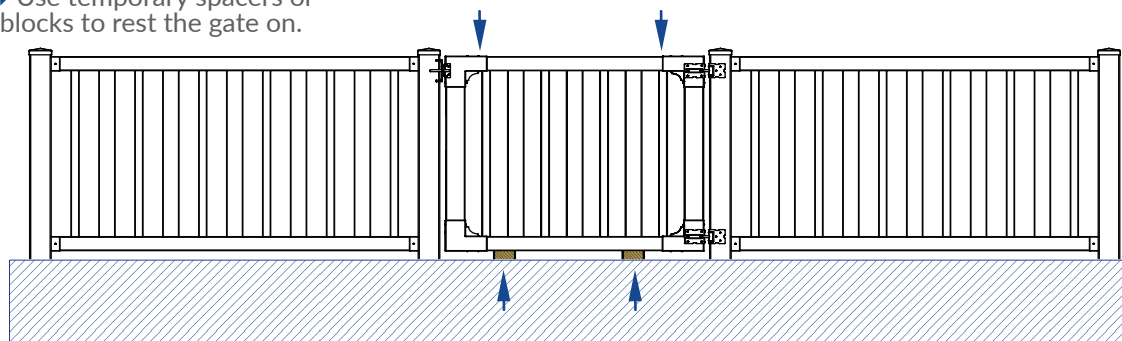

STEP 6.2 ▶

▶ Fasten the hinges to the fence post using (6) 1 ¼" black self-drilling stainless steel screws.

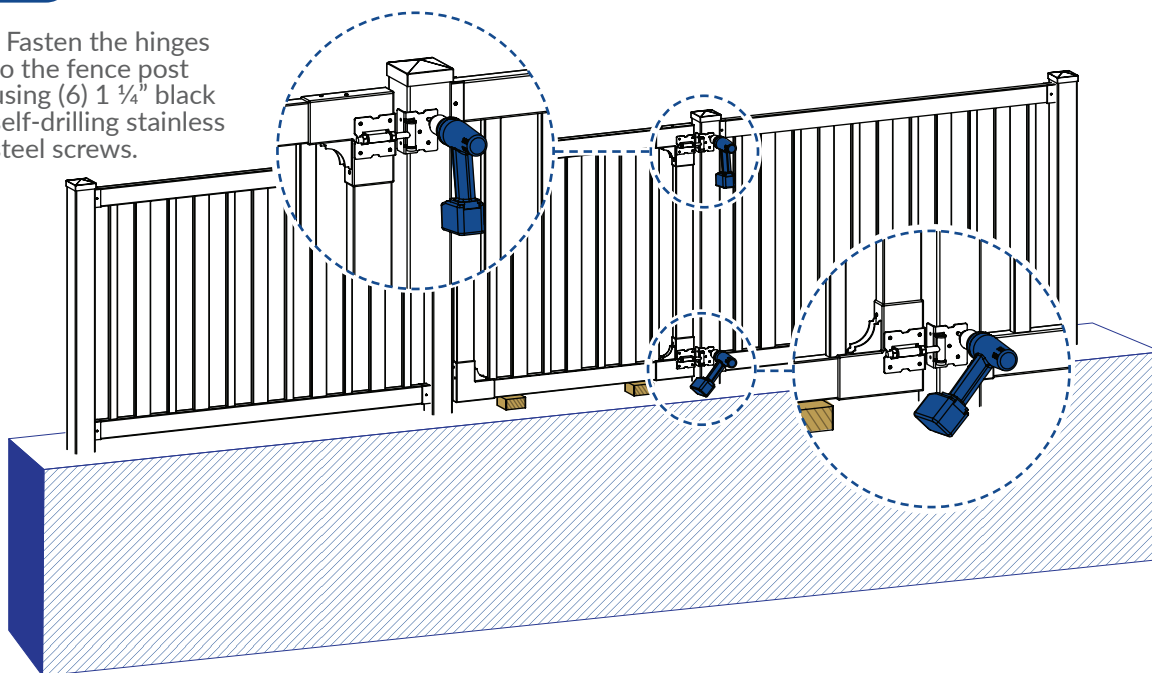
**STEP 7: LEVEL GATE AND ADJUST HINGES****STEP 7.1** ▶

▶ Fasten the hinges to the inside of the fence post by swinging the gate out as illustrated and by using (12) 1 ¼" self-drilling black stainless steel screws.

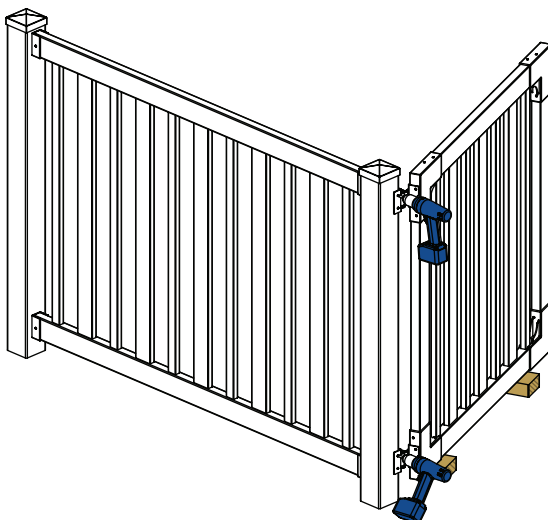
**STEP 7.2** ▶

▶ Level the gate to the fence post. Check the gate to make sure it functions correctly.

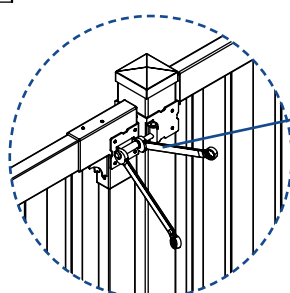
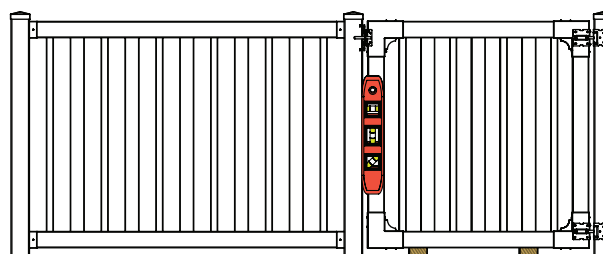

Note: The hinges can be adjusted moderately to level the gate.

Note: To adjust the spring tension in the hinges, use a steel 4" Tension Pin (L).

STEP 8: ALIGN AND INSTALL LATCH CATCH

STEP 8.1

► Align and fasten the Latch Catch (I) to the fence post by using (6) 1 ¼" self-drilling black stainless steel screws.

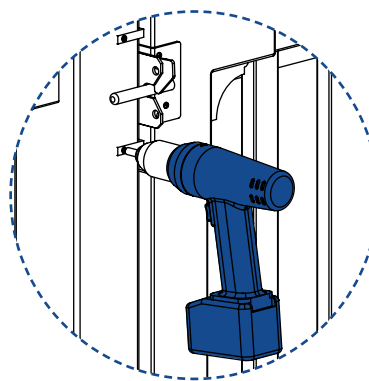
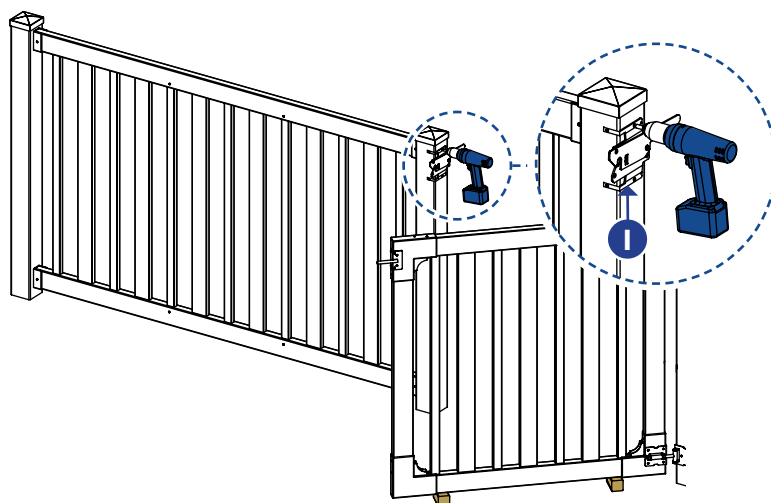

Note: The latch is designed for left and right hand applications. To reverse the latch, temporarily remove the spring and bolt, and reverse the paddle portion as necessary.

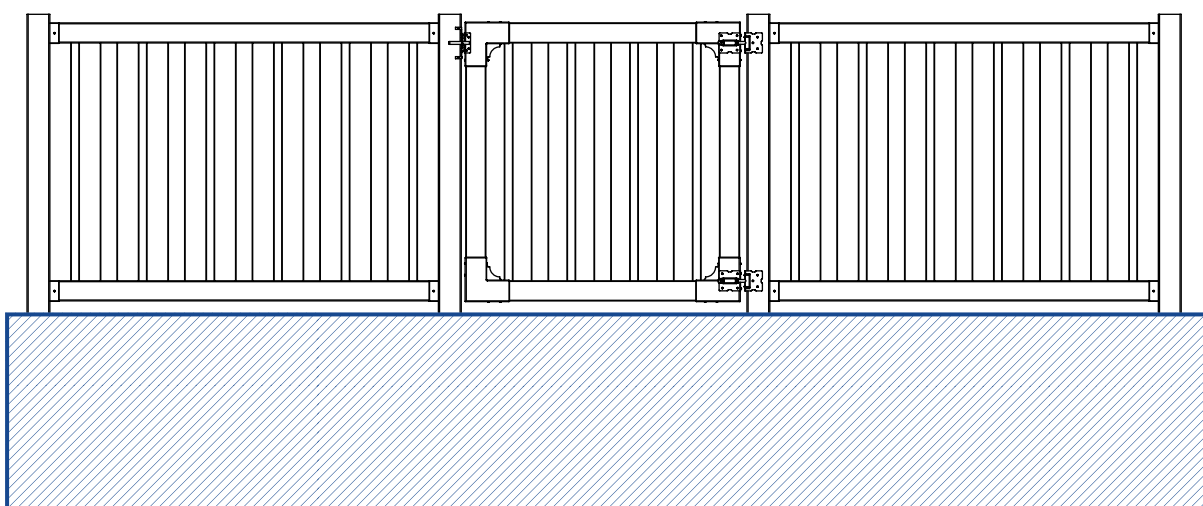



6935 Reames Rd. Ste. K.
Charlotte, NC 28216



hmmm@wambamfence.com

704-892-5222
877-778-5733



WWW.WAMBAMFENCE.COM