

allen + roth®

welcoming • sophisticated • inspiring

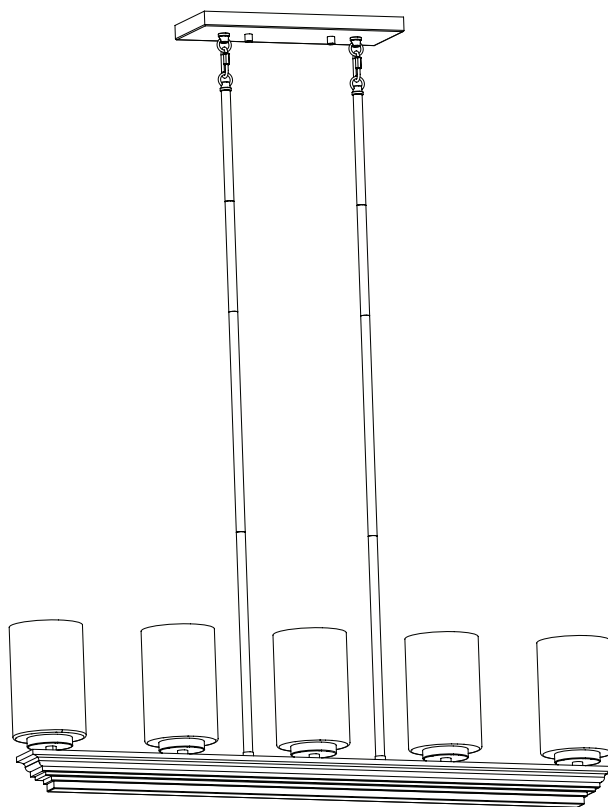

ALLEN + ROTH and logo design are trademarks or registered trademarks of LF, LLC. All rights reserved.

ITEM #5644922

## 5-LIGHT ISLAND

MODEL #43050

**ATTACH YOUR RECEIPT HERE**

**Español p. 10**

Purchase Date \_\_\_\_\_



SS23719

Thank you for purchasing this ALLEN + ROTH product.

Questions, problems or missing parts?

Before returning, contact us at:

866-439-9800, 8 a.m. - 8 p.m., EST, Monday - Sunday or [ascs@lowes.com](mailto:ascs@lowes.com).

**TABLE OF CONTENTS**

---

Package Contents. . . . . 3

Hardware Contents. . . . . 3

Preparation . . . . . 3

Safety Information. . . . . 4

Assembly Instructions. . . . . 5

Troubleshooting. . . . . 9

3-Year Limited Warranty. . . . . 9

PACKAGE CONTENTS

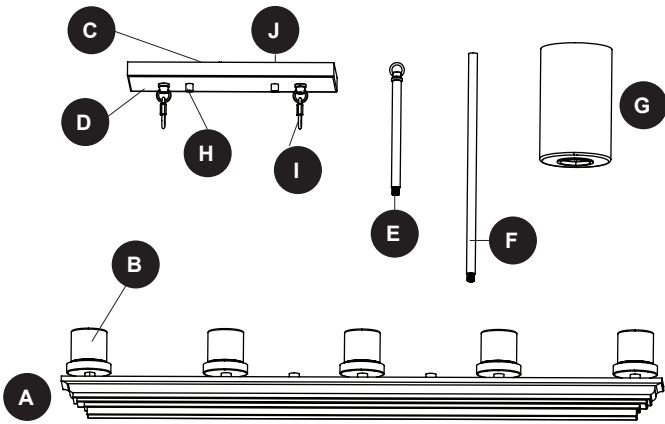

PART	DESCRIPTION	QUANTITY
A	Fixture	1
B	Socket Rings (preassembled to Fixture [A])	5
C	Mounting Bracket	1
D	Canopy (preassembled to Mounting Bracket [C])	1
E	Short Rod	4
F	Long Rod	8
G	Glass Shade	5
H	Screw Cap (preassembled to Mounting Screw [J])	2
I	Open Link (preassembled to Canopy [D])	2
J	Mounting Screw (preassembled to Mounting Bracket [C])	2

HARDWARE CONTENTS

AA



Wire Connector  
Qty. 3

RR



Bracket Screw  
Qty. 2

PREPARATION

Estimated Assembly Time: 60 minutes

Tools Required for Assembly (not included):

Helpful Tools (not included)

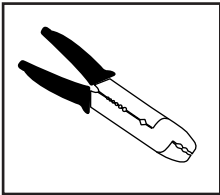
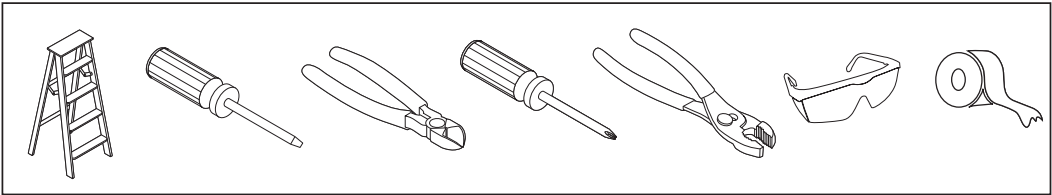

## SAFETY INFORMATION

---

Please read and understand this entire manual before attempting to assemble, operate or install the product. Failure to do so could lead to electrical shock, fire or other injuries that could be hazardous or even fatal.

- Before you begin installing the light kit, disconnect the power by removing fuses or turning off the circuit breakers.
- The net weight of the light kit is 11.84 lb.
- This fixture is intended for indoor use. It is not suitable for damp or outdoor locations.



### **DANGER:**

- DO NOT connect this fixture to an electrical system that does not provide a means for equipment grounding. Never use a fixture in a two-wire system that is not grounded. Installing a fixture into an electrical system not having a proper grounding means could cause metal parts of the fixture to carry electrical currents if any of the fixture wires, wire connections or splices were to become broken, cut or loose during the mounting or normal operation of the fixture. Under this condition, anyone coming in contact with the fixture would be subject to electrical shock, which could cause serious injury or death.
- DO NOT connect the bare or green insulation fixture ground wire to the black (hot) current-carrying wire or the white neutral house wire. Connection of the bare or green fixture ground wire to the black or white house wires may cause metal parts of the fixture to carry electrical currents. Under this condition anyone coming in contact with the fixture will receive electrical shock, which could cause serious injury or death.
- DO NOT damage or cut the wire insulation (covering) during installation of the fixture. DO NOT permit wires to contact any surface having a sharp edge. To do so may damage or cut the wire insulation, which could cause serious injury or death from electrical shock.



### **WARNING:**

- All electrical connections must be in agreement with local codes and ordinances, the National Electric Code (NEC) and ANSI/NFPA 70-1999. Contact your municipal building department to learn about your local codes, permits and/or inspections. Risk of fire - most dwellings built before 1985 have supply wire rated for 140°F. Consult a qualified electrician before installation.
- To avoid personal injury, the use of gloves may be necessary while handling fixture parts with sharp edges.
- DO NOT suspend any fixture by the house wires. A fixture must always be mounted directly to a an outlet box. Wire connectors will not support the weight of a fixture. Suspending a fixture by the house wires and wire connectors will result in the fixture falling, with the possibility of personal injury and the danger of electrical shock or fire.
- To reduce the risk of fire, electrical shock, or personal injury, each wire connector used with this light kit should accept only one 18-gauge wire from the light fixture and one 18-gauge wire from the outlet box. If there are three or more wires to connect or any of the wires is larger than 18 gauges, consult an electrician for the proper size wire connectors to use.
- If using the fixture in a wet location, the outlet must be connected to a supply circuit that is protected by a Ground Fault Circuit Interrupter (GFCI) to reduce the risk of personal injury, electrical shock or death.

## ASSEMBLY INSTRUCTIONS

1. Turn off the circuit breakers and the wall switch to the supply line leads.

**⚠ DANGER:** Failure to disconnect the power supply prior to installation may result in serious injury or death.

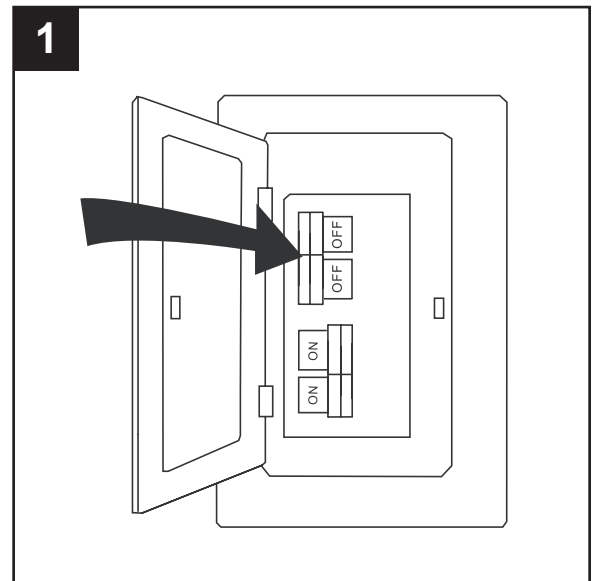

2. Remove the screw caps (H) from the mounting screws preassembled to the mounting bracket (C). Remove the mounting bracket (C) from the canopy (D).

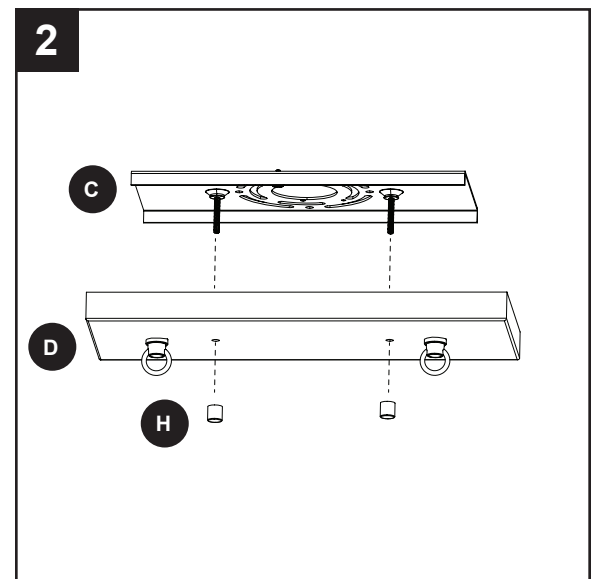

3. Use the bracket screws (RR) to attach the mounting bracket (C) securely to the outlet box (sold separately).

### Hardware Used

**RR** Bracket Screw  x 2

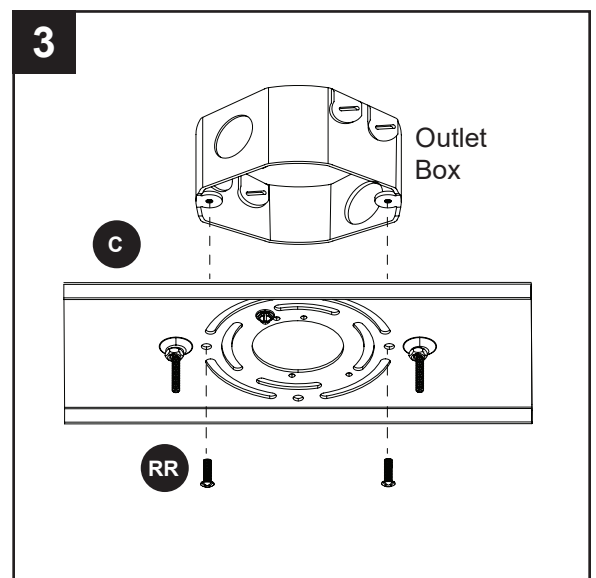

## ASSEMBLY INSTRUCTIONS

4. Determine which combination of short rods (E) and long rods (F) to use, based on the desired length of the fixture (A). Twist the wire ends coming from the fixture (A) together and feed through hole in the first rod (F). Connect the first long rod (F) to the fixture (A) by twisting the threaded end onto the fixture (A) in a clockwise direction until secure. Feed the wires through the remainder of the desired rods and then connect the rods by twisting them in a clockwise direction.

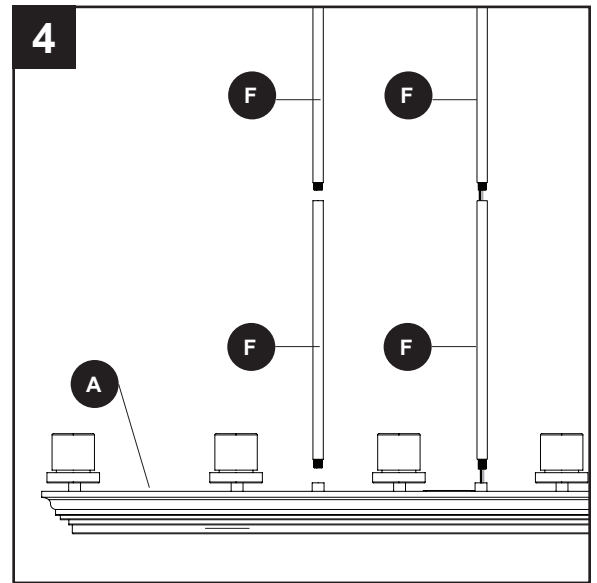

5. Use the two open links (I) to attach the short rods (E) to the chain loop (I). Feed the wires from the short rod (E) through the canopy (D).

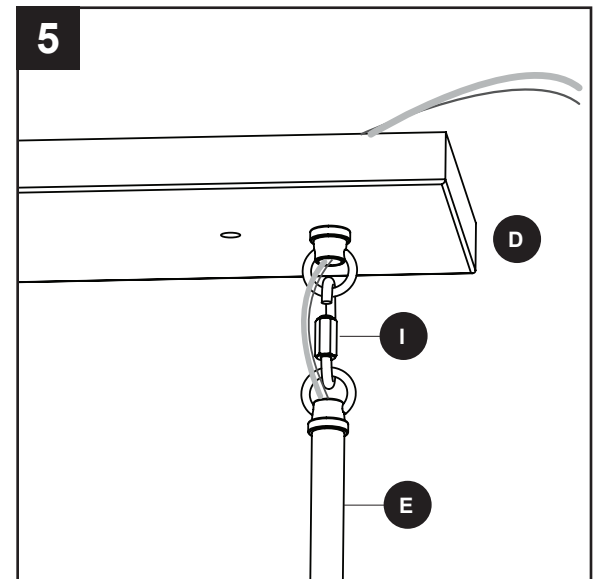

6. Separate the two wires all the way to the mounting bracket. Strip 1/2 in. of insulation from the end of the wires. Twist the stripped ends of each strand of wire within the insulation with pliers (not included).

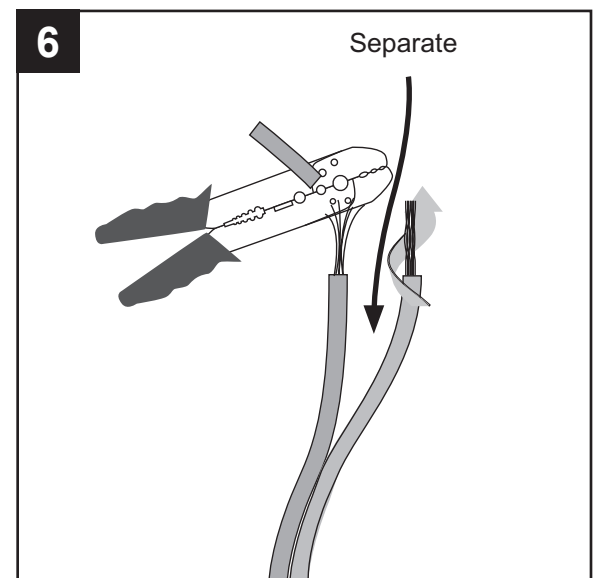

## ASSEMBLY INSTRUCTIONS

7. Notice one wire is smooth and the other has ridges on one side.

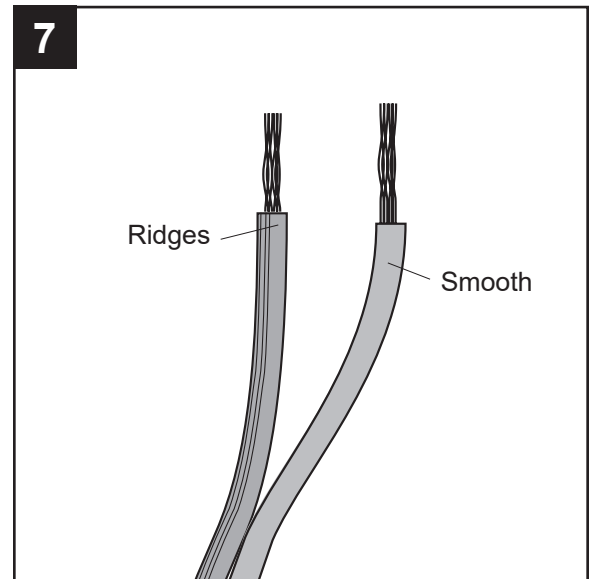

8. Loosen the ground screw on the mounting bracket (C) and wrap the bare wire from the fixture around the ground screw. Tighten the ground screw to hold the bare wire in place. **Note:** Ensure there is enough of the bare wire extending from the ground screw to connect to the ground wire from the outlet box using a wire connector.

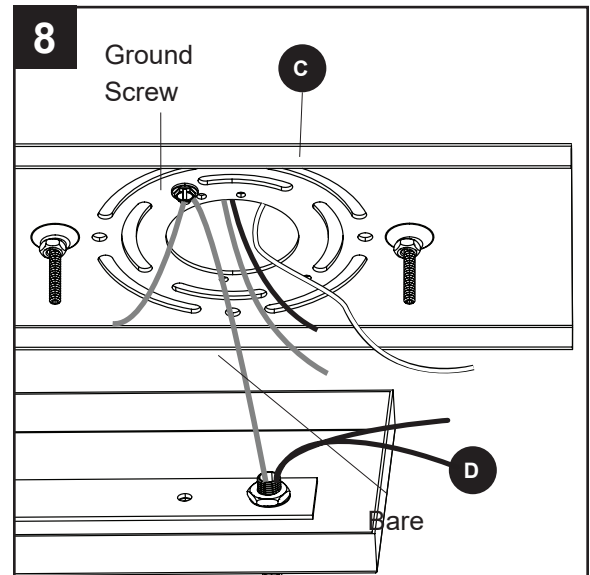

9. Use wire connectors(AA) to secure the household supply wires to the fixture (A) wires according to the image and the following instructions:

- Connect the black (hot) supply wire to the black wire from the fixture.
- Connect the white (neutral) supply wire to the white wire from the fixture.
- Connect the bare/green (ground) supply wire to the bare wire from the fixture.

Turn the wire connections upward and gently push them into the outlet box.

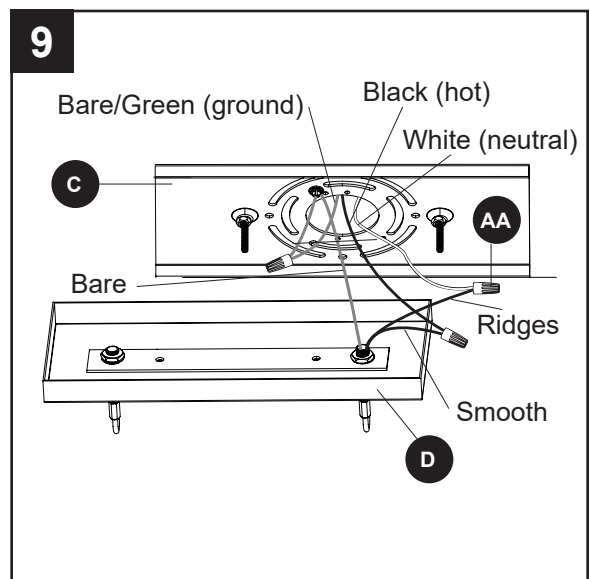

### Hardware Used

**AA** Wire Connector



x 2

## ASSEMBLY INSTRUCTIONS

10. Lift the canopy (D) up to the mounting screws (J) preassembled to the mounting bracket (C). Then use the screw caps (H) to secure the canopy (D) to the mounting bracket (C). **Note:** If the canopy (A) is not flush against the ceiling, remove the canopy (D) and loosen the hex nuts to allow the mounting screw (J) length to be adjusted. Once adjusted retighten the hex nuts and reinstall canopy (D).

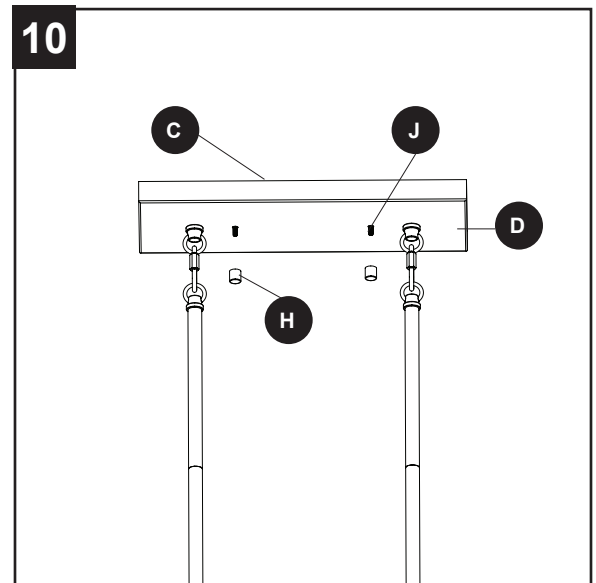

11. Remove the socket ring (B) from each socket. Raise the glass shade (G) over the socket of the fixture (A). Secure the glass shade (G) by twisting the socket ring (B) clockwise onto the socket. Repeat for each socket.

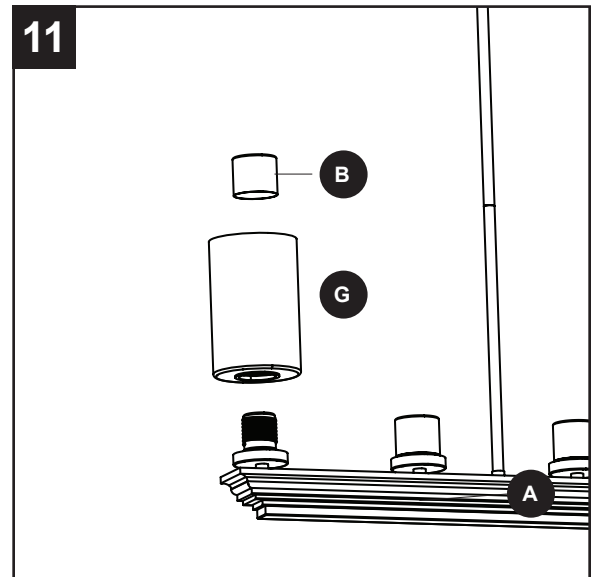

12. Install the E26-base bulb (sold separately) into the socket of the fixture. **Note:** Fixture is compatible with any E26-base LED, CFL, or incandescent bulb (60 watt max.).

Restore the power at the main fuse or circuit breaker and wall switch.

Assembly is complete.

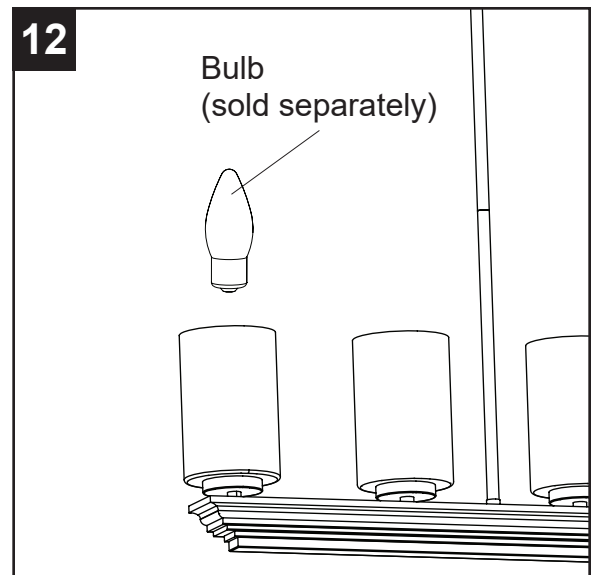



## TROUBLESHOOTING

---

PROBLEM	POSSIBLE CAUSE	CORRECTIVE ACTION
Bulbs will not light.	1. Fixture may be wired incorrectly. 2. Worn or broken bulb.	1. Check wiring. 2. Replace bulb.
Canopy (D) does not sit flush with ceiling.	Edge of outlet box may not be flush with ceiling.	Loosen and adjust the hex nuts on the two preassembled screws.

## THREE-YEAR LIMITED WARRANTY

---

The manufacturer warrants all of its lighting fixtures against defects in materials and workmanship for three (3) years from the date of purchase. If within this period the product is found to be defective, take a copy of the bill of sale as a proof of purchase and the product in its original carton to the place of purchase. The manufacturer will, at its option, repair, replace or refund the purchase price to the consumer. All costs of installation and removal of the fixture is the responsibility of the consumer. This warranty does not cover fixtures becoming defective due to misuse, accidental damage or improper handling and/or installation and specifically excludes liability for direct, incidental or consequential damages. As some states do not allow exclusions of limitations on an implied warranty, the above exclusion and limitation may not apply. This warranty gives you specific rights and you may also have other rights which may vary from state to state.