

# *Bookshelf*

## Installation Process

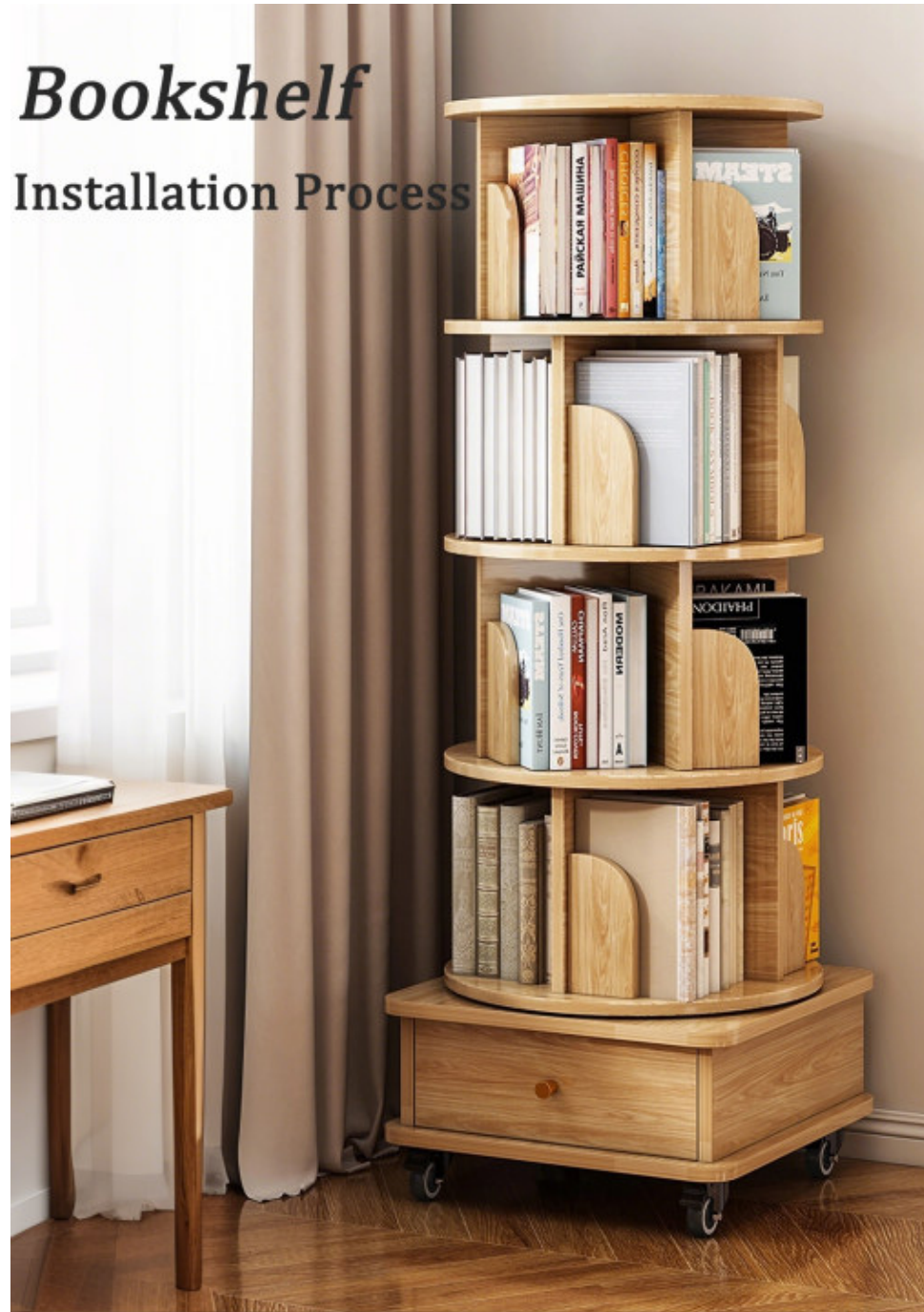

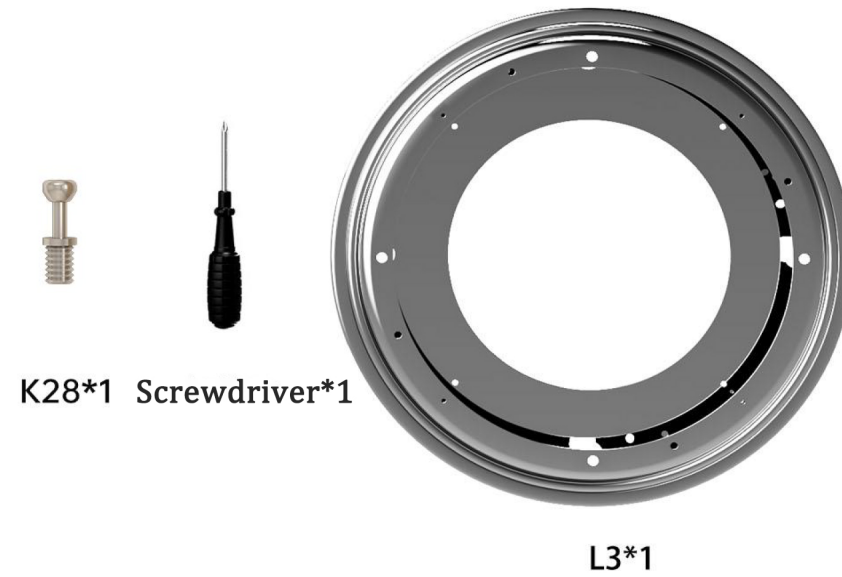

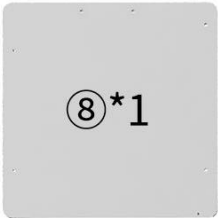

$⑧ * 1$



$④ * 1$



$⑤ * 5$



$⑦ * 5$



$① * 1$

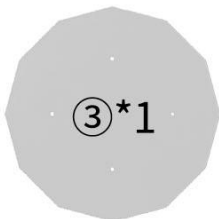

$③ * 1$



$② * 4$



$⑨ * 2$



$⑪ * 1$



$⑩ * 1$



$⑥ * 20$

## Presentation of finished product



## Product Split Diagram

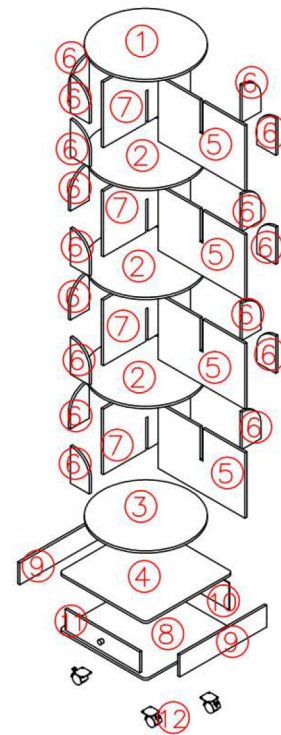

1

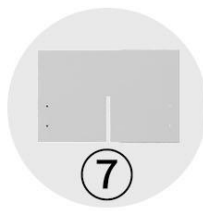
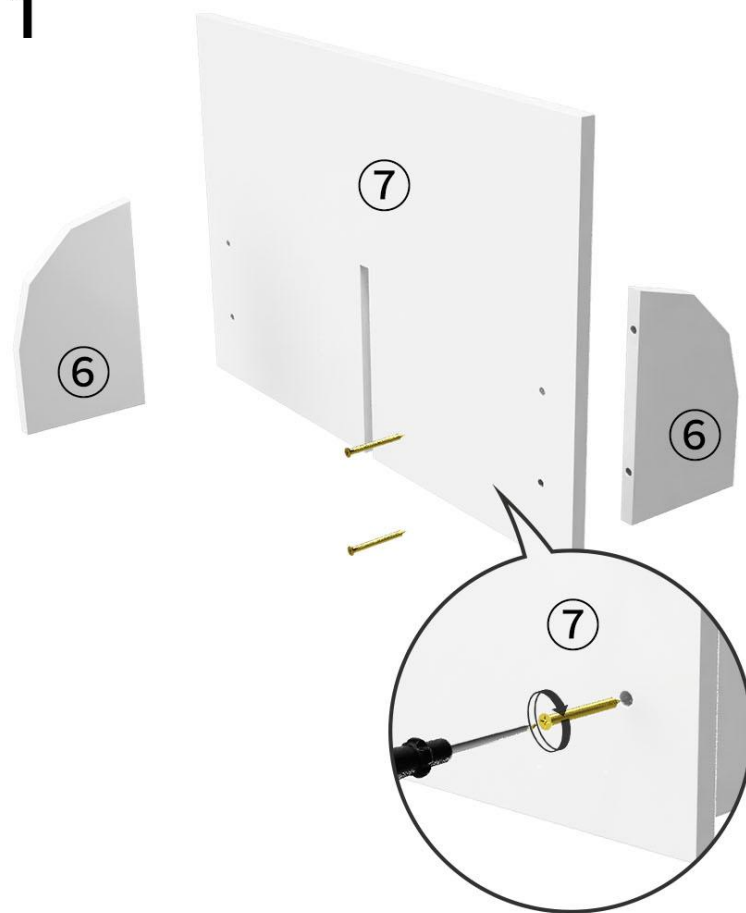

2

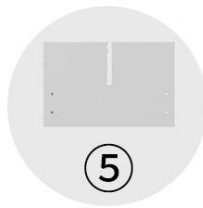
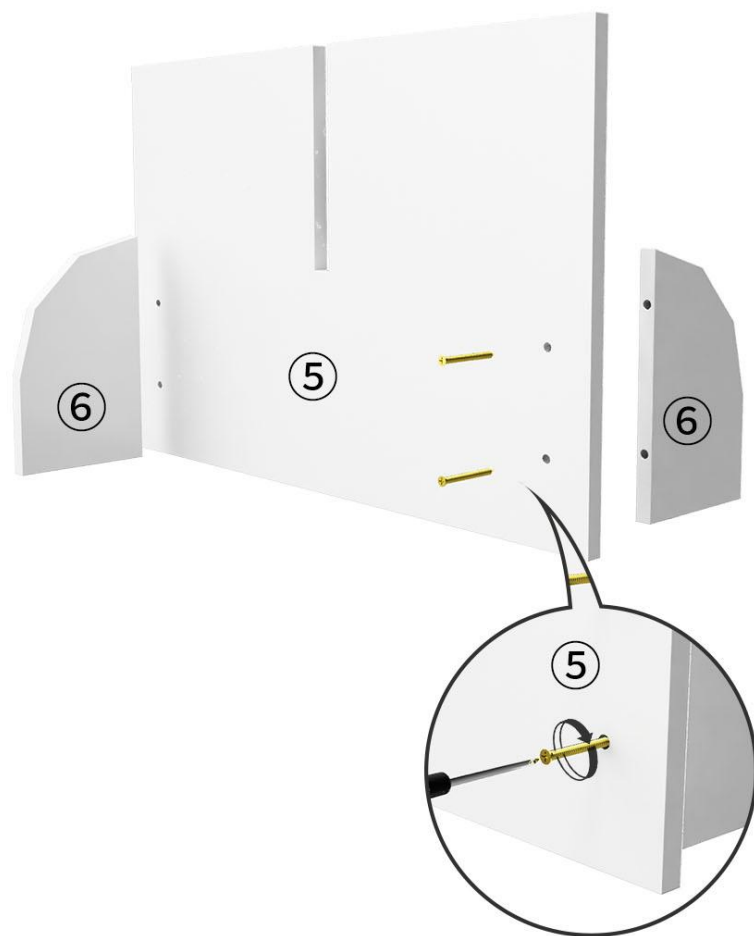

3

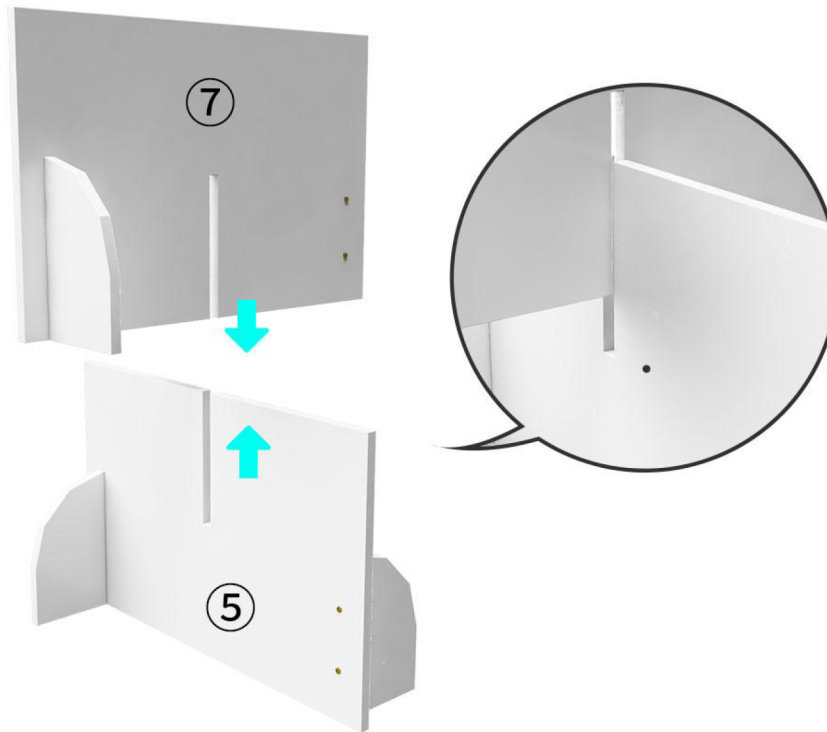

Put the plates from step 1 and 2 together to get a shelf.

4

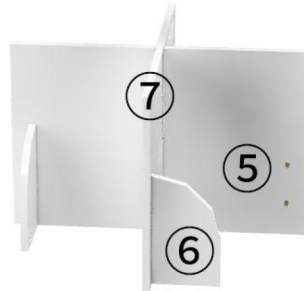

Repeat steps 1, 2, and 3 to  
get three racks.

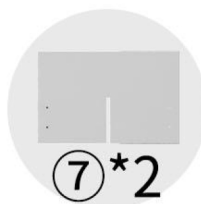



5

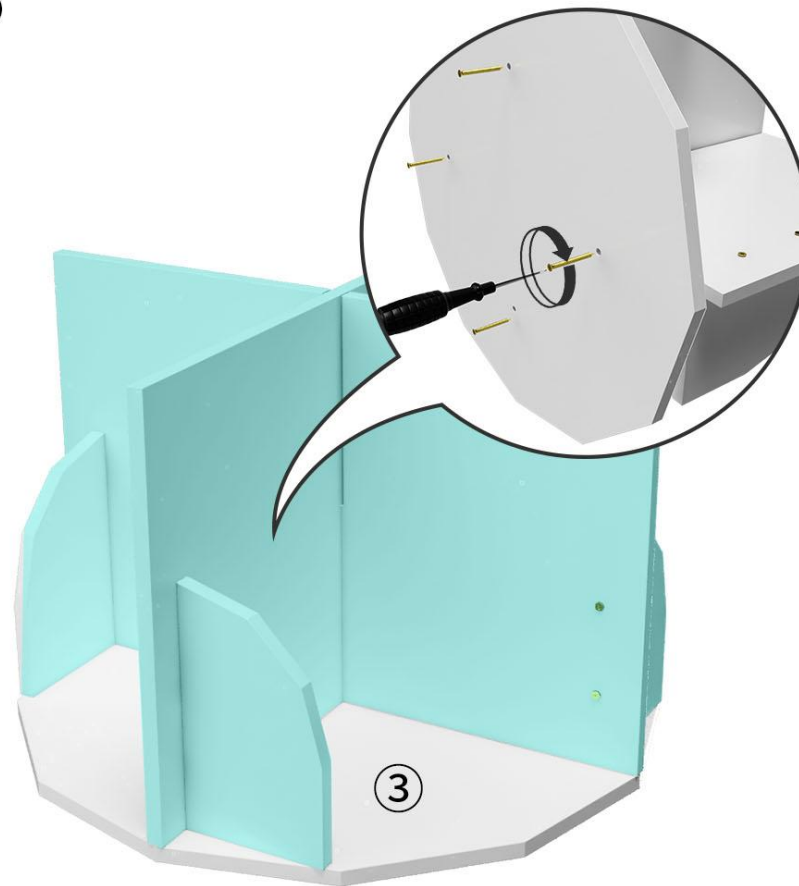

6



Align the large holes in the turntable with the large holes in the ④ board, then screw the small screws into the small holes to lock them in place



7

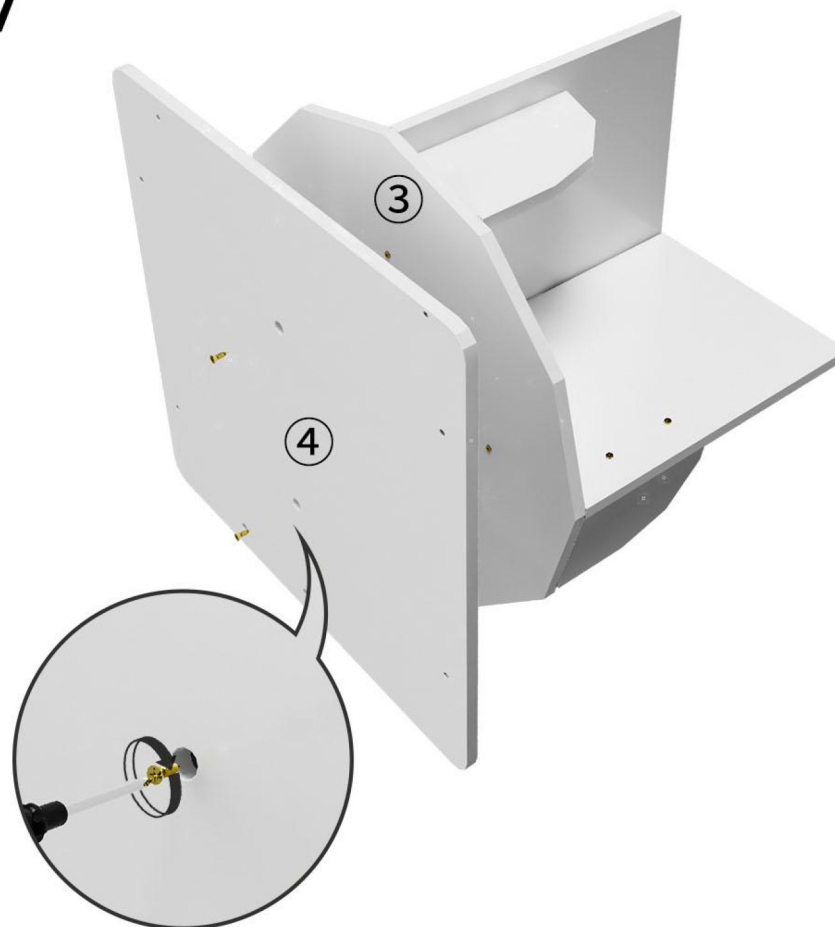

Reverse the ④ bottom board, Align the ③ ④ two boards

Rotate the turntable and find the small holes at the large  
holes to screw in the screws



A16\*2

8

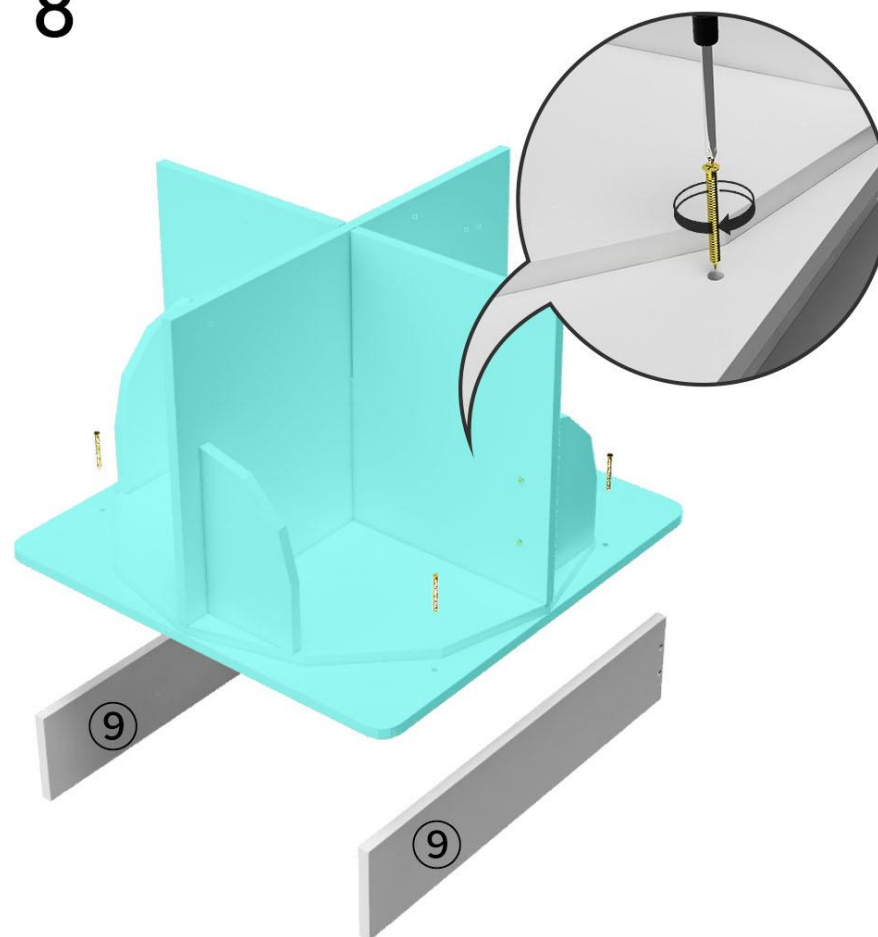

9

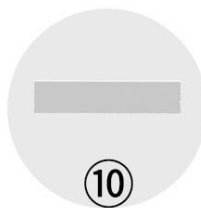
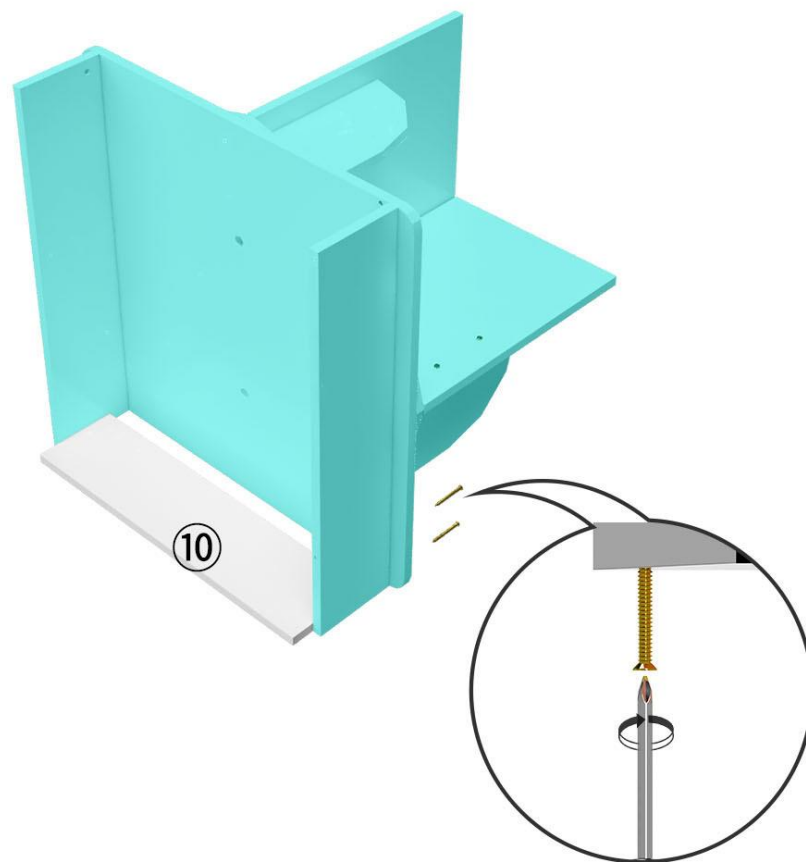

10

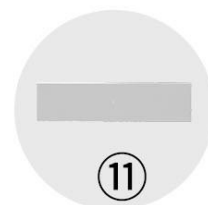
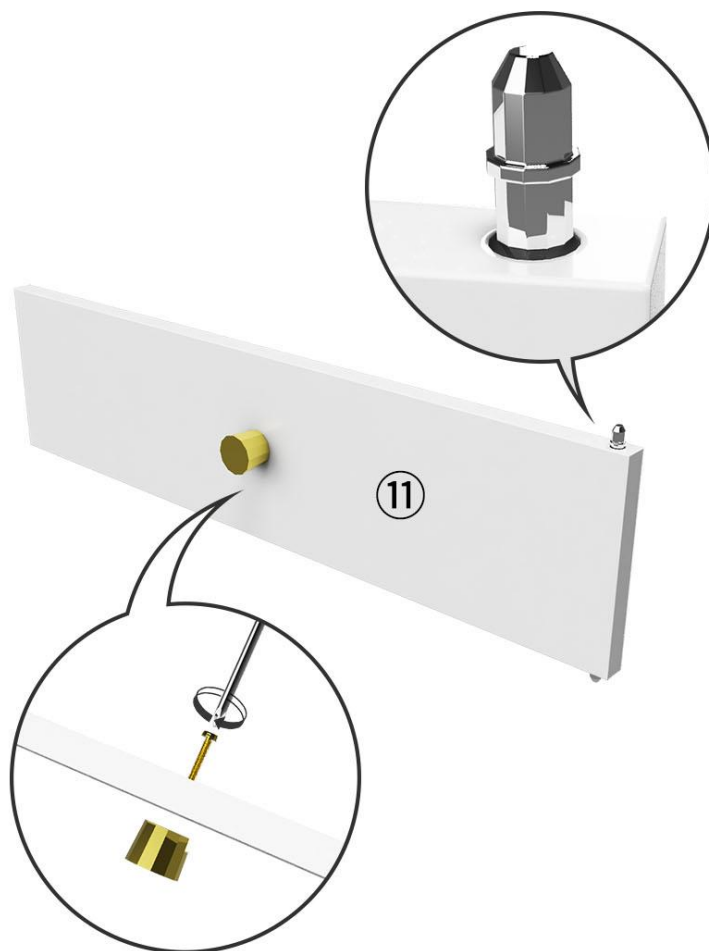

11

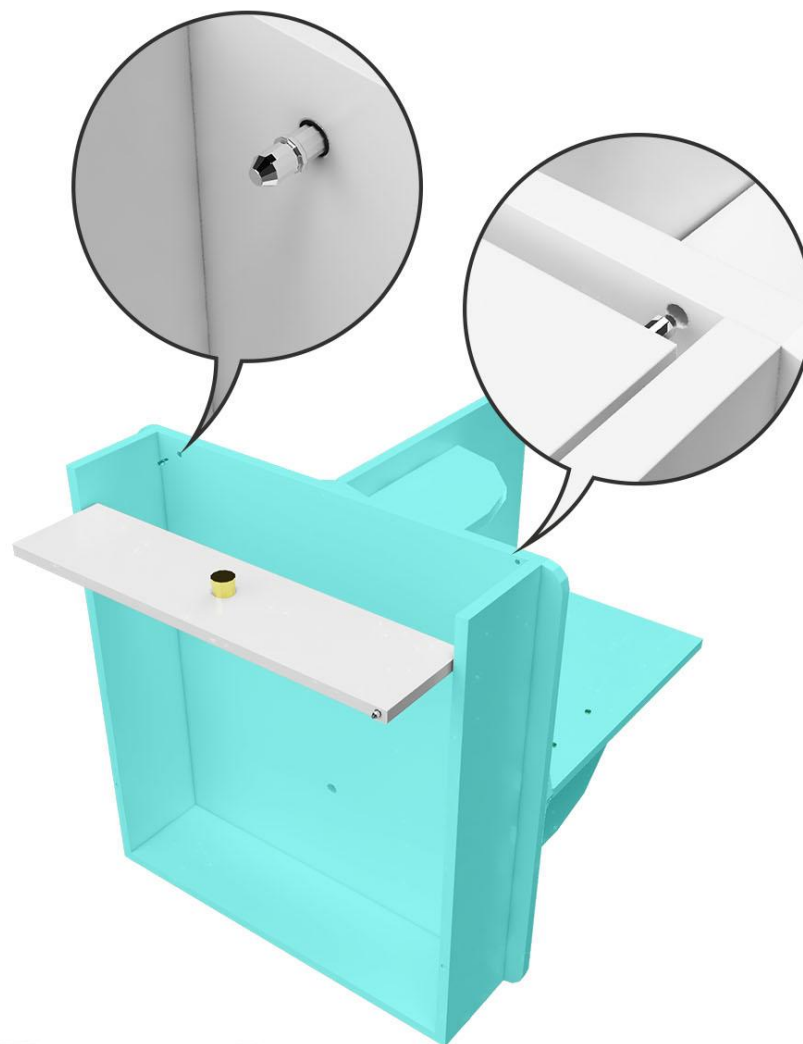

K0\*1



K28\*1

12

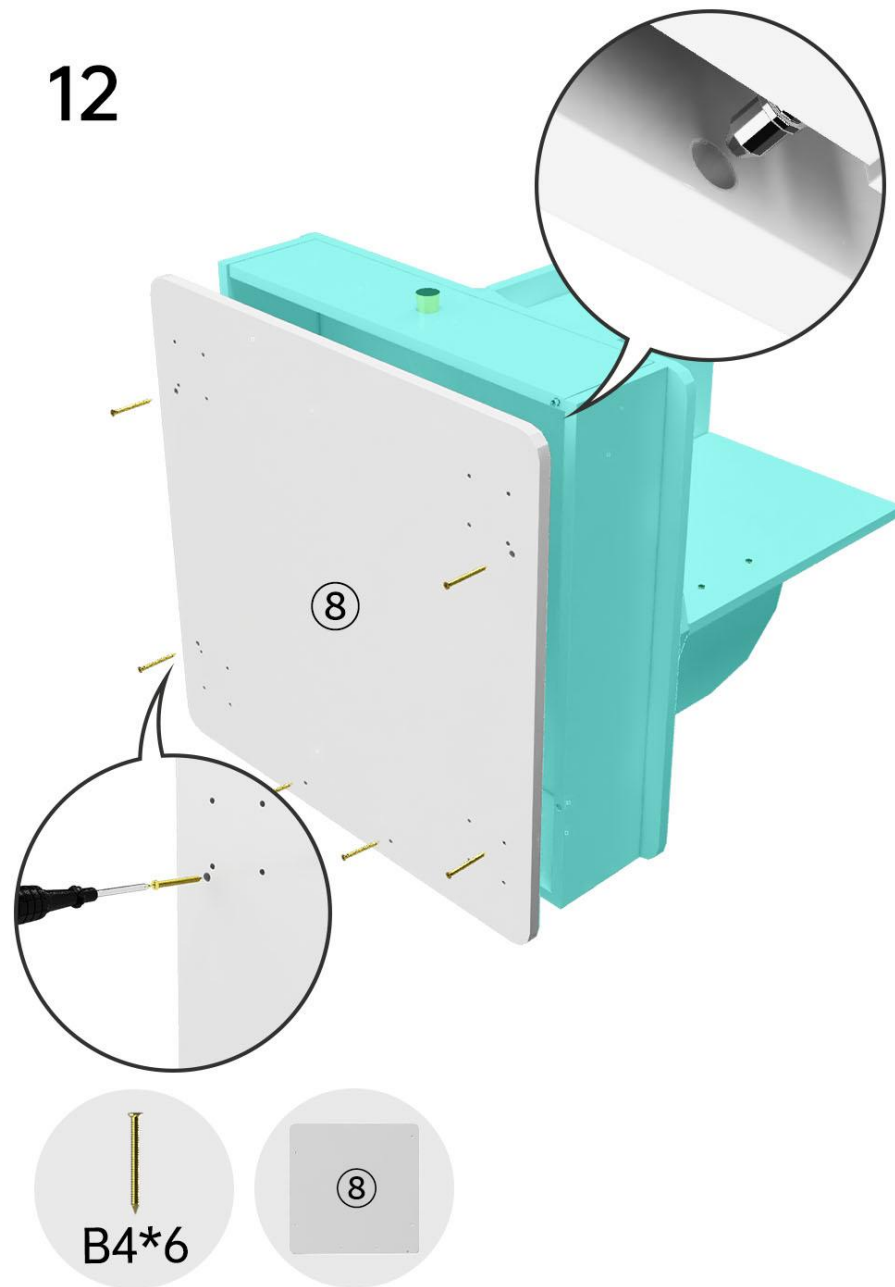



13

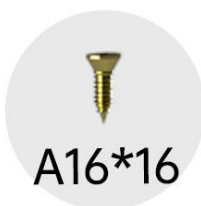
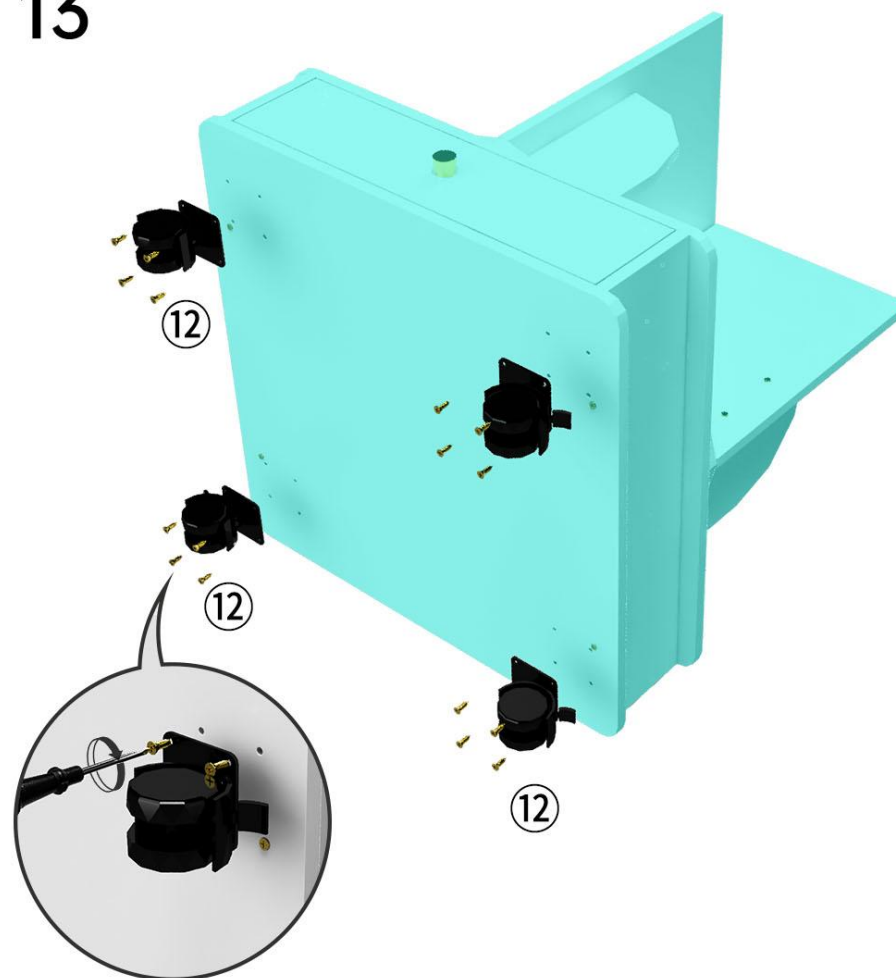

14

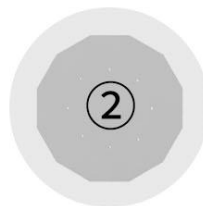
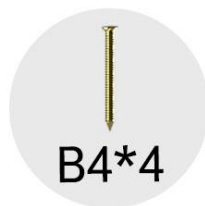
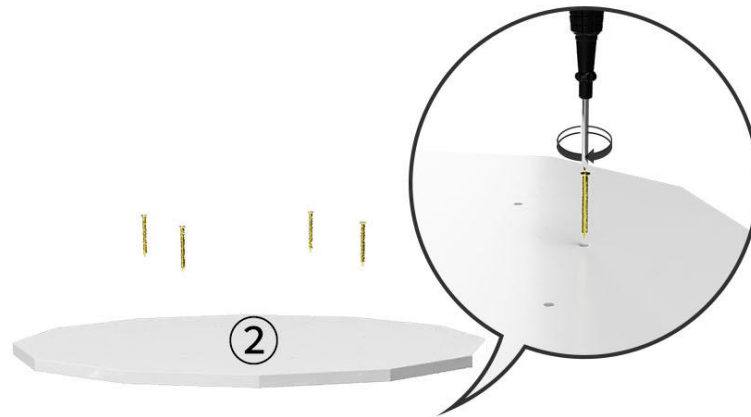

15

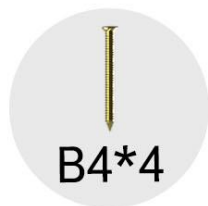
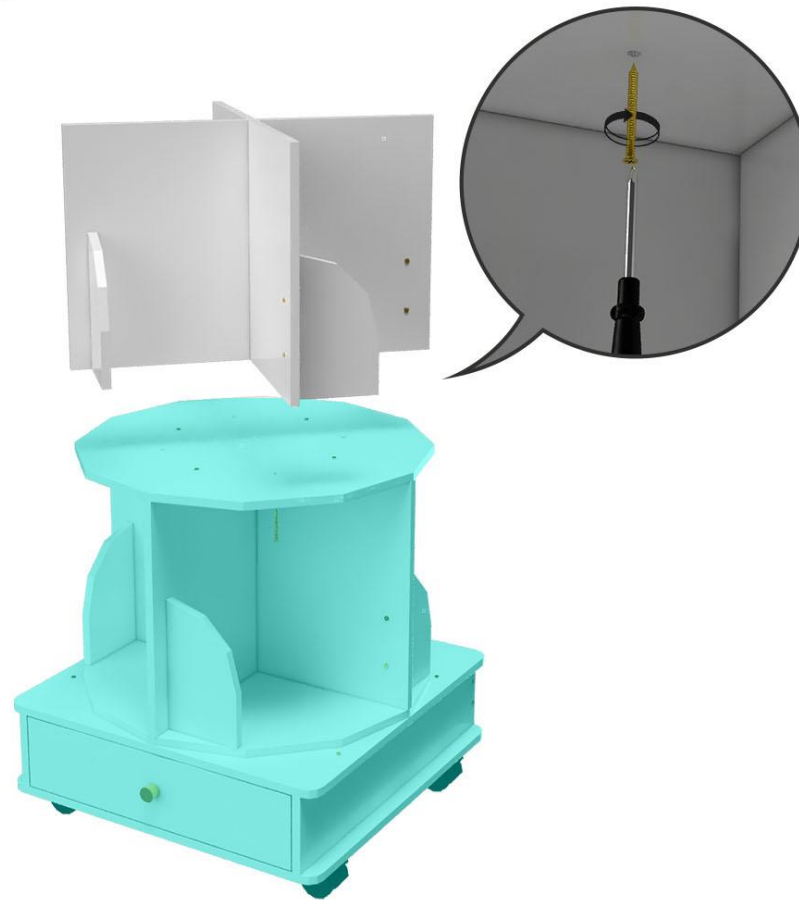

16

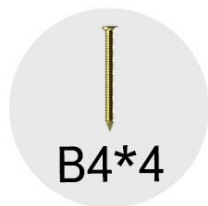
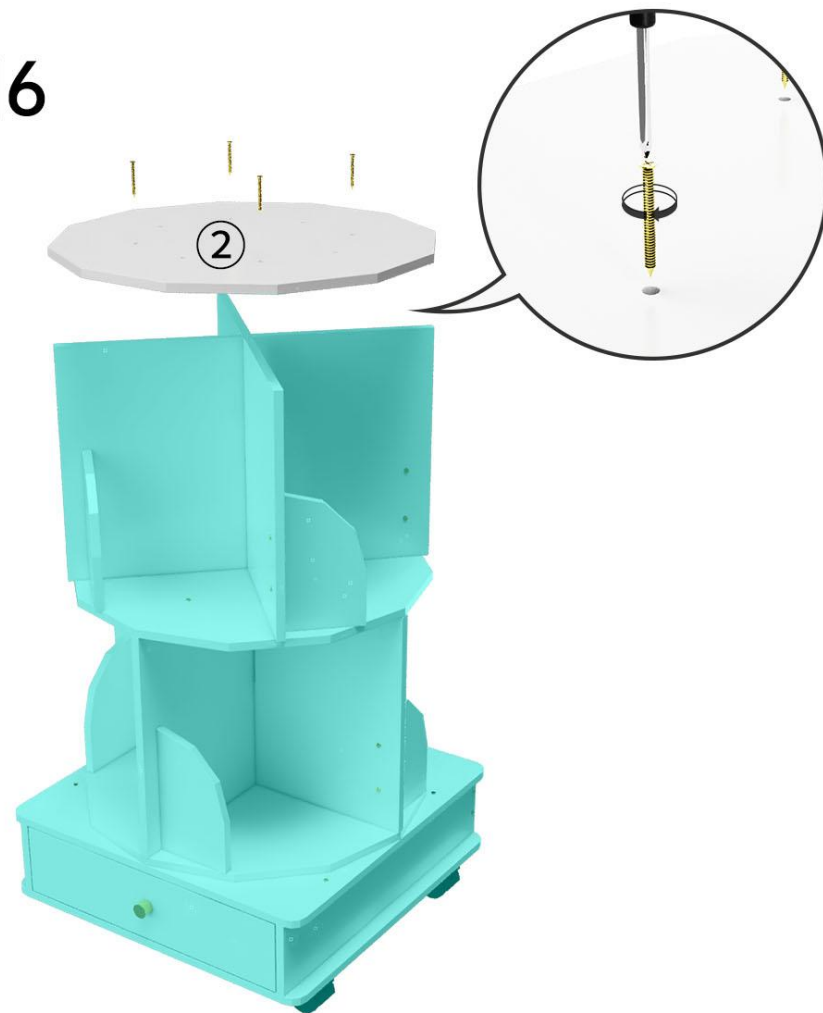

17

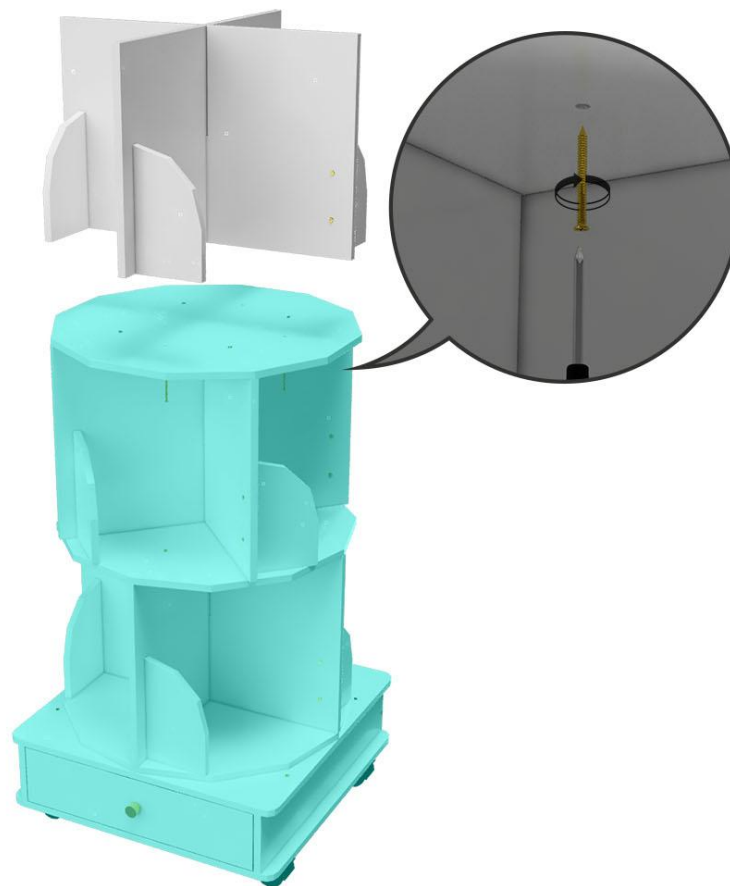

18

