

IMPORTANT INFORMATION ABOUT YOUR CENTERPOINTE COUNTERTOP

PRIOR TO INSTALL

- Keep product in its packaging and away from humidity or direct heat until you are ready to install.
- Open packaging and allow to acclimate 72 hours prior to installation (See pg. 2 for details).
- Check the color and finish of your surface before installation. Returns or exchanges are not accepted once there has been any alteration.
- CenterPointe Countertop must be envelope sealed with at least four (4) coats of sealer. This includes top, bottom, edges and ends.

DURING INSTALL

- If CenterPointe butcher block countertops are installed where food will be prepared, a food-safe sealer must be utilized.
- Reseal any areas that have been cut during installation, with at least (4) four coats of sealer.
- DO NOT attach CenterPointe Countertops to an existing countertop.
- DO NOT glue CenterPointe Countertops down to fix their position; allowing for movement during humidity and temperature changes.

AFTER INSTALL

- Do not place hot items directly on the surface. Contact with the wooden work surface may result in permanent damage.
- Wash the countertop immediately after each use with a mild dish soap and water taking care to thoroughly dry the surface. Avoid using abrasive cleaners.
- Avoid leaving standing water on the countertop for a prolonged period of time.
- DO NOT cut or chop on a butcher block countertop, as it may cause scoring. Always use a chopping block
- If light scratches occur, sand the surface lightly with 220 grit sandpaper and re-apply sealer.

TOOLS REQUIRED:

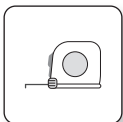

Measuring
Tape



Pencil

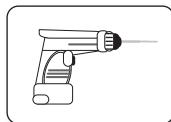

Drill

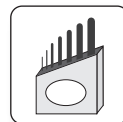

Set of
Drill Bits

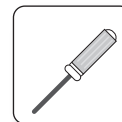

Screw
Driver

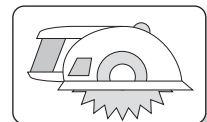

Circular
Saw

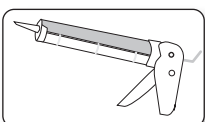

Silicone Sealant
& Gun

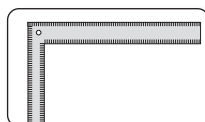

Carpenter
Square

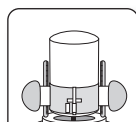

Router

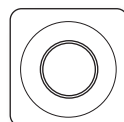

Masking
Tape

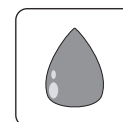

Sealer

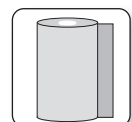

Self-Adhering
Aluminum Flashing



#10 Wood
Screw



#10 Washer

*How To Determine Screw Length

The appropriate length #10 screws and washers should be carefully chosen so the screw does not go all the way through the top, but the depth of penetration is enough to secure the butcher block countertop in place.

Butcher Block 3/4" Pilot Hole + Sub-Top Cabinet Base Thickness

SAFETY:



Dust Mask



Ear Protection

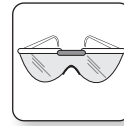

Safety Glasses



Protective Gloves

ACCLIMATING BUTCHER BLOCK



The butcher block should be placed in the room where it will be installed for a minimum of 72 hours prior to installation. The temperature should be controlled during the acclimation period. This allows the wood to stabilize in the new environment. Remove the packaging and allow the butcher block to have free airspace on the top and bottom during acclimation. Store the countertop in a flat position to avoid warping.

LAYOUT AND CUTOUT



STEP 1 - PRE-SITE SURVEY

Note: Installation is recommended to be performed by an experienced installer. Please see pages 3-4 for installations with additional layout considerations

Begin planning with a pre-site survey; ensure that planning starts at the sink. It is recommended to create a template to ensure the most accurate cuts are made. Plan countertop layout to ensure joints don't fall on or within 4" of appliances. Always leave an expansion of 1/8 inch on all edges that will meet up to a wall or a restrictive barrier. Use silicone caulking or a backsplash/trim to fill the 1/8 inch expansion gap.

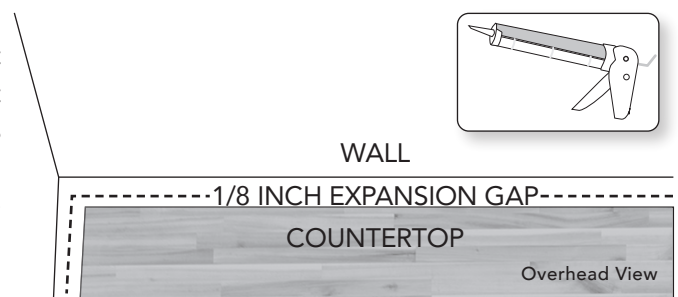

STEP 2 - VERIFY MEASUREMENTS

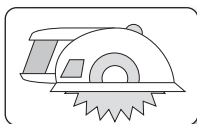
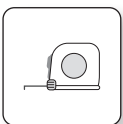

Verify measurements before making the necessary cuts to the product. If a butcher block top requires cutting for proper installation, either for a size adjustment or for a sink or cook top cutout, the cut edges need to be refinished with (4) four coats of sealer immediately. Use a circular saw to cut the butcher block blank to size, ensuring the ends are squared using a router.

STEP 3 - TAPE & MARK CUT LINE

Carefully measure the width of the run of cabinets to be covered with butcher block, including any desired overhang, if applicable. After determining the necessary cuts to be made, draw the cut line boldly with a pencil, using a carpenter's square to draw a straight line. Place a layer of masking tape over the pencil line. Press the masking tape firmly.



STEP 4 - CUT

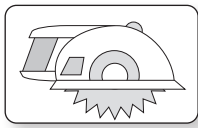

EXAMPLE:
 $1-1/2" + 1/4" = 1-3/4"$ BLADE DEPTH

To begin cutting using the circular saw, adjust the blade so that it extends 1/4" below the bottom of the butcher block countertop. A blade that hangs too low beyond the thickness of the wood may pull at the wood fibers, causing tears and splintering. Make the necessary cuts into the butcher block along the pencil line. Move the circular saw at a slow and even pace to ensure the blade does not tear the wood.

Note: If burn marks appear while cutting, sand the surface lightly with 220 grit sandpaper and re-apply sealer.

KITCHEN APPLIANCE PLACEMENT



Additional considerations should be made when installing a CenterPointe butcher block countertop around appliances and countertops with stove cutouts. Where appliances have heat acting on the countertop, such as dishwasher, under counter oven, or warming drawer, attach self-adhering aluminum flashing to the underside of the butcher block. This will assist in keeping heat and steam away from the block and cut down heat transference. The fitting of cooktops must not restrict the countertop from expanding and contracting. Ensure that there is at least 1/4" clearance all around the cooktop. To avoid splintering when cutting into the butcher block, it is recommended that masking tape be applied over the area that will be cut.

NOTE: Reseal any areas that have been cut during installation, with at least four coats of sealer.

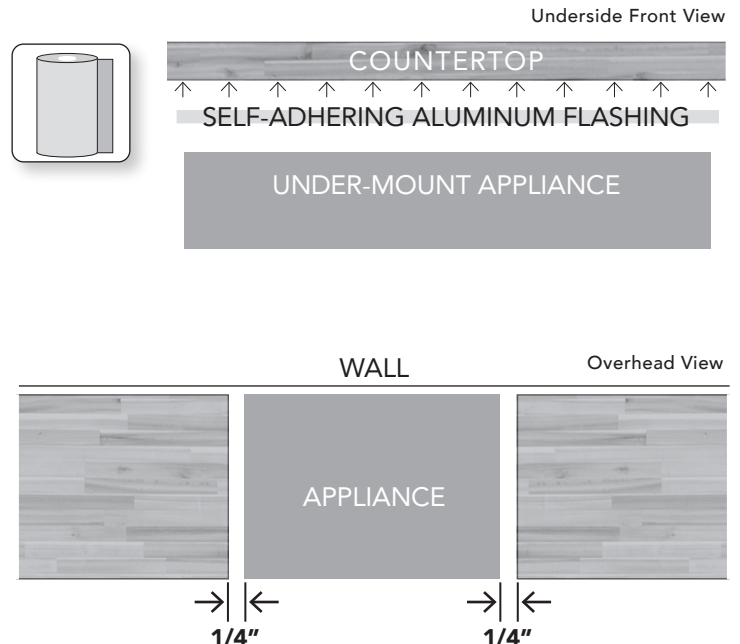

SINK AND FAUCET PLACEMENT

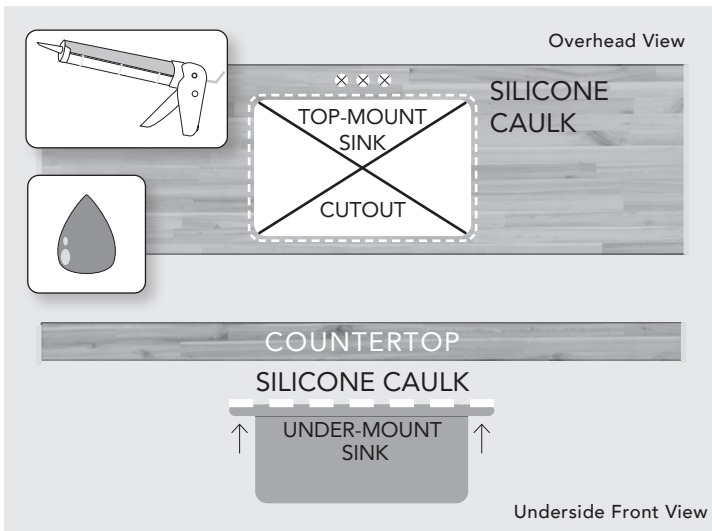

Silicone sealant should be used in sink applications to form a water tight bond between the countertop and the sink. To seal top-mount sink openings, apply a thin bead of silicone caulk under the sink flange. For top-mount sinks, apply a thin bead of caulk to the top of the sink flange. The fitting of sinks must not restrict the countertops from expanding and contracting. Ensure that there is at least 1/4" clearance all around the sink. For faucet holes/cutouts, ensure that the hole is a minimum 1/8" larger than the pipe diameter. Seal the cut edges of the internal hole with sealer. Finally seal the faucet and hole with a silicone sealant. To avoid splintering when cutting into the butcher block, it is recommended that masking tape be applied over the area that will be cut.

OVERHANG PLACEMENT

Overhangs less than 8" do not require additional support. If the layout includes any overhangs 8" or larger, additional support corbels or brackets will be required at least every 24".

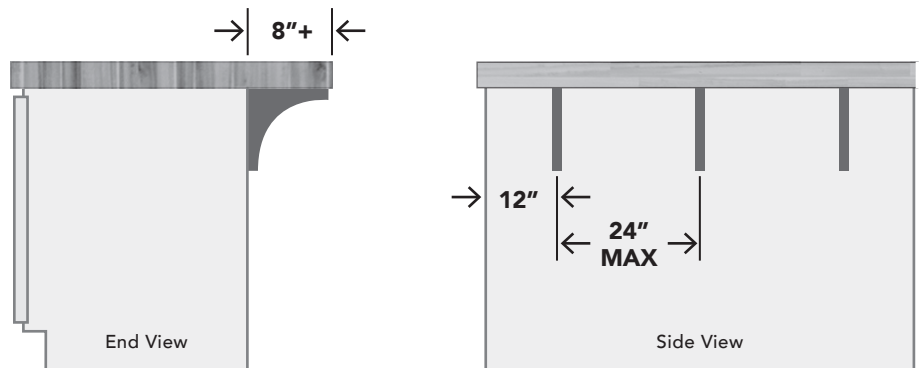

WOOD BACKSPLASH PLACEMENT

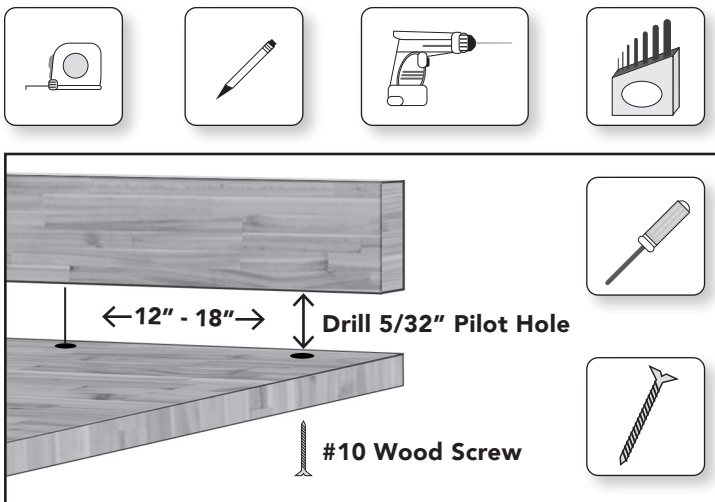

CenterPointe backsplash material may be screwed to the butcher block prior to installation by drilling pilot holes and screwing from the bottom of the block into the backsplash material. Attachment to the cabinet base is not necessary for the attachment of the backsplash. The number of installation fasteners is to be determined by the installer. It is recommended that fasteners be put every 12"-18".

NOTE: For non-wood backsplash applications, allow a 1/8" gap between the edge of the countertop and the wall, which will allow it to expand and contract within the humidity of the kitchen. Use silicone caulking or trim to fill the 1/8 inch expansion gap.

CORNER JOINT PLACEMENT

When joining two CenterPointe countertops together, the butt joint method is recommended. Three standard worktop jointing bolts must be used on each joint. Cut bolt cutouts to a depth of 25/32" using a worktop jig and router. Join using PVA which should be applied to

the top and bottom edge of the joint. Tape each side of joint to avoid PVA spreading over the countertops. Ensure cut edges are sealed before installing. Butt Joints with opposing grain direction are never to be glued, instead use silicone sealant.



MOUNTING BUTCHER BLOCK STEPS



PLACEMENT CONSIDERATIONS, SIZING ADJUSTMENTS AND CUTS MUST BE MADE PRIOR TO MOUNTING



MOUNTING STEP 1 - REMOVE EXISTING TOP

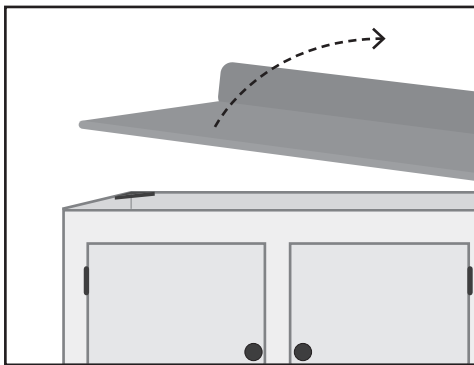

It is not recommended to attach butcher block directly on top of a solid underlayment or existing countertop; remove existing top if applicable.

NOTE: If a solid particleboard or MDF top must be used, ensure holes are cut into the board to assist with adequate ventilation.

MOUNTING STEP 2 - COUNTERTOP PLACEMENT

Place the butcher block in the location that it will be installed. Allow 1/8" of room for expansion at each end. The gap can be concealed with backsplash material or trim. Verify spacing and cuts are accurate.

NOTE: Butcher block surfaces should never be glued down with caulk or construction adhesive as this will prevent natural movement and result in damage to the top.

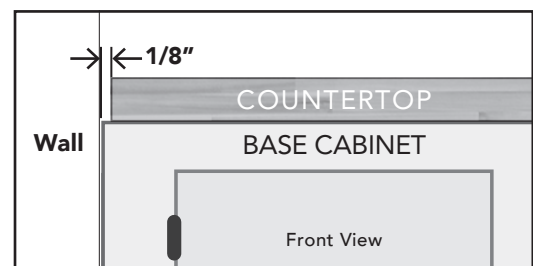

MOUNTING STEP 3 - FASTENER LOCATIONS

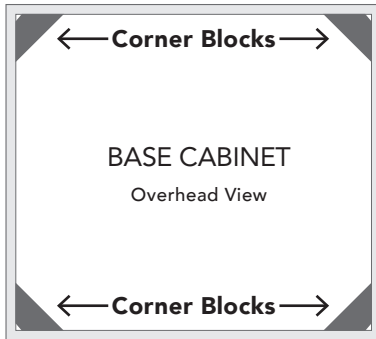

Minimal fixing is required as the top will be held down by self-weight. Use only enough fasteners to secure the countertop. Too many fasteners can keep the top from moving freely and can result in damage. Most cabinet manufacturers provide corner blocks or plywood within the cabinet for attaching the countertop to the cabinet base; fastener locations are usually in the corners. The number of installation fasteners is to be determined by the installer. It is recommended that fasteners be put every 12"-18".

NOTE: If there is not a cabinet corner block to secure to the countertop, other commonly used installation methods may be utilized including the use of 1/2" steel angle brackets.

MOUNTING STEP 4 - DRILL PILOT HOLES

Measure the thickness of the sub-top base and then add 3/4" to account for the butcher block pilot hole. DO NOT exceed the total drill depth of the sub-top cabinet base and 3/4"; risk of surface penetration if maximum depth is exceeded. Using the fastener locations marked in step 3, drill the pilot hole using the 5/32" drill bit upward through the corner blocks and into the countertop from below. DO NOT drill through the top of the countertop.

NOTE: It is important to drill the pilot hole before mounting the countertop to avoid splitting the wood of the countertop during the mounting process.

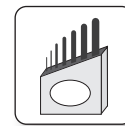
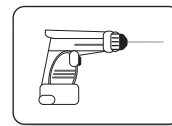
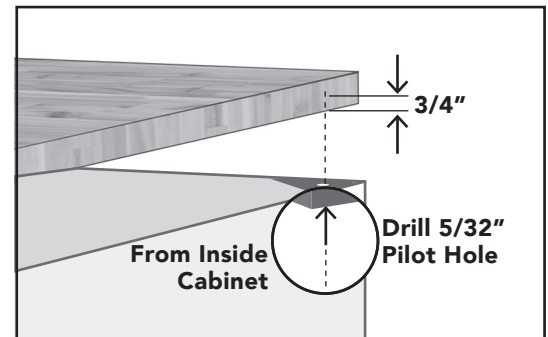

MOUNTING STEP 5 - REMOVE THE COUNTERTOP FROM THE CABINET BASE

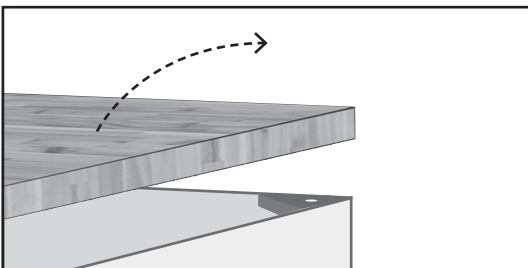

MOUNTING STEP 6 - EXPANSION HOLES

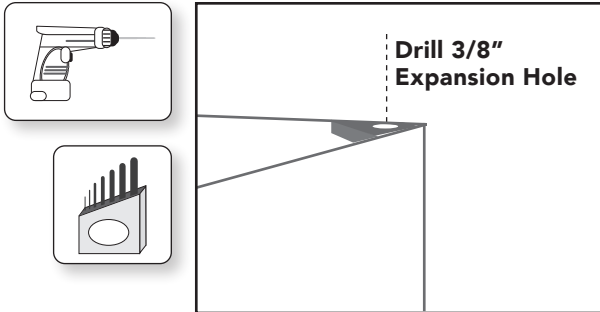

Use a 3/8" drill bit to create an expansion hole in the corner block cabinet base in the same location as the pilot holes in step 4, repeat for each fastener. This will enlarge the pilot holes in the sub-top created with the 5/32" bit. DO NOT enlarge the pilot holes in the butcher block.

NOTE: This allows the countertop to expand and contract after installation. Tops that are screwed down without expansion holes in the sub-top will be void of warranty.

MOUNTING STEP 7 - COUNTERTOP PLACEMENT

Place the countertop back in the desired location and line up the pilot holes on the countertop to the corner block expansion holes that were previously drilled.

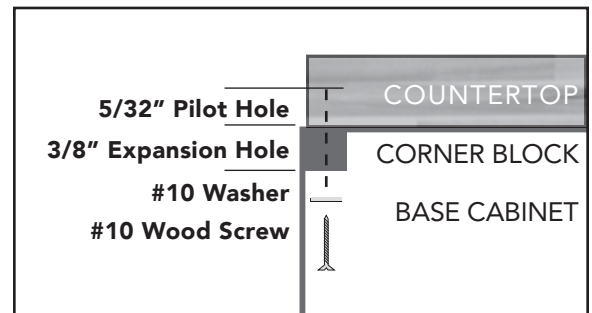

MOUNTING STEP 8 - FASTENING COUNTERTOP

On the underside of the sub-top cabinet base, place the washer on the screw and drive the screw into the expansion holes in the sub-top and pilot hole in the butcher block. Be careful not to over tighten.



This concludes the CenterPointe standard mounting process.

Have Questions? Contact our Technical Service Team at 1-800-827-10345

All VT CenterPointe products are backed by VT's 90-day limited warranty.
Warranty is void if the surface is not finished or treated.

Learn more at vtindustries.com



VT CUSTOMER SERVICE
525 N. 16TH STREET
SAC CITY, IA 50583
P. 712.662.4177 - 888.287.8356 F. 712.368.4188