

Aqua Fold Tub Door & EX/RT Panel

TUB DOOR AND PANEL INSTALLATION INSTRUCTIONS

IMPORTANT

DreamLine® reserves the right to alter, modify or redesign products at any time without prior notice. For the latest up-to-date technical drawings, manuals, warranty information or additional details please refer to your model's web page on **DreamLine.com**

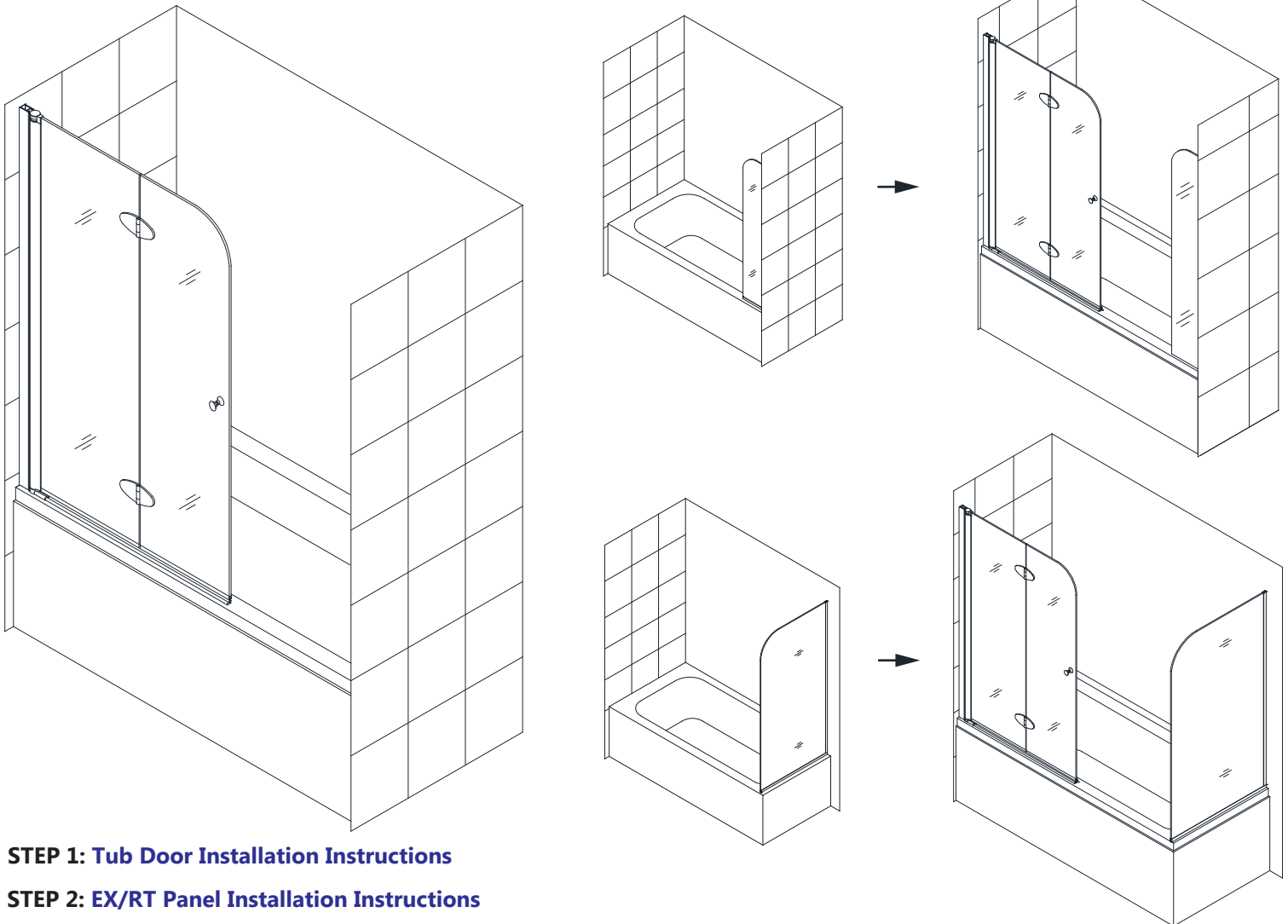

STEP 1: Tub Door Installation Instructions

STEP 2: EX/RT Panel Installation Instructions



Questions?

Please Call **DreamLine** Customer Support: **1-855-831-2126**
Hours of Operation M-F 8AM - 7PM EST and Saturday 9AM - 5PM EST

Support@DreamLine.com



For more information about DreamLine® Shower Doors, Tub Doors & Enclosures, please visit **DreamLine.com**



AQUA FOLD

SHOWER AND TUB DOOR INSTALLATION INSTRUCTIONS

PLEASE REVIEW THIS ENTIRE MANUAL PRIOR TO INSTALLATION

Shower Model#
SHDR-3630720-01
SHDR-3634720-01

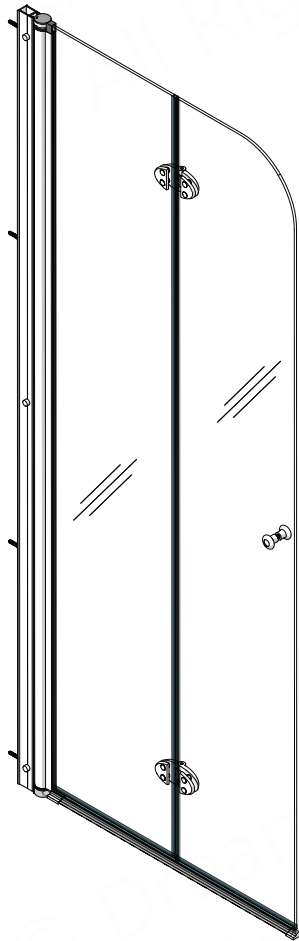

Tub Model#
SHDR-3636580-01

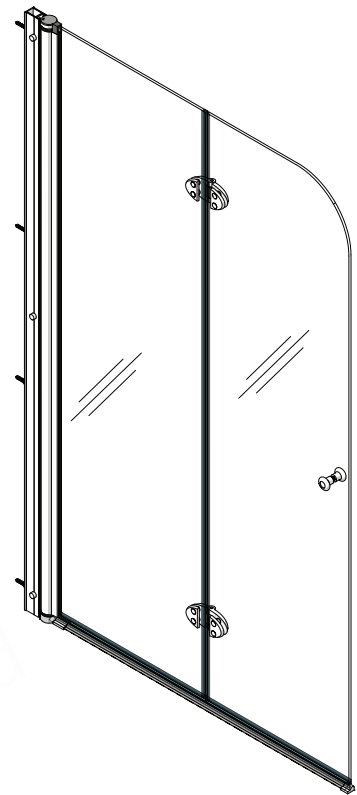

IMPORTANT!

DreamLine® reserves the right to alter, modify or redesign products at any time without prior notice for the purpose of product improvement and customer experience. Please refer to the model's web page on **DreamLine.com** for the latest technical drawings, installation manuals, warranty information or additional product details.

Do Not Return Product to the Store. Contact DreamLine® with any questions



Questions?

Please contact DreamLine Customer Support
See **DreamLine.com** for hours of operation

Support@DreamLine.com

1-866-731-2244





Record the following purchase information for your records or in the event you need to contact DreamLine®:

Purchase Order
Number _____

Store/Vendor
Purchased From _____

Installation Date _____

OD Number
(optional) _____
*found on the shipping box or label
if available.

Installed By: _____

SKU Number _____

Table of Contents

Section Title	Page #
Warnings and General Preparation	2
Model Specific Preparation	3
Tools	4
Detailed Diagram of Shower/Tub Door Components	5
Parts List	6-7
Installation Steps	8-18
Product Maintenance	19
Troubleshooting	20
Factory Parts Information	21-23

Symbol Legend



TIP - for ease of installation.



CORRECT - recommended.



NOTE - take note of special feature; additional information.



INCORRECT - not recommended.



REQUIRED - requires special attention; signifies a warning.

Average Installation Time

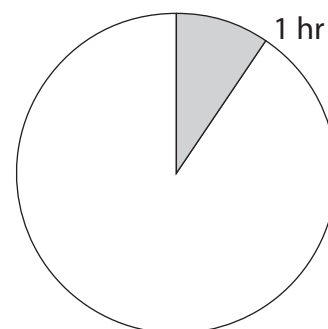



IMPORTANT

- DreamLine® reserves the right to alter, modify or redesign products any time without prior notice for product improvement and customer experience. Please refer to the model's web page on **DreamLine.com** for the latest technical drawings, installation manuals, warranty information or additional product details.
- This product should be installed by someone familiar with the construction requirements for this type of project and the care necessary for the safe installation and operation of the product.
- The safety of any installation is the responsibility of the installer.
- Professional installation recommended. (*All Models*)
- Professional installation required. (*Enigma Series*)
- To prevent damage or serious injury, Do Not lean against the installed panel/door/glass.
- To prevent damage or serious injury: Do Not attempt to lift or move a heavy lite of glass alone. Use an assistant and/or a professional grade glass suction cup.
- The installation of some models may require drilling down into the threshold. Contact the manufacturer of the base, tub, or threshold material with any questions regarding the drilling of holes into their product.
- All drawings in this installation manual are for illustrative purposes only and are not drawn to scale.

TEMPERED GLASS WARNING

- Your Shower Door Glass Could Shatter Without Warning if Improperly Installed or Mishandled
- Do Not install or operate a shower door if the glass has chipped corners, slivered edges or is otherwise damaged and/or has been dropped or banged into a hard surface such as tile, marble or glass.
- **The main causes of tempered glass breakage are:**
 - Improper handling, storage or installation
 - Misuse/abuse
 - Lack of maintenance
 - Failure to replace damaged glass
 - **Improper handling during storage, unpacking and installation:**
 - Corners and edges are the most susceptible area to damage on a lite of tempered glass and should be protected and handled with care during storage, unpacking, installation and operation. A concentrated point of pressure or impact with a surface harder than itself may cause the tempered glass to shatter. The tempered glass may release immediately, within several hours or even days later.
 - **Incorrect installation of door hardware, rollers, hinges, channels, stopper or glass:**
 - Improper installation may include: loose hardware and/or lack of proper gaskets between the hardware and glass. Additionally, improper alignment of guide rails, wall profiles or other hardware during installation or operation may place stress on the glass edges and cause it to break.
 - This product must be installed by a professional and experienced installer familiar with the safe handling of tempered glass.
 - **Improper use of this product:**
 - Aggressively opening or closing the door may cause trauma to the glass, which can lead to breakage. This may occur immediately or hours or even days later.
 - **The shower door hardware and glass should be inspected periodically:**
 - Instruct the homeowner how to perform a periodic inspection of the shower hardware and glass - some minor adjustments may be necessary based upon the use (or misuse) of the shower door. Ensure that the hardware remains tight and that the door alignment and operation are correct. Any adjustments should be made upon discovery to prevent damage to the product.
 - Additional considerations should be given to the installation of frameless tempered glass products in households with young children or an elderly person due to an increased chance of improper handling. In such cases, alternatives such as shower curtains or grab bars should be considered.

GENERAL PREPARATION

- After opening all boxes and packages, read this introduction carefully. Check that all the items are included in the package by marking off the components on the "**Detailed Diagram of Product Components**" page. Examine all boxes and packages for shipping damage. If the unit has been damaged, has a finishing defect, or is missing parts; please contact our Customer Support department within 3 business days of the delivery date. **Please note that DreamLine® will not replace any damaged products or missing parts free of charge after 3 business days or if the product has been installed.** Please contact DreamLine® if you have any questions.
- **Please note that you should refer to your local building codes with questions on installation compliance standards. Building and plumbing codes may vary by location, and DreamLine® is not responsible for code compliance standards for your project and will not accept any returns.**
- If this unit is going to be installed in a new construction, install all the required plumbing and drainage before installing the shower. **Use a competent and licensed (if required by local code) plumber for all plumbing installation.**
- Make sure that prior to beginning the installation, the surfaces are leveled and solid and will be able to support the total weight of the unit. Also make sure the walls are at right angles. Irregular installation surface level, radius corners or improper angle of side walls will result in serious problems for your installation. Please note that some adjustments and drilling will be necessary during the installation process.
- Protect all primary surfaces of the product during installation. Never set your glass down directly onto a tile floor. Leave corner protectors in place until it is necessary to remove them. Always use a piece of wood or cardboard to protect the bottom edge and corners of the glass prior to and during installation.
- This unit must be installed upon a finished threshold and against finished walls.
- *DreamLine® shower doors are not designed to be installed into a fiberglass surround due to the radius corners and lack of a solid surface to mount the hardware.*

WARNING: TO AVOID THE RISK OF DAMAGE OR INJURY:

- **Follow all recommendations and requirements as shown in the installation instructions.**
- Perform a thorough inspection of the glass and all parts for any damage prior to installation. Any damage to tempered glass can cause breakage. **Do Not install damaged glass!**
- Do Not install or operate a shower or tub door if the glass has chipped corners, slivered edges or is otherwise damaged. Do Not install or operate a shower or tub door that has been dropped or banged into a hard surface such as tile, marble or glass.
- **CAUTION:** Contact with any hard surface can damage tempered glass and cause it to shatter.
- This product uses tempered glass. Glass cannot be cut after it has been tempered. **Do Not attempt to cut tempered glass.**
- DreamLine® Glass Shower doors, Tub doors, Inline panels, and Return panels can shatter due to improper handling or lack of maintenance. Conduct periodic inspections of glass and all parts for possible damage, missing or loose parts.
- Always wear proper safety equipment such as: safety goggles, work gloves and appropriate footwear during the installation process.
- **WARNING. Risk of leakage and/or damage.** Follow all instructions regarding the application of silicone sealant or caulk. Allow 24 hours for the sealant to cure before the initial use of the shower or tub product. Follow the silicone manufacturer's recommendations regarding the use of their product.
- **Thoroughly read these instructions before installing or using this product.**
- **Leave this manual for the end-user of the product.**



This product should be installed by someone familiar with the construction requirements for this type of project and the care necessary for the safe installation and operation of the product.

Model Specific Preparation



REQUIRED:

3/8" Out-of-Plumb Adjustment at Wall Profile. DO NOT EXCEED this amount.



Verify tub deck and walls with a level

Threshold must be level

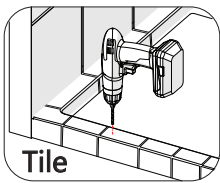
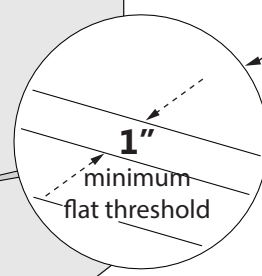
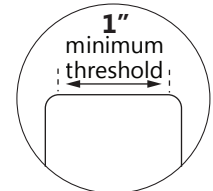
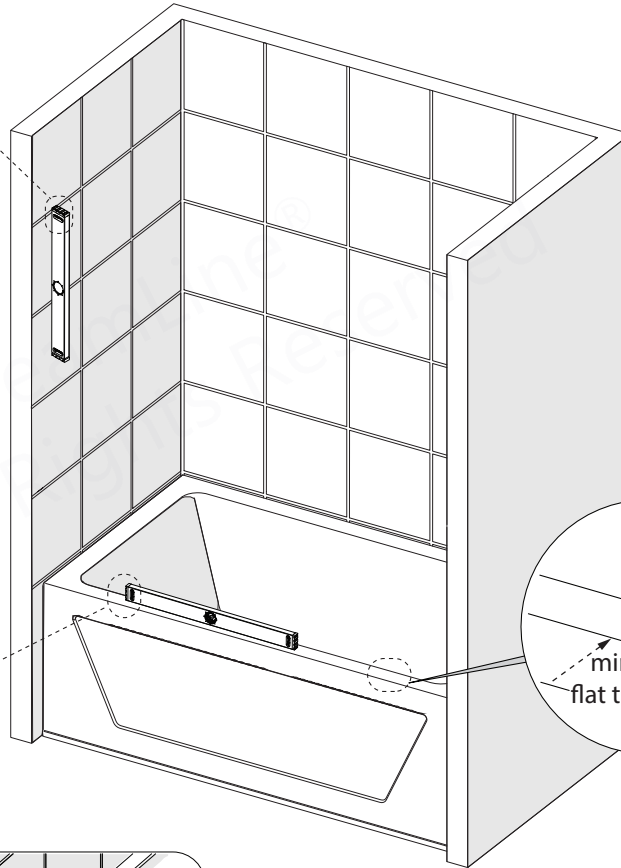
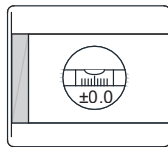
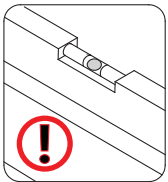

Tile

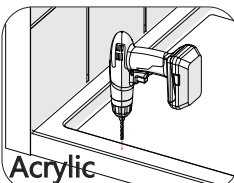

Acrylic

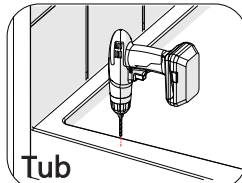

Tub



NOTE

Contact the manufacturer of the base, tub or threshold material with any questions regarding the drilling of holes into their product.

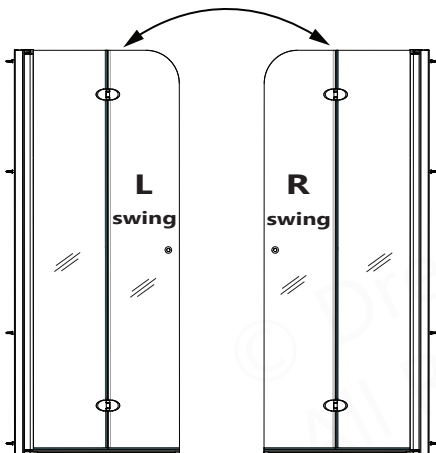

DO NOT attach the Handle to the door glass until instructed.
DO NOT use the Handle to lift the glass during installation. This may result in damage to the glass and/or serious injury. Always use an assistant or a professional grade glass suction cup when handling heavy glass.



NOTE

This model is reversible for right or left swing door installation. The right swing door installation is shown as an example throughout this manual. For the right swing door installation, simply begin on the opposite wall and reverse the orientation of the installation steps shown.



NOTE

Professional installation with two installers is recommended for this product.

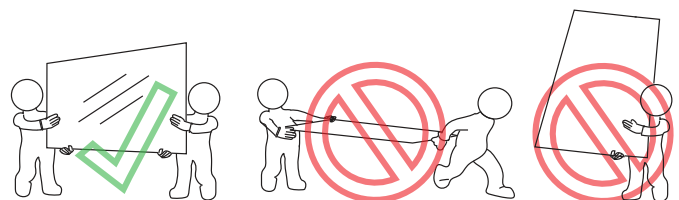

Tools



Level

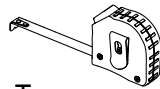

Tape Measure



Pencil

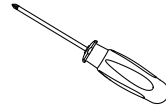

#2 Phillips Screwdriver

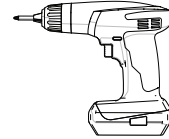

Screw Gun

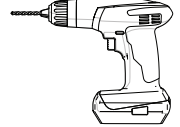

Drill



Drill Bit
Ø1/8"
(3mm)



Drill Bit
Ø3/16"
(5mm)



Drill Bit
Ø5/16"
(8mm)



Razor Knife



Rubber Mallet

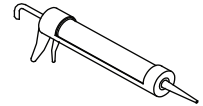

100% Silicone

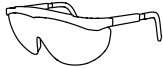

Safety Glasses



Work Gloves

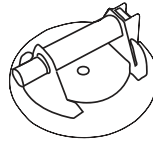

Professional-grade
Glass Suction Cup
(Optional but recommended)

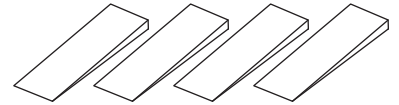

Wood or Plastic
Shims



Verify that the correct model size has been ordered; measure the finished opening **before** proceeding with the installation.

Confirm that the finished walls are plumb and the threshold is level and pitched into the shower area.

Use a good quality waterproof, mildew-resistant 100% silicone caulk.

Cover the shower/tub drain with tape prior to installation to prevent the loss of screws or small parts.



Unpack your unit carefully and inspect it. Lay it out and identify all parts using the **Detailed Diagram** on page 5; and packing list in this manual as a reference. Before discarding the carton, check for small hardware bags that may have fallen to the bottom of the box. If any parts are damaged or missing, please contact DreamLine® for replacement. The shipping boxes may contain extra parts not used in your model configuration. Retain these installation instructions for future reference.

Detailed Diagram of Aqua Fold Shower and Tub Door Components

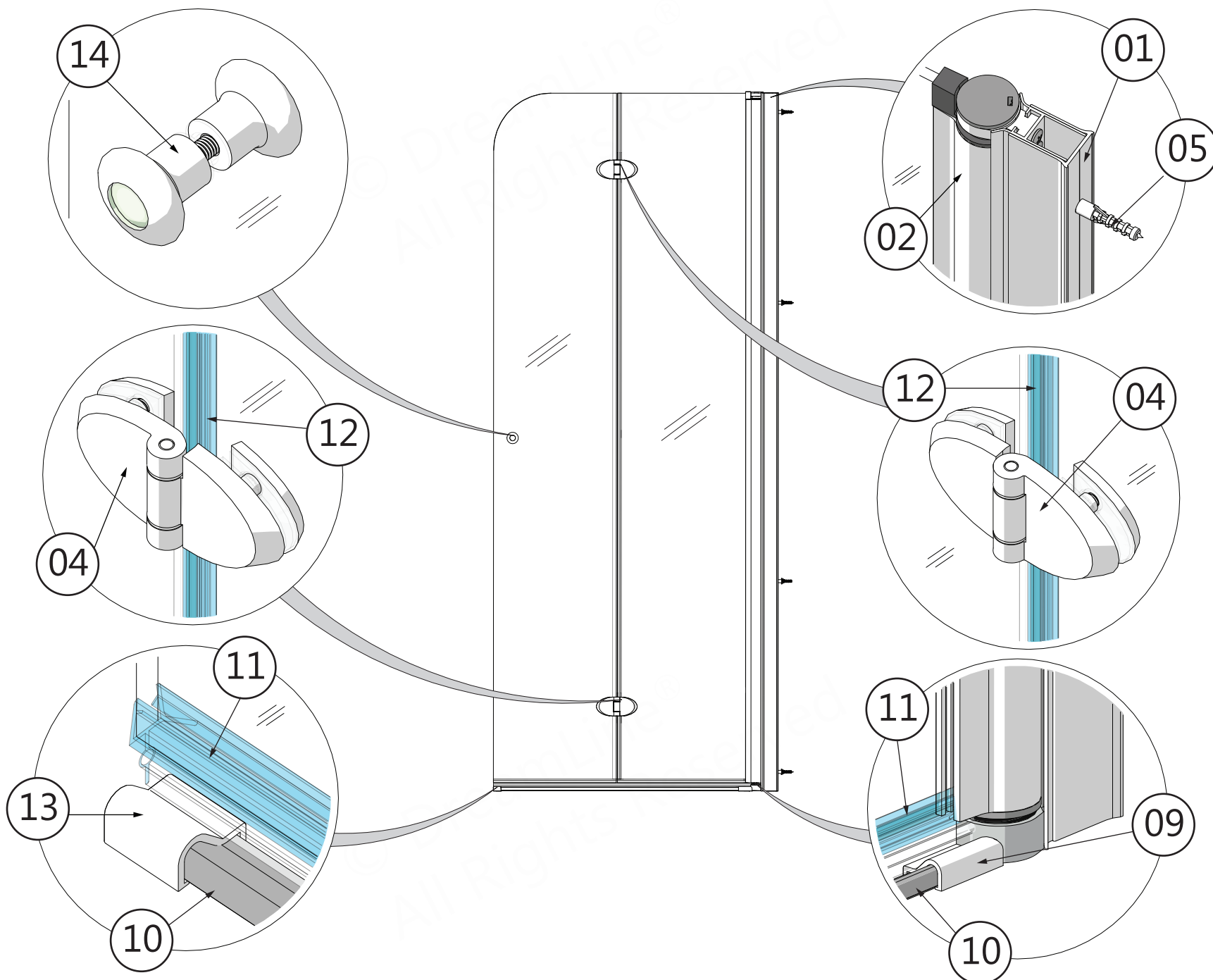

Parts List

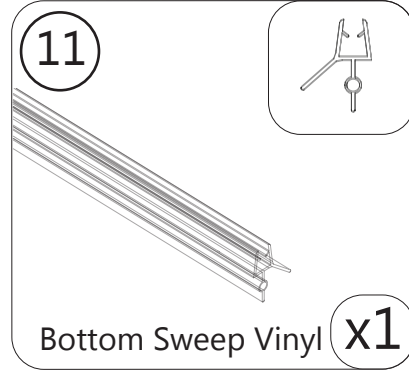
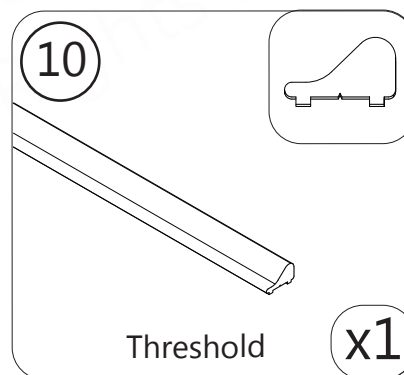
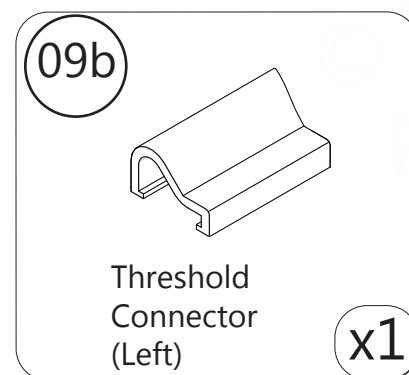
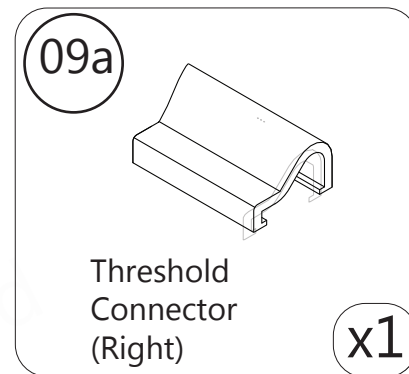
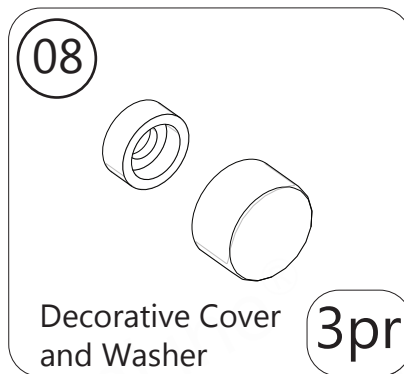
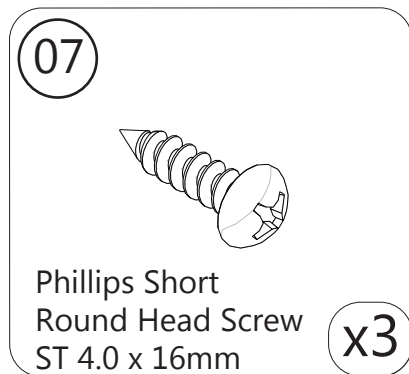
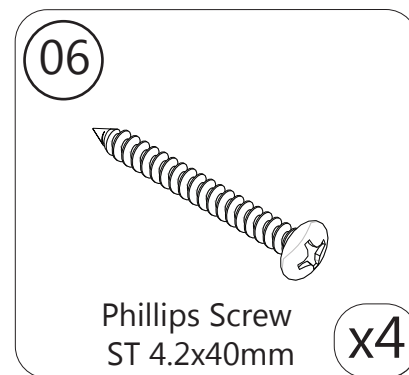
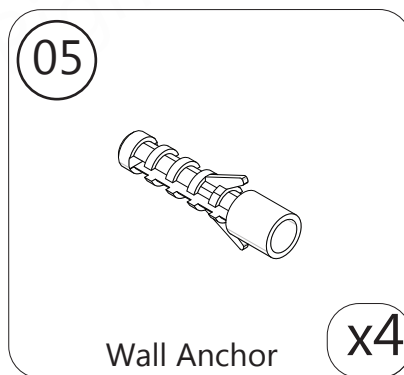
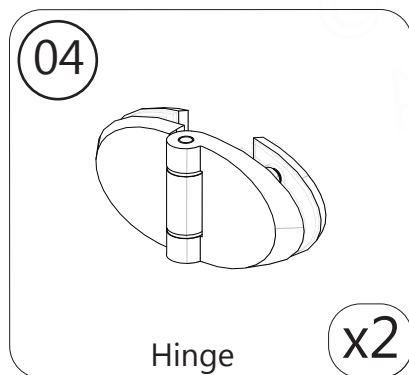
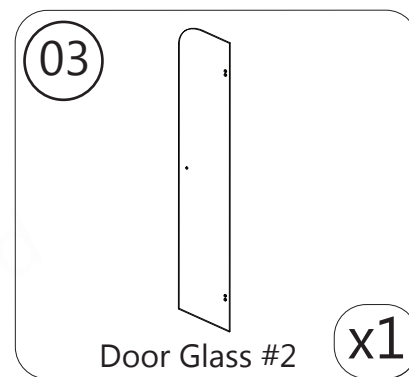
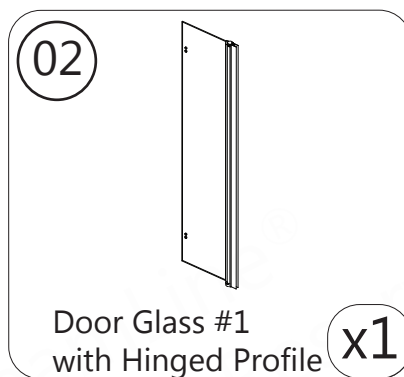
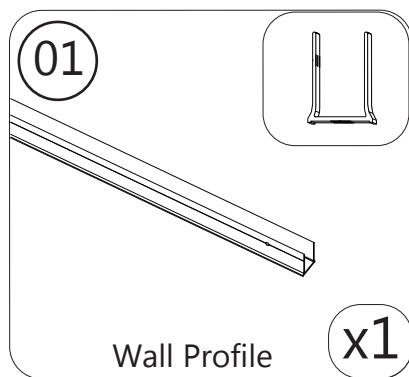

Parts List

12

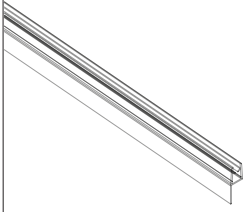

Side Vinyl Seal

x1

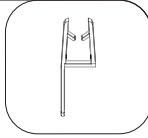

13a

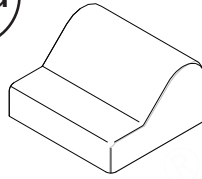

Threshold
End Cover
(Right)

x1

13b

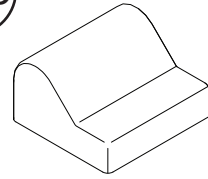

Threshold
End Cover
(Left)

x1

14

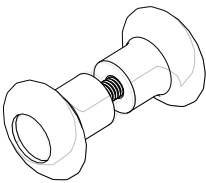

Knob Handle

x1

Installation Steps

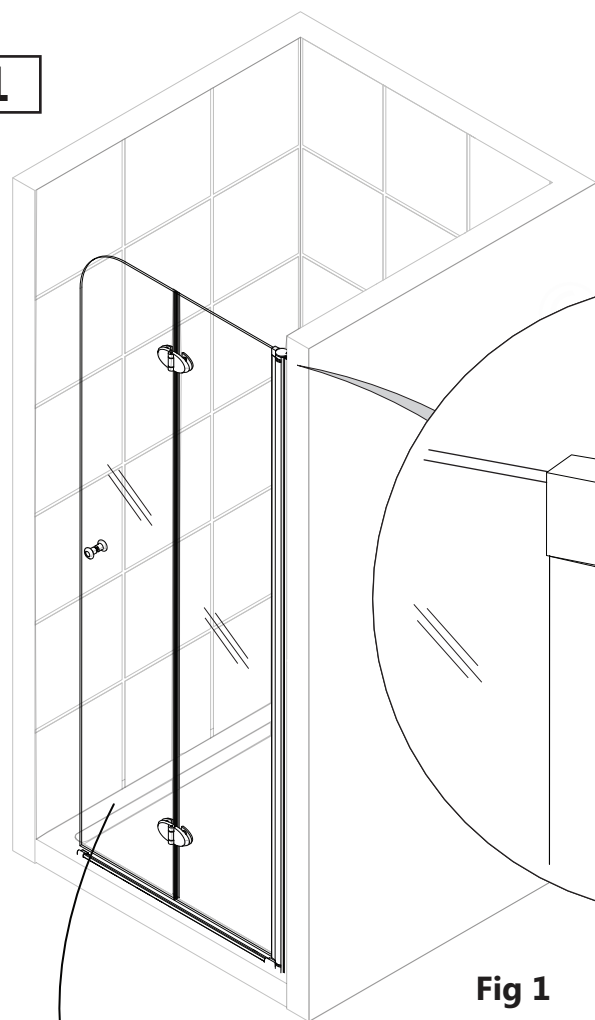
1

NOTE

Prepare and orient the panels for Hinge installation.

NOTE

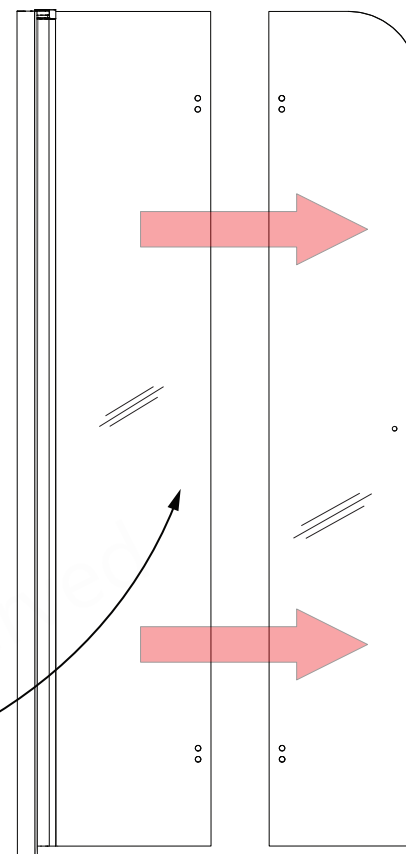
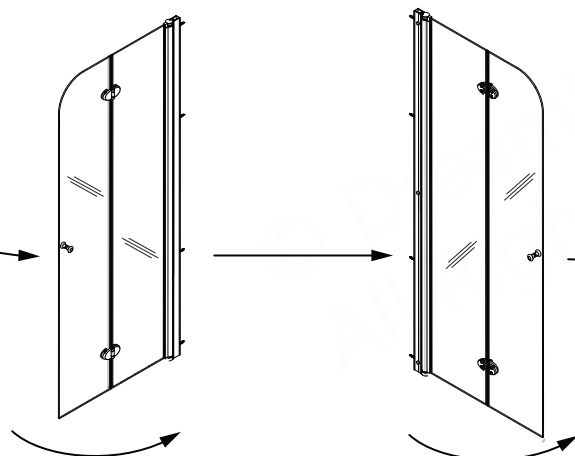
Right-hand installation shown. Reverse for left-hand installation.

Fig 1

Inside of Shower Door

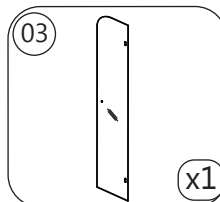
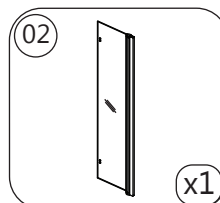
Parts Needed

2

Installing the Hinges on Door Glass #1 with Hinged Profile

Top

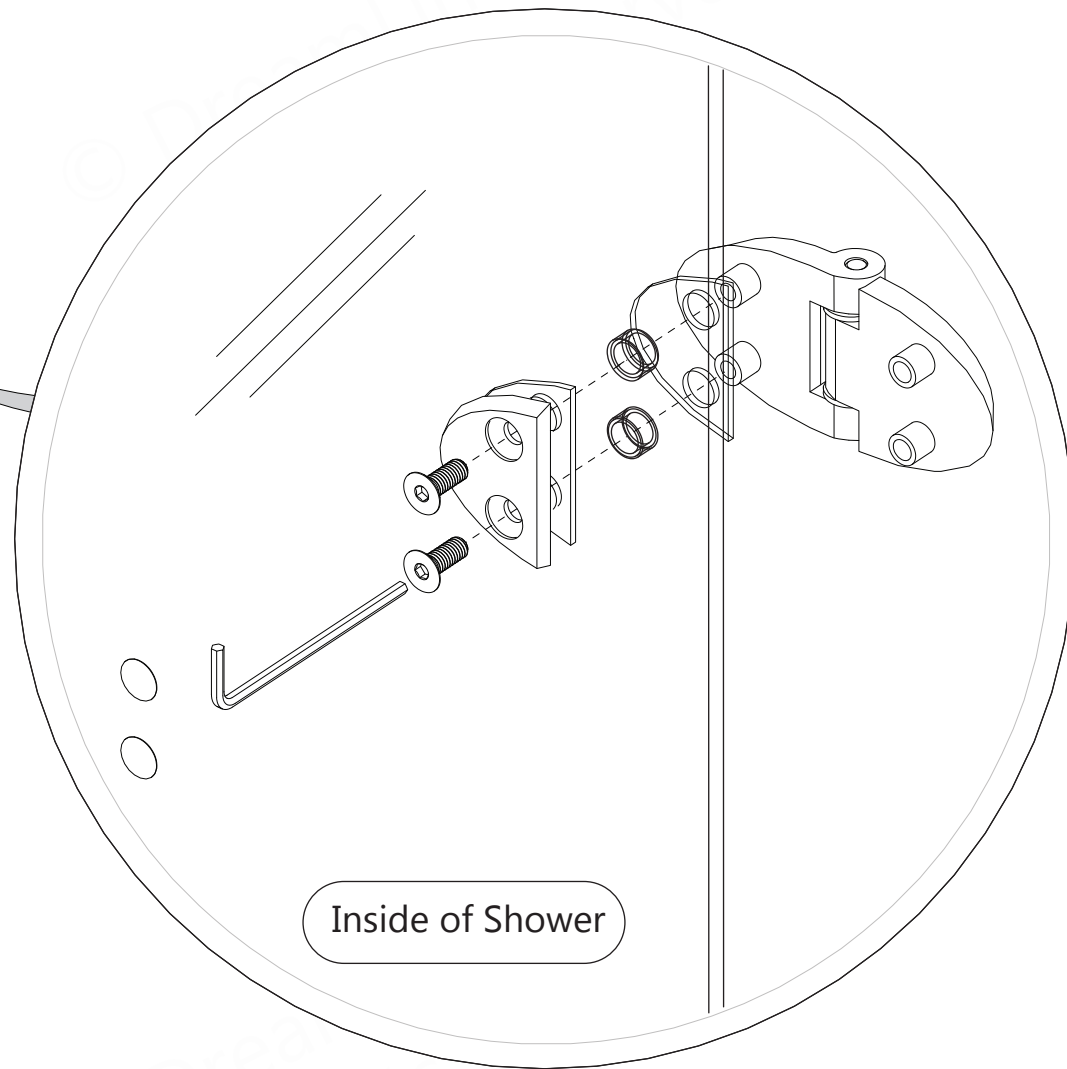
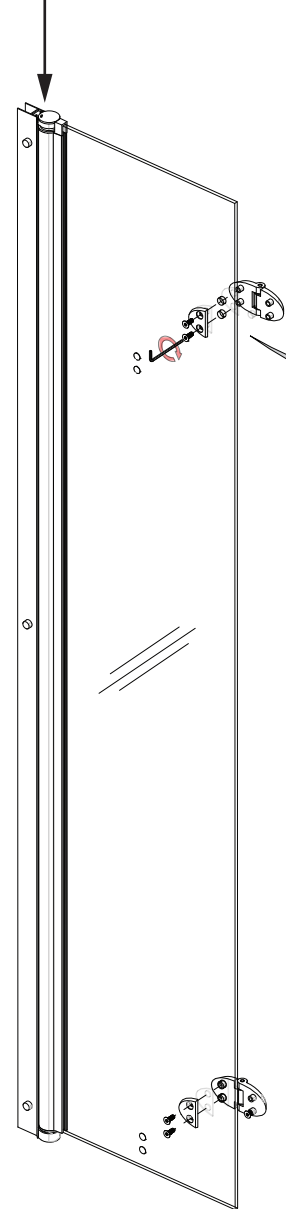

Inside of Shower

Fig 2



Be sure to use the gaskets on both sides of the glass to prevent glass to metal contact.

Parts Needed

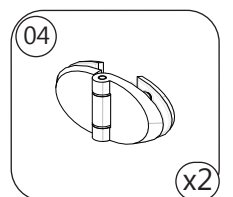
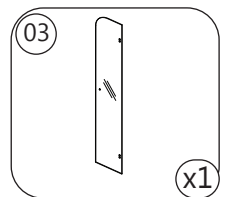

Tools Needed



3

Installing Door Glass #2 on the Hinges

TIP

Make sure the top edges of both doors are evenly aligned and that the space between the doors is even from top to bottom

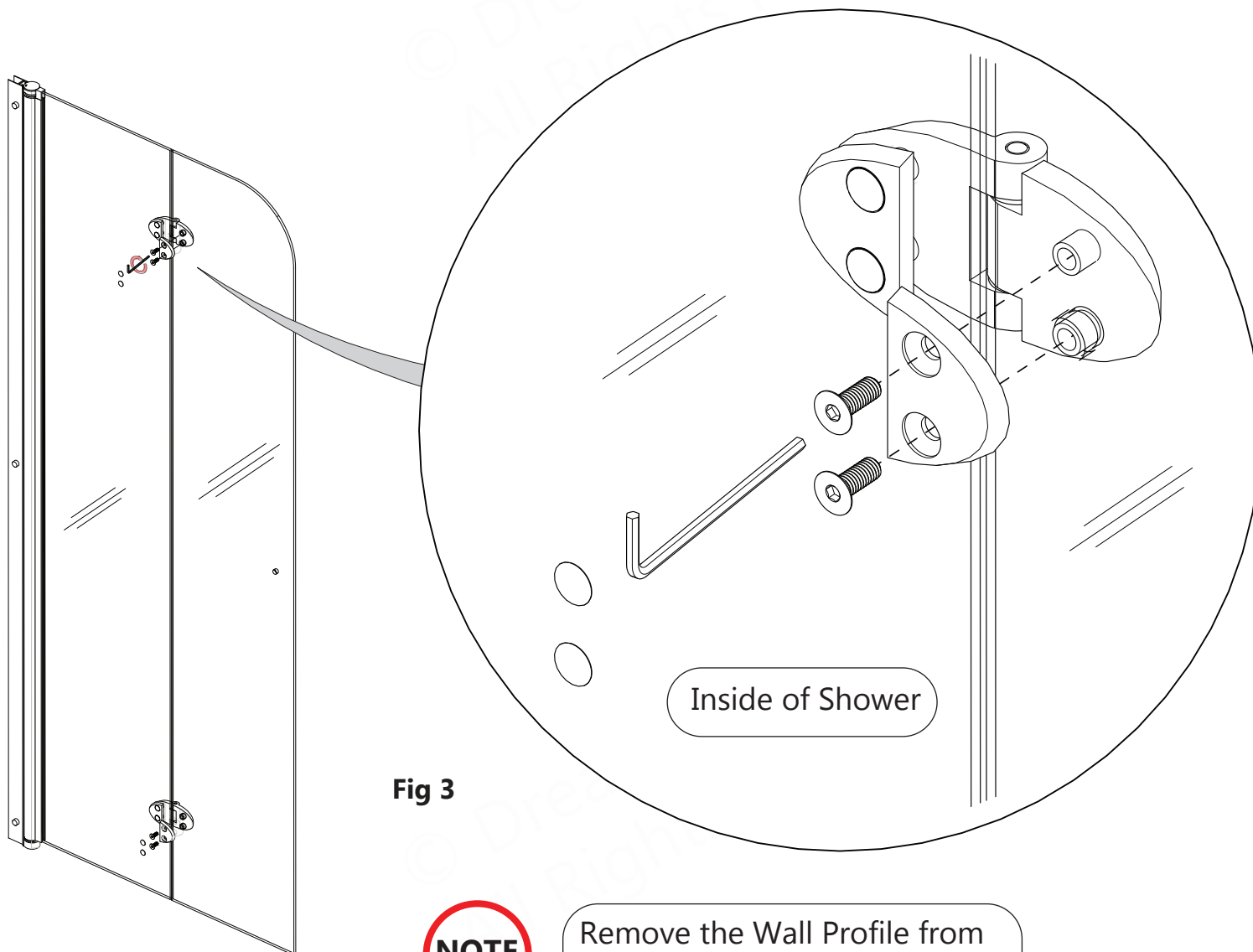
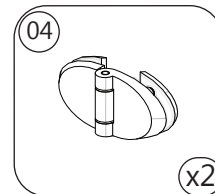
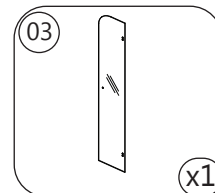
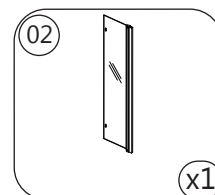

Fig 3

NOTE

Remove the Wall Profile from the assembly for the next step.

Parts Needed



Tools Needed

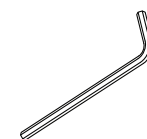

4

Installing the Wall Profile

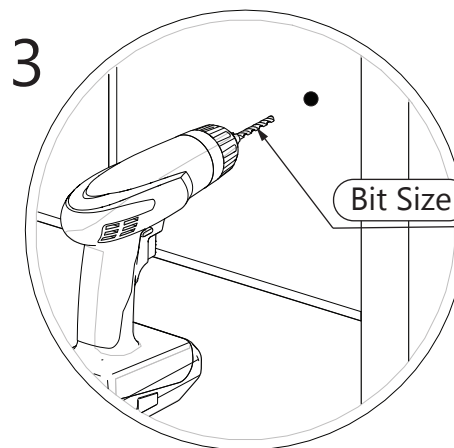
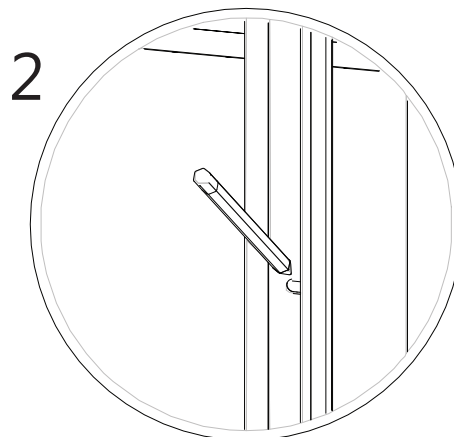
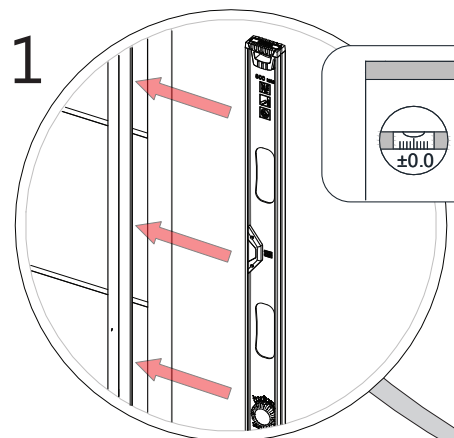

Bit Size

5/16" (8mm) for wall anchors, or 3/16" (5mm) up to a stud in the wall, then 1/8" (3mm) pilot hole into the stud.



NOTE

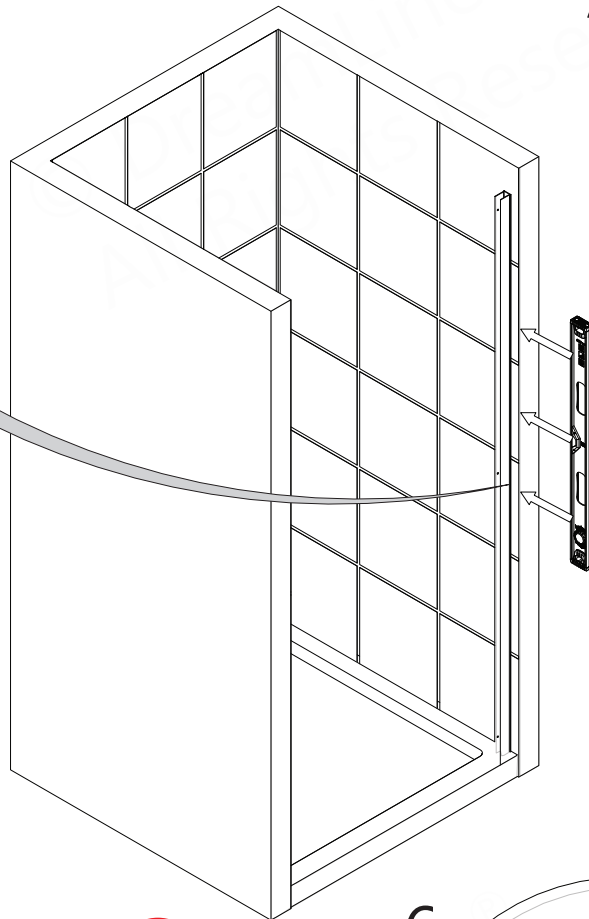

* 4

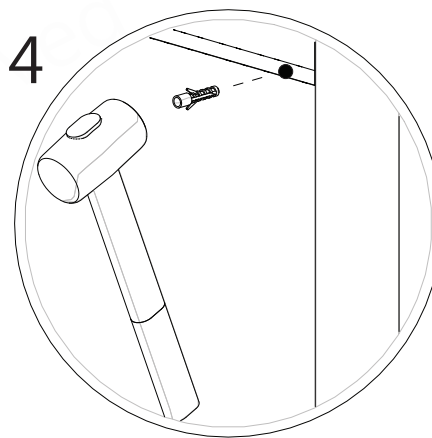

5

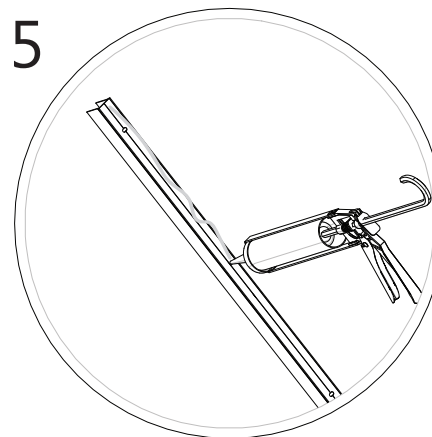

6

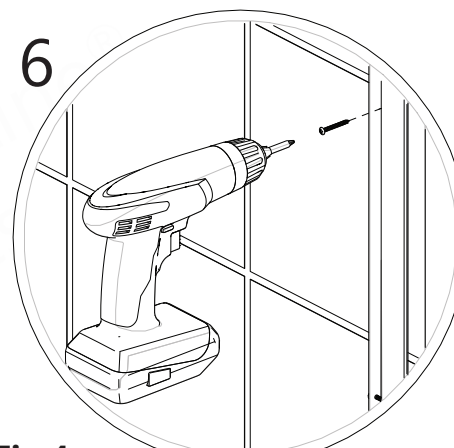

NOTE

* If needed (No wood in the wall)

Parts Needed

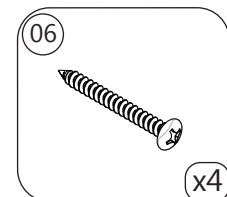
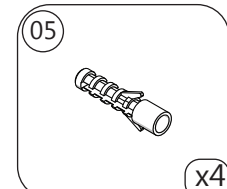
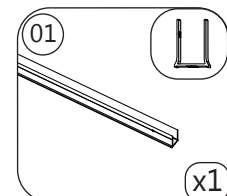

Tools Needed

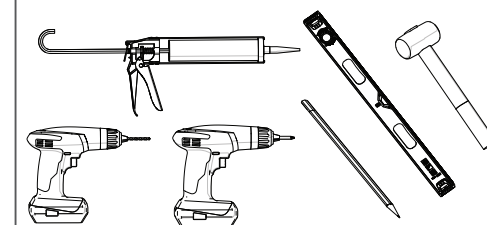

Fig 4

5

Installing the Door Assembly in the Wall Profile

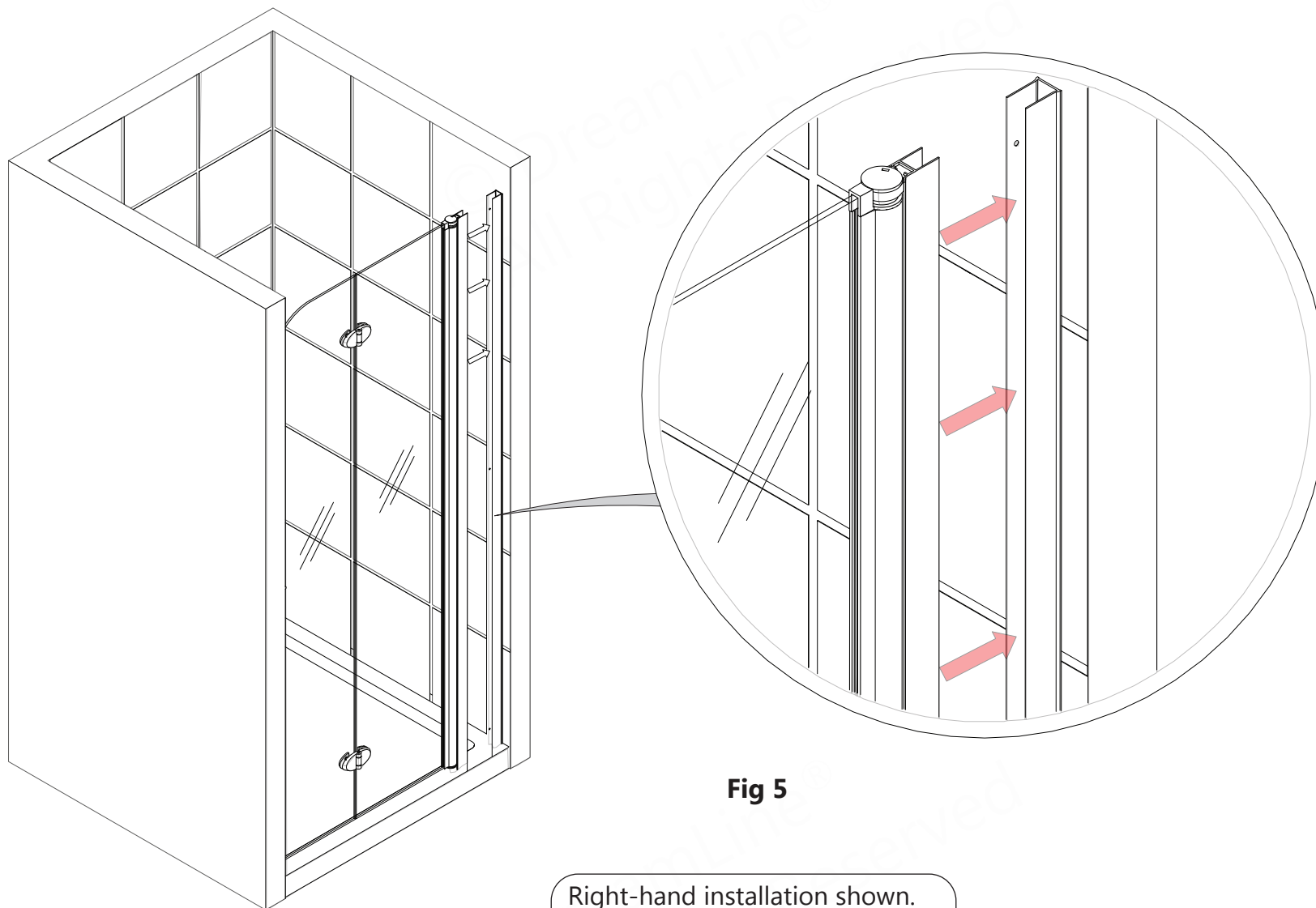

Fig 5

Right-hand installation shown.
Reverse for left-hand installation.

NOTE

Check the door for level and adjust for out of plumb conditions prior to connecting the profiles together from inside the shower with screws, washers and caps.

Parts Needed

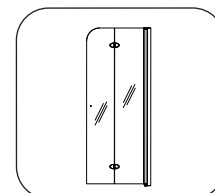

Tools Needed

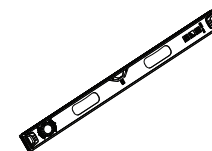

6

Securing the Profiles

NOTE

Check the door for level and adjust for out-of-plumb conditions prior to connecting the profiles together from inside the shower with the **Screws, Washers and Caps**.

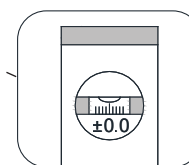
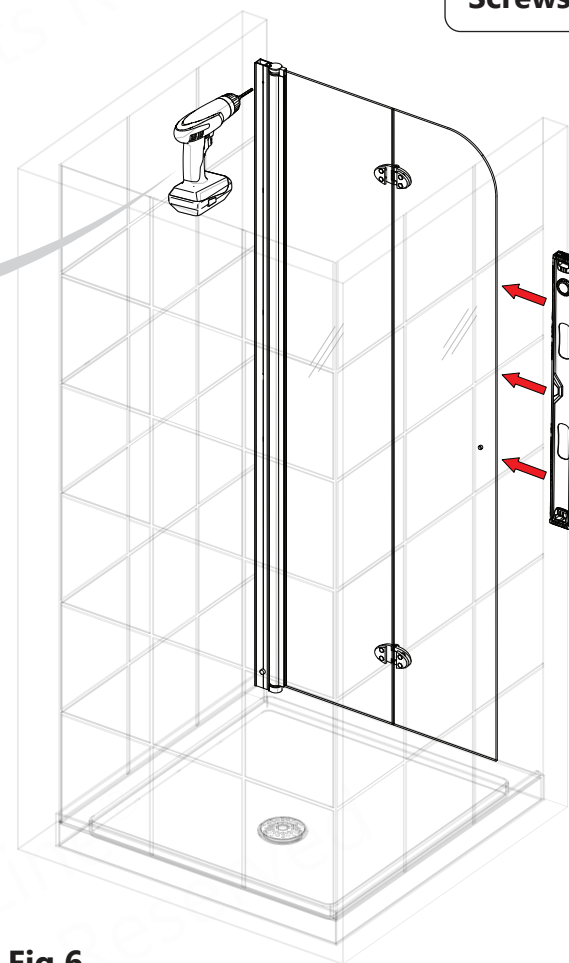
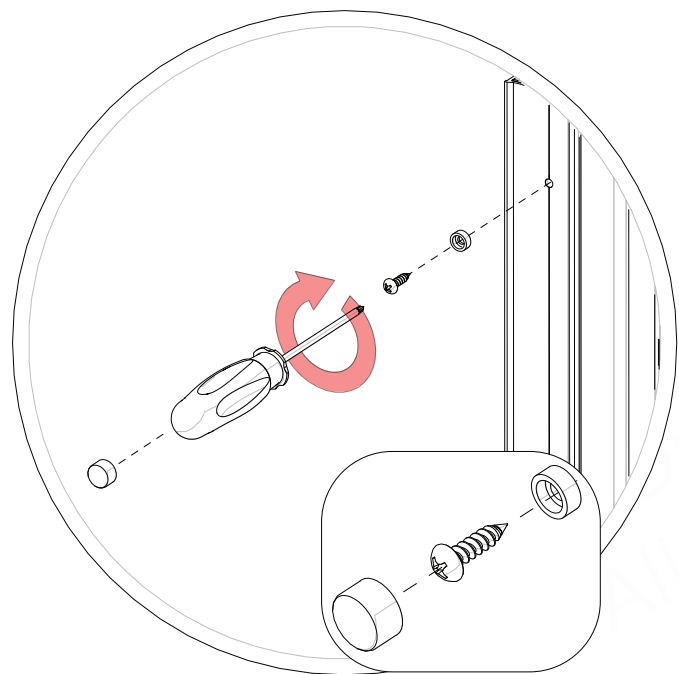
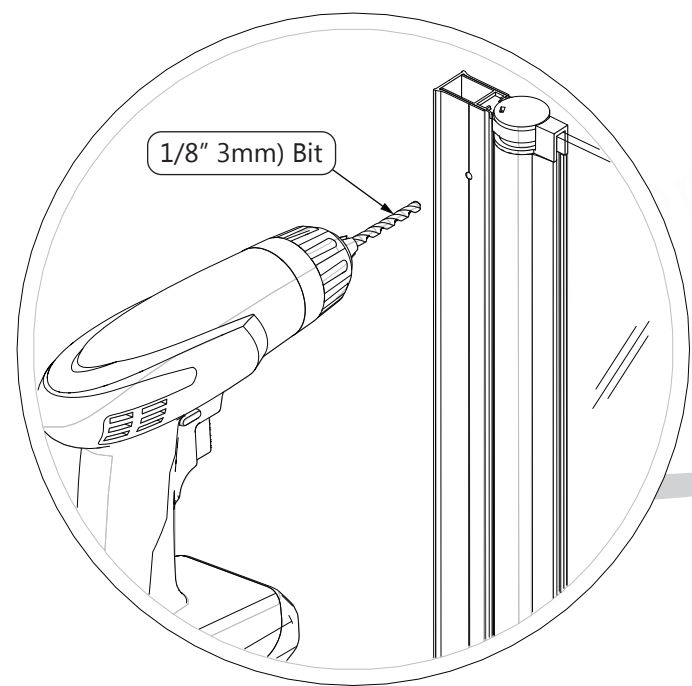

Parts Needed

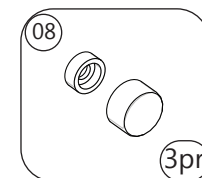
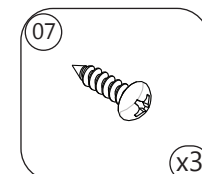

Tools Needed

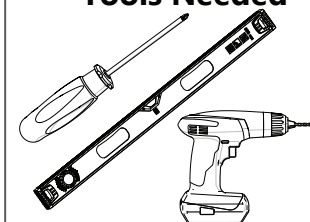

Fig 6

TIP

Drill only through one layer of metal. Use a hand-held Phillips screwdriver to prevent stripping the holes.

7

Installing the Threshold

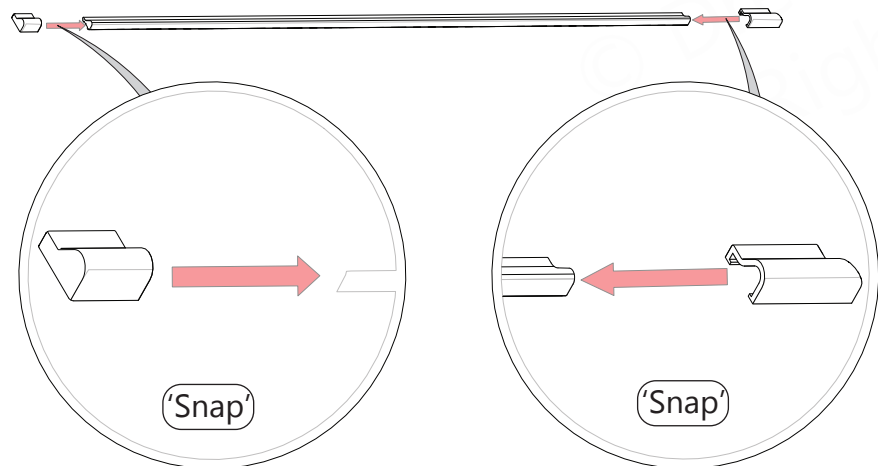

Right-hand installation shown.
Reverse for left-hand installation.

Fig 7

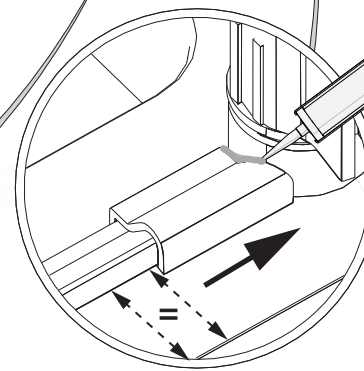
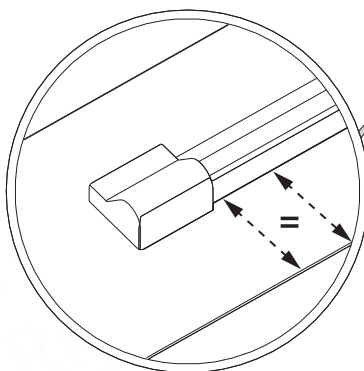
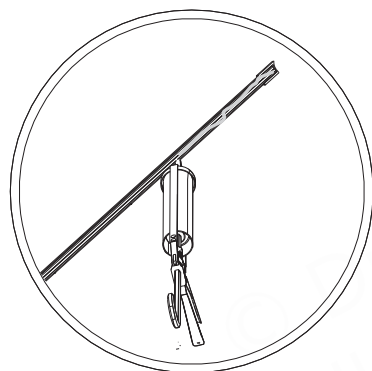

Allow the silicone to set up before proceeding to the next step.



Painter's tape can help keep the **Threshold** in place while the silicone sets up.

Parts Needed

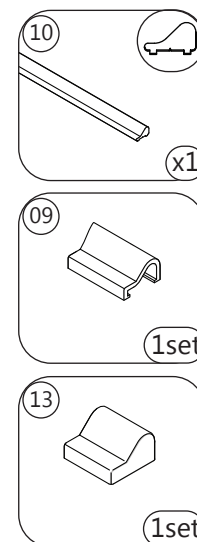

Tools Needed

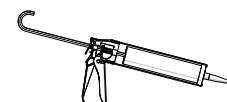

Measuring, Cutting & Installing the Sweep Vinyls

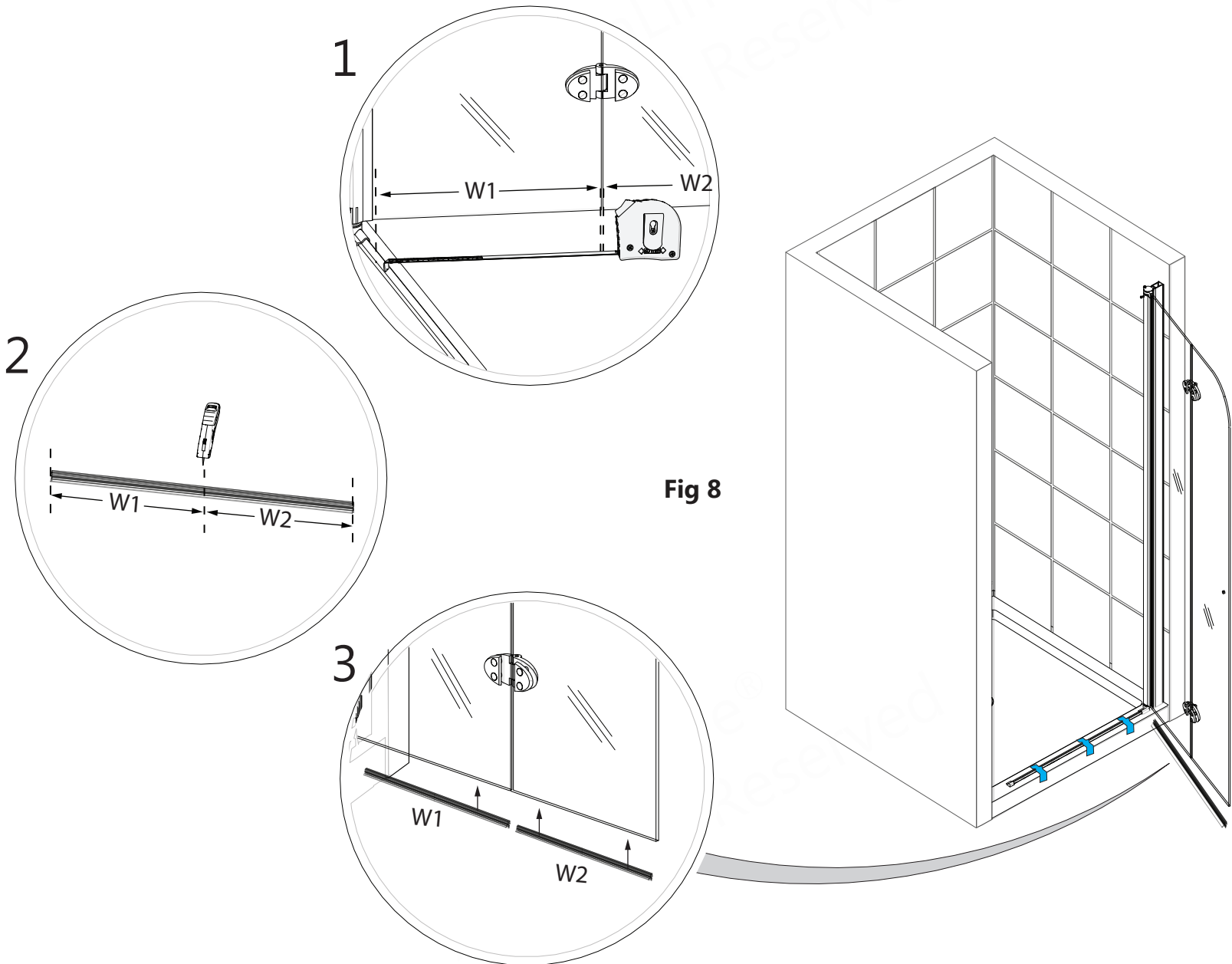

Parts Needed

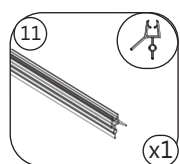

Tools Needed

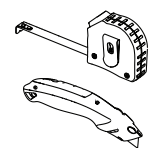

9

Installing the Side Vinyl Seal

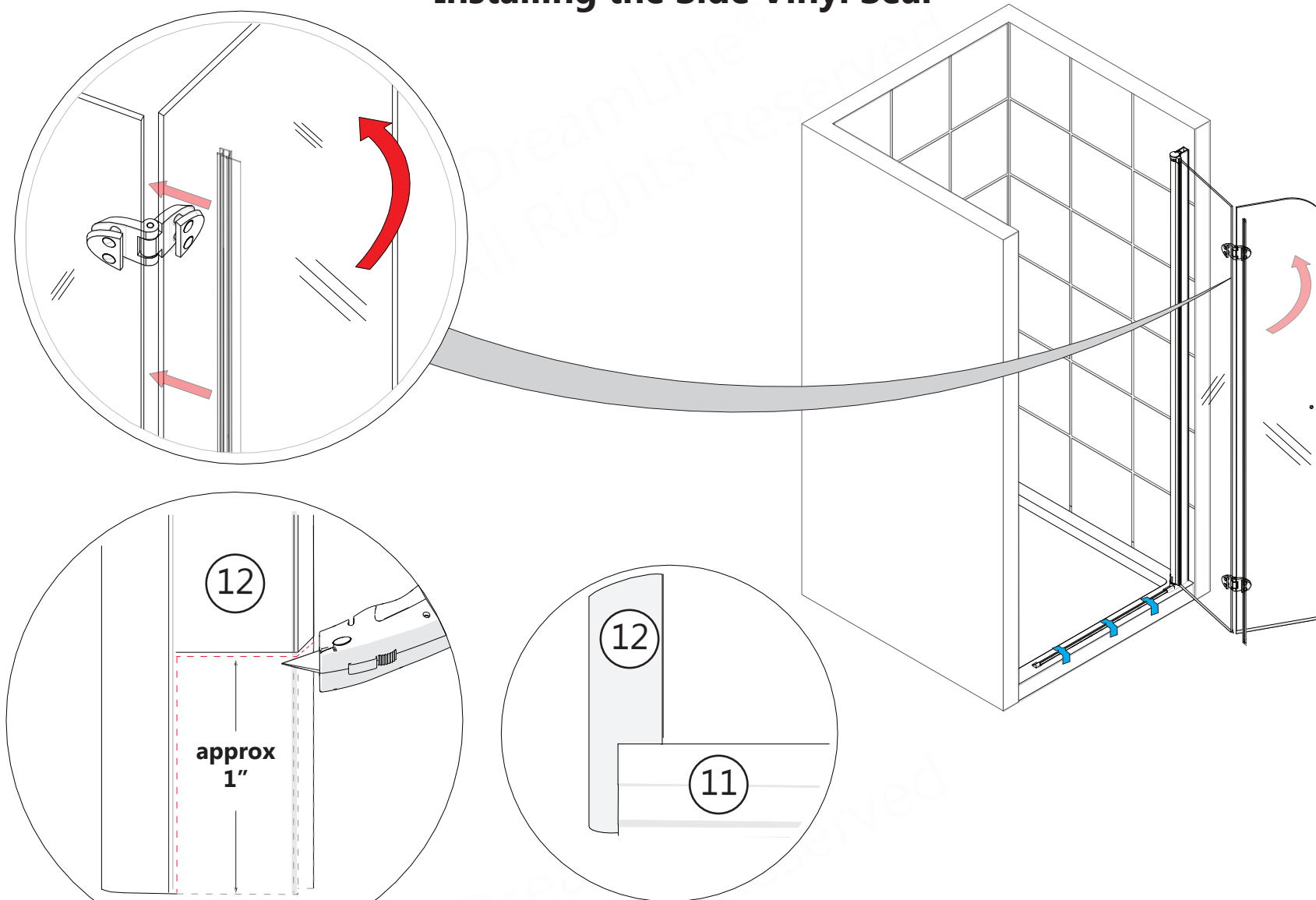
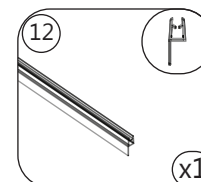

Fig 9



Use a razor knife to notch the **Vertical Vinyl Seal (#12)** to fit around the **Bottom Sweep Vinyl (#11)** as shown to prevent leaks. **Fig 9**

Parts Needed



10

Installing the Handle

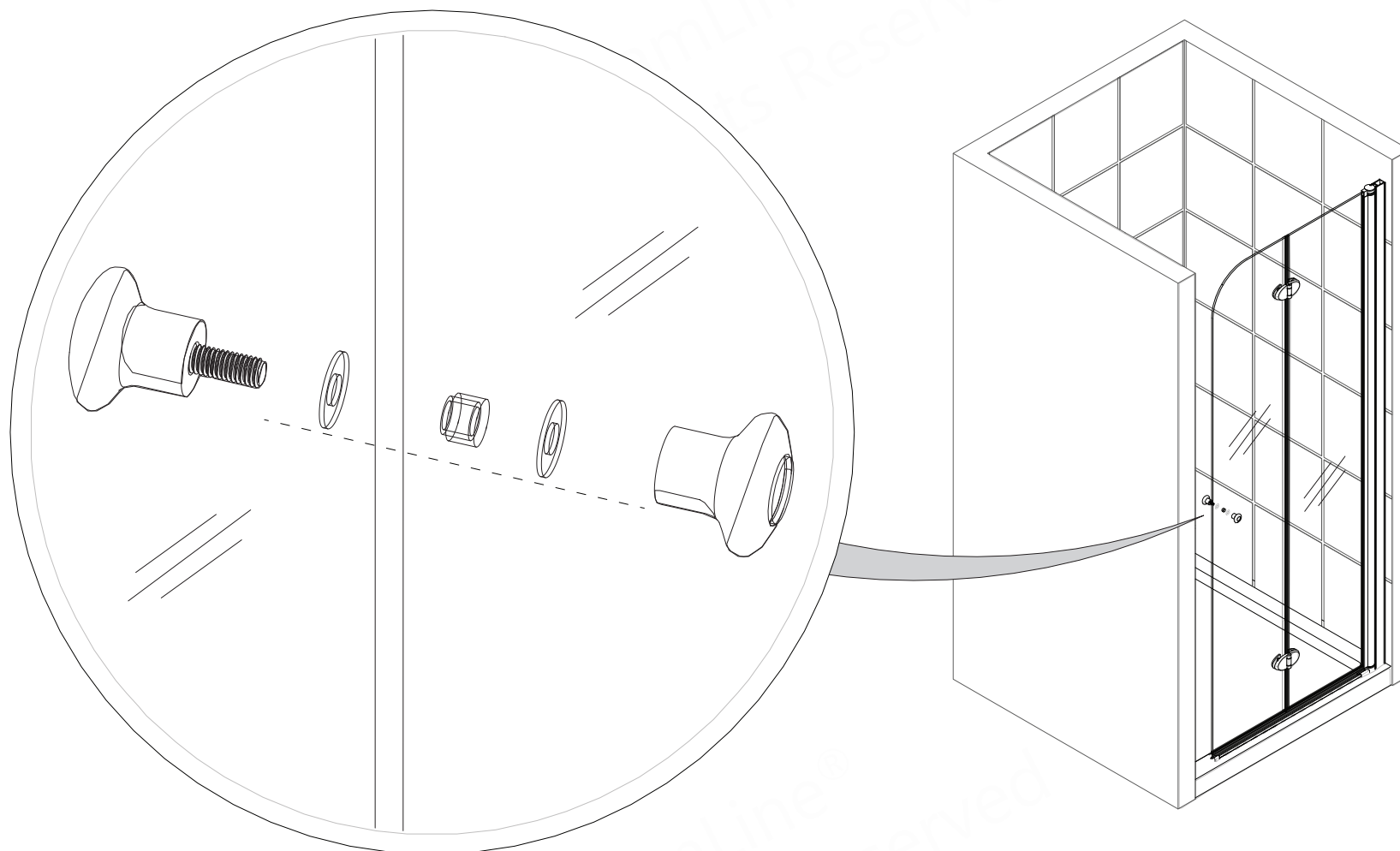
**Fig 10**

Warning: To avoid damage to the glass, always use caution when folding the doors. Make sure the metal **Handle** does not contact the **Door Glass**.

Parts Needed

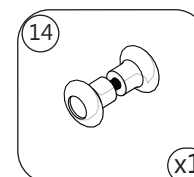

11

Apply Silicone to the Interior Perimeter



Use a high-quality, mildew-resistant silicone to seal the interior perimeter of the shower door. Allow 24 hours for the silicone to cure before using the shower.

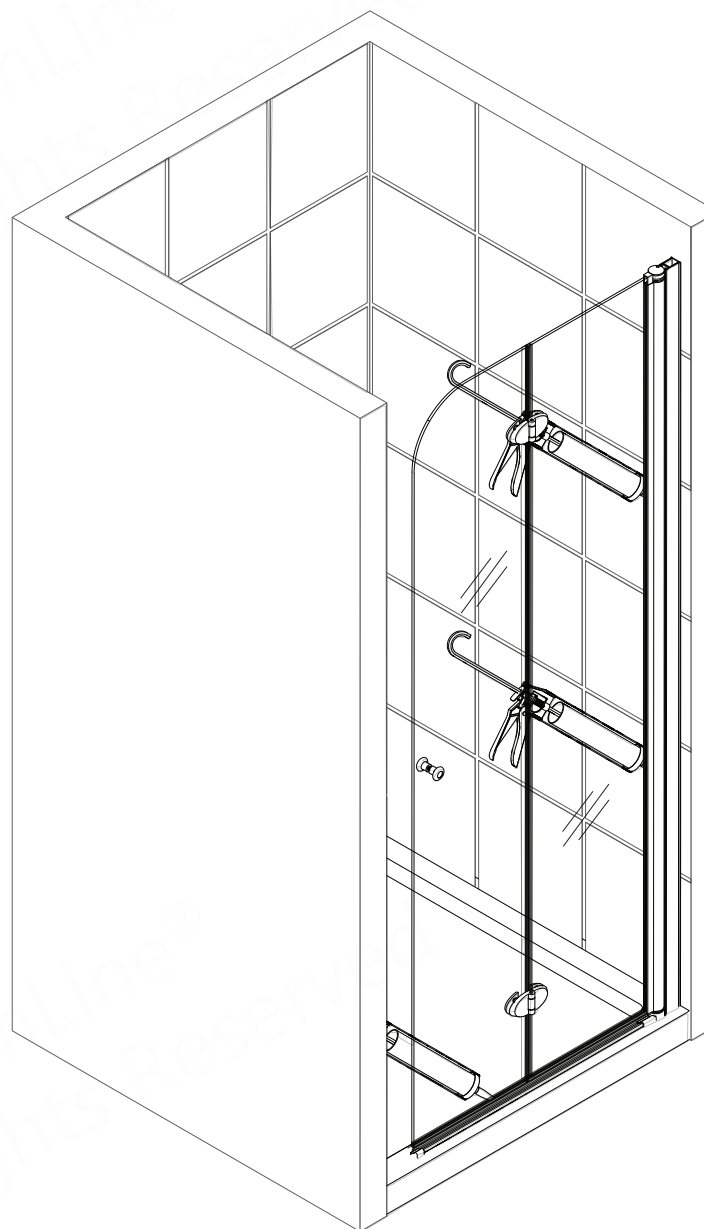
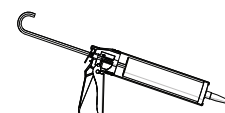

Fig 11

Tools Needed



Product Maintenance

BASES and BACKWALLS: To ensure long lasting life for your acrylic back walls: wipe them off after each use with a soft cloth. To clean the acrylic back walls use non-abrasive sprays or cream based cleaners. Avoid the use of aerosol spray cleaners. Never use abrasive cleansers, metal brushes or scrapers that could permanently scratch or dull the surface.

GLASS: To ensure long lasting life for your glass shower products: wipe them off after each use with a soft cloth. Rinse and wipe off the glass using either a soft cloth or a squeegee to prevent soap buildup and water spots (Hard water can etch the surface of the glass over time if left to dry). To prevent scratching the surface: never use abrasive cleaners or cleaning products that contain scouring agents. Never use bristle brushes or abrasive sponges that may scratch the surface of the glass.

HARDWARE: To ensure a long lasting finish: wipe off all metal parts after each use with a soft cloth. Do not use abrasive cleaners or cleaning products containing ammonia, bleach or acid. If accidentally used, rinse the surface as soon as possible to prevent damage to the finish (peeling or corrosion). After cleaning the polished finishes, rinse thoroughly and wipe dry with a soft clean-cloth.

Clean stainless steel surfaces at least once a week. When applying stainless steel cleaner or polish to stainless steel hardware, work with the grain (not across the grain). Never use an abrasive sponge or cloth, steel wool or wired brush as these may permanently scratch the surfaces.



To maximize the life of your door, it is important to regularly inspect the glass and other hardware for misalignment, proper attachment, and/or damage. Contact DreamLine® with any questions or concerns.

AQUA FOLD Maintenance Checklist

- ☐ Check that the unit is stable, operates smoothly and that installation is secure.
- ☐ Confirm that all screws/bolts are tight.
- ☐ Confirm that all vinyl seals are intact (replace if missing or damaged to prevent water leakage.)
- ☐ Inspect exposed and concealed glass edges for damage (**damaged glass must be replaced!**)
- ☐ Inspect silicone caulk for gaps. Replace silicone as necessary to prevent water leakage.

Troubleshooting

Problem/Symptom	Suggested Solution
Missing Parts	<ul style="list-style-type: none"> • Check all shipping/packaging material for missing parts/components. • If not found, contact DreamLine Customer Support [1-866-731-2244] to order factory part replacement.
Door is not operating smoothly	<p>Check the Vinyl Seals for proper trimming and installation</p> <ul style="list-style-type: none"> • Confirm the Hinges (#04) are tightly secured to the Door Glass. See Hinge Installation instructions on pages 9 and 10. • Confirm the Sweep Vinyl (#11) is tightly secured to the bottom of the Door Glass (#02, #03) as seen on page 15. • Confirm the Side Vinyl Seal (#12) is correctly notched around the Bottom Sweep Vinyl (#11) as seen on page 16.
Handle (#14) rattles during operation	<ul style="list-style-type: none"> • Confirm the vinyl gaskets are present and the knob is tightly secured to the glass.



The Aqua Fold Shower/Tub Door is designed to swing out.



Prior to contacting DreamLine® Customer Service, please have the following information readily available:

- Purchase Order Information
 - Name, PO Number, Dealer/Vendor Name, etc.
- SKU/Model Number (see Cover Page)
- Factory Part Information (see Pages 21-23)

Factory Parts Information

	Factory Part #	Item Description	Item Specification	Qty
	SHDR-3630720-0 X	AQUAFOLD (3072) Ground Pack	EF063 AQUAFOLD(3072)	1
1	041240 X 1-1830	Wall Profile	LC124/Chrome/1830mm	1
2	220630 X 01	Door Glass # 1 w/Hinged Profile	(3072)Chrome	1
3	010063006	Door Glass #2	1808X322X6 Clear	1
4	0741 X 014	Hinge	GP-918/ brass/ chrome	2
5	7552148	Wall Anchor	Ø8mm*L37mm/ plastic/ white	6
6	090108	Phillips Screw ST 4.2x40mm	ST4.2x40/Stainless steel	7
7	091102	Phillips Short Round Head Screw ST4.0 x 16mm	ST4.0×16/Stainless steel	6
8	0755 X 011	Decorative cover and Washer	M4/ plastic/ chrome	6
9a	0755 X 057	Threshold Connector-Right	Arc angle-R/ plastic/ chrome	1
9b	0755 X 058	Threshold Connector-Left	Arc angle-L/ plastic/ chrome	1
10	040920 X 1-0760	Threshold	LC092/Chrome/760mm	1
11	063015060-0678	Bottom Sweep Vinyl	678mm/Clear/For 6mm Glass/Soft Lip 16mm	1
12	063005060-1818	Side Vinyl Seal	1818mm/Clear/For 6mm Glass/Soft Lip 12mm	1
13a	0755 X 077	Threshold End Cover - Right	2# Corner-L/ plastic plastic/ chrome	1
13b	0755 X 078	Threshold End Cover - Left	2#Corner Angle-right/ plastic plastic/ chrome	1
14	0721 X 028	Knob Handle	∅ 30X25mm/ SS304/ chrome	1

BOLD ("**X**") indicates finish:

1 or 8 = Polished SS

4 or 5 or 7 = Brushed SS

6 = Oil Rubbed Bronze

9 = Satin Black

Contact **Support@DreamLine.com** for Part replacement, installation assistance or additional information.

Complete **Warranty** information is available on **DreamLine.com**.

Factory Parts Information

Item #	Factory Part #	Item Description	Item Specification	Qty
	SHDR-3634720-0 X	AQUAFOLD (3472) Ground Pack	EF063 AQUAFOLD(3472)	1
1	041240 X 1-1830	Wall Profile	LC124/Chrome/1830mm	1
2	220630 X 02	Door Glass # 1 w/Hinged Profile	(3472)Chrome	1
3	010063004	Door Glass #2	1808X373X6 Clear	1
4	0741 X 014	Hinge	GP-918/ brass/ chrome	2
5	07552148	Wall Anchor	Ø8mm*L37mm/ plastic/ white	6
6	090108	Phillips Screw ST 4.2x40mm	ST4.2x40/Stainless steel	7
7	091102	Phillips Short Round Head Screw ST4.0 x 16mm	ST4.0×16/Stainless steel	6
8	0755 X 011	Decorative cover and Washer	M4/ plastic/ chrome	6
9a	0755 X 057	Threshold Connector-Right	Arc angle-R/ plastic/ chrome	1
9b	0755 X 058	Threshold Connector-Left	Arc angle-L/ plastic/ chrome	1
10	040920 X 1-0760	Threshold	LC092/Chrome/760mm	1
11	063015060-0780	Bottom Sweep Vinyl	780mm/Clear/For 6mm Glass/Soft Lip 16mm	1
12	063005060-1818	Side Vinyl Seal	1818mm/Clear/For 6mm Glass/Soft Lip 12mm	1
13a	0755 X 078	Threshold End Cover-Right	2#Corner Angle-right/ plastic plastic/ chrome	1
13b	0755 X 077	Threshold End Cover-Left	2# Corner-L/ plastic plastic/ chrome	1
14	0721 X 028	Knob Handle	Ø 30X25mm/ SS304/ chrome	1

BOLD ("**X**") indicates finish:

1 or 8 = Polished SS

4 or 5 or 7 = Brushed SS

6 = Oil Rubbed Bronze

9 = Satin Black

Contact **Support@DreamLine.com** for Part replacement, installation assistance or additional information.

Complete **Warranty** information is available on **DreamLine.com**.

Factory Parts Information

Item #		Item Description	Item Specification	Qty
	SHDR-3636580-0 X	AQUAFOLD (3658) Ground Pack	EF063 AQUAFOLD(3658)	1
1	041240 X 1-1473	Wall Profile	LC124/Chrome/1473mm	1
2	220630 X 03	Door Glass #1 w/Hinged Profile	(3658)Chrome	1
3	010063002	Door Glass #2	1452X404X6 Clear	1
4	0741 X 014	Hinge	GP-918/ brass/ chrome	2
5	07552148	Wall Anchor	Ø8mm*L37mm/ plastic/ white	6
6	090108	Phillips Screw ST4.2 x 40mm	ST4.2x40/Stainless steel	7
7	091102	Phillips Short Round Head Screw ST4.0 x 16mm	ST4.0×16/Stainless steel	6
8	0755 X 011	Decorative cover and Washer	M4/ plastic/ chrome	6
9a	0755 X 057	Threshold Connector-Right	Arc angle-R/ plastic/ chrome	1
9b	0755 X 058	Threshold Connector-Left	Arc angle-L/ plastic/ chrome	1
10	040920 X 1-0823	Threshold	LC092/Chrome/823mm	1
11	063015060-0841	Bottom Sweep Vinyl	841mm/Clear/For 6mm Glass/Soft Lip 16mm	1
12	063005060-1463	Side Vinyl Seal	1463mm/Clear/For 6mm Glass/Soft Lip 12mm	1
13a	0755 X 078	Threshold End Cover-Right	2#Corner Angle-right/ plastic plastic/ chrome	1
13b	0755 X 077	Threshold End Cover-Left	2# Corner-L/ plastic plastic/ chrome	1
14	0721 X 028	Knob Handle	Ø 30X25mm/ SS304/ chrome	1

BOLD ("**X**") indicates finish:

1 or 8 = Polished SS

4 or 5 or 7 = Brushed SS

6 = Oil Rubbed Bronze

9 = Satin Black

Contact **Support@DreamLine.com** for Part replacement, installation assistance or additional information.

Complete **Warranty** information is available on **DreamLine.com**.



TEL: 866-731-2244
FAX: 866-857-3638
DREAMLINE.COM



For more information on DreamLine® Shower Doors and Enclosures please visit **DreamLine.com**

EXTENDER Panel (EX) / RETURN Panel (RT)

EX / RT STATIONARY PANEL INSTALLATION INSTRUCTIONS

IMPORTANT

DreamLine® reserves the right to alter, modify or redesign products at any time without prior notice. For the latest up-to-date technical drawings, manuals, warranty information or additional details please refer to your model's web page on **DreamLine.com**

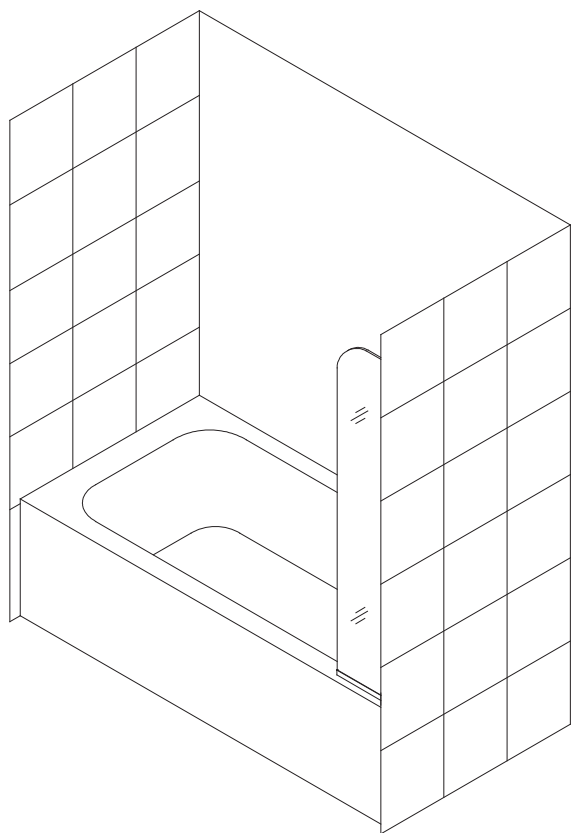

9" x 58" Extender Panel (EX)

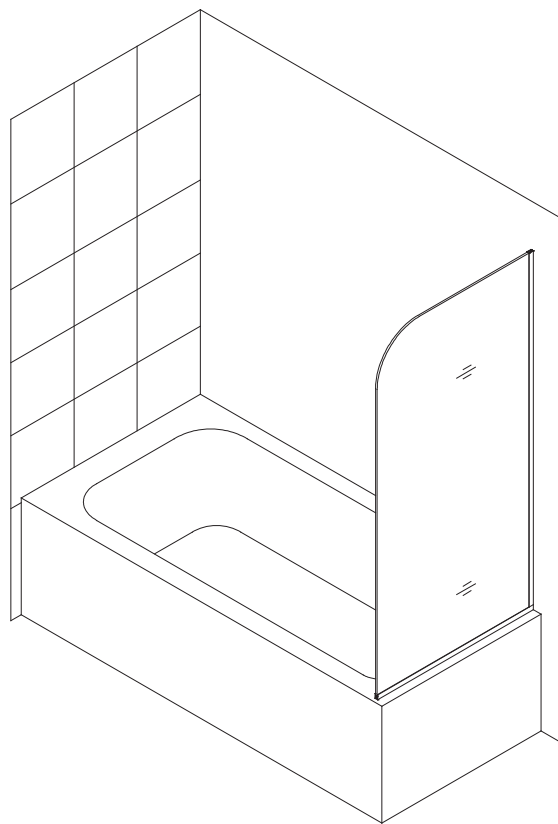

30" x 58" Return Panel (RT)

Right hand installation shown



Questions?

Please Call **DreamLine Customer Support: 1-855-831-2126**
Hours of Operation M-F 8AM - 7PM EST and Saturday 9AM - 5PM EST

Support@DreamLine.com



For more information about DreamLine® Shower Doors & Tub Doors please visit **DreamLine.com**

Table of Contents

Section title	Page #
Aqua Series with Extender (EX) or Return (RT) Panel Model #s	3
Preparation	4
Tools	5
Parts Diagram/Packing List	6
Installation Steps	7-14
Product Maintenance	15

AQUA series with Extender (EX) or Return Panel (RT) Model #s:

Aqua Tub -EX

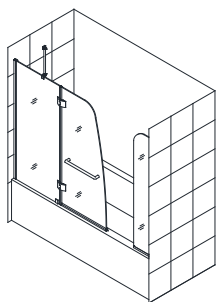

SHDR-3148586-EX-01
SHDR-3148586-EX-04

Aqua Tub -RT

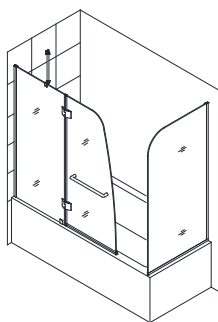

SHDR-3148586-RT-01
SHDR-3148586-RT-04

AquaLux-Tub -EX

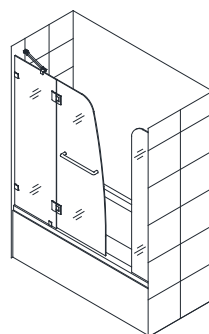

SHDR-3348588-EX-01
SHDR-3348588-EX-04

AquaLux-Tub -RT

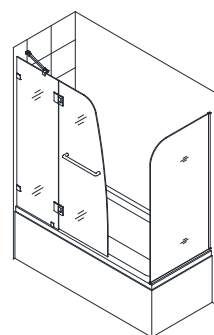

SHDR-3348588-RT-01
SHDR-3348588-RT-04

Aqua-Ultra Tub-EX

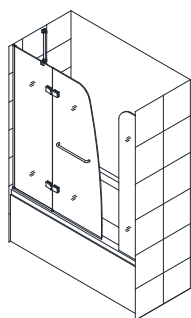

SHDR-3448580-EX-01
SHDR-3448580-EX-04

Aqua-Ultra Tub-RT

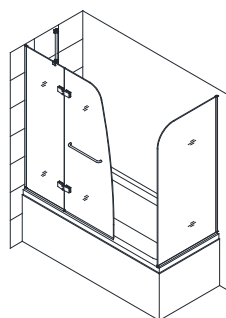

SHDR-3448580-RT-01
SHDR-3448580-RT-04

Aqua Uno-Tub-EX

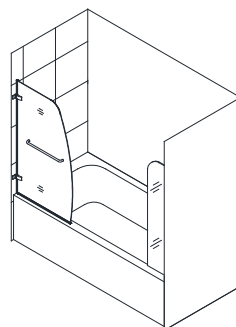

SHDR-3534586-EX-01
SHDR-3534586-EX-04

Aqua Uno-Tub-RT

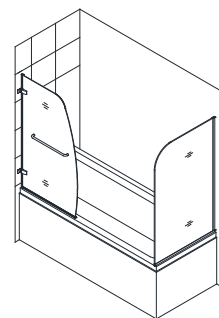

SHDR-3534586-RT-01
SHDR-3534586-RT-04

Aqua Fold-Tub -EX

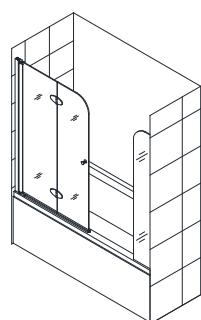

SHDR-3636580-EX-01

Aqua Fold-Tub -RT

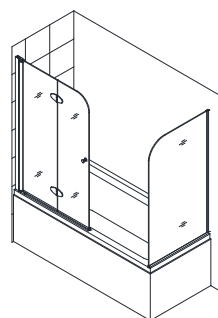

SHDR-3636580-RT-01

Aqua Swing-Tub-EX

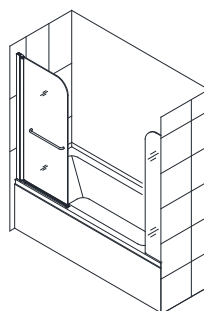

SHDR-3734580-EX-01

Aqua Swing-Tub-RT

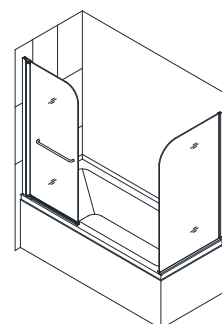

SHDR-3734580-RT-01

Finish:
01- Chrome
04- Brushed Nickel

Preparation

1. Prior to installation, examine all boxes and packages for shipping damage and compare the piece count with your packing slip. After opening all boxes and packages read this introduction carefully. Check that all of the needed parts are included in the package by checking off the components on the "Detailed Diagram of Shower Door Components". If the unit has been damaged, has a finishing defect, or has missing parts, please contact our customer support department within **3 business days** of the delivery date. **Please note that DreamLine® will not replace any damaged products or missing parts free of charge after 3 business days or if the product has been installed.** Contact DreamLine® if you have any questions and please provide an order number, job name or other proof of purchase to help us identify your original order.

2. **Please note that you should consult your local building codes with questions on installation compliance standards. Building and plumbing codes may vary by location, and DreamLine® is not responsible for code compliance standards for your project and will not accept any returns.**

3. If this unit is going to be installed in a new construction, please install all of the required plumbing and drainage before installing the shower. Use a competent and licensed (if required by local code) plumber for all plumbing installation.

4. Make sure that prior to beginning the installation, the surfaces are leveled and solid and will be able to support the total weight of the unit. Also make sure the walls are at right angles. Irregular installation surface level, radius corners or improper angle of side walls will result in serious problems for your installation. Please, note that some adjustments and drilling might be necessary during the installation process.

5. Protect all primary surfaces of the product during installation. Never set your glass down directly onto a tile floor. Leave corner protectors in place until necessary to remove them. Always use a piece of wood or cardboard to protect the bottom edge and corners of the glass prior to and during installation.

6. This unit must be installed upon a finished threshold and against finished walls.

7. This model allows for a maximum of 1/2" of adjustment for out-of-plumb wall conditions and 1/4" of adjustment for out-of-level conditions within the u-channel. Use a level to verify the opening conditions before proceeding with the installation.

8. **This model requires that you drill into the threshold for proper installation.**

9. These panels require 5/8" of flat threshold space for installation.

This manual assumes that the Aqua Series tub door has already been installed.



NOTE: These panels are reversible for left or right hand installation. This manual will show the right hand installation as an example. For a left hand installation, simply begin on the opposite wall and reverse the orientation of the parts as necessary.



To prevent serious injury, DO NOT lean against the installed panel glass.

Tools



Level

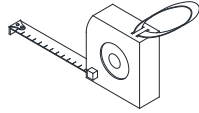

Tape Measure

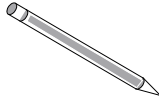

Pencil



Phillips Screwdriver



Drill bit
(Ø=5/16")



Drill bit
(Ø=1/8")

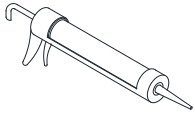

Silicone



Power Drill

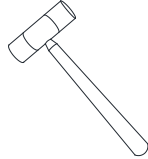

Hammer

NOTE: Unpack your unit carefully and inspect it. Lay it out and identify all parts using the detailed diagram and packing list in this manual as a reference. Before discarding the carton, check for small hardware bags that may have fallen to the bottom of the box. If any parts are damaged or missing, please contact DreamLine® for replacement. The shipping boxes may contain extra parts not used in your model configuration.

NOTE: Retain these installation instructions for future reference.

Parts Diagram

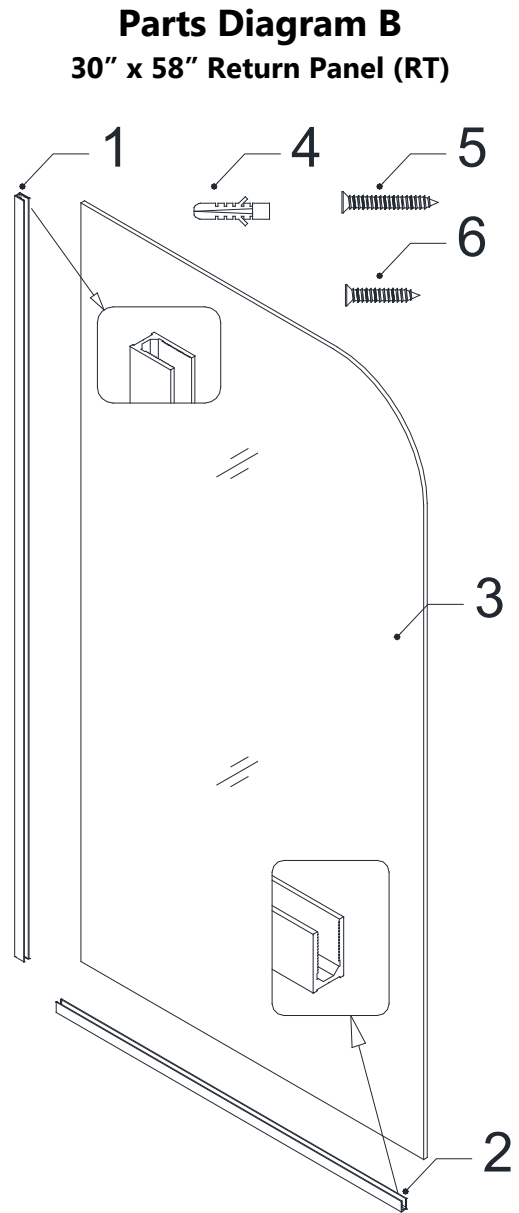
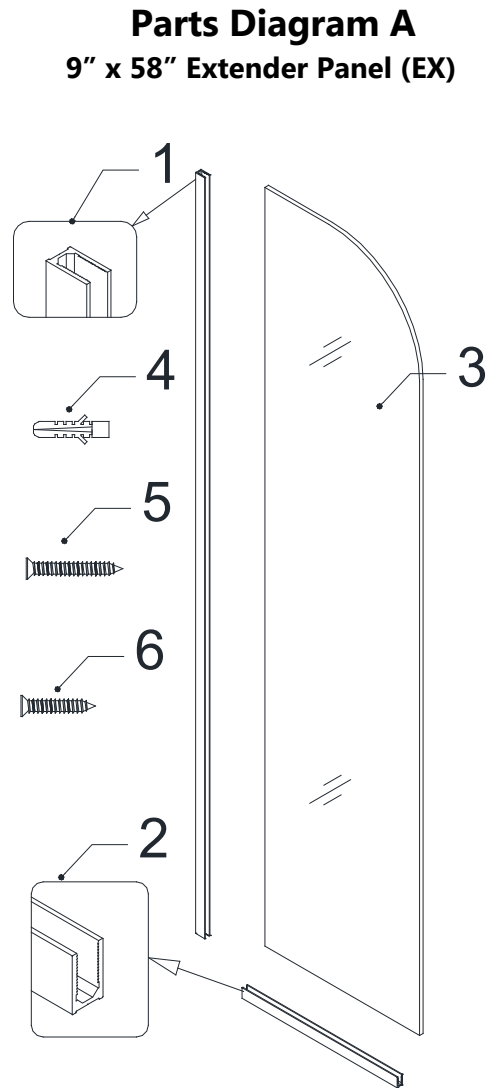

Packing List

Diagram A					
PART#	DESCRIPTION	QTY	PART#	DESCRIPTION	QTY
01	U-Channel 1 (58" wall profile)	1pc	04	Ø5/16" Wall anchor	4pcs
02	U-Channel 2 (9" bottom profile)	1pc	05	Countersunk screw ST4.2x40	4pcs
03	Extender panel glass	1pc	06	Countersunk screw ST4.2x25	2pcs
Diagram B					
01	U-Channel 1 (58" wall profile)	1pc	04	Ø5/16" Wall anchor	4pcs
02	U-Channel 2 (30" bottom profile)	1pc	05	Countersunk screw ST4.2x40	4pcs
03	Return panel glass	1pc	06	Countersunk screw ST4.2x25	2pcs

Installation steps

9" In-Line Extender Panel Installation (EX)

NOTE: The following panel installation instructions apply to all of the Aqua series tub doors. Please install whichever Aqua model tub door you purchased prior to proceeding with the following Stationary Glass installation instructions. Please see the Shower / Tub Door Installation manual included in the door packaging for complete tub door installation instructions.

NOTE: Use **Parts Diagram "A"** for the **EX panel** assembly and installation. (Fig 1)

Note: The **bottom u-channel (#02)** should measure: **Glass width (+) 3/16"**
the **vertical u-channel (#01)** should measure: **Glass height (-) 5/8"**

1. Slip the **U-Channel 2 (bottom profile) (#02)** and **U-Channel 1 (wall profile) (#01)** onto the **Extender Panel Glass (#03)**. With the door open, place the **Extender Panel Glass (#03)** and **U-Channel** onto the tub surface ensuring that the **U-Channel 1 (wall profile) (#01)** is flush with the wall. (Fig 2.1 and 2.1)

Close the Door Glass and align the **Extender Panel Glass (#03)** (Fig 2.3) Ensure that the **Extender Panel Glass (#03)** is precisely in line with the Door Glass and level it vertically (plumb). (Fig 2.5) Mark the position of both **U-Channels** along the inside edge on the wall and tub surface (Fig 2.6).

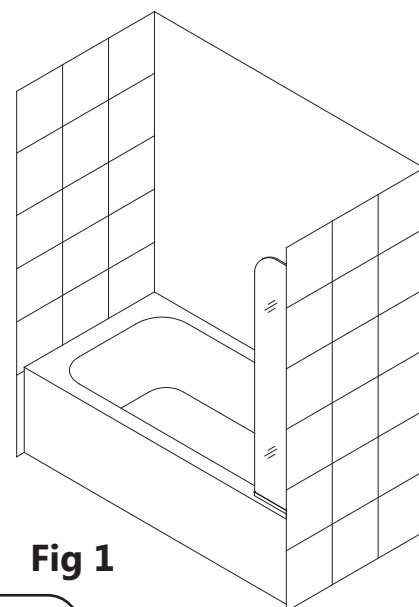

Fig 1

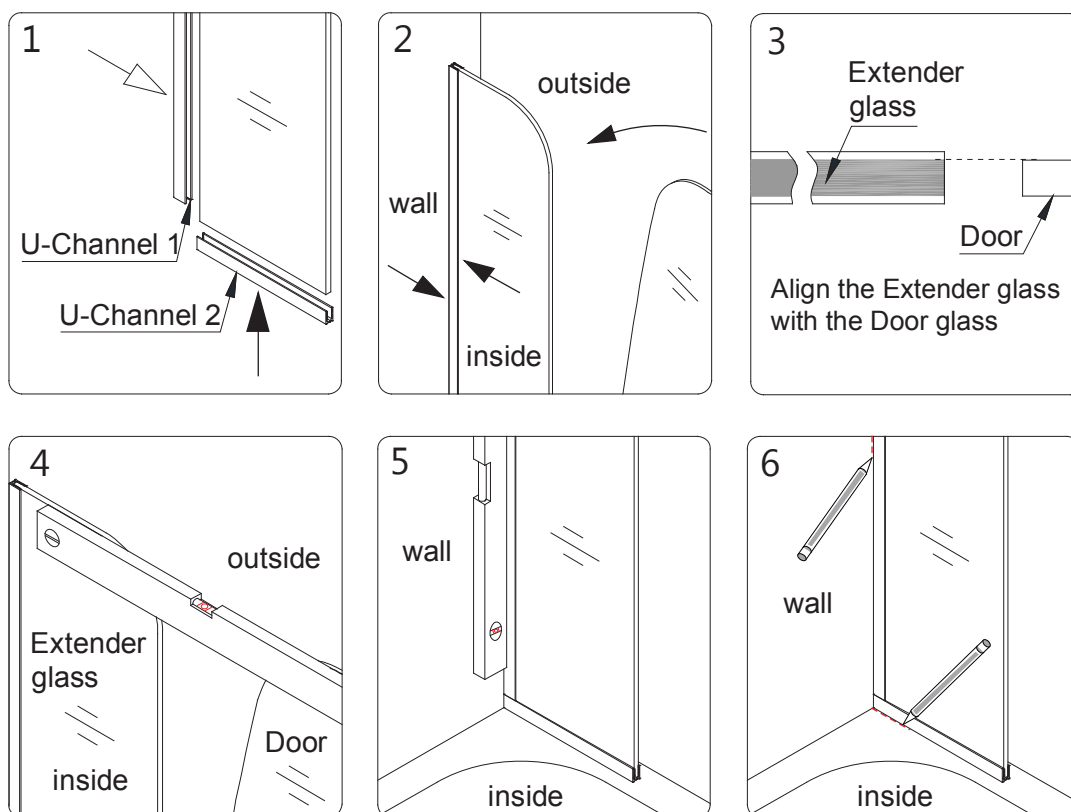

Fig 2

2. Remove the U-Channel 1 (wall profile) (#01) and U-Channel 2 (bottom profile) (#02) from the Extender Panel Glass (#03) and carefully set the Extender Panel Glass (#03) aside.

Place the **U-Channel 2 (bottom profile) (#02)** back onto the tub surface in line with the inside U-Channel mark. Mark the drill holes on the tub surface through the pre-drilled holes in the **U-Channel 2 (bottom profile) (#02)** and drill the holes using an **Ø1/8"** drill bit.

Apply waterproof silicone along the bottom surface and around the holes of the **U-Channel 2 (bottom profile) (#02)** and fasten it to the tub surface with the **Countersunk Screws ST4.2×25 (#06)**. (**Fig 3**)

NOTE: The surface needs to be clean and free of debris before applying silicone.

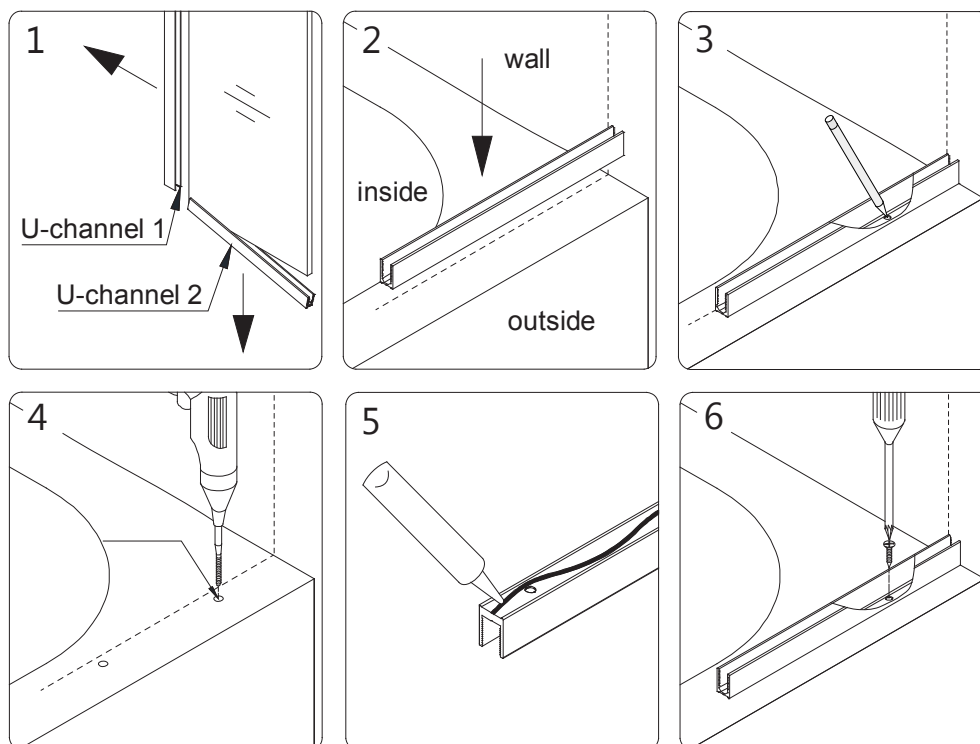

Fig 3

3. Place the U-Channel 1 (wall profile) (#01) onto the U-Channel 2 (bottom profile) (#02) and align it vertically with the inside U-channel wall mark from the previous step (Fig 4.1). Mark the drill holes on the wall through the predrilled holes in the U-Channel 1 (wall profile) (#01).

Now drill holes into the wall using a **Ø5/16"** drill bit and insert the **Ø5/16"** **Wall Anchors (#04)**. Apply waterproof silicone along the bottom surface and around the holes of the **U-Channel 1 (wall profile) (#01)** and fasten it to the wall with the **Countersunk Screws ST4.2×40 (#05)**. (**Fig 4**)

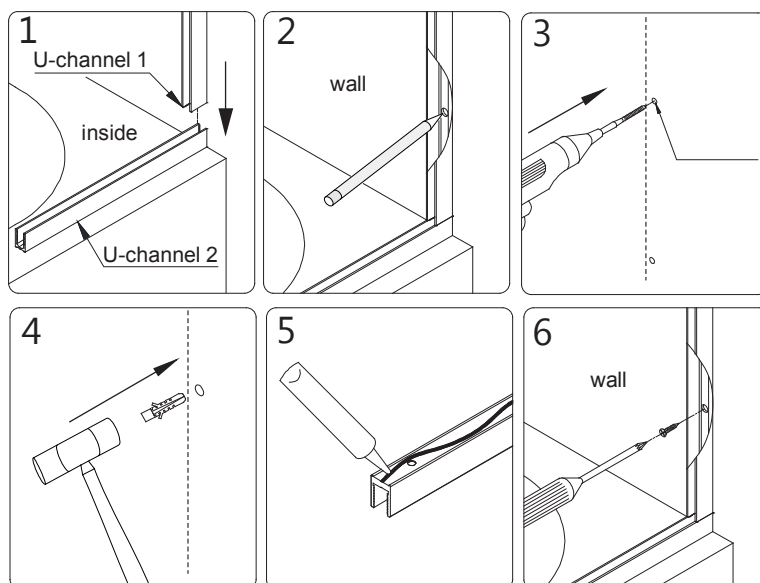

Fig 4

4. Apply waterproof silicone into both U-Channels. (Fig 5)

NOTE: The surface needs to be clean and free of debris before applying silicone.

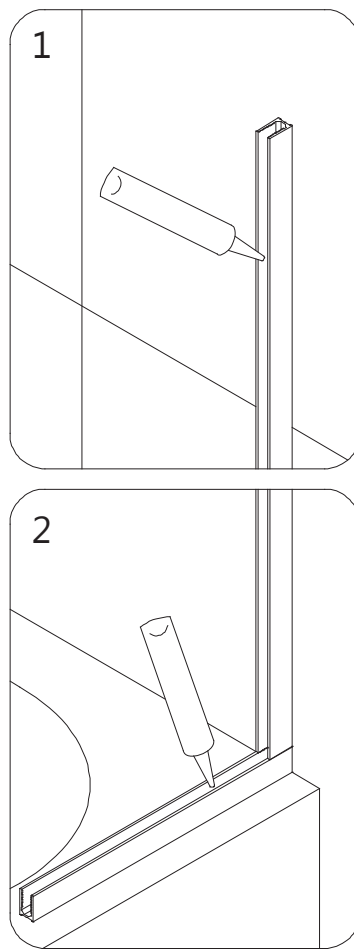

Fig 5

5. Slide the Extender Panel Glass (#03) into the installed U-Channels.

NOTE: If you have difficulty sliding the **Extender Panel Glass (#03)** into the U-Channels, you can use a small block of wood and a rubber mallet to lightly tap on the Extender glass until the glass is firmly set in the U-Channel. Apply a dab of silicone into both open ends of the U-Channels. **(Fig 6)**

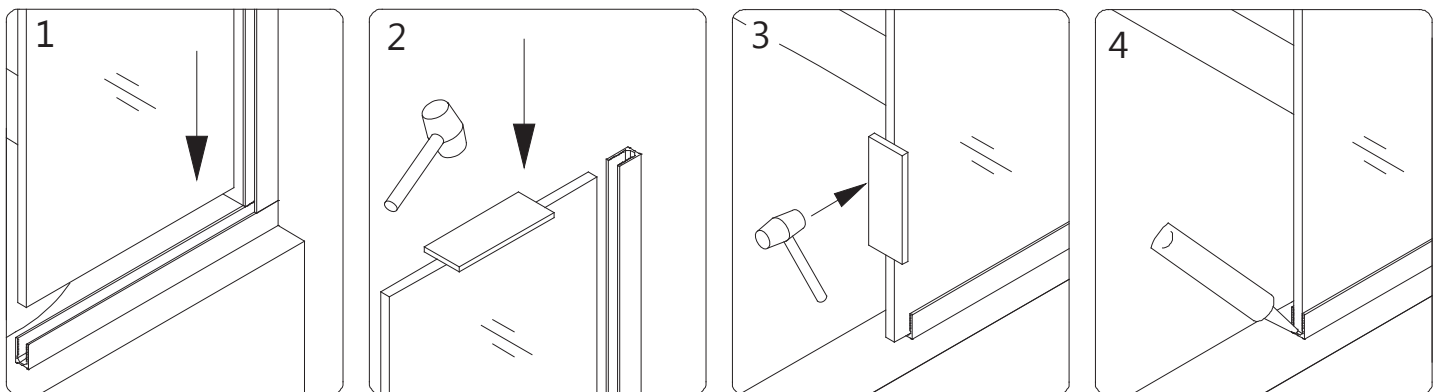

Fig 6

6. Apply a good quality mildew-resistant waterproof silicone along the connection of both U-Channels to the wall and tub surface from the inside of the shower. **(Fig 7)**



Allow 24 hours for the silicone to fully cure before using the shower.

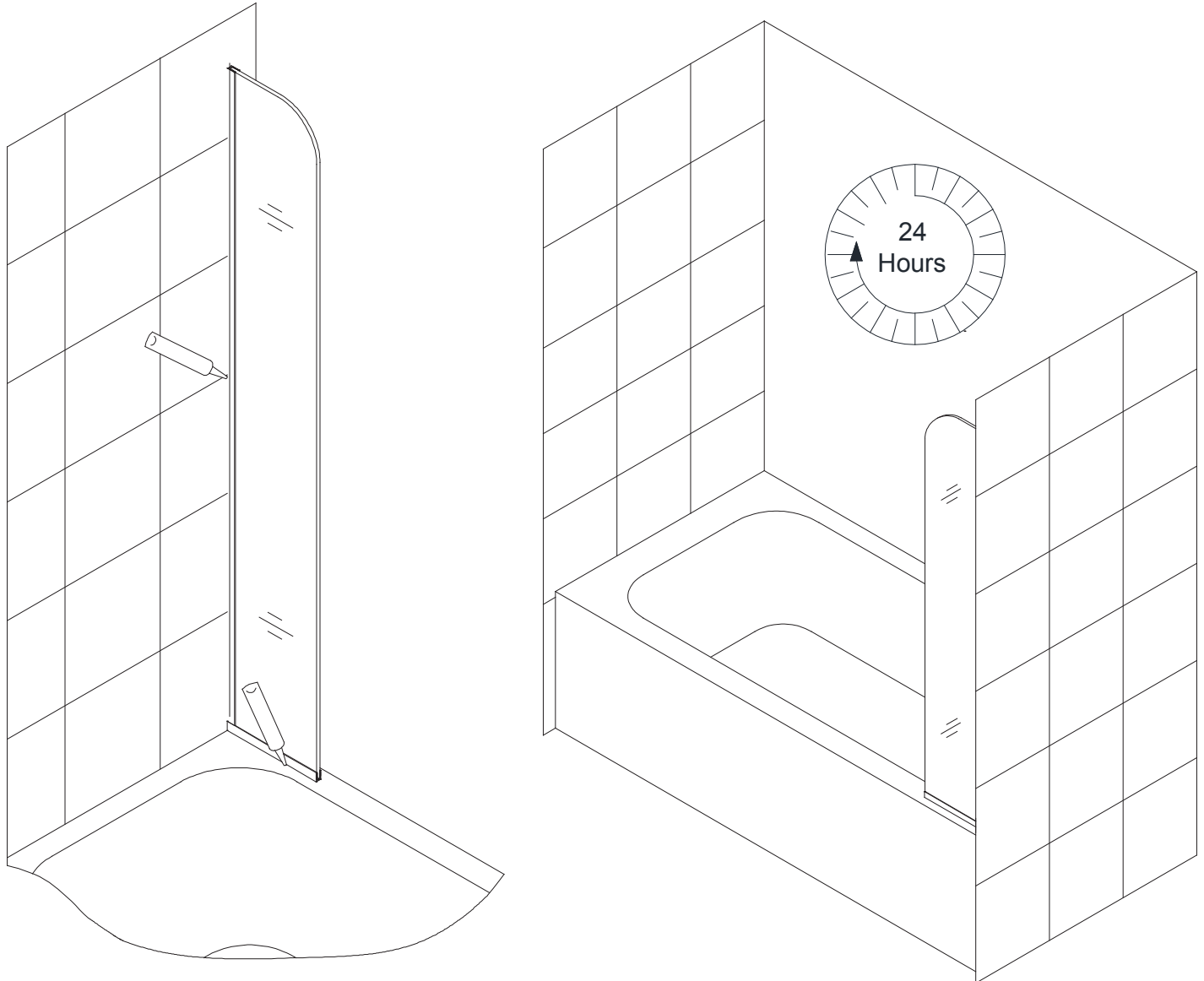

Fig 7

30" Return Panel Installation (RT)

NOTE: The following panel installation instructions apply to all of the Aqua series tub doors. Please install whichever Aqua model you purchased prior to proceeding with the following Return Glass installation instructions. Please see the Shower / Tub Door Installation manual included in the door packaging for complete tub door installation instructions.

NOTE: Use **Parts Diagram "B"** for the **RT panel** assembly and installation (**Fig 8**)

Note: The **bottom u-channel (#02)** should measure: **Glass width (+) 3/16"**
the **vertical u-channel (#01)** should measure: **Glass height (-) 5/8"**

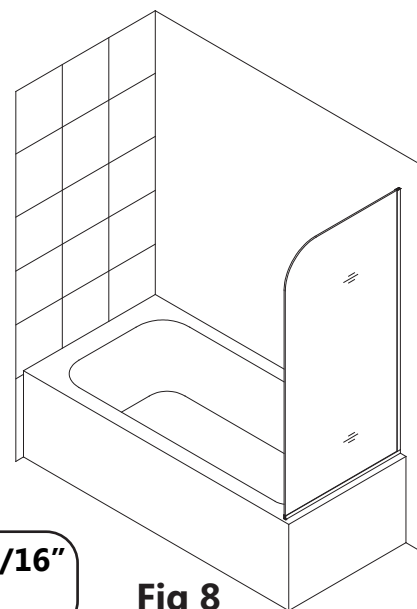

Fig 8

7. Slip the **U-Channel 2 (bottom profile) (#02)** and **U-Channel 1 (wall profile) (#01)** onto the **Return Panel Glass (#03)**.

With the door open, place the **Return Panel Glass (#03)** onto the middle of the tub ledge adjacent to the door ensuring that the **U-Channel 1 (wall profile) (#01)** is flush with the wall. Adjust the **Return Panel Glass (#03)** vertically using a level.

Mark the position of both **U-Channels** along the inside edge on the wall and tub surface. (**Fig 9.4**)

Remove the **U-Channel 1 (wall profile) (#01)** and **U-Channel 2 (bottom profile) (#02)** from the **Return Panel Glass (#03)** and carefully set the **Return Panel Glass (#03)** aside. (**Fig 9**)

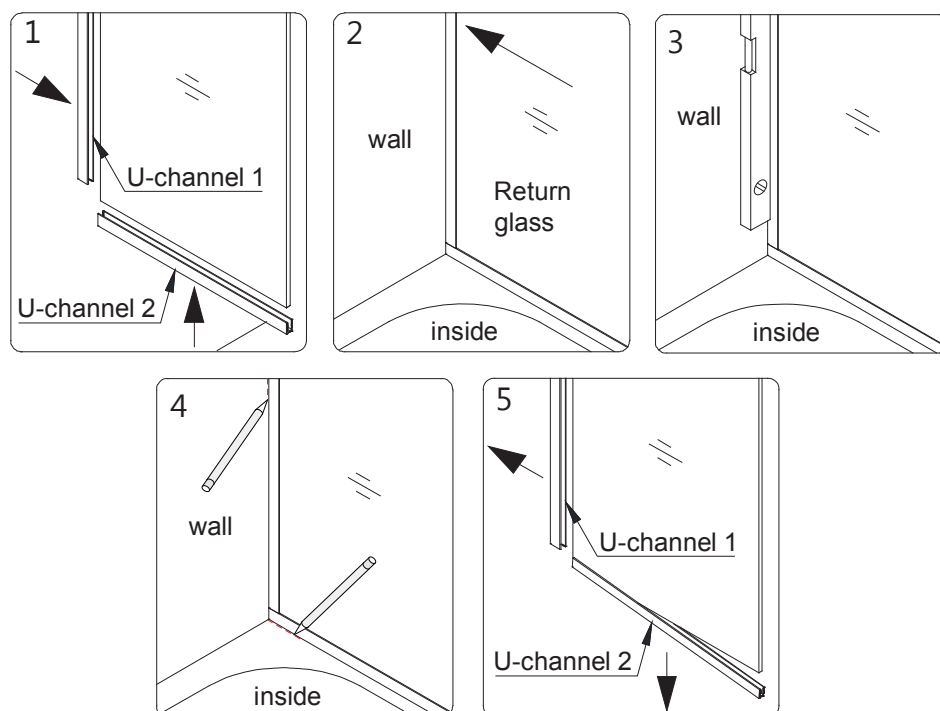

Fig 9

8. Place the **U-Channel 2 (bottom profile) (#02)** onto the tub surface in line with the inside **U-Channel** mark. Mark the drill holes onto the tub ledge through the predrilled holes in the **U-Channel 2 (bottom profile) (#02)** and drill the holes using a **Ø1/8"** drill bit.

Apply waterproof silicone along the bottom surface and around the holes of the **U-Channel 2 (bottom profile) (#02)** and fasten it to the tub ledge with the **Countersunk Screws ST4.2×25 (#06)**. (Fig 10)

NOTE: The surface needs to be clean and free of debris before applying silicone.

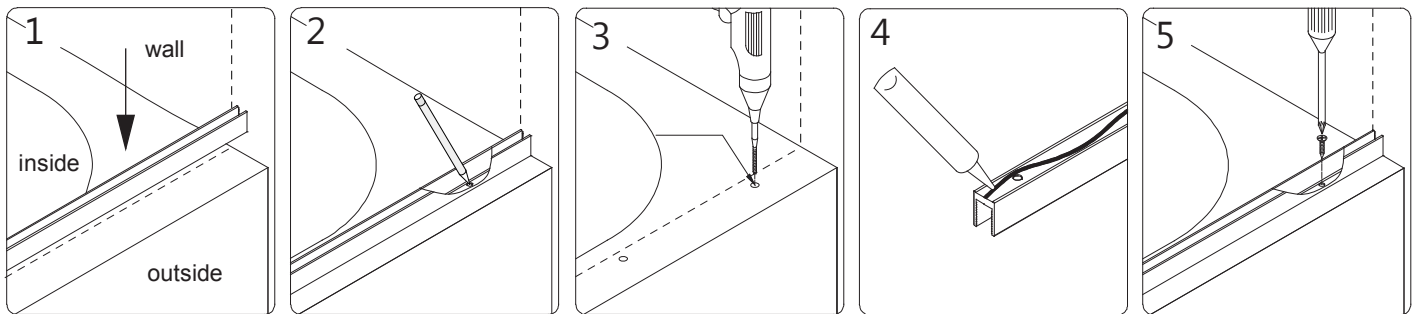

Fig 10

9. Place the **U-Channel 1 (wall profile) (#01)** onto the **U-Channel 2 (bottom profile) (#02)** and align vertically with the inside U-Channel wall mark from the previous step.

Mark the drill holes on the wall through the predrilled holes in the **U-Channel 1 (wall profile) (#01)**. Now drill holes in the wall using a **Ø5/16"** drill bit and insert the **Ø5/16"** Wall Anchors (#04). Apply waterproof silicone along the bottom surface and around the holes of the **U-Channel 1 (wall profile) (#01)** and fasten it to the wall with the **Countersunk Screws ST4.2×40 (#05)**. (Fig 11)

NOTE: The surface needs to be clean and free of debris before applying silicone.

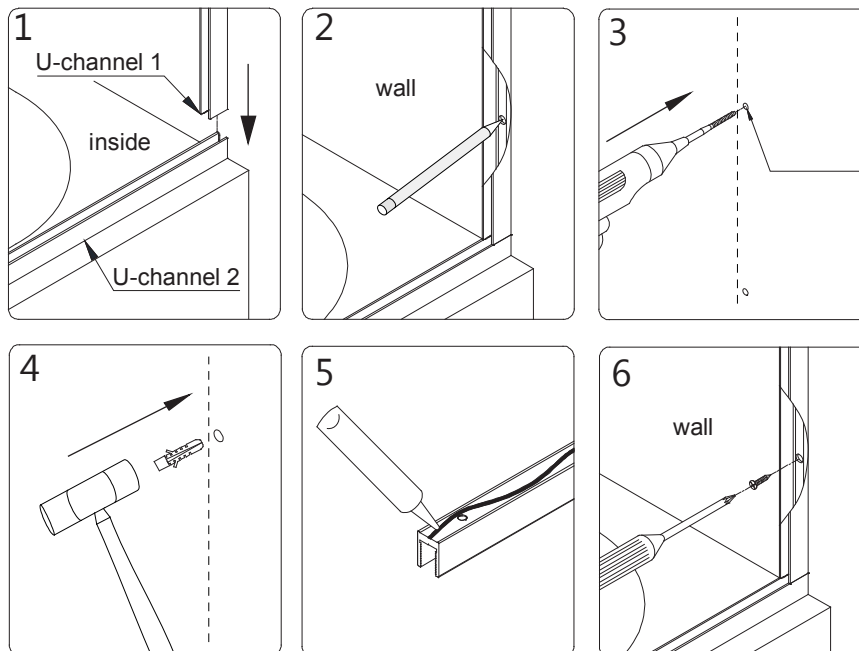

Fig 11

10. Apply waterproof silicone into both U-Channels. **(Fig 12)**

NOTE: The surface needs to be clean and free of debris before applying silicone.

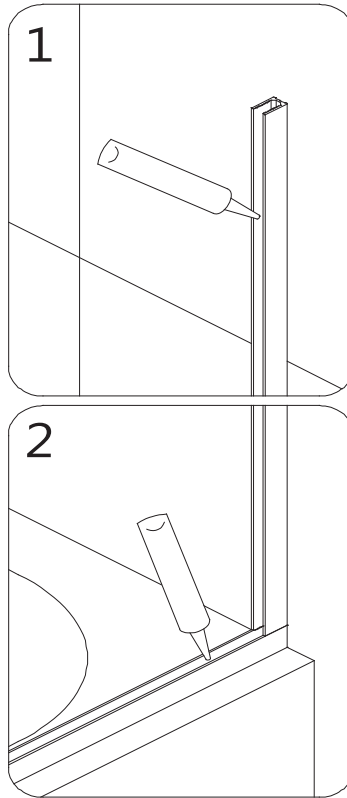

Fig 12

11. Slide the **Return Panel Glass (#17)** into the groove of the installed U-Channels.

NOTE: If you have difficulty sliding the **Return Panel Glass (#17)** into the U-Channels, you can use a small block of wood and a rubber mallet to lightly tap on the Extender glass until the glass is firmly set in the U-Channel.

Apply a dab of silicone to both open ends of the U-Channels. **(Fig 13)**

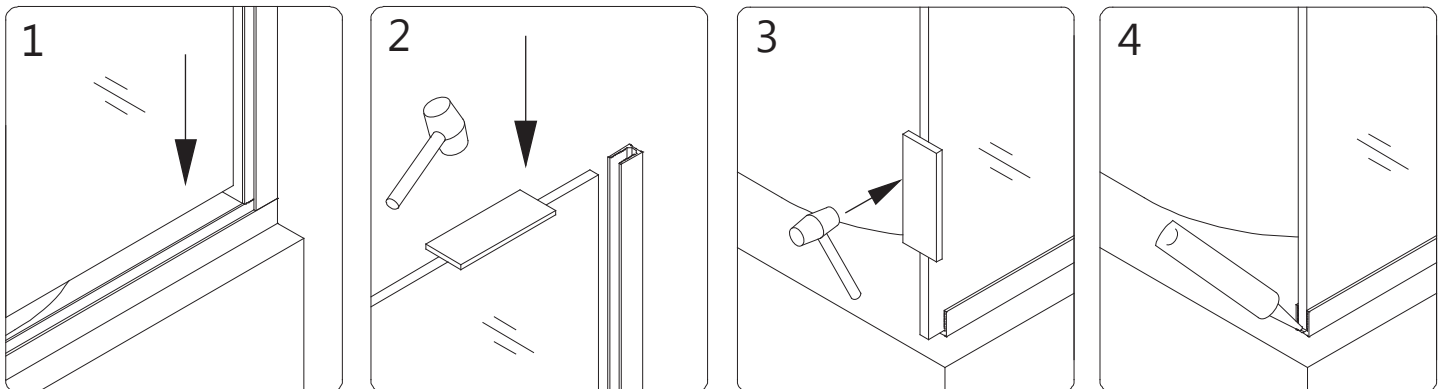

Fig 13

12. Apply a good quality mildew-resistant waterproof silicone along the connection of both U-Channels to the wall and tub surface from the inside of the shower. **(Fig 14)**



Allow 24 hours for the silicone to fully cure before using the shower.

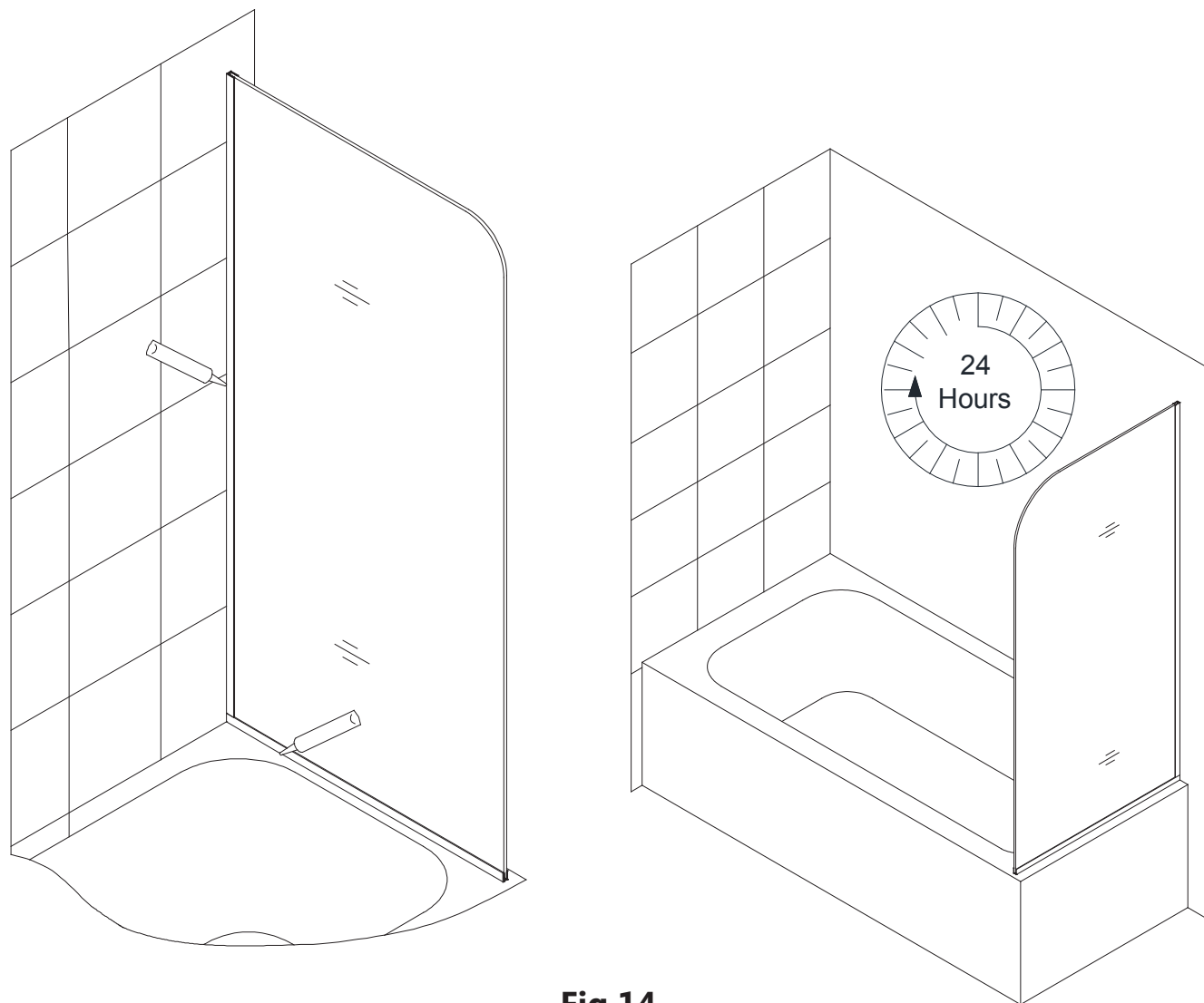

Fig 14

Product Maintenance

BASES and BACKWALLS: To ensure long lasting life for your acrylic back walls: wipe them off after each use with a soft cloth. To clean the acrylic back walls use non-abrasive sprays or cream based cleaners. Avoid the use of aerosol spray cleaners. Never use abrasive cleansers, metal brushes or scrapers that could scratch or dull the surface.

GLASS: To ensure long lasting life for your glass shower products: wipe them off after each use with a soft cloth. Rinse and wipe off the glass using either a soft cloth or a squeegee to prevent soap buildup and water spots (Hard water can etch the surface of the glass over time if left to dry). To prevent scratching the surface: never use abrasive cleaners or cleaning products that contain scouring agents. Never use bristle brushes or abrasive sponges that may scratch the surface.

HARDWARE: To ensure a long lasting finish: wipe off the metal parts after each use with a soft cloth. Do not use abrasive cleaners or cleaning products containing ammonia, bleach or acid. If accidentally used, rinse the surface as soon as possible to prevent damage to the finish (peeling or corrosion). After cleaning the polished finishes, rinse thoroughly and wipe dry with a soft cloth. Clean stainless steel surfaces at least once a week. When applying stainless steel cleaner or polish to stainless steel hardware, work with (not across) the grain. Never use an abrasive sponge or cloth, steel wool or wired brush as these may permanently scratch the surfaces.

NOTE: To maximize the life of your product, it is important to regularly inspect the glass and other hardware for misalignment, proper attachment, and/or damage. Contact DreamLine® with any questions or concerns.



TEL: 866-731-2244
FAX: 866-857-3638
DREAMLINE.COM

For more information on DreamLine® Shower Doors and Enclosures please visit DreamLine.com