

**TROUBLESHOOTING**

If you've followed the instruction carefully and your faucet still does not work properly, take these corrective steps :

Problem	Cause	Action
Leaks underneath handle.	Valve has loosened.	Tighten the valve.
Aerator leaks or has an inconsistent water flow pattern.	Aerator is dirty, worn out or misfitted.	Unscrew the aerator to clean or replace washer, or replace the aerator.
Water will not shut off completely.	Dirty or worn out washer in valve.	Remove handle and valve to check if the washer is damaged permanently or dirty. Re-install valve.



**Two Handle Kitchen Faucet  
With Spray**

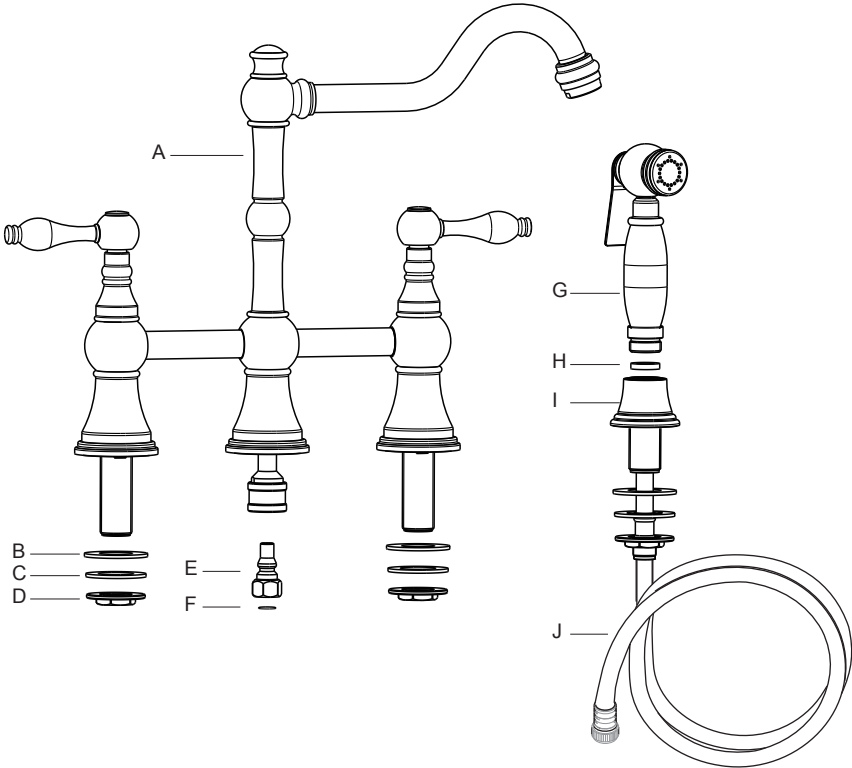

**PACKAGE CONTENTS**

PART	DESCRIPTION	QTY.	PART	DESCRIPTION	QTY.
A	Faucet	1	F	Washer	1
B	Washer	3	G	Spray head	1
C	Metal washer	3	H	Washer	1
D	Mounting nut	3	I	Spray seat	1
E	Joint	1	J	Spray hose	1

Questions, problems, missing parts?  
call Akicon Customer Service 8 a.m.-6p.m. EST, Monday-Friday  
Phone: +1(302)213 4406, Email: [service@akiconshop.com](mailto:service@akiconshop.com)  
[AKICONSHOP.COM](http://AKICONSHOP.COM)

## CAUTION

- Always turn off water and relieve pressure before working on your faucet.

## PREPARATION

Clean the dirt from valve outlets. Turn off the water supply valves. This is usually found near the water meter. If you are replacing an existing faucet, remove the faucet from the sink, and clean the sink surface thoroughly.

Estimated Assembly Time: 20 minutes

Helpful Tools: (not included)

- PTFE plumber's tape or thread sealant
- Flathead screwdriver
- Phillips screwdriver
- Pliers
- Adjustable wrench
- Cloth

Your installation may require supply lines and/or shut-off valves, cone washers, friction rings, or other additional tools. Consult the store where your faucet was purchased for connections that may be required for your area.

## ASSEMBLY AND INSTALLATION INSTRUCTIONS

1. Install the faucet to the hole of sink, and from under the sink, place Washer and Metal washer and mounting nut onto threaded, then tighten mounting nut using adjustable wrench.

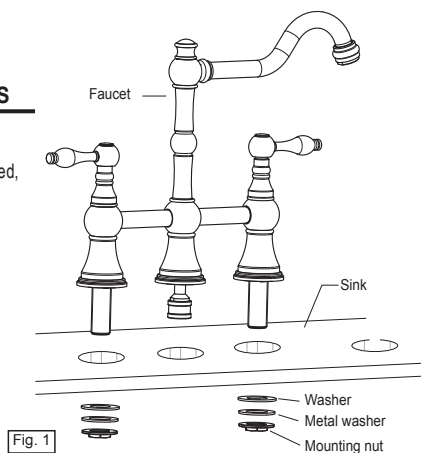

2. Insert spray seat through far right-hand hole on sink. Then tighten mounting nut using adjustable wrench. Insert spray hose down through spray seat, then Joint is installed in the end of the pipe, and tighten it using wrench, then as shown in the figure insert the connector from the body in the middle hole, and attention to whether to whether the installation in place.

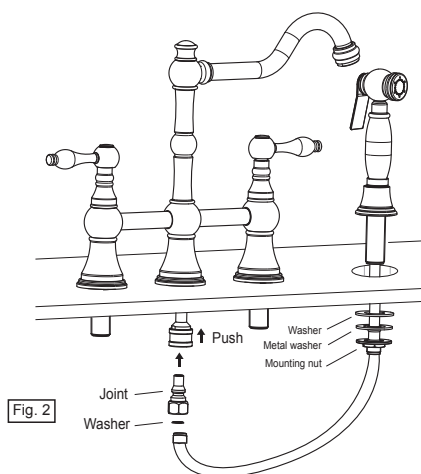

3. Connect spout hot water supply line to the left valve connector, connect Spout cold water supply line to the right valve connector, and connect hot and cold water supply lines to the water supply valves, then tighten Supply line nut.

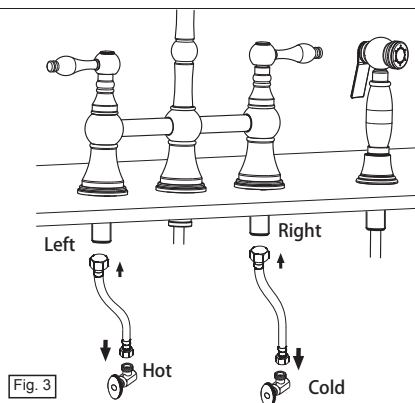

## MAINTENANCE AND CARE

To maintain the faucet, clean frequently and regularly.

Clean with clear water or mild liquid, rinse with clear water, and then dry with soft cotton cloth.

Do not use any abrasive cleansers, cloths, or paper towels.

Do not use any acid or abrasive detergent.

### 1. Faucet Start Up

After installation is complete, remove aerator and rotate handle to the closed position. Turn on the water supply valves, and check all connections for a leak. Turn on your faucet and allow both hot and cold water to run at least one minute each, then Install the Aerator.

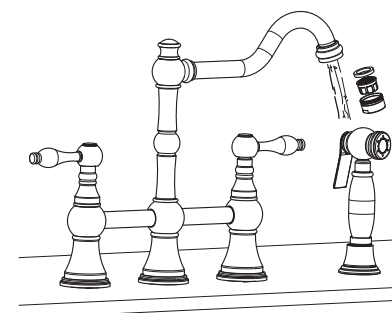

### 2. Handle and Valve Removal

Turn off water and relieve pressure before working on your faucet! Pull out the button at the top of the handle, screw the screws out with a cross screwdriver, pull out the handle and unscrew the cover, unscrew cartridge and inspect it, replace parts as necessary. Reassemble parts by reversing steps.

