

88 5180 691 Arts & Crafts Dining Buffet (Cottage Oak)

IMPORTANT NOTE

Carefully remove all the parts from the carton and put them individually on a soft cloth to prevent scratches or other damages occurring to the wood parts.

We have taken great care in the design of this product and request that you carefully and strictly follow our assembly instructions to ensure a completed product as it was designed.



Casual Attire For Today's Home

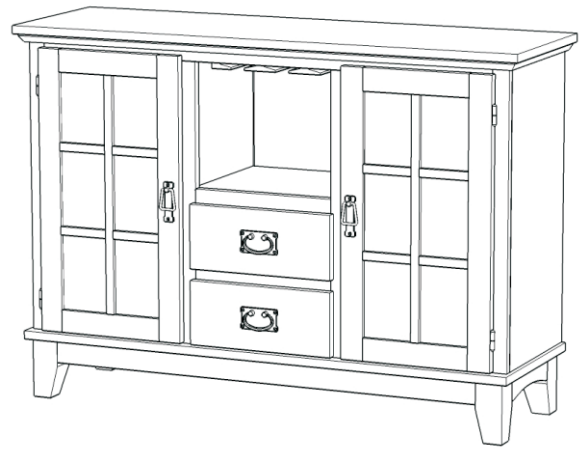

Buffet Unit Part List

A.
Top
1 pc.

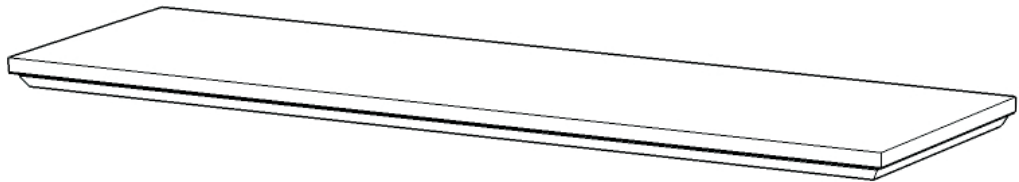

L.
Shelf
4 pcs.

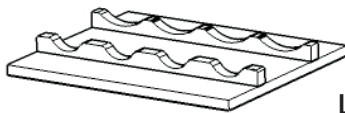

M.
Rack
1 pc.

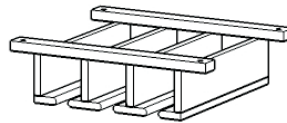

N.
Base
1 pc.

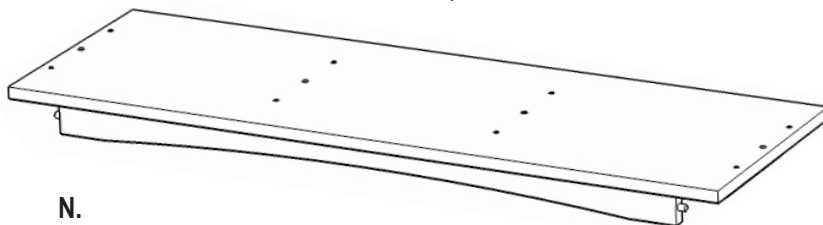

O.
Leg
2 pcs.

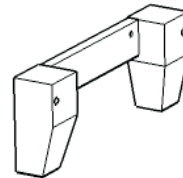

P.
Leg
1 pc.



Hardware List

**Small
Hex Wrench**
1 pc.



Hex Wrench
1 pc.



Cam Lock
8 pcs. (+1 extra)



Wood Screw
24 pcs. (+1 extra)



**Wood Screw
for Magnet**
8 pcs. (+1 extra)



Machine Screw
8 pcs.



**Door
Pull Handle**
2 pcs.



Head Cap Bolt
28 pcs. (+1 extra)



Cam Lock Screw
8 pcs. (+1 extra)



Wood Screw (long)
16 pcs. (+1 extra)



Magnet
4 pcs.



Adjustable Pin
16 pcs. (+2 extra)



**Drawer
Pull Handle**
2 pcs.



For assembly see instructions in carton 88 5180 692

Tools required for assembly : **Phillips** screwdriver

Home Styles Consumer Assistance Line 888-680-7460 and 877-831-0319
servicedesk@homestyles-furniture.com

88 5180 692 Arts & Crafts Dining Buffet (Cottage Oak)

IMPORTANT NOTE

Carefully remove all the parts from the carton and put them individually on a soft cloth to prevent scratches or other damages occurring to the wood parts.

We have taken great care in the design of this product and request that you carefully and strictly follow our assembly instructions to ensure a completed product as it was designed.



Casual Attire For Today's Home

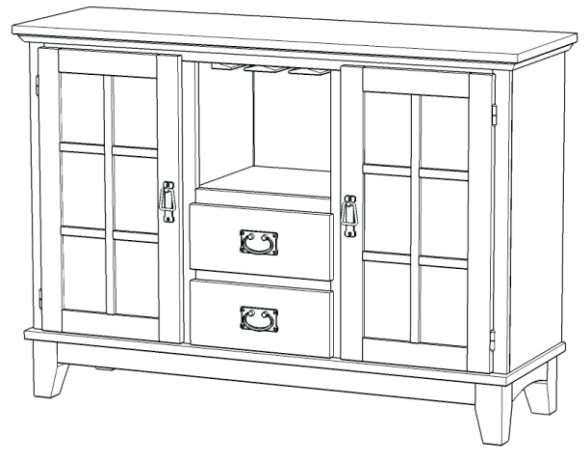

Part List (in this carton)

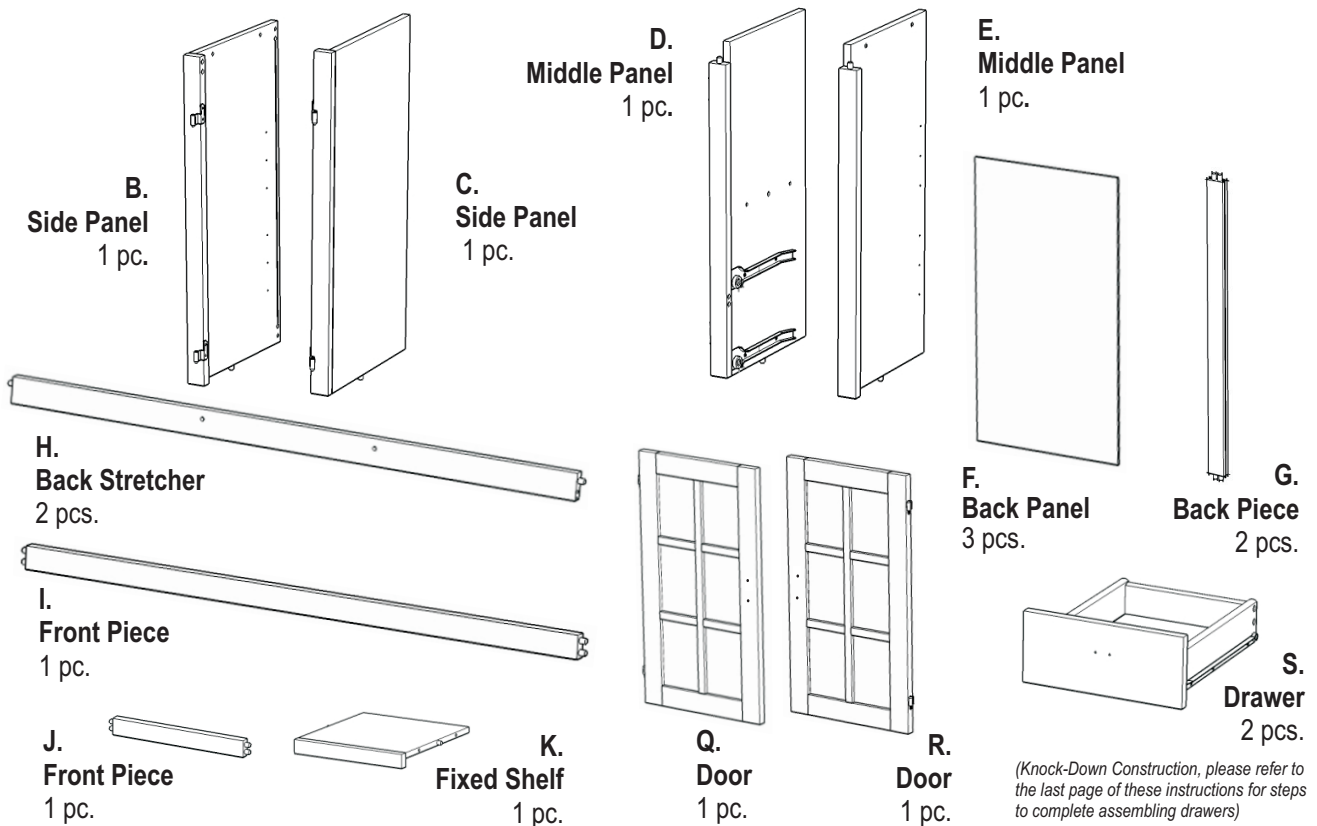

Also need the following from carton 88 5180 691 :

Part List in carton 88 5180 691

Top (A)	1 pc.
Shelf (L)	4 pcs.
Rack (M)	1 pc.
Base (N)	1 pc.
Leg (O)	2 pcs.
Leg (P)	1 pc.

Hardware List in carton 88 5180 691

Cam Lock Screw	9 pcs.
Cam Lock	9 pcs.
Magnet	4 pcs.
Wood Screw for Magnet	9 pcs.
Head Cap Bolt	29 pcs.
Adjustable Pin	18 pcs.
Wood Screw (long)	17 pcs.
Wood Screw	25 pcs.

Hardware List in carton 88 5180 691

Hex Wrench	1 pc.
Door Pull Handle	2 pcs.
Drawer Pull Handle	2 pcs.
Machine Screw	8 pcs.
Small Hex Wrench	1 pc.

Tools required for assembly : **Phillips** screwdriver

Home Styles Consumer Assistance Line 888-680-7460 and 877-831-0319
servicedesk@homestyles-furniture.com

Assembly Instructions 2/5

IMPORTANT

Do not tighten up all the screws until each part is properly assembled.

You should keep Hex Wrench in the safe place as you may need to tighten up the Head Cap Bolts in the future.

STEP 1

Put Cam Lock Screws into the pre-drilled holes of Side Panel (B),(C), Middle Panel (D),(E) and tighten.

Attach 2X Magnets to Middle Panel (D) and (E) by using Wood Screws in the pre-drilled holes (see Figure 1).

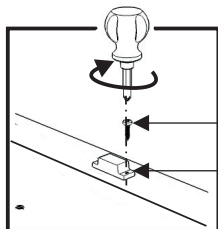

(Figure 1)

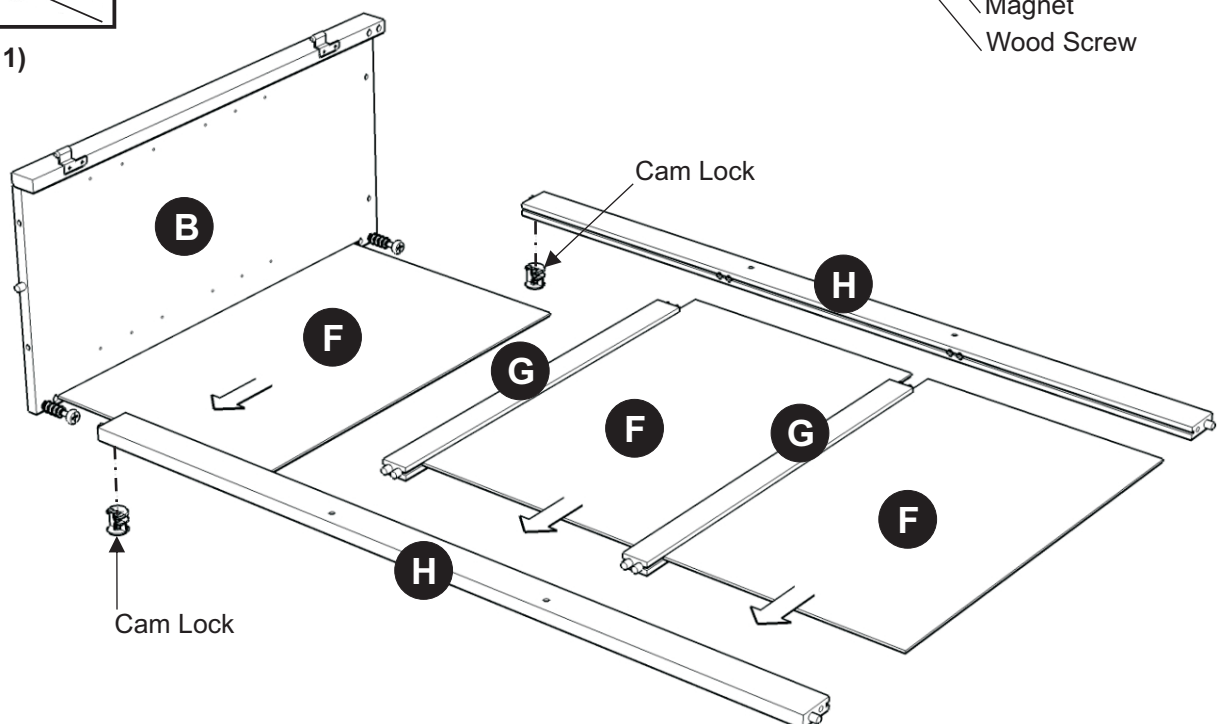
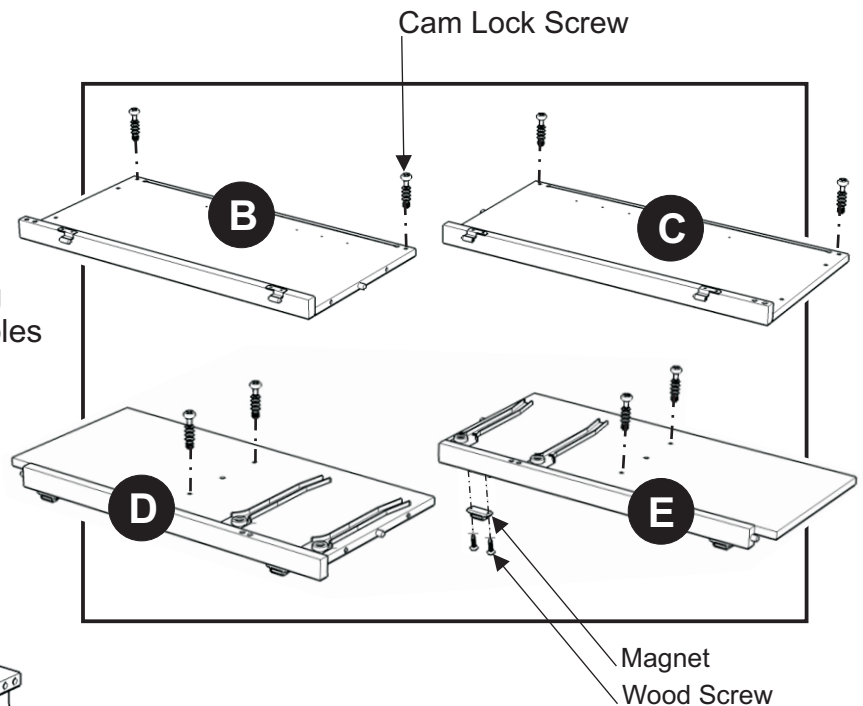

STEP 2

Attach Back Stretcher (H) to Side Panel (B) with Cam Lock.

Attach Back Piece (G) to Back Stretcher (H) then slide Back Panel (F) into place.

Attach second Back Stretcher (H) to the unit with Cam Locks.

STEP 3

Attach Middle Panel (D) to the unit with Head Cap Bolts.

Attach Fixed Shelf (K), Front Piece (J) and Middle Panel (E) to the unit, using Cam Locks and Head Cap Bolts.

Attach Front Piece (I) to the unit.

Attach Side Panel (C) to the unit with Cam Locks.

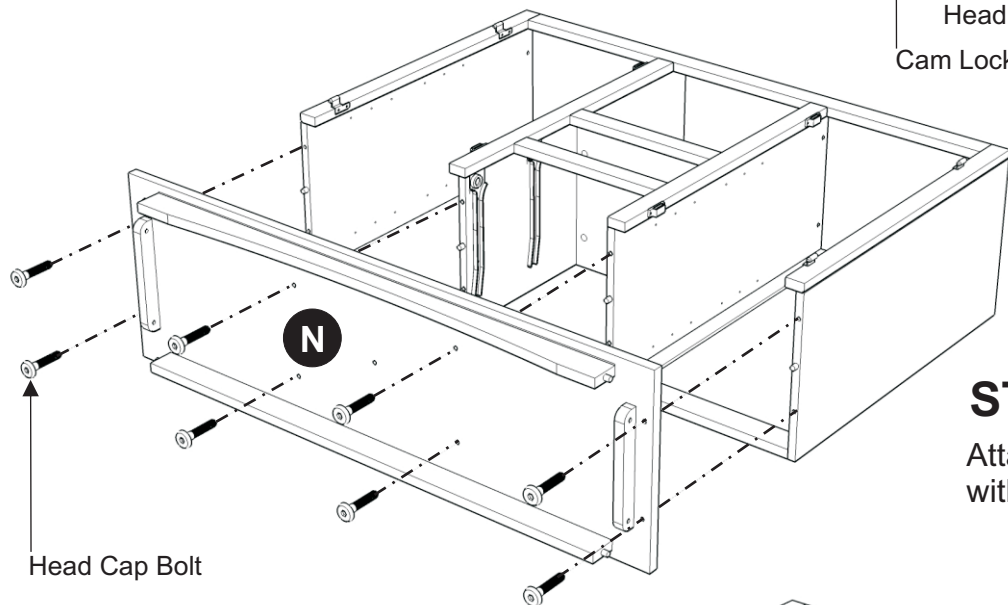
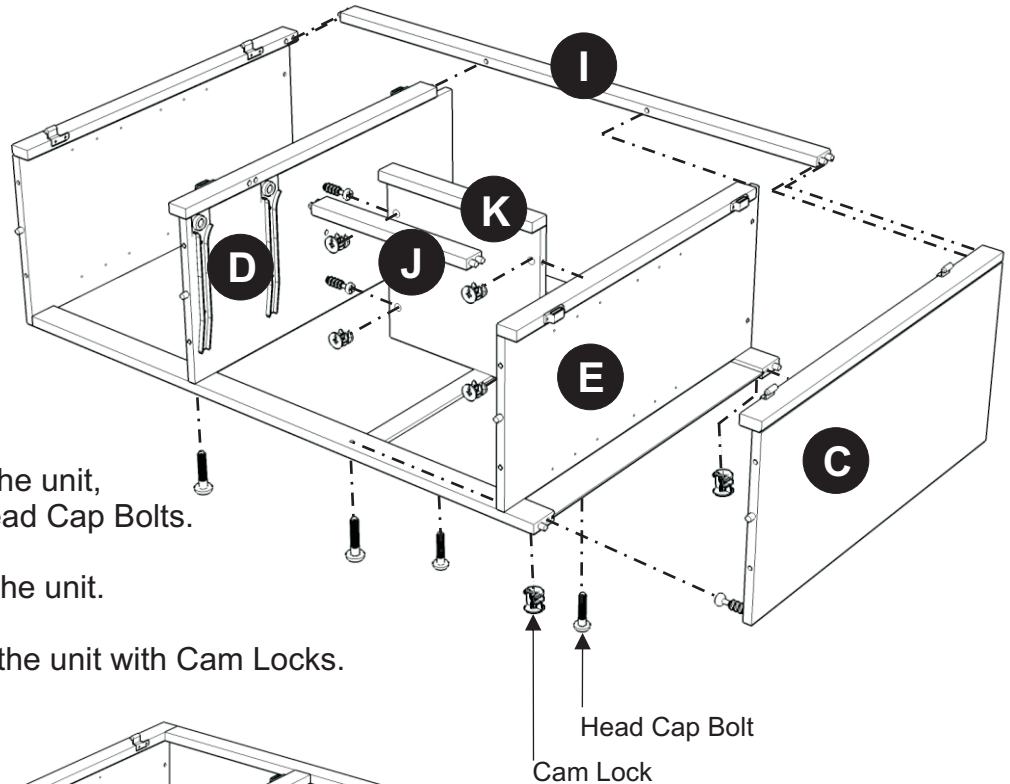

STEP 4

Attach Base (N) to the unit with Head Cap Bolts.

STEP 5

Attach Leg (O) to Base (N) with Head Cap Bolts.

Tighten up Leg (P) in the pre-drilled hole of unit as shown.

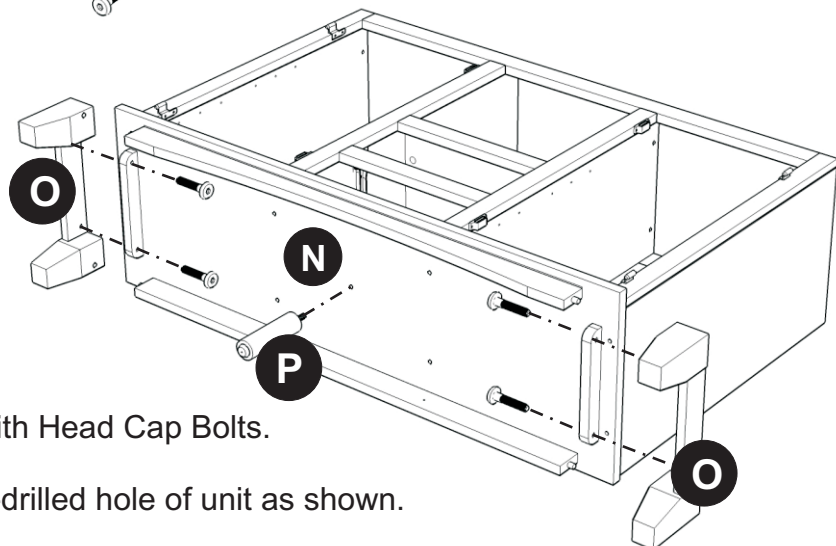

Assembly Instructions 4/5

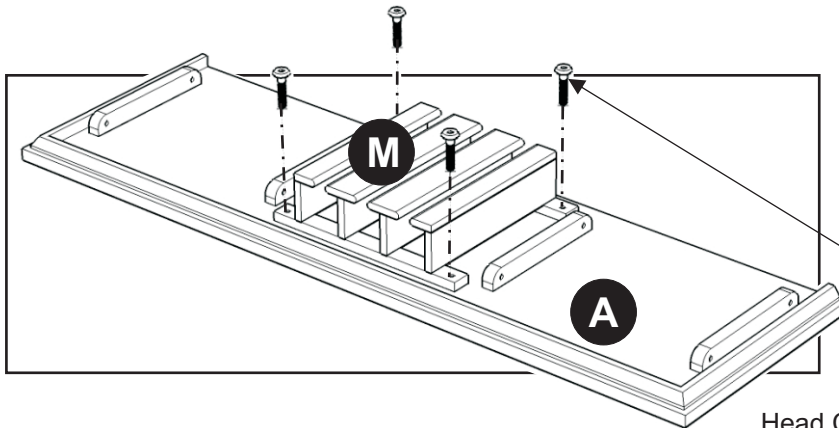

STEP 6

Attach Rack (M) to Top (A) with Head Cap Bolts..

Head Cap Bolt

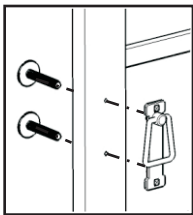

(Figure 2)

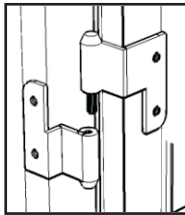

(Figure 3)

STEP 7

Turn the unit back to its upright position.

Place Top (A) onto the unit with Head Cap Bolts.

Slide Drawer (S) into place.

Insert Adjustable Pins into both side panels and middle panels at the desired level.
Slide Shelf (L) into place.

Assemble Pull Handles to Door (Q) and (R) with Machine Screws.(see Figure 2)

Attach Door (Q) and (R) to the side panels by sliding the door lift hinges into the side panel lift hinges. (see Figure 3)

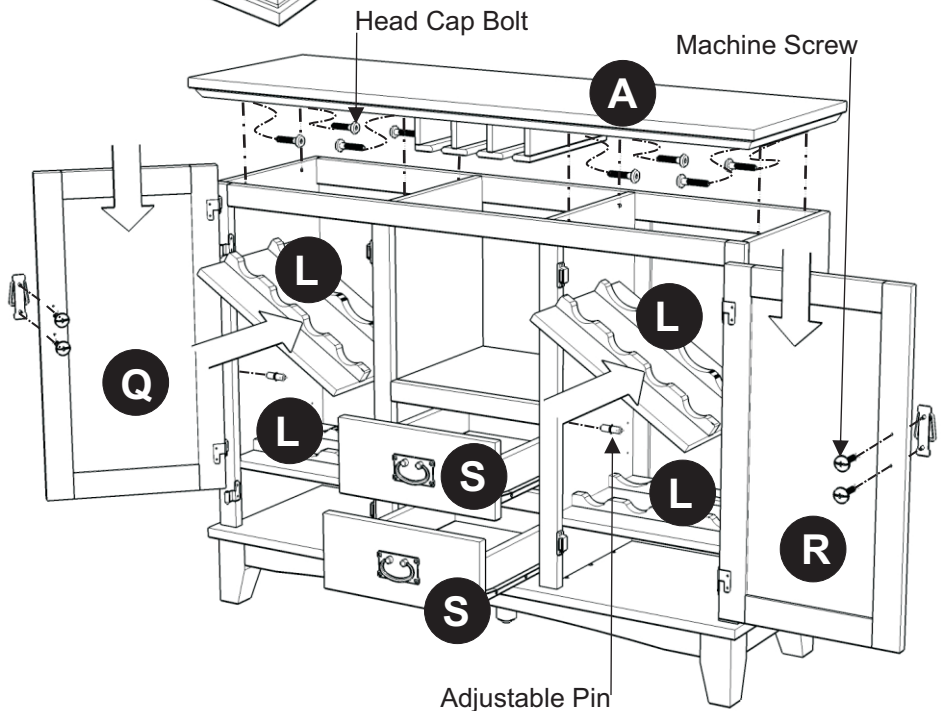

STEP 8

Insert Wood Screws from the back and tighten.

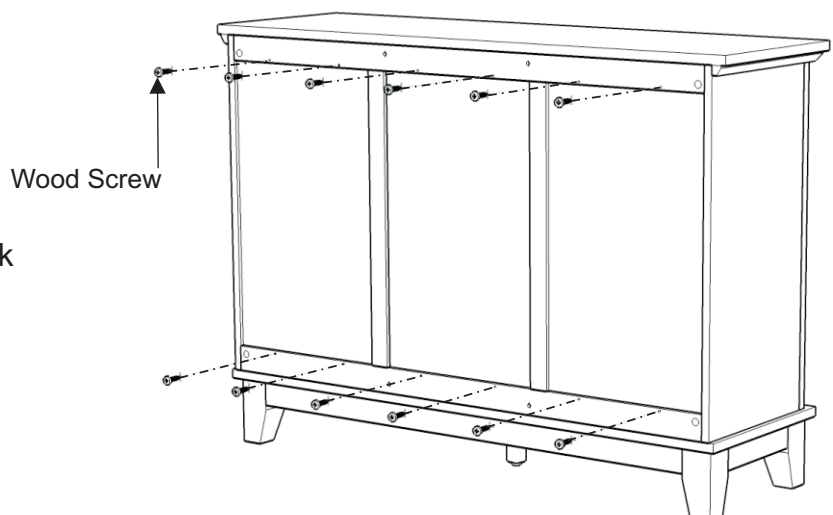

Drawer (S)

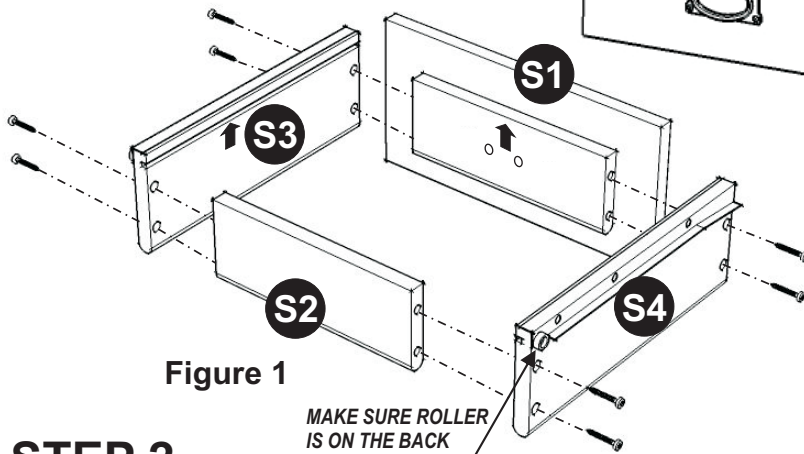

STEP 1

Attach S1 to S3 and S4, using a Phillips screwdriver and long wood screws (4X), tighten halfway.

Attach S2 to S3 and S4 using long wood screws (4X), tighten halfway. (see Figure 1)

STEP 2

Slide S5 into the grooves in S3 and S4. Be sure to push S5 all the way forward so it meets S1. (see Figure 2)

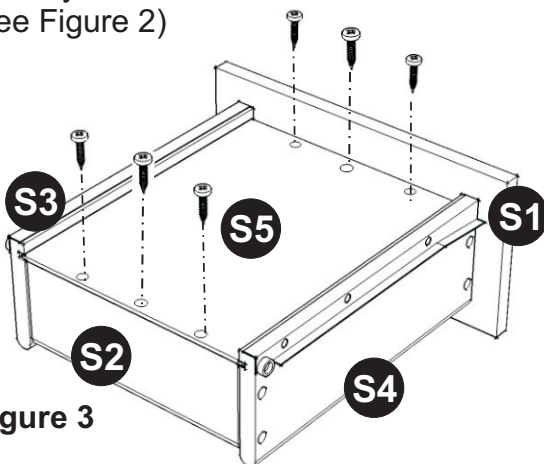
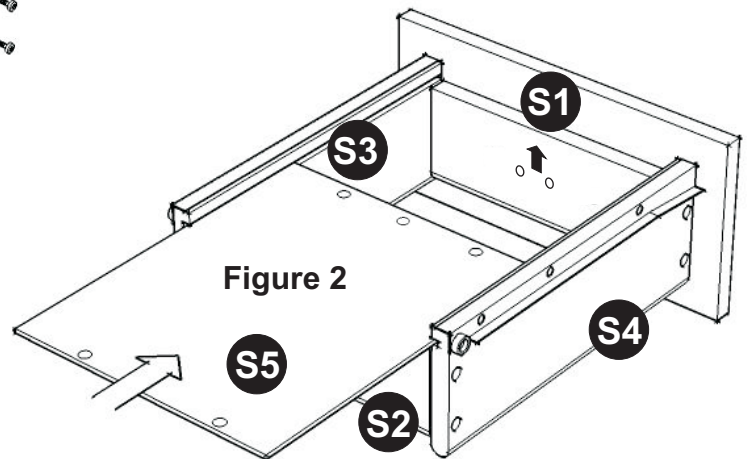

STEP 3

Insert short wood screws (6X) into the pre-drilled holes in S5, tighten screws. (see Figure 3)

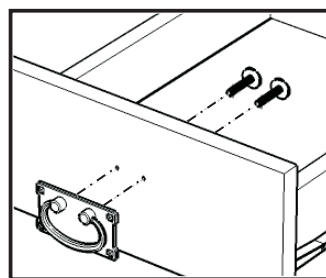

STEP 4

Attach hardware pulls with machine screws. (see Figure 4)

Tighten all screws used in drawer assembly.

Part List

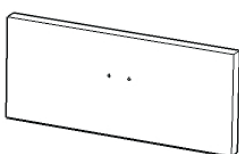

S1.
Front Part
2 pcs.

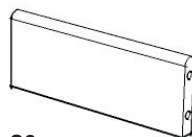

S2.
Back Part
2 pcs.

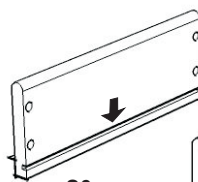

S3.
Side Part
2 pcs.

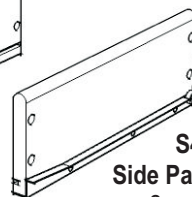

S4.
Side Part
2 pcs.

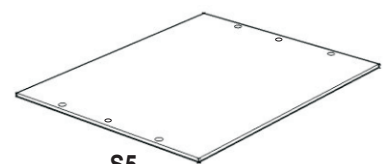

S5.
Base Part
2 pcs.