

DVE46BG6500V

7.5 cu. ft. AI Smart Dial Electric Dryer with Super Speed Dry and MultiControl™

SAMSUNG



Available Color

Brushed Black
DVE46BG6500V

- Features
- Super Speed Dry
 - AI Smart Dial
 - MultiControl™
 - Steam Sanitize+
 - ENERGY STAR® Certified
 - Flexible Installation
 - Wi-Fi Connectivity¹
 - Sensor Dry
 - Large 7.5 cu. ft. Capacity
 - Vent Sensor
 - Lint Filter Indicator
 - Premium Tempered Glass Door
 - Interior Drum Light
 - Reversible Dryer Door
 - ADA Compliant²
 - 19 Total Drying Cycles
 - 14 Options
 - 5 Temperature Settings
 - 9 Timed Dry Settings
 - 4-Way Venting

- Convenience
- Child Lock
 - Filter Check Indicator

Ratings

 ENERGY STAR® Rated:
608 kWh/yr

Electrical Requirements

240 V / 60 Hz

30 Amps

- Specifications
- 19 Total Drying Cycles:
- Steam Refresh, Wrinkle Away, Steam Sanitize+, Super Speed, Eco Normal, Normal, Heavy Duty, Towels, Permanent Press, Activewear, Bedding, Delicates, Wool, Shirts, Denim, Time Dry, Air Fluff, Small Load, Rack Dry
- 14 Options:
- Damp Alert, Wrinkle Prevent, AntiStatic, My Cycles, Smart Control, Eco Dry, Drum Light, Child Lock, Alarm, AI Pattern, Wi-Fi, Language, Vent Blockage Test, Factory Reset
- 5 Temperature Settings:
- High, Medium, Medium Low, Low, Extra Low

- 5 Dry Levels:
- Very Dry, More Dry, Normal Dry, Less Dry, Damp Dry
- Warranty
- One (1) Year Parts and Labor

Product Dimensions & Weight (WxHxD)

Dimensions: 27" x 38³/₄" x 31⁵/₁₆"

Weight: 119 lbs

Shipping Dimensions & Weight (WxHxD)

Dimensions: 29³/₈" x 42⁹/₁₆" x 33¹/₂"

Weight: 125.7 lbs

Electric Dryer	Model #	UPC Code
Brushed Black	DVE46BG6500V	887276660073
Gas Dryer		
Brushed Black	DVG46BG6500V	887276660172
Matching Washer		
Brushed Black	WF46BG6500AV	887276659794

Optional Accessories	Model #	UPC Code
Brushed Black Pedestal	WE402NV	887276310145
Brushed Black Riser	WE272NV	887276197630
MultiControl™ Kit and Stacking Kit	SKK-8MC	887276597959
Vent Kit	DV-2A	887276146416

¹Requires wireless network, Samsung account and Samsung SmartThings App. The Samsung SmartThings App supports Android OS 4.0 (ICS) or later which is optimized for Samsung smartphones (Galaxy S and Galaxy Note series). This app also supports iOS 7 or later for iPhone models. Samsung SmartThings App available in App Store and Play Store.

²ADA Compliant when using 27" wide riser. (Riser model codes: WE272NV, WE272NW, WE272NC)

DVE46BG6500V

7.5 cu. ft. AI Smart Dial Electric Dryer with Super Speed Dry and MultiControl™

SAMSUNG

Dimensions

Required dimensions for installation with pedestal:

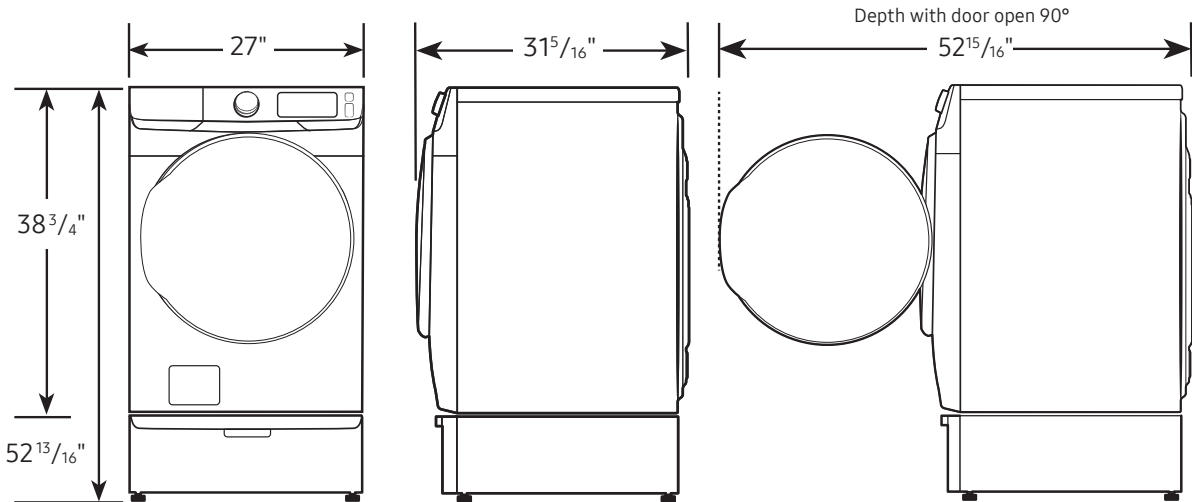

Installation Specifications – Side-by-Side

If the washer and dryer are installed together or the dryer alone, the closet front must have two unobstructed air openings for a combined minimum total area of 72-inch². Your washer alone does not require a specific air opening.

Alcove or closet installation

Minimum clearance for closet and alcove installations:

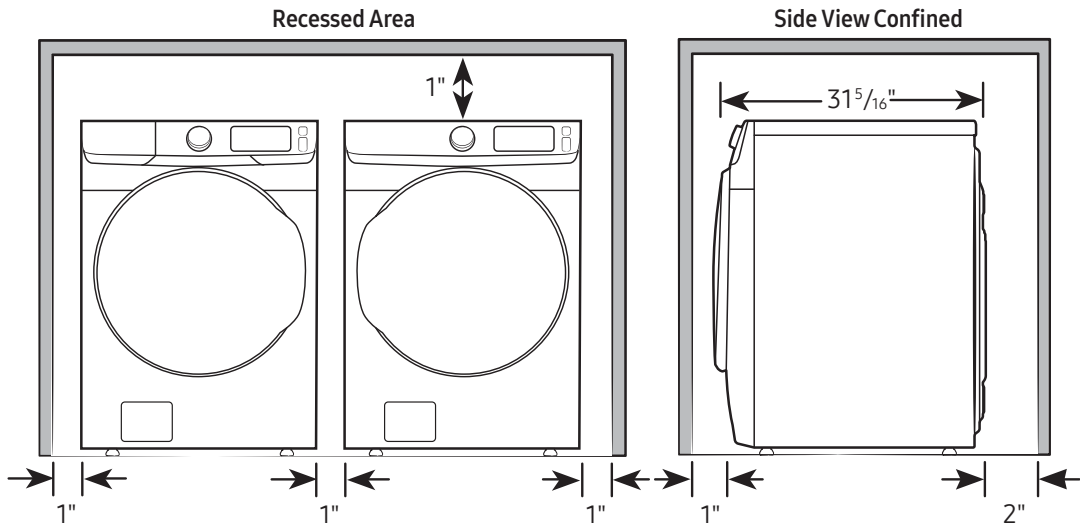

Connection Dimensions

Back and side view of dryer

LEGEND:

● Cold Water Connection

Actual color may vary. Design, specifications, and color availability are subject to change without notice. Non-metric weights and measurements are approximate.

©2022 Samsung Electronics America, Inc., 85 Challenger Road, Ridgefield Park, NJ 07660. Tel: 800-SAMSUNG. samsung.com. Samsung is a registered trademark of Samsung Electronics Co., Ltd.

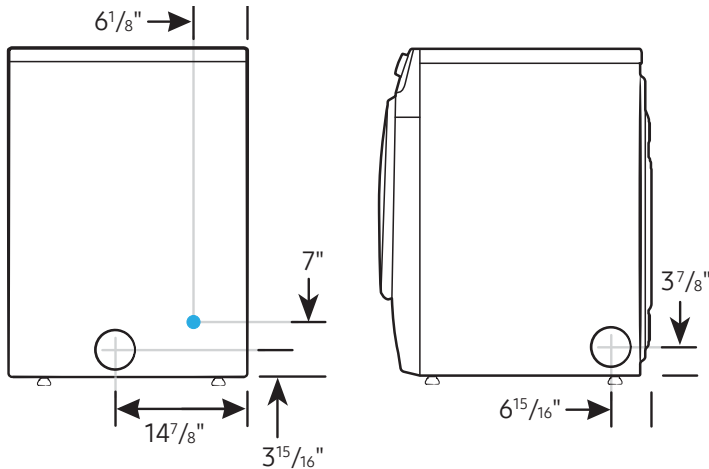

Installation Specifications – Stacked Pair

Clearances indicated are for stacked pairs. The closet front must have two unobstructed air openings for a combined minimum total area of 72-inch².

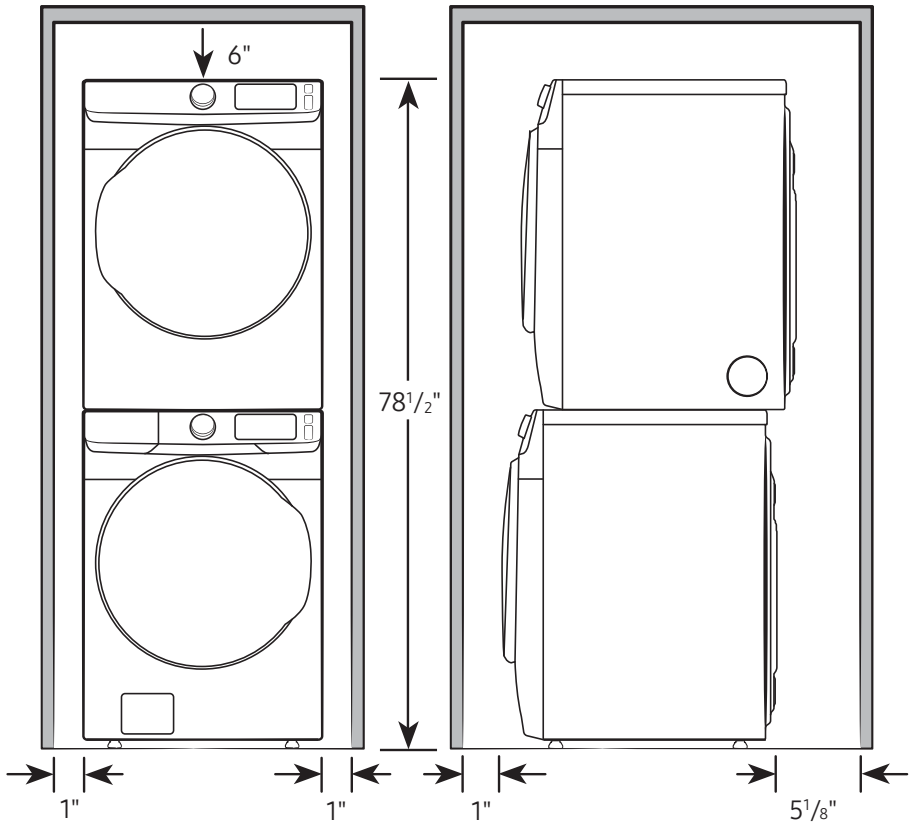

Connection Dimensions

Back and side views of stacked pair

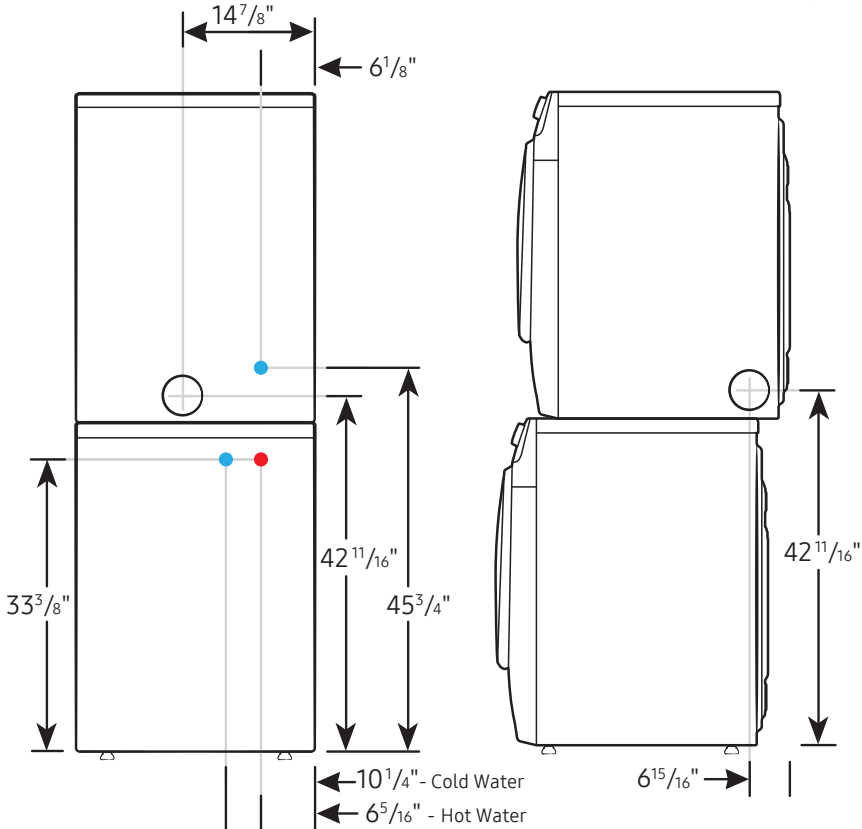

LEGEND:
● Cold Water Connection
● Hot Water Connection

Actual color may vary. Design, specifications, and color availability are subject to change without notice. Non-metric weights and measurements are approximate.

©2022 Samsung Electronics America, Inc., 85 Challenger Road, Ridgefield Park, NJ 07660. Tel: 800-SAMSUNG. samsung.com. Samsung is a registered trademark of Samsung Electronics Co., Ltd.