

QUICK START GUIDE

NV18SSG

**18 IN. SINGLE STAGE GAS
POWERED SNOW THROWER**

2025 V01



Jackson, Wisconsin
Website: www.novuspowerequipment.com
Email: Support@novuspowerequipment.com
Toll-Free Phone: 800-409-7802

2025 V01



PERFORMANCE
PRODUCTS

NV18SSG
18 IN. SINGLE STAGE GAS POWERED SNOW THROWER

UNPACKING

Carefully remove the Snow Thrower out of the carton/box and place the unit on the ground or other solid surface. Do not discard the packaging until you have confirmed the following items are present.

Ship Loose Items

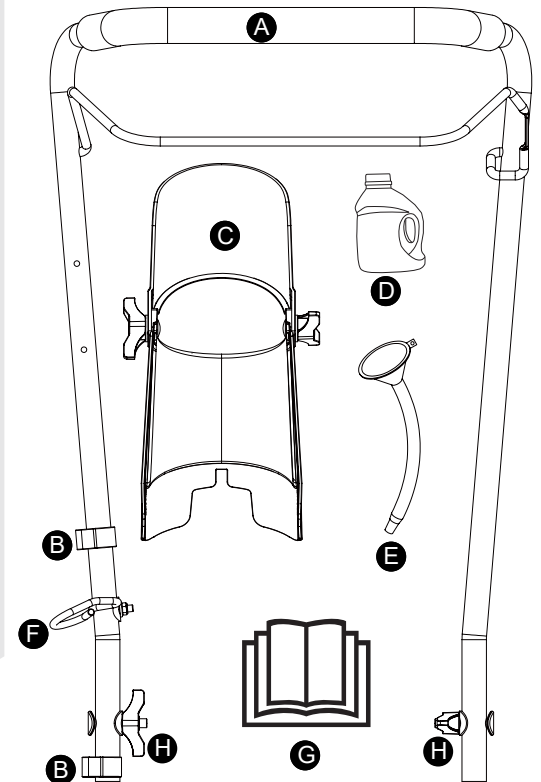

READ AND UNDERSTAND THE OPERATOR'S MANUAL AND ALL SAFETY WARNINGS BEFORE USE

FAILURE TO OPERATE THE PRODUCT CORRECTLY CAN RESULT IN DAMAGE TO THE PRODUCT, PERSONAL PROPERTY AND CAUSE SERIOUS INJURY OR DEATH.

Quick Start Guide Contents

- Unpacking / Package Contents
- Assembly Instructions
- Starting and Operating Procedures

If you require assistance during setup or operation of your new tiller, please contact our customer support team toll-free at (800) 409-7802 or email at support@novuspowerequipment.com

A) 1 X Upper Handle Assy	E) 1 X Oil funnel with Tube
B) 2 X Wire / Cable Retaining Clip	F) 1 X Starter Rope Guide
C) 1 X Discharge Chute Assy	G) 1 X Operators Manual
D) 5W-30 Engine Oil	H) 2 X Handle Hardware (Bolt, Washer, Wing Nut)

Assembly Hardware

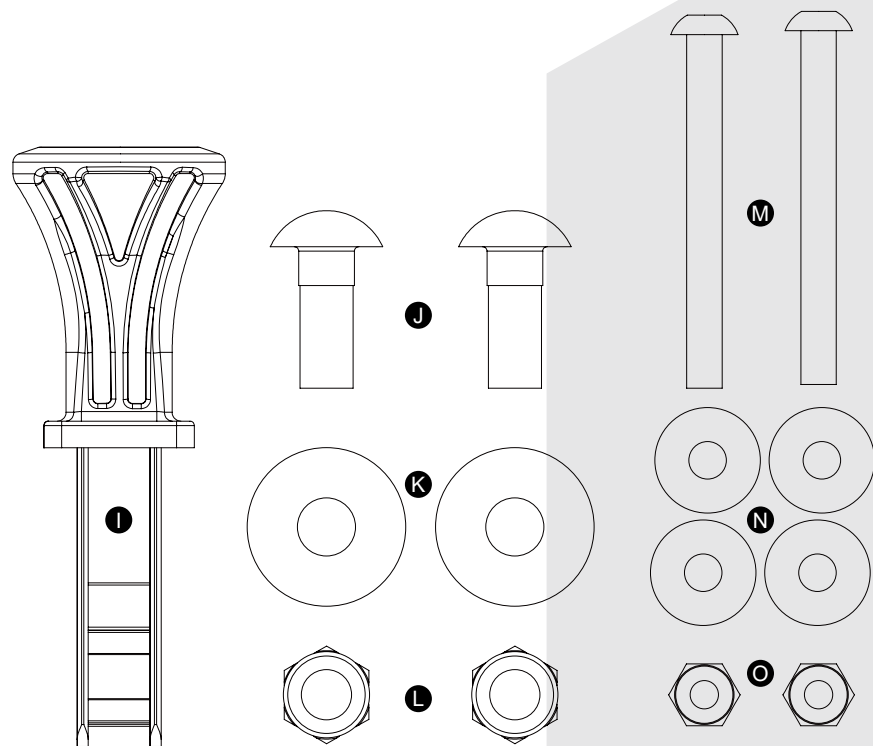

I) 1 X Ignition Key - Spare	M) 2 X M4 Phillips Head Bolt
J) 2 X M6 Carriage Bolt	N) 4 X M4 Flat Washer
K) 2 X M6 Flat Washer	O) 2 X M4 Lock Nut
L) 2 X M6 Lock Nut	

ASSEMBLY

1. Unwind the Auger Clutch Cable located on the left-hand side of the snow thrower. (Fig 1)

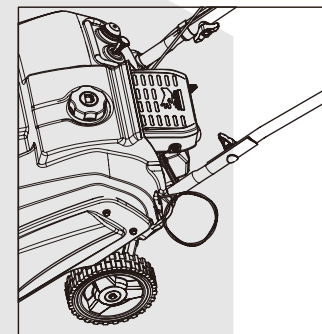

Fig 1

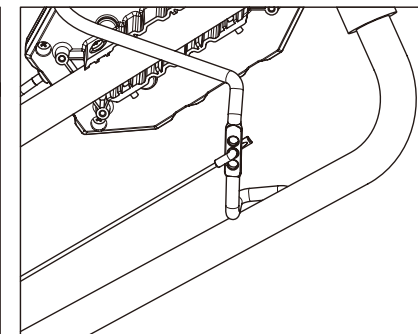

Fig 2

2. Route the z-bend of the cable through the center hole of the Auger Lever. (Fig 2)

3. Attach the Upper handle to Lower Handle using the square neck bolts (A), curved washer (B) and handle knob (C). (Fig 3)

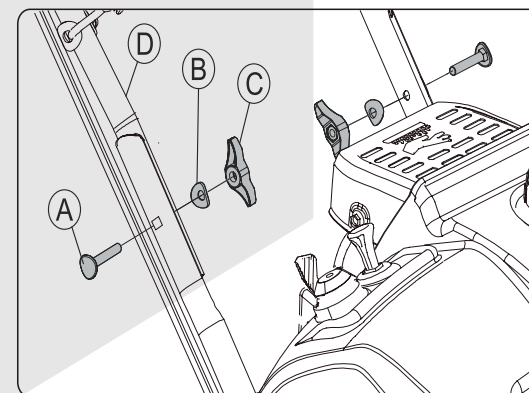

Fig 3

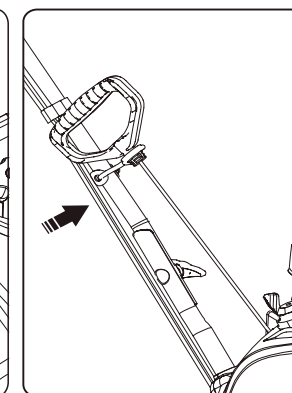

Fig 4

4. Place the recoil start handle into the ring. (Fig 4)

Installing the Discharge Chute and Chute Deflector

1. Place the Discharge Chute Assy (item A) onto the chute base. Note: Align the locating tab on the discharge chute base with the slot on the back of the discharge chute assy.

2. Install two M6 Carriage bolts (Item B) from the inside of the chute outward, placing the washers and M6 locknuts (items C, D) on the outside. Tighten securely. (Fig 5)

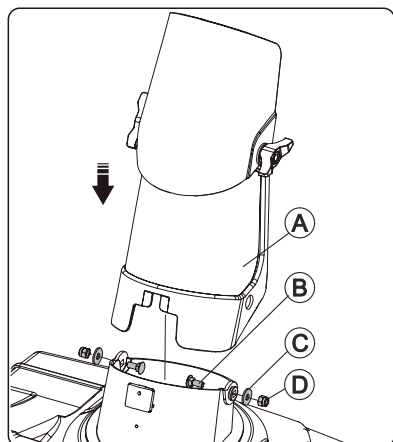

Fig 5

Installing the Chute Rotator

1. Install the Chute Control Assembly onto the right side of the upper handle using two M4 Phillips head screws (item A), M4 Flat washers (item B) and M4 Lock Nut (item E). Note: Place the M4 Flat Washer on the top side of the Chute Control Assy. (Fig 6)

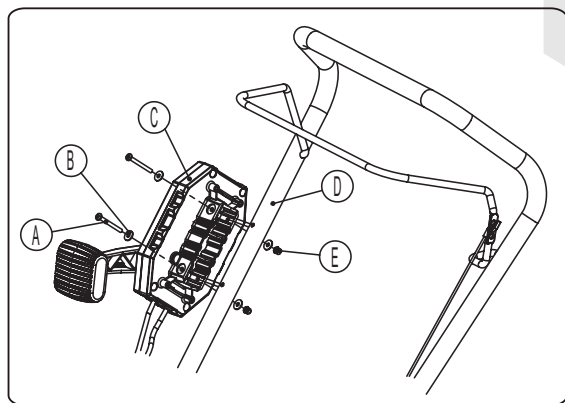

Fig 6

Add Engine Oil



IMPORTANT NOTE: ENGINE IS SHIPPED FROM THE FACTORY WITHOUT OIL. ENGINE OIL MUST BE ADDED PRIOR TO OPERATING GENERATOR.

1. Place the snow thrower on a flat, level surface.
2. Remove oil fill cap/dipstick to add engine oil.
3. Using the supplied funnel and tube, add up to 12.oz (350 ml) of oil to the engine crankcase. DO NOT OVERFILL.
4. Once oil has been added, a visual check should show oil about 1-2 threads from running out of the fill hole.

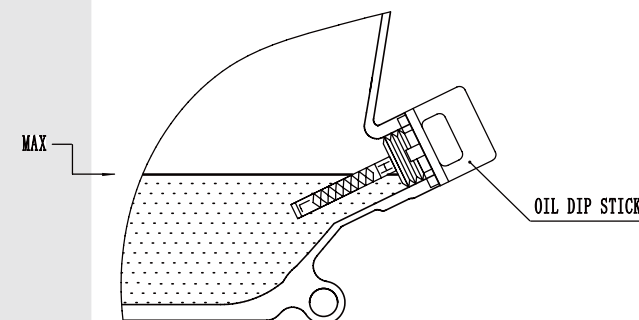
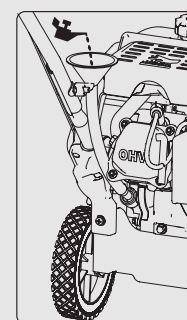

Note: When using the dipstick to check oil level, DO NOT screw in the dipstick while checking.

5. When completed securely screw in the oil filler cap/dipstick.

Add Fuel



DANGER

Gasoline vapors are highly flammable and extremely explosive.

1. Remove the fuel tank cap.
2. Add fresh, regular unleaded gasoline with a minimum of 87 octane and a maximum of 10% ethanol to the fuel tank. DO NOT OVERFILL.
3. Reinstall fuel tank cap and turn clockwise until it stops.

Congratulations, your machine is now ready to operate. Please read the entire operator's manual for full safety and operations guidelines.

Operating Procedures

This section of the quick start guide provides the basic instructions on how to start and operate your new Snow Thrower. This quick start guide is not a comprehensive guide, we recommend the Operator's Manual is read and understood before using your new equipment.



Warning: Read, understand and follow the safety, operation and maintenance information provided in the Operator's Manual.

Starting the Engine

1. Check the oil level and add oil if necessary.
2. Release the Auger Lever.
3. Insert the ON/OFF key. (Fig 7)

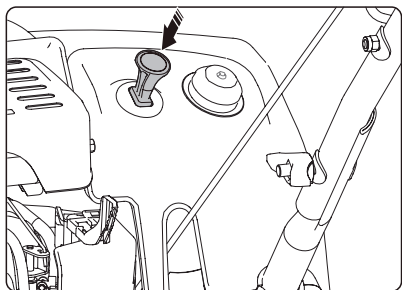

Fig 7

4. Slide the Choke lever to the CLOSED position. (Fig 8)

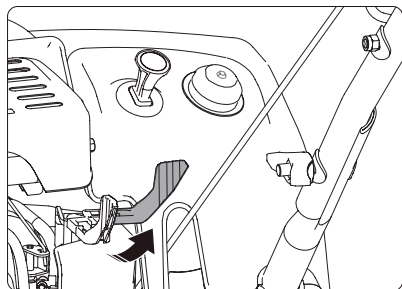

Fig 8

5. Firmly push in the primer 3 times with your thumb, holding the primer in for a second before releasing it each time. (Fig 9)

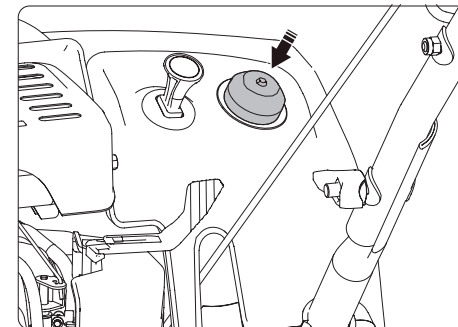

Fig 9

NOTE: Remove your glove when you push in the primer so that air cannot escape from the primer hole.

IMPORTANT: It may not be necessary to use the primer or the choke if the engine has been running and is hot. Excessive priming may flood the engine and prevent it from starting.

6. Pull the starter handle slowly until resistance felt, then pull rapidly. (Fig 10)

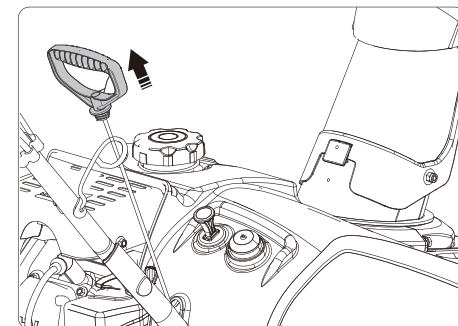

Fig 10

7. Once the engine starts, slide the choke lever to the OPEN position.

Stopping the Engine and the Snow Thrower

To stop the engine

1. Release the Auger Lever.
2. Pull the ON/OFF key out. (Fig 11)

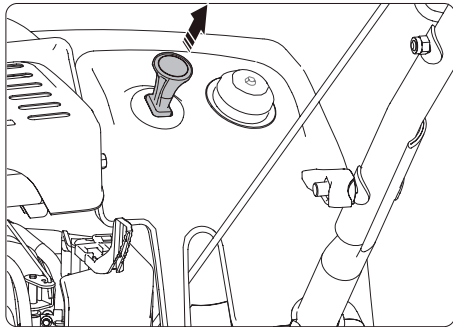

Fig 11

Engaging the Auger Blade

To engage the auger blade, hold the Auger Lever against the upper handle. (Fig 12)

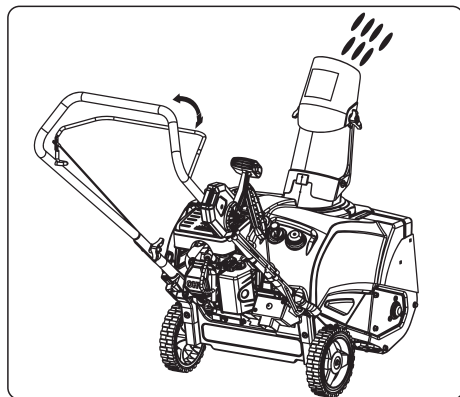

Fig 12

Disengaging the Auger Blade

To disengage the auger blade, release the Auger Lever.

