

3. Align the groove and arrow at the bottom of the fan housing (D) to the arrow on the base assembly (which is near the central hole edge of the base assembly) (Fig. 3). Push the base assembly into the fan body until a “click” is heard. Please make sure the three buckles at the bottom of the fan body connected closely to the base and all connections between the fan body and the base are tight and secure (Fig. 4).

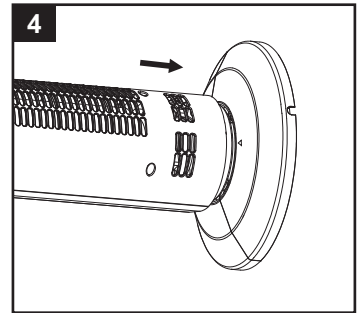

4. Locate the power cord holding bracket at the bottom of the base assembly . Gently pull any slack out of the power cord ,place the power cord securely in the holding bracket and secure the power cord bracket over the power cord .Then thread the power cord through the “U” locating notch on the edge of the base assembly (Fig. 5). Stand the fan in an upright position.

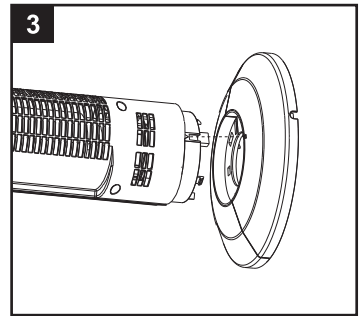
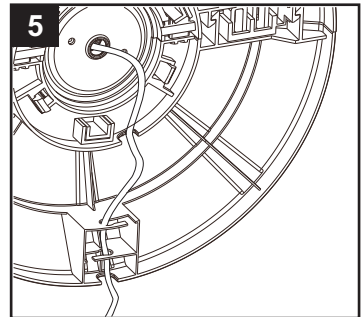

**Note: Do not operate the tower fan unless it is in its proper, upright position.**

## **OPERATING INSTRUCTIONS**

### **Controlling the Fan Speed**

Once fan is fully assembled (see Assembly Instructions section), place fan on a dry, level surface. Plug it into a 120V AC electrical outlet. To operate, turn the rotary knob switch to the appropriate speed control option. There are four available settings: 0=Off, 3=High, 2=Medium, 1=Low.

## Controlling Fan Oscillation

To activate or deactivate fan oscillation, press the oscillation button.

**IMPORTANT:** During the first few minutes of initial use, you may notice a slight odor. This is normal and will quickly disappear.

## CARE AND MAINTENANCE

---

**TO CLEAN:** Always disconnect the power cord from the electrical outlet when cleaning your fan. Light accumulated dust can be removed by using a soft cloth to wipe away the dust at the back grille of the fan. Wipe the exterior surfaces of the fan occasionally with a damp cloth (not dripping wet) and dry thoroughly with a soft dry cloth before operating the fan. Do not use harsh cleaners or materials to clean this unit. Doing so will damage the unit.

**CAUTION:** DO NOT ALLOW WATER TO RUN INTO THE INTERIOR OF THE FAN AS THIS COULD CREATE A FIRE OR ELECTRIC SHOCK HAZARD. THE FAN MOTOR IS FACTORY LUBRICATED FOR LIFE AND WILL REQUIRE NO FURTHER LUBRICATION. NO OTHER USER MAINTENANCE IS REQUIRED OR RECOMMENDED. IF SERVICE IS REQUIRED, SEND YOUR FAN TO THE AUTHORIZED SERVICE FACILITY.

**TO STORE:** Make sure to disassemble and clean the fan before storing. Retain the original packaging for the purpose of storing your fan. Always store fan in a dry place. Never store it while it is still plugged in. Never wrap the cord tightly around the fan, and do not put any stress on the cord where it enters the fan, as it could cause the cord to fray and break.

## ONE-YEAR LIMITED WARRANTY

---

The manufacturer warrants to the original purchaser that each new product and service part is free from defects in material and workmanship and agrees to repair or replace under this warranty any defective product or part as follows from the original date of purchase for a period of one (1) year.