

DESIGN

PURCHASE

CONSTRUCT

ENJOY

Installation Instructions,
56639 6-8" Joist Hanger Flush (JHF-68-LS)
51739 6-8" Joist Hanger Flush (JHF-68-IW)

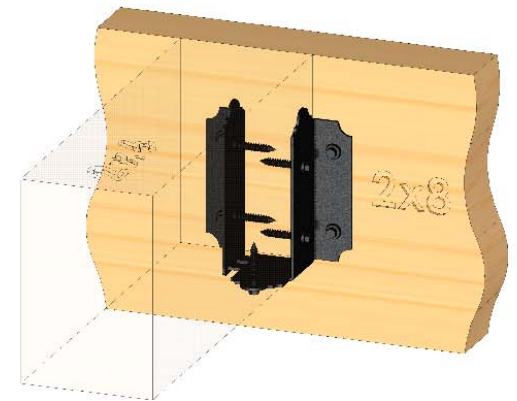

Typical Installation
Laredo Sunset shown



Installation Instructions, 56639



Printing Documents from ISSUU

Unfortunately, there is currently no way to print content directly through issuu. To print a publication, you will need to download it and print it from your computer.

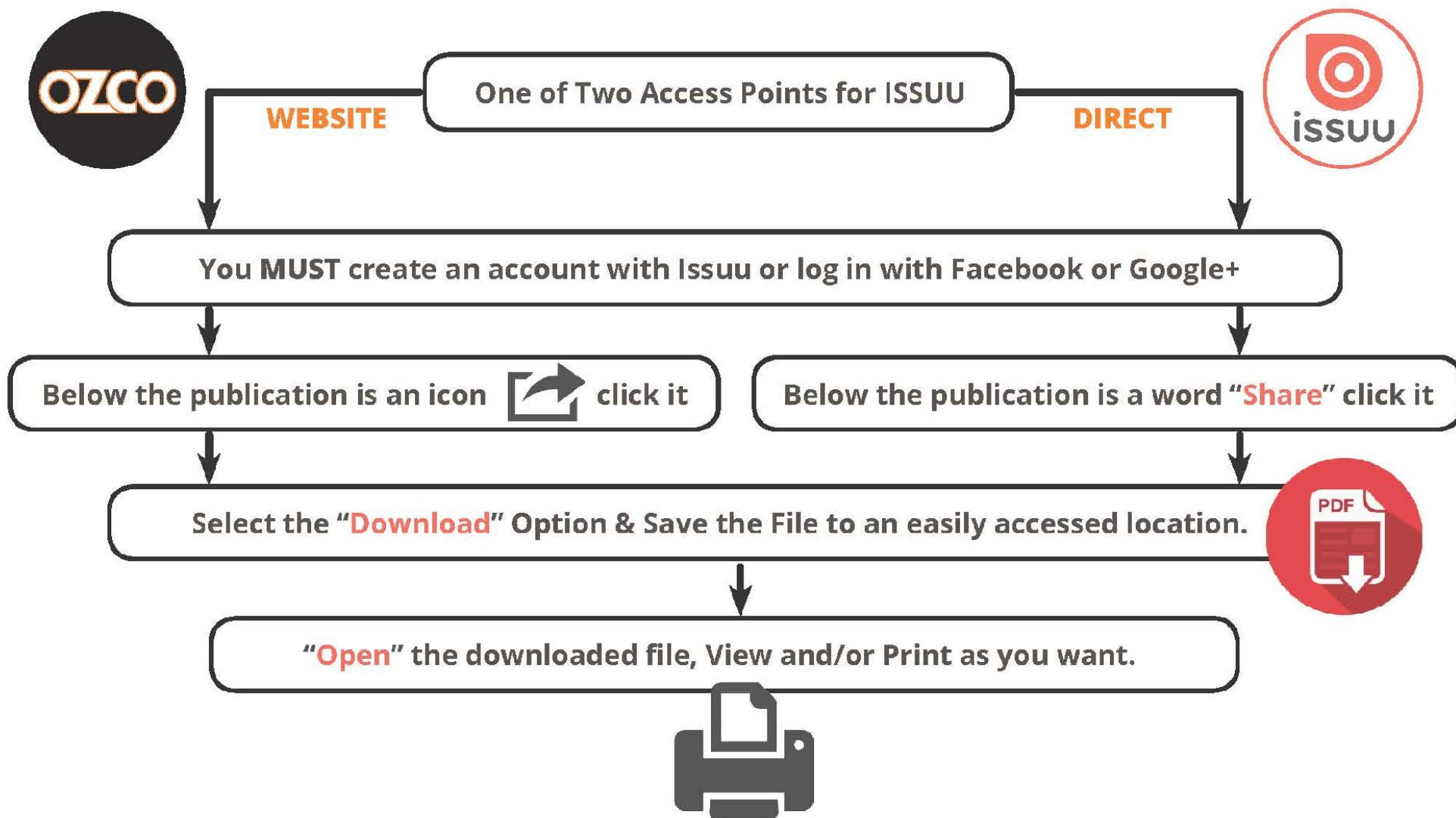

Laredo Sunset & Ironwood



Laredo Sunset
(566XX series)

2 great styles
Same functionality
choose your
connection lifestyle
both styles available for
most products

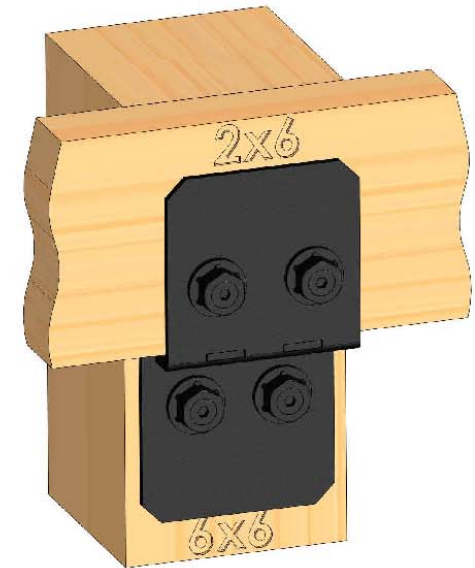

Ironwood
(517XX series)



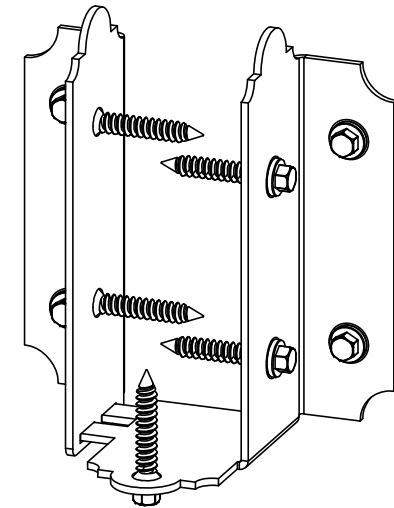
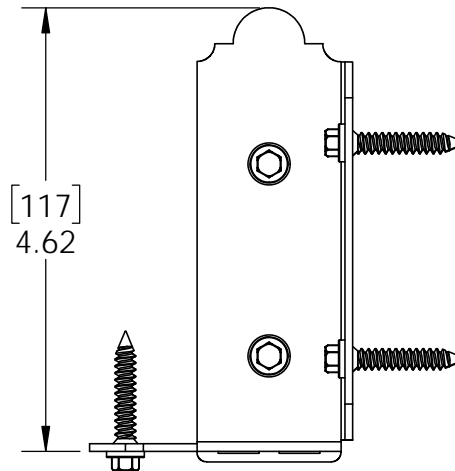
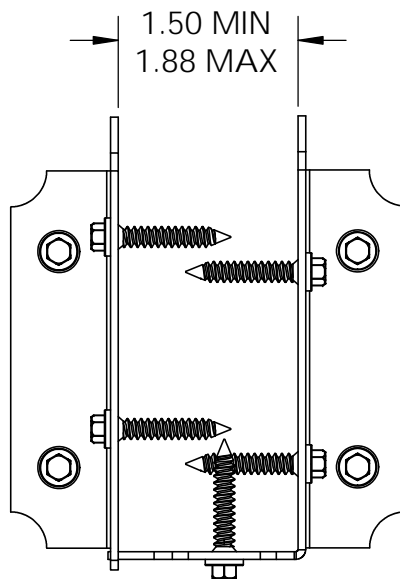
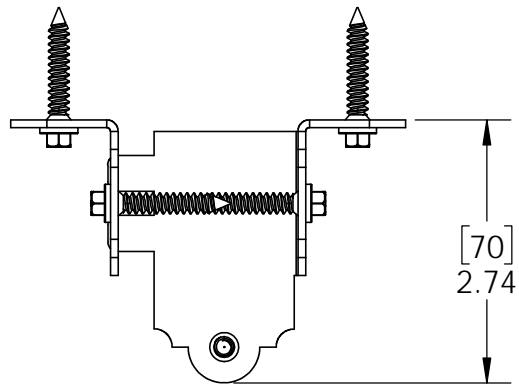

kit includes 6 assemblies

56639

Installation Instructions, 56639

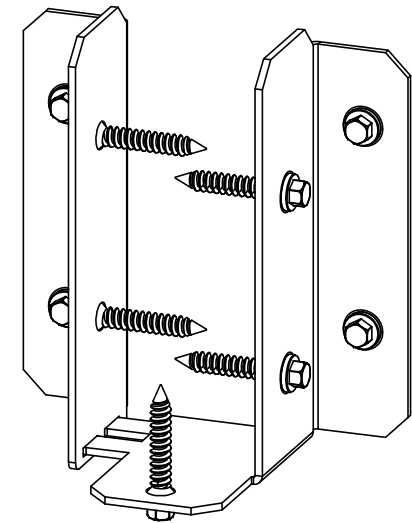
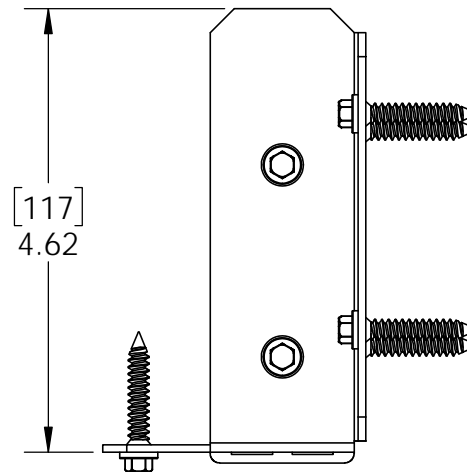
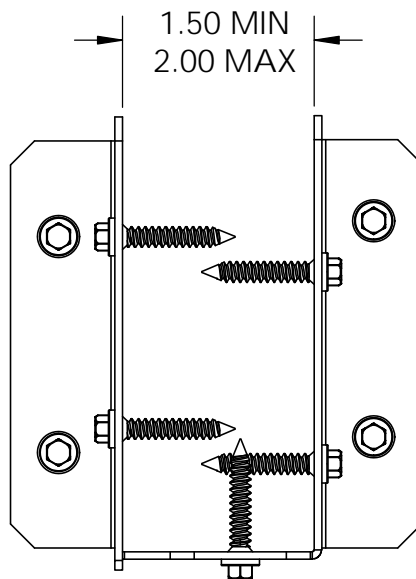
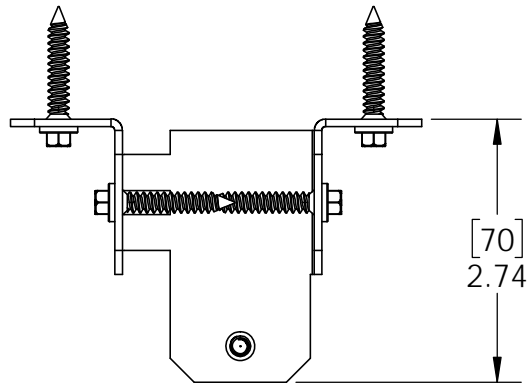

kit includes 6 assemblies

51739

Installation Instructions, 56639

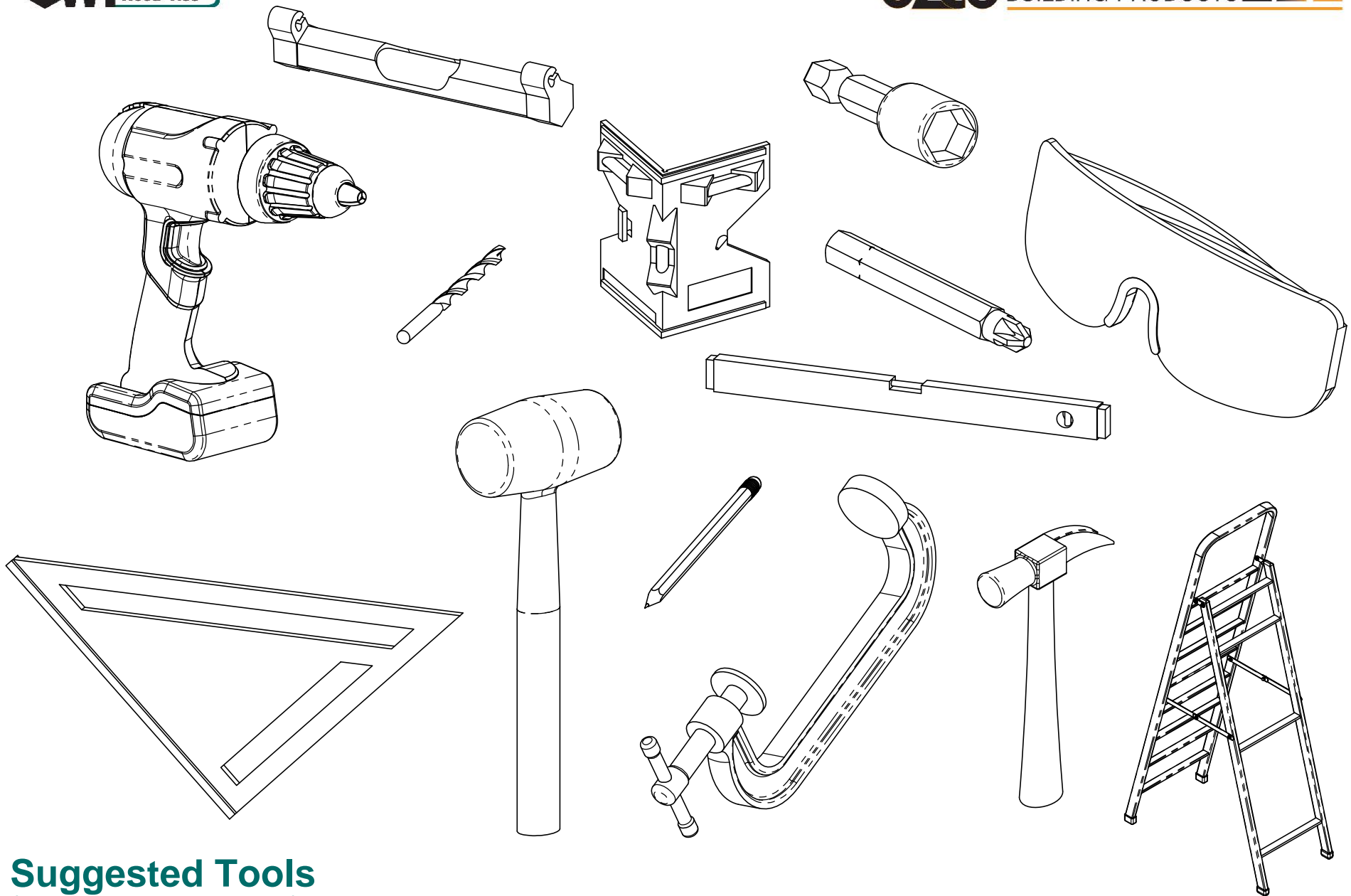

Suggested Tools

(others may be required)

Installation Instructions, 56639

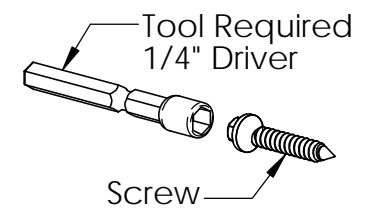
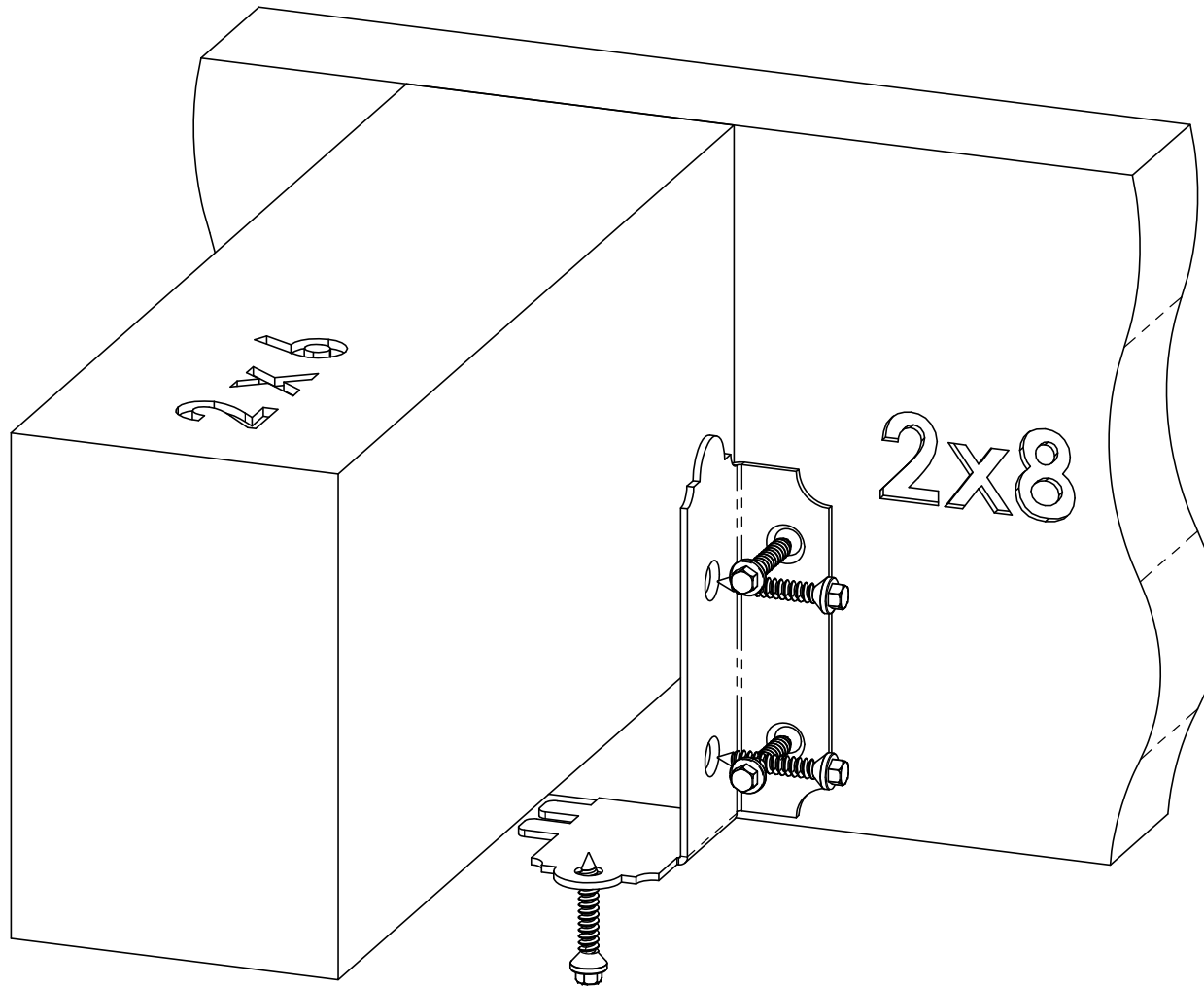

Typical Installation & Assembly

Installation Instructions, 56639

V2.00 - Installation Instructions, Specifications and Project Plans are effective 8/3/2016 . This information is updated periodically and should not be relied upon after 2 years from 8/3/2016 . Please visit OZCOBP.com to get current information.